



Graders

845B / 845B DHP

865B / 865B VHP / 865B AWD

885B / 885B DHP / 885B AWD

TIER 0 / TIER 1 / TIER 2 / TIER 3

Service Manual

71114392



CNH Latin America Ltda.
Printed in Brazil

GRADERS
845B / 865B / 885B
845B DHP / 865B VHP / 885B DHP
865B AWD / 885B AWD
Service Manual
71114392
Table of Contents

Description	Section Number	Publication Form Number
General		Tab 1
Section Index - General		6-46520
Standard Torque Especifications	1001	6-46530
Fluids and Lubricants	1002	6-46540
Metric Conversion Chart	1003	6-46550
Service Tools	1005	6-46551
Engine		Tab 2
Section Index – Engines		6-46559
Engine – Tier 3	2002	6-46557
Charge Air Cooler System	2003	6-46570
Fuel System		Tab 3
Section Index - Fuel System		6-46580
Fuel System	3001	6-46590
Electrical		Tab 4
Section Index - Electrical		6-46600
Removal and Installation of Starter and Alternator	4001	6-42320
Electrical Diagram – Without All Wheel Drive System	4002	6-46620
Electrical Diagram– With All Wheel Drive System	4003	6-46621
Battery	4004	6-42330
Steering		Tab 5
Section Index - Steering		6-46780
Steering Control Valve	5003	6-46690
Steering Priority Valve	5004	6-46700

Description	Section Number	Publication Form Number
Power Train	Tab 6	
Section Index - Power Train		6-46740
ZF Transmission – Ergopower 5/6 WG-160 – 845B / 845B DHP / 865B / 865B VHP Models	6000	6-46730
ZF Transmission – Specifications, Pressure Checks, and Troubleshooting	6001	6-46750
FUNK Transmission – 845B / 845B DHP 865B / 865B VHP / 865B AWD Models	6003	6-75360
FUNK Transmission – 885B / 885B DHP / 885B AWD Models	6004	6-75361
Front Axle – 845B / 865B / 885B / 845B DHP / 865B VHP / 885B DHP Models	6007	6-46790
Front Drive Axle – 865B AWD / 885B AWD Models	6008	6-46770
Transmission Gear Box (Wheel Reductor) For Front Drive Axle – 865B AWD / 885B AWD Models	6009	6-46771
Rear Axle Assembly (Graziano) – 845B / 845B DHP Models	6010	6-46820
Rear Axle Assembly (Graziano) – 865B / 865B VHP / 865B AWD / 885B / 885B DHP / 885B AWD Models	6011	6-46811
Tandem for Rear Axle Assembly (Graziano)	6013	6-46821
Tandem Flange Adjustments (Graziano)	6014	6-46822
Brakes	Tab 7	
Section Index – Brakes		6-46810
Hydraulic Brake Troubleshooting	7002	6-46830
Brake Pedal Valve and System	7003	6-46840
Hydraulics	Tab 8	
Section Index - Hydraulics		6-46812
Removal and Installation of Hydraulic Components	8001	6-46870
Front Wheel Drive Hydraulic Pump and Motor – 865B AWD / 885B AWD Models	8003	6-46890
Hydraulic Schematics – 865B AWD / 885B AWD Models	8004	6-46891
Mounted Equipment	Tab 9	
Section Index - Mounted Equipment		6-46940
Air Conditioning Troubleshooting and System Checks for Systems With HFC-134A Refrigerant	9002	6-46950
Removal and Installation of Air Conditioning Components for Systems With HFC-134A Refrigerant	9004	6-46971
Rear Ripper	9007	6-47011
Frame, Articulation Joint Circle and Scarifier	9008	6-47001
Front Blade and Counterweight	9009	6-47021

<https://www.ebooklibonline.com>

Hello dear friend!

Thank you very much for reading.

Enter the link into your browser.

The full manual is available for immediate download.

<https://www.ebooklibonline.com>

SECTION INDEX

GENERAL

Section Title	Section Number
Standard Torque Especifications	1001
Fluids and Lubricants	1002
Metric Conversion Chart	1003
Service Tools	1005

Section 1001

1001

STANDARD TORQUE ESPECIFICACIONES

TABLE OF CONTENTS

TORQUE SPECIFICATIONS	3
Decimal.....	3
Métric.....	4
Steel Hydraulic Fittings.....	5
Steel Hydraulic Fittings.....	6

NOTE: CASE reserves the right to make improvements in design or changes in specifications at any time without incurring any obligation to install them on units previously sold.

TORQUE SPECIFICATIONS

Decimal

Use the torques in this chart when special torques are not given. These torques apply to fasteners with both UNC and UNF threads as received from suppliers dry, or when lubricated with engine oil. Not applicable if special graphities, Molydisulfide greases, or other extreme pressure lubricants are used.

GRADE 5 BOLTS, NUTS AND STUDS		
		
Size (inch)	Pound-Inches	N.m
1/4	9 - 11	12 - 15
5/16	17 - 21	23 - 28
3/8	35 - 42	48 - 57
7/16	54 - 64	73 - 87
1/2	80 - 96	109 - 130
9/16	110 - 132	149 - 179
5/8	150 - 180	203 - 244
3/4	270 - 324	366 - 439
7/8	400 - 480	542 - 651
1.0	580 - 696	787 - 944
1-1/8	800 - 880	1085 - 1193
1-1/4	1120 - 1240	1519 - 1681
1-3/8	1460 - 1680	1980 - 2278
1-1/2	1940 - 2200	2631 - 2983

GRADE 8 BOLTS, NUTS AND STUDS		
		
Size (inch)	Pound-Inches	N.m
1/4	12 - 15	16 - 20
5/16	24 - 29	33 - 39
3/8	45 - 54	61 - 73
7/16	70 - 84	95 - 114
1/2	110 - 132	149 - 179
9/16	160 - 192	217 - 260
5/8	220 - 264	298 - 358
3/4	380 - 456	515 - 618
7/8	600 - 720	814 - 976
1.0	900 - 1080	1220 - 1465
1-1/8	1280 - 1440	1736 - 1953
1-1/4	1820 - 2000	2468 - 2712
1-3/8	2380 - 2720	3227 - 3688
1-1/2	3160 - 3560	4285 - 4827

NOTE: Use thick nuts with Grade 8 bolts.

Métric

Use the following torques when specifications are not given. These values apply to fasteners with coarse threads as received from supplier, plated or unplated, or when lubricated with engine oil. These values do not apply if graphite or Molydisulfide grease or oil is used.

GRADE 8.8 BOLTS, NUTS AND STUDS		
		
Size (inch)	Pound-Inches	N.m
M4	2 - 3	3 - 4
M5	5 - 6	6.5 - 8
M6	8 - 9	10.5 - 12
M8	19 - 23	26 - 31
M10	38 - 45	52 - 61
M12	66 - 79	90 - 107
M14	106 - 127	144 - 172
M16	160 - 200	217 - 271
M20	320 - 380	434 - 515
M24	500 - 600	675 - 815
M30	920 - 1100	1250 - 1500
M36	1600 - 1950	2175 - 2600

GRADE 10.9 BOLTS, NUTS AND STUDS		
		
Size (inch)	Pound-Inches	N.m
M4	3 - 4	4 - 5
M5	7 - 8	9.5 - 11
M6	11 - 13	15 - 17.5
M8	27 - 32	37 - 43
M10	54 - 64	73 - 87
M12	93 - 112	125 - 152
M14	149 - 179	300 - 245
M16	230 - 280	310 - 380
M20	450 - 540	610 - 730
M24	780 - 940	1050 - 1275
M30	1470 - 1770	2000 - 2400
M36	2580 - 3090	3500 - 4200

GRADE 12.9 BOLTS, NUTS AND STUDS		
		
Usually the torque values specified for grade 10.9 fasteners. can be used satisfactorily on grade 12.9 fasteners.		

Steel Hydraulic Fittings

Tube OD Hose ID	Thread Size	Pound- Inches	N.m
37 DEGREE FLARE FITTING			
1/4" (6.4 mm)	7/16 - 20	6 - 12	8 - 16
5/16" (7.9 mm)	1/2 - 20	8 - 16	11 - 22
3/8" (9.5 mm)	9/16 - 18	10 - 20	14 - 34
1/2" (12.7 mm)	3/4 - 16	15 - 42	20 - 56
5/8" (15.9 mm)	7/8 - 14	25 - 58	34 - 78
3/4" (19.0 mm)	1-1/16 - 12	40 - 80	54 - 108
7/8" (22.2 mm)	1-3/16 - 12	60 - 100	81 - 135
1.0" (25.4 mm)	1-5/16 - 12	75 - 117	102 - 158
1-1/4" (31.8 mm)	1-5/8 - 12	125 - 165	169 - 223
1-1/2" (38.1 mm)	1-7/8 - 12	210 - 250	285 - 338

Tube OD Hose ID	Thread Size	Pound- Inches	N.m
STRAIGHT THREADS WITH O-RING			
1/4" (6.4 mm)	7/16 - 20	12 - 19	16 - 25
5/16" (7.9 mm)	1/2 - 20	16 - 25	22 - 34
3/8" (9.5 mm)	9/16 - 18	25 - 40	34 - 54
1/2" (12.7 mm)	3/4 - 16	42 - 67	57 - 90
5/8" (15.9 mm)	7/8 - 14	58 - 92	79 - 124
3/4" (19.0 mm)	1-1/16 - 12	80 - 128	108 - 174
7/8" (22.2 mm)	1-3/16 - 12	100 - 160	136 - 216
1.0" (25.4 mm)	1-5/16 - 12	117 - 187	159 - 253
1-1/4" (31.8 mm)	1-5/8 - 12	165 - 264	224 - 357
1-1/2" (38.1 mm)	1-7/8 - 12	250 - 400	339 - 542

SPLIT FLANGE MOUNTING BOLTS		
Size (inch)	Pound-Inches	N.m
5/16 - 18	15 - 20	20 - 27
3/8 - 16	20 - 25	27 - 34
7/16 - 14	35 - 45	47 - 61
1/2 - 13	55 - 65	74 - 88
5/8 - 11	140 - 150	190 - 203

Section 2002

2002

**ENGINE – TIER 3
845B DHP / 865B VHP / 885B DHP /
865B AWD / 885B AWD
MODELS**

TABLE OF CONTENTS

ENGINE DIAGNOSTIC TOOL.....	6
FAILS DIAGNOSTICS.....	7
Engine Fails to Start	7
Engine Overheating.....	8
Engine Lacks Power and Operates Irregularly	9
Engine Smokes Black or Dark Grey	10
Engine Smokes (Tending to White)	10
Engine Smokes Light Blue.....	10
Engine Knocks Abnormally.....	11
The Engine Dies	12
Excessive or Insufficient Oil Pressure	12
Excessive Fuel Consumption	12
ENGINE.....	13
Identification Code	14
Properties	14
GENERAL SPECIFICATIONS.....	15
CRANKSHAFT MECHANISM COMPONENTS AND CYLINDERS SET	17
VALVE MECHANISM – CYLINDER SET	20
SPECIAL TOOLS	22
TIGHTENNING TORQUES.....	23
667TA ENGINES	25
DESCRIPTION OF ENGINE MAIN COMPONENTS	26
Engine Block.....	26
Crankshaft	27
Connecting Rod	28
Piston.....	29
Camshaft	30
Exhaust Gas Recirculation - EGR	30
Valve Control	31
Cylinder Head of Engines – 667TA/EBF – 667TA/EBD – 667TA/EED	32
Cylinder Head of Engines – 667TA/EEG – 667TA/EEC	33
Cylinder Head of Engines – 667TA/EDJ.....	34
Valves and Valves Seats	35
Valves Bridge.....	35
Cylinder Head Machining.....	36
Engine Flywheel	36
AUXILIARY DEVICES DRIVING	37
ENGINE LUBRICATION.....	38
Oil Coller	39
Oil Pressure Control Valve.....	39
Deviation Valve	39
Oil Pump.....	40
Oil Sump of Engines – 667TA/EEG – 667TA/EEC – 667TA/EBF – 667TA/EED – 667TA/EDJ	41
Oil Sump of Engines – 667TA/EED – 667TA/EBD	41
Blow-By.....	42
ENGINE COOLER.....	43
Water Pump.....	44
COMMON RAIL – HIGH PRESSURE ELECTRONIC INJECTION SYSTEM	45

EDC7UC31 – ELECTRONIC CONTROL UNIT OPERATION.....	46
Engine Pre-Post Heater Control	46
Phase Recognition.....	46
Injection Control.....	46
Closed Mesh Injection Pressure Control System	46
Main Control and Main Injection Advance Control.....	46
Idle Control	46
Overheating Protection	46
Engine Maximum Rotation Limit.....	46
Cut-Off	46
Smoke Control Under Acceleration.....	46
After Engine Cut-Off	46
Work Rotation Control in Normal Operation Conditions	46
Recovery Strategy	47
FUEL SUPPLY SISTEM	48
Fuel Supply System Diagram	49
Fuel Filter.....	50
Mechanical Supply Pump – Normal Operation Condition.....	51
Mechanical Supply Pump – Unit Exit Overpressure Condition.....	51
Bleeding Condition of the Fuel System.....	52
High Pressure Pump CP3.3 TYPE	53
High Pressure Pump Exploded View.....	54
High Pressure Pump Internal View.....	55
Operation.....	56
Operation Theory.....	58
COMMON RAIL.....	59
Common Rail Pressure Relief Valve.....	60
ELECTROINJECTOR.....	61
Injector in Rest Position.....	61
Injection Starts	61
Injection End.....	61
Injector Nozzler.....	62
Fuel Return Pressure Limiter.....	62
LOCATION OF MAIN ELECTRICAL COMPONENTS.....	63
EDC7UC31 – Electronic Control Unit	64
Engine Pin-Out	65
Injectors Connector A Pin-Out Diagram.....	66
Injectors Connector C Pin-Out Diagram	66
Crankshaft Sensor	67
Camshaft Sensor.....	67
Pressure and Temperature Sensor.....	68
Engine Oil Pressure and Temperature Sensor	68
Common Rail – Fuel Pressure Sensor	69
Electroinjector	70
Intake Air Resistance Heater and Rele.....	71
Fuel Temperature Sensor	72
Filter Heater Rele.....	72
High Pressure Pump – Pressure Regulator.....	73

FUEL SYSTEM CHECK	74
High Pressure Supply Test	74
Low Pressure Pump	75
Common Rail Pressure Relief Valve Test	76
Fuel Counter-Flow Test from the Return.....	77
ENGINE OVERHAULING IN BENCH	79
Engine Disassembly	79
ENGINE BLOCK CHECKS AND SPECIFICATIONS	91
Checks And Measurement.....	91
Camshaft Lobe And Journal Surface Check.....	91
Bearings.....	92
Checking The Contact Surface Between Cylinder Head And Cylinder Block.....	93
Camshaft Synchronism.....	93
Lobe Bearing Replacement	94
Tappets	94
Camshaft Tappets Installation.....	95
CRANCKSHAFT.....	97
Cranckshaft Journal Measurement.....	97
Cranckshaft Journals Marking Data.....	97
Cranckshaft Main Tolerances	98
Oil Pump Gears Replacement.....	99
Main Bearings Installation.....	99
Journals Assembly Clearance Measurement	100
Cranckshaft Recess Clearance Measurement	101
Connecting Rod – Piston Set.....	101
Piston, Pin and Piston Ring Data.....	102
Piston Pin Diameter Measurement.....	103
Piston Pin.....	103
Pin-Piston Correct Mating Condition.....	103
Piston Rings.....	104
Connecting Rod	105
Bearings.....	106
Connecting Rod Check.....	106
Torsion Check.....	107
Flexibility Check.....	107
Connecting Rod – Piston Set Coupling Installation	108
Piston Rings Installation	109
Connecting Rods-Piston Sets – Installation in Cylinder Block.....	109
Journal Clearance Measurement in Cranckshaft Set	110
Piston Outgrowth Check	112
Timing Gear Housing.....	112
Valve Synchronism	113
Engine Flywell Housing	114
ENGINE FLYWHEEL.....	115
Replacement of the Engine Flywheel Annular Gear	115
CYLINDER HEAD	121
Valve Remotion.....	121
Cylinder Head Water Sealing Check	122
Cylinder Head Contact Surface Sealing	122

VALVES	123
Cleaning, Checking and Valve Rectification	123
Assembling Clearance Checking and Valve Centralization	123
VALVE GUIDES	124
VALVE SEATS	125
Cylinder Head Valve Seat Main Data	125
Cylinder Head Valve Seat Main Data	126
VALVE SPRINGS	127
Main Data Check of Intake and Exhaust Valve Springs	127
CYLINDER HEAD	128
Cylinder Head Installation	129
Injectors Installation	130
Pushrods and Tappets	131
Rocker Set	132
Locating the Top Dead Center (TDC)	133
Valve Clearance Adjust	134
Wiring Harness Connection to Engine	139
STARTER	141
Quick Diagnosys	141
Starter Bosch 24 Volts – 4KW	142
Starter Iskra 24 Volts – 4KW	143
Starter Denso 24 Volts – 7,8KW	143
ALTERNATOR	144
Quick Diagnosys	144
Bosch: NCBI 28 Volt 35-70 AMP	145
Starter Remotion	146
Starter Installation	147
Alternator Remotion	148
Alternator Installation	150
Belt Installation	152

667TA ENGINES

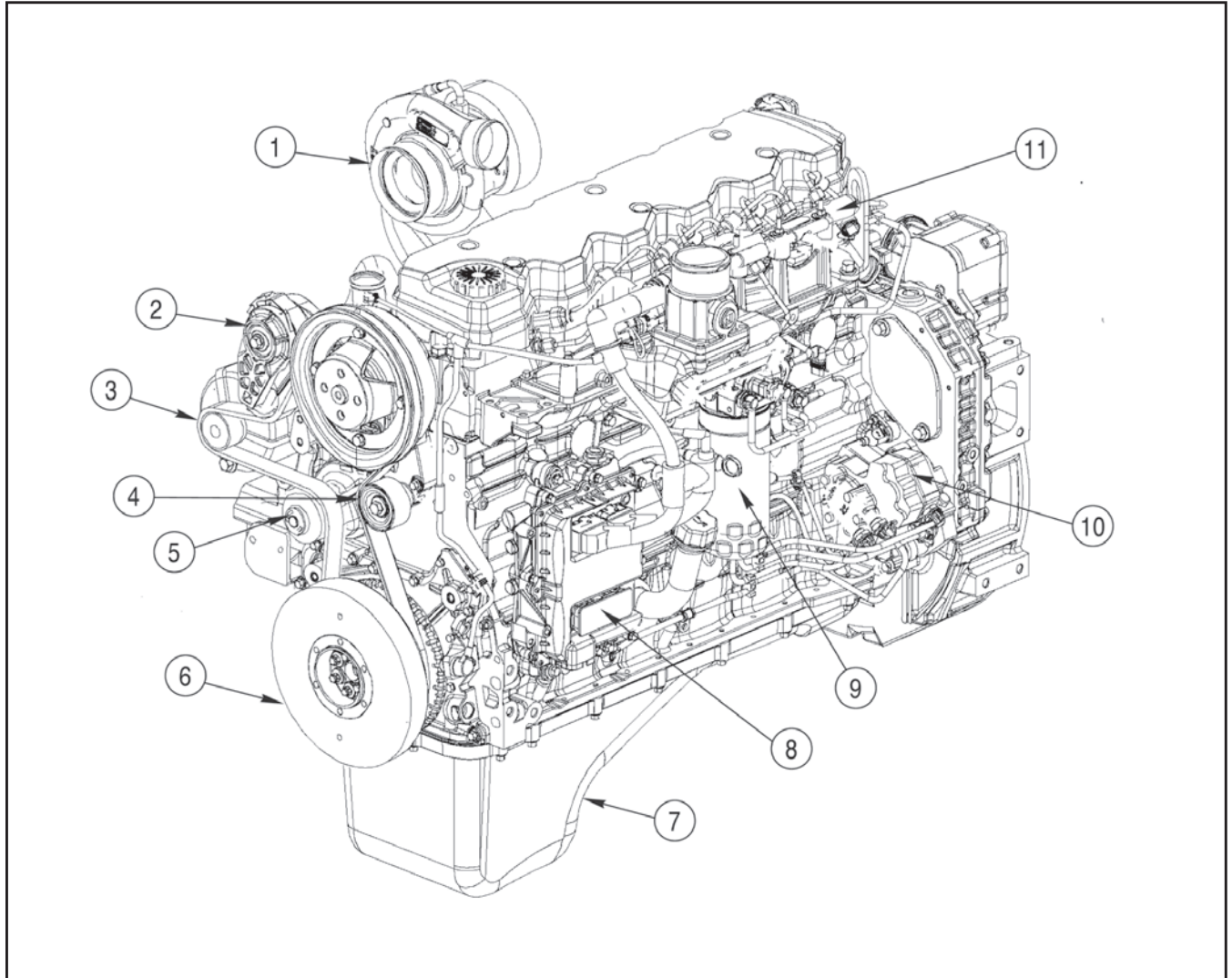

BS06K020

Figura 3000-12

1. TURBOCHARGER
2. AUTOMATIC TENSION BELT
3. ALTERNATOR
4. FIX GUIDE PULLEY
5. WATER PUMP
6. ENGINE FLYWHEEL COUNTERWEIGHT

7. OIL SUMP
8. ELECTRONIC CONTROL UNIT - E.C.U.
9. FUEL FILTER
10. HIGH PRESSURE PUMP
11. COMMON RAIL

DESCRIPTION OF ENGINE MAIN COMPONENTS

Engine Block

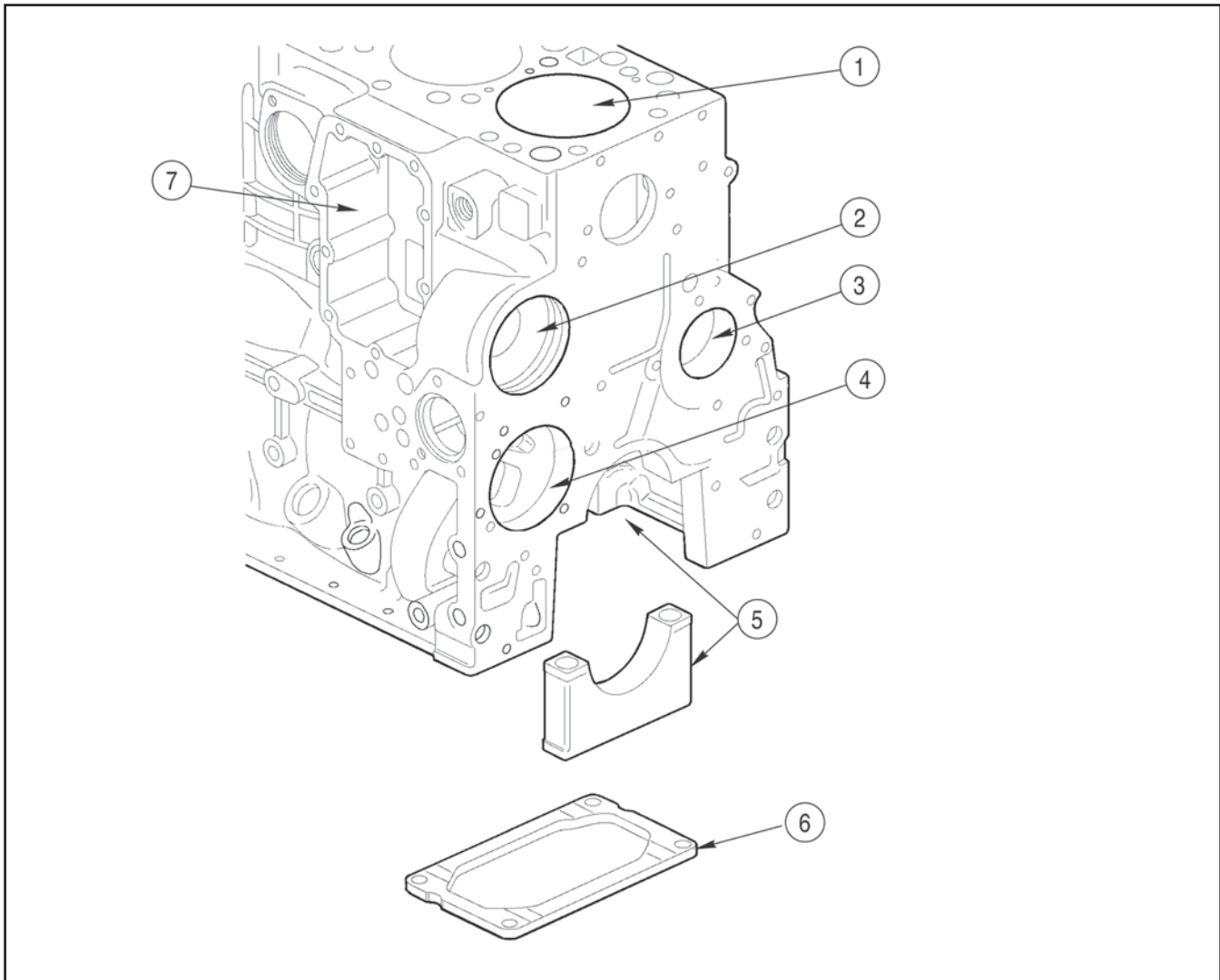

- | | |
|----------------------------------|---|
| 1. CYLINDER BORE | 5. MAIN JOURNALS |
| 2. MOUNTING FOR WATER PUMP | 6. STIFFENING PLATE |
| 3. MOUNTING FOR CAMSHAFT BEARING | 7. MOUNTING FOR WATER-OIL EXCHANGE HEATER |
| 4. MOUNTING FOR OIL PUMP | |

The cylinder block is a cast iron structure with cylinders bores (1), main journals (5) e moun-tings for camshaft bearing (3) and valves, water-oil exchanger heater (7), water pump (2) and oil pump (4). The block also has coolant and oil passages. The lubrication circuit provides oil for the moving parts. The stiffening plate (6) is applied in the engine block bottom to increase the resistance to mechanical fatigue.

Crankshaft

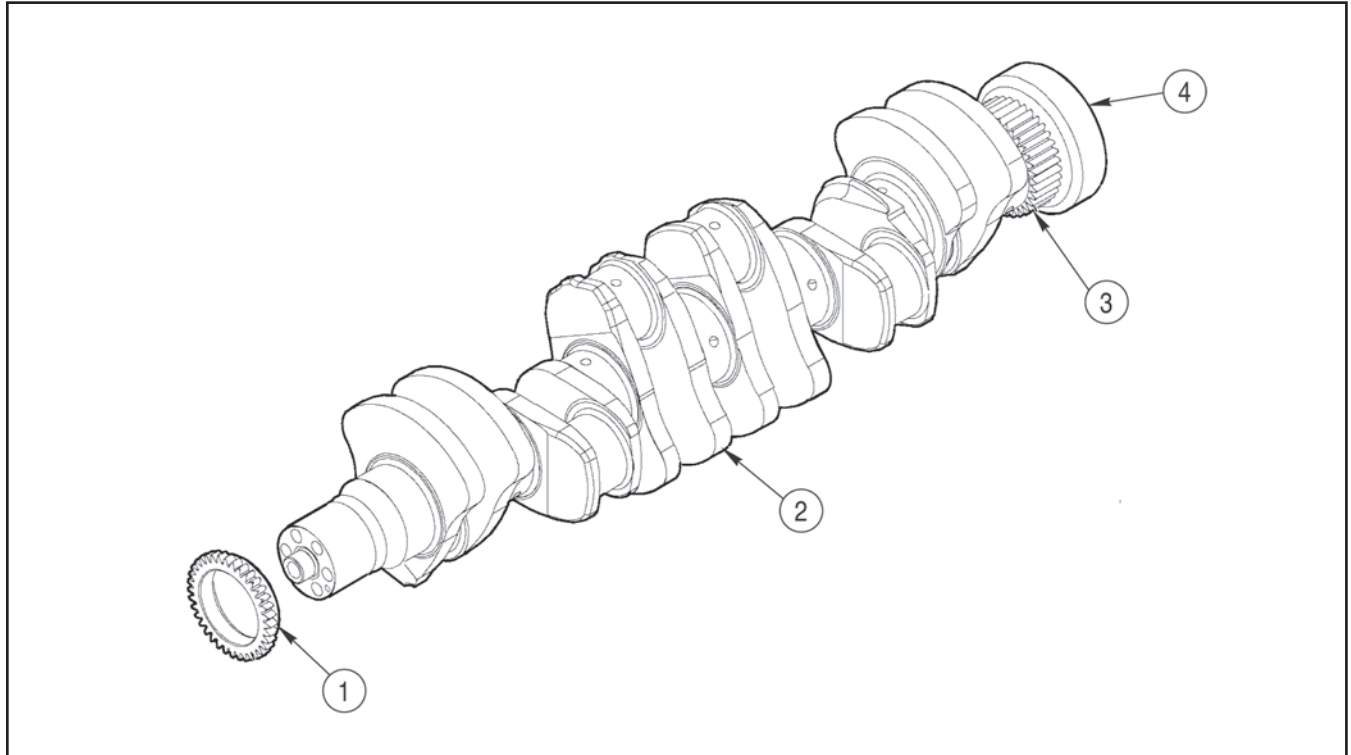

BS06K022

Figura 3000-14

- | | |
|------------------|---------------------------------|
| 1. OIL PUMP GEAR | 3. TIMING GEAR |
| 2. CRANKSHAFT | 4. MOUNTING FOR ENGINE FLYWHEEL |

The crankshaft is steel made and rests in seven journals tempered by induction.

There is a series of drilled passages for the lubricating oil.

The follow items are pressed in front: oil pump gear (1), position sensor sprocket, counterweight, and the auxiliary devices pulley.

The follow items are pressed in rear: timing gear (3), and the mounting for engine flywheel (4).

The main journals bearings are steel made and coated by a anti-friction alloy. One of them is equipped with shoulders to limit the crantckshaft axial clearance.

The timing gear (3) and the engine flywheel mounting (4) are forced positioned in the crantckshaft rear and can not be replaced.

CRANCKSHAFT OIL SEALS

The front and rear seals are box type with radial sealing. To remove them use the special tools 380000665 e 380000663. For installation se special tools 380000666 e 380000664.

Connecting Rod

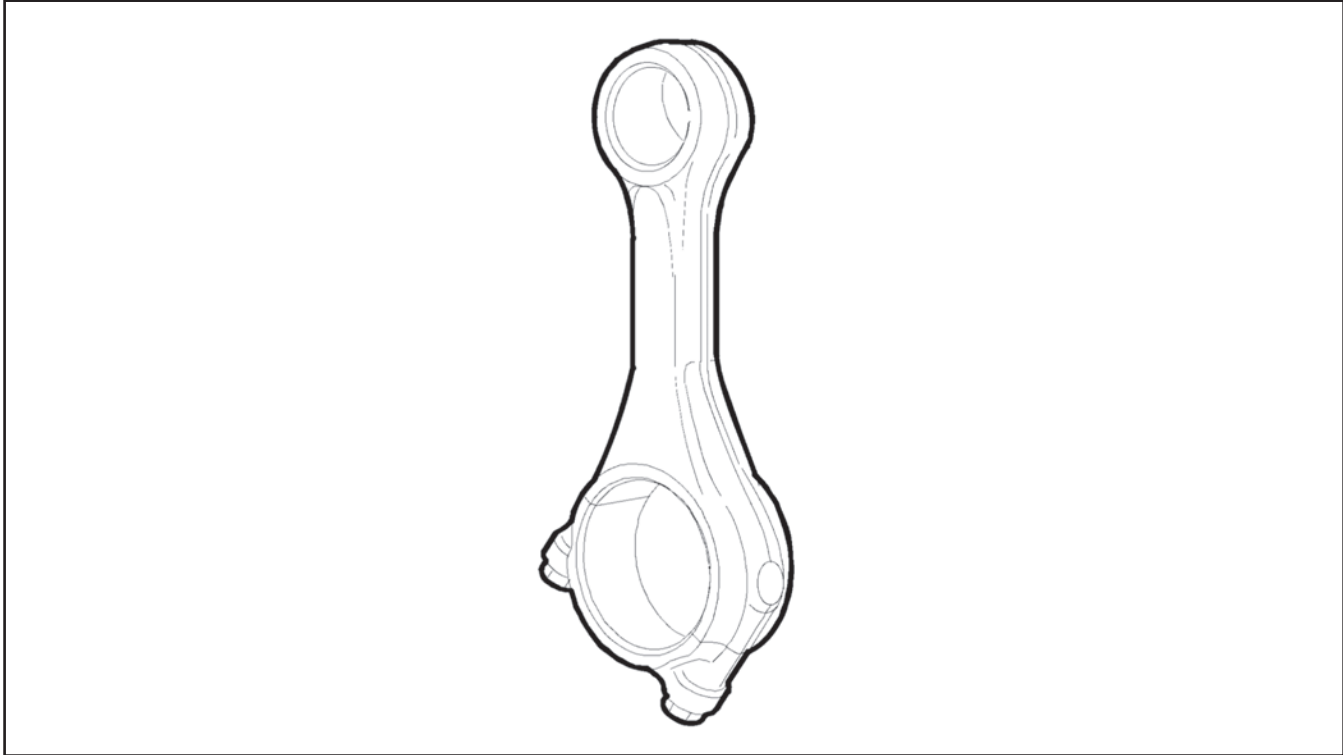

BS06K023

Figura 3000-15

Connecting rods are forged steel. The big ends are made with an oblique angle. Caps and rods are separated by a fracture splitting method that produces a strong and unique fit cap. The connecting rod big end bearings are coated by anti-friction alloy.

They are marked two ways:

- Body-cap: have a number that indicates match and cylinder which they are assembled.
- Rod shank: marked with a letter indicating weight class.

Piston

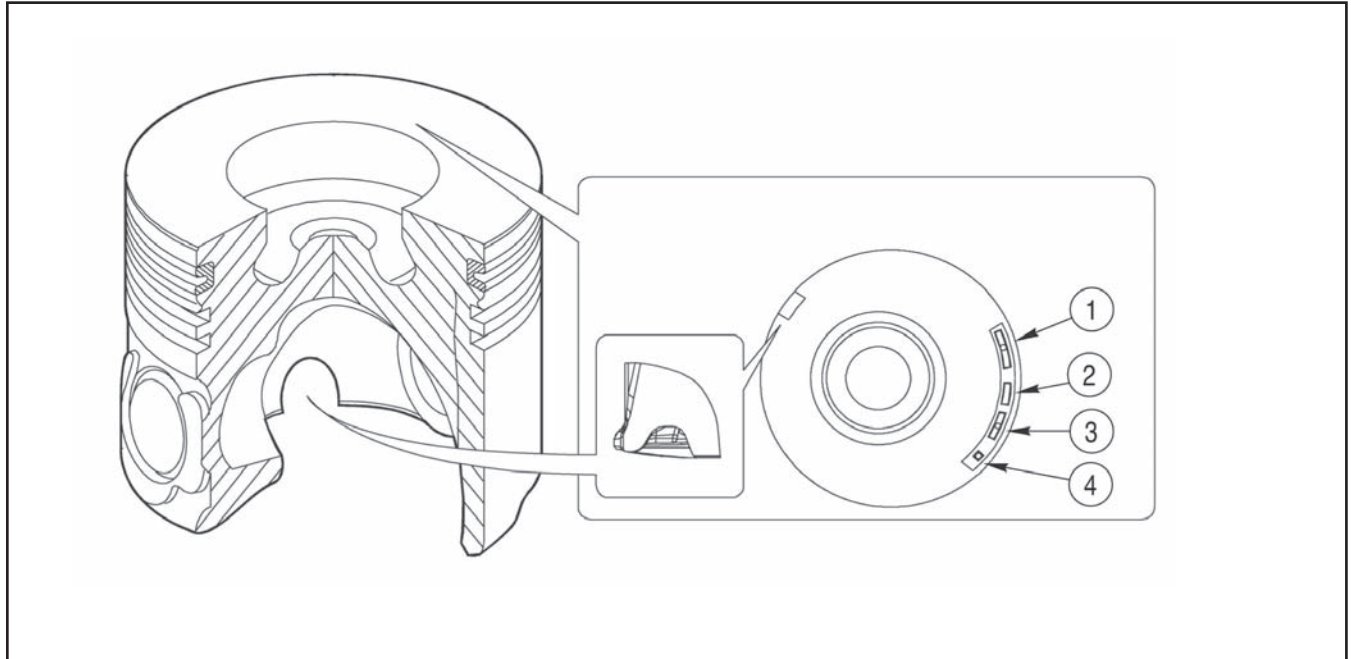

BS06K024

Figura 3000-16

A coroa na cabeça do pistão apresenta uma câmara de combustão de alta turbulência. A parte inferior da coroa na cabeça do pistão é arrefecida pelo óleo do motor distribuído por um bico pulverizador instalado no bloco do motor.

Existem três canaletas para anéis do pistão com diferentes funções e diferente geometria:

The piston crown features a high turbulence combustion chamber. The piston crown is cooled from underneath by a spray nozzle installed in the crankcase.

There is three groves for piston rings with different functions and different geometry:

- 1st piston ring with trapezoidal section (keystone) and coated by chrome ceramic.
- 2nd piston ring with torsional conical rectangular section.
- 3rd piston ring with double oil scraper and inner spring.

In the piston crown are marked the reference data:

1. Number of spare part and number of design modification.
2. Mark (looking from the frontal engine block) indicating the direction of assembly of the piston in the cylinder
3. Date of manufacture.
4. Mark indicating the first test of the recess insert.

Camshaft

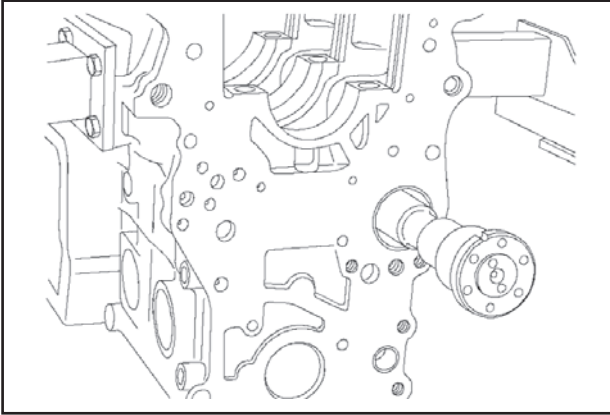

BS06K025

Figura 3000-17

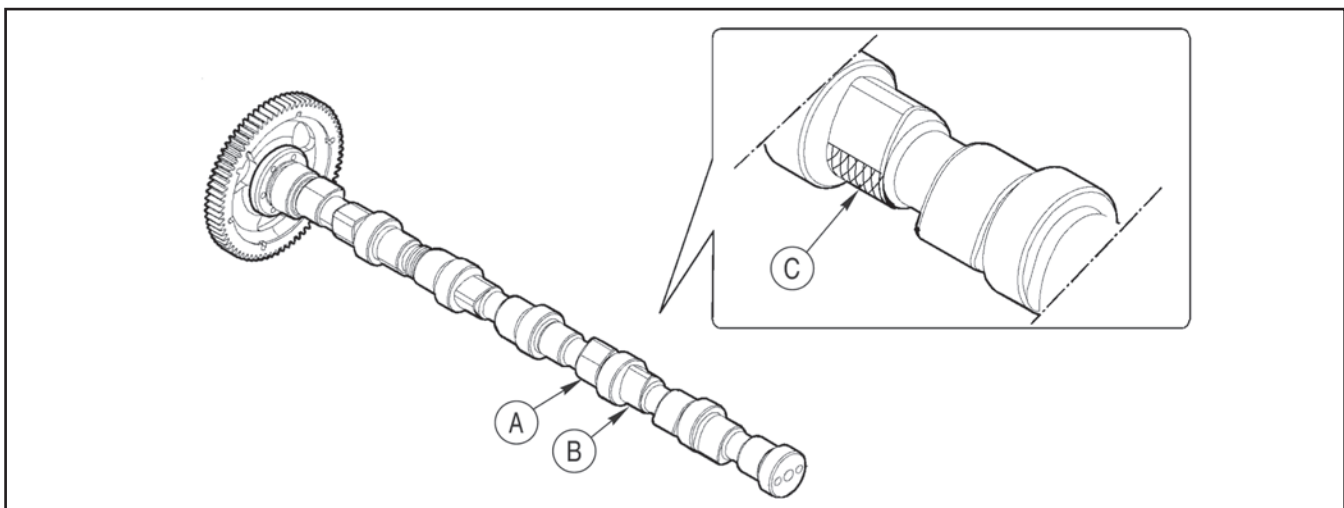

BS06K026

Figura 3000-18

- A. INTAKE VALVE LOBE
- B. EXHAUST VALVE LOBE
- C. LOBE EGR

Camshaft is supported by seven journals in the engine block.

The front and rear journals seats are equipped with steel bushings coated with anti-friction material forced positioned.

There is two lobes for each cylinder

- A. Intake lobe
- B. Exhaust lobe

Camshaft is directly controlled by rear gears moved by the crankshaft.

Exhaust Gas Recirculation - EGR

The exhaust gas can return partially to the cylinder and reduce the maximum temperature responsible caused by the nitrogen oxide (NOx) generation.

The ECR reduces the combustion temperature, decreasing the oxygen concentration in the combustion chamber, creating an efficient system to control the NOx emissions. The EGR lobe is not equipped with any electronic control, and the system is always enabled. Its configuration does not require additional elements such as retaining valve, pipes or heat dissipation.

There is an additional lobe (C). When a cylinder is intaking, this lobe allows a brief opening of the exhaust valve. The recirculation occurs in that cylinder due to the great exhaust pressure compared to the intake gases.

Valve Control

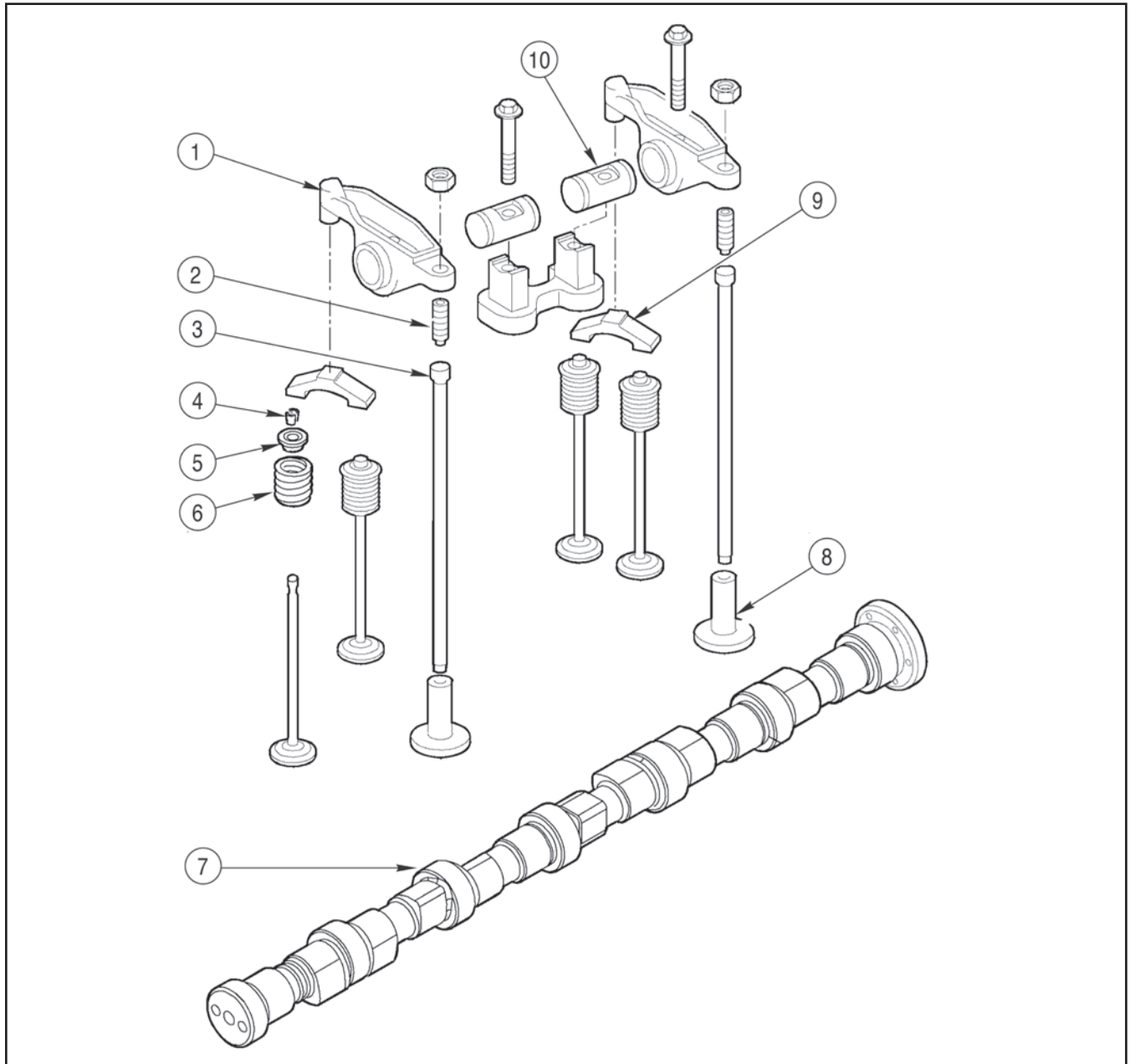

BS06K027

Figura 3000-19

1. ROCKER
2. VALVE CLEARANCE ADJUSTING SCREW
3. PUSHROD
4. VALVE CONE
5. VALVE SEAT

6. SPRING
7. CAMSHAFT
8. TAPPET
9. BRIDGE
10. ROCKER AXLE

Cylinder Head of Engines – 667TA/EBF – 667TA/EBD – 667TA/EED

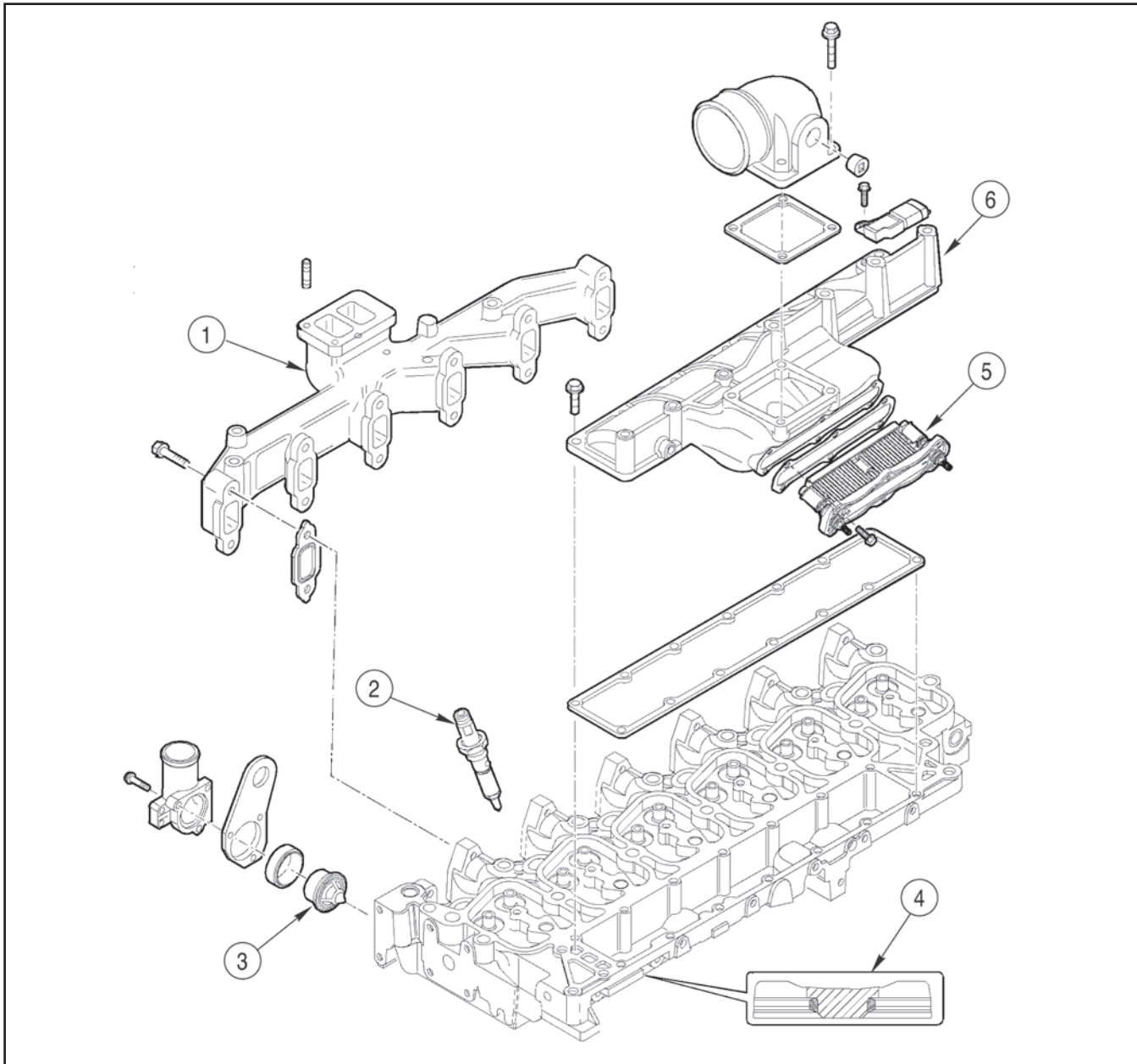

- 1. EXHAUST MANIFOLD
- 2. INJECTOR
- 3. THERMOSTAT

- 4. VALVE SEAT
- 5. INTAKE AIR HEATER
- 6. INTAKE MANIFOLD

The cast iron cylinder head is machined to allow mounting the following parts:

- Valve seats (4).
- Injectors (2).
- Thermostat (3).

It is designed also to accommodate the following components:

- Exhaust manifold (1).
- Intake manifold (6) with intake air heater mounting (5).



Suggest:

If the above button click is invalid.

Please download this document

first, and then click the above link

to download the complete manual.

Thank you so much for reading

Cylinder Head of Engines – 667TA/EEG – 667TA/EEC

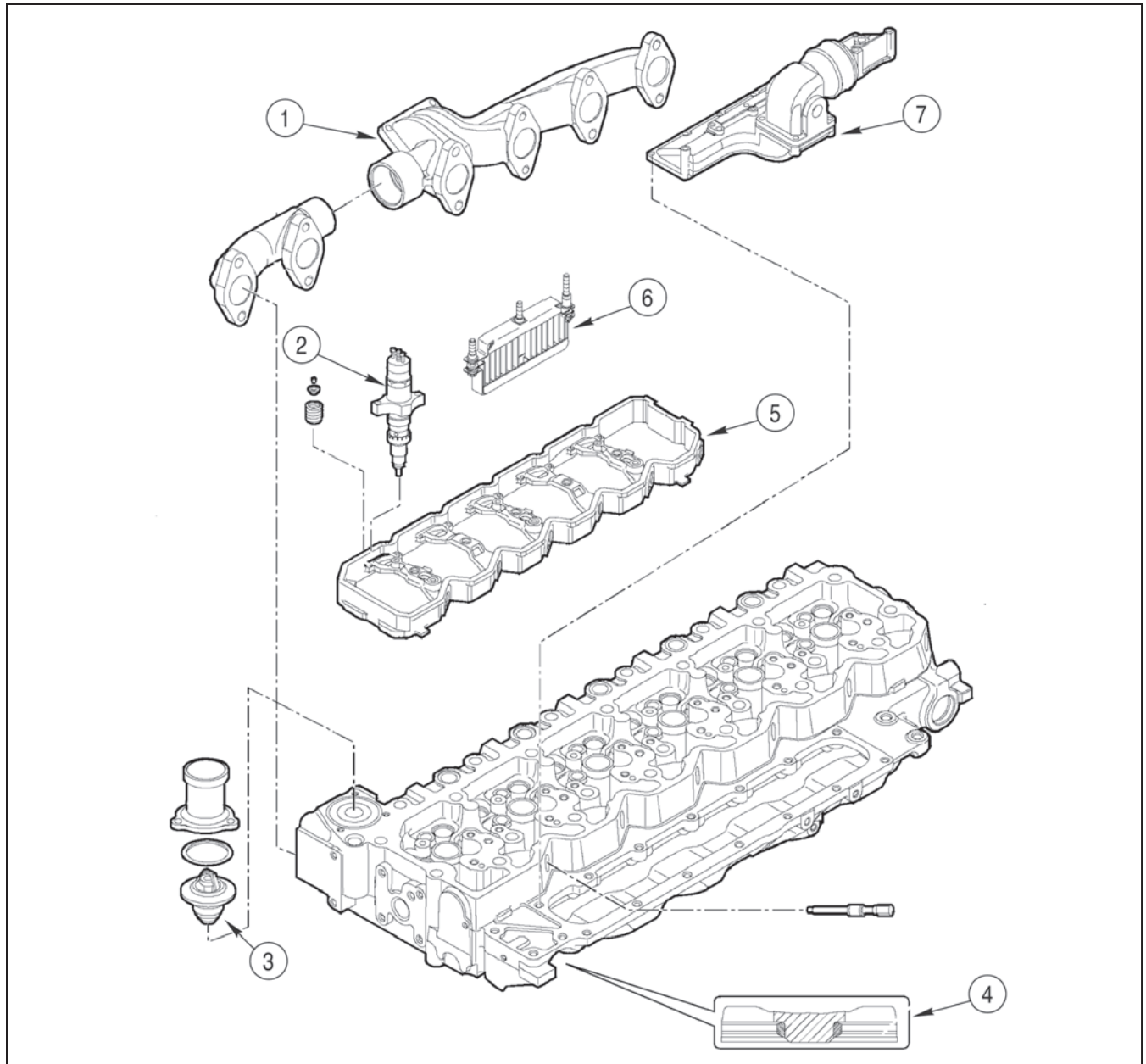

1. EXHAUST MANIFOLD
2. INJECTOR
3. THERMOSTAT
4. VALVE SEAT

5. INJECTORS ELECTRICAL CABLE SUPPORT
6. INTAKE AIR HEATER
7. INTAKE MANIFOLD

The cast iron cylinder head is machined to allow mounting the following parts:

- Valve seats (4)
- Injectors (2)
- Thermostat (3)

It is designed also to accommodate the following components:

- Exhaust manifold (1)
- Intake manifold (7) with intake air heater mounting (6)

<https://www.ebooklibonline.com>

Hello dear friend!

Thank you very much for reading.

Enter the link into your browser.

The full manual is available for immediate download.

<https://www.ebooklibonline.com>