

QUANTUM® 80F
QUANTUM® 90F
QUANTUM® 100F
QUANTUM® 110F
QUANTUM® 80CL
QUANTUM® 90CL
QUANTUM® 100CL
QUANTUM® 110CL

Tractor

PIN ZFLK00441 and above

SERVICE MANUAL

Part number 51523378

English

August 2018

© 2018 CNH Industrial Italia S.p.A. All Rights Reserved.

CASE IH
AGRICULTURE

Link Product / Engine

Product	Market Product	Engine
Quantum® 100CL With cab [ZHLK05263 -]	Asia Pacific	F5DFL413K*C001
Quantum® 100CL With cab [ZHLK05263 -]	Europe	F5DFL413K*C001
Quantum® 100CL With cab [ZHLK05263 -]	Middle East Africa	F5DFL413K*C001
Quantum® 100CL Without cab [ZHLK05304 -]	Europe	F5DFL413K*C001
Quantum® 100CL Without cab [ZHLK05304 -]	Asia Pacific	F5DFL413K*C001
Quantum® 100CL Without cab [ZHLK05304 -]	Middle East Africa	F5DFL413K*C001
Quantum® 110CL With cab [ZGLK03974 -]	Europe	F5DFL413J*C002
Quantum® 110CL With cab [ZGLK03974 -]	Asia Pacific	F5DFL413J*C002
Quantum® 110CL With cab [ZGLK03974 -]	Middle East Africa	F5DFL413J*C002
Quantum® 110CL Without cab [ZHLK05256 -]	Middle East Africa	F5DFL413J*C002
Quantum® 110CL Without cab [ZHLK05256 -]	Asia Pacific	F5DFL413J*C002
Quantum® 110CL Without cab [ZHLK05256 -]	Europe	F5DFL413J*C002
Quantum® 80CL With cab [ZHLK07642 -]	Middle East Africa	F5DFL413B*H001
Quantum® 80CL With cab [ZHLK07642 -]	Asia Pacific	F5DFL413B*H001
Quantum® 80CL With cab [ZHLK07642 -]	Europe	F5DFL413B*H001
Quantum® 80CL Without cab [ZHLK07049 -]	Europe	F5DFL413B*H001
Quantum® 80CL Without cab [ZHLK07049 -]	Middle East Africa	F5DFL413B*H001
Quantum® 80CL Without cab [ZHLK07049 -]	Asia Pacific	F5DFL413B*H001
Quantum® 90CL With cab [ZHLK07094 -]	Asia Pacific	F5DFL413L*C001
Quantum® 90CL With cab [ZHLK07094 -]	Middle East Africa	F5DFL413L*C001
Quantum® 90CL With cab [ZHLK07094 -]	Europe	F5DFL413L*C001
Quantum® 90CL Without cab [ZHLK06238 -]	Asia Pacific	F5DFL413L*C001
Quantum® 90CL Without cab [ZHLK06238 -]	Middle East Africa	F5DFL413L*C001
Quantum® 90CL Without cab [ZHLK06238 -]	Europe	F5DFL413L*C001

Product	Market Product	Engine
Quantum® 100F With cab [ZHLK01675 -]	Europe	F5DFL413K*C001
Quantum® 100F With cab [ZHLK01675 -]	Asia Pacific	F5DFL413K*C001
Quantum® 100F With cab [ZHLK01675 -]	Middle East Africa	F5DFL413K*C001
Quantum® 100F Without cab [ZFLK00441 -]	Middle East Africa	F5DFL413K*C001
Quantum® 100F Without cab [ZFLK00441 -]	Europe	F5DFL413K*C001
Quantum® 100F Without cab [ZFLK00441 -]	Asia Pacific	F5DFL413K*C001
Quantum® 110F With cab [ZGLK02439 -]	Middle East Africa	F5DFL413J*C002
Quantum® 110F With cab [ZGLK02439 -]	Europe	F5DFL413J*C002
Quantum® 110F With cab [ZGLK02439 -]	Asia Pacific	F5DFL413J*C002
Quantum® 110F Without cab [ZHLK01638 -]	Europe	F5DFL413J*C002
Quantum® 110F Without cab [ZHLK01638 -]	Middle East Africa	F5DFL413J*C002
Quantum® 110F Without cab [ZHLK01638 -]	Asia Pacific	F5DFL413J*C002
Quantum® 80F With cab [ZHLK01644 -]	Middle East Africa	F5DFL413B*H001
Quantum® 80F With cab [ZHLK01644 -]	Europe	F5DFL413B*H001
Quantum® 80F With cab [ZHLK01644 -]	Asia Pacific	F5DFL413B*H001
Quantum® 80F Without cab [ZHLK02413 -]	Europe	F5DFL413B*H001
Quantum® 80F Without cab [ZHLK02413 -]	Asia Pacific	F5DFL413B*H001
Quantum® 80F Without cab [ZHLK02413 -]	Middle East Africa	F5DFL413B*H001
Quantum® 90F With cab [ZHLK02445 -]	Middle East Africa	F5DFL413L*C001
Quantum® 90F With cab [ZHLK02445 -]	Asia Pacific	F5DFL413L*C001
Quantum® 90F With cab [ZHLK02445 -]	Europe	F5DFL413L*C001
Quantum® 90F Without cab [ZFLK00985 -]	Asia Pacific	F5DFL413L*C001
Quantum® 90F Without cab [ZFLK00985 -]	Europe	F5DFL413L*C001
Quantum® 90F Without cab [ZFLK00985 -]	Middle East Africa	F5DFL413L*C001

<https://www.ebooklibonline.com>

Hello dear friend!

Thank you very much for reading.

Enter the link into your browser.

The full manual is available for immediate download.

<https://www.ebooklibonline.com>

Contents

INTRODUCTION

Engine.....	10
[10.001] Engine and crankcase	10.1
[10.114] Pump drives	10.2
[10.216] Fuel tanks	10.3
[10.206] Fuel filters	10.4
[10.202] Air cleaners and lines	10.5
[10.254] Intake and exhaust manifolds and muffler	10.6
[10.501] Exhaust Gas Recirculation (EGR) exhaust treatment.....	10.7
[10.400] Engine cooling system	10.8
[10.414] Fan and drive	10.9
[10.310] Aftercooler.....	10.10
[10.304] Engine lubrication system.....	10.11
Clutch	18
[18.100] Clutch mechanical release control	18.1
[18.104] Clutch hydraulic release control.....	18.2
[18.110] Clutch and components	18.3
Transmission.....	21
[21.114] Mechanical transmission	21.1
[21.130] Mechanical transmission external controls.....	21.2
[21.100] Mechanical transmission hydraulic components.....	21.3
[21.140] Mechanical transmission internal components.....	21.4
[21.112] Power shuttle transmission.....	21.5
[21.134] Power shuttle transmission external controls	21.6
[21.104] Power shuttle transmission hydraulic components	21.7
[21.154] Power shuttle transmission internal components	21.8
[21.160] Creeper	21.9

[21.162] Reverser	21.10
[21.168] Hi-Lo unit.....	21.11
[21.109] Transmission cooler and lines.....	21.12
[21.118] Transmission/Rear drive	21.13
[21.182] Differential.....	21.14
Four-Wheel Drive (4WD) system	23
[23.202] Electro-hydraulic control	23.1
[23.304] Four-Wheel Drive (4WD) gearbox	23.2
[23.314] Drive shaft.....	23.3
Front axle system	25
[25.100] Powered front axle	25.1
[25.102] Front bevel gear set and differential	25.2
[25.108] Final drive hub, steering knuckles, and shafts	25.3
[25.310] Final drives	25.4
[25.400] Non-powered front axle	25.5
Rear axle system.....	27
[27.100] Powered rear axle.....	27.1
[27.106] Rear bevel gear set and differential	27.2
[27.120] Planetary and final drives	27.3
[27.126] Spur gear and final drives.....	27.4
Power Take-Off (PTO).....	31
[31.101] Rear mechanical control	31.1
[31.142] Front Power Take-Off (PTO) control	31.2
[31.146] Front Power Take-Off (PTO)	31.3
Brakes and controls	33
[33.202] Hydraulic service brakes	33.1
[33.110] Parking brake or parking lock	33.2

[33.220] Trailer brake hydraulic control.....	33.3
Hydraulic systems.....	35
[35.000] Hydraulic systems.....	35.1
[35.104] Fixed displacement pump.....	35.2
[35.204] Remote control valves	35.3
[35.100] Main lift system.....	35.4
[35.114] Three-point hitch control valve	35.5
[35.124] Three-point hitch hydraulic adjustment	35.6
[35.160] Front hitch controls and lines	35.7
[35.162] Front hitch cylinders and lines	35.8
Hitches, drawbars, and implement couplings.....	37
[37.120] Rear three-point hitch linkage.....	37.1
[37.162] Front hitch.....	37.2
[37.166] Front hitch linkage.....	37.3
[37.110] Rear three-point hitch	37.4
Frames and ballasting	39
[39.140] Ballasts and supports	39.1
Steering.....	41
[41.101] Steering control	41.1
[41.200] Hydraulic control components.....	41.2
Wheels	44
[44.511] Front wheels.....	44.1
[44.520] Rear wheels.....	44.2
Cab climate control	50
[50.100] Heating.....	50.1
[50.104] Ventilation	50.2
[50.200] Air conditioning	50.3
[50.300] Cab pressurizing system.....	50.4

Electrical systems	55
[55.100] Harnesses and connectors.....	55.1
[55.525] Cab engine controls.....	55.2
[55.015] Engine control system.....	55.3
[55.201] Engine starting system.....	55.4
[55.301] Alternator.....	55.5
[55.302] Battery.....	55.6
[55.011] Fuel tank system	55.7
[55.010] Fuel injection system.....	55.8
[55.014] Engine intake and exhaust system.....	55.9
[55.989] Exhaust Gas Recirculation (EGR) electrical system	55.10
[55.640] Electronic modules	55.11
[55.513] Cab transmission controls.....	55.12
[55.024] Transmission control system.....	55.13
[55.021] Transmission pressure sensors and switches	55.14
[55.541] Cab Front-Wheel Drive (FWD) controls.....	55.15
[55.040] Four-Wheel Drive (4WD) control system.....	55.16
[55.542] Cab axle controls.....	55.17
[55.522] Cab Power Take-Off (PTO) controls	55.18
[55.048] Rear Power Take-Off (PTO) control system	55.19
[55.049] Front Power Take-Off (PTO) control system	55.20
[55.031] Parking brake electrical system.....	55.21
[55.032] Trailer brake electrical system	55.22
[55.512] Cab controls.....	55.23
[55.035] Remote control valve electric control	55.24
[55.051] Cab Heating, Ventilation, and Air-Conditioning (HVAC) controls.....	55.25
[55.050] Heating, Ventilation, and Air-Conditioning (HVAC) control system.....	55.26
[55.523] Cab hitch controls	55.27

[55.130] Rear three-point hitch electronic control system	55.28
[55.518] Wiper and washer system.....	55.29
[55.404] External lighting	55.30
[55.405] External lighting switches and relays	55.31
[55.514] Cab lighting	55.32
[55.408] Warning indicators, alarms, and instruments	55.33
[55.DTC] FAULT CODES.....	55.34
Accessories	88
[88.100] Accessories	88.1
Platform, cab, bodywork, and decals	90
[90.150] Cab.....	90.1
[90.151] Cab interior.....	90.2
[90.160] Cab interior trim and panels.....	90.3
[90.154] Cab doors and hatches	90.4
[90.110] Operator platform less cab	90.5
[90.118] Protections and footboards.....	90.6
[90.114] Operator protections	90.7
[90.120] Mechanically-adjusted operator seat.....	90.8
[90.124] Pneumatically-adjusted operator seat.....	90.9
[90.100] Engine hood and panels	90.10



INTRODUCTION

Foreword - Important notice regarding equipment servicing

All repair and maintenance work listed in this manual must be carried out only by qualified dealership personnel, strictly complying with the instructions given, and using, whenever possible, the special tools.

Anyone who performs repair and maintenance operations without complying with the procedures provided herein shall be responsible for any subsequent damages.

The manufacturer and all the organizations of its distribution chain, including - without limitation - national, regional, or local dealers, reject any responsibility for damages caused by parts and/or components not approved by the manufacturer, including those used for the servicing or repair of the product manufactured or marketed by the manufacturer. In any case, no warranty is given or attributed on the product manufactured or marketed by the manufacturer in case of damages caused by parts and/or components not approved by the manufacturer.

The manufacturer reserves the right to make improvements in design and changes in specifications at any time without notice and without incurring any obligation to install them on units previously sold. Specifications, descriptions, and illustrative material herein are as accurate as known at time of publication but are subject to change without notice.

In case of questions, refer to your CASE IH Sales and Service Networks.

Note to the Owner WARNINGS FOR AIR CONDITIONING SYSTEM REPAIR OPERATIONS

Quantum® 100CL With cab [ZHLK05263 -]	APAC --- MEA --- WE
Quantum® 100F With cab [ZHLK01675 -]	APAC --- MEA --- WE
Quantum® 110CL With cab [ZGLK03974 -]	APAC --- MEA --- WE
Quantum® 110F With cab [ZGLK02439 -]	APAC --- MEA --- WE
Quantum® 80CL With cab [ZHLK07642 -]	APAC --- MEA --- WE
Quantum® 80F With cab [ZHLK01644 -]	APAC --- MEA --- WE
Quantum® 90CL With cab [ZHLK07094 -]	APAC --- MEA --- WE
Quantum® 90F With cab [ZHLK02445 -]	APAC --- MEA --- WE

Starting the system at low temperatures can damage the compressor. Only operate the air conditioner when the engine is hot and the temperature inside the cab is at least **20 °C (68.00 °F)**.

When disconnecting the hoses, close the ends with plastic caps to prevent foreign matter and humidity from getting inside the hoses.

Handle the thermostatic sensor carefully to avoid damage that may prevent efficient system operation.

Always use two spanners to unscrew the hose fittings to avoid twisting the fitting.

Do not use any type of engine oil to lubricate the compressor and the system.

Never leave the compressor oil container open, always make sure that it is tightly closed. If left exposed the oil will absorb humidity from the air and may, subsequently, damage the system.

Do not transfer compressor oil from the original container to another container.

Do not introduce any additives to the compressor oil. Any additional substances could contain elements which are incompatible with the chemical base of the refrigerant and thus alter its characteristics.

Check that the thermostatic sensor is correctly inserted in the fins on the evaporator to ensure efficient system operation.

Safety rules

Quantum® 100CL With cab [ZHLK05263 -]	APAC --- MEA --- WE
Quantum® 100CL Without cab [ZHLK05304 -]	APAC --- MEA --- WE
Quantum® 110CL With cab [ZGLK03974 -]	APAC --- MEA --- WE
Quantum® 110CL Without cab [ZHLK05256 -]	APAC --- MEA --- WE
Quantum® 80CL With cab [ZHLK07642 -]	APAC --- MEA --- WE
Quantum® 80CL Without cab [ZHLK07049 -]	APAC --- MEA --- WE
Quantum® 90CL With cab [ZHLK07094 -]	APAC --- MEA --- WE
Quantum® 90CL Without cab [ZHLK06238 -]	APAC --- MEA --- WE

Personal safety





This is the safety alert symbol. It is used to alert you to potential personal injury hazards. Obey all safety messages that follow this symbol to avoid possible death or injury.

Throughout this manual you will find the signal words DANGER, WARNING, and CAUTION followed by special instructions. These precautions are intended for the personal safety of you and those working with you.

Read and understand all the safety messages in this manual before you operate or service the machine.

 DANGER indicates a hazardous situation that, if not avoided, will result in death or serious injury.

 WARNING indicates a hazardous situation that, if not avoided, could result in death or serious injury.

 CAUTION indicates a hazardous situation that, if not avoided, could result in minor or moderate injury.

FAILURE TO FOLLOW DANGER, WARNING, AND CAUTION MESSAGES COULD RESULT IN DEATH OR SERIOUS INJURY.

Machine safety

NOTICE: Notice indicates a situation that, if not avoided, could result in machine or property damage.

Throughout this manual you will find the signal word Notice followed by special instructions to prevent machine or property damage. The word Notice is used to address practices not related to personal safety.

Information

NOTE: Note indicates additional information that clarifies steps, procedures, or other information in this manual.

Throughout this manual you will find the word Note followed by additional information about a step, procedure, or other information in the manual. The word Note is not intended to address personal safety or property damage.



SERVICE MANUAL

Engine

Quantum® 100CL With cab [ZHLK05263 -], Quantum® 100CL Without cab [ZHLK05304 -], Quantum® 100F With cab [ZHLK01675 -], Quantum® 100F Without cab [ZFLK00441 -], Quantum® 110CL With cab [ZGLK03974 -], Quantum® 110CL Without cab [ZHLK05256 -], Quantum® 110F With cab [ZGLK02439 -], Quantum® 110F Without cab [ZHLK01638 -], Quantum® 80CL With cab [ZHLK07642 -], Quantum® 80CL Without cab [ZHLK07049 -], Quantum® 80F With cab [ZHLK01644 -], Quantum® 80F Without cab [ZHLK02413 -], Quantum® 90CL With cab [ZHLK07094 -], Quantum® 90CL Without cab [ZHLK06238 -], Quantum® 90F With cab [ZHLK02445 -], Quantum® 90F Without cab [ZFLK00985 -]

Engine - Remove from transmission

⚠ WARNING

Burn hazard!

Be very careful to avoid contact with hot fluids. If fluid is extremely hot, allow it to cool to a moderately warm temperature before proceeding.

Failure to comply could result in death or serious injury.

W0362A

⚠ WARNING

Hot surface possible!

Wait for all components to cool before performing any operation.

Failure to comply could result in death or serious injury.

W0251A

⚠ CAUTION

Hot area!

Use care when working near hot components. Wear protective gloves.

Failure to comply could result in minor or moderate injury.

C0034A

⚠ WARNING

Chemical hazard!

When handling fuel, lubricants, and other service chemicals, follow the manufacturer's instructions. Wear Personal Protective Equipment (PPE) as instructed. Do not smoke or use open flame. Collect fluids in proper containers. Obey all local and environmental regulations when disposing of chemicals.

Failure to comply could result in death or serious injury.

W0371A

Prior operation:

A. Remove the front ballast - See **Front ballast - Remove (39.140)**.

1. Carefully clean the area around the central drain plug (1) on the transmission.
2. Use a suitable container to collect the transmission oil.
3. Loosen the central drain plug (1) on the transmission and drain the transmission oil.
4. Replace the central drain plug (1) on the transmission.
5. Tighten the central drain plug (1) on the transmission.
6. Carefully clean all the parts contaminated by any leaking hydraulic fluid.
7. Remove the cab – See **Cab and platform - Remove (90.150)**.
8. Remove the transmission drive shaft going from the transmission to the front axle – See **Front drive shaft - Remove (23.314)**.

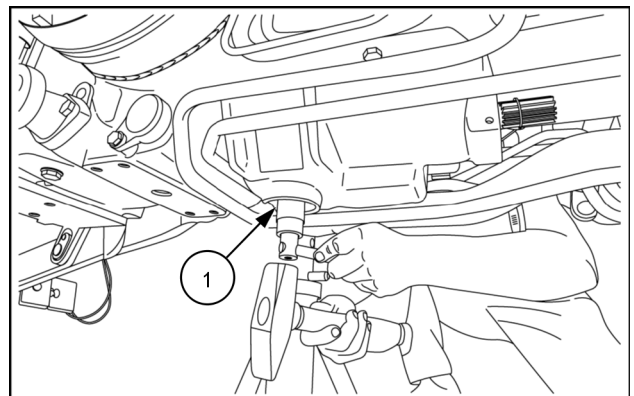

MOIL16TR01450AA 1

9. Carefully clean the area around the couplings **(1)** on the intermediate delivery and return pipes on the transmission oil exchanger.
10. Use a suitable container to collect the transmission oil.
11. Loosen the couplings **(1)** on the intermediate delivery and return pipes on the transmission oil exchanger.

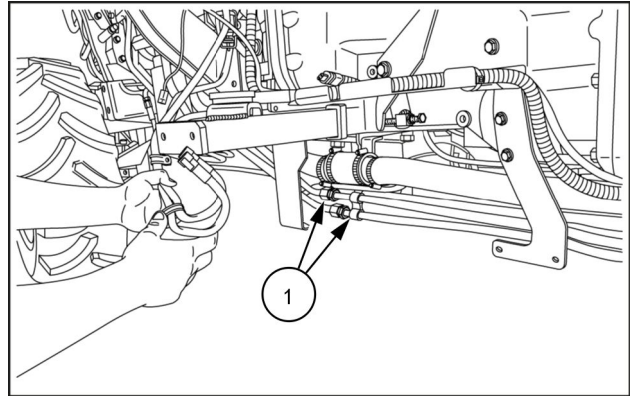

MOIL16TR01454AA 2

12. Carefully clean the area around the coupling **(1)** of the intermediate differential oil delivery pipe on the left-hand side of the vehicle.
13. Use a suitable container to collect the transmission oil.
14. Loosen the coupling **(1)** of the intermediate differential oil delivery pipe on the left-hand side of the vehicle.

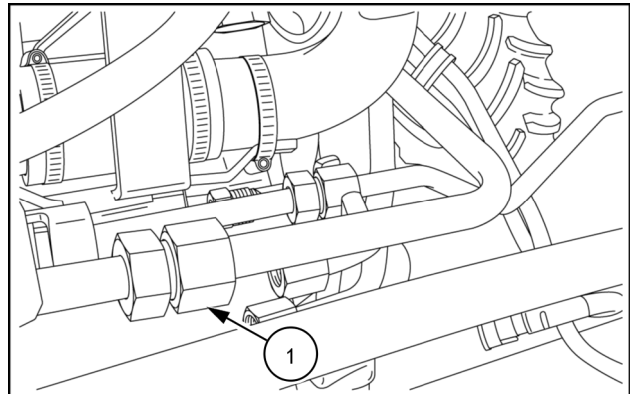

MOIL16TR01455AA 3

15. Carefully clean the area around the coupling **(1)** of the intermediate delivery pipe connected to the transmission oil filter.
16. Use a suitable container to collect the transmission oil.
17. Loosen the coupling **(1)** of the intermediate delivery pipe connected to the transmission oil filter.
18. Carefully clean all the parts contaminated by any leaking hydraulic fluid.

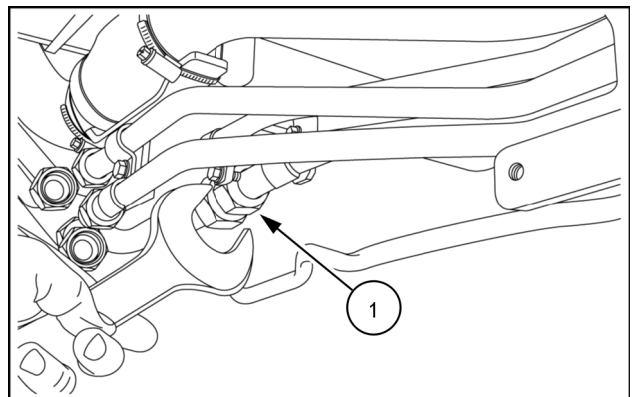

MOIL16TR01456AA 4

19. Carefully clean the area around the sleeve **(1)** of the intermediate delivery pipe connected to the transmission oil filter.
20. Use a suitable container to collect the transmission oil.
21. Loosen the two screw collars **(2)** on the sleeve **(1)** of the intermediate delivery pipe connected to the transmission oil filter.
22. Loosen the screw collar **(3)** fixing the sleeve **(1)** of the intermediate delivery pipe connected to the transmission oil filter.
23. Disconnect the sleeve **(1)** of the intermediate delivery pipe connected to the transmission oil filter.
24. Carefully clean all the parts contaminated by any leaking hydraulic fluid.

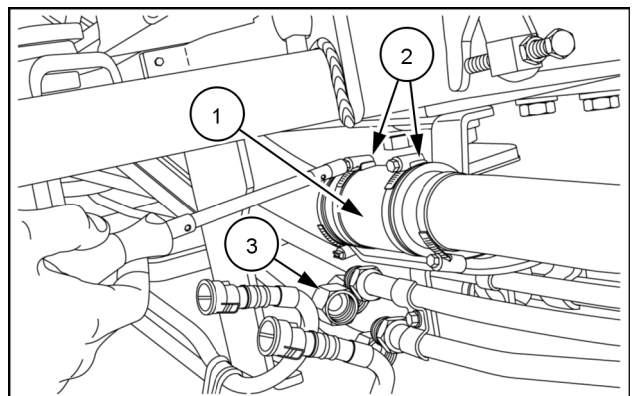

MOIL16TR01457AA 5

25. Carefully clean the area around the connector **(1)** of the steering sensor.
26. Disconnect the steering sensor connector **(1)**.
27. Disconnect the connector cable **(1)** from the steering sensor.

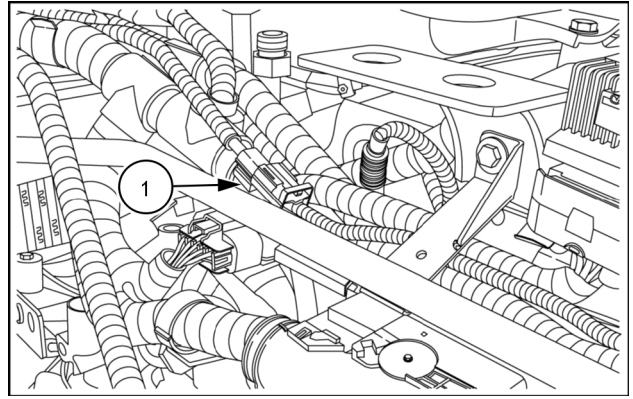

MOIL16TR01459AA 6

28. Carefully clean the area around the connector **(1)** of the hydraulic fluid pressure sensor.
29. Disconnect the connector **(1)** of the hydraulic fluid pressure sensor.
30. Disconnect the connector cable **(1)** from the hydraulic fluid pressure sensor.

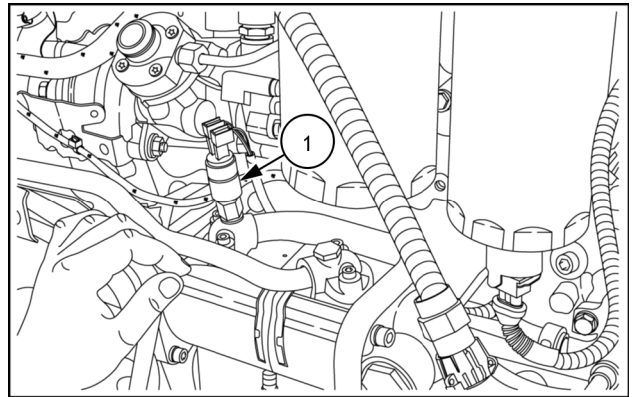

MOIL16TR01460AA 7

31. Carefully clean the area around the connector **(1)**.
32. Disconnect connector **(1)**.
33. Unclamp the connector **(1)** from the support bracket **(2)**.

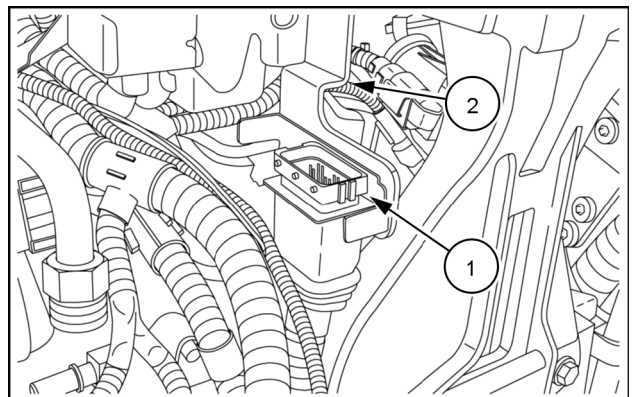

MOIL16TR01458AA 8

34. Loosen the screw **(1)** and remove the collar **(2)**.
35. Loosen the sleeve **(3)** of the oil delivery pipe **(4)**.

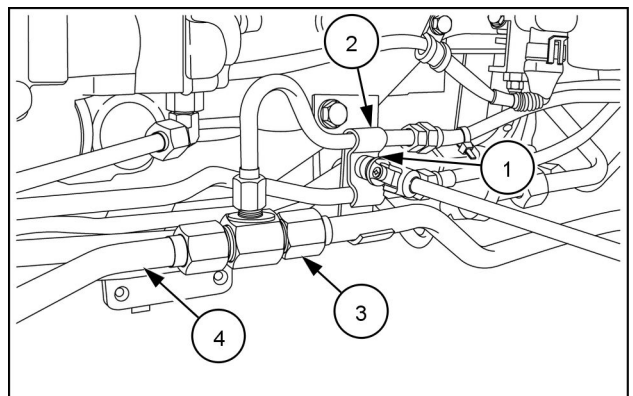

MOIL16TR01462AA 9

36. Carefully clean the area around the two holes **(1)** on the upper side of the clutch bell **(2)**.
37. Restore the thread in the two holes **(1)** on the upper side of the clutch bell **(2)**.

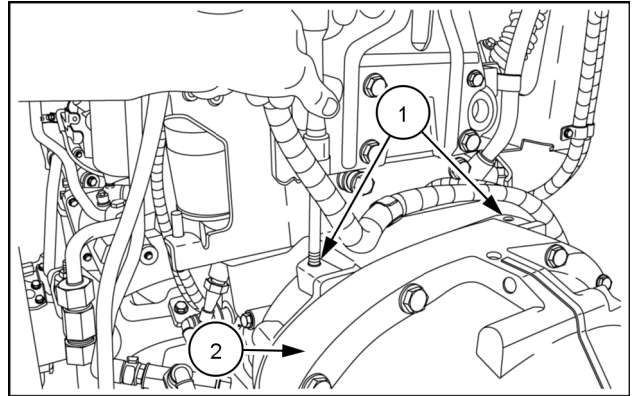

MOIL16TR01463AA 10

38. Loosen the two screws **(1)** securing the bracket **(2)**.
39. Remove the bracket **(2)** and the cable **(3)**.
40. Arrange two eyebolts suitable for lifting the engine.
41. Prepare a hoist and chains/straps that are suitable for lifting the engine.

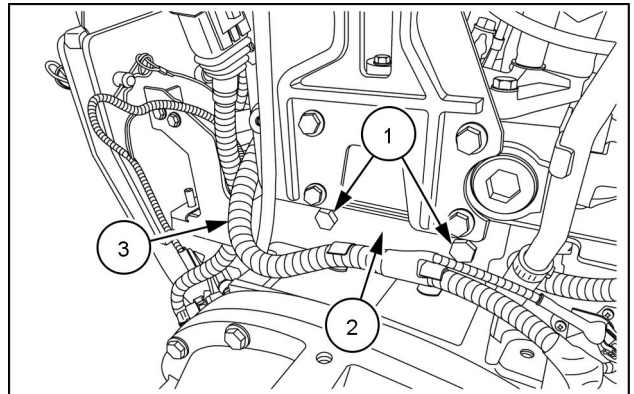

MOIL16TR01461AA 11

42. Place a suitable lift under the transmission housing.

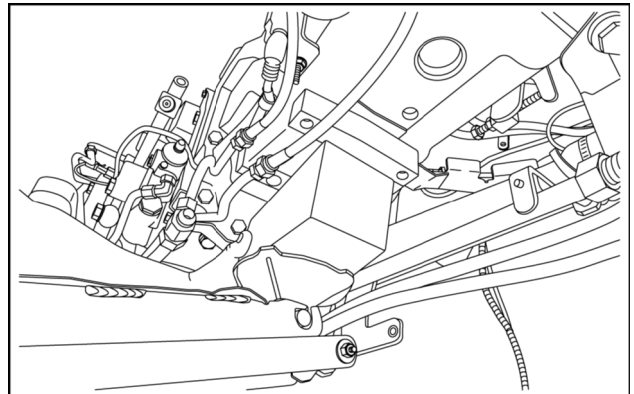

MOIL16TR01464AA 12

43. Clean the area around the clutch bell **(1)**.
44. Correctly position the two eyebolts **(1)**, and using the correct screws, lock into the holes on the upper face of the clutch bell **(2)**.
45. Correctly hook the chains/straps to the eyebolts **(1)**.
46. Use a suitable tool to separate the engine from the transmission.

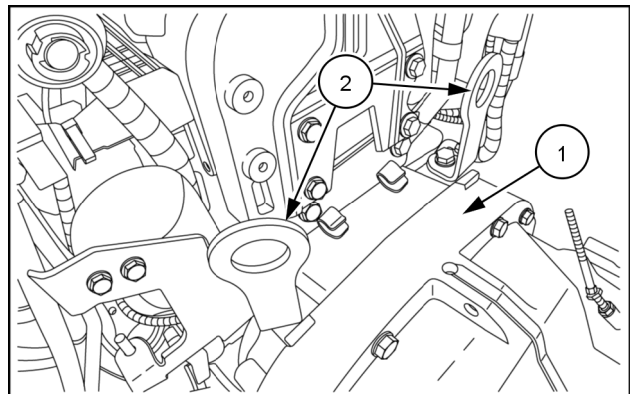

MOIL16TR01465AA 13

47. Loosen the four fastening screws **(1)** on the left-hand side of the clutch bell.
48. Repeat for the four fastening screws on the right-hand side of the clutch bell.

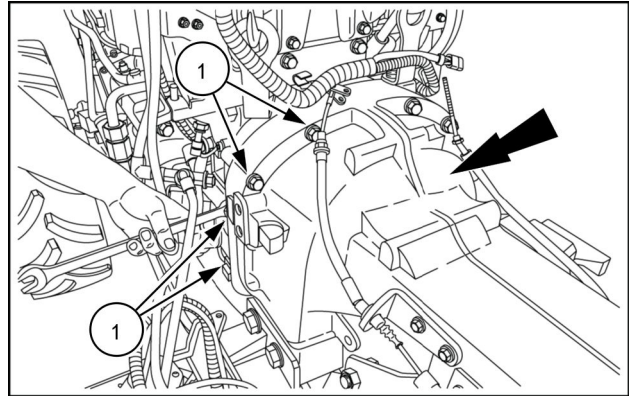

MOIL16TR01466AA 14

49. Loosen the four retaining nuts **(1)** on the lower side of the clutch bell.

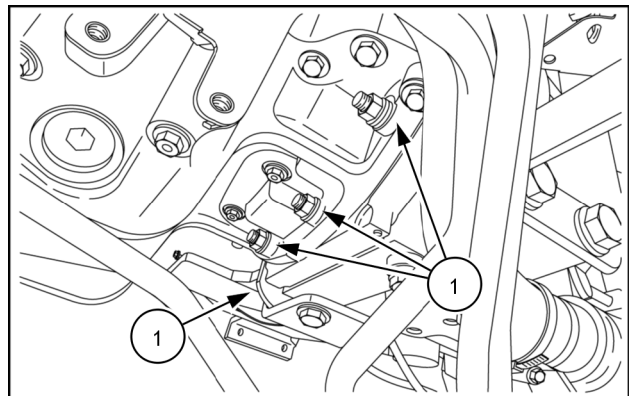

MOIL16TR01467AA 15

50. Using a suitable tool, separate the engine from the transmission.

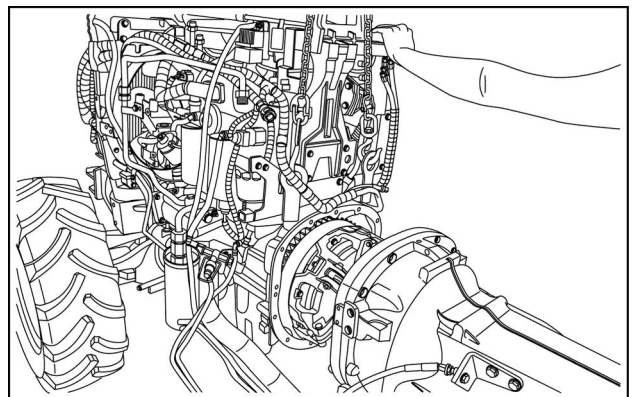

MOIL16TR01468AA 16

51. Place a suitable bracket under the clutch bell on the engine side.
52. Place a suitable bracket under the clutch bell on the engine side.

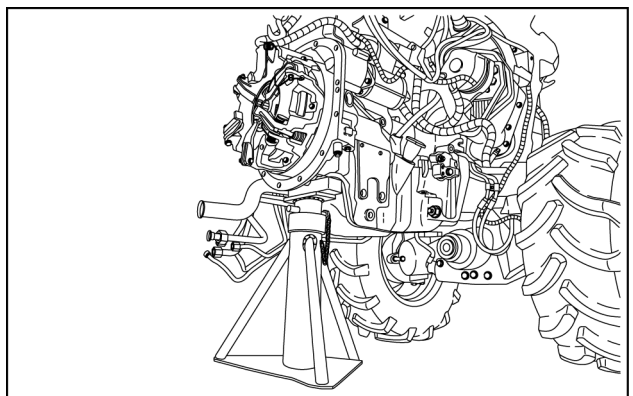

MOIL16TR01469AA 17

53. Place a suitable bracket under the support bracket of the front ballasts.
54. Place a suitable bracket under the support bracket of the front ballasts.
55. Unclamp the chains on the eyebolts and free the engine.

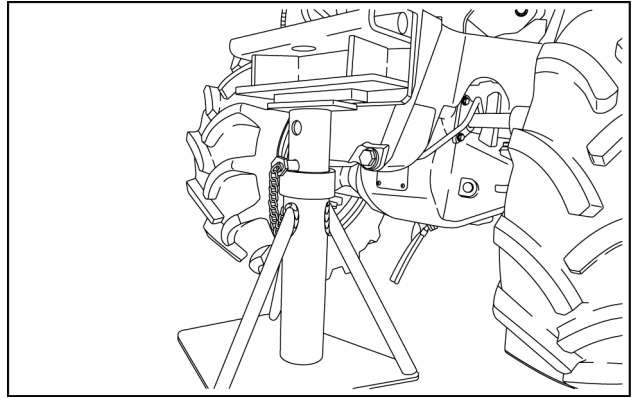

MOIL16TR01470AA 18

56. Place a suitable bracket under the clutch bell on the transmission side.
57. Place a suitable bracket under the clutch bell on the transmission side.

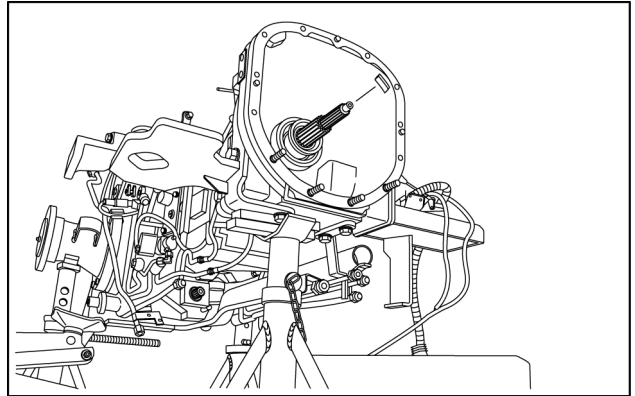

MOIL16TR01471AA 19

Engine - Install to the transmission

1. Retrieve the transmission assembly and carefully clean the area around the clutch bell.
2. Retrieve the front axle and engine assembly and clean the clutch bell.
3. Arrange two eyebolts suitable for lifting the engine.
4. Prepare a hoist and chains/straps that are suitable for lifting the engine.
5. Arrange two eyebolts suitable for lifting the engine.
6. Prepare a hoist and chains/straps that are suitable for lifting the engine.
7. Carefully clean the area around the two holes **(1)** on the upper side of the clutch bell **(2)**.
8. Restore the thread in the two holes **(1)** on the upper side of the clutch bell **(2)**.
9. Correctly position the two eyebolts **(1)**, and using the correct screws, lock into the holes on the upper face of the clutch bell **(2)**.
10. Correctly hook the chains/straps to the eyebolts **(1)**.
11. Remove any supports positioned under the clutch bell on the engine side.

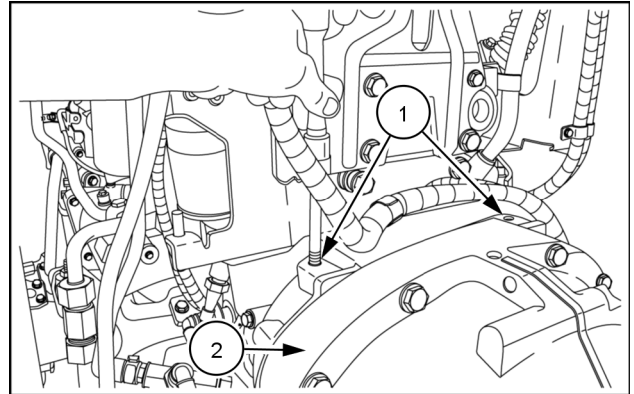

MOIL16TR01463AA 1

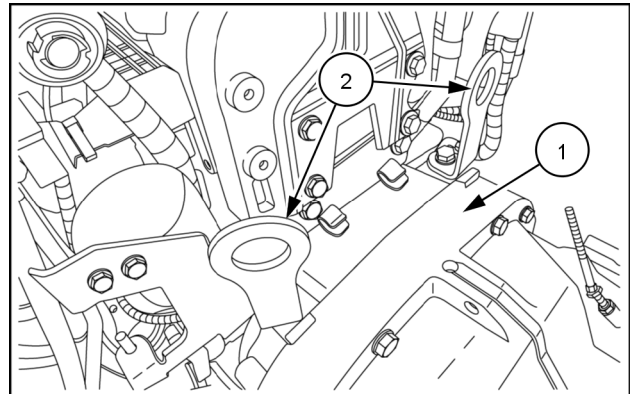

MOIL16TR01465AA 2

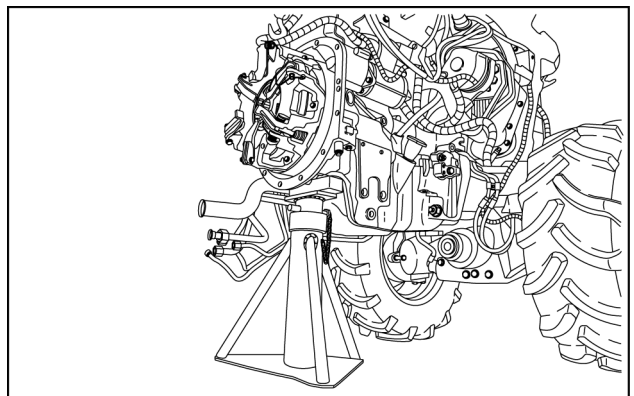

MOIL16TR01469AA 3

12. Remove any supports positioned under the support bracket **(1)** of the front ballasts.
13. Use a suitable tool to fit the transmission to the engine.

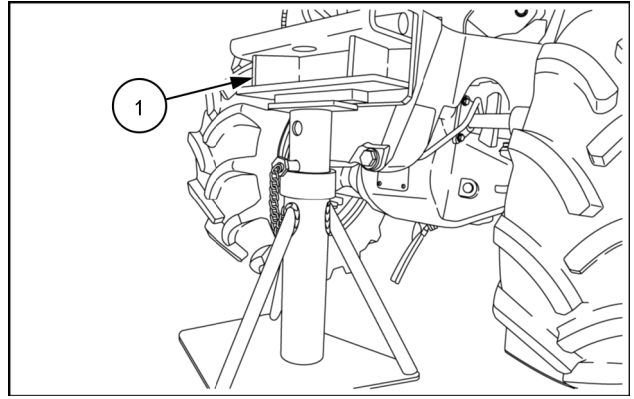

MOIL16TR01470AA 4

14. Apply suitable sealing paste to the coupling face **(1)** of the transmission clutch bell.
15. Using a suitable tool, move the engine closer to the transmission.

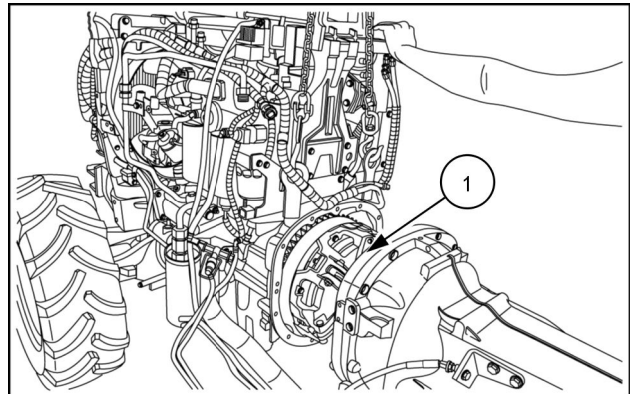

MOIL16TR01468AA 5

16. Tighten the four fastening screws **(1)** on the left-hand side of the clutch bell and tighten to the prescribed torque.
17. Repeat for the four fastening screws on the right-hand side of the clutch bell **(1)**.

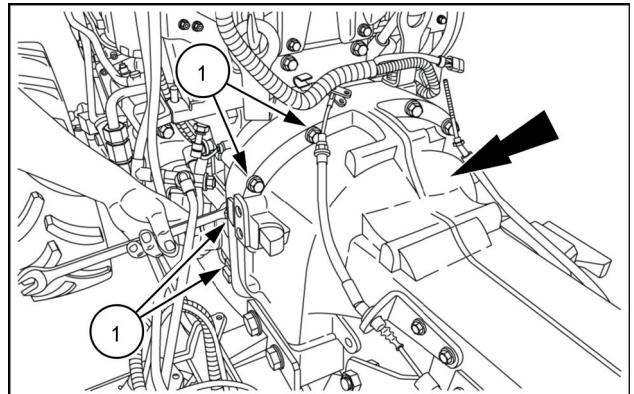

MOIL16TR01466AA 6

18. Tighten the four retaining nuts **(1)** on the lower side of the clutch bell and tighten to the prescribed torque.
19. Carefully clean all the parts contaminated by any sealing paste residue.
20. Unclamp the chains on the eyebolts and free the engine.
21. Remove the two eyebolts used to lift the engine.
22. Remove any supports positioned under the clutch bell on the transmission side.

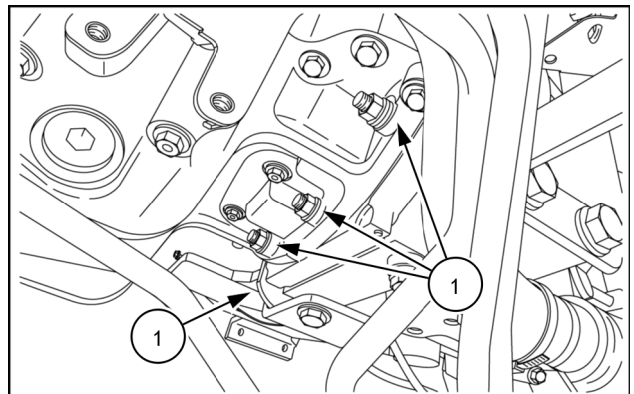

MOIL16TR01467AA 7

23. Remove any supports positioned under the transmission housing.

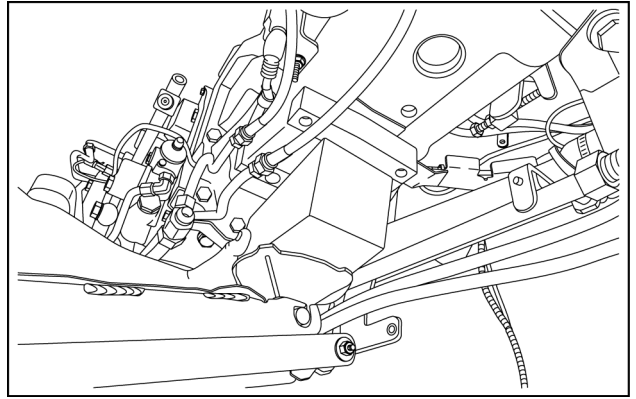

MOIL16TR01464AA 8

24. Retrieve and carefully clean the bracket **(1)**.
 25. Correctly position the cable **(2)**.
 26. Correctly position the bracket **(1)** in its housing on the engine.
 27. Tighten the two screws **(3)** which fix the bracket **(1)** in place.

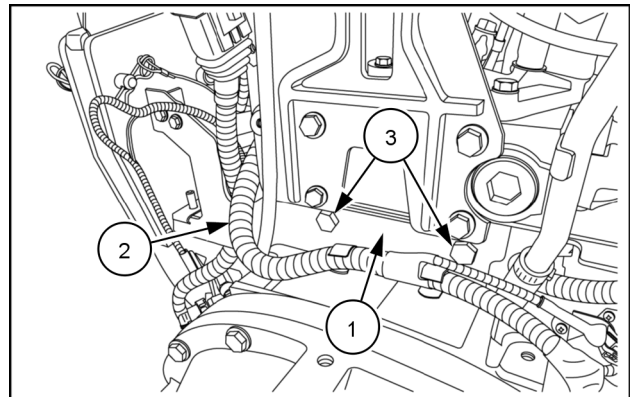

MOIL16TR01461AA 9

28. Carefully clean the area around the sleeve **(1)** of the oil delivery pipe **(2)**.
 29. Tighten the sleeve **(1)** of the oil delivery pipe **(2)**.
 30. Retrieve the collar **(3)** and position it correctly in its housing.
 31. Tighten the fastening screw **(4)** on the collar **(2)**.

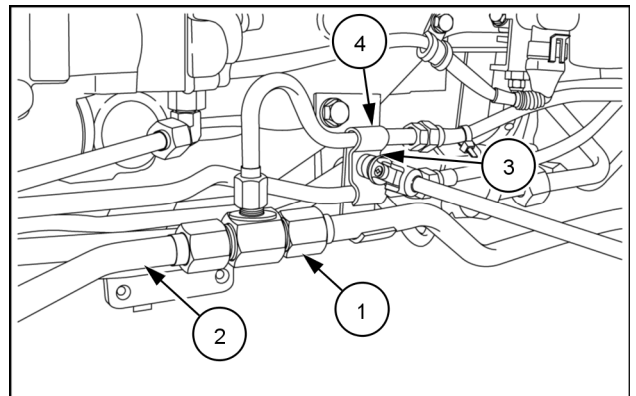

MOIL16TR01462AA 10

32. Carefully clean the area around the connector **(1)** of the steering sensor.
 33. Correctly position the connector cable **(1)** of the steering sensor.
 34. Connect the steering sensor connector **(1)**.

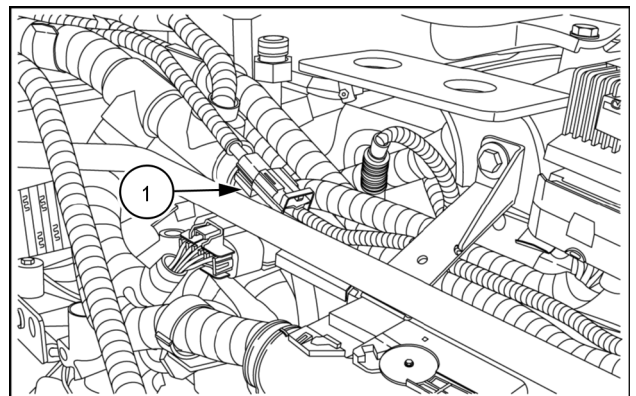

MOIL16TR01459AA 11



Suggest:

If the above button click is invalid.

Please download this document

first, and then click the above link

to download the complete manual.

Thank you so much for reading

35. Carefully clean the area around the connector **(1)** of the hydraulic fluid pressure sensor.
36. Correctly position the connector cable **(1)** of the hydraulic fluid pressure sensor.
37. Connect the connector **(1)** of the hydraulic fluid pressure sensor.

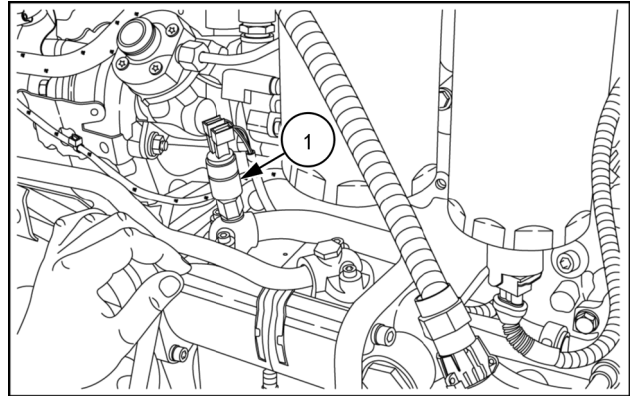

MOIL16TR01460AA 12

38. Carefully clean the area around the connector **(1)**.
39. Fasten the connector **(1)** to the support bracket **(2)**.
40. Connect the connector **(1)**.

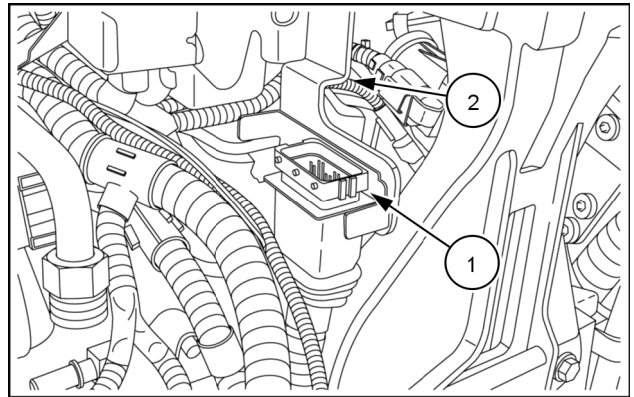

MOIL16TR01458AA 13

41. Carefully clean the area around the sleeve **(1)** of the intermediate delivery pipe connected to the transmission oil filter.
42. Connect the sleeve **(1)** of the intermediate delivery pipe connected to the transmission oil filter.
43. Tighten the two screw collars **(2)** on the sleeve **(1)** of the intermediate delivery pipe connected to the transmission oil filter.
44. Tighten the screw collar **(3)** fixing the sleeve **(1)** to the intermediate delivery pipe connected to the transmission oil filter.

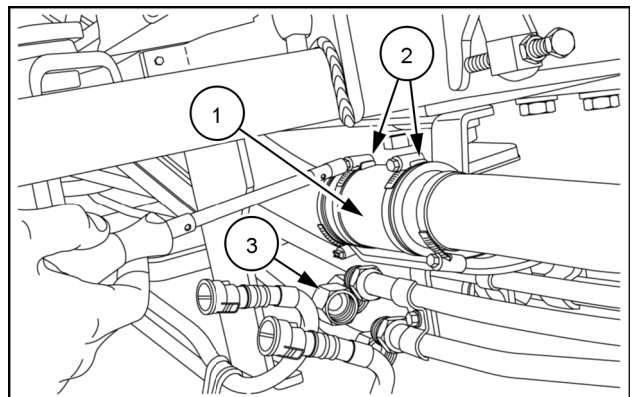

MOIL16TR01457AA 14

45. Carefully clean the area around the coupling **(1)** of the intermediate delivery pipe connected to the transmission oil filter.
46. Correctly connect the coupling **(1)** of the intermediate delivery pipe connected to the transmission oil filter.
47. Tighten the coupling **(1)** of the intermediate delivery pipe connected to the transmission oil filter.

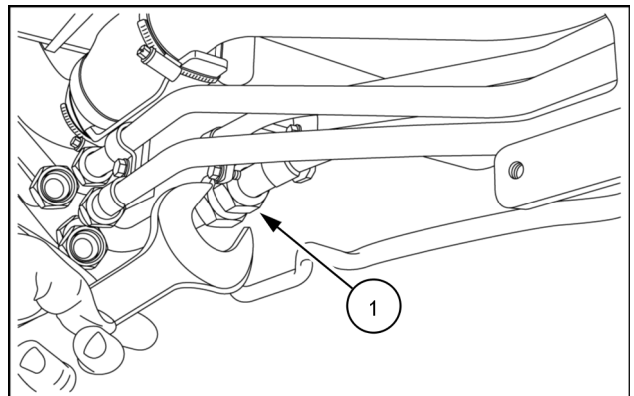

MOIL16TR01456AA 15

<https://www.ebooklibonline.com>

Hello dear friend!

Thank you very much for reading.

Enter the link into your browser.

The full manual is available for immediate download.

<https://www.ebooklibonline.com>