

**NEW HOLLAND
TX60 Series**

**REPAIR
MANUAL**



NEW HOLLAND

S E R V I C E

	Section
Introduction	01
Traction	02
Grain Header	03
Maize Header	Refer to separate publication
Straw Elevator	05
Threshing	06
Separation	07
Cleaning	08
Grain Storage	09
Straw Chopper	10
Functional Adjustments	11
Engine	12
Airconditioning	13
Hydraulic System	14
Hydrostatic System	15
Electrical System	16

INTRODUCTION

	Page
Explanation of machine and header serial numbers	3
Notes for Service Parts Catalogue consulting	4
Conversion chart	6
Tightening torques	7
Speed ranges	9
Oil application guide	13

<https://www.ebooklibonline.com>

Hello dear friend!

Thank you very much for reading.

Enter the link into your browser.

The full manual is available for immediate download.

<https://www.ebooklibonline.com>

EXPLANATION OF MACHINE AND HEADER SERIAL NUMBERS

Machine serial number

PRODUCT IDENTIFICATION

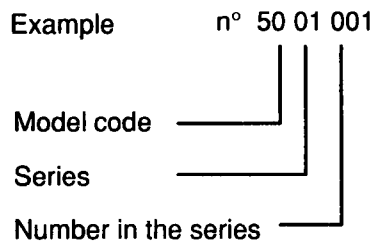

Explanation of model code

- Type 48 = TX62
- 49 = TX64
- 66 = TX65
- 50 = TX66
- 51 = TX68

Header number

PRODUCT IDENTIFICATION

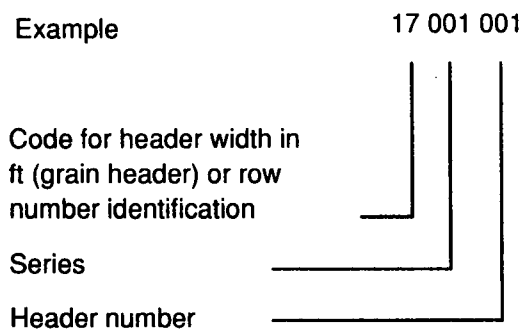

AVAILABLE HEADERS

- 12: 12 ft width grain header
- 13: 13 ft width grain header
- 15: 15 ft width grain header
- 17: 17 ft width grain header
- 20: 20 ft width grain header
- 24: 24 ft width grain header
- 56: 5-row maize header
- 57: 7-row maize header

NOTES FOR SERVICE PARTS CATALOGUE CONSULTING

NOTES FOR CATALOGUE CONSULTING

UPDATING ONLY MICROFICHE

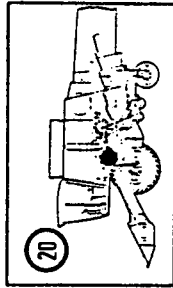

MODIF. ITEM	PART NR.	NT O. DESCRIPTION	DENOMINAZIONE	DESIGNATION	L.C.
1	84007894	1 SPACER	DISTANZIALE	ENTRETOISE	0750
2	80380429	1 GREASE ZERK	INGRASSATORE	GRAISSEUR	060
3	84000265	1 BEARING	CUSCINETTO	ROULEMENT	341C
4	80100020	4 NUT, M16	DADO	ECROU	0100
5	80140048	4 LOCKWASHER, 16MM	ROSETTA DI SICUREZZA	RONDELLE DE SECURITE	132R
6	80120089	4 BOLT, M16x40	BULLONE	BOULON	140B
7	80353308	2 NUT, M6	DADO	ECROU	0100
8	80140015	2 WASHER, 6MM	ROSETTA PIANA	RONDELLE	131R
9	84007920	1 CAM (10)	CAMMA	CAME	040C
10	80062312	A 1 SCREW, M10x25	VITE	VIS	040D

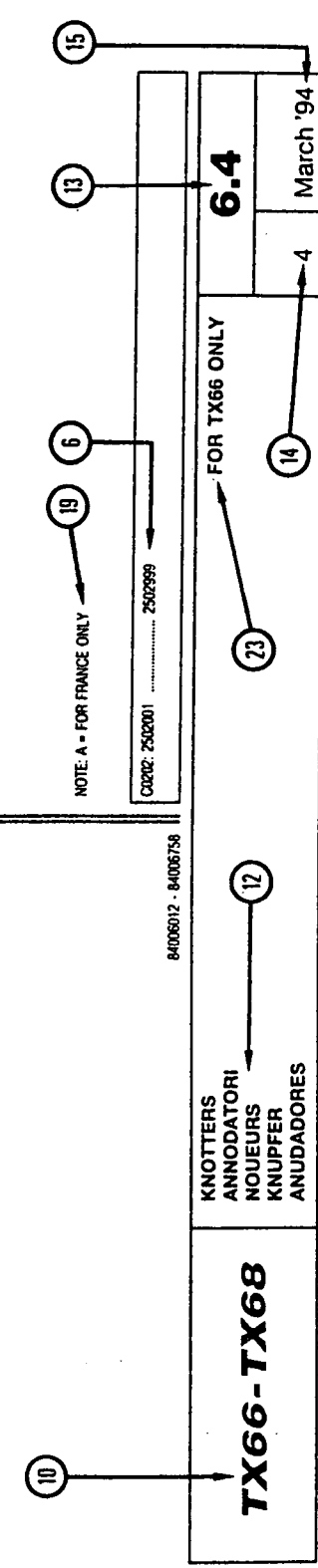
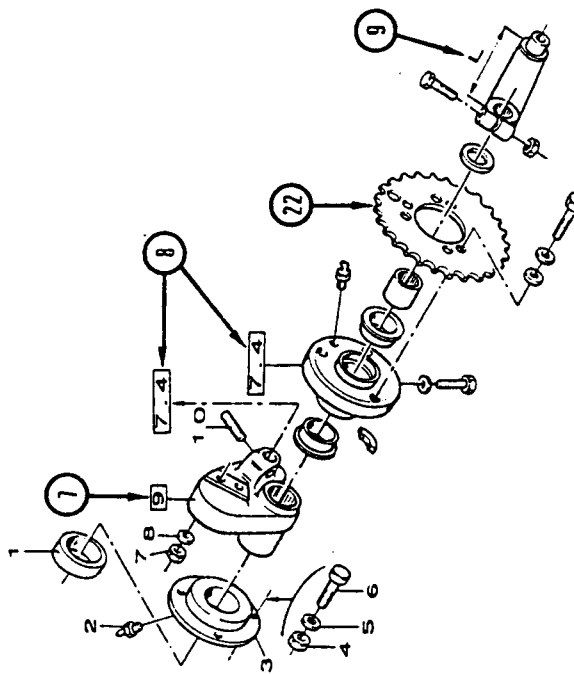

NOTE: A = FOR FRANCE ONLY

CU202: 2502001 2502999

84006012 - 84006758

KNOTTERS
ANNODATORI
NOUJEURS
KNUJPFER
ANUDADORES

TX66-TX68

6.4

FOR TX66 ONLY

March '94

CONVERSION CHART

	Foot	Yard	Mile	Inch	Metre
1 Foot	1	0.333	–	12	0.3048
1 Yard	3	1	–	36	0.9144
1 Mile	5280	1760	1	63360	1609.35
1 Inch	0.0833	0.0277	–	1	0.0254
1 Metre	3.281	1.0936	–	39.37	1

1 US bushel = 35.2391 litre

1 litre = 0.028 US bushel

1 US quart = 0.9464 litre

1 litre = 1.056 US quart

1 UK bushel = 36.3687 litre

1 litre = 0.027 UK bushel

1 UK quart = 1.1365 litre

1 litre = 0.879 UK quart

1 US gallon = 3.785 litre

1 litre = 0.264 US gallon

1 UK gallon = 4.5461 litre

1 litre = 0.22 UK gallon

1 barrel = 158.987 litre

1 litre = 0.0063 barrel

1 acre = 0.4047 ha

1 ha = 2.471 acre

1 pound = 0.4536 kg

1 kg = 2.204 pound

1 hp = 0.736 kW

1 kW = 1.358 hp

1 lb/ in² = 0.0689 bar
= 6.894 kPa

1 bar = 14.5 lbs/ in²
1 kPa = 0.145 lbs/ in²

1 pa = 10⁻⁵ bar
= 1.450x10⁻⁴ lbs/ in²

1 bar = 100 kPa
1 lb/ in² = 6.896 kPa

1 kgf.m = 9.806 Nm

1 Nm = 0.1019 kgf.m

1 lbf ft = 0.1385 kgm

1 kgf.m = 7.22 lbf ft



TIGHTENING TORQUES

Metric hardware

Nominal size	Property class 5-8 Torque Nm		Property class 8-8 Torque Nm			Property class 10-9 Torque Nm	
	plain	plated	lock nut	plain	plated	plain	plated
M4	1.7	2.2	2.3	2.6	3.4	3.7	4.8
M6	5.8	7.1	7.9	8.9	12	3	17
M8	14	18	19	22	28	31	40
M10	28	36	38	43	56	61	79
M12	49	63	66	75	97	107	138
M16	121	158	164	186	240	266	344
M20	237	307	331	375	485	519	671
M24	411	531	573	648	839	897	1160

Imperial hardware

Diameter	SAE GR 2	SAE GR 5		SAE GR 8	
	TORQUE				
	Nm	Nm		Nm	
		A	B	A	B
	1/4"	7	11	10	16
5/16"	14	24	20	35	29
3/8"	24	42	34	65	53
7/16"	42	72	58	102	81
1/2"	61	111	90	156	125
5/8"	111	231	190	319	258
3/4"	210	393	312	563	448
7/8"	224	583	461	814	651
1"	339	868	692	1220	976

A. Bolts not oiled

B. Bolts oiled

Identification

Specification

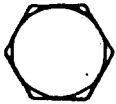

SAE - Grade 1

No identification

SAE - Grade 2



SAE - Grade 5

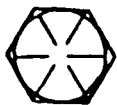

SAE - Grade 8

SPEED RANGES (maximum idle)

Fig. 1

Combine left-hand side (Fig. 1)
TX62-64-65-66
TX68

		rpm	rpm
1	Engine	2500	2100
2	Loose pulley on beater shaft	1340	1340
3	Intermediate shaft	800	800
4	Straw elevator top shaft	374	374
5	Header drive	433 (575 for Canada and Australia)	
6	Cleaning shoe drive	600 (540*)	600 (540*)
7	Returns cross auger and roto-thresher (TX68-66 only)	800 (720*)	800 (720*)
8	Returns auger and thrower (TX68-66 only)	600 (540*)	600 (540*)
9	Eccentric shaft	320 (288*)	320 (288*)
10	Chopper drive	2098	2098
11	Chopper	3500	3500
12	Chaff spreader (input shaft)	330	330

* When using small diameter drive pulley 3

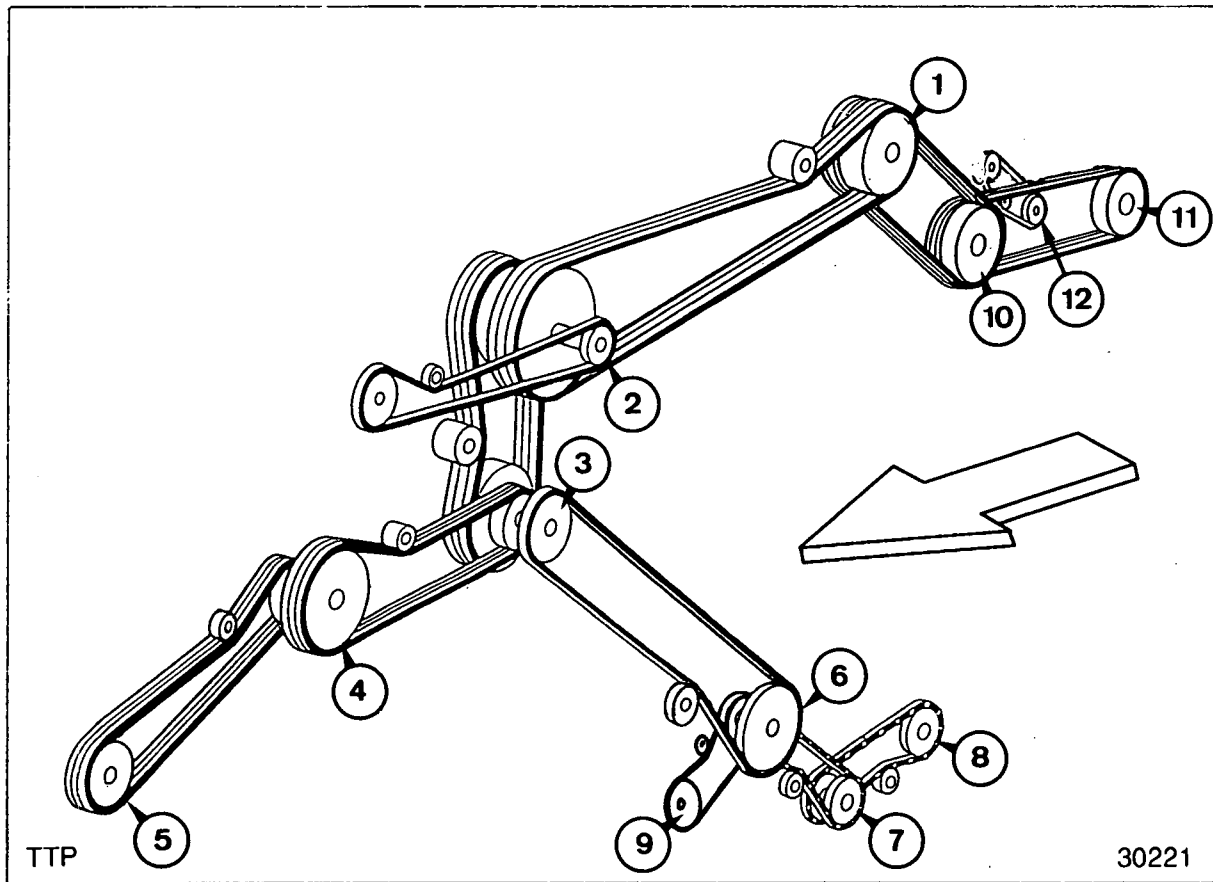
Combine right-hand side (Fig. 2)

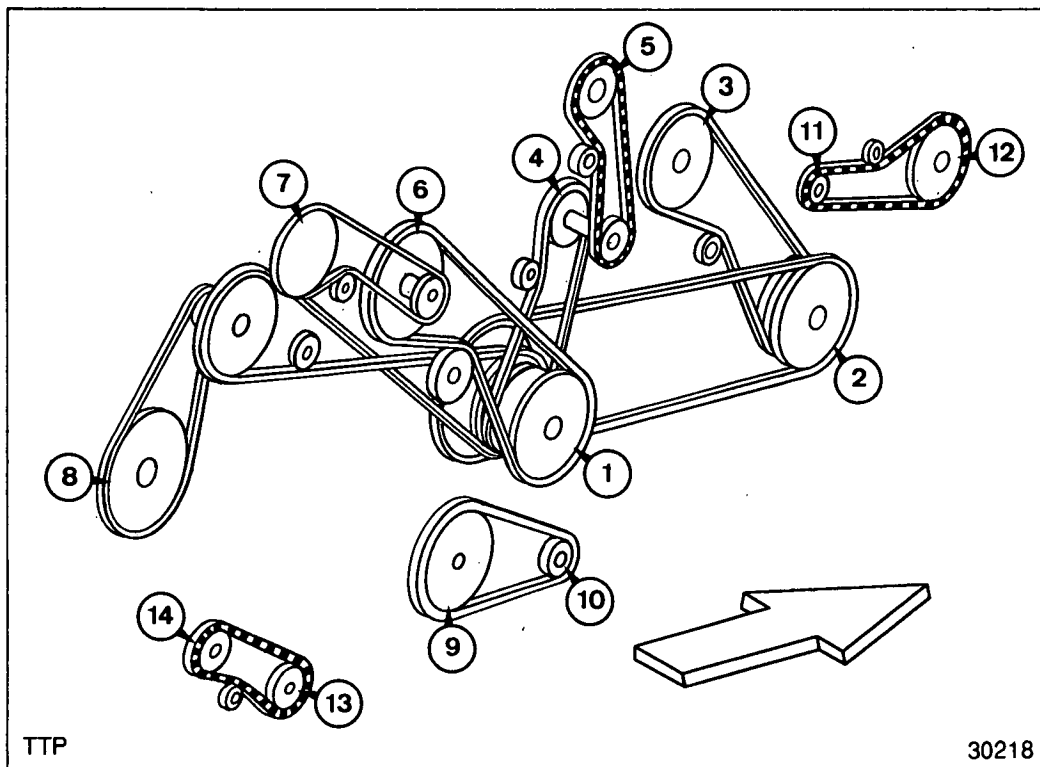

Fig. 2

	rpm		
1	Intermediate shaft	800	
2	Threshing drum	385 to 1140	
3	Beater	256 to 760	
4	Bubble-up auger speed (gearbox)		
	standard:	370	
	option:	441	
5	Grain elevator top shaft		
	standard:	382	
	option:	456	
6	Rotary separator	760 or 400	
7	Straw flow beater	760 or 400	
8	Straw walker	220	
9	Eccentric shaft	320	288*
10	Cleaning fan	500 to 920	450 to 838*
11	Graintank unloading intermediate shaft	1340	
12	Graintank unloading auger	604	
13	Returns cross auger and rotothresher	800	720*
14	Returns auger and thrower	600	540*

* When using small diameter drive pulley 3 on left-hand side



Combine engine compartment

Models TX62-64-65-66: Ford 675 TA (Fig. 3)

	TX62	TX64/65	TX66
	rpm	rpm	rpm
1 Engine	2100	2500	2500
2 Hydraulic pump	2564	2564	2564
3 Alternator	5817	6925	6925
4 Intermediate shaft	2600	2600	1552
5 Airconditioning compressor	2453	2453	2453
6 Rotary screen	300	300	300
7 Engine fan	1567	1866	1475

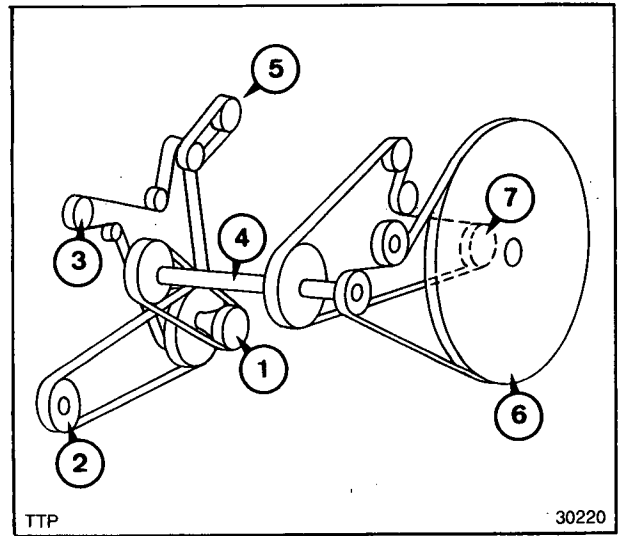

30220

Fig. 3

Model TX68: IVECO 8460SRI (Fig. 4)

	rpm
1 Engine	2100
2 Hydraulic pump	2564
3 Alternator	3934
4 Intermediate shaft	1563
5 Airconditioning compressor	2355
6 Rotary screen	302
7 Engine fan	1475

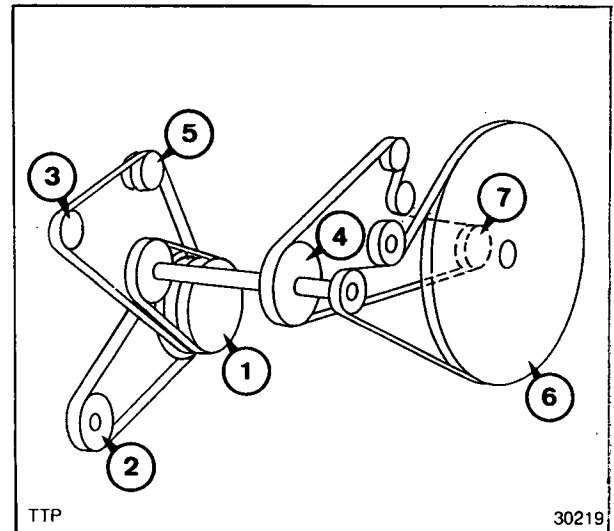

30219

Fig. 4

Grain header (Fig. 5)

- | | | |
|---|--|------------------------------|
| 1 | Knife speed | 575 rpm (1150 cuts/min) |
| 2 | Reel speed with
23-tooth sprocket
13-tooth sprocket | 21 to 57 rpm
12 to 32 rpm |
| 3 | Auger speed with
44-tooth sprocket
52-tooth sprocket | 176 rpm
150 rpm |

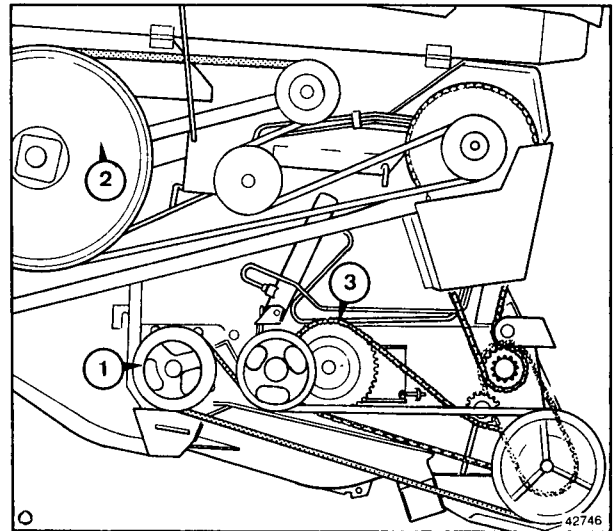

Fig. 5

Maize header (Fig. 6)

- | | | |
|---|--|--|
| 1 | Auger speed | 144 rpm |
| 2 | Stalk roll speed with
28-tooth sprocket
24-tooth sprocket
20-tooth sprocket | 892 rpm
1041 rpm
1249 rpm |
| 3 | Gathering chains with
28-tooth sprocket
24-tooth sprocket
20-tooth sprocket | 1.27 m/sec
1.47 m/sec
1.76 m/sec |

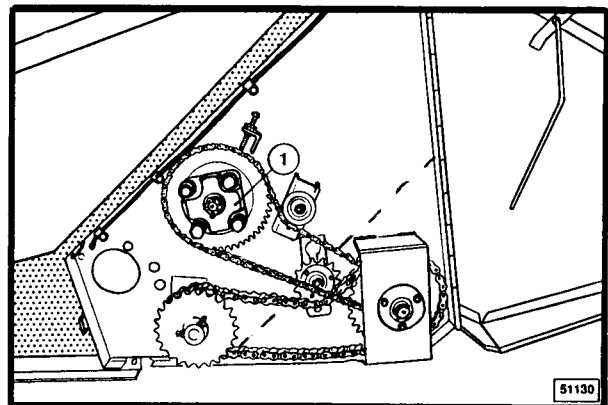

Fig. 6

OIL APPLICATION GUIDE

Lubricant	Recommended FNH product	Corresponding international classification
Engine oil	M2C-121-C (SAE 15W-40)	API CE/SF CCMC D4/G2 MIL-L-2104 D
Gearbox oil	M2C-94-A (SAE 80W-90)	API GL-5 MIL-L-2105 D
Hydraulic oil Hydrostatic oil	M2C-48-C3	ISO HV 46 DIN 51524 H-LP32 H-LP46
Chains Threaded rods Pivot points	M2C-94-A	SAE 90 gear oil
Grease nipples	M1C-137A	NLGI - class 2
Brake fluid	M6C-25-A	SAE J 1703A DOT 4
Tracks	M2C-159-B	API-CC-CD MIL-L-2104 C
Airconditioning compressor	—	—
Antifreeze	E 2218 - T - 9	BSS 6580

TRACTION AND STEERING AXLE

	Page
Models TX62-64-65-66-68	1 to 44
Model TX67	45 to 54

TRACTION AND STEERING AXLE

	Page
Traction gearbox	2
- Removal	4
- Disassembly	6
- Assembly	12
Brakes	
- Replacement of the brake linings	17
- Brake cylinders	18
- Bleeding the brakes	20
- Parking brake adjustment	22
- Disassembly and assembly of brake shoes and discs	23
Final drives	
- Removal and installation of final drives	25
- Gear ratio 11/68 and 10/75 with standard seals	27
- Gear ratio 11/68 and 10/75 with mud seals	30
- Gear ratio 11/111 with standard seals	32
- Gear ratio 11/111 with mud seals	36
Steering axles – General data	38
- Steering wheel spindles	38
- Fixed steering axle for TX62-64-65 and adjustable steering axle for TX62-64-65-66	38
- Fixed steering axle for TX68	40
- Heavy-duty adjustable steering axle	41

TRACTION GEARBOX

Oil change

- After the first 100 operating hours
- After 200 operating hours
- Thereafter, every 400 operating hours or annually

Gearbox capacity

15 litres

Oil specification

Use AMBRA Hypoid 90 oil (ref. NH520A) or an oil meeting the following specification:

- API-GL-5 or MIL-L-2105 D
- Viscosity grade: SAE 80W-90

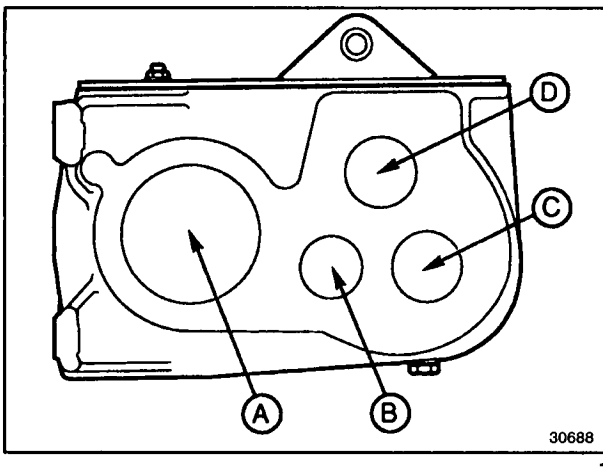

Gear shifting diagram - Figure 1

Shaft A: half-shafts from differential

Shaft B: transmission main shaft

Shaft C: countershaft

Shaft D: drive shaft

Shifting diagram - Figure 2

First gear: 1 - 2 - 3 - 4 - differential

Second gear: 1 - 2 - 5 - 6 - differential

Third gear: 1 - 2 - 7 - 8 - differential

Fourth gear: 1 - 2 - 9 - differential



Suggest:

If the above button click is invalid.

Please download this document

first, and then click the above link

to download the complete manual.

Thank you so much for reading

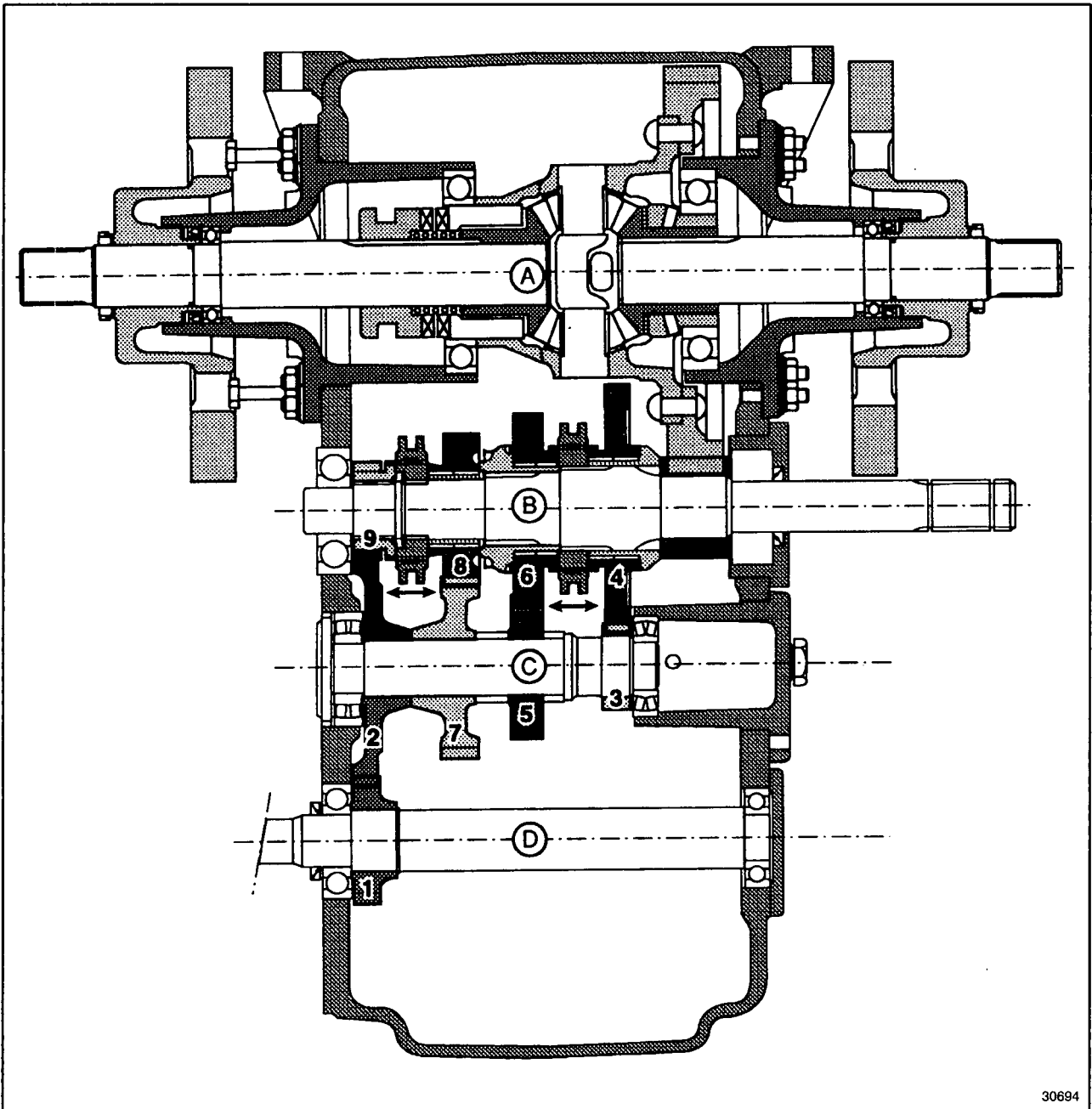

30694

<https://www.ebooklibonline.com>

Hello dear friend!

Thank you very much for reading.

Enter the link into your browser.

The full manual is available for immediate download.

<https://www.ebooklibonline.com>