

SERVICE MANUAL

TC5.30 / TC5.30
Combine

Part number 48068867

1st edition English

March 2017





SERVICE MANUAL

**TC5.30 Combine Without Cab
TC5.30 Combine with CAB**

Contents

INTRODUCTION

Engine.....	10
[10.001] Engine and crankcase	10.1
[10.103] Crankshaft and flywheel.....	10.2
[10.216] Fuel tanks	10.3
[10.202] Air cleaners and lines	10.4
[10.254] Intake and exhaust manifolds and muffler	10.5
[10.400] Engine cooling system	10.6
[10.418] Rotary screen	10.7
[10.450] Engine air compressor	10.8
Clutch	18
[18.110] Clutch and components	18.1
Transmission.....	21
[21.600] Traction variator	21.1
[21.114] Mechanical transmission	21.2
[21.130] Mechanical transmission external controls.....	21.3
[21.120] Gearbox	21.4
[21.145] Gearbox internal components.....	21.5
[21.182] Differential.....	21.6
Front axle system	25
[25.310] Final drives	25.1
Rear axle system.....	27
[27.100] Powered rear axle.....	27.1
Brakes and controls	33
[33.202] Hydraulic service brakes	33.1
[33.110] Parking brake or parking lock	33.2

<https://www.ebooklibonline.com>

Hello dear friend!

Thank you very much for reading.

Enter the link into your browser.

The full manual is available for immediate download.

<https://www.ebooklibonline.com>

Hydraulic systems	35
[35.000] Hydraulic systems.....	35.1
[35.300] Reservoir, cooler, and filters.....	35.2
[35.359] Main control valve.....	35.3
[35.701] Front loader arm hydraulic system.....	35.4
[35.410] Header or attachment height system.....	35.5
Steering	41
[41.200] Hydraulic control components.....	41.1
[41.216] Cylinders.....	41.2
Wheels	44
[44.511] Front wheels.....	44.1
[44.520] Rear wheels.....	44.2
Cab climate control	50
[50.104] Ventilation.....	50.1
[50.200] Air conditioning.....	50.2
Electrical systems	55
[55.100] Harnesses and connectors.....	55.1
[55.301] Alternator.....	55.2
[55.302] Battery.....	55.3
[55.051] Cab Heating, Ventilation, and Air-Conditioning (HVAC) controls.....	55.4
[55.518] Wiper and washer system.....	55.5
[55.404] External lighting.....	55.6
[55.408] Warning indicators, alarms, and instruments.....	55.7
Attachments/Headers	58
[58.101] Attachment/Header reel.....	58.1
Product feeding	60
[60.105] Floating roll, feed chain, and drive.....	60.1
[60.110] Feeder housing.....	60.2

[60.112] Stone trapping system	60.3
[60.122] Length-of-cut gearbox.....	60.4
Threshing	66
[66.000] Threshing	66.1
[66.330] Drum	66.2
[66.321] Drum/Rotor variator with electrical control	66.3
[66.105] Concave.....	66.4
Separation	72
[72.350] Beater	72.1
[72.420] Rotary separator	72.2
[72.101] Straw walkers and shafts	72.3
Cleaning.....	74
[74.000] Cleaning.....	74.1
[74.101] Cleaning drive systems	74.2
[74.110] Grain pan.....	74.3
[74.114] Upper shaker shoe	74.4
[74.118] Lower shaker shoe	74.5
[74.130] Fan housing.....	74.6
[74.136] Fan drive system.....	74.7
[74.140] Tailings return system	74.8
Crop storage / Unloading	80
[80.101] Clean grain elevator.....	80.1
[80.180] Grain tank unload	80.2
Platform, cab, bodywork, and decals.....	90
[90.150] Cab.....	90.1
[90.151] Cab interior.....	90.2
[90.154] Cab doors and hatches	90.3

[90.118] Protections and footboards..... 90.4



INTRODUCTION

Foreword

TC5.30 Combine Without Cab	APAC
TC5.30 Combine with CAB	APAC

Important information

All repair and maintenance works listed in this manual must be carried out only by staff belonging to NEW HOLLAND Service network, strictly complying with the instructions given and using, whenever required, the special tools.

Anyone who carries out the above operations without complying with the prescriptions shall be responsible for the subsequent damages.

The manufacturer and all the organizations of its distribution chain, including - without limitation - national, regional or local dealers, reject any responsibility for damages due to the anomalous behavior of parts and/or components not approved by the manufacturer himself, including those used for the servicing or repair of the product manufactured or marketed by the manufacturer. In any case, no warranty is given or attributed on the product manufactured or marketed by the manufacturer in case of damages due to an anomalous behavior of parts and/or components not approved by the manufacturer.

No reproduction, though partial of text and illustrations is allowed.

Foreword

TC5.30 Combine Without Cab	APAC
TC5.30 Combine with CAB	APAC

Technical information

This manual has been produced by a new technical information system. This new system is designed to deliver technical information electronically through CD-ROM and in paper manuals. A coding system called ICE has been developed to link the technical information to other product support functions, e.g. warranty.

Technical information is written to support the maintenance and servicing of the functions or systems of the customer's machine. When a customer has a concern about a machine, it is usually because a function or system in the machine is not working at all, not working efficiently, or not responding correctly to commands. When you refer to the technical information in this manual to resolve the customer's concern, you will find all the information classified using the new ICE coding, based on that machine's functions or systems. Once you have located the technical information for that function or system, you will find all the mechanical, electrical or hydraulic devices, components, assemblies and sub-assemblies for that function or system. You will also find all the types of information that have been written for that function or system, the technical data (specifications), the functional data (how it works), the diagnostic data (fault codes and troubleshooting) and the service data (remove, install adjust, etc.).

By integrating this new ICE coding into the technical information, you will be able to search for and retrieve the right piece of technical information needed to resolve the customer's concern about the machine. This is made possible by attaching 3 categories to each piece of technical information during the authoring process.

The first category is the location, the second category is the information type and the third category is the product:

- Location - is the component or function on the machine that the technical information is going to describe, e.g. Fuel tank.
- Information type - is the technical information that has been written for a particular component or function on the machine, e.g. Capacity would be a type of technical data describing the amount of fuel held by the fuel tank.
- Product - is the model for which the technical information is written.

Every piece of technical information will have those 3 categories attached to it. You will be able to use any combination of those categories to find the right piece of technical information you need to resolve the customer's concern about the machine.

This information could be:

- The description of how to remove the cylinder head
- A table of specifications for a hydraulic pump
- A fault code
- A troubleshooting table
- A special tool

How to use this manual

This manual is divided into sections. Each section is then divided into chapters. Contents pages are included at the beginning of the manual, then inside every section and inside every Chapter. There is an alphabetic index at the end of every chapter. Page number references are included for every piece of technical information listed in the chapter contents or chapter index.

Each chapter is divided into four information types:

- Technical data (specifications) for all the mechanical, electrical or hydraulic devices, components and assemblies.
- Functional data (how it works) for all the mechanical, electrical or hydraulic devices, components and assemblies.
- Diagnostic data (fault codes, electrical and hydraulic troubleshooting) for all the mechanical, electrical or hydraulic devices, components and assemblies.
- Service data (remove disassembly, assemble, install) for all the mechanical, electrical or hydraulic devices, components and assemblies.

Sections

Sections are grouped according to the machine's main functions or systems. Each section is identified by a letter A, B, C etc. The number of sections in the manual will depend on the type and function of the machine for which it is written. Each section has a contents page listed in alphabetic/numeric order. This table illustrates which Sections could be included in a manual for a particular product.

Product	Section										
	A - Distribution systems										
	B - Power production										
	C - Power train										
	D - Travelling										
	E - Body and structure										
	F - Frame positioning										
	G - Tool positioning										
	H - Working arm										
	J - Tools and couplers										
	K - Crop processing										
L - Field processing											
Tractors	X	X	X	X	X	X		X	X		
Vehicles with working arms: backhoes, excavator, front end loaders with shoes.....	X	X	X	X	X	X	X	X	X		
Harvesters, forage harvesters, balers....	X	X	X	X	X	X	X	X	X	X	
Seeder, planter, floater, pulverising equipment....	X	X	X	X	X	X		X		X	
Mounted equipment and tools.....					X	X	X		X		



SERVICE MANUAL

Engine

**TC5.30 Combine Without Cab
TC5.30 Combine with CAB**

Engine - Remove

TC5.30 Combine Without Cab	APAC
TC5.30 Combine with CAB	APAC

Prior operation:

Disconnect the battery connections. See the “ **Battery - Disconnect (55.302)**”.

Prior operation:

Remove radiator. See the “ **Radiator - Remove (10.400)**”.

Prior operation:

Remove hydraulic oil reservoir. See the “ **Oil reservoir - Remove (35.300)**”.

Prior operation:

Remove hydrostatic pump. See the “ **Pump - Remove (29.218)**”.

Prior operation:

Remove air cleaner. See the “ **Air cleaner - Remove (10.202)**”.

Prior operation:

Remove fly wheel belt. See the “ **Engine flywheel - Remove (10.103)**”.

1. Loosen and remove the bolt (1) along with nut and washer from the flywheel side profile support bracket (2).

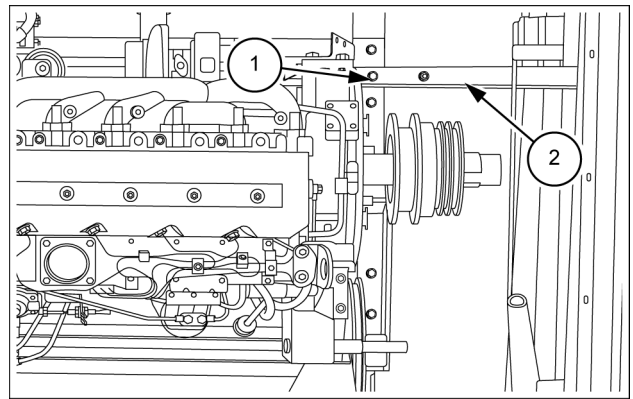

PUIL16CH01840AB 1

2. Loosen and remove the four bolts along with nuts and washers (1) from the profile (2).

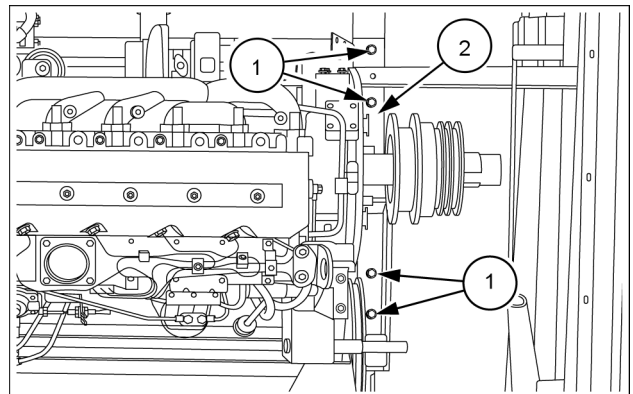

PUIL16CH01841AB 2

3. Loosen and remove the two bolts along with nuts and washers (1) from the engine front side support reinforcement (2).

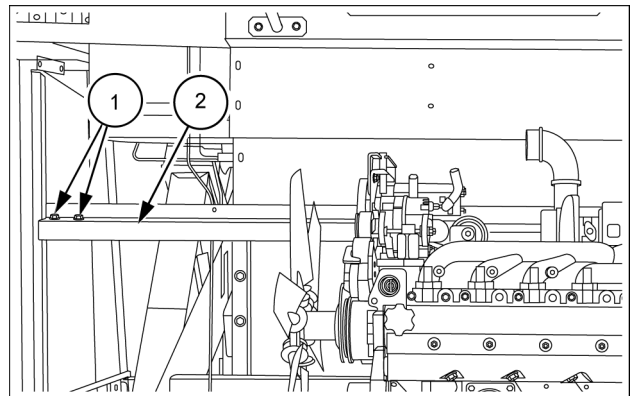

PUIL16CH01844AB 3

4. Loosen and remove the five bolts along with nuts and washers **(1)** from the engine front side support reinforcement **(2)**.
5. Place the suitable holding device to hold the engine and lift it from the profile and place it on leveled surface area.

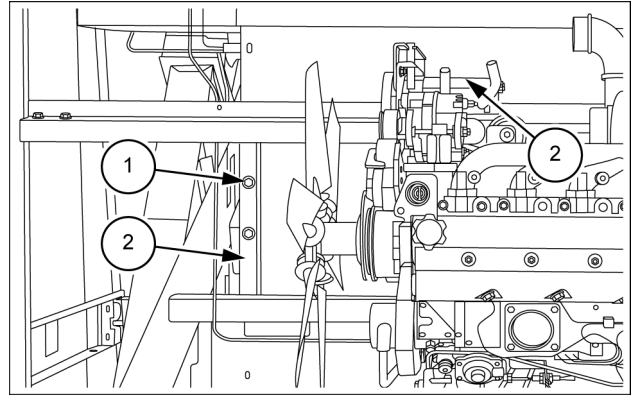

PUIL16CH01843AB 4

Engine - Install

TC5.30 Combine Without Cab	APAC
TC5.30 Combine with CAB	APAC

1. Place the suitable holding device to hold the engine and lift it from the ground and place it in the combine.
2. Tighten the five bolts **(1)** along with nuts and washers on the engine front side support reinforcement **(2)**.

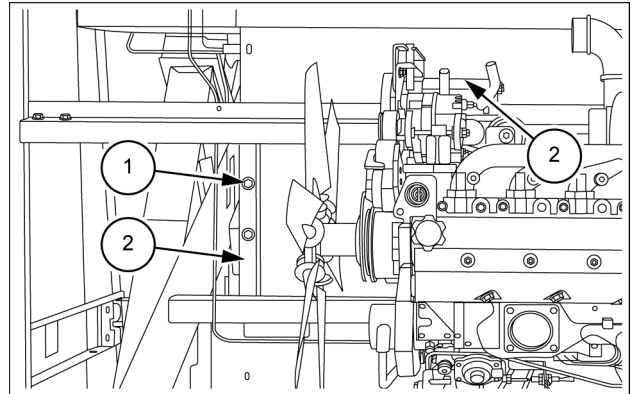

PUIL16CH01843AB 1

3. Tighten the two bolts **(1)** along with nuts and washers on the engine front side support reinforcement **(2)**.

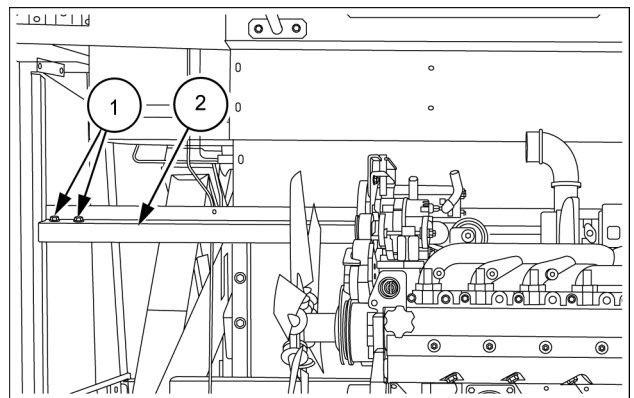

PUIL16CH01844AB 2

4. Tighten the four bolts **(1)** along with nuts and washers on the profile and support bracket **(2)**.

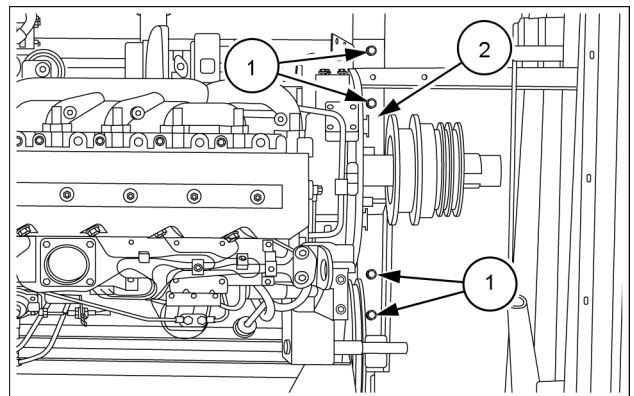

PUIL16CH01841AB 3

5. Tighten the bolt **(1)** along with nut and washer on the flywheel side support bracket **(2)**.

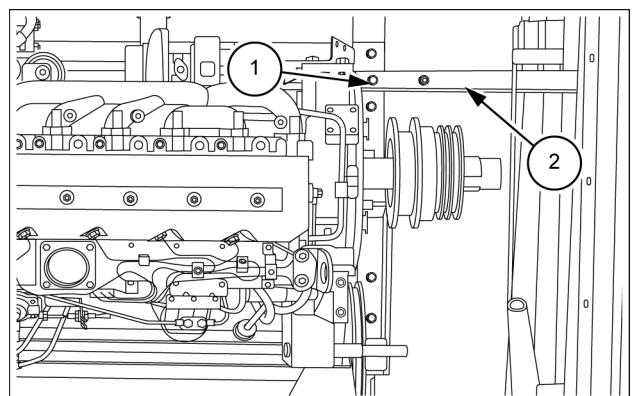

PUIL16CH01846AB 4

Next operation:

Install the fly wheel belt. See the “ **Engine flywheel - Install (10.103)**”.

Next operation:

Install the air cleaner. See the “ **Air cleaner - Remove (10.202)**”.

Next operation:

Install the hydrostatic pump. See the “ **Pump - Install (29.218)**”.

Next operation:

Install the hydraulic oil reservoir. See the “ **Oil reservoir - Install (35.300)**”.

Next operation:

Install the radiator. See the “ **Radiator - Install (10.400)**”.

Next operation:

Connect the battery. See the “ **Battery - Connect (55.302)**”.

Engine flywheel - Remove - Belt

TC5.30 Combine Without Cab	APAC
TC5.30 Combine with CAB	APAC

1. Remove the cotter pin (1) from the rod (2) to disconnect the main drive lever (3).
2. Disconnect the spring (4) from the main drive lever (3) and from the grain tank bottom bracket (5).

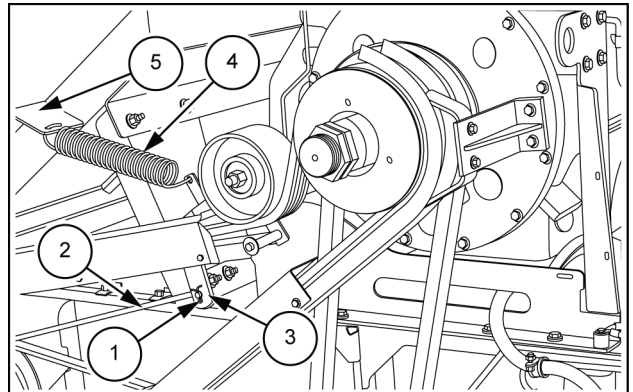

PUIL16CH01847AB 1

3. Loosen and remove the bolt (1) along with nut and washer from the support (2) and from the conveyor (3).

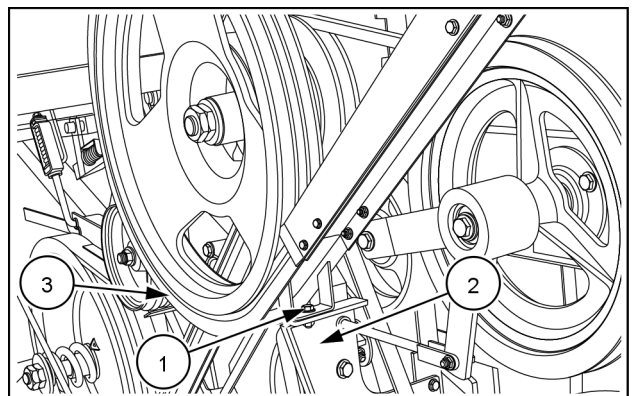

PUIL15CH01102AB 2

4. Loosen and remove all the bolts (1) along with nuts and washers from the both beugel (2) and remove both the beugels from the guideway.

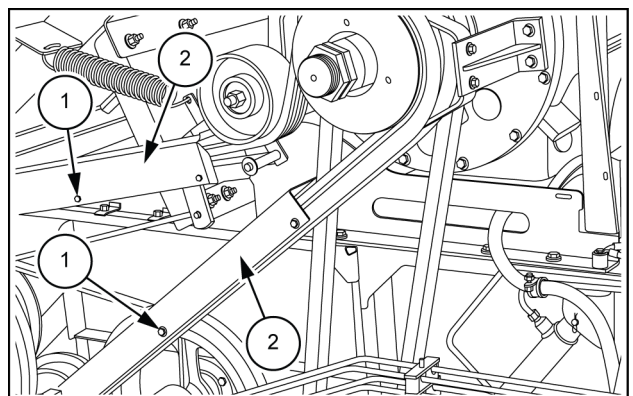

PUIL16CH01848AB 3

5. Loosen and remove the two bolts (1) along with nuts and washers from the support (2) to remove the guideway (3).

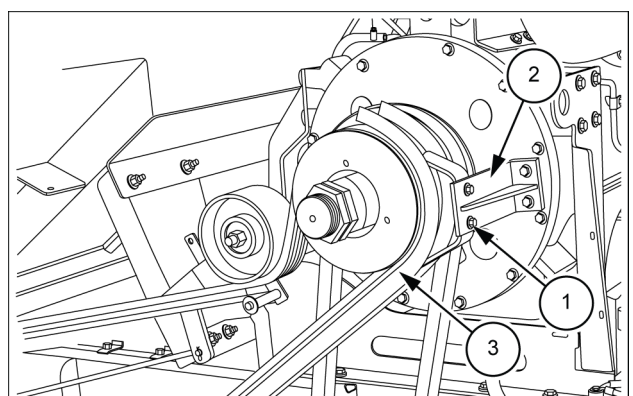

PUIL16CH01849AB 4



Suggest:

If the above button click is invalid.

Please download this document

first, and then click the above link

to download the complete manual.

Thank you so much for reading

6. Remove the belt (1) from the pulley (2).

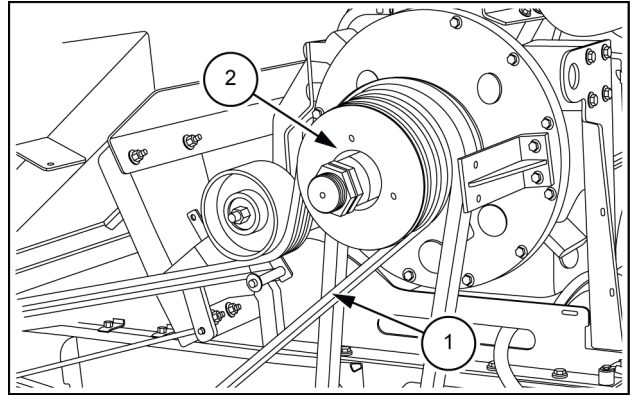

PUIL16CH01908AB 5

7. Loosen and remove the two bolts (1) along with washers from the support (2).
8. Remove the support (2) from the flywheel housing (3).

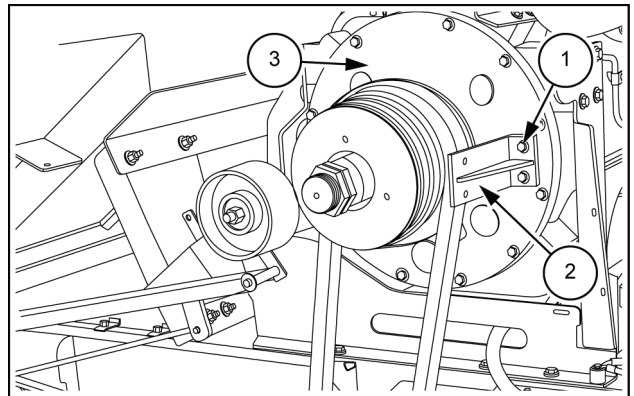

PUIL16CH01909AB 6

9. Loosen the traction drive control bolt (1) to reduce the belt tension and remove the belt (2) from the pulley (3).

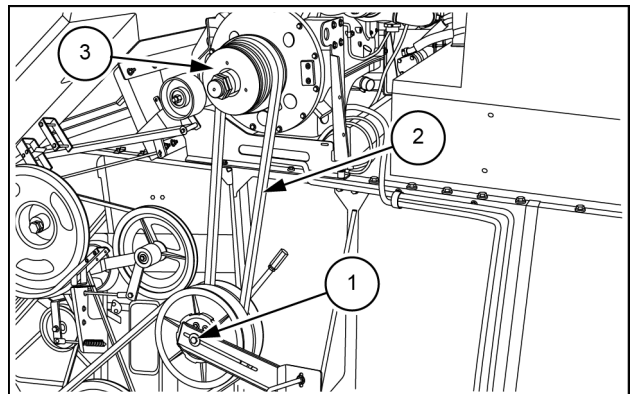

PUIL16CH01914AB 7

10. Loosen and remove the two nuts (1) along with washers from the power take-off shaft (2).
11. Remove the pulley (3) from the power take-off shaft (2).

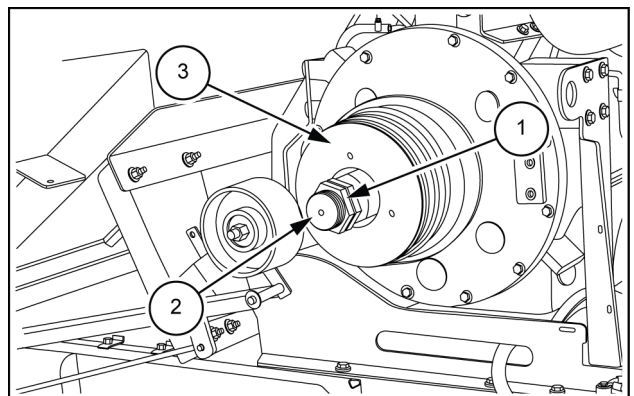

PUIL16CH01911AB 8

<https://www.ebooklibonline.com>

Hello dear friend!

Thank you very much for reading.

Enter the link into your browser.

The full manual is available for immediate download.

<https://www.ebooklibonline.com>