

---

# TC23DA, TC26DA REPAIR MANUAL COMPLETE CONTENTS

SECTION 00 - GENERAL INFORMATION .....	2
SECTION 10 - ENGINE .....	3
SECTION 18 - SINGLE CLUTCH .....	10
SECTION 21 - TRANSMISSION .....	11
SECTION 25 - FWD FRONT AXLE .....	13
SECTION 27 - DIFFERENTIAL, REAR AXLE .....	14
SECTION 29 - HYDROSTATIC TRANSMISSION .....	15
SECTION 31 - POWER TAKE-OFF (PTO) .....	19
SECTION 33 - BRAKES .....	20
SECTION 35 - HYDRAULIC SYSTEM .....	21
SECTION 41 - STEERING .....	24
SECTION 44 - WHEELS AND TIRES .....	25
SECTION 55 - ELECTRICAL SYSTEM .....	26
SECTION 90 - PLATFORM .....	32

The following pages are the collation of the contents pages from each section and chapter of the TC23DA, TC26DA Repair manual. Complete Repair part # 87367140.

The sections used through out all New Holland product Repair manuals may not be used for each product. Each Repair manual will be made up of one or several books. Each book will be labeled as to which sections are in the overall Repair manual and which sections are in each book.

The sections listed above are the sections utilized for the TC23DA, TC26DA Tractors.

## SECTION 00 - GENERAL INFORMATION

### Chapter 1 - General Information

#### CONTENTS

<b>Section</b>	<b>Description</b>	<b>Page</b>
	Introduction .....	2
	Precautionary Statements .....	3
	Safety .....	4
	The Tractor .....	4
	Servicing the Tractor .....	4
	Operating the Tractor .....	5
	Driving the Tractor .....	5
	Operating the PTO .....	6
	Diesel Fuel .....	6
	Safety Frame (ROPS) .....	6
	Safety Decals .....	7
	Instruction Decals .....	9
	Product Identification Plate .....	13
	Universal Symbols .....	14
	Specifications - TC23DA, TC26DA .....	15
	General Dimensions - TC23DA, TC26DA .....	20
	Minimum Hardware Tightening Torques .....	23
	Lubricants .....	25
	Adjustments .....	26

## **INTRODUCTION**

This repair manual provides the technical information needed to properly service the New Holland TC23DA, TC26DA tractor. Use this manual in conjunction with the operator's manual for complete operation, adjustment, and maintenance information.

On New Holland equipment, left and right are determined by standing behind the unit, looking in the direction of travel.

**<https://www.ebooklibonline.com>**

Hello dear friend!

Thank you very much for reading.

Enter the link into your browser.

The full manual is available for immediate download.

**<https://www.ebooklibonline.com>**

# SAFETY

## PRECAUTIONARY STATEMENTS

A careful operator is the best operator. Most accidents can be avoided by observing certain precautions. To help prevent accidents, read and take the following precautions before operating this equipment. Equipment should be operated only by those who are responsible and instructed to do so.

Carefully review the procedures given in this manual with all operators. It is important that all operators be familiar with and Follow safety precautions.

### THE TRACTOR

1. Read the Operator's Manual carefully before using the tractor. Lack of operating knowledge can lead to accidents.
2. Use an approved roll bar and seat belt for safe operation. Overturning a tractor without a roll bar can result in death or injury. If your tractor is not equipped with a roll bar and seat belt, see your New Holland Dealer.
3. Always use the seat belt. The only instance when the seat belt should not be used is if the roll bar has been removed from the tractor.
4. If a front end loader is to be installed, always use a FOPS (Falling Object Protective Structure) canopy to avoid injury from falling objects.
5. Use the handholds and step plates when getting on and off the tractor to prevent falls. Keep steps and platform cleared of mud and debris.
6. Do not permit anyone but the operator to ride on the tractor. There is no safe place for extra riders.
7. Keep all safety decals clean of dirt and grime, and replace all missing, illegible, or damaged safety decals. See the list of decals in the Decal section of this manual.
3. Keep the tractor and equipment, particularly brakes and steering, maintained in a reliable and satisfactory condition to ensure your safety and comply with legal requirements.
4. Keep open flame or cold weather starting aids away from the battery to prevent fires or explosions. Use jumper cables according to instructions to prevent sparks which could cause explosion.
5. Stop the engine before performing any service on the tractor.
6. Escaping hydraulic/diesel fluid under pressure can penetrate the skin causing serious injury. If fluid is injected into the skin, obtain medical attention immediately or gangrene may result.
  - DO NOT use your hand to check for leaks. Use a piece of cardboard or paper to search for leaks.
  - Stop the engine and relieve pressure before connecting or disconnecting lines.
  - Tighten all connections before starting the engine or pressurizing lines.
7. Do not modify or permit anyone else to modify or alter this tractor or any of its components or functions without first consulting a New Holland Dealer.

### SERVICING THE TRACTOR

1. The cooling system operates under pressure which is controlled by the radiator cap. It is dangerous to remove the cap while the system is hot. Always turn the cap slowly to the first stop and allow pressure to escape before removing the cap entirely.
2. Keep any type of open flame away from the tractor and do not smoke while refueling. Wait for the engine to cool before refueling.
8. The fuel oil in the injection system is under high pressure and can penetrate the skin. Unqualified persons should not remove or attempt to adjust a pump, injector, nozzle, or any other part of the fuel injection system. Failure to follow these instructions can result in serious injury.
9. Continuous long-term contact with used engine oil may cause skin cancer. Avoid prolonged contact with used engine oil. Wash skin promptly with soap and water.

10. Some components of your tractor, such as gaskets and friction surfaces (brake linings, clutch linings, etc.) may contain asbestos. Breathing asbestos dust is dangerous to your health. You are advised to have any maintenance or repair on such components carried out by an authorized New Holland Dealer. However, if service operations are to be undertaken on parts that contain asbestos, the essential precautions listed below must be observed:
  - Work out of doors or in a well ventilated area.
  - Dust found on the tractor or produced during work on the tractor should be removed by extraction, not by blowing.
  - Dust waste should be dampened, placed in a sealed container, and marked to ensure safe disposal.
  - If any cutting, drilling, etc. is attempted on materials containing asbestos, the item should be dampened and only hand tools or low speed power tools used.
9. Pull only from the drawbar or the lower link drawbar in the down position. Use only a drawbar pin that locks in place. Pulling from the tractor rear axle or any point above the axle may cause the tractor to upset.
10. If the front end of the tractor tends to rise when heavy implements are attached to the three-point hitch, install front end or front wheel weights. Do not operate the tractor with a light front end.
11. Always set the hydraulic selector lever in position control when attaching or transporting equipment. Ensure hydraulic couplers are properly mounted and will disconnect safely in case of accidental detachment of implement.
12. Do not leave equipment in the raised position.
13. Use the flasher/turn signal lights and SMV signs when traveling on public roads both day and night (unless prohibited by law).
14. When operating at night, adjust lights to prevent blinding oncoming drivers.

## **OPERATING THE TRACTOR**

1. Before starting the tractor, apply the parking brake, place the PTO lever in the "OFF" position, the lift control lever in the down position, the remote control valve levers in the neutral position, and the transmission in neutral.
2. Always sit in the tractor seat when starting the engine or operating controls. Do not start the engine or operate controls while standing beside the tractor.
3. Do not bypass the neutral start switches. Consult your New Holland Dealer if your neutral start controls malfunction. Use jumper cables only in the recommended manner. Improper use can result in tractor runaway.
4. Avoid accidental contact with the gear shift lever while the engine is running, as this can cause unexpected tractor movement.
5. Before getting off the tractor, disengage the PTO, turn the engine off, and apply the parking brake. Never get off the tractor while it is in motion.
6. Do not park the tractor on a steep incline.
7. Do not operate the tractor engine in an enclosed building without adequate ventilation. Exhaust fumes can cause death or illness.
8. If the power steering or engine ceases operating, stop the tractor immediately.

## **DRIVING THE TRACTOR**

1. Watch where you are going, especially at row ends, on roads, around trees and low hanging obstacles.
2. To avoid upsets, drive the tractor with care and at a safe speed. Use extra caution when operating over rough ground, when crossing ditches or slopes, and when turning corners.
3. To provide two-wheel braking, lock tractor brake pedals together when transporting on roads.
4. Do not coast or free wheel down hills. Use the same gear when going downhill as is used when going uphill.
5. Any towed vehicle with a total weight exceeding that of the towing tractor should be equipped with brakes for safe operation.
6. If the tractor becomes stuck or the tires become frozen to the ground, back up the tractor to prevent upset.
7. Always check overhead clearance, especially when transporting the tractor.
8. When operating at night, adjust lights to prevent blinding oncoming drivers.

**SECTION 10 - ENGINE**

**Chapter 1 - Engine Systems**

**CONTENTS**

<b>Section</b>	<b>Description</b>	<b>Page</b>
10 000	Specifications .....	6
	Cylinder Head .....	6
	Cylinder Block .....	7
	Piston .....	7
	Piston Ring .....	8
	Connecting Rod .....	8
	Crankshaft .....	9
	Camshaft .....	10
	Valves .....	11
	Push Rods .....	12
	Rocker Arms .....	12
	Lubrication System .....	12
	Cooling System .....	13
	Torque Specifications .....	14
	Metric Bolt Torque Specifications .....	14
	Special Tools .....	15
	Description and Operation - General Information .....	16
	Identification Chart .....	16
	Cylinder Head and Valve Train Components .....	17
	Cylinder Block Assembly .....	17
	Troubleshooting .....	19
	Overhaul - Engine .....	25
	Engine Preparation .....	25
	Disassembly .....	25
	Fuel Injector and Glow Plug .....	27
	Removal .....	27
	Oil Pressure Switch .....	27
	Removal .....	27
	Temperature Sending Switch and Alternator .....	28
	Removal .....	28
	Fan, Water Pump, and External Oil Tube .....	28
	Removal .....	28

*SECTION 10 - ENGINE - CHAPTER 1*

---

<b>Section</b>	<b>Description</b>	<b>Page</b>
	Valve Cover .....	28
	Removal .....	28
	Rocker Shaft and Push Rod .....	29
	Removal .....	29
	Cylinder Head .....	29
	Removal .....	29
	Valve Tappet .....	29
	Removal .....	29
	Fuel Shut-off Solenoid .....	30
	Removal .....	30
	Engine Timing Gear Cover .....	30
	Removal .....	30
	Timing Gears and Camshaft .....	32
	Removal .....	32
	Oil Sump .....	32
	Removal .....	32
	Oil Suction Pipe and Strainer .....	33
	Removal .....	33
	Connecting Rods, Bearing and Pistons .....	33
	Removal .....	33
	Flywheel .....	34
	Removal .....	34
	Backplate and Oil Seal .....	34
	Removal .....	34
	Crankshaft and Main Bearing .....	34
	Removal .....	34
18 110	Cylinder Head .....	35
	Disassembly .....	35
	Inspection .....	35
	Valve Seats .....	36
	Inspection .....	36
	Valves .....	37
	Inspection .....	37
	Valve Guides .....	39
	Inspection .....	39
	Valve Springs .....	39
	Inspection .....	39
	Rocker Arms .....	40
	Inspection .....	40

*SECTION 10 - ENGINE - CHAPTER 1*

---

<b>Section</b>	<b>Description</b>	<b>Page</b>
	Push Rods .....	40
	Inspection .....	40
	Cylinder Head .....	41
	Assembly .....	41
	Cylinder Block .....	41
	Inspection .....	41
10 105	Pistons, Piston Rings, and Connecting Rods .....	42
	Disassembly .....	42
	Piston .....	42
	Inspection .....	42
	Piston Rings .....	44
	Inspection .....	44
	Connecting Rods .....	45
	Inspection .....	45
	Bearing Oil Clearance Check .....	47
10 105	Pistons, Piston Rings, and Connecting Rod .....	47
	Assembly .....	47
10 103	Crankshaft Main Bearings .....	48
	Removal .....	48
	Inspection .....	48
	Crankshaft .....	49
	Inspection .....	49
	Crankshaft Journal Wear Limit and Bearing Usage .....	49
	Crankshaft Front Main Bearing (Bushing) .....	50
	Inspection .....	50
	Replacement .....	50
	Crankshaft Main Bearing .....	51
	Assembly .....	51
	Port Block .....	51
	Removal .....	51
	Installation .....	51
	Timing Gear .....	52
	Inspection .....	52
	Camshaft .....	52
	Disassembly .....	52
	Inspection .....	53
	Assembly .....	53
10 103	Flywheel .....	54
	Inspection .....	54

*SECTION 10 - ENGINE - CHAPTER 1*

---

<b>Section</b>	<b>Description</b>	<b>Page</b>
	Timing Gear Housing .....	54
	Front Oil Seal and Steering Pump Seal .....	54
	Replacement .....	54
	Crankshaft and Bearing Holder .....	55
	Assembly .....	55
	Rear Oil Seal and Backplate .....	55
	Assembly .....	55
	Flywheel .....	56
	Installation .....	56
	Piston and Connecting Rod .....	56
	Installation .....	56
	Oil Suction Pipe and Suction Strainer .....	57
	Installation .....	57
	Oil Sump .....	57
	Installation .....	57
	Camshaft and Camshaft Gear .....	57
	Assembly .....	57
	Idle Gear, Oil Pump and Injection Timing .....	58
	Installation .....	58
	Timing Gear Cover .....	58
	Installation .....	58
	Crankshaft Pulley .....	58
	Installation .....	58
	Fuel Injection Pump .....	59
	Installation .....	59
	Power Steering Pump .....	59
	Installation .....	59
	Head Gasket .....	60
	Cylinder Head .....	61
	Assembly .....	61
	Valve Clearance Adjustment .....	62
	Valve Cover .....	62
	Installation .....	62
	Fan, Water Pump and External Oil Tube .....	63
	Installation .....	63
	Glow Plug and Connector .....	63
	Installation .....	63
	Fuel Injector .....	63
	Installation .....	63

*SECTION 10 - ENGINE - CHAPTER 1*

---

<b>Section</b>	<b>Description</b>	<b>Page</b>
	Fuel Piping .....	64
	Installation .....	64
	Alternator and Temperature Sending Switch .....	64
	Installation .....	64
	Exhaust Manifold, Radiator, and Air Cleaner .....	65
	Installation .....	65
10 304	Description of Operation - Engine Lubrication System .....	66
10 206	Engine Oil Filter .....	69
10 304	Oil Pump .....	69
	Removal .....	69
	Inspection .....	69
	Installation and Adjustment .....	70
	Engine Oil Pressure Check .....	71
	Oil Pressure Relief Valve .....	71
	Removal .....	71
	Installation .....	71
	Oil Consumption .....	72
10 400	Description of Operation - Cooling System .....	73
	Maintenance .....	75
	Coolant .....	75
	Thermostat .....	75
	Water Pump .....	75
	Cooling Fan .....	75
	Radiator .....	75
	Radiator Cap .....	75
	Overhaul - Cooling System .....	76
10 406	Radiator .....	76
	Removal .....	76
	Inspection and Repair .....	77
	Installation .....	77
10 402	Water Pump and Thermostat .....	78
	Removal .....	78
	Inspection and Repair .....	80
	Assembly .....	80
	Installation .....	80
	Compression Test and Tools .....	82

**SECTION 10 - ENGINE - CHAPTER 1**

**SPECIFICATIONS**

**Op. 10 000**

<b>GENERAL</b>		
<b>Tractor Model</b>	<b>TC23DA</b>	<b>TC26DA</b>
PTO H.P. (at engine rated speed) w/9x3 w/HST	18.6 17.4	NA 19.7
Engine Model	S773	S773L
Number of Cylinders	3	3
Bore x Stroke	77 x 72 mm (3.03 x 2.83 in.)	77 x 81 mm (3.03 x 3.19 in.)
Displacement	1.005 L, 1005 cc (61.3 cu. in.)	1.131 L, 1.131 cc (69.0 cu. in.)
Compression Ratio	24.5:1	23.5:1
Rated Speed (rpm)	2850	2850
Muffler	In the hood	In the hood
Firing Order	1 - 2 - 3	1 - 2 - 3
Low Idle Speed (rpm)	1100 - 1200	1100 - 1200
High Idle Speed (rpm)	3000 - 3050	3000 - 3050
Cylinder Arrangement	In-line Vertical	In-line Vertical
Valve Arrangement	Overhead	Overhead
Compression Pressure @ 200 rpm (cylinder speed) Variation between cylinders	427 ± 70 psi  70 psi	427 ± 70 psi  70 psi

<b>CYLINDER HEAD</b>		
<b>Tractor Model</b>	<b>TC23DA</b>	<b>TC26DA</b>
Head Warp Standard Maximum	0.05 mm (0.002 in.) 0.12 mm (0.005 in.)	0.05 mm (0.002 in.) 0.12 mm (0.005 in.)
Valve Seat Width Standard Maximum	1.7 - 2.1 mm (0.067 - 0.082 in.) 2.5 mm (0.098 in.)	1.7 - 2.1 mm (0.067 - 0.082 in.) 2.5 mm (0.098 in.)
Valve Seat Sink Standard Maximum	0.85 - 1.15 mm (0.0334 - 0.0453 in.) 1.8 mm (0.0708 in.)	0.85 - 1.15 mm (0.0334 - 0.0453 in.) 1.8 mm (0.0708 in.)
Valve Angle	45°	45°
Piston to Valve Clearance	1.0 mm (0.039 in.) @ Piston TDC (Minimum 0.8 mm [0.031 in.]	1.0 mm (0.039 in.) @ Piston TDC (Minimum 0.8 mm [0.031 in.]

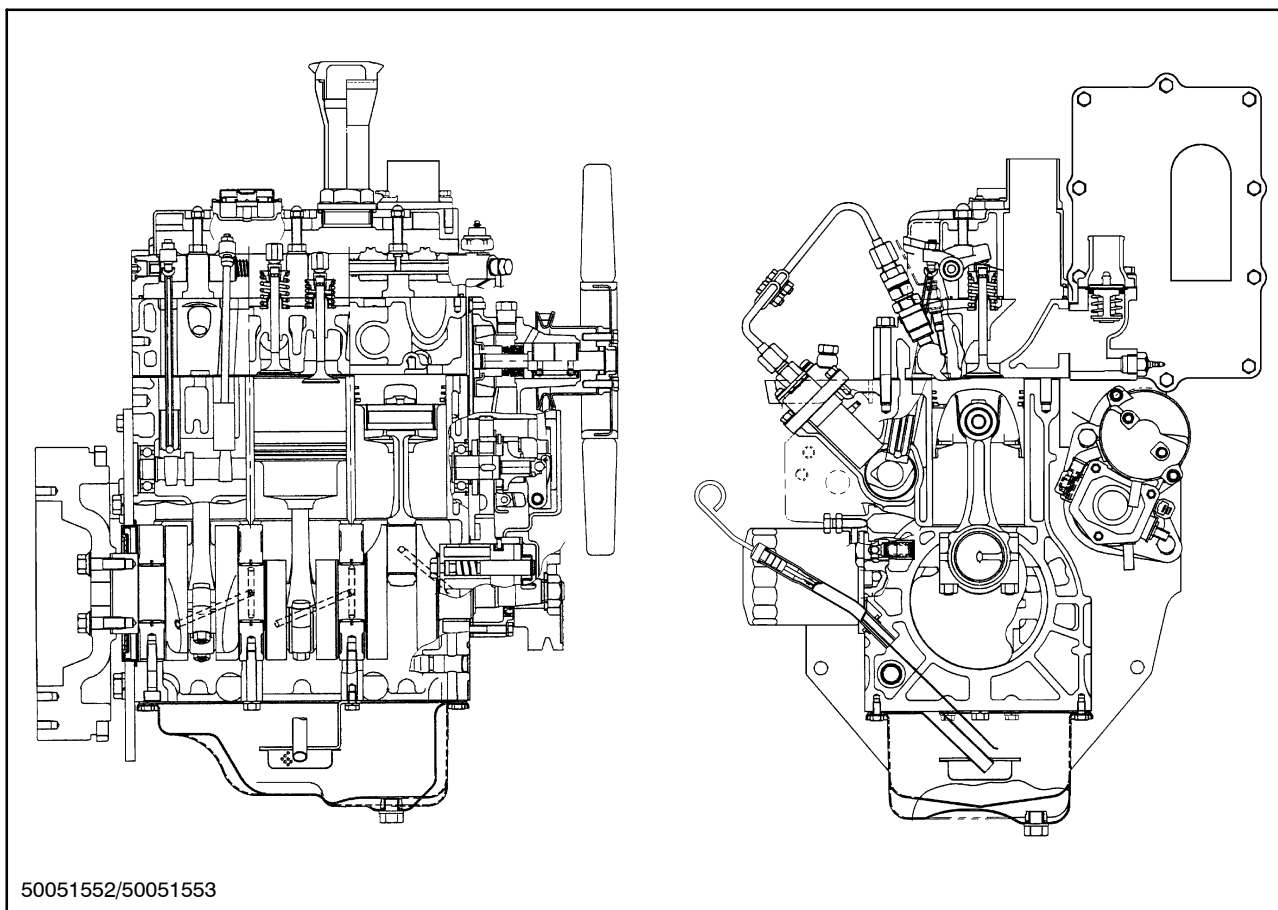

2

### CYLINDER HEAD AND VALVE TRAIN COMPONENTS

The cylinder head incorporates the valve assemblies, rocker arms, rocker shaft, push rods, lifters, and pre-combustion chambers. The air intake manifold is incorporated into the left hand side of the valve cover assembly. The exhaust manifold is bolted on the left-hand side of the cylinder head. The cylinder heads have integral valve guides. Standard size valves only are used. Figure 2 provides a cut-away front and side view of an engine.

A pre-combustion chamber is located between the injector assembly and the combustion chamber of the cylinder and provides an area for initial ignition of the fuel for improved starting. A glow plug located in the head extends into the pre-combustion chamber and, when energized, pre-heats the fuel-air mixture for improved fuel ignition under cold weather conditions.

### CYLINDER BLOCK ASSEMBLY

The cylinder block assembly contains the pistons, connecting rods, crankshaft, timing gears, and engine oil pump. The engine crankshaft is supported by four main bearings. The front main bearing is a full circle bearing positioned in a bore in the front of the block. The second, third, and fourth main bearings are split liners located in holders bolted to the block. The camshaft is supported by two ball bearings one located on each end of the block. The engines utilize a straight connecting rod and a three ring piston.

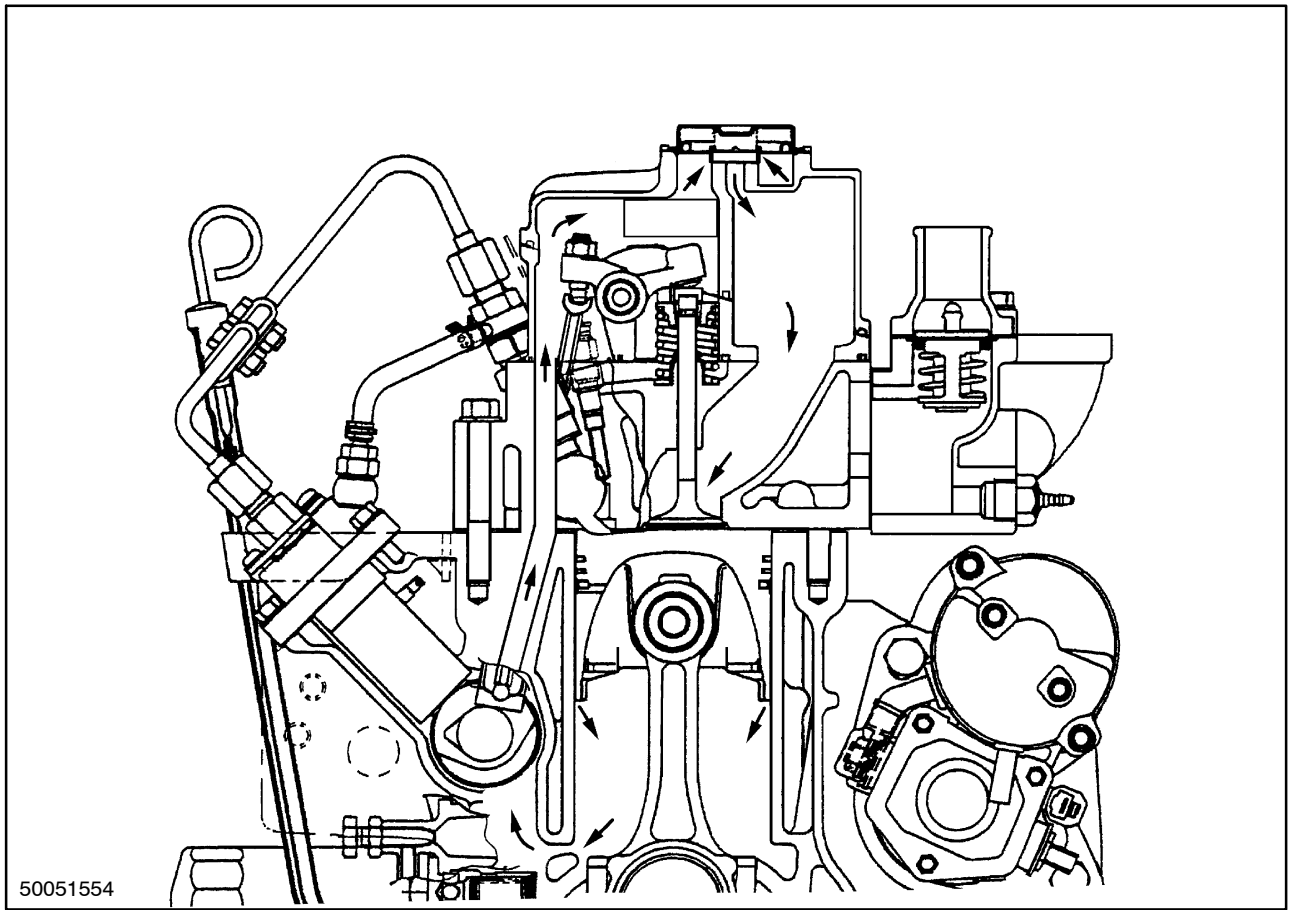

A breather valve is located on the valve cover between the air intake manifold and the valve room.

The valve is opened when the crankcase (blow by gas) pressure increases to approximately 25 mm Aq. Once the valve is open, blow by gas passes into the intake manifold, and is burned with the aspirated air.

OVERHAUL - ENGINE

ENGINE PREPARATION

Disassembly

1. Open the radiator drain, 1, and drain and remove the radiator assembly. See "Radiator Removal" discussed later in this section.

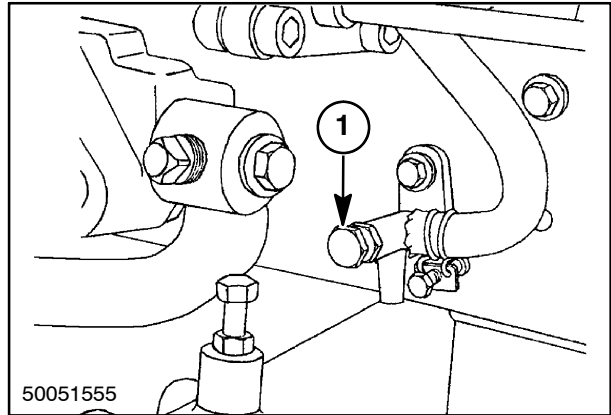

4

2. Disconnect the electrical connector, 1, for the head lamps.

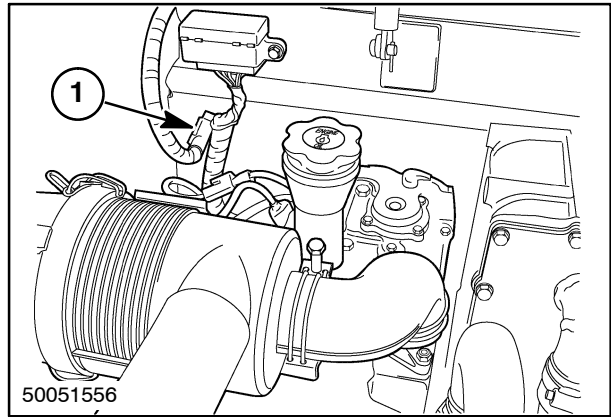

5

3. Remove the clip pin, 1, from the hood support, 2, and damper, 3, and gradually slide to the left and remove the hood.

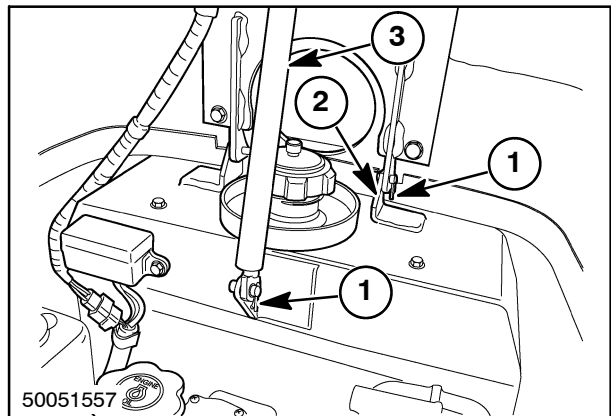

6

SECTION 10 - ENGINE - CHAPTER 1

4. Remove the air cleaner assembly, 1, along with the air cleaner hoses.

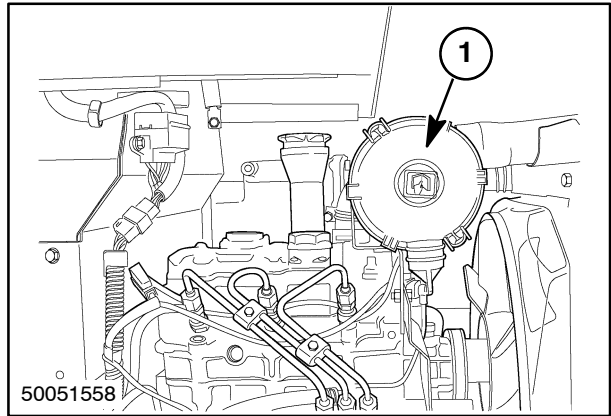

7

5. Remove the two capscrews, 1, and remove the air cleaner mounting bracket, 2.

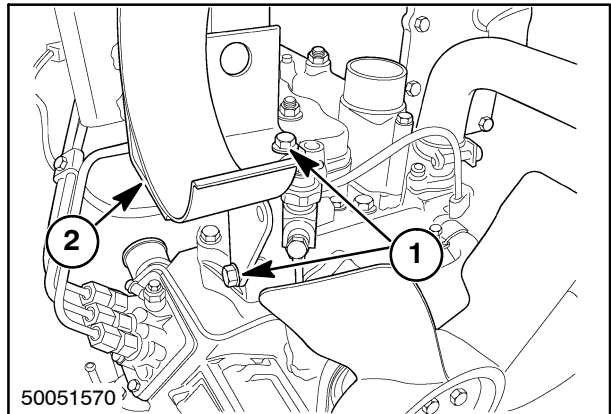

8

6. Remove the exhaust muffler and manifold assembly, 1.

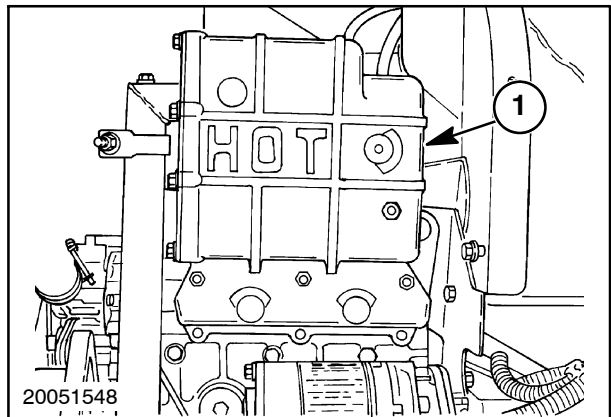

9

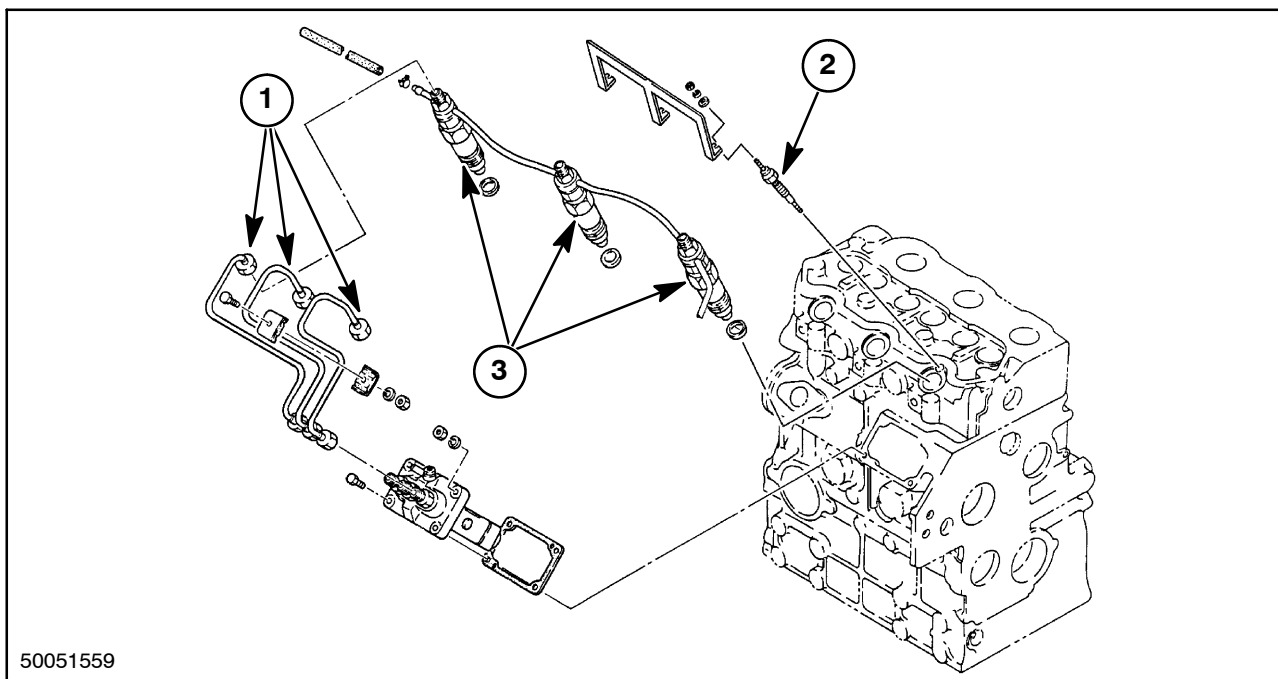

50051559

10

## FUEL INJECTOR AND GLOW PLUG

### Removal

1. Clean all dirt and oil from the injectors and surrounding areas.
2. Disconnect the fuel lines, 1, from the injectors and cap all openings.
3. Remove the three glow plugs, 2.
4. Disconnect the return line to the fuel tank from the number three injector.
5. Remove the injector assemblies, 3.

**NOTE:** Be sure to remove the injector sealing washer from the injector bore, if not removed with the injector.

## OIL PRESSURE SWITCH

### Removal

1. Disconnect and remove the oil pressure switch, 1.

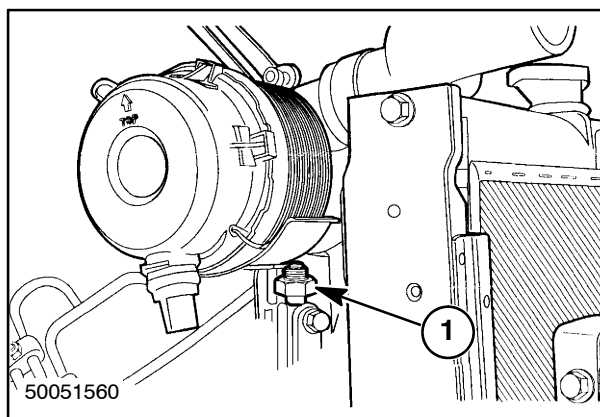

50051560

11



**Suggest:**

**If the above button click is invalid.**

**Please download this document**

**first, and then click the above link**

**to download the complete manual.**

**Thank you so much for reading**

### TEMPERATURE SENDING SWITCH AND ALTERNATOR

#### Removal

1. Remove the temperature sending switch, 1, from the front of the cylinder head.
2. Loosen the alternator mounting bolts, 2, and remove the V-belt, 3, from the drive pulley.
3. Disconnect the wires from the back of the alternator.
4. Remove the alternator mounting bolts and remove the alternator, 4.

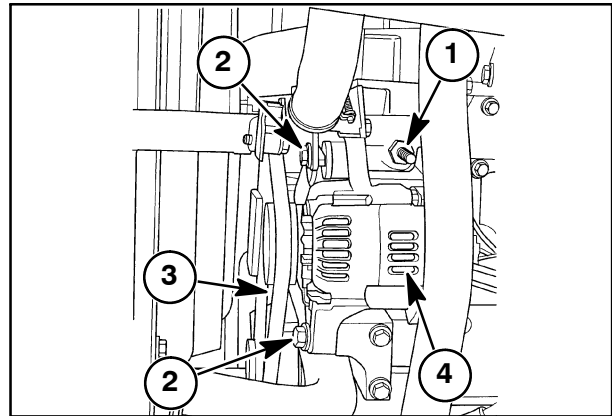

12

### FAN, WATER PUMP, AND EXTERNAL OIL TUBE

#### Removal

1. Remove the fan and water pump assembly. See "Water Pump and Thermostat Removal" discussed later in this section.
2. Remove the external oil transfer tube banjo bolts, 1, from the front of the cylinder head and the side of the cylinder block and remove the external oil transfer tube.

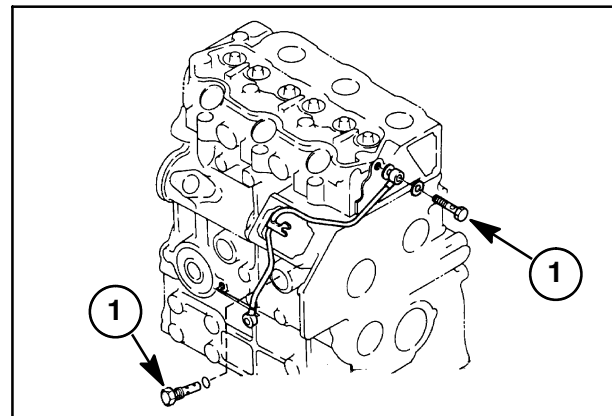

13

### VALVE COVER

#### Removal

1. Remove the valve cover, 1, and gasket.

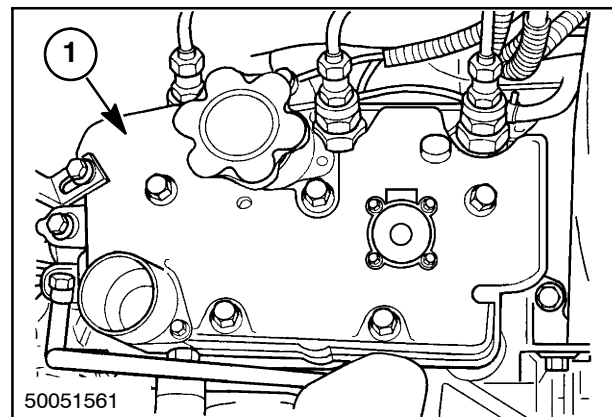

50051561

14

**<https://www.ebooklibonline.com>**

Hello dear friend!

Thank you very much for reading.

Enter the link into your browser.

The full manual is available for immediate download.

**<https://www.ebooklibonline.com>**