TT45A, TT50A REPAIR MANUAL COMPLETE CONTENTS

SECTION 00 - GENERAL	2
SECTION 10 - ENGINE	3
SECTION 18 - CLUTCHES	10
SECTION 21 - TRANSMISSION SYSTEM	11
SECTION 27 - MECHANICAL REAR WHEEL DRIVE	13
SECTION 31 - POWER TAKE-OFF	15
SECTION 33 - BRAKING SYSTEM	16
SECTION 35 - HYDRAULIC SYSTEM	16
SECTION 41 - STEERING SYSTEMS	19
SECTION 44 - FRONT AXLE	20
SECTION 55 - ELECTRICAL SYSTEM	21
SECTION 90 - BODYWORK	27

The following pages are the collation of the contents pages from each section and chapter of the TT45A, TT50A Repair manual. Complete Repair part # 87655297.

The sections used through out all New Holland product Repair manuals may not be used for each product. Each Repair manual will be made up of one or several books. Each book will be labeled as to which sections are in the overall Repair manual and which sections are in each book.

The sections listed above are the sections utilized for the TT45A, TT50A Tractors.

SECTION 00 - GENERAL

Chapter 1 - General

CONTENTS

Section	Description	Page
	Federal Emissions Warranty	2
	California Emission Control Warranty Statement	3
	General Instructions	5
	Important Notice	5
	Shimming	5
	Rotating Shaft Seals	5
	O-Rings	6
	Sealers	6
	Bearings	6
	Spring Pins	6
	Precautionary Notice	7
	Equipment Notice	7
	Spare Parts Notice	7
	General Notices	7
	Health and Safety Precautions	8
	General Workshop Tools and Equipment	13
	Legal Aspects	13
	Lubricants and Greases	13
	Precautionary Statements	17
	Safety	18
	The Tractor	18
	Driving the Tractor	19
	Operating the Tractor	20
	Operating the PTO	21
	Servicing the Tractor	21
	Diesel Fuel	22
	Universal Symbols	23
	Safety Decals	24
	Instructional Decals	28
	Ecology and the Environment	29
	Minimum Hardware Tightening Torques	30
	General Specifications	32
	Lubricants and Coolants	37

GENERAL INSTRUCTIONS

—————  **WARNING**  —————

All maintenance and repair work described in this manual must be performed exclusively by NEW HOLLAND service technicians in strict accordance with the instructions given and using any specific tools necessary.

—————  **WARNING**  —————

Anyone who performs the operations described herein without strictly following the instructions is personally responsible for resulting injury or damage to property.

—————  **WARNING**  —————

The Manufacturer and all organizations belonging to the Manufacturer's distribution network, including but not restricted to national, regional or local distributors, will accept no responsibility for personal injury or damage to property caused by abnormal function of parts and/or components not approved by the Manufacturer, including those used for maintenance and/or repair of the product manufactured or marketed by the Manufacturer. In any case, the product manufactured or marketed by the Manufacturer is covered by no guarantee of any kind against personal injury or damage to property caused by abnormal function of parts and/or components not approved by the Manufacturer.

IMPORTANT NOTICE

All maintenance and repair operations described in this manual should be carried out exclusively by the authorized workshops. All instructions detailed should be carefully observed and special equipment indicated should be used if necessary.

Everyone who carries out service operations described without carefully observing these prescriptions will be directly responsible of deriving damages.

SHIMMING

At each adjustment, select adjusting shims, measure them individually using a micrometer and then sum up recorded values. Do not rely on measuring the whole shimming set, which may be incorrect, or on the rated value indicated for each shim.

ROTATING SHAFT SEALS

To correctly install rotating shaft seals, observe the following instructions:

- Let the seal soak into the same oil as it will seal for at least half an hour before mounting;
- Thoroughly clean the shaft and ensure that the shaft working surface is not damaged;
- Place the sealing lip towards the fluid. In case of a hydrodynamic lip, consider the shaft rotation direction and orient grooves in order that they deviate the fluid towards the inner side of the seal;
- Coat the sealing lip with a thin layer of lubricant (oil rather than grease) and fill the gap between the sealing lip and the dust lip of double lip seals with grease;
- Insert the seal into its seat and press it down using a flat punch. Do not tap the seal with a hammer or a drift;
- Take care to insert the seal perpendicularly to its seat while you are pressing it. Once the seal is settled, ensure that it contacts the thrust element, if required;
- To prevent damaging the sealing lip against the shaft, place a suitable protection during installation.

<https://www.ebooklibonline.com>

Hello dear friend!

Thank you very much for reading.

Enter the link into your browser.

The full manual is available for immediate download.

<https://www.ebooklibonline.com>

O RINGS

Lubricate the O rings before inserting them into their seats. This will prevent the O rings from roll over and twisting during mounting, which will jeopardize sealing.

SEALERS

Apply silicone/gasket eliminator over the mating surfaces marked with an X.

Before applying the sealer, prepare the surface as follows:

- Remove possible scales using a metal brush;
- Thoroughly degrease the surfaces using one of the following cleaning agents: trichlorethylene, diesel fuel or a water and soda solution.

BEARINGS

It is advisable to heat the bearings to 80° to 90°C (176° to 194°F) before mounting them on their shafts and cool them down before inserting them into their seats with external tapping.

SPRING PINS

When mounting split socket spring pins, ensure that the pin notch is oriented in the direction of the effort to stress the pin.

Spiral spring pins should not be oriented during installation.

SAFETY

⚠ PRECAUTIONARY STATEMENTS ⚠

A careful operator is the best operator. Most accidents can be avoided by observing certain precautions. To help prevent accidents, read and take the following precautions **before** driving, operating or servicing the tractor. Equipment should be operated only by those who are responsible and instructed to do so.

THE TRACTOR

1. Read this Operator's Manual carefully before using the tractor. Lack of operating knowledge can lead to accidents.
2. Only allow properly trained and qualified persons to operate the tractor.
3. To prevent falls, use the handrails and step plates when getting on and off the tractor. Keep steps and platform clear of mud and debris.
4. Replace all missing, illegible or damaged safety decals.
5. Keep safety decals free of dirt or grime.
6. Do not permit anyone but the operator to ride on the tractor. It is unsafe for extra passengers to travel.
7. Keep children away from the tractor and farm machinery at all times.
8. Do not modify or alter or permit anyone else to modify or alter the tractor or any of its components or any tractor function without first consulting your dealer.
9. Install all guards before starting the engine or operating the tractor.
10. Tractor wheels are very heavy. They need to be handled with care. Ensure that they are stored at a place where they do not fall down & cause injury.



DRIVING THE TRACTOR

1. Always sit in the driver's seat while starting or driving the tractor.
2. When driving on public roads, have consideration for other road users. Pull in to the left side of the road occasionally to allow any following traffic to pass. Do not exceed the legal speed limit set for agricultural tractors.
3. Dip the tractor lights when meeting a vehicle at night. Make sure the lights are adjusted to prevent blinding the driver of an oncoming vehicle.
4. Reduce speed before turning or applying the brakes. Brake both wheels simultaneously when making an emergency stop. Ensure that both brake pedals are locked together when travelling at road speeds or when on public roads ensure correct operation of trailer brakes.



5. Use extreme caution and avoid hard application of the tractor brakes when towing heavy loads at road speeds.
6. Keep the tractor in the same gear when going downhill as would be used when going uphill. Do not coast or freewheel down hills.

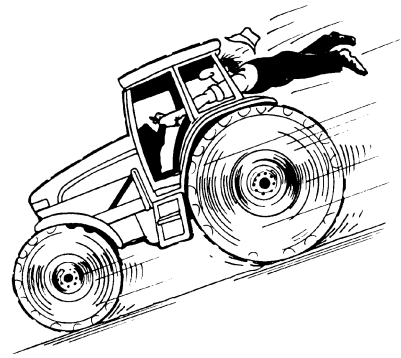

7. Any towed vehicle whose total weight exceeds that of the towing tractor must be equipped with brakes for safe operation.
8. Never try to apply the differential lock when turning. When engaged, the differential lock will prevent the tractor from turning.
9. Always check overhead clearance, especially when transporting the tractor. Watch where you are going, especially at row ends, on roads and around trees and low overhanging obstacles.
10. To avoid overturns, drive the tractor with care and at speeds compatible with safety, especially when operating over rough ground, when crossing ditches or slopes and when turning corners.

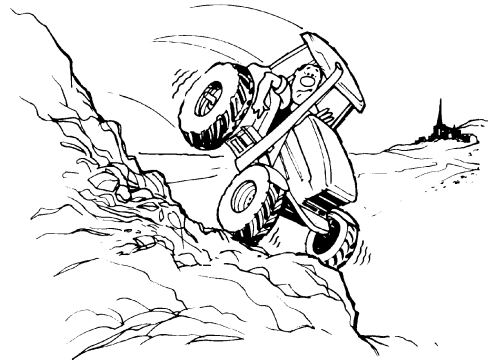

11. Use extreme caution when operating on steep slopes.
12. If the tractor becomes stuck or the tires are frozen to the ground, reverse the tractor out to prevent overturning.

SECTION 10 - ENGINE

Chapter 1 - Engine

CONTENTS

Section	Description	Page
	Specifications	6
	Metric Bolt Torque Specifications	15
	Special Tools	16
	Compression Test and Tools	17
	Description of Operation	18
	Troubleshooting	19
	Cylinder Head and Valve Train Components	23
	Cylinder Block Assembly	23
	Separating the Tractor at the Clutch Housing/Engine - 8 x 12 Transmission	25
	Disassembly	25
	Separating the Tractor at the Engine/Frame	28
	Removal	28
	Installation	29
	Attaching the Tractor at the Clutch Housing/Engine - 8 x 12 Transmission	30
	Assembly	30
	Overhaul	34
	Engine	34
	Fuel Injector and Glow Plug	34
	Removal	34
	Oil Pressure Switch	34
	Temperature Sending Switch and Alternator	34
	Removal	34
	Fan, Water Pump and External Oil Tube	35
	Removal	35
	Air Inlet Manifold	35
	Removal	35
	Rocker Arm Shaft and Support Bracket	36
	Removal	36
10 101	Cylinder Head	36
	Removal	36
	Valve Tappet	37
	Removal	37
	Fuel Shutoff Solenoid	37
	Removal	37

SECTION 10 - ENGINE - CHAPTER 1

Section	Description	Page
10 106	Engine Timing Gear Cover, Timing Gears, and Cam Shaft	37
	Timing Gear Cover Removal	37
10 106	Timing Gears and Cam Shaft	40
	Removal	40
10 102	Oil Sump	41
	Removal	41
	Oil Suction Pipe and Strainer	41
	Removal	41
10 110	Balancer Assembly	42
	Removal	42
10 105	Connecting Rods, Bearings, and Pistons, Rings	42
	Removal	42
10 103	Flywheel	43
	Removal	43
10 103	Backplate and Oil Seal	43
	Removal	43
	Crankshaft - Main Bearings	43
	Removal	43
10 101	Cylinder Head	44
	Disassembly	44
	Inspection and Repair	44
	Valve Seats	45
	Valves	46
	Valve Guides	47
	Valve Springs	48
	Rocker Arms	48
	Push Rods	49
	Cylinder Head	49
	Assembly	49
	Cylinder Block	50
	Pistons	50
	Disassembly and Inspection	50
	Piston Rings	53
	Connecting Rods	53
	Connecting Rod Bearing	55
	Clearance Check	55

SECTION 10 - ENGINE - CHAPTER 1

Section	Description	Page
	Pistons, Rings, and Connecting Rod	56
	Assembly	56
10 103	Crankshaft - Main Bearing and Thrust Washer	57
	Removal and Inspection	57
	Crankshaft	58
	Bearing (Bushing)	59
	Replacement	59
	Main Bearing	60
	Assembly	60
	Port Block	61
	Removal	61
	Installation	61
10 106	Timing Gear	62
	Camshaft	62
	Disassembly	62
	Inspection	62
	Assembly	63
10 103	Flywheel	63
10 102	Timing Gear Housing	64
10 102	Front Oil Seal and Steering Pump Seal	64
	Replacement	64
10 103	Crankshaft and Bearing Holder	65
	Installation	65
	Rear Oil Seal and Backplate	65
	Installation	65
	Flywheel	66
	Installation	66
10 105	Pistons and Connecting Rods	66
	Installation	66
10 110	Balancer Assembly	67
	Installation	67
	Balancer Shims	67
	Oil Suction Pipe and Suction Strainer	68
	Installation	68
	Oil Sump	68
	Installation	68
10 106	Camshaft and Camshaft Gear	68
	Installation	68

SECTION 10 - ENGINE - CHAPTER 1

Section	Description	Page
10 106	Idler Gear, Oil Pump, and Injection Timing	69
	Installation	69
	Timing Gear Cover	69
	Installation	69
	Crankshaft Pulley	70
	Installation	70
	Fuel Injection Pump	70
	Installation	70
	Hydraulic Oil Pump	71
	Installation	71
	Power Steering Pump	71
	Installation	71
10 101	Head Gasket Selection	72
	Selection Chart	72
	Cylinder Head	72
	Installation	72
10 106	Valve Clearance	73
	Adjustment	73
	Valve Cover	74
	Installation	74
	Water Pump and Cooling Fan	74
	Installation	74
	External Oil Tube	74
	Assembly	74
	Glow Plug and Connector	75
	Installation	75
	Fuel Injector	75
	Installation	75
10 218	Fuel Piping	75
	Installation	75
	Alternator and Temperature Sender Switch	76
	Installation	76
	Exhaust Manifold	76
	Installation	76
10 304	Description of Operation - Engine Lubrication System	77
10 206	Oil Filter	80
	Construction and Function	80
	Maintenance	80

SECTION 10 - ENGINE - CHAPTER 1

Section	Description	Page
10 304	Oil Pump	80
	Removal	80
	Inspection	80
	Installation and Adjustment	81
	Engine Oil Pressure	82
	Check	82
	Oil Pressure Relief Valve	83
	Removal	83
	Installation	83
	Oil Consumption	83
10 400	Description of Operation - Cooling System	84
	Maintenance	86
	Coolant	86
	Radiator Cap	86
10 402	Thermostat	87
10 402	Water Pump	87
10 414	Cooling Fan	87
	Overhaul - Cooling System	88
10 406	Radiator	88
	Removal	88
	Inspection and Repair	89
	Installation	89
10 402	Water Pump	90
	Removal	90
	Inspection and Repair	92
	Installation	92
10 402	Thermostat	93
	Removal	93
	Inspection and Repair	93
	Installation	94

SPECIFICATIONS

GENERAL	TT45A	TT50A
Engine Model	N844	N844L
Number of Cylinders	4	4
Bore x Stroke	84 x 90 mm (3.31 x 3.54 in)	84 x 100 mm (3.31 x 3.94 in)
Displacement	1995 cc (121.7 cu. in.)	2216 cc (135.2 cu. in.)
Compression Ratio	22.5:1	22.4:1
Rated Speed (rpm)	2600	2800
Gross Engine Horsepower	29.8 kw (40 Hp)	33.5 kw (45 Hp)
PTO Horsepower at 2250 Engine and 766 PTO rpm	26.1 kw (35.0 Hp)	31.3 kw (42.2 Hp)
Firing Order	1-3-4-2	1-3-4-2
Low Idle Speed	1050 rpm	1050 rpm
Maximum No-Load Speed	2855 rpm	3000 rpm
Cylinder Arrangement	In-Line Vertical	In-Line Vertical
Valve Arrangement	Overhead	Overhead
Compression Pressure at 200 rpm (cylinder speed)	29.4 ± 1.8 bar (427 ± 50 psi)	29.4 ± 1.8 bar (427 ± 50 psi)
Variation between cylinders	1.8 bar (50 psi)	1.8 bar (50 psi)
CYLINDER BLOCK	N844	N844L
Bore		
Standard	84.0 mm (3.3071 - 3.3078 in)	84.0 mm (3.3071 - 3.3078 in)
Maximum	85.2 mm (3.3543 in)	85.2 mm (3.3543 in)
Head Surface Warp		
Standard	0.002 in. (0.05 mm)	0.05 mm (0.002 in)
Maximum	0.12 mm (0.005 in)	0.12 mm (0.005 in)

* If bore size exceeds 85.2 mm (3.3543 in) replace with long block.

SECTION 10 - ENGINE - CHAPTER 1

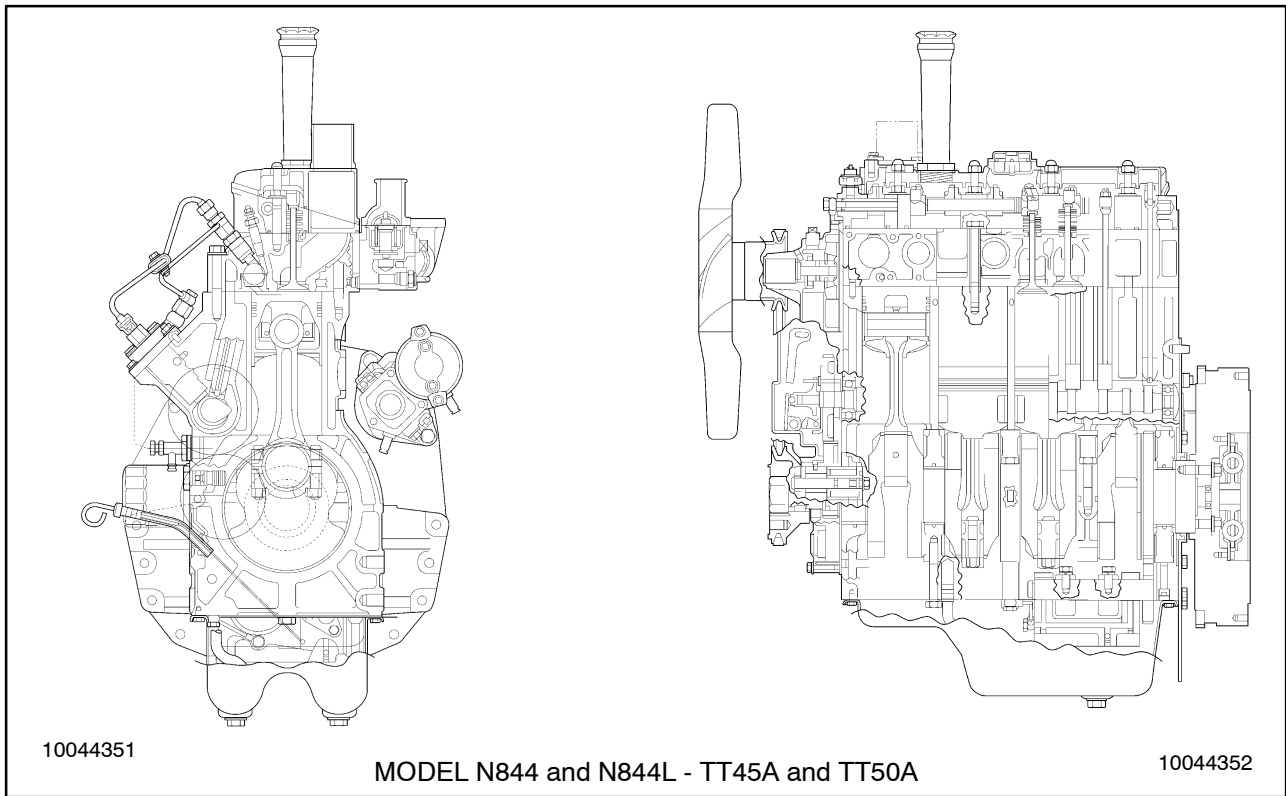

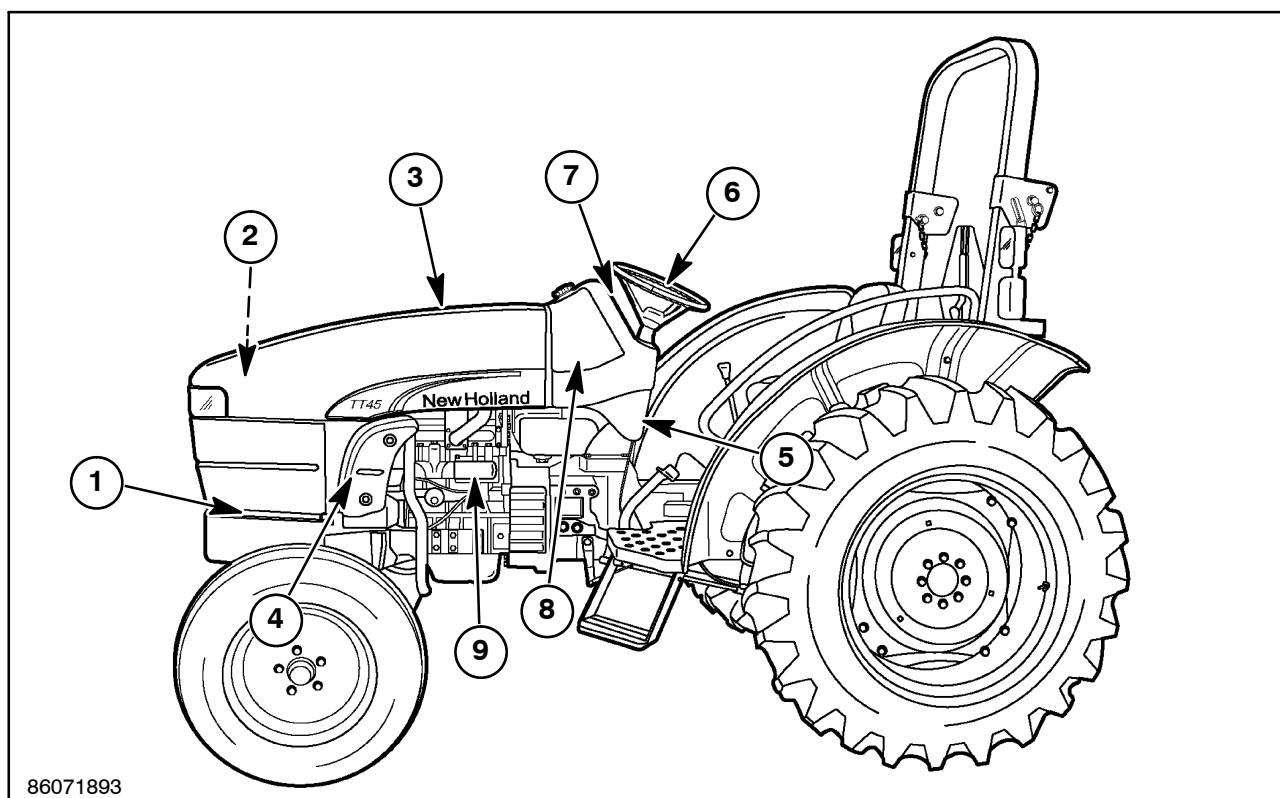

86071893

5

SEPARATING THE TRACTOR AT THE CLUTCH HOUSING/ENGINE – 8 x 2 TRANSMISSION

Disassembly

1. Disconnect the negative (-) battery cable, and the positive (+) battery cable from the battery, 1.
2. Disconnect the headlight wiring harness, 2, and remove the hood, 3.
3. If equipped, remove the remote loader control valve, and all the connecting hydraulic tubes from the right side loader tower.
4. Remove the LH and RH engine side covers, 4.
5. Remove the LH, RH and center rear hood panels, 5.
6. Remove the steering wheel, 6.
7. Remove the instrument panel, 7, from the dash housing. Disconnect all electrical connectors from the instrument panel.
8. Remove the dash housing, 8, from the firewall. Disconnect all electrical connectors from the dash housing.
9. Disconnect electrical harness to the starter, 9.

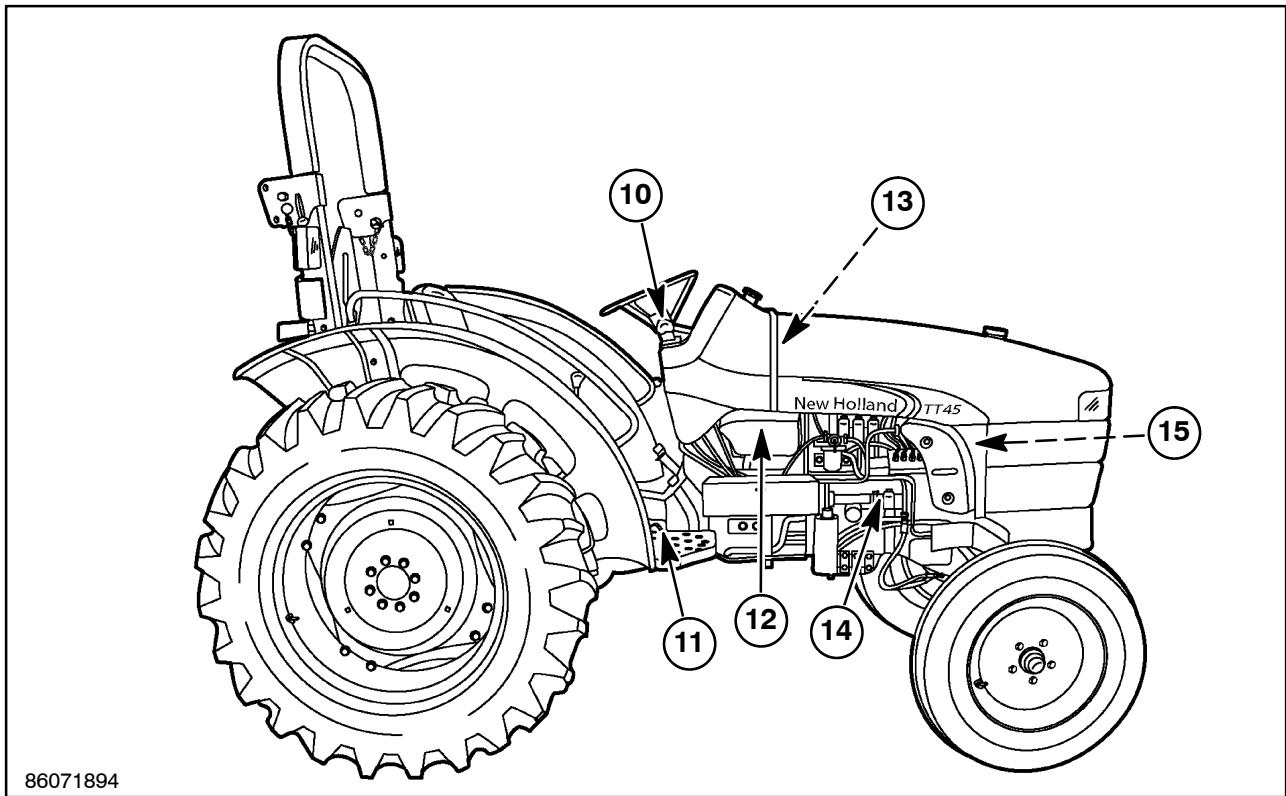

6

10. Disconnect and remove the throttle cable from the dash mounted throttle control lever, 10.
11. Disconnect and remove the throttle cable from the foot control pedal, 11.
12. Drain fuel from fuel tank, 12, into a suitable container. Remove fuel tank from firewall.

13. Remove the firewall, 13, from the tractor.
14. Disconnect all hydraulic tubes 14, to the hydraulic pump, 15.

SECTION 10 - ENGINE - CHAPTER 1

15. Attach a chain sling to the two hoist eyes, 1.
16. Attach a suitable hoist to the chain sling.

NOTE: The hoist is used for supporting the engine and axle assembly, not necessarily for lifting.

17. Roll a floor jack under the rear of the tractor, and place under the clutch housing. Raise the jack enough to support the drive train.

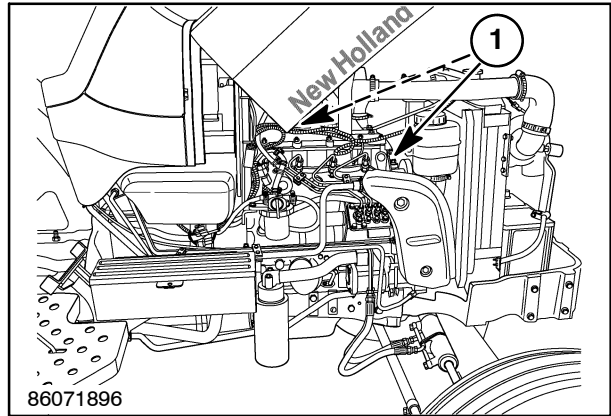

7

18. Remove the buckle-up bolts, 1, and starter, 2, that secure the engine, 3, to the clutch housing, 4.

NOTE: The hoist and/or floor jack may need to be raised or lowered to allow for separation of the engine and clutch housing.

19. Carefully roll the drive train away from the engine, using the floor jack for support.

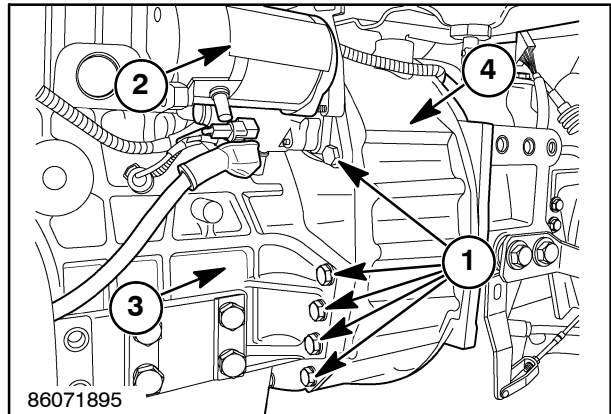

8



Suggest:

If the above button click is invalid.

Please download this document

first, and then click the above link

to download the complete manual.

Thank you so much for reading

SEPARATING THE TRACTOR AT THE ENGINE/FRAME

Removal

1. Use jack stands under the frame rails to support the front frame/engine assembly.



Make sure the front frame/engine assembly is securely supported before removing the engine.

2. Remove the chain sling from the two hoist eyes on the engine.
3. Drain the hydraulic fluid from the power steering reservoir, 1, into a suitable container. Remove the reservoir, 1, and mounting bracket from the engine.

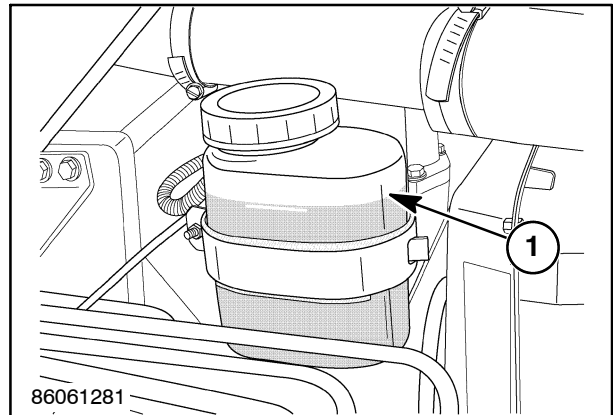

9

4. Remove the air cleaner assembly, 1, from the tractor.
5. Remove the muffler and tailpipe assembly, 2, from engine.
6. Loosen the lower radiator hose, 3, and drain the coolant into a suitable container.
7. Remove the lower, 3, and upper, 4, radiator hoses.
8. Remove the radiator, 5, from the tractor.

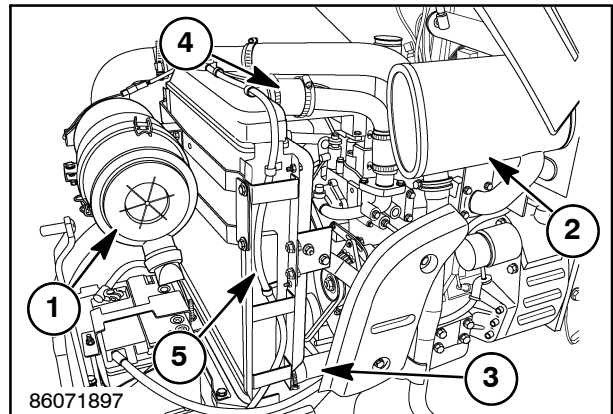

10

<https://www.ebooklibonline.com>

Hello dear friend!

Thank you very much for reading.

Enter the link into your browser.

The full manual is available for immediate download.

<https://www.ebooklibonline.com>