

## SERVICE MANUAL

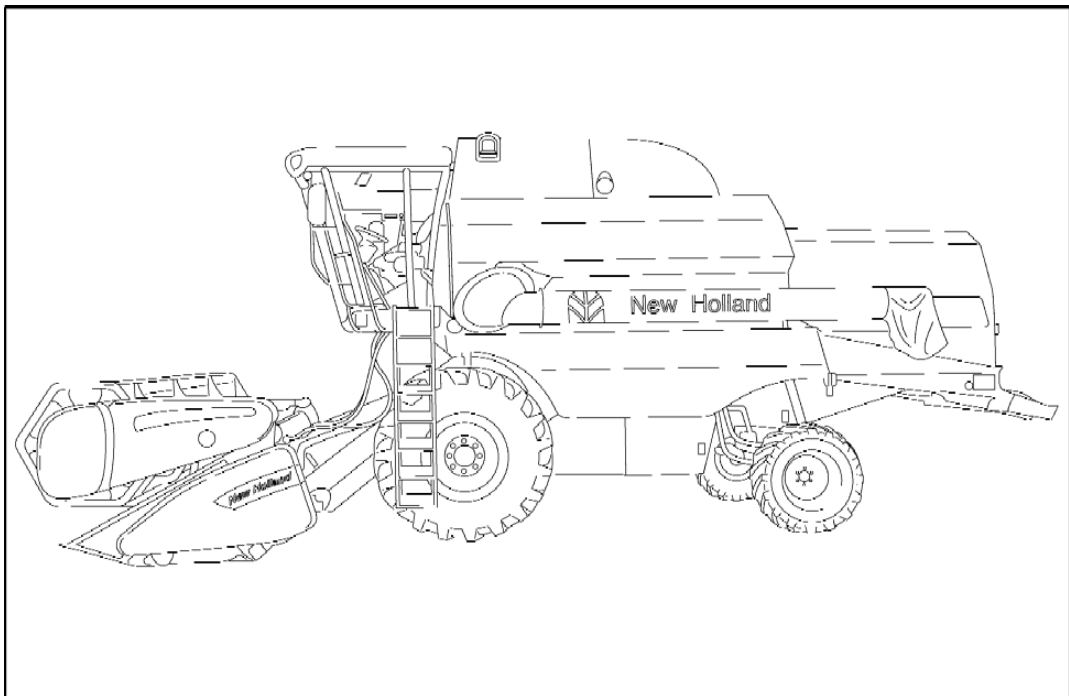

**TC5040 [9622 - ] , TC5050 [9622 - ] , TC5060 [9622 - ] , TC5070 [9622 - ] ,  
TC5070 , TC5080 Hillside , TC5080 [9622 - ] , TC5080**

# Contents

---

## INTRODUCTION

Engine.....	10
Engine air compressor .....	10.450
Clutch .....	18
Clutch hydraulic release control .....	18.104
Clutch and components .....	18.110
Transmission.....	21
Mechanical transmission .....	21.114
Mechanical transmission external controls .....	21.130
Gearbox .....	21.120
Gearbox internal components .....	21.145
Differential .....	21.182
Front axle system .....	25
Final drives .....	25.310
Rear axle system.....	27
Planetary and final drives.....	27.120
Hydrostatic drive.....	29
Transmission and steering hydrostatic control .....	29.100
Reservoir, cooler, and lines.....	29.204
Pump and motor components .....	29.218
Hydrostatic transmission .....	29.202
Rear hydrostatic transmission .....	29.300
Brakes and controls .....	33
Hydraulic service brakes .....	33.202
Parking brake.....	33.110
Hydraulic systems.....	35

Hydraulic systems .....	35.000
Reservoir, cooler, and filters .....	35.300
Variable displacement pump .....	35.106
Main control valve .....	35.359
Remote control valves .....	35.204
Machine leveling control system .....	35.610
Machine lateral leveling system .....	35.630
Machine longitudinal leveling system.....	35.640
Header/Attachment leveling system.....	35.602
Reel control system .....	35.518
<b>Steering.....</b>	<b>41</b>
Hydraulic control components .....	41.200
Pump .....	41.206
Cylinders .....	41.216
<b>Cab climate control .....</b>	<b>50</b>
Air conditioning .....	50.200
<b>Electrical systems .....</b>	<b>55</b>
Electrical system .....	55.000
Harnesses and connectors .....	55.100
Selective Catalytic Reduction (SCR) electrical system.....	55.988
Electronic modules .....	55.640
Cab Heating, Ventilation, and Air-Conditioning (HVAC) controls.....	55.051
Heating, Ventilation, and Air-Conditioning (HVAC) control system.....	55.050
Sieve electric control .....	55.834
Precision farming system.....	55.785
FAULT CODES .....	55.DTC
<b>Attachments/Headers.....</b>	<b>58</b>
Attachment/Header reel .....	58.101
Belt feeding.....	58.900

**<https://www.ebooklibonline.com>**

Hello dear friend!

Thank you very much for reading.

Enter the link into your browser.

The full manual is available for immediate download.

**<https://www.ebooklibonline.com>**

<b>Product feeding</b> .....	<b>60</b>
Feed roll .....	60.101
Floating roll, feed chain, and drive .....	60.105
Feeder drive system .....	60.150
Length-of-cut gearbox .....	60.122
<b>Threshing</b> .....	<b>66</b>
Threshing .....	66.000
Drum .....	66.330
Drum/Rotor variator with electrical control .....	66.321
Concave .....	66.105
<b>Separation</b> .....	<b>72</b>
Beater .....	72.350
Straw walkers and shafts .....	72.101
<b>Residue handling</b> .....	<b>73</b>
Straw chopper drive system .....	73.210
Straw chopper electromagnetic clutch support .....	73.215
<b>Cleaning</b> .....	<b>74</b>
Cleaning .....	74.000
Cleaning drive systems .....	74.101
Grain pan .....	74.110
Upper shaker shoe .....	74.114
Lower shaker shoe .....	74.118
Fan housing .....	74.130
Fan drive system .....	74.136
Tailings return system .....	74.140
<b>Crop storage / Unloading</b> .....	<b>80</b>
Clean grain elevator .....	80.101
<b>Platform, cab, bodywork, and decals</b> .....	<b>90</b>

Cab doors and hatches..... 90.154



# INTRODUCTION

## **Foreword**

TC5040, TC5050, TC5060, TC5070, TC5080, TC5070, TC5080, TC5080 Hillside

### **IMPORTANT INFORMATION**

All repair and maintenance works listed in this manual must be carried out only by staff belonging to the NEW HOLLAND Service network, strictly complying with the instructions given and using, whenever required, the special tools.

Anyone who carries out the above operations without complying with the prescriptions shall be responsible for the subsequent damages.

The manufacturer and all the organizations of its distribution chain, including - without limitation - national, regional or local dealers, reject any responsibility for damages due to the anomalous behavior of parts and/or components not approved by the manufacturer himself, including those used for the servicing or repair of the product manufactured or marketed by the Manufacturer. In any case, no warranty is given or attributed on the product manufactured or marketed by the Manufacturer in case of damages due to an anomalous behavior of parts and/or components not approved by the Manufacturer.

No reproduction, though partial of text and illustrations allowed

---

## Basic instructions - How To Use and Navigate Through This Manual

### Technical Information

This manual has been produced by a new technical information system. This new system is designed to deliver technical information electronically through Web delivery (eTim), DVD and in paper manuals. A coding system called SAP has been developed to link the technical information to other Product Support functions, e.g., Warranty.

Technical information is written to support the maintenance and service of the functions or systems on a customer's machine. When a customer has a concern on his machine it is usually because a function or system on his machine is not working at all, is not working efficiently, or is not responding correctly to his commands. When you refer to the technical information in this manual to resolve that customer's concern, you will find all the information classified using the SAP coding, according to the functions or systems on that machine. Once you have located the technical information for that function or system then you will find all the mechanical, electrical or hydraulic devices, components, assemblies and sub assemblies for that function or system. You will also find all the types of information that have been written for that function or system, the technical data (specifications), the functional data (how it works), the diagnostic data (fault codes and troubleshooting) and the service data (remove, install adjust, etc.).

By integrating SAP coding into technical information, you will be able to search and retrieve just the right piece of technical information you need to resolve that customer's concern on his machine. This is made possible by attaching 3 categories to each piece of technical information during the authoring process.

The first category is the Location, the second category is the Information Type and the third category is the Product:

- LOCATION - is the component or function on the machine, that the piece of technical information is going to describe e.g. Fuel tank.
- INFORMATION TYPE - is the piece of technical information that has been written for a particular component or function on the machine e.g. Capacity would be a type of Technical Data that would describe the amount of fuel held by the Fuel tank.
- PRODUCT - is the model for which the piece of technical information is written.

Every piece of technical information will have those 3 categories attached to it. You will be able to use any combination of those categories to find the right piece of technical information you need to resolve that customer's concern on his machine.

That information could be:

- the description of how to remove the cylinder head
- a table of specifications for a hydraulic pump
- a fault code
- a troubleshooting table
- a special tool

## How to Use this Manual

This manual is divided into Sections. Each Section is then divided into Chapters. Contents pages are included at the beginning of the manual, then inside every Section and inside every Chapter. An alphabetical Index is included at the end of a Chapter. Page number references are included for every piece of technical information listed in the Chapter Contents or Chapter Index.

Each Chapter is divided into four Information types:

- Technical Data (specifications) for all the mechanical, electrical or hydraulic devices, components and assemblies.
- Functional Data (how it works) for all the mechanical, electrical or hydraulic devices, components and assemblies.
- Diagnostic Data (fault codes, electrical and hydraulic troubleshooting) for all the mechanical, electrical or hydraulic devices, components and assemblies.
- Service Data (remove disassembly, assemble, install) for all the mechanical, electrical or hydraulic devices, components and assemblies.

## Sections

Sections are grouped according to the main functions or a systems on the machine. Each Section is identified by a number 00, 35, 55, etc. The amount of Sections included in the manual will depend on the type and function of the machine that the manual is written for. Each Section has a Contents page listed in alphabetic/numeric order. This table illustrates which Sections could be included in a manual for a particular product.

SECTION	PRODUCT				
	Tractors				
	Vehicles with working arms: backhoes, excavators, skid steers, ....				
	Combines, forage harvesters, balers, ....				
	Seeding, planting, floating, spraying equipment, ....				
	Mounted equipment and tools, ....				
00 - Maintenance	X	X	X	X	X
05 - Machine completion and equipment					
10 - Engine	X	X	X	X	
14 - Main gearbox and drive					
18 - Clutch	X				
21 - Transmission	X	X	X	X	
23 - Four wheel drive system	X		X	X	
25 - Front axle system	X		X		
27 - Rear axle system	X	X	X	X	
29 - Hydrostatic drive	X				
31 - Implement power take-off					
33 - Brakes and controls					
35 - Hydraulic systems					
36 - Pneumatic system					
37 - Hitches, drawbars and implement couplings					
39 - Frames and ballasting					
41 - Steering					
44 - Wheels					
46 - Steering clutches					
48 - Tracks and track suspension					
50 - Cab climate control					
55 - Electrical systems					
56 - Grape harvester shaking					
58 - Attachments/headers					
60 - Product feeding					

## INTRODUCTION

61 - Metering system						
62 - Pressing - Bale formation						
63 - Chemical applicators						
64 - Chopping						
66 - Threshing						
68 - Tying/Wrapping/Twisting						
69 - Bale wagons						
70 - Ejection						
71 - Lubrication system						
72 - Separation						
73 - Residue handling						
74 - Cleaning						
75 - Soil preparation/Finishing						
76 - Secondary cleaning / Destemmer						
77 - Seeding						
78 - Spraying						
79 - Planting						
80 - Crop storage / Unloading						
82 - Front loader and bucket						
83 - Telescopic single arm						
84 - Booms, dippers and buckets						
86 - Dozer blade and arm						
88 - Accessories						
89 - Tools						
90 - Platform, cab, bodywork and decals						

# SERVICE MANUAL

## Engine

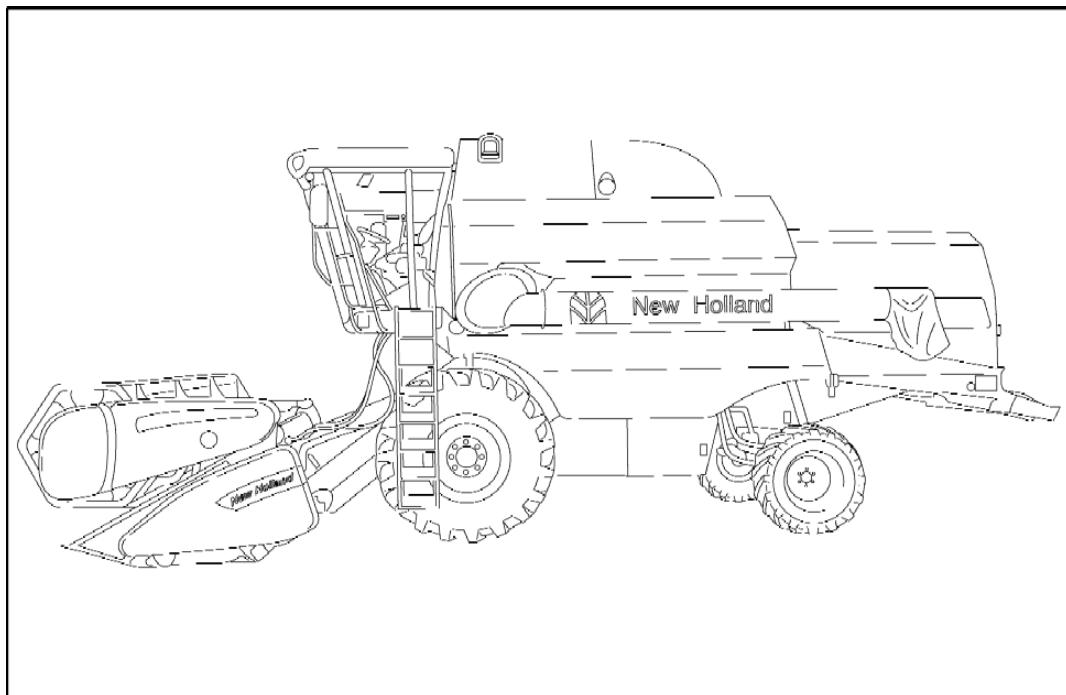

**TC5040 [9622 - ] , TC5050 [9622 - ] , TC5060 [9622 - ] , TC5070 [9622 - ] ,  
TC5070 , TC5080 Hillside , TC5080 [9622 - ] , TC5080**

---

## Air compressor - Static description

TC5070, TC5080, TC5070, TC5080, TC5080 Hillside

The air compressor **(3)** is a single cylinder, gear driven air compressor, which supplies air to a reservoir tank, enabling the operator to have a source of compressed air for cleaning purposes and tyre inflation. The compressor is mounted directly on the engine with the two nuts **(10)**.

Engine oil is supplied through an internal connection with the engine, using engine oil pressure to lubricate the compressor.

The compressed air is delivered through tubing to a combination pressure relief control valve, and from there to the reservoir tank located on the straw hood of the combine. A quick disconnect fitting allows easy connection to the air supply for blow off nozzles as well as for tyre inflation equipment.

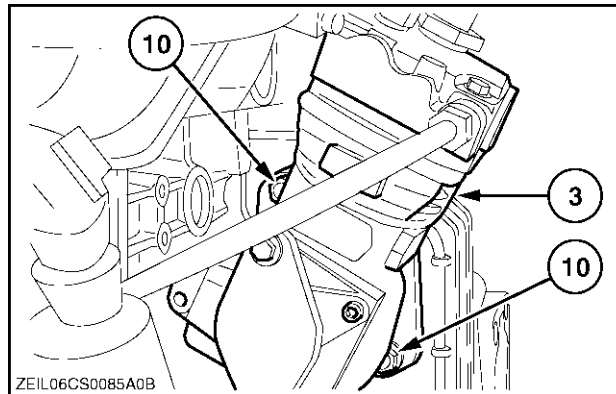

ZEIL06CS0085A0B 1

## Air compressor - Drawing

TC5070, TC5080, TC5070, TC5080, TC5080 Hillside

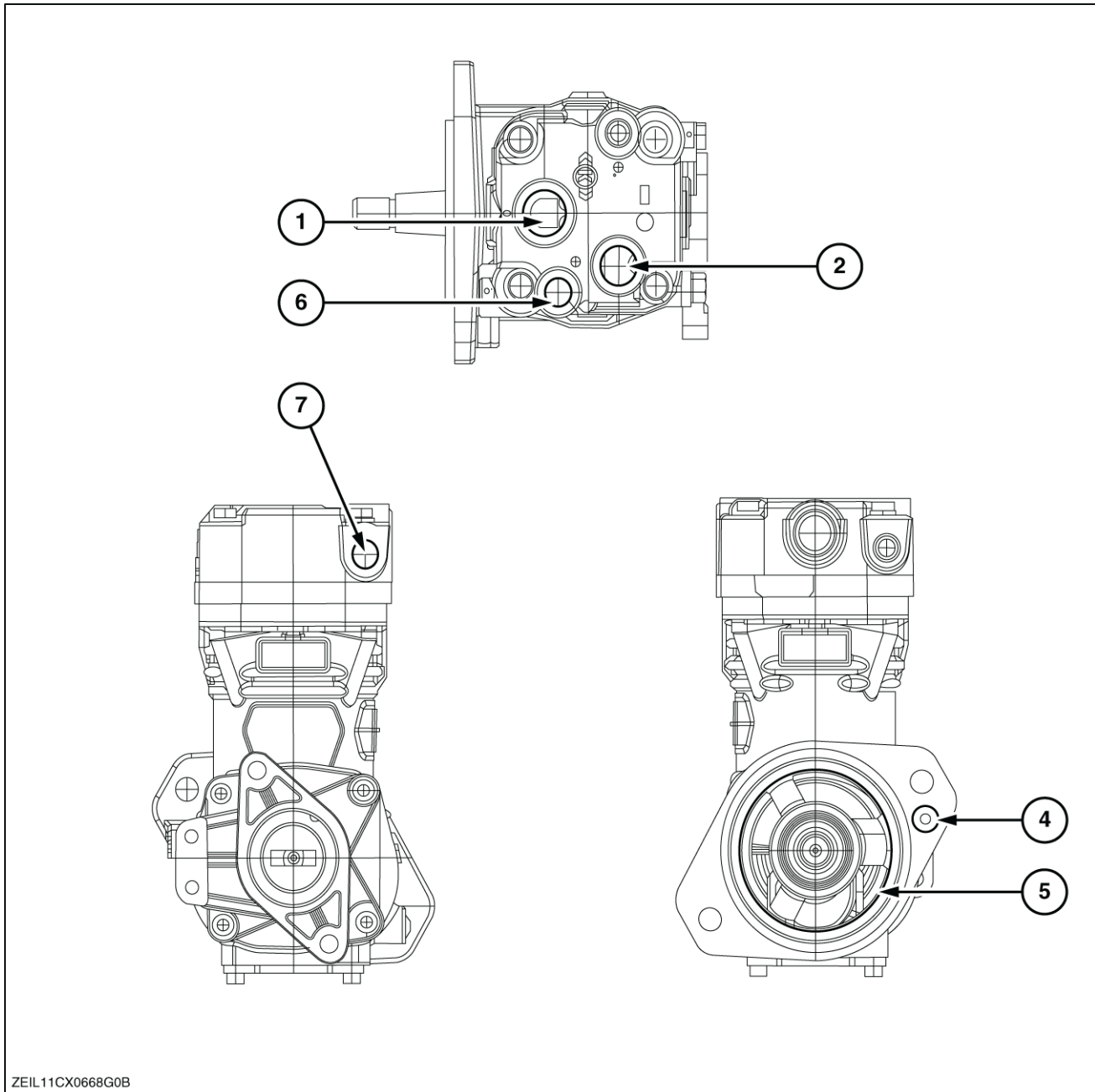

ZEIL11CX0668G0B

ZEIL11CX0668G0B 1

Reference	Port	Port Name	Port Function
1	0	Inlet Port	Supplies Compressor with clean intake air
2	2	Discharge Port	Expels pressurized air for system
4	8.1	Oil Supply	Supplies compressor with lube oil from engine
5	8.2	Oil Drain	Allows lube oil to return to engine
6	9.1	Coolant	Receive coolant from engine
7	9.2	Coolant	Return coolant to engine

## Compressed air tank Relief valve - Drawing

TC5070, TC5080, TC5070, TC5080 Hillside

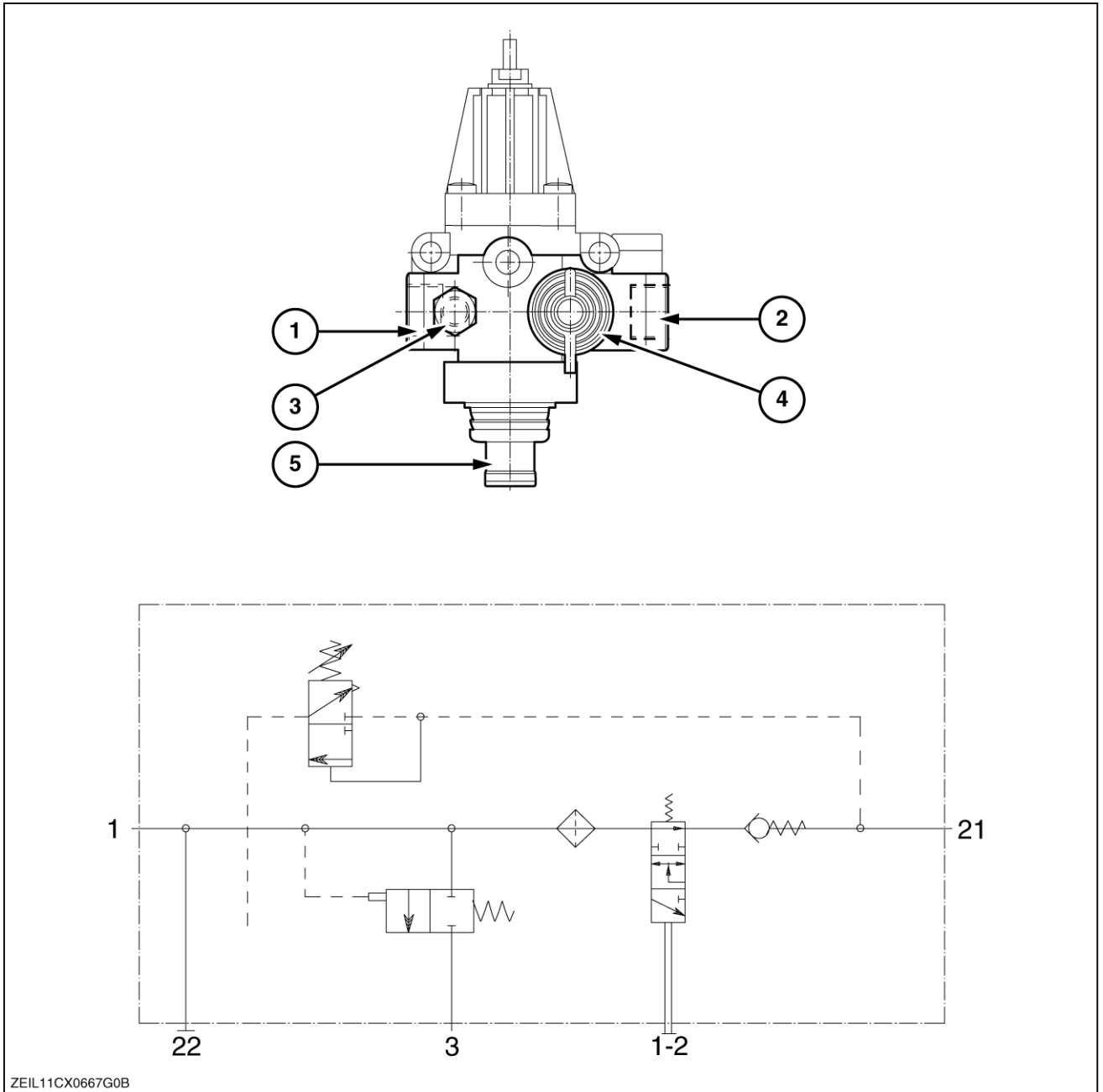

ZEIL11CX0667G0B 1

Reference	Port	Port name	Port function
1	1	Inlet	Pressurized air "in" from compressor
2	21	Outlet	Pressurized air "out" to reservoir tank and blow off line quick connect port
3	22	Auxiliary supply	Auxiliary port not used in this application
4	1-2	Tire inflation device	Port used to connect tire inflation device
5	3	Exhaust for compressor idling	Discharge exhaust for excess pressure in system

## Compressed air tank Relief valve - Static description

TC5070, TC5080, TC5070, TC5080, TC5080 Hillside

The pressure relief valve is developed to protect the system against pressures higher than **8 bar ( 116 psi)**.

Port **(1)** is connected to the air compressor, port **(21)** is connected to the pressurized reservoir.

When the pressure on port **(21)** reaches **8 bar ( 116 psi)**, the control valve **(9d)** will be activated which means that also control valve **(9c)** will be activated. The pressure from the compressor will now pass through port **(3)**.

If the pressure drops below **8 bar ( 116 psi)** by activation a engaging valve, control valve **(9d)** will close.

Valve **(9c)** will not close immediately but will remain in the open position until the pressure exerted on the control of valve **(9c)** will be reduced by **0.6 bar ( 8.7 psi)**. Then the air will pass through valve **(9b)**.

Schematic diagram

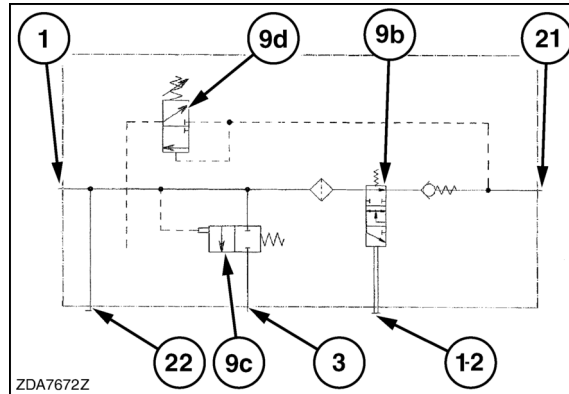

ZDA7672Z 1

## Air compressor - Remove

TC5070, TC5080, TC5070, TC5080, TC5080 Hillside

1. Bleed the air from the system by opening the drain (2) at the bottom of the air reservoir.

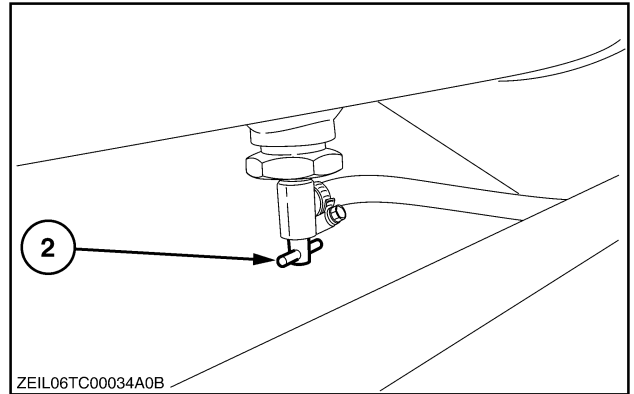

ZEIL06TC00034A0 1

2. Loosen the retaining strap (1) and remove the air inlet pipe (2) from the air compressor (3).

**NOTE:** Protect the air inlet and outlet ports from dirt ingress.

3. Loosen the connection (4) to remove the hose (5) from the air compressor (3).

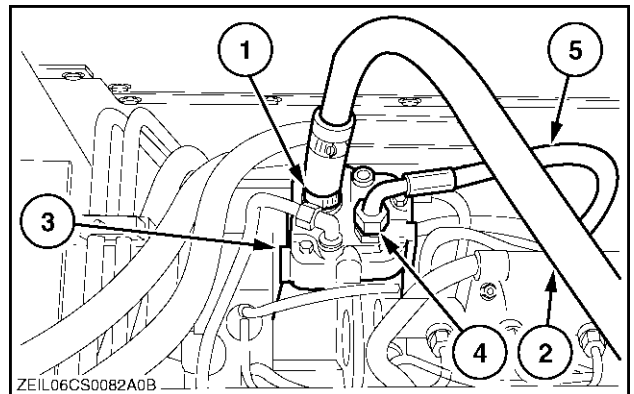

ZEIL06CS0082A0B 2

4. Drain sufficient coolant from the engine cooling system to allow removal of the coolant lines.

**NOTE:** Refer to the Operator's Manual of your machine.

5. Loosen the connection (6).

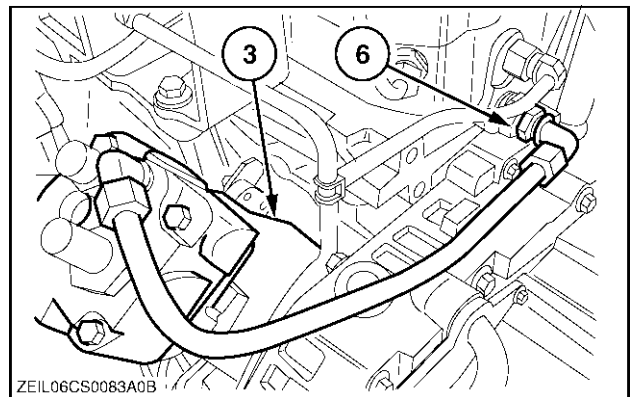

ZEIL06CS0083A0B 3

6. Loosen the connection (7).
7. Remove the four bolts (8) to remove the support (9).

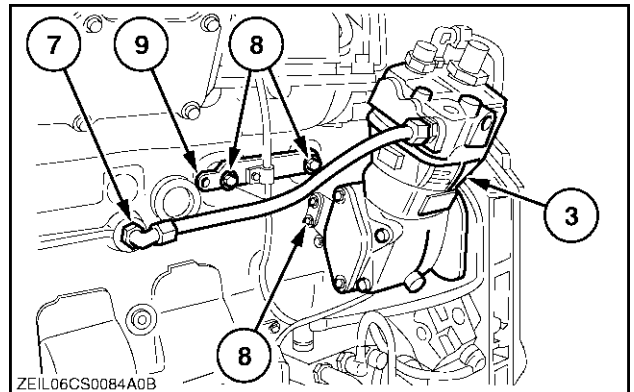

ZEIL06CS0084A0B 4



**Suggest:**

**If the above button click is invalid.**

**Please download this document**

**first, and then click the above link**

**to download the complete manual.**

**Thank you so much for reading**

8. Remove the two nuts **(10)** to remove the air compressor **(3)** from the engine.

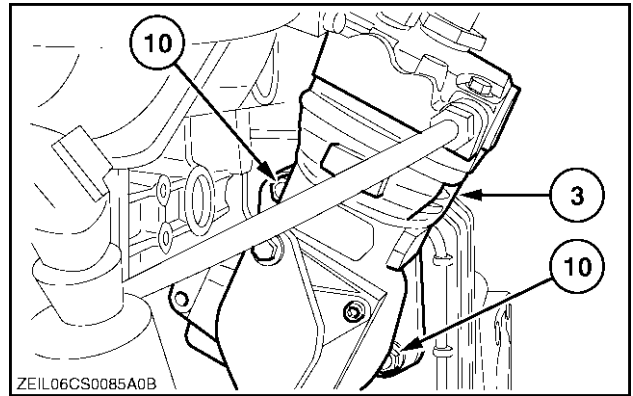

ZEIL06CS0085A0B 5

**<https://www.ebooklibonline.com>**

Hello dear friend!

Thank you very much for reading.

Enter the link into your browser.

The full manual is available for immediate download.

**<https://www.ebooklibonline.com>**