

SERVICE MANUAL

T5.110 Electro Command™

T5.120 Electro Command™

Tier 4B (final)

Tractor

PIN HLRT5120JHLO10006 and above

Part number 51487916

1st edition English
June 2018





SERVICE MANUAL

T5.110 Electro Command™ With 16x16 Semi-Powershift transmission
T5.120 Electro Command™ With 16x16 Semi-Powershift transmission
[HLRT5120JHLO10006 -]

Link Product / Engine

Product	Market Product	Engine
T5.110 Electro Command™ With 16x16 Semi-Powershift transmission	North America	F5GFL413V*C001
T5.120 Electro Command™ With 16x16 Semi-Powershift transmis- sion [HLRT5120JHLO10006 -]	North America	F5GFL413U*C002

<https://www.ebooklibonline.com>

Hello dear friend!

Thank you very much for reading.

Enter the link into your browser.

The full manual is available for immediate download.

<https://www.ebooklibonline.com>

Contents

INTRODUCTION

Engine	10
[10.001] Engine and crankcase	10.1
[10.216] Fuel tanks	10.2
[10.206] Fuel filters	10.3
[10.202] Air cleaners and lines	10.4
[10.254] Intake and exhaust manifolds and muffler	10.5
[10.500] Selective Catalytic Reduction (SCR) exhaust treatment.....	10.6
[10.501] Exhaust Gas Recirculation (EGR) exhaust treatment.....	10.7
[10.400] Engine cooling system	10.8
[10.414] Fan and drive	10.9
[10.310] Aftercooler.....	10.10
[10.218] Fuel injection system.....	10.11
Clutch	18
[18.100] Clutch mechanical release control	18.1
[18.112] Slip clutch or flywheel damper	18.2
Transmission	21
[21.111] Semi-Powershift transmission	21.1
[21.133] Semi-Powershift transmission external controls	21.2
[21.103] Semi-Powershift transmission hydraulic components.....	21.3
[21.152] Semi-Powershift transmission internal components	21.4
[21.160] Creeper	21.5
[21.109] Transmission cooler and lines.....	21.6
Four-Wheel Drive (4WD) system	23
[23.202] Electro-hydraulic control	23.1
[23.314] Drive shaft.....	23.2

Front axle system	25
[25.100] Powered front axle	25.1
[25.102] Front bevel gear set and differential	25.2
[25.108] Final drive hub, steering knuckles, and shafts	25.3
[25.122] Axle suspension control	25.4
Rear axle system.....	27
[27.100] Powered rear axle.....	27.1
[27.106] Rear bevel gear set and differential.....	27.2
[27.120] Planetary and final drives	27.3
Power Take-Off (PTO).....	31
[31.104] Rear electro-hydraulic control.....	31.1
[31.114] Two-speed rear Power Take-Off (PTO)	31.2
[31.116] Three-speed rear Power Take-Off (PTO)	31.3
[31.142] Front Power Take-Off (PTO) control	31.4
[31.146] Front Power Take-Off (PTO)	31.5
Brakes and controls	33
[33.202] Hydraulic service brakes	33.1
[33.110] Parking brake or parking lock	33.2
[33.220] Trailer brake hydraulic control.....	33.3
[33.224] Trailer brake pneumatic control	33.4
[33.204] Front axle brake	33.5
Hydraulic systems.....	35
[35.000] Hydraulic systems.....	35.1
[35.304] Combination pump units	35.2
[35.322] Regulated/Low pressure system	35.3
[35.204] Remote control valves	35.4
[35.100] Main lift system.....	35.5
[35.114] Three-point hitch control valve	35.6

[35.116] Three-point hitch cylinder	35.7
[35.160] Front hitch controls and lines	35.8
[35.162] Front hitch cylinders and lines	35.9
[35.300] Reservoir, cooler, and filters.....	35.10
[35.350] Safety and main relief valves	35.11
Hitches, drawbars, and implement couplings.....	37
[37.100] Drawbars and towing hitches	37.1
[37.110] Rear three-point hitch	37.2
[37.120] Rear three-point hitch linkage.....	37.3
[37.162] Front hitch	37.4
[37.166] Front hitch linkage.....	37.5
Frames and ballasting	39
[39.140] Ballasts and supports	39.1
Steering.....	41
[41.101] Steering control	41.1
[41.106] Tie rods.....	41.2
[41.200] Hydraulic control components.....	41.3
[41.216] Cylinders	41.4
Wheels.....	44
[44.511] Front wheels.....	44.1
[44.520] Rear wheels	44.2
Cab climate control	50
[50.100] Heating	50.1
[50.104] Ventilation	50.2
[50.200] Air conditioning.....	50.3
Electrical systems	55
[55.100] Harnesses and connectors.....	55.1

[55.525] Cab engine controls 55.2

[55.015] Engine control system..... 55.3

[55.201] Engine starting system 55.4

[55.301] Alternator..... 55.5

[55.302] Battery..... 55.6

[55.202] Cold start aid 55.7

[55.011] Fuel tank system 55.8

[55.010] Fuel injection system 55.9

[55.014] Engine intake and exhaust system..... 55.10

[55.988] Selective Catalytic Reduction (SCR) electrical system 55.11

[55.989] Exhaust Gas Recirculation (EGR) electrical system 55.12

[55.012] Engine cooling system 55.13

[55.013] Engine oil system 55.14

[55.640] Electronic modules 55.15

[55.513] Cab transmission controls..... 55.16

[55.024] Transmission control system 55.17

[55.020] Transmission speed sensors..... 55.18

[55.021] Transmission pressure sensors and switches 55.19

[55.022] Transmission temperature sensors 55.20

[55.040] Four-Wheel Drive (4WD) control system..... 55.21

[55.045] Front axle control system 55.22

[55.046] Rear axle control system..... 55.23

[55.522] Cab Power Take-Off (PTO) controls 55.24

[55.048] Rear Power Take-Off (PTO) control system 55.25

[55.049] Front Power Take-Off (PTO) control system 55.26

[55.031] Parking brake electrical system 55.27

[55.032] Trailer brake electrical system 55.28

[55.512] Cab controls..... 55.29

[55.035] Remote control valve electric control 55.30

[55.051] Cab Heating, Ventilation, and Air-Conditioning (HVAC) controls.....	55.31
[55.050] Heating, Ventilation, and Air-Conditioning (HVAC) control system.....	55.32
[55.523] Cab hitch controls	55.33
[55.130] Rear three-point hitch electronic control system	55.34
[55.785] Precision farming system	55.35
[55.911] Satellite navigation systems.....	55.36
[55.680] Autopilot/Autoguidance	55.37
[55.518] Wiper and washer system.....	55.38
[55.404] External lighting	55.39
[55.405] External lighting switches and relays	55.40
[55.408] Warning indicators, alarms, and instruments	55.41
[55.905] ISOBUS components	55.42
[55.DTC] FAULT CODES.....	55.43
Front loader and bucket.....	82
[82.100] Arm.....	82.1
Accessories	88
[88.100] Accessories	88.1
Platform, cab, bodywork, and decals.....	90
[90.150] Cab.....	90.1
[90.151] Cab interior.....	90.2
[90.160] Cab interior trim and panels.....	90.3
[90.154] Cab doors and hatches	90.4
[90.156] Cab windshield and windows	90.5
[90.118] Protections and footboards.....	90.6
[90.120] Mechanically-adjusted operator seat.....	90.7
[90.124] Pneumatically-adjusted operator seat.....	90.8
[90.100] Engine hood and panels	90.9
[90.102] Engine shields, hood latches, and trims	90.10

[90.116] Fenders and guards 90.11



INTRODUCTION

Foreword - Important notice regarding equipment servicing

All repair and maintenance work listed in this manual must be carried out only by qualified dealership personnel, strictly complying with the instructions given, and using, whenever possible, the special tools.

Anyone who performs repair and maintenance operations without complying with the procedures provided herein shall be responsible for any subsequent damages.

The manufacturer and all the organizations of its distribution chain, including - without limitation - national, regional, or local dealers, reject any responsibility for damages caused by parts and/or components not approved by the manufacturer, including those used for the servicing or repair of the product manufactured or marketed by the manufacturer. In any case, no warranty is given or attributed on the product manufactured or marketed by the manufacturer in case of damages caused by parts and/or components not approved by the manufacturer.

The manufacturer reserves the right to make improvements in design and changes in specifications at any time without notice and without incurring any obligation to install them on units previously sold. Specifications, descriptions, and illustrative material herein are as accurate as known at time of publication but are subject to change without notice.

In case of questions, refer to your NEW HOLLAND Sales and Service Networks.

Safety rules

Personal safety





This is the safety alert symbol. It is used to alert you to potential personal injury hazards. Obey all safety messages that follow this symbol to avoid possible death or injury.

Throughout this manual you will find the signal words DANGER, WARNING, and CAUTION followed by special instructions. These precautions are intended for the personal safety of you and those working with you.

Read and understand all the safety messages in this manual before you operate or service the machine.

 DANGER indicates a hazardous situation that, if not avoided, will result in death or serious injury.

 WARNING indicates a hazardous situation that, if not avoided, could result in death or serious injury.

 CAUTION indicates a hazardous situation that, if not avoided, could result in minor or moderate injury.

FAILURE TO FOLLOW DANGER, WARNING, AND CAUTION MESSAGES COULD RESULT IN DEATH OR SERIOUS INJURY.

Machine safety

NOTICE: Notice indicates a situation that, if not avoided, could result in machine or property damage.

Throughout this manual you will find the signal word Notice followed by special instructions to prevent machine or property damage. The word Notice is used to address practices not related to personal safety.

Information

NOTE: Note indicates additional information that clarifies steps, procedures, or other information in this manual.

Throughout this manual you will find the word Note followed by additional information about a step, procedure, or other information in the manual. The word Note is not intended to address personal safety or property damage.



SERVICE MANUAL

Engine

T5.110 Electro Command™ With 16x16 Semi-Powershift transmission
T5.120 Electro Command™ With 16x16 Semi-Powershift transmission
[HLRT5120JHLO10006 -]

Engine - Torque

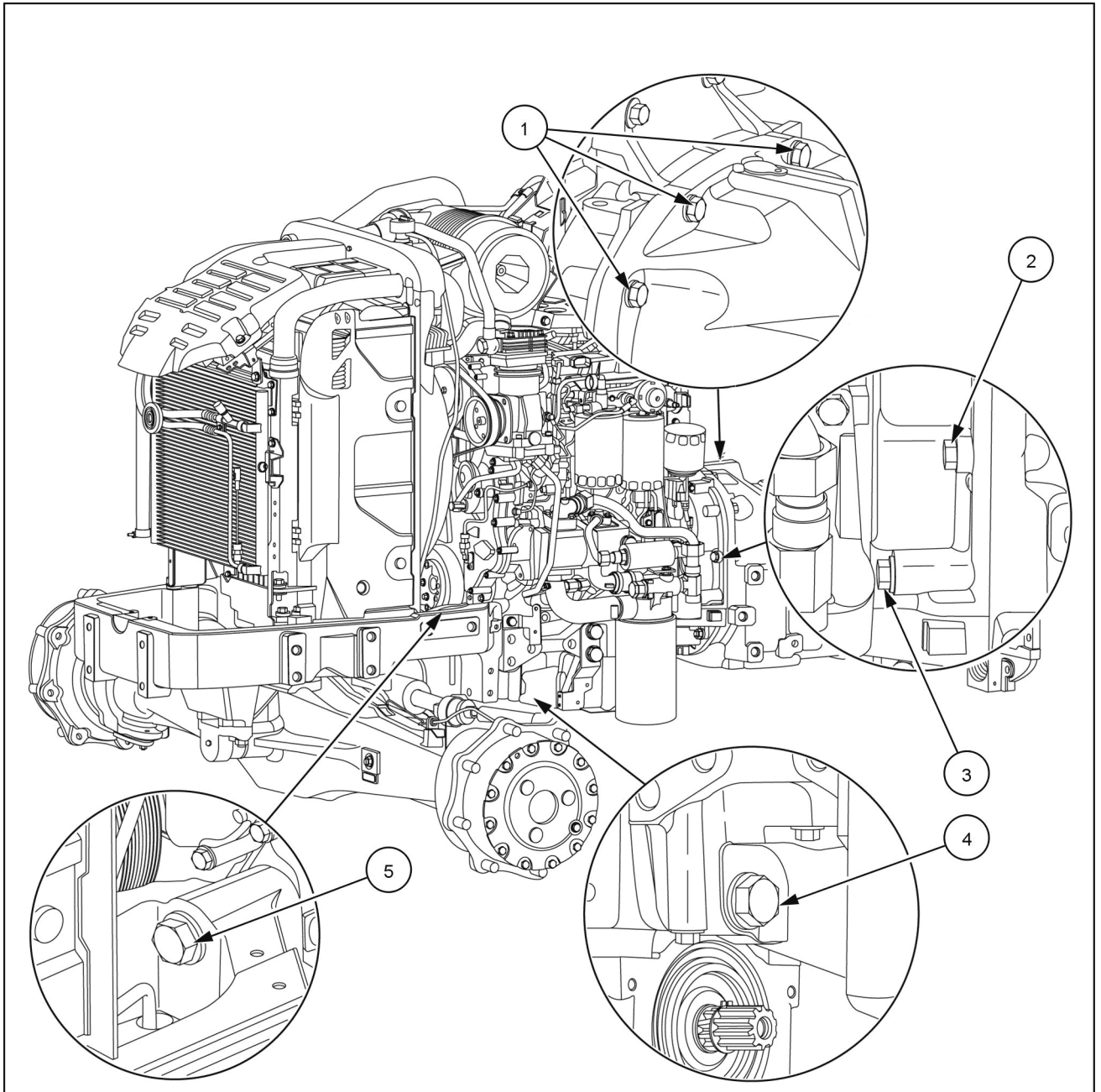

MOIL17TR00673GA 1

Part to tighten	Thread	Tighten torque
Bolt (5) securing the front axle to the engine block	M20 x 1.5 x 130	587 N·m (432.95 lb ft)
Bolt (4) securing the engine block to the front axle	M20 x 1.5 x 110	587 N·m (432.95 lb ft)
Bolt (1) securing the gearbox to the engine block	M12 x 1.25 x 50	121 N·m (89.25 lb ft)
Bolt (2) securing the engine block to the gearbox	M12 x 1.25 x 50	121 N·m (89.25 lb ft)
Bolt (3) securing the engine block to the gearbox	M12 x 1.25 x 90	121 N·m (89.25 lb ft)

Engine - Remove

⚠ WARNING

Heavy objects!

Lift and handle all heavy components using lifting equipment with adequate capacity. Always support units or parts with suitable slings or hooks. Make sure the work area is clear of all bystanders. Failure to comply could result in death or serious injury.

W0398A

⚠ WARNING

Avoid injury!

Handle all parts carefully. Do not place your hands or fingers between parts. Use Personal Protective Equipment (PPE) as indicated in this manual, including protective goggles, gloves, and safety footwear.

Failure to comply could result in death or serious injury.

W0208A

Prior operation:

Hood - Remove (90.100).

Side panels - Remove (90.100).

Battery - Remove (55.302)

Fuel tank - Remove (10.216).

Air conditioning - Evacuate (50.200)

Selective Catalytic Reduction (SCR) muffler and catalyst - Remove (10.500) .

Fender - Remove (90.116)

1. Remove the front ballast (if present) as described in **Front ballast - Remove (39.140)**
2. Position wooden wedges (1) between the front axle and the front axle support (2) to prevent articulation.

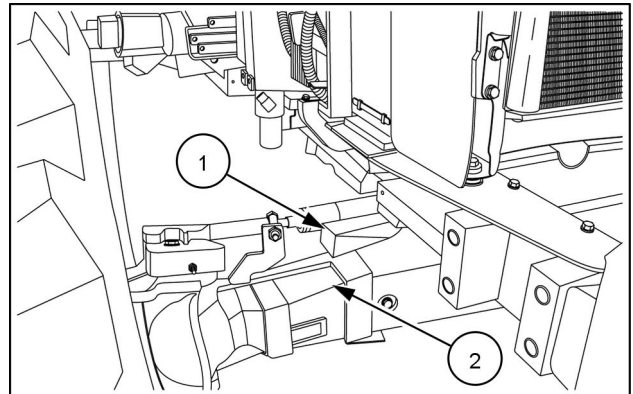

MOIL15TR01239AA 1

3. Release the steering cylinder control lines of the fastening clamps (1) to allow the front transmission drive shaft and its protection to be extracted.

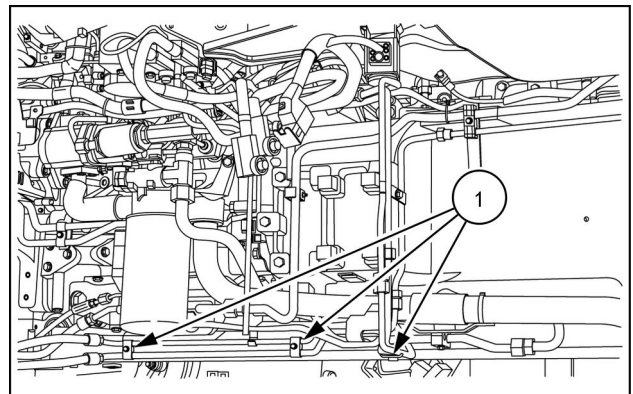

MOIL17TR01408AA 2

- Remove the front transmission drive shaft (1) as described in **Front drive shaft - Remove (23.314)**.

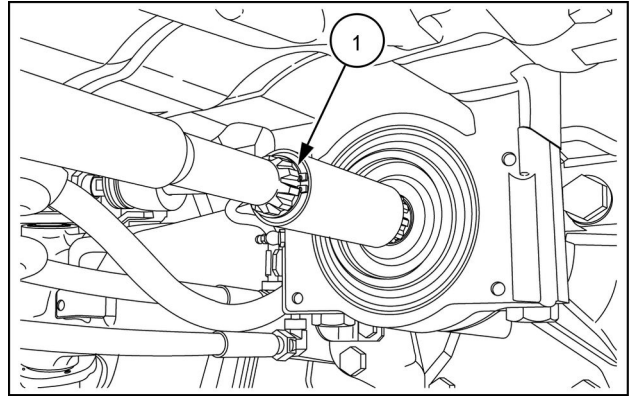

MOIL15TR01371AA 3

- Position a container for transmission oil recovery under the transmission casing near the plug (1).
- Remove the plug (1) and drain the transmission oil.

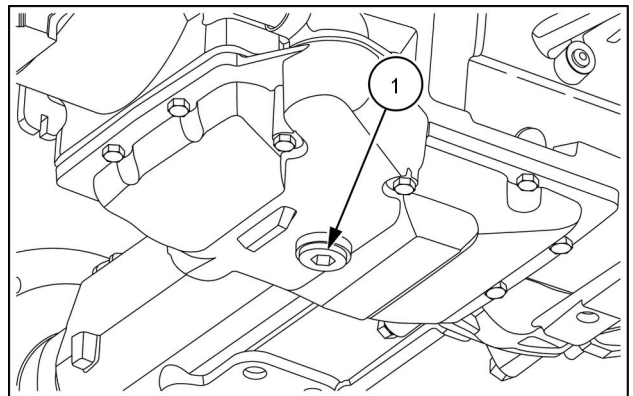

MOIL15TR01232AA 4

- Disconnect the inlet pipe (1) of the filter loosening the 2 front retaining clamps.
- Disconnect the hydraulic fitting (2) of the heat exchanger pipe.

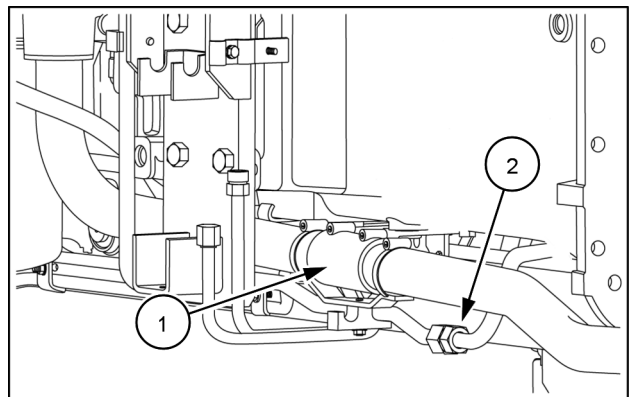

MOIL17I00390AA 5

- Remove the steering cylinder control lines disconnecting the hydraulic fittings (1).
- Disconnect the hydraulic fitting (2) of the oil pipe.
- Uncouple the differential lock fitting (3).

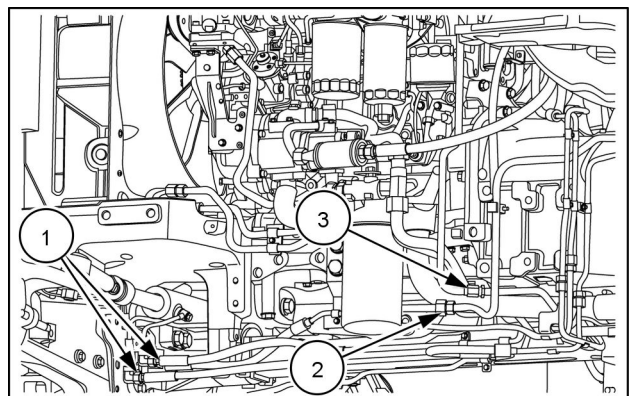

MOIL17TR01698AA 6



Suggest:

If the above button click is invalid.

Please download this document

first, and then click the above link

to download the complete manual.

Thank you so much for reading

12. Uncouple the two electrical connectors (1) and the cab steering pump pipe (2).

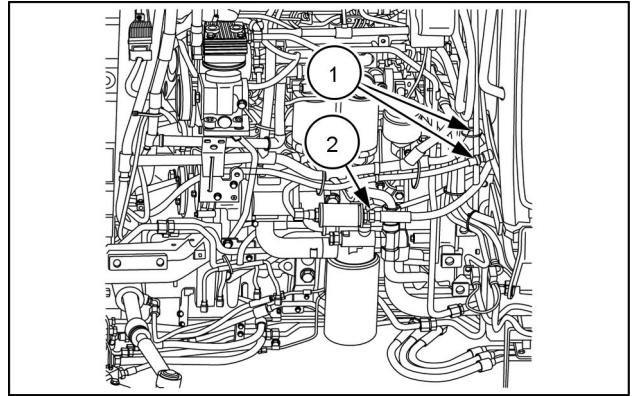

MOIL17TR01410AA 7

13. Disconnect the hydraulic connections (1) and (2) of the lines to the hydraulic steering control valve.
 14. Disconnect the two heating system pipes (3) and the protection screws (4) to disconnect the cables from the battery to the starter motor.

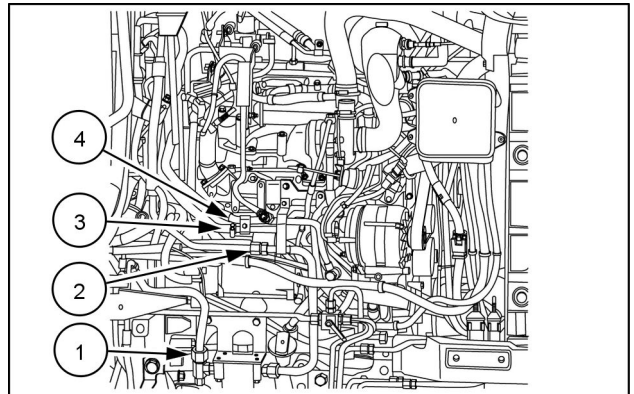

MOIL17TR01412AA 8

15. Uncouple the oil delivery fitting (1) to the control valves.

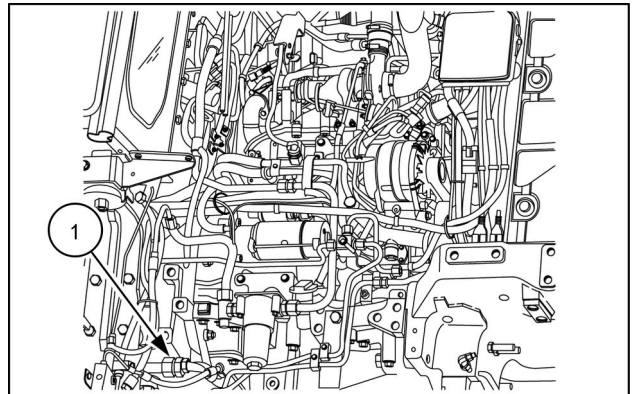

MOIL17TR01413AA 9

16. Disconnect the hydraulic fitting (3) on the capacitor (4) and loosen the screw (1) of the retaining clamp.
 17. Disconnect the sensor wiring (2).

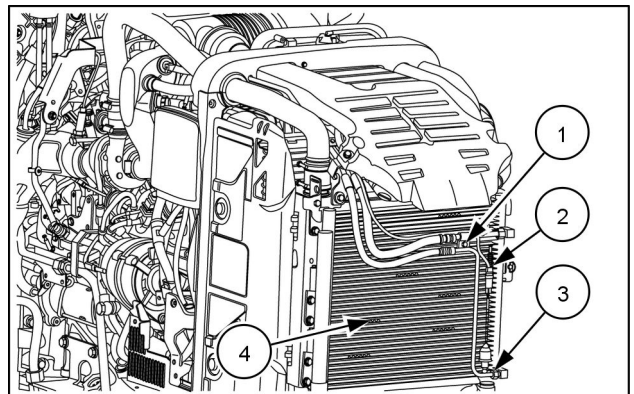

MOIL17TR01665AA 10

<https://www.ebooklibonline.com>

Hello dear friend!

Thank you very much for reading.

Enter the link into your browser.

The full manual is available for immediate download.

<https://www.ebooklibonline.com>