

SERVICE MANUAL

T4.80F / T4.80V / T4.90F / T4.90V T4.100F / T4.100V / T4.110F / T4.110V Tier 4A (interim) Tractor

*T4.80F with cab PIN ZGLH01657 and above; T4.80F without cab PIN ZGLH01068 and above;
T4.80V with cab PIN ZFLJ01935 and above; T4.80V without cab PIN ZFLJ02353 and above;
T4.90F with cab PIN ZGLH01601 and above; T4.90F without cab PIN ZGLH00695 and above;
T4.90V with cab PIN ZGLJ03134 and above; T4.90V without cab PIN ZGLJ02059 and above;
T4.100F with cab PIN ZGLH00384 and above; T4.100F without cab PIN ZGLH00644 and above;
T4.100V with cab PIN ZGLJ02249 and above; T4.100V without cab PIN ZGLJ02246 and above;
T4.110F with cab PIN ZFLH00040 and above; T4.110F without cab PIN ZFLH02101 and above;
T4.110V with cab PIN ZGLJ01295 and above; T4.110V without cab PIN ZFLJ00805 and above*

Part number 51430128

1st edition English
December 2017





SERVICE MANUAL

**T4.100F With cab [ZGLH00384 -], T4.100F Without cab [ZGLH00644 -],
T4.100V With cab [ZGLJ02249 -], T4.100V Without cab [ZGLJ02246 -],
T4.110F With cab [ZFLH00040 -], T4.110F Without cab [ZFLH02101 -],
T4.110V With cab [ZGLJ01295 -], T4.110V Without cab [ZFLJ00805 -],
T4.80F With cab [ZGLH01657 -], T4.80F Without cab [ZGLH01068 -], T4.80V
With cab [ZFLJ01935 -], T4.80V Without cab [ZFLJ02353 -], T4.90F With
cab [ZGLH01601 -], T4.90F Without cab [ZGLH00695 -], T4.90V With cab
[ZGLJ03134 -], T4.90V Without cab [ZGLJ02059 -]**

Link Product / Engine

Product	Market Product	Engine
T4.100F With cab [ZGLH00384 -]	North America	F5DFL413K*A010
T4.100F Without cab [ZGLH00644 -]	North America	F5DFL413K*A010
T4.110F With cab [ZFLH00040 -]	North America	F5DFL413J*A011
T4.110F Without cab [ZFLH02101 -]	North America	F5DFL413J*A011
T4.80F With cab [ZGLH01657 -]	North America	F5DFL413A*E009
T4.80F Without cab [ZGLH01068 -]	North America	F5DFL413A*E009
T4.90F With cab [ZGLH01601 -]	North America	F5DFL413L*A007
T4.90F Without cab [ZGLH00695 -]	North America	F5DFL413L*A007
T4.100V With cab [ZGLJ02249 -]	North America	F5DFL413K*A010
T4.100V Without cab [ZGLJ02246 -]	North America	F5DFL413K*A010
T4.110V With cab [ZGLJ01295 -]	North America	F5DFL413J*A011
T4.110V Without cab [ZFLJ00805 -]	North America	F5DFL413J*A011
T4.80V With cab [ZFLJ01935 -]	North America	F5DFL413A*E009
T4.80V Without cab [ZFLJ02353 -]	North America	F5DFL413A*E009
T4.90V With cab [ZGLJ03134 -]	North America	F5DFL413L*A007
T4.90V Without cab [ZGLJ02059 -]	North America	F5DFL413L*A007

<https://www.ebooklibonline.com>

Hello dear friend!

Thank you very much for reading.

Enter the link into your browser.

The full manual is available for immediate download.

<https://www.ebooklibonline.com>

Contents

INTRODUCTION

Engine	10
[10.001] Engine and crankcase	10.1
[10.114] Pump drives	10.2
[10.216] Fuel tanks	10.3
[10.206] Fuel filters	10.4
[10.220] Throttle linkage.....	10.5
[10.202] Air cleaners and lines	10.6
[10.254] Intake and exhaust manifolds and muffler	10.7
[10.501] Exhaust Gas Recirculation (EGR) exhaust treatment.....	10.8
[10.400] Engine cooling system	10.9
[10.414] Fan and drive	10.10
[10.310] Aftercooler.....	10.11
[10.304] Engine lubrication system.....	10.12
Clutch	18
[18.100] Clutch mechanical release control	18.1
[18.104] Clutch hydraulic release control.....	18.2
[18.110] Clutch and components	18.3
Transmission	21
[21.114] Mechanical transmission	21.1
[21.130] Mechanical transmission external controls.....	21.2
[21.100] Mechanical transmission hydraulic components	21.3
[21.140] Mechanical transmission internal components.....	21.4
[21.112] Power shuttle transmission.....	21.5
[21.134] Power shuttle transmission external controls	21.6
[21.104] Power shuttle transmission hydraulic components	21.7
[21.154] Power shuttle transmission internal components	21.8

[21.145] Gearbox internal components.....	21.9
[21.160] Creeper	21.10
[21.162] Reverser	21.11
[21.168] Hi-Lo unit	21.12
[21.109] Transmission cooler and lines.....	21.13
[21.118] Transmission/Rear drive	21.14
[21.182] Differential.....	21.15
Four-Wheel Drive (4WD) system	23
[23.202] Electro-hydraulic control	23.1
[23.304] Four-Wheel Drive (4WD) gearbox	23.2
[23.314] Drive shaft.....	23.3
Front axle system	25
[25.100] Powered front axle	25.1
[25.102] Front bevel gear set and differential	25.2
[25.108] Final drive hub, steering knuckles, and shafts	25.3
[25.310] Final drives	25.4
[25.400] Non-powered front axle	25.5
Rear axle system.....	27
[27.100] Powered rear axle.....	27.1
[27.106] Rear bevel gear set and differential	27.2
[27.120] Planetary and final drives	27.3
[27.126] Spur gear and final drives.....	27.4
Power Take-Off (PTO).....	31
[31.101] Rear mechanical control	31.1
[31.142] Front Power Take-Off (PTO) control	31.2
[31.146] Front Power Take-Off (PTO)	31.3
Brakes and controls	33

[33.202] Hydraulic service brakes	33.1
[33.110] Parking brake or parking lock	33.2
Hydraulic systems.....	35
[35.000] Hydraulic systems.....	35.1
[35.104] Fixed displacement pump.....	35.2
[35.204] Remote control valves	35.3
[35.100] Main lift system.....	35.4
[35.114] Three-point hitch control valve	35.5
[35.160] Front hitch controls and lines	35.6
[35.162] Front hitch cylinders and lines	35.7
Hitches, drawbars, and implement couplings.....	37
[37.110] Rear three-point hitch	37.1
[37.162] Front hitch.....	37.2
[37.166] Front hitch linkage.....	37.3
Frames and ballasting	39
[39.140] Ballasts and supports	39.1
Steering.....	41
[41.101] Steering control	41.1
[41.200] Hydraulic control components.....	41.2
[41.216] Cylinders	41.3
Wheels.....	44
[44.511] Front wheels.....	44.1
[44.520] Rear wheels.....	44.2
Cab climate control	50
[50.100] Heating	50.1
[50.104] Ventilation	50.2
[50.200] Air conditioning.....	50.3
[50.300] Cab pressurizing system.....	50.4

Electrical systems	55
[55.100] Harnesses and connectors	55.1
[55.525] Cab engine controls	55.2
[55.015] Engine control system	55.3
[55.201] Engine starting system	55.4
[55.301] Alternator	55.5
[55.302] Battery	55.6
[55.011] Fuel tank system	55.7
[55.010] Fuel injection system	55.8
[55.014] Engine intake and exhaust system	55.9
[55.989] Exhaust Gas Recirculation (EGR) electrical system	55.10
[55.640] Electronic modules	55.11
[55.513] Cab transmission controls	55.12
[55.024] Transmission control system	55.13
[55.021] Transmission pressure sensors	55.14
[55.541] Cab Front-Wheel Drive (FWD) controls	55.15
[55.040] Four-Wheel Drive (4WD) control system	55.16
[55.542] Cab axle controls	55.17
[55.522] Cab Power Take-Off (PTO) controls	55.18
[55.048] Rear Power Take-Off (PTO) control system	55.19
[55.049] Front Power Take-Off (PTO) control system	55.20
[55.030] Service brake electrical system	55.21
[55.031] Parking brake electrical system	55.22
[55.512] Cab controls	55.23
[55.035] Remote control valve electric control	55.24
[55.051] Cab Heating, Ventilation, and Air-Conditioning (HVAC) controls	55.25
[55.050] Heating, Ventilation, and Air-Conditioning (HVAC) control system	55.26
[55.523] Cab hitch controls	55.27

[55.130] Rear three-point hitch electronic control system	55.28
[55.518] Wiper and washer system.....	55.29
[55.404] External lighting	55.30
[55.405] External lighting switches and relays	55.31
[55.514] Cab lighting	55.32
[55.408] Warning indicators, alarms, and instruments	55.33
[55.DTC] FAULT CODES.....	55.34
Platform, cab, bodywork, and decals.....	90
[90.150] Cab.....	90.1
[90.151] Cab interior.....	90.2
[90.160] Cab interior trim and panels.....	90.3
[90.154] Cab doors and hatches	90.4
[90.156] Cab windshield and windows	90.5
[90.110] Operator platform less cab	90.6
[90.118] Protections and footboards.....	90.7
[90.114] Operator protections	90.8
[90.120] Mechanically-adjusted operator seat.....	90.9
[90.124] Pneumatically-adjusted operator seat.....	90.10
[90.100] Engine hood and panels	90.11



INTRODUCTION

Foreword - Important notice regarding equipment servicing

All repair and maintenance work listed in this manual must be carried out only by qualified dealership personnel, strictly complying with the instructions given, and using, whenever possible, the special tools.

Anyone who performs repair and maintenance operations without complying with the procedures provided herein shall be responsible for any subsequent damages.

The manufacturer and all the organizations of its distribution chain, including - without limitation - national, regional, or local dealers, reject any responsibility for damages caused by parts and/or components not approved by the manufacturer, including those used for the servicing or repair of the product manufactured or marketed by the manufacturer. In any case, no warranty is given or attributed on the product manufactured or marketed by the manufacturer in case of damages caused by parts and/or components not approved by the manufacturer.

The manufacturer reserves the right to make improvements in design and changes in specifications at any time without notice and without incurring any obligation to install them on units previously sold. Specifications, descriptions, and illustrative material herein are as accurate as known at time of publication but are subject to change without notice.

In case of questions, refer to your NEW HOLLAND Sales and Service Networks.

Safety rules

Personal safety





This is the safety alert symbol. It is used to alert you to potential personal injury hazards. Obey all safety messages that follow this symbol to avoid possible death or injury.

Throughout this manual you will find the signal words DANGER, WARNING, and CAUTION followed by special instructions. These precautions are intended for the personal safety of you and those working with you.

Read and understand all the safety messages in this manual before you operate or service the machine.

 DANGER indicates a hazardous situation that, if not avoided, will result in death or serious injury.

 WARNING indicates a hazardous situation that, if not avoided, could result in death or serious injury.

 CAUTION indicates a hazardous situation that, if not avoided, could result in minor or moderate injury.

FAILURE TO FOLLOW DANGER, WARNING, AND CAUTION MESSAGES COULD RESULT IN DEATH OR SERIOUS INJURY.

Machine safety

NOTICE: Notice indicates a situation that, if not avoided, could result in machine or property damage.

Throughout this manual you will find the signal word Notice followed by special instructions to prevent machine or property damage. The word Notice is used to address practices not related to personal safety.

Information

NOTE: Note indicates additional information that clarifies steps, procedures, or other information in this manual.

Throughout this manual you will find the word Note followed by additional information about a step, procedure, or other information in the manual. The word Note is not intended to address personal safety or property damage.



SERVICE MANUAL

Engine

**T4.100F With cab [ZGLH00384 -], T4.100F Without cab [ZGLH00644 -],
T4.100V With cab [ZGLJ02249 -], T4.100V Without cab [ZGLJ02246 -],
T4.110F With cab [ZFLH00040 -], T4.110F Without cab [ZFLH02101 -],
T4.110V With cab [ZGLJ01295 -], T4.110V Without cab [ZFLJ00805 -],
T4.80F With cab [ZGLH01657 -], T4.80F Without cab [ZGLH01068 -], T4.80V
With cab [ZFLJ01935 -], T4.80V Without cab [ZFLJ02353 -], T4.90F With
cab [ZGLH01601 -], T4.90F Without cab [ZGLH00695 -], T4.90V With cab
[ZGLJ03134 -], T4.90V Without cab [ZGLJ02059 -]**

Engine - Remove from transmission

T4.100F Without cab [ZGLH00644 -]	
T4.110F Without cab [ZFLH02101 -]	
T4.80F Without cab [ZGLH01068 -]	
T4.90F Without cab [ZGLH00695 -]	

⚠ WARNING

Burn hazard!

Be very careful to avoid contact with hot fluids. If fluid is extremely hot, allow it to cool to a moderately warm temperature before proceeding.

Failure to comply could result in death or serious injury.

W0362A

⚠ WARNING

Hot surface possible!

Wait for all components to cool before performing any operation.

Failure to comply could result in death or serious injury.

W0251A

⚠ CAUTION

Hot area!

Use care when working near hot components. Wear protective gloves.

Failure to comply could result in minor or moderate injury.

C0034A

⚠ WARNING

Chemical hazard!

When handling fuel, lubricants, and other service chemicals, follow the manufacturer's instructions. Wear Personal Protective Equipment (PPE) as instructed. Do not smoke or use open flame. Collect fluids in proper containers. Obey all local and environmental regulations when disposing of chemicals.

Failure to comply could result in death or serious injury.

W0371A

Prior operation:

A. Remove the front ballast - See **Front ballast - Remove (39.140)**.

1. Carefully clean the area around the central drain plug (1) on the transmission.
2. Use a suitable container to collect the transmission oil.
3. Loosen the central drain plug (1) on the transmission and drain the transmission oil.
4. Replace the central drain plug (1) on the transmission.
5. Tighten the central drain plug (1) on the transmission.
6. Carefully clean all the parts contaminated by any leaking hydraulic fluid.
7. Remove the operator platform – See **Platform - Remove (90.110)**.
8. Remove the transmission drive shaft going from the transmission to the front axle - See **Front drive shaft - Remove (23.314)**.

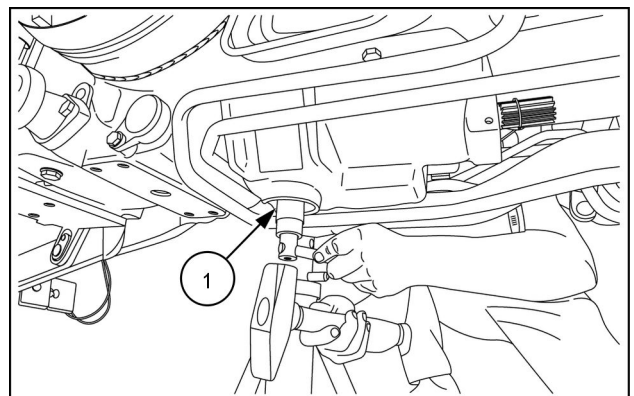

MOIL16TR01450AA 1

9. Use a suitable hydraulic lift and position it under the oil sump of the engine.

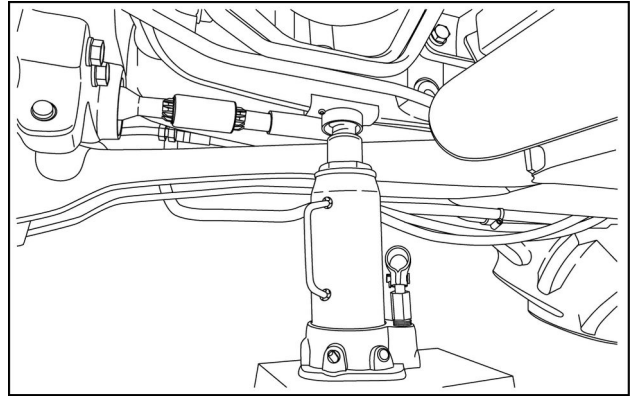

MOIL16TR01451AA 2

10. Use a second suitable hydraulic lift and position it under the swinging arm (1).

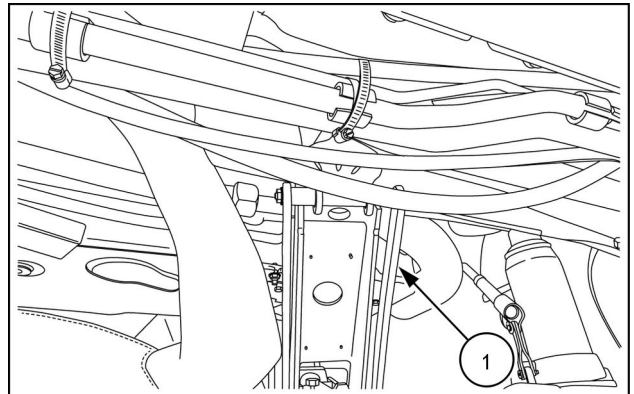

MOIL16TR01452AA 3

11. Remove the snap ring fixing the half bushes (1) to the rear ball joint (2) of the swinging arm (3).
12. Push down on the hydraulic lifts and extract the half bushes (1) on the rear ball joint (2).

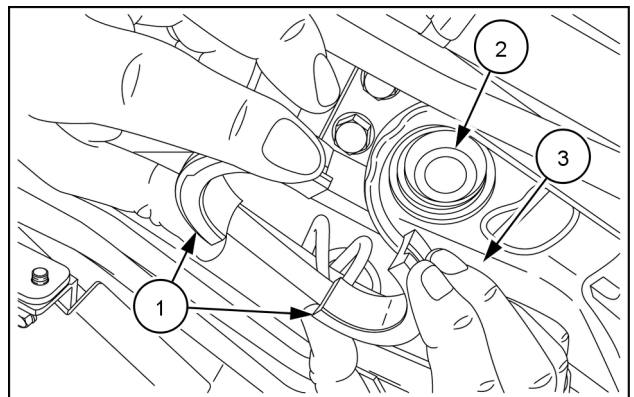

MOIL16TR01453AA 4

13. Carefully clean the area around the couplings (1) on the intermediate delivery and return pipes on the transmission oil exchanger.
14. Use a suitable container to collect the transmission oil.
15. Loosen the couplings (1) on the intermediate delivery and return pipes on the transmission oil exchanger.

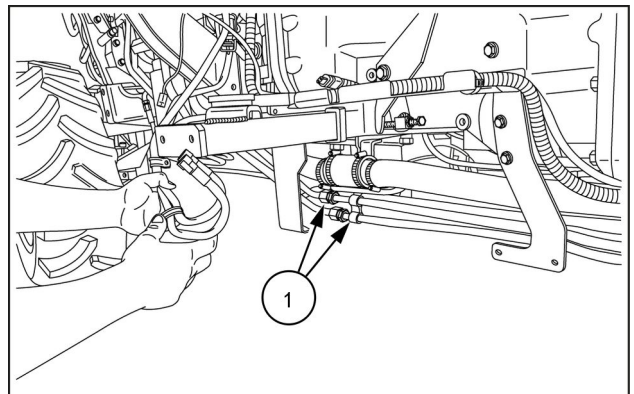

MOIL16TR01454AA 5

16. Carefully clean the area around the coupling **(1)** of the intermediate differential oil delivery pipe on the left-hand side of the vehicle.
17. Use a suitable container to collect the transmission oil.
18. Loosen the coupling **(1)** of the intermediate differential oil delivery pipe on the left-hand side of the vehicle.

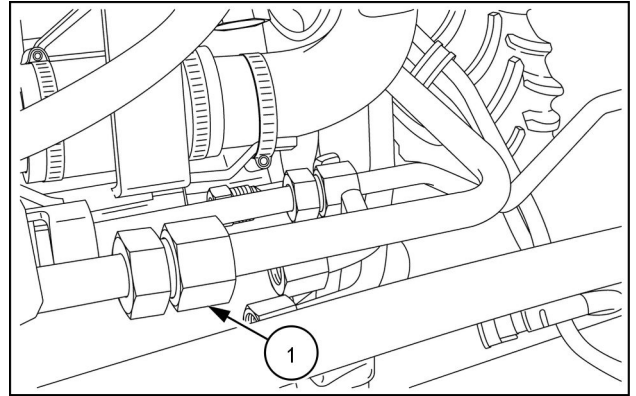

MOIL16TR01455AA 6

19. Carefully clean the area around the coupling **(1)** of the intermediate delivery pipe connected to the transmission oil filter.
20. Use a suitable container to collect the transmission oil.
21. Loosen the coupling **(1)** of the intermediate delivery pipe connected to the transmission oil filter.
22. Carefully clean all the parts contaminated by any leaking hydraulic fluid.

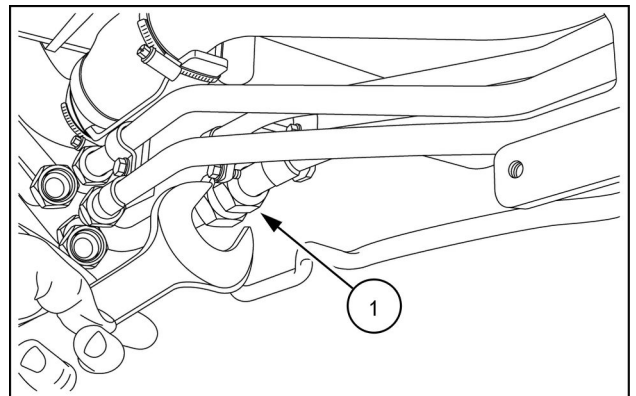

MOIL16TR01456AA 7

23. Carefully clean the area around the sleeve **(1)** of the intermediate delivery pipe connected to the transmission oil filter.
24. Use a suitable container to collect the transmission oil.
25. Loosen the two screw collars **(2)** on the sleeve **(1)** of the intermediate delivery pipe connected to the transmission oil filter.
26. Loosen the screw collar **(3)** fixing the sleeve **(1)** of the intermediate delivery pipe connected to the transmission oil filter.
27. Disconnect the sleeve **(1)** of the intermediate delivery pipe connected to the transmission oil filter.

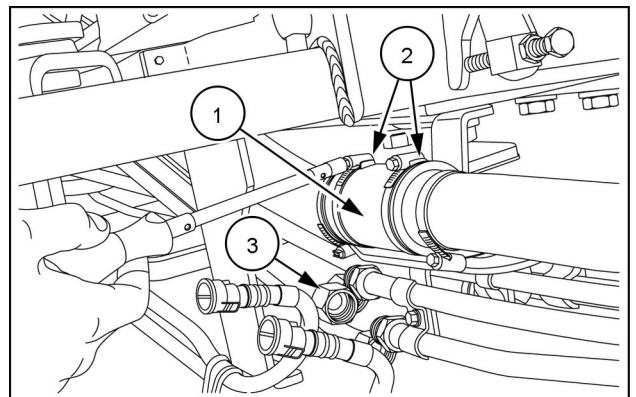

MOIL16TR01457AA 8

28. Carefully clean all the parts contaminated by any leaking hydraulic fluid.
29. Carefully clean the area around the connector **(1)** of the steering sensor.
30. Disconnect the steering sensor connector **(1)**.
31. Disconnect the connector cable **(1)** from the steering sensor.

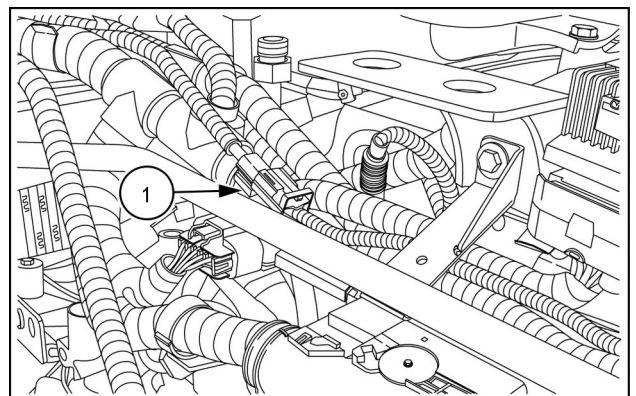

MOIL16TR01459AA 9

32. Carefully clean the area around the connector **(1)** of the hydraulic fluid pressure sensor.
33. Disconnect the connector **(1)** of the hydraulic fluid pressure sensor.
34. Disconnect the connector cable **(1)** from the hydraulic fluid pressure sensor.

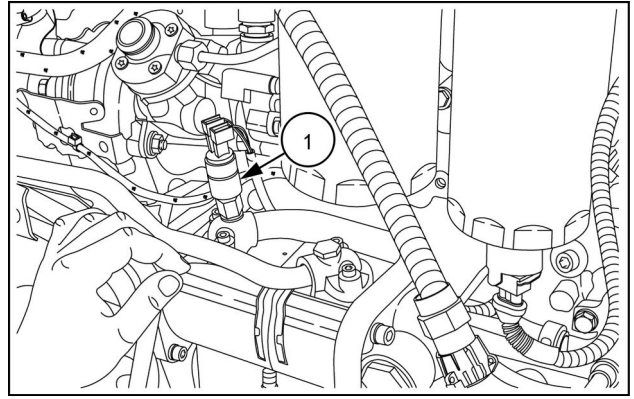

MOIL16TR01460AA 10

35. Carefully clean the area around the connector **(1)**.
36. Disconnect connector **(1)**.
37. Unclamp the connector **(1)** from the support bracket **(2)**.

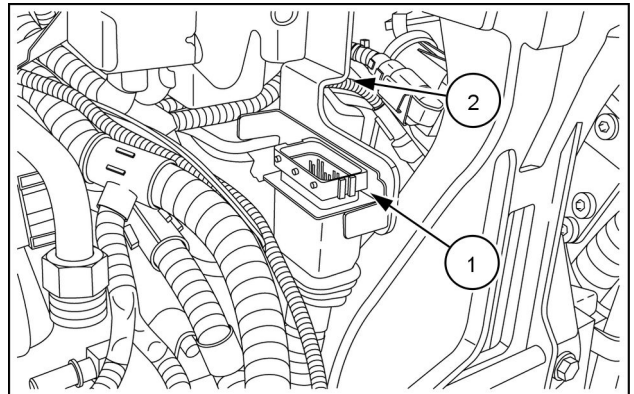

MOIL16TR01458AA 11

38. Loosen the screw **(1)** and remove the collar **(2)**.
39. Loosen the sleeve **(3)** of the oil delivery pipe **(4)**.

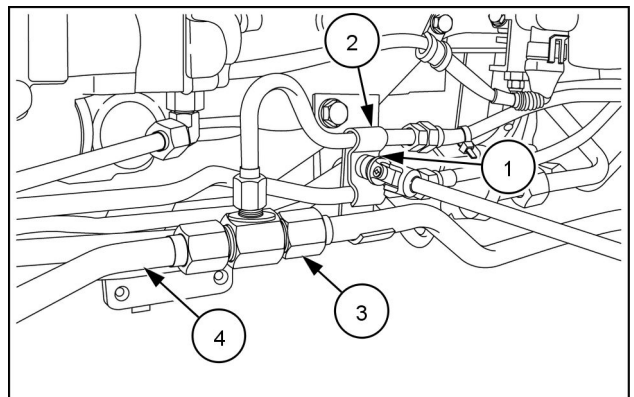

MOIL16TR01462AA 12

40. Carefully clean the area around the two holes **(1)** on the upper side of the clutch bell **(2)**.
41. Restore the thread in the two holes **(1)** on the upper side of the clutch bell **(2)**.

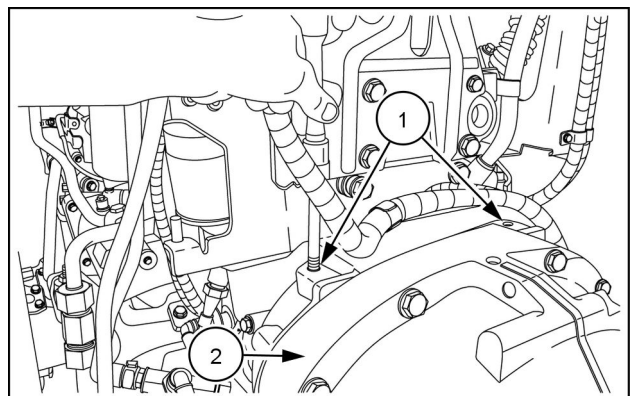

MOIL16TR01463AA 13



Suggest:

If the above button click is invalid.

Please download this document

first, and then click the above link

to download the complete manual.

Thank you so much for reading

42. Loosen the two screws **(1)** securing the bracket **(2)**.
43. Remove the bracket **(2)** and the cable **(3)**.
44. Arrange two eyebolts suitable for lifting the engine.
45. Prepare a hoist and chains/straps that are suitable for lifting the engine.

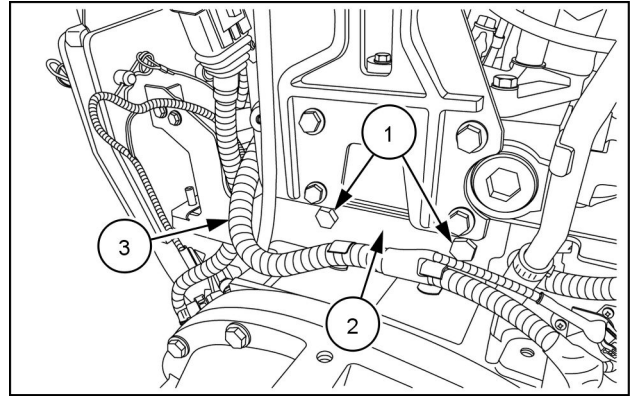

MOIL16TR01461AA 14

46. Place a suitable lift under the transmission housing.

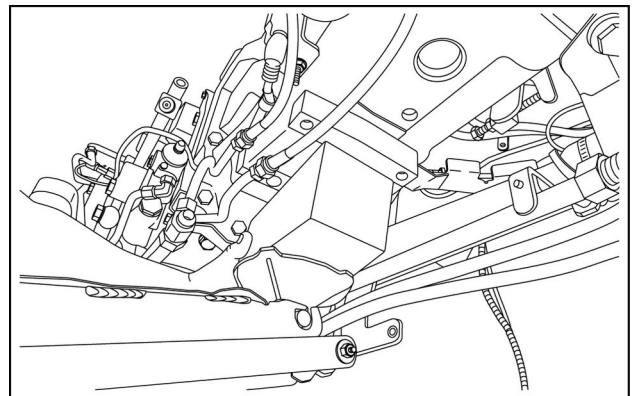

MOIL16TR01464AA 15

47. Clean the area around the clutch bell **(1)**.
48. Correctly position the two eyebolts **(1)**, and using the correct screws, lock into the holes on the upper face of the clutch bell **(2)**.
49. Correctly hook the chains/straps to the eyebolts **(1)**.
50. Use a suitable tool to separate the engine from the transmission.

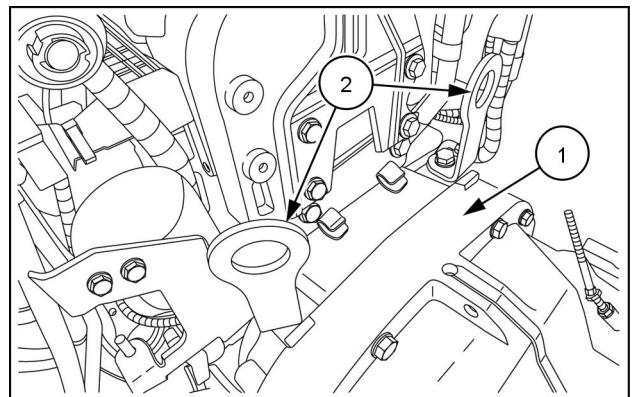

MOIL16TR01465AA 16

51. Loosen the four fastening screws **(1)** on the left-hand side of the clutch bell.
52. Repeat for the four fastening screws on the right-hand side of the clutch bell.

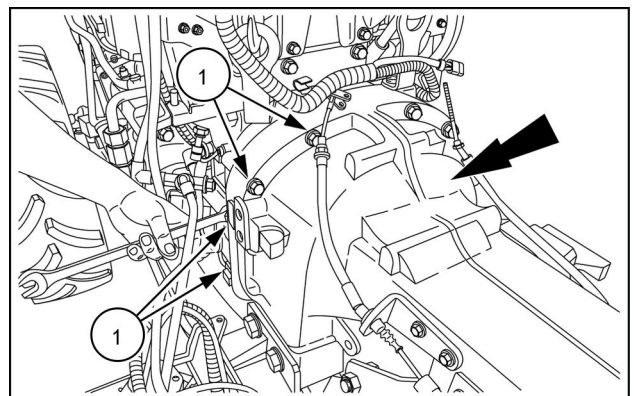

MOIL16TR01466AA 17

<https://www.ebooklibonline.com>

Hello dear friend!

Thank you very much for reading.

Enter the link into your browser.

The full manual is available for immediate download.

<https://www.ebooklibonline.com>