

# SERVICE MANUAL

## **Boomer™ 45** **Boomer™ 50** **Boomer™ 55** **Tier 4B (final)** **Compact Tractor**

*Boomer™ 45 Cab - From PIN LSM0B45Cxx0010001 to LSM0B45CAH0010031*  
*Boomer™ 45 ROPS - From PIN LSM0B45Rxx0010001 to LSM0B45RJH0010062*  
*Boomer™ 50 Cab - From PIN LSM0B50Cxx0010001 to LSM0B50CEH0010080*  
*Boomer™ 50 ROPS - From PIN LSM0B50Rxx0010001 to LSM0B50REH0010097*  
*Boomer™ 55 Cab - From PIN LSM0B55Cxx0010001 to LSM0B55CCH0010090*  
*Boomer™ 55 ROPS - From PIN LSM0B55Rxx0010001 to LSM0B55RCH0010120*

**Part number 48144020**

1<sup>st</sup> edition English  
June 2017





## **SERVICE MANUAL**

**Boomer™ 45 Tier 4B (final), Cab [LSM0B45Cxx0010001 - LSM0B45CAH0010031], Boomer™ 45 Tier 4B (final), ROPS [LSM0B45Rxx0010001 - LSM0B45RJH0010062], Boomer™ 50 Tier 4B (final), Cab [LSM0B50Cxx0010001 - LSM0B50CEH0010080], Boomer™ 50 Tier 4B (final), ROPS [LSM0B50Rxx0010001 - LSM0B50REH0010097], Boomer™ 55 Tier 4B (final), Cab [LSM0B55Cxx0010001 - LSM0B55CCH0010090], Boomer™ 55 Tier 4B (final), ROPS [LSM0B55Rxx0010001 - LSM0B55RCH0010120]**

## Link Product / Engine

| Product  | Market Product | Engine   |
|--|----------------|----------|
| Boomer™ 45 Tier 4B (final),<br>ROPS [LSM0B45Rxx0010001 -<br>LSM0B45RJH0010062] | North America  | L3C19-T3 |
| Boomer™ 45 Tier 4B (final),<br>Cab [LSM0B45Cxx0010001 -<br>LSM0B45CAH0010031]  | North America  | L3C19-T3 |
| Boomer™ 50 Tier 4B (final),<br>ROPS [LSM0B50Rxx0010001 -<br>LSM0B50REH0010097] | North America  | L3C19-T2 |
| Boomer™ 50 Tier 4B (final),<br>Cab [LSM0B50Cxx0010001 -<br>LSM0B50CEH0010080]  | North America  | L3C19-T2 |
| Boomer™ 55 Tier 4B (final),<br>ROPS [LSM0B55Rxx0010001 -<br>LSM0B55RCH0010120] | North America  | L3C19-T1 |
| Boomer™ 55 Tier 4B (final),<br>Cab [LSM0B55Cxx0010001 -<br>LSM0B55CCH0010090]  | North America  | L3C19-T1 |

**<https://www.ebooklibonline.com>**

Hello dear friend!

Thank you very much for reading.

Enter the link into your browser.

The full manual is available for immediate download.

**<https://www.ebooklibonline.com>**

# Contents

---

## INTRODUCTION

|   |           |
|---|-----------|
| <b>Engine</b> .....   | <b>10</b> |
| [10.001] Engine and crankcase .....                             | 10.1      |
| [10.216] Fuel tanks .....                                       | 10.2      |
| [10.206] Fuel filters .....                                     | 10.3      |
| [10.218] Fuel injection system.....                             | 10.4      |
| [10.202] Air cleaners and lines .....                           | 10.5      |
| [10.254] Intake and exhaust manifolds and muffler .....         | 10.6      |
| [10.501] Exhaust Gas Recirculation (EGR) exhaust treatment..... | 10.7      |
| [10.400] Engine cooling system .....                            | 10.8      |
| [10.414] Fan and drive .....                                    | 10.9      |
| <b>Clutch</b> .....   | <b>18</b> |
| [18.100] Clutch mechanical release control .....                | 18.1      |
| [18.110] Clutch and components .....                            | 18.2      |
| <b>Power coupling</b> .....                                     | <b>19</b> |
| [19.110] Flywheel damper .....                                  | 19.1      |
| <b>Transmission</b> .....                                       | <b>21</b> |
| [21.114] Mechanical transmission .....                          | 21.1      |
| [21.130] Mechanical transmission external controls.....         | 21.2      |
| [21.140] Mechanical transmission internal components.....       | 21.3      |
| [21.110] Master clutch housing .....                            | 21.4      |
| <b>Four-Wheel Drive (4WD) system</b> .....                      | <b>23</b> |
| [23.314] Drive shaft.....                                       | 23.1      |
| [23.101] Mechanical control .....                               | 23.2      |
| <b>Front axle system</b> .....                                  | <b>25</b> |
| [25.100] Powered front axle .....                               | 25.1      |

|   |           |
|---|-----------|
| [25.102] Front bevel gear set and differential .....          | 25.2      |
| [25.108] Final drive hub, steering knuckles, and shafts ..... | 25.3      |
| <b>Rear axle system.....</b>                                  | <b>27</b> |
| [27.106] Rear bevel gear set and differential.....            | 27.1      |
| [27.120] Planetary and final drives .....                     | 27.2      |
| <b>Hydrostatic drive.....</b>                                 | <b>29</b> |
| [29.200] Mechanical control .....                             | 29.1      |
| [29.100] Transmission and steering hydrostatic control .....  | 29.2      |
| [29.204] Reservoir, cooler, and lines .....                   | 29.3      |
| [29.218] Pump and motor components.....                       | 29.4      |
| [29.202] Hydrostatic transmission .....                       | 29.5      |
| <b>Power Take-Off (PTO).....</b>                              | <b>31</b> |
| [31.101] Rear mechanical control .....                        | 31.1      |
| [31.104] Rear electro-hydraulic control.....                  | 31.2      |
| [31.110] One-speed rear Power Take-Off (PTO) .....            | 31.3      |
| [31.120] Central Power Take-Off (PTO) .....                   | 31.4      |
| <b>Brakes and controls .....</b>                              | <b>33</b> |
| [33.110] Parking brake or parking lock .....                  | 33.1      |
| [33.120] Mechanical service brakes .....                      | 33.2      |
| <b>Hydraulic systems.....</b>                                 | <b>35</b> |
| [35.000] Hydraulic systems.....                               | 35.1      |
| [35.300] Reservoir, cooler, and filters.....                  | 35.2      |
| [35.104] Fixed displacement pump.....                         | 35.3      |
| [35.350] Safety and main relief valves .....                  | 35.4      |
| [35.204] Remote control valves .....                          | 35.5      |
| [35.114] Three-point hitch control valve .....                | 35.6      |
| [35.116] Three-point hitch cylinder .....                     | 35.7      |
| [35.724] Front loader hydraulic system control.....           | 35.8      |

|   |           |
|---|-----------|
| <b>Hitches, drawbars, and implement couplings</b> ..... | <b>37</b> |
| [37.100] Drawbars and towing hitches .....              | 37.1      |
| [37.108] Rear three-point hitch external controls.....  | 37.2      |
| [37.110] Rear three-point hitch .....                   | 37.3      |
| <b>Steering</b> .....                                   | <b>41</b> |
| [41.101] Steering control .....                         | 41.1      |
| [41.106] Tie rods.....                                  | 41.2      |
| [41.200] Hydraulic control components.....              | 41.3      |
| [41.216] Cylinders .....                                | 41.4      |
| [41.206] Pump .....                                     | 41.5      |
| <b>Wheels</b> .....                                     | <b>44</b> |
| [44.511] Front wheels.....                              | 44.1      |
| [44.520] Rear wheels .....                              | 44.2      |
| <b>Cab climate control</b> .....                        | <b>50</b> |
| [50.100] Heating .....                                  | 50.1      |
| [50.104] Ventilation .....                              | 50.2      |
| [50.200] Air conditioning.....                          | 50.3      |
| [50.300] Cab pressurizing system .....                  | 50.4      |
| [50.AAA] Cab climate control generic sub-group.....     | 50.5      |
| <b>Electrical systems</b> .....                         | <b>55</b> |
| [55.000] Electrical system .....                        | 55.1      |
| [55.100] Harnesses and connectors.....                  | 55.2      |
| [55.525] Cab engine controls.....                       | 55.3      |
| [55.015] Engine control system.....                     | 55.4      |
| [55.201] Engine starting system .....                   | 55.5      |
| [55.301] Alternator.....                                | 55.6      |
| [55.302] Battery.....                                   | 55.7      |
| [55.011] Fuel tank system .....                         | 55.8      |

|   |           |
|---|-----------|
| [55.989] Exhaust Gas Recirculation (EGR) electrical system .....                | 55.9      |
| [55.640] Electronic modules .....   | 55.10     |
| [55.031] Parking brake electrical system .....                                  | 55.11     |
| [55.512] Cab controls .....   | 55.12     |
| [55.051] Cab Heating, Ventilation, and Air-Conditioning (HVAC) controls .....   | 55.13     |
| [55.050] Heating, Ventilation, and Air-Conditioning (HVAC) control system ..... | 55.14     |
| [55.023] Transmission position sensors and switches .....                       | 55.15     |
| [55.052] Central or middle Power Take-Off (PTO) control system .....            | 55.16     |
| [55.610] Ground speed control .....   | 55.17     |
| [55.DTC] FAULT CODES .....  | 55.18     |
| <b>Platform, cab, bodywork, and decals .....</b>                                | <b>90</b> |
| [90.150] Cab .....  | 90.1      |
| [90.110] Operator platform less cab .....                                       | 90.2      |
| [90.114] Operator protections .....   | 90.3      |
| [90.120] Mechanically-adjusted operator seat .....                              | 90.4      |
| [90.100] Engine hood and panels .....   | 90.5      |
| [90.116] Fenders and guards .....   | 90.6      |



# INTRODUCTION

## Safety rules

### Personal safety





This is the safety alert symbol. It is used to alert you to potential personal injury hazards. Obey all safety messages that follow this symbol to avoid possible death or injury.

Throughout this manual you will find the signal words DANGER, WARNING, and CAUTION followed by special instructions. These precautions are intended for the personal safety of you and those working with you.

Read and understand all the safety messages in this manual before you operate or service the machine.

 DANGER indicates a hazardous situation that, if not avoided, will result in death or serious injury.

 WARNING indicates a hazardous situation that, if not avoided, could result in death or serious injury.

 CAUTION indicates a hazardous situation that, if not avoided, could result in minor or moderate injury.

**FAILURE TO FOLLOW DANGER, WARNING, AND CAUTION MESSAGES COULD RESULT IN DEATH OR SERIOUS INJURY.**

### Machine safety

**NOTICE:** Notice indicates a situation that, if not avoided, could result in machine or property damage.

Throughout this manual you will find the signal word Notice followed by special instructions to prevent machine or property damage. The word Notice is used to address practices not related to personal safety.

### Information

**NOTE:** Note indicates additional information that clarifies steps, procedures, or other information in this manual.

Throughout this manual you will find the word Note followed by additional information about a step, procedure, or other information in the manual. The word Note is not intended to address personal safety or property damage.

---

## Safety rules - Ecology and the environment

Soil, air, and water quality is important for all industries and life in general. When legislation does not yet rule the treatment of some of the substances that advanced technology requires, sound judgment should govern the use and disposal of products of a chemical and petrochemical nature.

Familiarize yourself with the relative legislation applicable to your country, and make sure that you understand this legislation. Where no legislation exists, obtain information from suppliers of oils, filters, batteries, fuels, anti-freeze, cleaning agents, etc., with regard to the effect of these substances on man and nature and how to safely store, use, and dispose of these substances.

### Helpful hints

- Avoid the use of cans or other inappropriate pressurized fuel delivery systems to fill tanks. Such delivery systems may cause considerable spillage.
- In general, avoid skin contact with all fuels, oils, acids, solvents, etc. Most of these products contain substances that may be harmful to your health.
- Modern oils contain additives. Do not burn contaminated fuels and or waste oils in ordinary heating systems.
- Avoid spillage when you drain fluids such as used engine coolant mixtures, engine oil, hydraulic fluid, brake fluid, etc. Do not mix drained brake fluids or fuels with lubricants. Store all drained fluids safely until you can dispose of the fluids in a proper way that complies with all local legislation and available resources.
- Do not allow coolant mixtures to get into the soil. Collect and dispose of coolant mixtures properly.
- The air-conditioning system contains gases that should not be released into the atmosphere. Consult an air-conditioning specialist or use a special extractor to recharge the system properly.
- Repair any leaks or defects in the engine cooling system or hydraulic system immediately.
- Do not increase the pressure in a pressurized circuit as this may lead to a component failure.
- Protect hoses during welding. Penetrating weld splatter may burn a hole or weaken hoses, allowing the loss of oils, coolant, etc.

### Battery recycling

Batteries and electric accumulators contain several substances that can have a harmful effect on the environment if the batteries are not properly recycled after use. Improper disposal of batteries can contaminate the soil, groundwater, and waterways. NEW HOLLAND strongly recommends that you return all used batteries to a NEW HOLLAND dealer, who will dispose of the used batteries or recycle the used batteries properly. In some countries, this is a legal requirement.



### Mandatory battery recycling

**NOTE:** The following requirements are mandatory in Brazil.

Batteries are made of lead plates and a sulfuric acid solution. Because batteries contain heavy metals such as lead, CONAMA Resolution 401/2008 requires you to return all used batteries to the battery dealer when you replace any batteries. Do not dispose of batteries in your household garbage.

Points of sale are obliged to:

- Accept the return of your used batteries
- Store the returned batteries in a suitable location
- Send the returned batteries to the battery manufacturer for recycling

## Safety rules Service precautionary statements climate control

|   |  |
|---|--|
| Boomer™ 45 Tier 4B (final), Cab [LSM0B45Cxx0010001 - LSM0B45CAH0010031] |  |
| Boomer™ 50 Tier 4B (final), Cab [LSM0B50Cxx0010001 - LSM0B50CEH0010080] |  |
| Boomer™ 55 Tier 4B (final), Cab [LSM0B55Cxx0010001 - LSM0B55CCH0010090] |  |

### SERVICE PRECAUTIONARY STATEMENTS

#### Leak Testing

Recharging an air conditioning system that leaks simply allows more refrigerant to escape into the atmosphere and ultimately leaves the system non-functioning and in need of additional charging.

Therefore, the proper service procedure is to locate and fix any leaks before putting any more refrigerant into the system.

If a large amount of refrigerant has leaked out, the system pressure will be too low to identify all but the largest leaks. In this case, partially recharge the system with no more than one pound of refrigerant to check for leaks.

**NOTICE:** • *Any refrigerant introduced into the system for the purpose of finding leaks must also be recovered without releasing it into the atmosphere.*

• *Always use the same type of refrigerant for checking leaks as was originally installed into the AC system by the manufacturer.*

• *Never use compressed air to detect system leaks. The introduction of air into the system may create a fire or explosion hazard, may overload the desiccant with moisture, and could contaminate the system with dirt and improper oil.*

All automotive type air conditioning systems leak to some extent. When servicing them it is important that leakage be minimized. Much of the normal leakage comes from the slow seepage of refrigerant through the flexible hoses. Other common sources of leaks are at joints between the flexible hose and metal tubing or at threaded hose connections. These are usually much larger leaks than the natural seepage through the walls of the hose and are almost always repairable.

Research by the EPA has found that leak detection can be difficult, but existing halogen leak detection systems are adequate for the major task of finding and repairing leaks causing complaints. Dye stains are not very satisfactory for finding small leaks.

Newer electronic leak detectors may offer even better leak detection capabilities. However, no single method can find every leak. Electronic leak detectors may not detect leaks of all refrigerants. For example, older units designed to detect R12 may not detect **R134A**. Be sure that the leak detector you use is state-of-the-art and that it is designed to detect the refrigerant in the system you are servicing.

Service professionals must be extremely diligent in their work to correct all possible leaks. Diligence is essential to ensure that no small, difficult-to-find leaks go undetected.

Before leaving a job, make one last leak check. Catching a leak just after service will save an inconvenient and expensive return visit.

#### Refilling

Refill the air conditioning system using the weight method. The lubricants used in R134a tend to layer onto the walls of the refrigeration system. This layering obscures the view through the sight glass. Visual methods of refilling R134a systems will result in improper system charging. For this reason, we do not recommend the old practice of topping off a partially discharged air conditioning system using the sight glass. The Boomer 45/50/55 cab tractors use **700 g (25 oz)** of **R134A** refrigerant.



## **SERVICE MANUAL**

### **Engine**

**Boomer™ 45 Tier 4B (final), Cab [LSM0B45Cxx0010001 - LSM0B45CAH0010031], Boomer™ 45 Tier 4B (final), ROPS [LSM0B45Rxx0010001 - LSM0B45RJH0010062], Boomer™ 50 Tier 4B (final), Cab [LSM0B50Cxx0010001 - LSM0B50CEH0010080], Boomer™ 50 Tier 4B (final), ROPS [LSM0B50Rxx0010001 - LSM0B50REH0010097], Boomer™ 55 Tier 4B (final), Cab [LSM0B55Cxx0010001 - LSM0B55CCH0010090], Boomer™ 55 Tier 4B (final), ROPS [LSM0B55Rxx0010001 - LSM0B55RCH0010120]**

## Engine - Remove

**Prior operation:**

Drain fluid **Hydrostatic transmission - Change fluid (29.202)**

**Prior operation:**

Drain fluid **Mechanical transmission - Change fluid (21.114)**

**Prior operation:**

**Hood - Remove (90.100)**

**Prior operation:**

**Radiator - Remove (10.400)**

**NOTE:** Note the placement of cable ties for reassembly.

1. Remove the two M8 flange bolts (1) securing the rear cowling.
2. Remove the rear cowling (2).

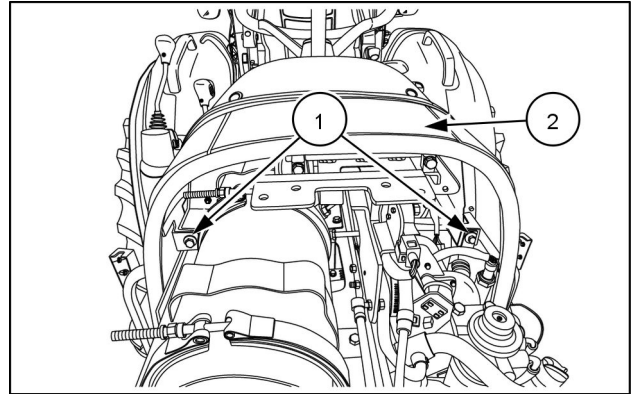

NHIL16CT01367AA 1

3. Remove the four M10 bolts (2) that mount the hood support bracket (1) to the flywheel housing.

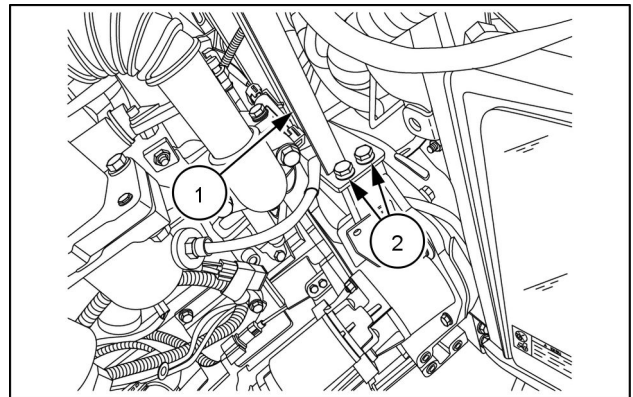

NHIL16CT01398AA 2

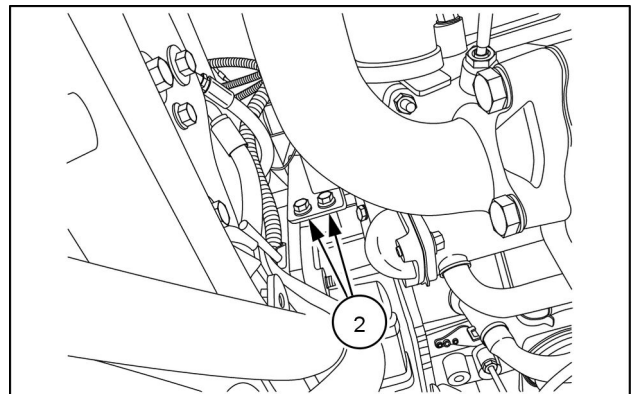

NHIL16CT01400AA 3

4. Remove the M8 bolt **(1)** in the front of the Four Wheel Drive (FWD) guard tube.
5. Slide the guard tube rear-ward.

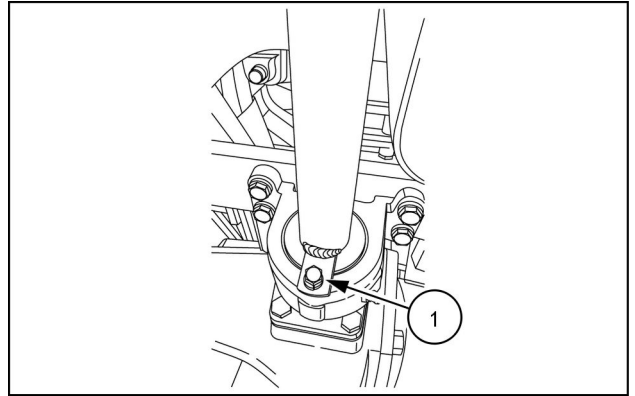

NHIL16CT01006AA 4

6. Use a roll pin punch and a hammer and drive the roll pin **(1)** through the coupler.
7. Slide the coupler rear-ward.

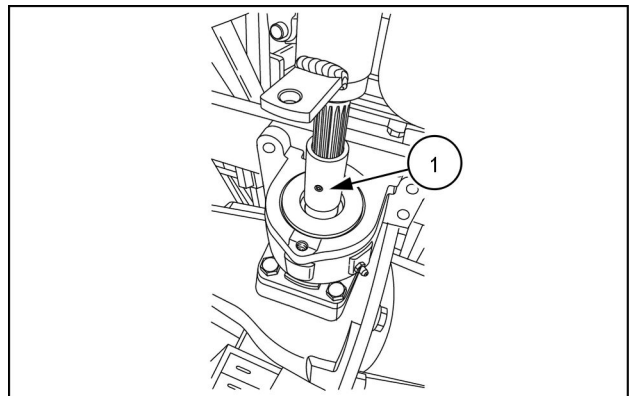

NHIL16CT00679AA 5

### Right-hand side

8. Remove the M6 bolt **(1)** and remove the ground wire **(2)** from the bell housing.

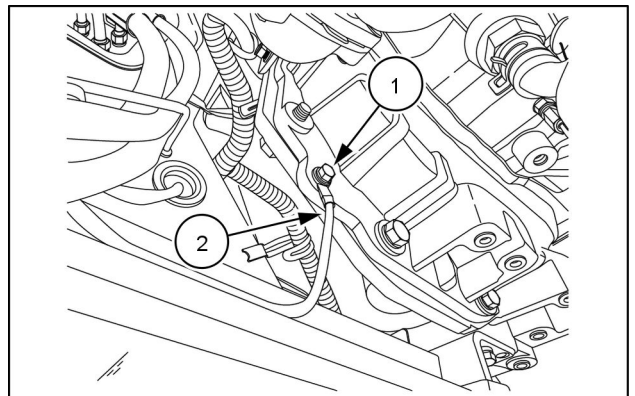

NHIL16CT01383AA 6

9. Cut the cable ties **(1)** from the right-hand and left-hand steering hoses.

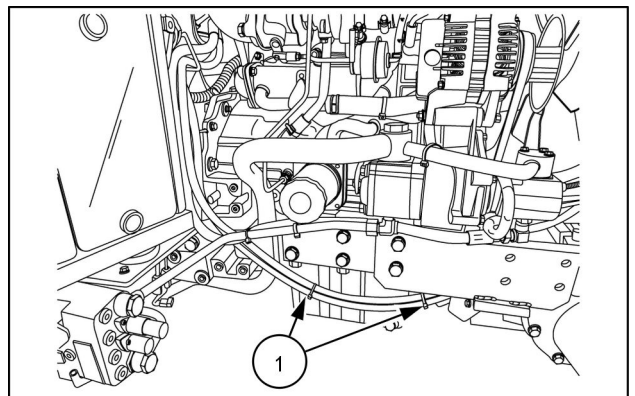

NHIL16CT01377AA 7

10. Disconnect the right-hand and left-hand steering hoses (1).

**NOTE:** Cap off all hydraulic and fuel fittings or tubes to prevent contamination.

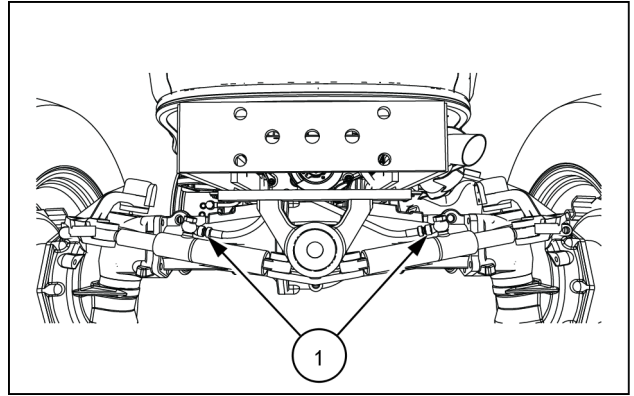

NHIL16CT01037AA 8

11. Remove the steering hoses from the top of the front axle by unfolding the hose stays (1).
12. Route the steering hoses from under the front frame and place them away from the engine.

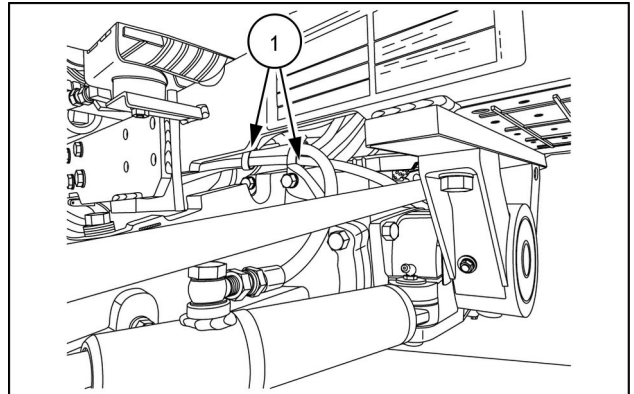

NHIL16CT00995AA 9

13. Loosen the hose clamps (1) and slide the suction tube coupler (2) rear-ward.

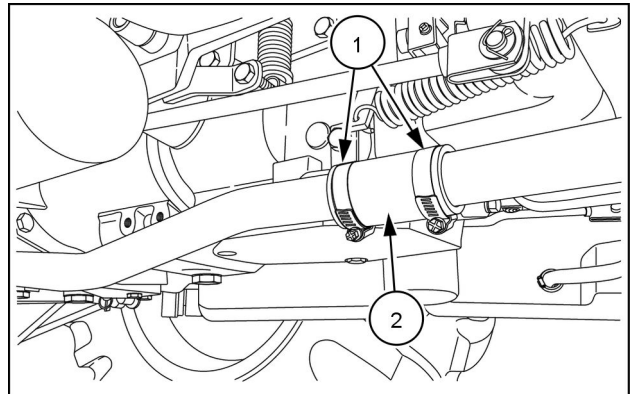

NHIL16CT00550AA 10

14. Remove the banjo bolt **(2)** from the main hydraulic pump.
15. Remove the three M6 bolts **(3)** from the steering pump suction fitting **(4)**.
16. Remove the suction tube **(5)**.
17. Disconnect the steering pump outlet hose **(6)**. Cap off the hose and route the hose away from the engine.
18. Disconnect the main hydraulic pump outlet pipe **(7)**.
19. For Roll Over Protective Structure (ROPS) tractor:
  1. Disconnect the steering pump outlet hose **(6)**. Cap off the hose and route the hose away from the engine.
20. For mechanical transmissions:
  1. Remove the banjo bolt **(8)** from the Mid Mount Valve (MMV) pressure port.
  2. Remove the main hydraulic pump outlet pipe **(1)** from the MMV.
21. For Hydro-Static Transmissions (HST):
  1. Remove the main hydraulic pump outlet pipe **(1)** from the union fitting **(2)**.

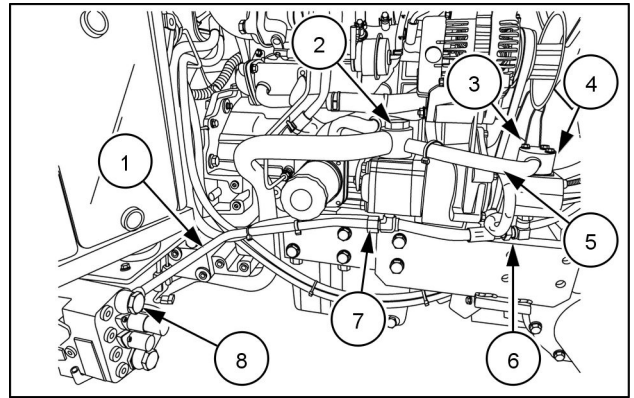

NHIL16CT01377AA 11

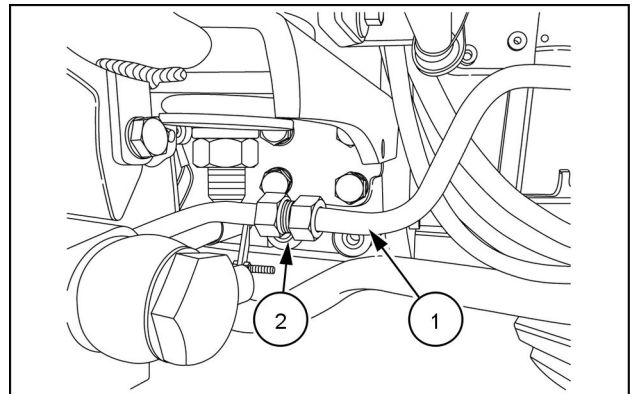

NHIL15CT00802AA 12

**Cab tractor only**

22. Disconnect the steering pressure hose **(2)** at the back side of the resonator **(1)**. Cap off the hose and route the hose away from the engine.

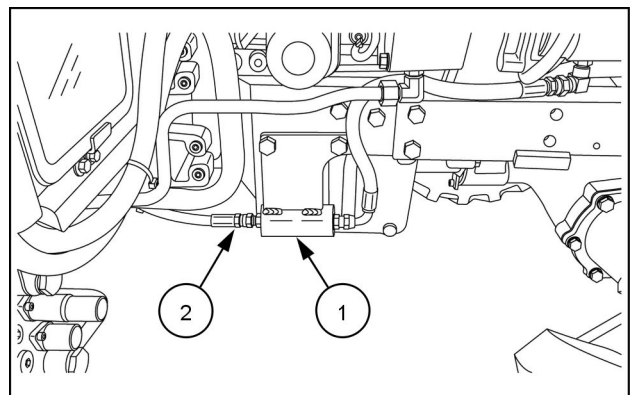

NHIL17CT00216AA 13



**Suggest:**

**If the above button click is invalid.**

**Please download this document**

**first, and then click the above link**

**to download the complete manual.**

**Thank you so much for reading**

23. Disconnect the two heater coolant hoses (1) on the right side of the machine.

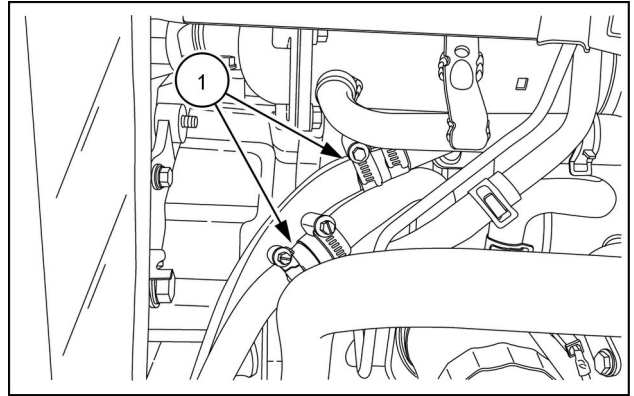

NHIL16CT01417AA 14

24. Disconnect the air conditioning lines at quick disconnects (1) on the left side of the machine.

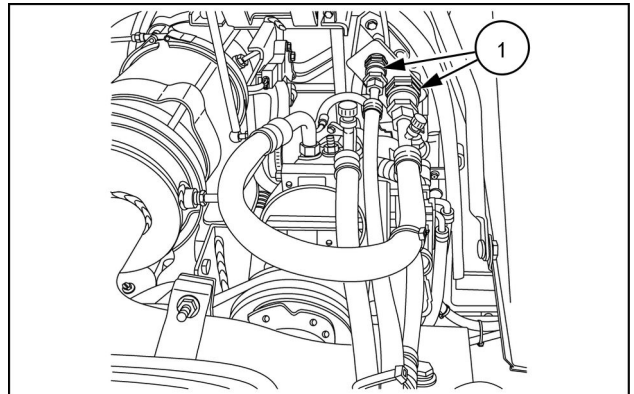

NHIL16CT01488AA 15

### Left-hand side

25. Remove the coated nut and remove the shield (1) from the starter motor solenoid.

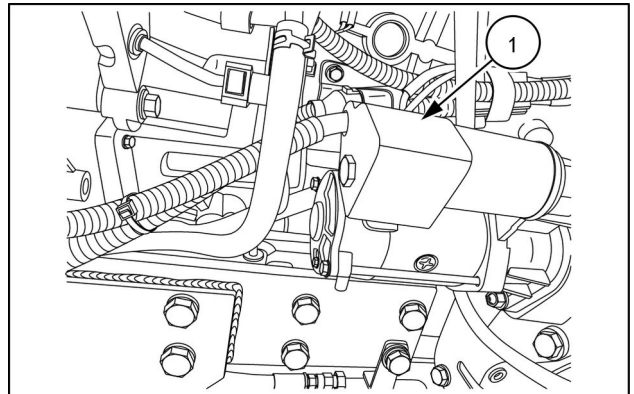

NHIL16CT01381AA 16

26. Remove the M8 flange nut and remove the power cable (1) from the stud.

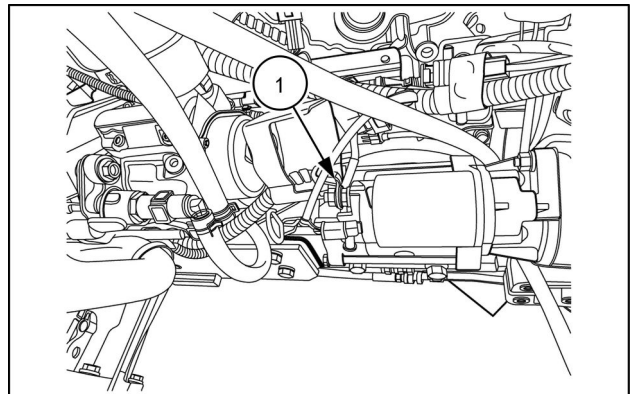

NHIL16CT01385AA 17

**<https://www.ebooklibonline.com>**

Hello dear friend!

Thank you very much for reading.

Enter the link into your browser.

The full manual is available for immediate download.

**<https://www.ebooklibonline.com>**