

SERVICE MANUAL

DI50B Crawler Dozer

Part number 47998875B

3rd edition English

June 2018





SERVICE MANUAL

**D150B XLT, With cab, Tier 3, Power Angle Tilt (PAT) Blade, Made in Brazil
[N9AC03000 -]**

Link Product / Engine

Product	Market Product	Engine
D150B XLT, com cabine, Tier 3, lâmina Power Angle Tilt (PAT), produzido no Brasil [N9AC03000 -]	Latin America	F4HE9684U*J101

<https://www.ebooklibonline.com>

Hello dear friend!

Thank you very much for reading.

Enter the link into your browser.

The full manual is available for immediate download.

<https://www.ebooklibonline.com>

Contents

INTRODUCTION

Engine.....	10
[10.001] Engine and crankcase	10.1
[10.400] Engine cooling system	10.2
[10.310] Aftercooler.....	10.3
[10.304] Engine lubrication system.....	10.4
Rear axle system.....	27
[27.120] Planetary and final drives	27.1
[27.126] Spur gear and final drives.....	27.2
Hydrostatic drive.....	29
[29.100] Transmission and steering hydrostatic control	29.1
[29.202] Hydrostatic transmission	29.2
Brakes and controls	33
[33.202] Hydraulic service brakes	33.1
Hydraulic systems.....	35
[35.000] Hydraulic systems.....	35.1
[35.104] Fixed displacement pump.....	35.2
[35.310] Distributor and lines	35.3
[35.350] Safety and main relief valves	35.4
[35.741] Dozer blade cylinders	35.5
[35.742] Ripper hydraulic system.....	35.6
Tracks and track suspension.....	48
[48.130] Track frame and driving wheels.....	48.1
[48.110] Front suspension	48.2
[48.100] Tracks	48.3
[48.134] Track tension units	48.4

[48.138] Track rollers	48.5
Cab climate control	50
[50.100] Heating	50.1
[50.200] Air conditioning	50.2
Electrical systems	55
[55.013] Engine oil system	55.1
[55.000] Electrical system	55.2
[55.100] Harnesses and connectors	55.3
[55.525] Cab engine controls	55.4
[55.015] Engine control system	55.5
[55.201] Engine starting system	55.6
[55.301] Alternator	55.7
[55.302] Battery	55.8
[55.202] Cold start aid	55.9
[55.010] Fuel injection system	55.10
[55.012] Engine cooling system	55.11
[55.019] Hydrostatic drive control system	55.12
[55.050] Heating, Ventilation, and Air-Conditioning (HVAC) control system	55.13
[55.408] Warning indicators, alarms, and instruments	55.14
[55.101] Chassis harness	55.15
[55.014] Engine intake and exhaust system	55.16
[55.DTC] FAULT CODES	55.17
Dozer blade and arm	86
[86.110] Dozer blade	86.1
Tools	89
[89.128] Ripper assembly	89.1
Platform, cab, bodywork, and decals	90
[90.150] Cab	90.1

[90.114] Operator protections 90.2
[90.124] Pneumatically-adjusted operator seat..... 90.3



INTRODUCTION

Foreword - Important notice regarding equipment servicing

D150B XLT, With cab, Tier 3, Power Angle Tilt (PAT) Blade, Made in Brazil [N9AC03000 -]	LA
---------------------------------------------------------------------------------------------	----

All repair and maintenance work listed in this manual must be carried out only by qualified dealership personnel, strictly complying with the instructions given, and using, whenever possible, the special tools.

Anyone who performs repair and maintenance operations without complying with the procedures provided herein shall be responsible for any subsequent damages.

The manufacturer and all the organizations of its distribution chain, including - without limitation - national, regional, or local dealers, reject any responsibility for damages caused by parts and/or components not approved by the manufacturer, including those used for the servicing or repair of the product manufactured or marketed by the manufacturer. In any case, no warranty is given or attributed on the product manufactured or marketed by the manufacturer in case of damages caused by parts and/or components not approved by the manufacturer.

The manufacturer reserves the right to make improvements in design and changes in specifications at any time without notice and without incurring any obligation to install them on units previously sold. Specifications, descriptions, and illustrative material herein are as accurate as known at time of publication but are subject to change without notice.

In case of questions, refer to your NEW HOLLAND CONSTRUCTION Sales and Service Networks.

Foreword - How to use and navigate through this manual

D150B XLT, With cab, Tier 3, Power Angle Tilt (PAT) Blade, Made in Brazil [N9AC03000 -]	LA
---------------------------------------------------------------------------------------------	----

This manual has been produced by a new technical information system. This new system is designed to deliver technical information electronically through web delivery (eTIM), DVD, and paper manuals. A coding system called SAP has been developed to link the technical information to other Product Support functions, e.g., Warranty.

Technical information is written to support the maintenance and service of the functions or systems on a customer's machine. When a customer has a concern on their machine it is usually because a function or system on their machine is not working at all, is not working efficiently, or is not responding correctly to their commands. When you refer to the technical information in this manual to resolve that customer's concern, you will find all the information classified using the SAP coding, according to the functions or systems on that machine. Once you have located the technical information for that function or system, you will then find all the mechanical, electrical or hydraulic devices, components, assemblies, and sub assemblies for that function or system. You will also find all the types of information that have been written for that function or system: the technical data (specifications), the functional data (how it works), the diagnostic data (fault codes and troubleshooting), and the service data (remove, install adjust, etc.).

By integrating SAP coding into technical information, you will be able to search and retrieve just the right piece of technical information you need to resolve that customer's concern on his machine. This is made possible by attaching 3 categories to each piece of technical information during the authoring process.

The first category is the Location, the second category is the Information Type and the third category is the Product:

- **LOCATION** - the component or function on the machine, that the piece of technical information is going to describe (e.g., Fuel tank).
- **INFORMATION TYPE** - the piece of technical information that has been written for a particular component or function on the machine (e.g., Capacity would be a type of Technical Data describing the amount of fuel held by the fuel tank).
- **PRODUCT** - the model for which the piece of technical information is written.

Every piece of technical information will have those three categories attached to it. You will be able to use any combination of those categories to find the right piece of technical information you need to resolve that customer's concern on their machine.

That information could be:

- the procedure for how to remove the cylinder head
- a table of specifications for a hydraulic pump
- a fault code
- a troubleshooting table
- a special tool

Manual content

This manual is divided into Sections. Each Section is then divided into Chapters. Contents pages are included at the beginning of the manual, then inside every Section and inside every Chapter. An alphabetical Index is included at the end of each Chapter. Page number references are included for every piece of technical information listed in the Chapter Contents or Chapter Index.

Each Chapter is divided into four Information types:

- Technical Data (specifications) for all the mechanical, electrical or hydraulic devices, components, assemblies or sub-assemblies.
- Functional Data (how it works) for all the mechanical, electrical or hydraulic devices, components, assemblies or sub-assemblies.
- Diagnostic Data (fault codes, electrical and hydraulic troubleshooting) for all the mechanical, electrical or hydraulic devices, components, assemblies or sub-assemblies.
- Service Data (remove disassemble, assemble, install) for all the mechanical, electrical or hydraulic devices, components, assemblies or sub-assemblies.

Sections

Sections are grouped according to the main functions or a systems on the machine. Each Section is identified by a number (00, 35, 55, etc.). The Sections included in the manual will depend on the type and function of the machine that the manual is written for. Each Section has a Contents page listed in alphabetic/numeric order. This table illustrates which Sections could be included in a manual for a particular product.

SECTION	PRODUCT					
	Tractors					
	Vehicles with working arms: backhoes, excavators, skid steers,					
	Combines, forage harvesters, balers,					
	Seeding, planting, floating, spraying equipment,					
	Mounted equipment and tools,					
00 - Maintenance	X	X	X	X	X	
05 - Machine completion and equipment	X	X	X	X	X	
10 - Engine	X	X	X	X		
14 - Main gearbox and drive	X	X	X	X		
18 - Clutch	X	X	X			
21 - Transmission	X	X	X	X		
23 - Four wheel drive (4WD) system	X	X	X	X		
25 - Front axle system	X	X	X	X		
27 - Rear axle system	X	X	X	X		
29 - Hydrostatic drive	X	X	X	X		
31 - Power Take-Off (PTO)	X		X			
33 - Brakes and controls	X	X	X	X		
35 - Hydraulic systems	X	X	X	X		
36 - Pneumatic system	X	X	X	X		
37 - Hitches, drawbars and implement couplings	X		X	X		
39 - Frames and ballasting	X	X	X	X	X	
41 - Steering	X	X	X	X		
44 - Wheels	X	X	X	X		
46 - Steering clutches						
48 - Tracks and track suspension	X	X	X			
50 - Cab climate control	X	X	X	X		
55 - Electrical systems	X	X	X	X	X	
56 - Grape harvester shaking						
58 - Attachments/headers			X			
60 - Product feeding			X			

INTRODUCTION

61 - Metering system				X	
62 - Pressing - Bale formation			X		
63 - Chemical applicators				X	
64 - Chopping			X		
66 - Threshing			X		
68 - Tying/Wrapping/Twisting			X		
69 - Bale wagons					
70 - Ejection			X		
71 - Lubrication system	X	X	X	X	X
72 - Separation			X		
73 - Residue handling			X		
74 - Cleaning			X		
75 - Soil preparation/Finishing					
76 - Secondary cleaning / Destemmer					
77 - Seeding				X	
78 - Spraying				X	
79 - Planting				X	
80 - Crop storage / Unloading			X		
82 - Front loader and bucket	X	X			
83 - Telescopic single arm	X	X			
84 - Booms, dippers and buckets	X	X			
86 - Dozer blade and arm	X	X			
88 - Accessories	X	X	X	X	X
89 - Tools	X	X	X	X	X
90 - Platform, cab, bodywork and decals	X	X	X	X	

Product overview - (Machine Components)

D150B XLT, With cab, Tier 3, Power Angle Tilt (PAT) Blade, Made in Brazil [N9AC03000 -] LA

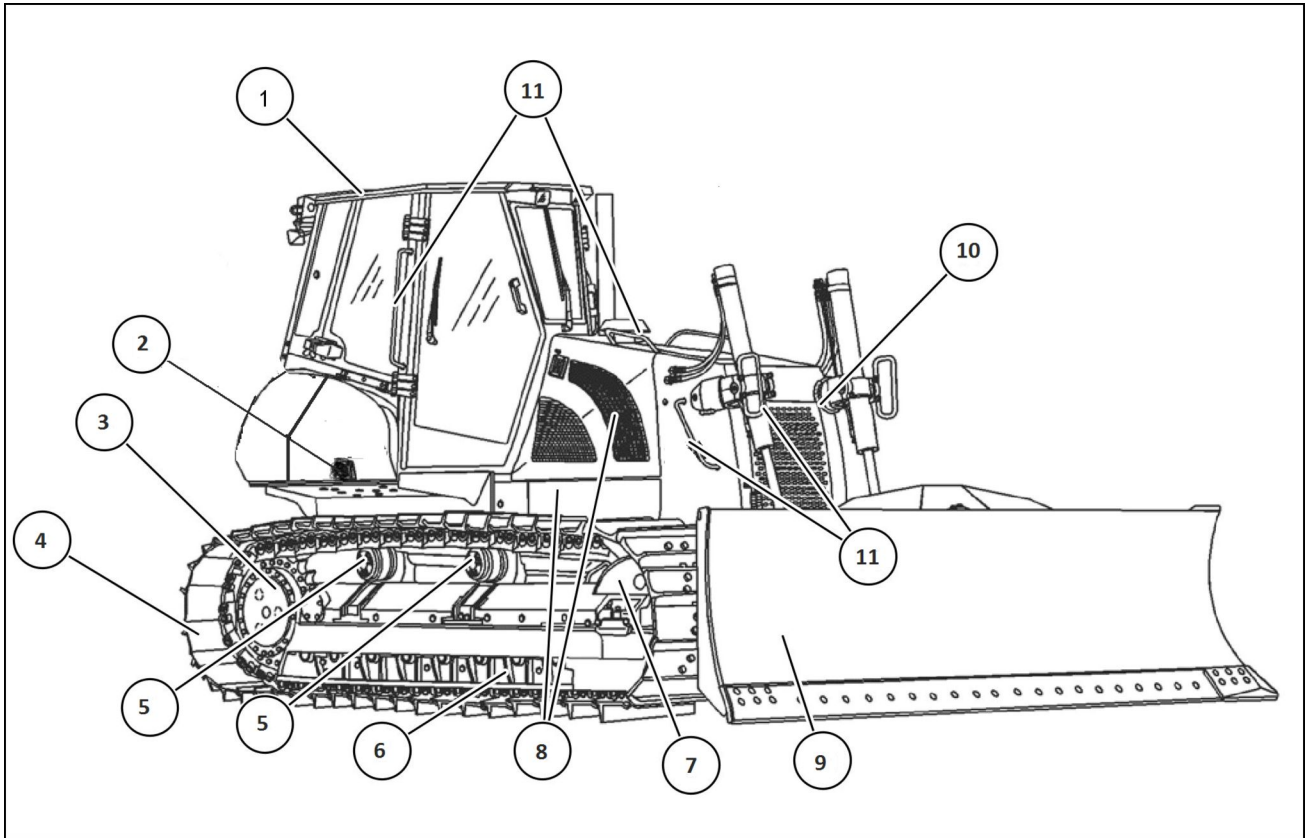

BRCE12DOCNH0004 1

- (1) Cab
- (2) Right rear access door
- (3) Travel reducer
- (4) Track
- (5) Top track roller
- (6) Lower track roller
- (7) Track tensioner wheel
- (8) Right-hand access door to the engine compartment and side shield panel
- (9) Blade
- (10) Radiator compartment door
- (11) Front handholds



SERVICE MANUAL

Engine

**D150B XLT, With cab, Tier 3, Power Angle Tilt (PAT) Blade, Made in Brazil
[N9AC03000 -]**

Engine - Remove

D150B XLT, With cab, Tier 3, Power Angle Tilt (PAT) Blade, Made in Brazil [N9AC03000 -]	LA
---------------------------------------------------------------------------------------------	----

NOTE: If the machine is equipped with a brush shield, continue to item 1. Otherwise, go to item 2.

1. Attach appropriate lifting equipment to the brush shield. Remove the two lower bolts and jam nuts. Remove the two upper bolts and washers that secure the upper brush shield. Remove the brush shield.
2. Open the engine side panels. Disconnect the hose from the coolant reservoir. Remove the engine side panels.
3. Make sure that the engine is cold. Slowly remove the radiator cap. Connect a hose to the drain valve. Drain the contents of the radiator into a suitable container.
4. Place a label on the wires. Disconnect the wires from the air filter restriction switch.

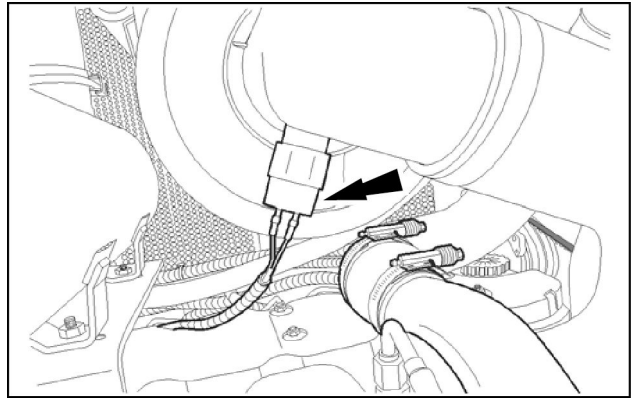

LAIL11CD0252A0A 1

5. Remove the after cooler line.

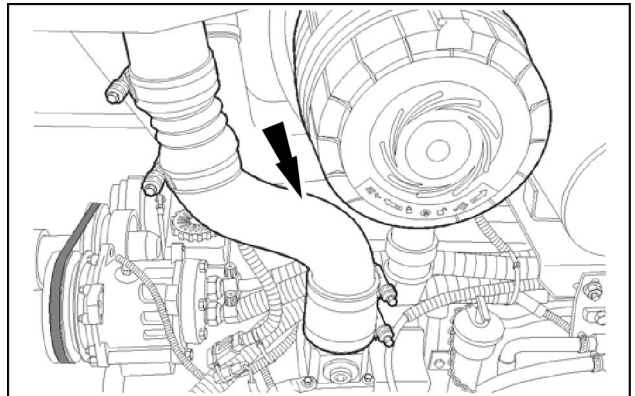

LAIL11CD0253A0A 2

6. Remove the air filter hose. Disconnect the crankcase ventilation hose.

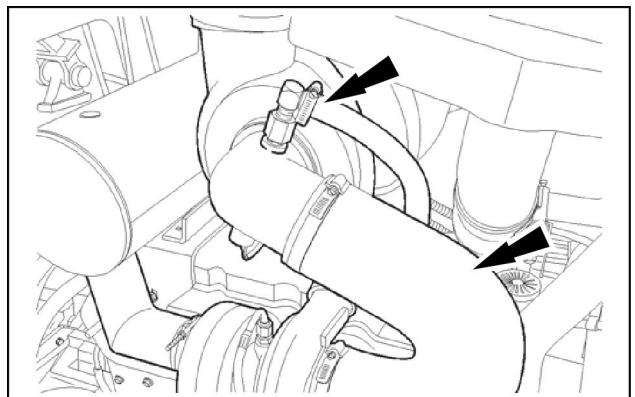

LAIL11CD0254A0A 3

7. Remove the after cooler line.

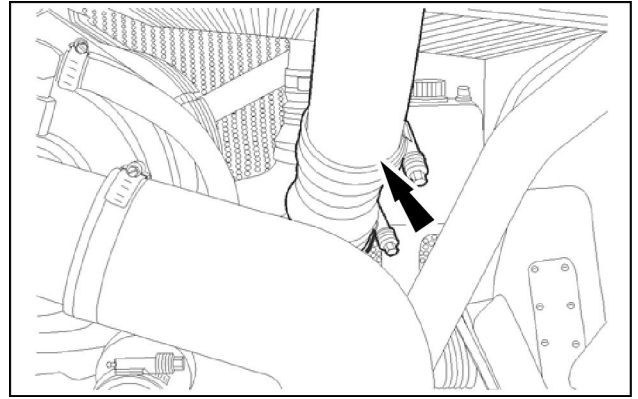

LAIL11CD0255A0A 4

8. Remove the two plugs. Remove the front mounting bolts from the hood.

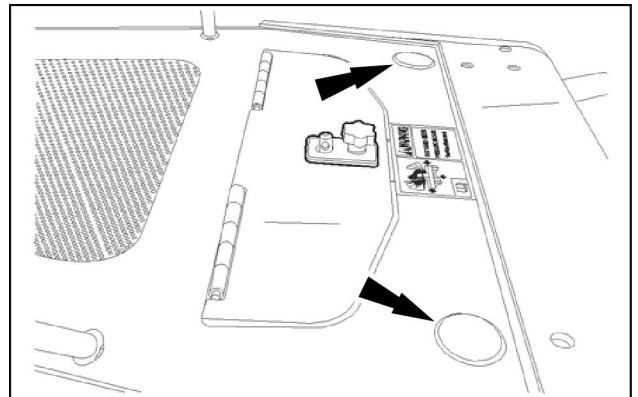

LAIL11CD0256A0A 5

9. Remove the two plugs. Remove the rear mounting bolts from the hood.
10. Connect the lifting equipment to the hood. Remove the hood from the machine.

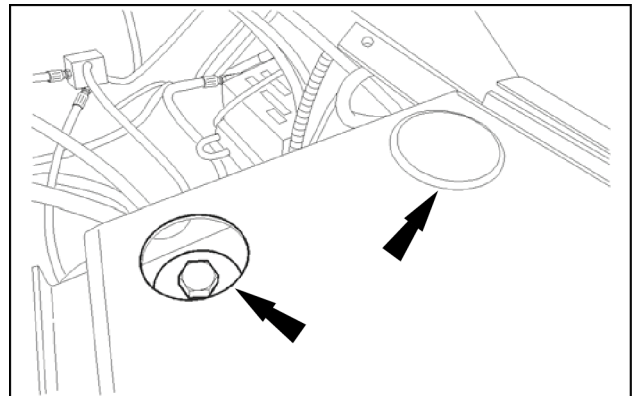

LAIL11CD0257A0A 6

11. Remove the upper radiator hose.

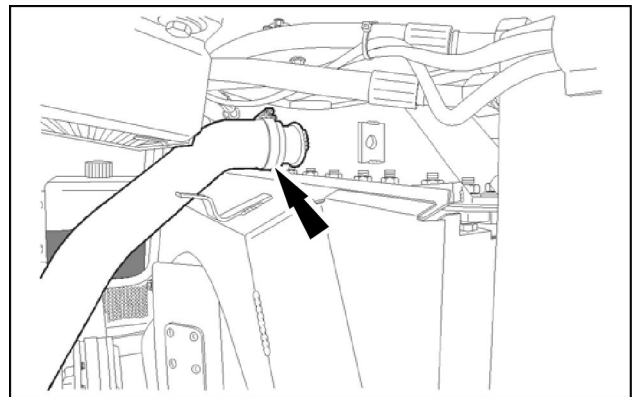

LAIL11CD0258A0A 7

12. Disconnect the lower radiator hose.

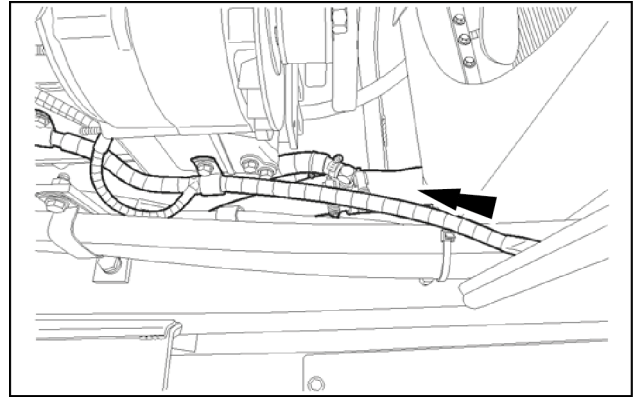

LAIL11CD0259A0A 8

13. Remove the fan and the spacer from the engine.

- (1) Spacer
- (2) Fan mounting bolts (4)

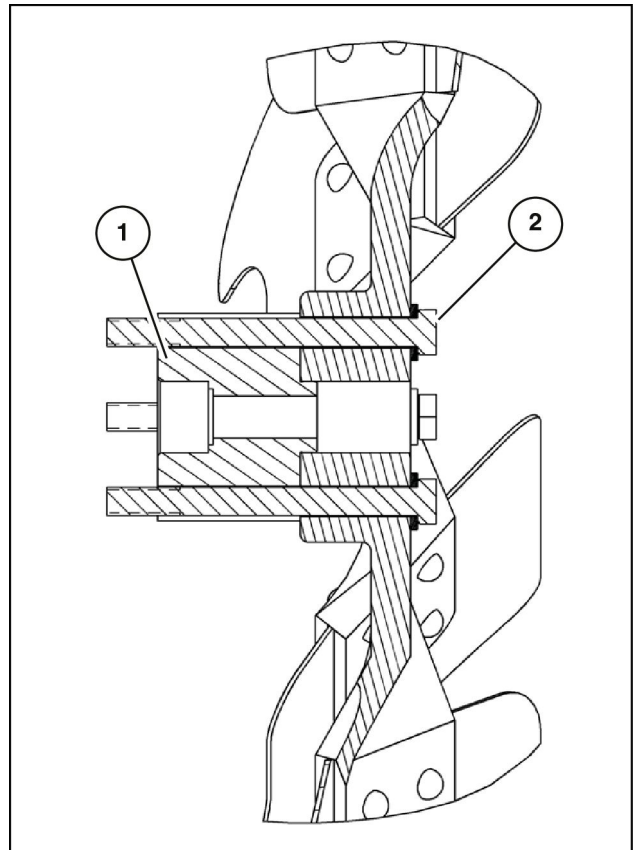

LAIL11CD0369B0A 9

14. Tilt the cab or ROPS canopy. See **Roll Over Protective Structure (ROPS) frame - Tilt (90.114)**.
15. If the machine is equipped with a heater, loosen the fixing clamp. Connect the heater hose.

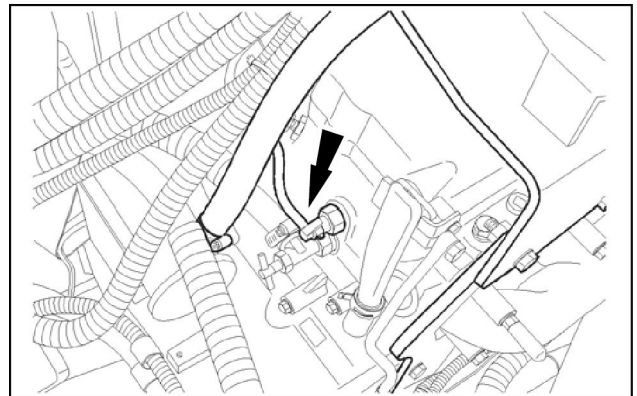

LAIL11CD0260A0A 10



Suggest:

If the above button click is invalid.

Please download this document

first, and then click the above link

to download the complete manual.

Thank you so much for reading

16. Disconnect the alternator wires.

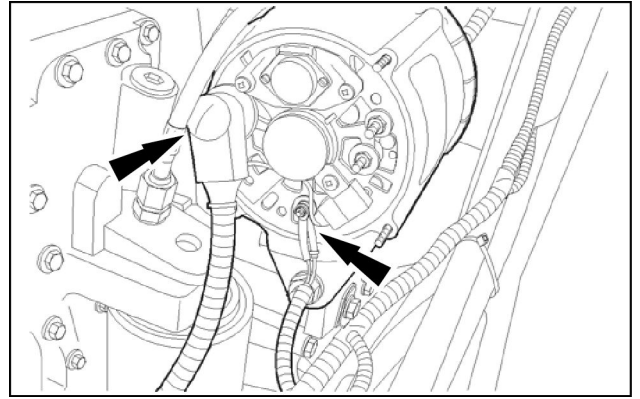

LAIL11CD0261A0A 11

17. Disconnect the battery cable and the electrical harness wires from the starter motor.

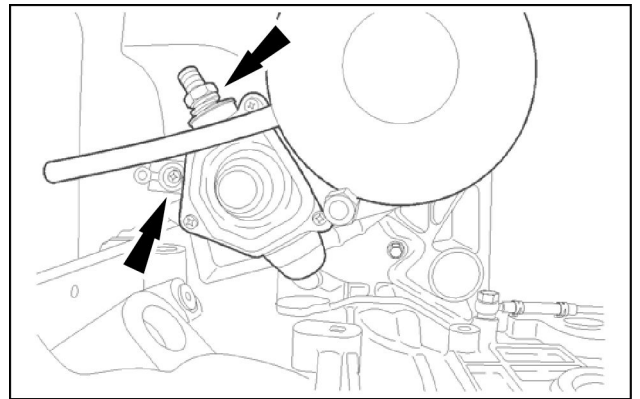

LAIL11CD0262A0A 12

18. Discharge the air-conditioning system, if the machine has one. See **Air conditioning - Charging (50.200)**. Disconnect the clutch electrical connector and the compressor hoses. Plug the hoses and cap the fittings.

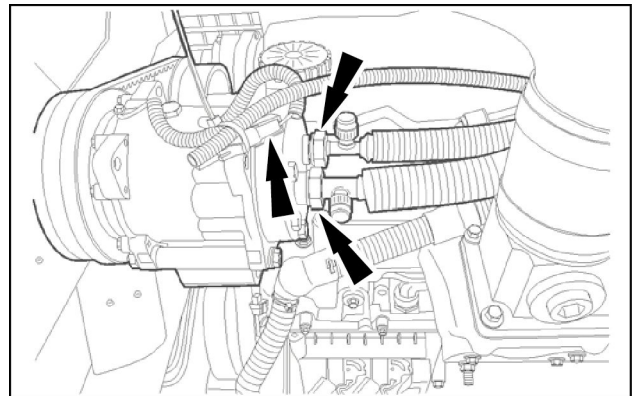

LAIL11CD0263A0A 13

19. Disconnect the electrical connector from the engine controller.

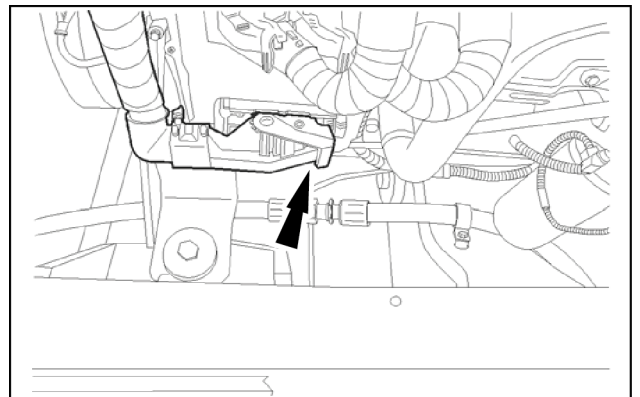

LAIL11CD0264A0A 14

<https://www.ebooklibonline.com>

Hello dear friend!

Thank you very much for reading.

Enter the link into your browser.

The full manual is available for immediate download.

<https://www.ebooklibonline.com>