

1. Trim along dashed line.
2. Slide into pocket on Binder Spine.

TYPE 1-4

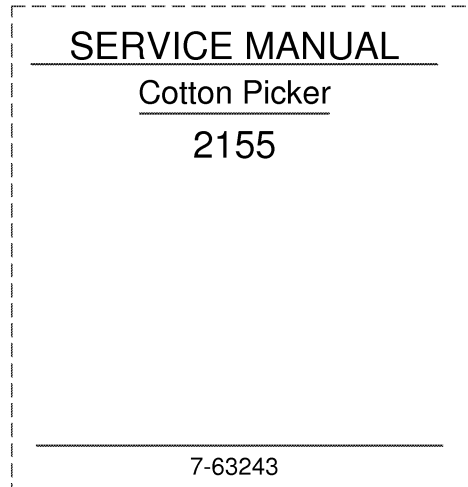

1. Trim along dashed line.
2. Slide into pocket on Binder Spine.

TYPE 1-4

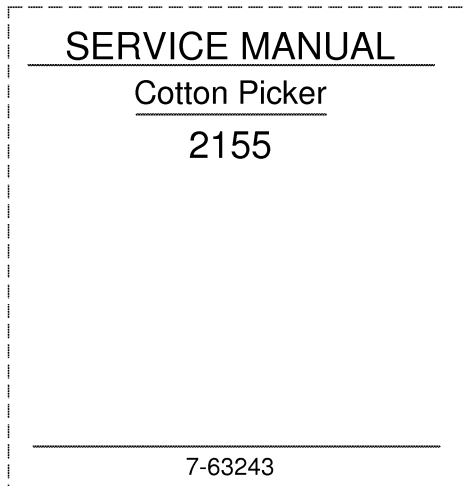

1. Trim along dashed line.
2. Slide into pocket on Binder Spine.

TYPE 1-4

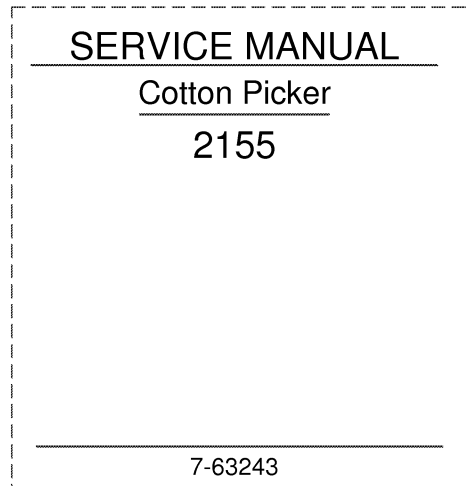

1. Trim along dashed line.
2. Slide into pocket on Binder Spine.

TYPE 1-4

2155 Cotton Picker
Service Manual No.7-63243
Table of Contents

Description	PC Code	Section No.	Form No.
General		Tab 1	
LOCTITE® Product Chart	2		8-98902
Standard Torque Specifications	5	1001	8-71602
Fluid and Lubricants	4	1010	7-63272
Engine		Tab 2	
6TA-830 Engine			
Aftercooler	6	2011	8-91703
Specification Details	10	2403	8-28426
Cylinder Head and Valve Train	42	2415	8-28434
Cylinder Block	80	2425	8-28444
Lubrication System	14	2445	8-28453
Cooling System	12	2455	8-28464
Turbocharger	26	2465	8-28471
Fuel System		Tab 3	
Fuel System and Filters	4	3410	8-28482
Injection Pump	28	3412	8-28494
Fuel Injectors	22	3413	8-28503
Electrical		Tab 4	
Electrical Schematics and Troubleshooting	52	4002	7-62820
Electrical Schematic Prior to P.I.N. JJC0156231 (Refer to pocket at rear of Service Manual)			7-63750
Electrical Schematic P.I.N. JJC0156231 and after (Refer to pocket at rear of Service Manual)			7-66390
Starting Motor - Nippendoso	22	4011	8-95970
Battery Servicing and Testing	10	4235	8-20291
Alternator	24	4240	7-62451
Steering		Tab 5	
Steering Axle	16	5003	8-99061
Steering Hand Pump	14	5020	7-62571
Steering Cylinder	12	5030	8-62441

Description	PC Code	Section No.	Form No.
Power Train		Tab 6	
Foot - N - Inch Valve	4	6015	7-63830
Hydrostatic Drive Pump Service	14	6018	7-64341
Hydrostatic Drive Motor Service	10	6030	7-64121
Transmission Service	40	6040	7-63351
Drum Drive	16	6051	8-82772
Final Drives	14	6060	7-63491
Cable Adjustment	6	6080	7-89540
Brakes		Tab 7	
Brake Assemblies	13	7010	7-62541
Master Brake Valve	13	7020	7-62550
Hydraulics		Tab 8	
Hydraulic Schematic and Troubleshooting	28	8002	7-62810
Hydraulic Schematic (Refer to pocket at rear of Service Manual)			7-63750
Hydraulic Oil Filter	4	8030	7-63291
Hydraulic Pump and Compensator	33	8040	8-62480
Hydraulic Gear Pump	10	8045	7-86310
Hydraulic Manifold Valve	6	8051	8-99022
Height Control Valves and Cylinders	12	8062	8-99111
Chassis		Tab 9	
Air Conditioning Troubleshooting	21	9010	7-86210
Air Conditioning System Gauges and Testing	24	9020	7-63310
Air Conditioning System Service for R134A	12	9030	7-85540
Air Conditioning Components Service	30	9040	7-63331
Air Suspension Seat	8	9065	7-60911
Fan Assembly	22	9070	8-62222
Pressure Moistener System	10	9075	7-64011
Picker Drum Removal and Installation	8	9081	8-99191
Picker Drum Service	54	9091	6-11951
Picker Bar and Spindle Lubrication System	6	9092	8-98611
Drum Gearboxes and Input Driveshaft	12	9093	8-99101

<https://www.ebooklibonline.com>

Hello dear friend!

Thank you very much for reading.

Enter the link into your browser.

The full manual is available for immediate download.

<https://www.ebooklibonline.com>

Section 1001

GENERAL TORQUE SPECIFICATIONS

TABLE OF CONTENTS

TORQUE SPECIFICATIONS - DECIMAL HARDWARE	3
TORQUE SPECIFICATIONS - METRIC HARDWARE	4
TORQUE SPECIFICATIONS - STEEL HYDRAULIC FITTINGS	5
TORQUE SPECIFICATIONS - STEEL HYDRAULIC FITTINGS	6

TORQUE SPECIFICATIONS - DECIMAL HARDWARE

Use the torques in this chart when special torques are not given. These torques apply to fasteners with both UNC and UNF threads as received from suppliers dry, or when lubricated with engine oil. Not applicable if special graphities, Molydisulfide greases, or other extreme pressure lubricants are used.

Grade 5 Bolts, Nuts, and Studs		
		
Size	Pound-Inches	Newton metres
1/4 inch	108 to 132	12 to 15
5/16 inch	204 to 252	23 to 28
3/8 inch	420 to 504	48 to 57
Size	Pound-Feet	Newton metres
7/16 inch	54 to 64	73 to 87
1/2 inch	80 to 96	109 to 130
9/16 inch	110 to 132	149 to 179
5/8 inch	150 to 180	203 to 244
3/4 inch	270 to 324	366 to 439
7/8 inch	400 to 480	542 to 651
1.0 inch	580 to 696	787 to 944
1-1/8 inch	800 to 880	1085 to 1193
1-1/4 inch	1120 to 1240	1519 to 1681
1-3/8 inch	1460 to 1680	1980 to 2278
1-1/2 inch	1940 to 2200	2631 to 2983

Grade 8 Bolts, Nuts, and Studs		
		
Size	Pound-Inches	Newton metres
1/4 inch	144 to 180	16 to 20
5/16 inch	288 to 348	33 to 39
3/8 inch	540 to 648	61 to 73
Size	Pound-Feet	Newton metres
7/16 inch	70 to 84	95 to 114
1/2 inch	110 to 132	149 to 179
9/16 inch	160 to 192	217 to 260
5/8 inch	220 to 264	298 to 358
3/4 inch	380 to 456	515 to 618
7/8 inch	600 to 720	814 to 976
1.0 inch	900 to 1080	1220 to 1465
1-1/8 inch	1280 to 1440	1736 to 1953
1-1/4 inch	1820 to 2000	2468 to 2712
1-3/8 inch	2380 to 2720	3227 to 3688
1-1/2 inch	3160 to 3560	4285 to 4827

NOTE: Use thick nuts with Grade 8 bolts.

TORQUE SPECIFICATIONS - METRIC HARDWARE

Use the following torques when specifications are not given.

These values apply to fasteners with coarse threads as received from supplier, plated or unplated, or when lubricated with engine oil. These values do not apply if graphite or Molydisulfide grease or oil is used.

Grade 8.8 Bolts, Nuts, and Studs		
		
Size	Pound-Inches	Newton metres
M4	24 to 36	3 to 4
M5	60 to 72	7 to 8
M6	96 to 108	11 to 12
M8	228 to 276	26 to 31
M10	456 to 540	52 to 61
Size	Pound-Feet	Newton metres
M12	66 to 79	90 to 107
M14	106 to 127	144 to 172
M16	160 to 200	217 to 271
M20	320 to 380	434 to 515
M24	500 to 600	675 to 815
M30	920 to 1100	1250 to 1500
M36	1600 to 1950	2175 to 2600

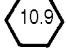
Grade 10.9 Bolts, Nuts, and Studs		
		
Size	Pound-Inches	Newton metres
M4	36 to 48	4 to 5
M5	84 to 96	9 to 11
M6	132 to 156	15 to 18
M8	324 to 384	37 to 43
Size	Pound-Feet	Newton metres
M10	54 to 64	73 to 87
M12	93 to 112	125 to 150
M14	149 to 179	200 to 245
M16	230 to 280	310 to 380
M20	450 to 540	610 to 730
M24	780 to 940	1050 to 1275
M30	1470 to 1770	2000 to 2400
M36	2580 to 3090	3500 to 4200

Grade 12.9 Bolts, Nuts, and Studs

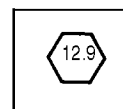

Usually the torque values specified for grade 10.9 fasteners can be used satisfactorily on grade 12.9 fasteners.

TORQUE SPECIFICATIONS - STEEL HYDRAULIC FITTINGS

Tube OD Hose ID	Thread Size	Pound- Inches	Newton metres
37 Degree Flare Fitting			
1/4 inch 6.4 mm	7/16-20	72 to 144	8 to 16
5/16 inch 7.9 mm	1/2-20	96 to 192	11 to 22
3/8 inch 9.5 mm	9/16-18	120 to 300	14 to 34
1/2 inch 12.7 mm	3/4-16	180 to 504	20 to 57
5/8 inch 15.9 mm	7/8-14	300 to 696	34 to 79
Tube OD Hose ID	Thread Size	Pound- Inches	Newton metres
3/4 inch 19.0 mm	1-1/16-12	40 to 80	54 to 108
7/8 inch 22.2 mm	1-3/16-12	60 to 100	81 to 135
1.0 inch 25.4 mm	1-5/16-12	75 to 117	102 to 158
1-1/4 inch 31.8 mm	1-5/8-12	125 to 165	169 to 223
1-1/2 inch 38.1 mm	1-7/8-12	210 to 250	285 to 338

Tube OD Hose ID	Thread Size	Pound- Inches	Newton metres
Straight Threads with O-ring			
1/4 inch 6.4 mm	7/16-20	144 to 228	16 to 26
5/16 inch 7.9 mm	1/2-20	192 to 300	22 to 34
3/8 inch 9.5 mm	9/16-18	300 to 480	34 to 54
1/2 inch 12.7 mm	3/4-16	540 to 804	57 to 91
Tube OD Hose ID	Thread Size	Pound- Inches	Newton metres
5/8 inch 15.9 mm	7/8-14	58 to 92	79 to 124
3/4 inch 19.0 mm	1-1/16-12	80 to 128	108 to 174
7/8 inch 22.2 mm	1-3/16-12	100 to 160	136 to 216
1.0 inch 25.4 mm	1-5/16-12	117 to 187	159 to 253
1-1/4 inch 31.8 mm	1-5/8-12	165 to 264	224 to 357
1-1/2 inch 38.1 mm	1-7/8-12	250 to 400	339 to 542

Split Flange Mounting Bolts		
Size	Pound- Inches	Newton metres
5/16-18	180 to 240	20 to 27
3/8-16	240 to 300	27 to 34
7/16-14	420 to 540	47 to 61
Size	Pound- Feet	Newton metres
1/2-13	55 to 65	74 to 88
5/8-11	140 to 150	190 to 203

TORQUE SPECIFICATIONS - STEEL HYDRAULIC FITTINGS

Nom. SAE Dash Size	Tube OD	Thread Size	Pound-Inches	Newton metres	Thread Size	Pound-Inches	Newton metres
O-ring Face Seal End					O-ring Boss End Fitting or Lock Nut		
-4	1/4 inch 6.4 mm	9/16-18	120 to 144	14 to 16	7/16-20	204 to 240	23 to 27
-6	3/8 inch 9.5 mm	11/16-16	216 to 240	24 to 27	9/16-18	300 to 360	34 to 41
-8	1/2 inch 12.7 mm	13/16-16	384 to 480	43 to 54	3/4-16	540 to 600	61 to 68
					Thread Size	Pound-Inches	Newton metres
-10	5/8 inch 15.9 mm	1-14	552 to 672	62 to 76	7/8-14	60 to 65	81 to 88
Nom. SAE Dash Size	Tube OD	Thread Size	Pound-Inches	Newton metres	1-1/16-12	85 to 90	115 to 122
					1-3/16-12	95 to 100	129 to 136
-12	3/4 inch 19.0 mm	1-3/16-12	65 to 80	90 to 110	1-5/16-12	115 to 125	156 to 169
-14	7/8 inch 22.2 mm	1-3/16-12	65 to 80	90 to 110	1-5/8-12	150 to 160	203 to 217
-16	1.0 inch 25.4 mm	1-7/16-12	92 to 105	125 to 140	1-7/8-12	190 to 200	258 to 271
-20	1-1/4 inch 31.8 mm	1-11/16-12	125 to 140	170 to 190			
-24	1-1/2 inch 38.1 mm	2-12	150 to 180	200 to 254			

Section 1010

FLUIDS AND LUBRICANTS

CASE CORPORATION
700 State Street
Racine, WI 53404 U.S.A.

CASE CANADA CORPORATION
3350 South Service Road
Burlington, ON L7N 3M6 CANADA

Rac 7-63272

© 1995 Case Corporation
Printed in U.S.A.
May, 2001

1010

TABLE OF CONTENTS

ENGINE	3
COOLING SYSTEM	3
FUEL SYSTEM	3
TRANSMISSION	3
FINAL DRIVE	3
HYDRAULIC RESERVOIR	3
CHASSIS DRIVE GEAR BOX	3
DRUM DRIVE GEAR BOX	3
AIR CONDITIONING REFRIGERANT CAPACITY	4
PICKER BAR AUTOMATIC LUBRICATION SYSTEM	4

ENGINE

Oil Type CASE No. 1 Engine Oil
 Oil Capacity - Without Filter Change 20 U.S. Quarts (19 Litres)
 Oil Capacity - With Filter Change 22 U.S. Quarts (21 Litres)

NOTE: *DO NOT put Performance Additives or other oil additive products in the engine crankcase.*

COOLING SYSTEM

Coolant Type 50 Percent Mixture of Water and Ethylene Glycol Solution
 Coolant Capacity 35 U.S. Quarts (33.1 Litres)

IMPORTANT: *Use only heavy duty low silicate coolant. Automotive antifreeze purchased at local supply store outlets most likely is not low silicate and must not be used in Case engines.*

FUEL SYSTEM

Fuel Type ASTM D975 Grade 2-D Number 2 Diesel Fuel
 Fuel Capacity 150 U.S. Gallons (567 Litres)

TRANSMISSION

Oil Type CASE HY-TRAN® ULTRA
 Oil Capacity 15 U.S. Quarts (14 Litres)

NOTE: *If brakes are removed from the transmission for service, an additional 1 U.S. Quart (0.95 Liter) per brake assembly must be added to the transmission.*

FINAL DRIVE

Oil Type CASE HY-TRAN® ULTRA
 Oil Capacity 7.5 U.S. Quarts (7.3 Litres)

HYDRAULIC RESERVOIR

Oil Type CASE HY-TRAN® ULTRA
 Reservoir Capacity 10 U.S. Gallons (38 Litres)
 System Capacity 18 U.S. Gallons (68 Litres)

CHASSIS GEAR BOX - RIGHT AND LEFT

Oil Type CASE 135H EP 85W 140 Gear Lubricant
 Oil Capacity (Each Gear Box) 1 1/2 U.S. Quarts (1.4 Litres)

DRUM TOP GEAR BOX

Oil Type CASE 135H EP 85W 140 Gear Lubricant
 Oil Capacity (Each Gear Box) 1 1/2 U.S. Quart (1.4 Litres)

AIR CONDITIONING REFRIGERANT CAPACITY

Air Conditioning System Refrigerant Capacity 4.41 lbs (2.00 kg)
Refrigerant Type HFC-134A

PICKER BAR AUTOMATIC LUBRICATION SYSTEM

Oil Type Picker Bar and Spindle Lubricant - PN 407515R1
Reservoir Capacity..... 60 U.S. Gallons (227 Litres)

IMPORTANT: *DO NOT substitute any other lubricant for this application. Improper lubrication will cause damage to the parts.*

NOTE: Case Corporation reserves the right to make improvements in design or changes in specifications at any time without incurring any obligation to install them on units previously sold.

Section 2011

AFTERCOOLER 6-830 Diesel Engine

IMPORTANT: *This engine was made using the metric measurement system. All measurements and checks must be made with metric tools to make sure of an accurate reading when inspecting parts.*

TABLE OF CONTENTS

SPECIAL TOOLS	2
SPECIAL TORQUES	2
SERVICING THE AFTERCOOLER	3
Removal	3
Installation	4

SPECIAL TOOLS

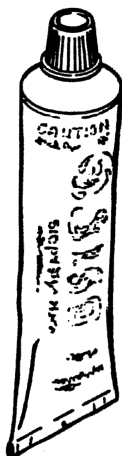

404L94
THREAD SEALANT WITH TEFLON - B17503 6ml TUBE



485L94
THREE BOND SILVER RTV SEALER
J823494 - 3 oz TUBE

SPECIAL TORQUES

Aftercooler Mounting Bolts	21 to 27 Nm
Crossover Tube Clamps	4 to 6 Nm

SERVICING THE AFTERCOOLER Removal

STEP 1

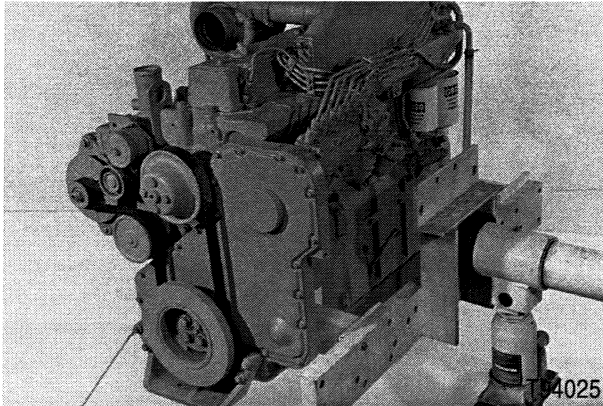

Case 6TA 830 engine.

STEP 4

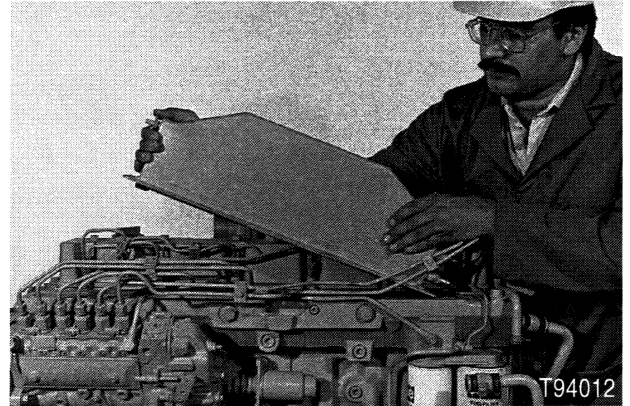

Remove the bolts and aftercooler. Discard the gasket. Clean the gasket surfaces. Inspect the housing and core for damage.

STEP 2

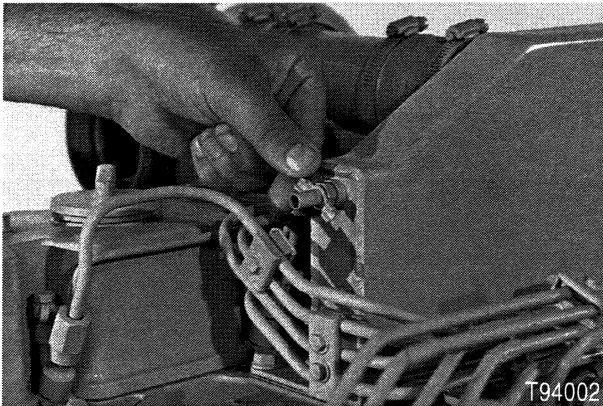

Drain the coolant from the engine. Open the air vent valve on the aftercooler to help drain the coolant.

STEP 5

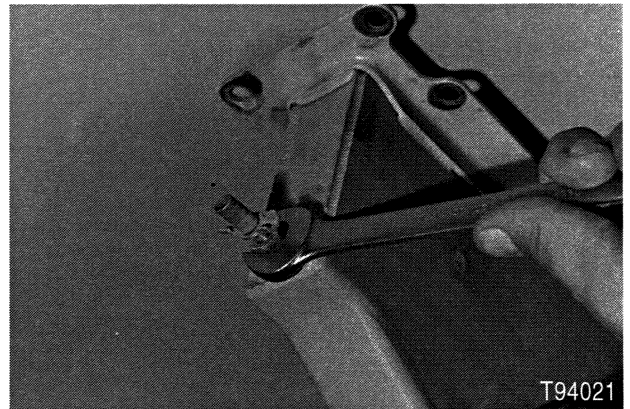

Remove the air vent valve from the aftercooler.

STEP 3

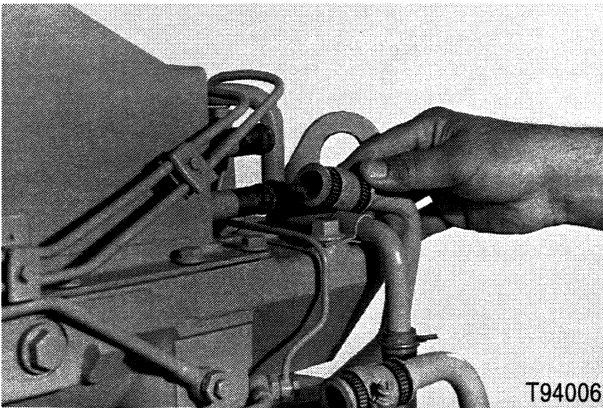

Remove all fuel lines and water hoses from the aftercooler.

STEP 6



77L91

Install a plug in the air vent valve and put a cap on one of the aftercooler water hose tube. Attach regulated air pressure to the other water hose tube. Pressurize the core to 206 kPa (2 bar) (30 PSI) and submerge the aftercooler in water. Inspect for any air leaks. If there leaks or damage, the aftercooler must be replaced.



Suggest:

If the above button click is invalid.

Please download this document

first, and then click the above link

to download the complete manual.

Thank you so much for reading

Installation

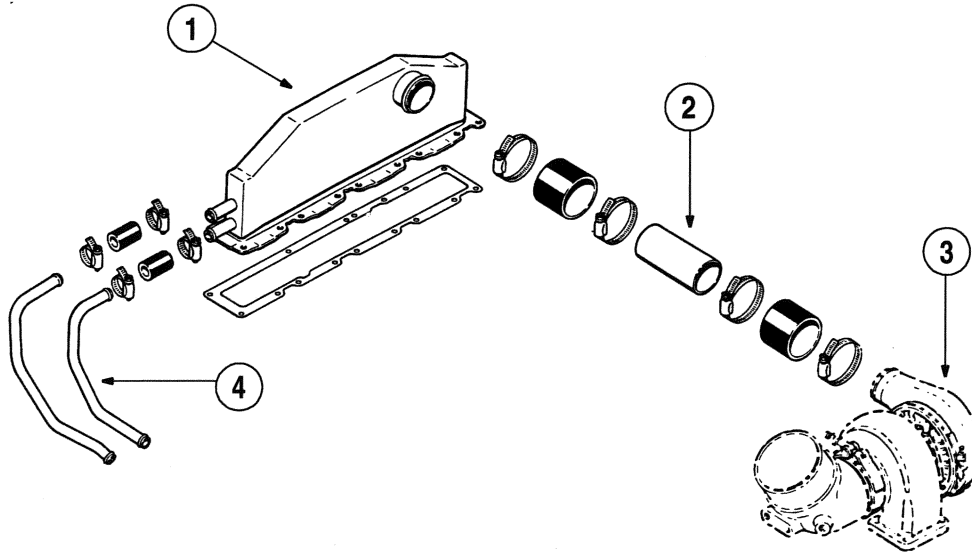

87L91

- 1. Aftercooler
- 2. Crossover Tube

- 3. Turbocharger
- 4. Water Line

STEP 7

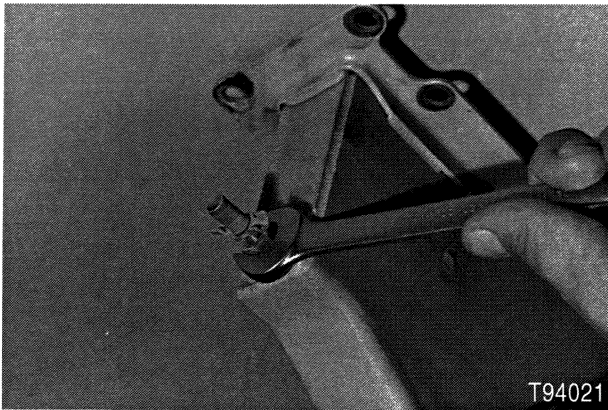

T94021

Apply teflon thread sealant to threads of air vent valve and install in the aftercooler.

STEP 8

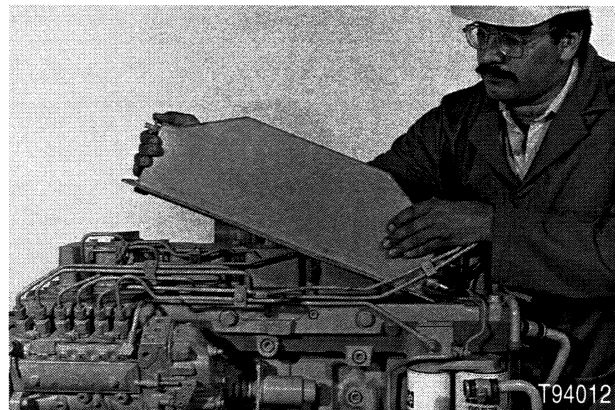

T94012

Apply a thin layer of Three Bond RTV Silver Sealer to both sides of a new gasket. Install the gasket and aftercooler on the cylinder head.

<https://www.ebooklibonline.com>

Hello dear friend!

Thank you very much for reading.

Enter the link into your browser.

The full manual is available for immediate download.

<https://www.ebooklibonline.com>