

# SERVICE MANUAL

**Boomer™ 3040 CVT / Boomer™ 3045 CVT /  
Boomer™ 3050 CVT**  
**Compact Tractor**  
*PIN ZCMB11001 and above*

**Part number 48080061**

2<sup>nd</sup> edition English

November 2016

*Replaces part number 47454118*





## **SERVICE MANUAL**

**Boomer™ 3040 CVT [ZCMB11001 - ], Boomer™ 3040 CVT [ZDMB11925 - ],  
Boomer™ 3045 CVT [ZCMB11001 - ], Boomer™ 3045 CVT [ZDMB11925 - ],  
Boomer™ 3050 CVT [ZCMB11001 - ], Boomer™ 3050 CVT [ZDMB11925 - ]**

## Link Product / Engine

---

<b>Product</b>	<b>Market Product</b>	<b>Engine</b>
Boomer™ 3040 CVT [ZCMB11001 - ]	North America	N844
Boomer™ 3040 CVT [ZDMB11925 - ]	North America	N844
Boomer™ 3045 CVT [ZCMB11001 - ]	North America	N844L
Boomer™ 3045 CVT [ZDMB11925 - ]	North America	N844L
Boomer™ 3050 CVT [ZCMB11001 - ]	North America	N844L
Boomer™ 3050 CVT [ZDMB11925 - ]	North America	N844L

**<https://www.ebooklibonline.com>**

Hello dear friend!

Thank you very much for reading.

Enter the link into your browser.

The full manual is available for immediate download.

**<https://www.ebooklibonline.com>**

# Contents

---

## INTRODUCTION

<b>Engine</b> .....	<b>10</b>
[10.001] Engine and crankcase .....	10.1
[10.101] Cylinder heads .....	10.2
[10.102] Pan and covers .....	10.3
[10.103] Crankshaft and flywheel.....	10.4
[10.105] Connecting rods and pistons.....	10.5
[10.106] Valve drive and gears .....	10.6
[10.110] Balancer and damper .....	10.7
[10.114] Pump drives .....	10.8
[10.218] Fuel injection system.....	10.9
[10.254] Intake and exhaust manifolds and muffler .....	10.10
[10.304] Engine lubrication system.....	10.11
[10.400] Engine cooling system .....	10.12
[10.414] Fan and drive .....	10.13
<b>Transmission</b> .....	<b>21</b>
[21.504] Continuously Variable Transmission (CVT).....	21.1
<b>Four-Wheel Drive (4WD) system</b> .....	<b>23</b>
[23.101] Mechanical control .....	23.1
<b>Front axle system</b> .....	<b>25</b>
[25.100] Powered front axle .....	25.1
[25.102] Front bevel gear set and differential .....	25.2
[25.310] Final drives .....	25.3
<b>Rear axle system</b> .....	<b>27</b>
[27.100] Powered rear axle.....	27.1
[27.106] Rear bevel gear set and differential .....	27.2

<b>Power Take-Off (PTO)</b> .....	<b>31</b>
[31.104] Rear electro-hydraulic control .....	31.1
[31.110] One-speed rear Power Take-Off (PTO) .....	31.2
[31.120] Central Power Take-Off (PTO) .....	31.3
<b>Brakes and controls</b> .....	<b>33</b>
[33.110] Parking brake or parking lock .....	33.1
[33.120] Mechanical service brakes .....	33.2
<b>Hydraulic systems</b> .....	<b>35</b>
[35.000] Hydraulic systems .....	35.1
[35.104] Fixed displacement pump .....	35.2
[35.204] Remote control valves .....	35.3
[35.300] Reservoir, cooler, and filters.....	35.4
<b>Steering</b> .....	<b>41</b>
[41.200] Hydraulic control components.....	41.1
[41.206] Pump .....	41.2
[41.216] Cylinders .....	41.3
<b>Cab climate control</b> .....	<b>50</b>
[50.100] Heating .....	50.1
[50.104] Ventilation .....	50.2
[50.200] Air conditioning .....	50.3
<b>Electrical systems</b> .....	<b>55</b>
[55.000] Electrical system .....	55.1
[55.010] Fuel injection system .....	55.2
[55.100] Harnesses and connectors.....	55.3
[55.201] Engine starting system .....	55.4
[55.301] Alternator .....	55.5
[55.302] Battery.....	55.6
[55.404] External lighting .....	55.7

[55.408] Warning indicators, alarms, and instruments .....	55.8
[55.518] Wiper and washer system.....	55.9
[55.640] Electronic modules .....	55.10
[55.DTC] FAULT CODES.....	55.11
<b>Platform, cab, bodywork, and decals .....</b>	<b>90</b>
[90.100] Engine hood and panels .....	90.1
[90.116] Fenders and guards.....	90.2
[90.124] Pneumatically-adjusted operator seat.....	90.3
[90.150] Cab.....	90.4
[90.151] Cab interior.....	90.5
[90.154] Cab doors and hatches .....	90.6



# INTRODUCTION

---

## **Foreword - Important notice regarding equipment servicing**

All repair and maintenance work listed in this manual must be carried out only by qualified dealership personnel, strictly complying with the instructions given, and using, whenever possible, the special tools.

Anyone who performs repair and maintenance operations without complying with the procedures provided herein shall be responsible for any subsequent damages.

The manufacturer and all the organizations of its distribution chain, including - without limitation - national, regional, or local dealers, reject any responsibility for damages caused by parts and/or components not approved by the manufacturer, including those used for the servicing or repair of the product manufactured or marketed by the manufacturer. In any case, no warranty is given or attributed on the product manufactured or marketed by the manufacturer in case of damages caused by parts and/or components not approved by the manufacturer.

The manufacturer reserves the right to make improvements in design and changes in specifications at any time without notice and without incurring any obligation to install them on units previously sold. Specifications, descriptions, and illustrative material herein are as accurate as known at time of publication but are subject to change without notice.

In case of questions, refer to your NEW HOLLAND Sales and Service Networks.

## Safety rules

### Personal safety





This is the safety alert symbol. It is used to alert you to potential personal injury hazards. Obey all safety messages that follow this symbol to avoid possible death or injury.

Throughout this manual you will find the signal words DANGER, WARNING, and CAUTION followed by special instructions. These precautions are intended for the personal safety of you and those working with you.

Read and understand all the safety messages in this manual before you operate or service the machine.

 DANGER indicates a hazardous situation that, if not avoided, will result in death or serious injury.

 WARNING indicates a hazardous situation that, if not avoided, could result in death or serious injury.

 CAUTION indicates a hazardous situation that, if not avoided, could result in minor or moderate injury.

**FAILURE TO FOLLOW DANGER, WARNING, AND CAUTION MESSAGES COULD RESULT IN DEATH OR SERIOUS INJURY.**

### Machine safety

**NOTICE:** Notice indicates a situation that, if not avoided, could result in machine or property damage.

Throughout this manual you will find the signal word Notice followed by special instructions to prevent machine or property damage. The word Notice is used to address practices not related to personal safety.

### Information

**NOTE:** Note indicates additional information that clarifies steps, procedures, or other information in this manual.

Throughout this manual you will find the word Note followed by additional information about a step, procedure, or other information in the manual. The word Note is not intended to address personal safety or property damage.

---

## Safety rules - Ecology and the environment

Soil, air, and water quality is important for all industries and life in general. When legislation does not yet rule the treatment of some of the substances that advanced technology requires, sound judgment should govern the use and disposal of products of a chemical and petrochemical nature.

Familiarize yourself with the relative legislation applicable to your country, and make sure that you understand this legislation. Where no legislation exists, obtain information from suppliers of oils, filters, batteries, fuels, anti-freeze, cleaning agents, etc., with regard to the effect of these substances on man and nature and how to safely store, use, and dispose of these substances.

### Helpful hints

- Avoid the use of cans or other inappropriate pressurized fuel delivery systems to fill tanks. Such delivery systems may cause considerable spillage.
- In general, avoid skin contact with all fuels, oils, acids, solvents, etc. Most of these products contain substances that may be harmful to your health.
- Modern oils contain additives. Do not burn contaminated fuels and or waste oils in ordinary heating systems.
- Avoid spillage when you drain fluids such as used engine coolant mixtures, engine oil, hydraulic fluid, brake fluid, etc. Do not mix drained brake fluids or fuels with lubricants. Store all drained fluids safely until you can dispose of the fluids in a proper way that complies with all local legislation and available resources.
- Do not allow coolant mixtures to get into the soil. Collect and dispose of coolant mixtures properly.
- The air-conditioning system contains gases that should not be released into the atmosphere. Consult an air-conditioning specialist or use a special extractor to recharge the system properly.
- Repair any leaks or defects in the engine cooling system or hydraulic system immediately.
- Do not increase the pressure in a pressurized circuit as this may lead to a component failure.
- Protect hoses during welding. Penetrating weld splatter may burn a hole or weaken hoses, allowing the loss of oils, coolant, etc.

### Battery recycling

Batteries and electric accumulators contain several substances that can have a harmful effect on the environment if the batteries are not properly recycled after use. Improper disposal of batteries can contaminate the soil, groundwater, and waterways. NEW HOLLAND strongly recommends that you return all used batteries to a NEW HOLLAND dealer, who will dispose of the used batteries or recycle the used batteries properly. In some countries, this is a legal requirement.



### Mandatory battery recycling

**NOTE:** *The following requirements are mandatory in Brazil.*

Batteries are made of lead plates and a sulfuric acid solution. Because batteries contain heavy metals such as lead, CONAMA Resolution 401/2008 requires you to return all used batteries to the battery dealer when you replace any batteries. Do not dispose of batteries in your household garbage.

Points of sale are obliged to:

- Accept the return of your used batteries
- Store the returned batteries in a suitable location
- Send the returned batteries to the battery manufacturer for recycling



# **SERVICE MANUAL**

## **Engine**

**Boomer™ 3040 CVT [ZCMB11001 - ], Boomer™ 3040 CVT [ZDMB11925 - ],  
Boomer™ 3045 CVT [ZCMB11001 - ], Boomer™ 3045 CVT [ZDMB11925 - ],  
Boomer™ 3050 CVT [ZCMB11001 - ], Boomer™ 3050 CVT [ZDMB11925 - ]**

## Cylinder head - Static description

Boomer™ 3040 CVT	NA
Boomer™ 3045 CVT	NA
Boomer™ 3050 CVT	NA

### Cylinder Head and Valve Train Components

The cylinder head incorporates the valve assemblies, rocker arms, rocker shaft, push rods, and lifters. A swirl chamber located between the injector assembly and the main combustion chamber of the cylinders provides improved starting and greater fuel efficiency. Initial combustion starts in the precombustion chamber and as the expansion occurs a strong swirl pattern is created in the main combustion chamber for more complete combustion of the air-fuel mixture. The air intake manifold is separate from the cast aluminum valve cover on all these engines. The exhaust manifold is bolted on the left-hand side of the cylinder head on each of the models. Cylinder heads have integral valve guides. Standard size valves only are used.

The cylinder block assembly contains the pistons, connecting rods, crankshaft, timing gears, and engine oil pump. The crankshaft is supported on five main bearings. The front bearing is positioned in a bore in front of the block. The other bearings are split liners located in holders bolted to the block. The camshaft is supported on four ball bearings located in the block.

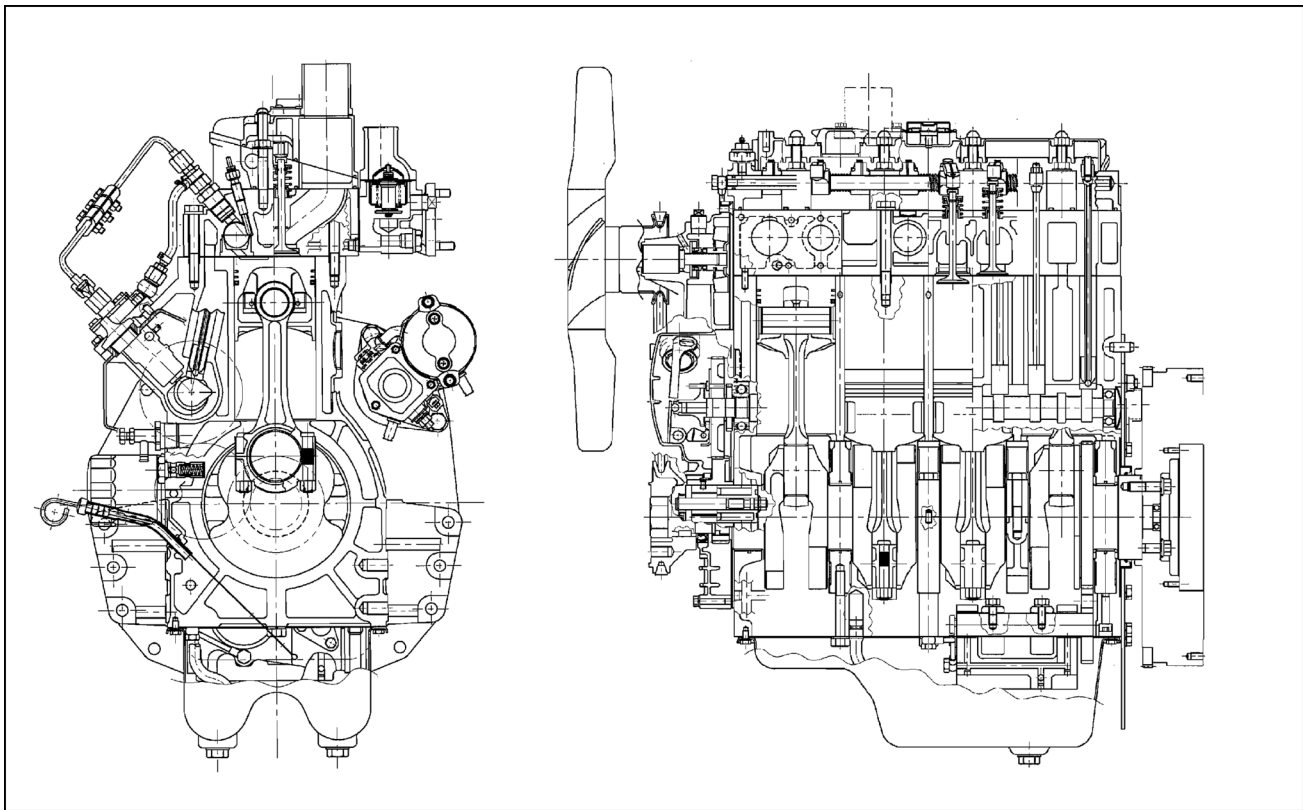

7607624950 1

Engine models ISM N844 and ISM N844L

## Valve cover - Install

Boomer™ 3040 CVT	NA
Boomer™ 3045 CVT	NA
Boomer™ 3050 CVT	NA

### Prior operation:

#### Valve drive and gears - Clearance (Valves) (10.106).

1. Install a new gasket (1) and position the valve cover (2) over the rocker arms.
2. Install the valve cover retaining bolts (3), and tighten to **12 - 16 N·m (9 - 19 lb ft)**.
3. Install and tighten the seal washer (4), and cap nuts (5).

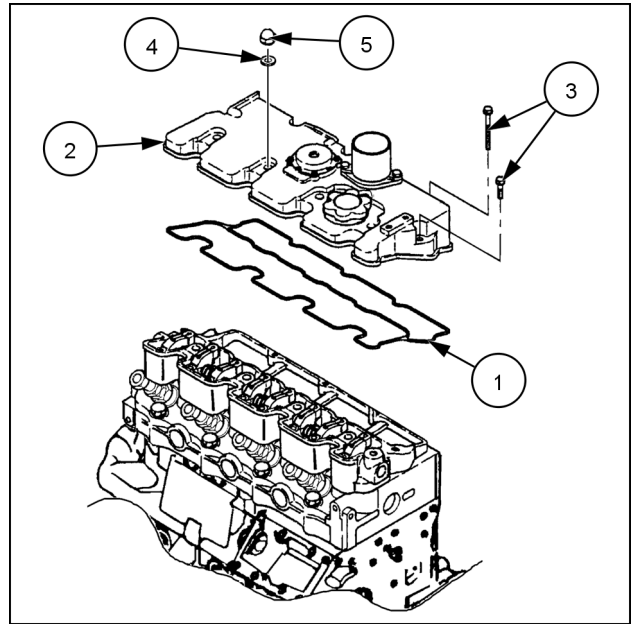

76075733A 1

### Next operation:

#### Water pump - Install (with Cooling Fan) (10.400).

## Cylinder head - Compression test

Boomer™ 3040 CVT	NA
Boomer™ 3045 CVT	NA
Boomer™ 3050 CVT	NA

Compression test is performed through the glow plug ports. The test adapter tool **(1)**, is equipped with quick coupler ends for easy installation of the hose and gauge.

The procedures to perform a compression test are as follows:

1. Remove the wire lead from the fuel injection pump solenoid.
2. Remove the glow plug electrical wire and wire connector from top of the glow plugs.

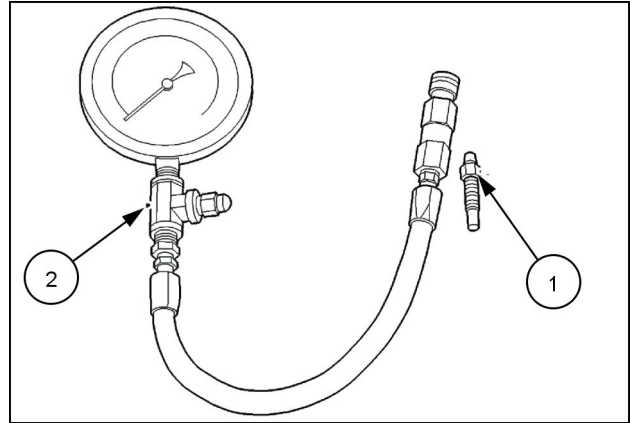

SECT10C01PG17\_1 1

3. Remove all of the glow plugs.

**NOTE:** Be sure all the glow plugs are removed before starting the compression tests.

4. Install the adapter Tool No. **FNH00120** , hose and gauge assembly OEM1074 **(2)**, in each port and crank the engine until pressure stabilizes. The gauge should read **2944 kPa (427 psi)** ) plus or minus **345 kPa (50 psi)** .

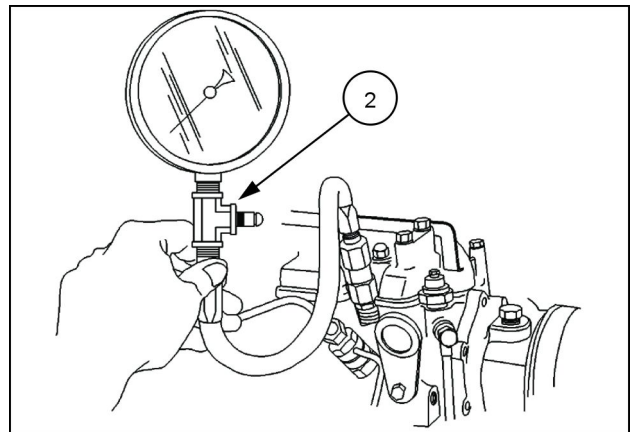

SECT10C01PG17\_2 2

**NOTE:** It may be necessary to remove some injector fuel lines to install the adapter tool.

**NOTE:** There should not be more than **345 kPa (50 psi)** variation between the cylinders.

5. When all cylinders have been tested, reinstall the glow plugs and electrical connections.

## Cylinder head - Remove

Boomer™ 3040 CVT	NA
Boomer™ 3045 CVT	NA
Boomer™ 3050 CVT	NA

### Prior operation:

Rocker Arm Shaft and Support Bracket - Remove; See: "Engine Disassemble"..

1. Remove the valve stem caps (1), and push rods (2).
2. To remove the cylinder head, remove the cylinder head bolts (3), by alternately loosening a half turn at a time to prevent warping the head.

**NOTE:** Keep all valve components in separately marked containers for reassembly in their original location.

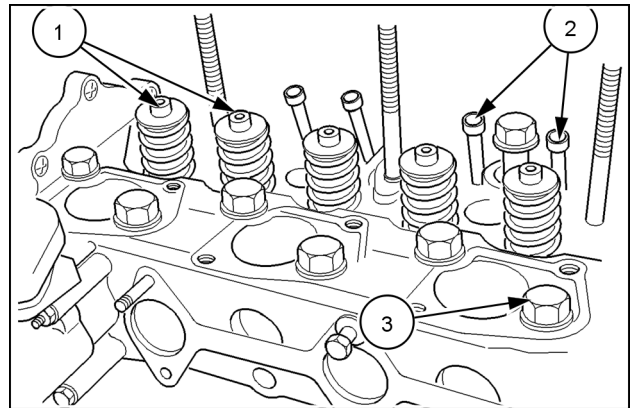

20093361A 1

### Next operation:

Valve Tappet - Removal; See: "Engine Disassemble".

## Cylinder head - Inspect

Boomer™ 3040 CVT	NA
Boomer™ 3045 CVT	NA
Boomer™ 3050 CVT	NA

### Prior operation:

**Crankcase gears - Remove - with Camshaft (10.114).**

#### 1. Disassembly

1. Clean the cylinder head and remove any carbon deposits from around the valve heads.
2. Use a valve spring compressor and remove the valve spring retainer locks **(1)**, spring **(2)**, and spring retainer **(3)**, from each valve **(4)**.
3. Remove the valves and place the valve components together in separately marked containers for reassembly in their original position.

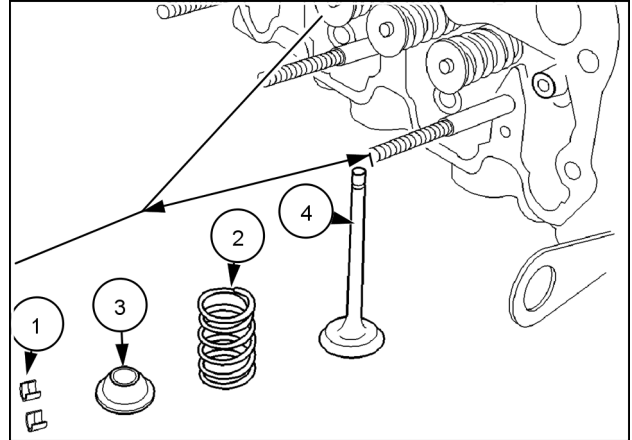

20093369 1

#### 2. Inspection and Repair

1. Clean all carbon deposits from the combustion chamber and valve ports using a wire brush and scraper.
2. Clean all dirt and residue from the gasket surface using care not to scratch or nick the machined surface.
3. Clean the cylinder head in solvent and air dry.
4. Inspect the head for cracks or damage in the following areas:
  - Valve ports
  - Valve seats **(2)**.
  - Prechamber **(3)**.
  - External cracks in the water jackets **(1)**..
5. Inspect the gasket surfaces for scratches or nicks, which could cause leakage.
6. Examine the core hole plugs for rust or signs of leakage. If a plug shows signs of damaging rust or leakage, replace all plugs in the head.
7. Inspect the prechamber for carbon deposits and looseness. Remove any carbon deposits found. If prechamber is found to be loose, cylinder head may be warped.

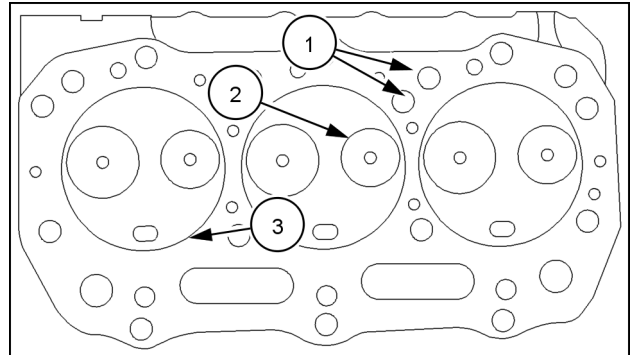

20093370 2



**Suggest:**

**If the above button click is invalid.**

**Please download this document**

**first, and then click the above link**

**to download the complete manual.**

**Thank you so much for reading**

3. Inspection, Continued

- Use a straight edge and a feeler gauge and check the cylinder head for warp lengthwise, crosswise, and diagonally

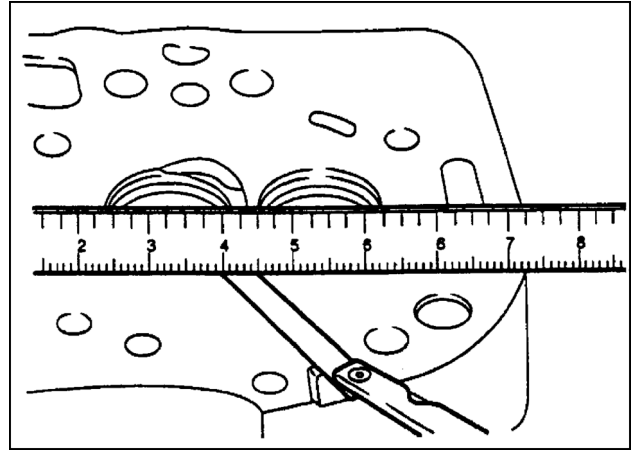

20093371F 3

**Next operation:**  
**Valve drive and gears - Inspect - Valve Seats (10.106).**

**<https://www.ebooklibonline.com>**

Hello dear friend!

Thank you very much for reading.

Enter the link into your browser.

The full manual is available for immediate download.

**<https://www.ebooklibonline.com>**