



Super Caddy 4

Manual

aerospace
climate control
electromechanical
filtration
fluid & gas handling
hydraulics
pneumatics
process control
sealing & shielding



ENGINEERING YOUR SUCCESS.

Super Caddy 4

Warnings



Do not remove cover of the variable speed controller unit for at least five (5) minutes after AC power is disconnected to allow capacitors to discharge. Dangerous voltages are present inside the equipment. Electrical shock can cause serious or fatal injury.



Motor circuit may have high voltage present whenever AC power is applied, even when motor is not rotating. Electrical shock can cause serious or fatal injury.



MEDICAL DEVICE/PACEMAKER DANGER - Magnetic and electromagnetic fields in the vicinity of current carrying conductors and industrial motors can result in a serious health hazard to persons with cardiac pacemakers, internal cardiac defibrillators, neurostimulators, metal implants, cochlear implants, hearing aids, and other medical devices. To avoid risk, stay away from the area surrounding a motor and its current carrying conductors.



Do not connect AC power to the Motor terminals U, V and W. Connecting AC power to these terminals may result in damage to the control.



Electric retractable cord should be fully extended during use per manufacturers recommendations. Clean cord of excess debris during retraction back to storage position.

Product Features

- Variable Speed - Flows 3 to 8 GPM
- 1-1/4" dia. x 16' Suction Hose
- 1" dia. x 16' Return Hose
- Dual Purpose Concentric Wand for 1 Piece Suction & Return Functionality
- Separate Return Wand Included for Transferring and filtering from Drum to Systems
- Large Semi-Pneumatic Tires
- Steel Black Powder Coated Frame
- Hinged Cabinet - Color Coded Element Storage
- Removable Drip Pan for Easy Clean-Up
- Weatherproof Retractable Cord Reel (115VAC Version)
- Weatherproof Electrical Components for Field/ Outdoor Use
- 115VAC
- <160 lbs. Dry Weight
- Mechanical Flow Meter
- Low Fluid Volume Retention allows for Easier Element and Fluid Change
- Cleanable high capacity 238 micron suction element
- Elements available in 2Q, 5Q, and water separation
- Sampling port with valve (6mm) for icountOS Particle Oil Sampler

Super Caddy 4

Specifications

Maximum Recommended Fluid Viscosity:

3000 SUS (647 cSt) @ 3GPM
0.85 specific gravity

Visual Indicator (outlet filter):
60 PSI (Gauge)

Filter Bypass Valve Settings (Integral to Element):

Inlet – 5 psid (0.345 bar)
Outlet – 35 psid (2.4 bar)

Operating Temperature:

Seal Type: Nitrile seals on suction and return elements
14°F to +104°F
(-10°C to +40°C)

Storage Temperature:

-40°F to 140°F
(-40°C to +60°C)

Operating Environment:

Indoor/outdoor

Humidity:

10 to 95% relative humidity
non-condensing

Electrical Service Required:

110-115V +/- 10%, 50/60 Hz,
voltage range: 99-126V

Electrical Motor:

½ hp @ 1740 rpm

Starter (switch):

IP66 rated, start-stop
20 foot (6 meter) lead with
plug

Pump Specification:

External gear pump
3-8 GPM (11-30 LPM)
operation below 2.5 GPM will
shorten pump life

**1st Stage Filtration (suction/
inlet filter):**

238 micron
5 psi (0.34 bar) bypass
(prevents pump cavitation)
Air in suction hose will cause
sporadic flow reading

**2nd Stage Filtration (pressure/
outlet filter):**

2 micron, 5 micron, and water
removal
Pressure gauge, 2", 0-60 psi,
color coded (25 psi)
25 psi (1.7 bar) bypass
(prevents excessive
pressures)

Suction/Pressure Hose:

PVC 16 ft. (4.88 meter)

Suction/Pressure Wand:

(2) PVC 39" (1 meter)
(1) Concentric steel 39" (1 meter)

Construction:

Cart frame – Steel
Filter head – Aluminum
Filter bowl – Aluminum
Hoses – PVC
Wands – Return - PVC
Suction - Steel tube

Weight:

approx. 165 lbs. (74.8kg)

Element Storage:

3 plastic tubes for return
elements



<https://www.ebooklibonline.com>

Hello dear friend!

Thank you very much for reading.

Enter the link into your browser.

The full manual is available for immediate download.

<https://www.ebooklibonline.com>

Super Caddy 4

Operating Instructions

Initial Start-Up

Assembly of Hoses

1. Install hoses to inlet and outlet filters by threading the hose end with the straight thread fittings and tighten into the filter threads.
2. Connect the PVC tube wands, or metal concentric wand, to the swivel fitting on the hose end. *Do not over-torque the metal fittings going into the PVC coupling. Over-torque will result in cracking the coupling. 1/4 turn beyond hand-tight is sufficient.*

Standard Use

1. Insert the inlet wand assembly into the supply fluid receptacle (drum/reservoir). The PT filter is the suction filter.
2. Insert the outlet wand assembly into the clean fluid receptacle (drum/reservoir). The 50AS filter is the outlet filter.
3. Verify that the ON/OFF switch is OFF and plug the cord into the proper grounded power source (3 wire).
4. Turn switch to ON position and check outlet wand for oil flow. Allow 30-60 seconds for filters to fill with oil. *If repeated attempts to obtain oil flow fail, check pump inlet fittings for tightness. For very viscous fluids it may be necessary to pour 1 or 2 quarts of fluid into the inlet filter hose to prime pump initially.*
 - 4a. Controls variable pump flow
 - 4b. Turn to FWD only for motor direction (reverse has been programmed to be non-functional)
5. Monitor the condition of the filter element by observing the cleanliness indicator on the outlet filter. When the gauge is in the YELLOW position, the inlet filter element must be replaced.
6. The inlet filter element has a 5 PSI bypass spring to prevent the pump from cavitating if the element is not changed. The outlet filter element has a 25 PSI bypass spring to prevent excessive pressure which may be harmful to personnel or to the filter cart. **Warning:** *The filter bypass spring acts as a relief valve for the pump. Do not restrict the outlet hose with a shut-off valve which will defeat the function of the bypass valve, causing excessive pressure, which may be harmful to personnel or to the filter cart.*
7. The cleanliness gauge works on pressure and will indicate the condition of the element. **NOTE:** The filter cart must be in operation for the gauge to read properly



Power/Variable Speed Controller

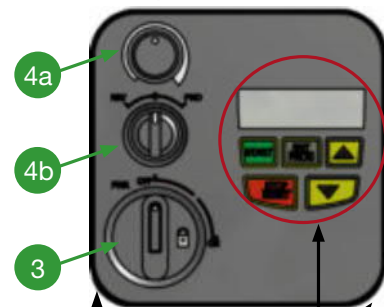

Note: Program buttons and display not required for usage.



Super Caddy 4

Service Instructions - Main Return Filter (50AS)

Filter element should be replaced as indicated by filter indicator gauge, change as required or with any fluid type change.

Replacement element procedure

- A. Shut down system and release pressure in the filter line.
- B. Loosen drain plug and allow fluid to empty from bowl to drip pan.
- C. Loosen bowl and remove rotating counter clockwise. *(bowl hex 1-1/16"/27mm)*
- D. Remove dirty element from filter head and discard.
- E. Lubricate element seals on clean element and install on filter head element locator.
- F. Install reusable bowl onto element and filter head. Tighten to specified torque of 50-60 ft-lbs.
- G. Install drain plug and tighten to specific torque of 10-12 ft-lbs.

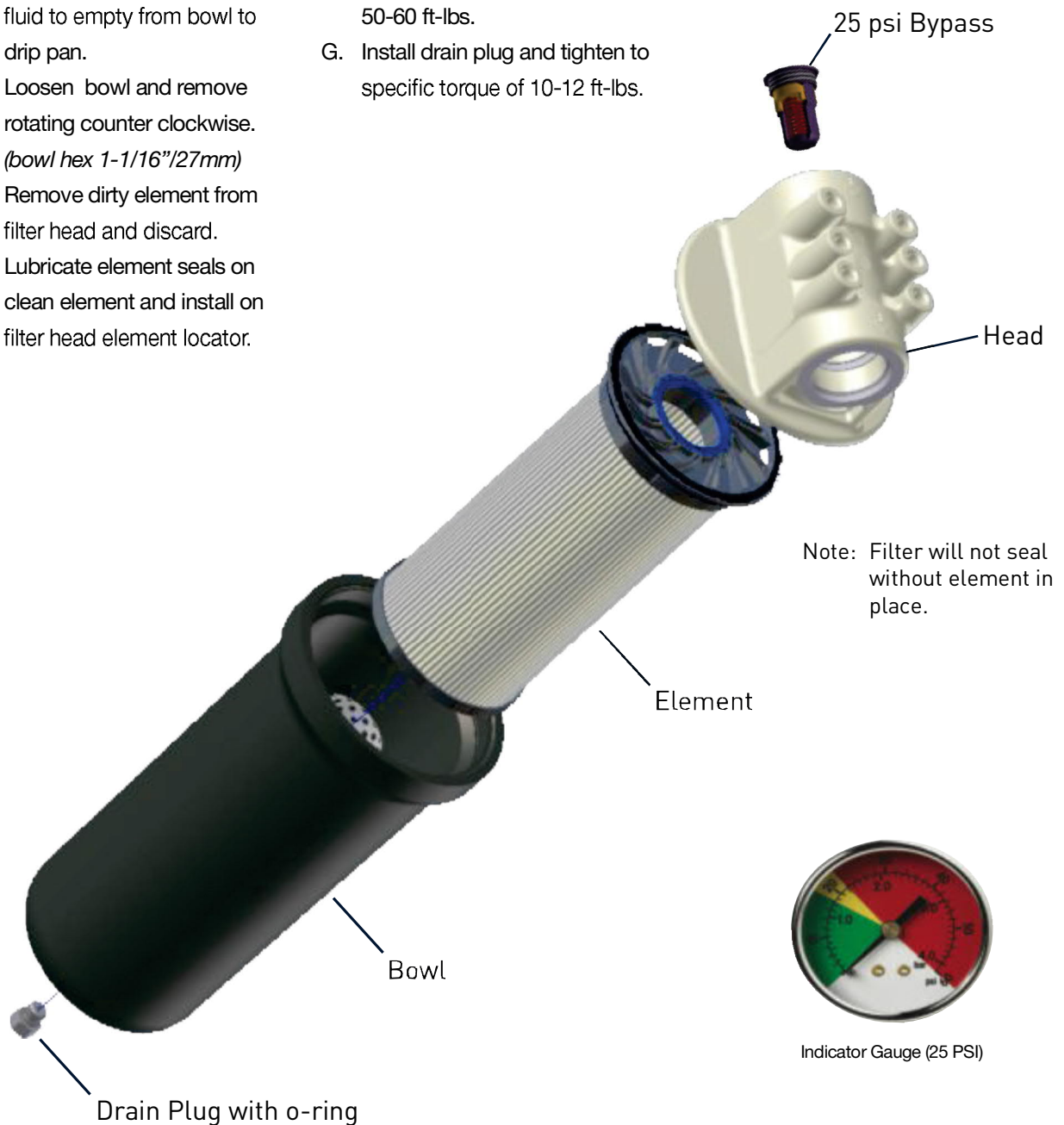

Super Caddy 4

Service Instructions - Suction Filter (PT)

Suction filter element should be checked when servicing the 50AS filter, change as required or with any fluid type change.

Replacement element procedure

- A. Shut down system and release pressure in the filter line.
- B. Loosen head and remove rotating counter clockwise. (*element head hex 15/16"/24mm*)
- C. Remove dirty element from filter head and discard.
- D. Lubricate element seals on clean element and install in filter head.
- E. Tighten to specified torque of 200-240 in-lbs.

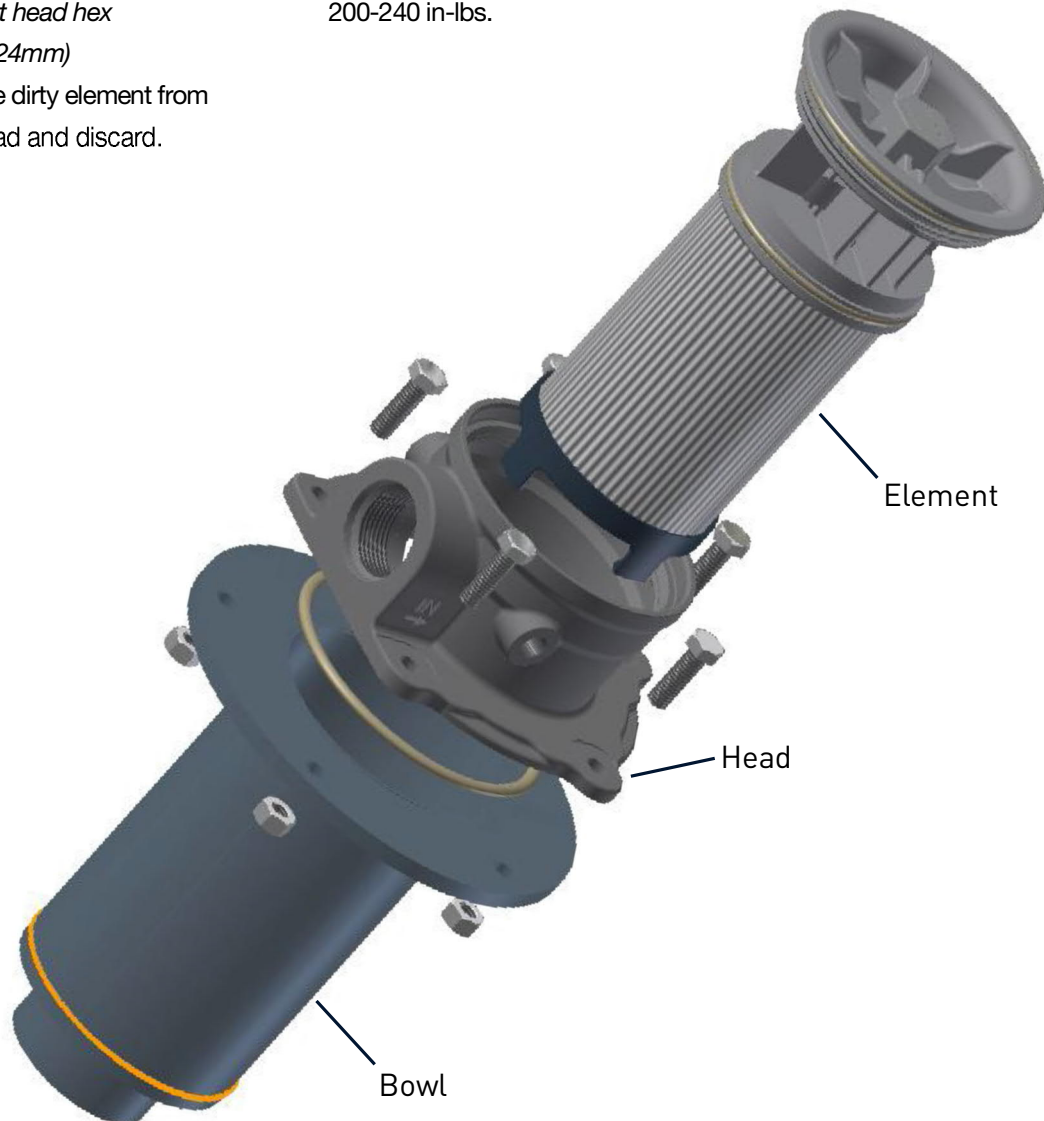



Suggest:

For more complete manuals. Please go to the home page.

<https://www.ebooklibonline.com>

If the above button click is invalid. Please download this document first, and then click the above link to download the complete manual.

Thank you so much for reading

Super Caddy 4

Details

Two Wands are included with the cart: the concentric wand and the standard wand. There is a place holder for each to hold and to drain into drip pan on cart. **Keep suction inlet submerged and clear of blockage.**

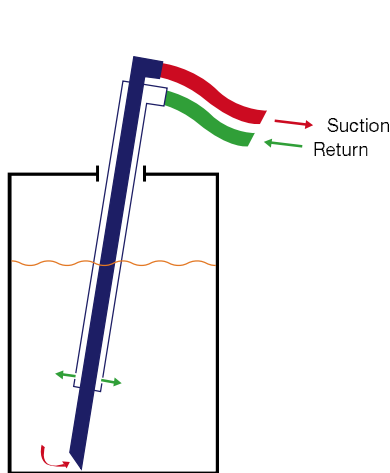

In-tank filtering

- The concentric wand provides a unique option of using one port access to the tank to suction and return the fluid in an opening as small as 2"
- During this type of filtering: the inlet/suction hose would be hooked up to the concentric wand inlet (top 90 degree fitting on wand), and the outlet hose would be attached to the concentric wand return/outlet (lower fitting on wand).

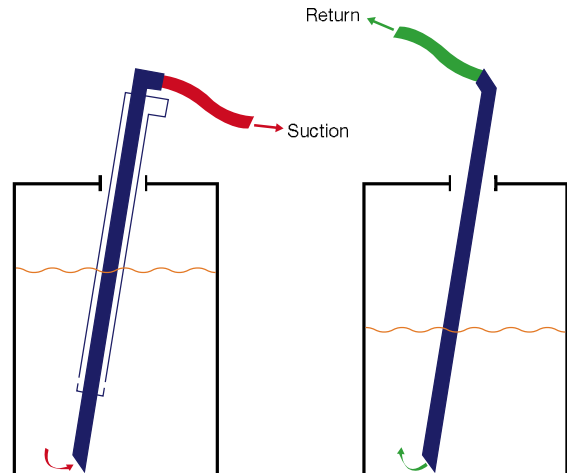

Transfer of fluid tank to tank

- During transfer of fluid: you will utilize the concentric wand for the suction only, and the standard wand for the return line.
- Unhook the return/outlet hose from the concentric wand (lower fitting) and re-attach it to the single wand.
- Then utilize the cart as normal filtration while transferring fluid from one container/tank to another.

Resetting the Circuit Breaker

The cord reel is equipped with an internal mini circuit breaker safety device. This mini breaker will trip if the recommended amperage is exceeded. If an overload should trip the mini breaker, check the amperage usage. The total amperage should not exceed 13 amps. Remove the overload.

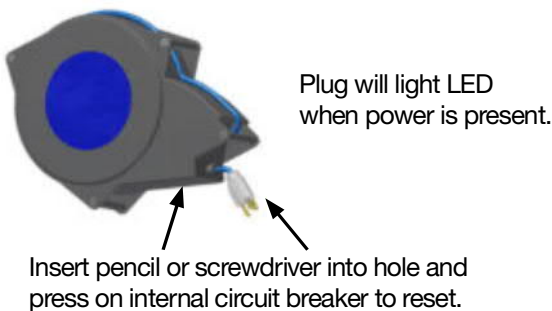

Sampling Port

Valve in off position during normal operation. 6mm tubing direct hook up to IOS unit for on-line sampling or bottle collection.

* The icount Oil Sampler (IOS) is available as a separate part through Servicegard.

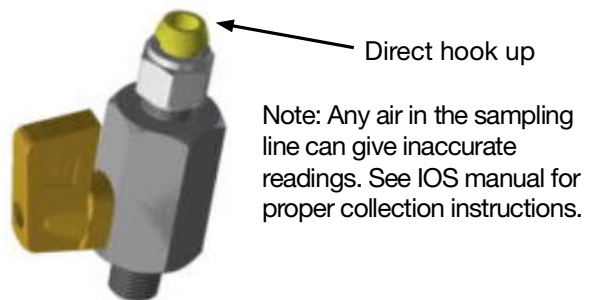

Super Caddy 4

Parts List

Item	Description	50AS
Filter Cart Complete	120V - US/Mexico	JDG11700
Replaceable Components		
White Plastic Element Tubes	set of 3 pcs w/labels	JDG11701
Suction Hose	1.25" ID - 16' length (TBD Black or Visual)	JDG11702
Return Hose	1.0" ID - 16' length (TBD Black or Visual)	JDG11703
Concentric Wand	suction/return metal wand	JDG11704
Return Wand	plastic return wand	JDG11705
Oil Drip Pan	fiberglass 12"x14"x4" drip pan	JDG11706
Replaceable Elements		
Element	inlet suction element w/Nitrile seal (1 supplied with original cart)	JDG11707
Element	2Q replacement filter element w/Nitrile seal	JDG11708
Element	5Q replacement filter element w/Nitrile seal (1 supplied with original cart)	JDG11709
Element	Water Removal filter element w/Nitrile seal	JDG11710

Replacement parts are ordered directly via the SERVICEGARD e-commerce website.
<https://servicegard.spx.com>

General Troubleshooting

Problem	Cause	Solution
Does not start	ON/OFF Switch	Turn switch ON, replace VSIMX if defective
	No electrical power	Plug in cart
	Defective motor	Replace
No oil flow or erratic pump noise	Filter housing not filled with oil	Allow pump to run 30 to 60 seconds
	Suction leak	Check tightness of inlet fittings
		Check o-ring in inlet filter cover for nicks
		Kink or restriction in inlet hose
		Add 1 or 2 quarts of oil to inlet hose
	Defective pump	Replace pump
Pump doesn't prime	Add oil to inlet suction hose	
Gauge reads YELLOW or RED	Element dirty	Replace or clean elements (both filters)
	Oil extremely cold or viscous	Change element to coarser micron rating
Indicator does not seem to move	No outlet element	Install element
Housing leaks	No element, no drain plug	Install element/plug

Technical questions/issues with operation can be addressed through Parker Technical Service at 419-644-4311 or hfdtechsupport@parker.com

<https://www.ebooklibonline.com>

Hello dear friend!

Thank you very much for reading.

Enter the link into your browser.

The full manual is available for immediate download.

<https://www.ebooklibonline.com>