

OPERATOR'S MANUAL

SNOWBLOWERS

SB1174 | SB1184 | SB1194

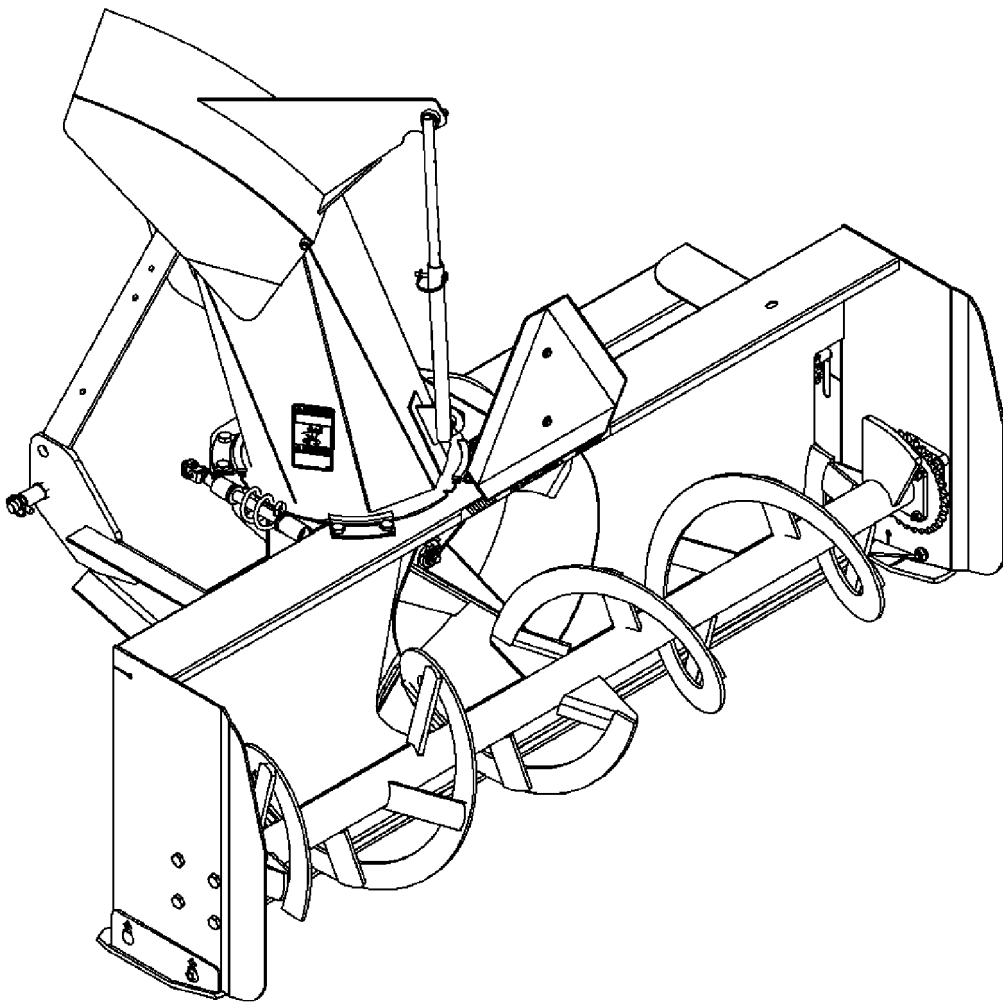

FRONTIER
EQUIPMENT

OM0369SB1174-A
10/09-1

TABLE OF CONTENT

SPECIFICATIONS.....	3
INTRODUCTION – TO THE PURCHASER	4
SAFETY PRECAUTIONS.....	5
General Information	5
Before Operation	6
Notice	6
The Snowblower	6
Before Operation	6
Snowblower Operation	7
The Tractor	7
General Information	7
Maintenance	8
Transporting.....	9
Storage	9
SAFETY DECALS	10
ASSEMBLY	11
Tractor Preparation	11
Snowblower Assembly	11
Installation of SMV Sign	11
Installation of Chute and Manual Rotation Kit 5RDF0016	12
Installation of Chute and Hydraulic Rotation Kit 5RDF0018	14
Installation of Electric Deflector Kit 5RDF0021	16
Installation of Hydraulic Deflector Kit 5RDF0009.....	18
Installation of Snowblower with Three Point Hitch	19
Installation of Snowblower with Quick Hitch	22
How to Determine Driveline Angles.....	24
Angles at Each End of Driveline.....	25
Determining Driveline Length.....	25
Driveline Installation.....	27
Removing Snowblower from Tractor.....	28

TABLE OF CONTENT

OPERATION	30
General Preparation	30
Operating Controls	30
Work and Travel Speed	30
Raising and Lowering the Snowblower.....	30
Adjustments	30
Reduction Chain Tension Adjustment	30
Skid Shoe Adjustment	30
Manual Deflector Adjustment	30
Snow Removal Methods	31
MAINTENANCE	32
Maintenance.....	32
Shearbolts.....	32
Drive shaft.....	32
Driveline	32
Lubrication.....	33
Driveline – Troubleshooting.....	34
PARTS	37
Introduction	37
Snowblower – SB1174	38
Snowblower – SB1184.....	41
Gearbox 5RD663485 for SB1174	44
Gearbox 5RD662195 for SB1184 & SB1194	45
Driveline 5RD4700159 for SB1174	46
Driveline 5RD662194 for SB1174 - <i>SERIAL #: XFSB11X080102 to XFSB11X080406</i>	47
Driveline 5RD662194 for SB1184	47
Driveline 5RD662538 for SB1184 - <i>SERIAL #: XFSB11X080103 to XFSB11X080531 & SB1194</i>	48
5RDF0016 - Manual Rotation	49
5RDF0018 - Hydraulic Rotation	50
5RDF0009 - Hydraulic Deflector	51
5RDF0021- Electric Deflector.....	52
TORQUE SPECIFICATION TABLE	53

<https://www.ebooklibonline.com>

Hello dear friend!

Thank you very much for reading.

Enter the link into your browser.

The full manual is available for immediate download.

<https://www.ebooklibonline.com>

<https://www.ebooklibonline.com>

Hello dear friend!

Thank you very much for reading.

Enter the link into your browser.

The full manual is available for immediate download.

<https://www.ebooklibonline.com>



Suggest:

For more complete manuals. Please go to the home page.

<https://www.ebooklibonline.com>

If the above button click is invalid. Please download this document first, and then click the above link to download the complete manual.

Thank you so much for reading

SPECIFICATIONS

Features and Specifications	SB1174	SB1184	SB1194
Working Width	74"	84"	94"
Transport Width	74"	84"	94"
Working Height	26"	34"	34"
Length	47 3/4"	55 3/8"	55 3/8"
Single/Dual Auger	Single	Single	Single
Auger Diameter	15"	20"	20"
Auger Flighting Thickness	5/16"	3/8"	3/8"
Impeller Diameter	24"	27 1/2"	27 1/2"
Impeller Width	9"	10 1/2"	10 1/2"
Impeller Shaft Diameter	1 3/8"	40 mm (1 9/16")	40 mm (1 9/16")
Number of Impeller blades	4	4	4
Roller Chain	60	60	60
Drive sprocket (# of teeth)	10	10	10
Driven sprocket (# of teeth)	32	32	32
Chain idler	Manual adjustment	Manual adjustment	Manual adjustment
Gearbox Manufacturer	Comer	Comer	Comer
Gearbox Description	Model T-281A	Model T-27D	Model T-27D
Tractor RPM	540	540	540
Impeller RPM	540	540	540
Auger RPM	170	170	170
PTO Manufacturer	Comer	Comer	Comer
PTO Description	40	50	60
Skid Shoe	Adjustable	Adjustable	Adjustable
Skid Shoe Material	High carbon steel	High carbon steel	High carbon steel
End Plate Thickness	3/16"	3/16"	3/16"
Back Plate Thickness	11ga	11ga	11ga
Impeller Housing Thickness	11ga	11ga	11ga
Impeller Blade Thickness	1/4"	3/8"	3/8"
Side Panel Bottom Thickness	3/16"	3/16"	3/16"
Cutting Edge	Welded	Welded	Welded
Cutting Edge Dimension	3/8" x 2"	1/2" x 3"	1/2" x 3"
Chute Base	Standard	Standard	Standard
Parking Stand	Standard	Standard	Standard
Hitch Category	Cat. 1 & 2	Cat. 1 & 2	Cat. 2 only
Quick Hitch Compatibility	ASABE Compatible Cat. 1 only	ASABE Compatible Cat. 1 & 2	ASABE Compatible Cat. 2 only
HP Requirements - min-max (hp)	20-50	35-90	35-90
Operating Weight (lbs)-hyd. rot. & defl.	715	1130	1182
Shipping Weight (lbs)	628	1060	1021
Approx. Set-up Time (min.) *	35	35	35
Chute Deflector Adjustment (standard)	Manual	Manual	Manual
Chute Deflector Adjustment (option)	Hydraulic - cylinder (2"x8") including hoses and tips Electric - 8" actuator - 1000 lbs. including hardware, switch, and electric cable.	Hydraulic - cylinder (2"x8") including hoses and tips Electric - 8" actuator - 1000 lbs. including hardware, switch, and electric cable.	Hydraulic - cylinder (2"x8") including hoses and tips Electric - 8" actuator - 1000 lbs. including hardware, switch, and electric cable.
Chute Rotation	Manual - worm gear w/ handle. Hydraulic - cylinder (2"x8") including bracket, hoses, and tips	Manual - worm gear w/ handle. Hydraulic - cylinder (2"x8") including bracket, hoses, and tips	Manual - worm gear w/ handle. Hydraulic - cylinder (2"x8") including bracket, hoses, and tips
Chute	Two-part	Two-part	Two-part

* With manual rotation