

| | | | |
|---|-------------------------------|---|---------------------------|
| Document Title: Frame and track unit, description | Function Group: 700 | Information Type: Service Information | Date: 2015/9/15 |
| Profile: EXC, EC220D LR [GB] | | | |

Frame and track unit, description

Upper frame type

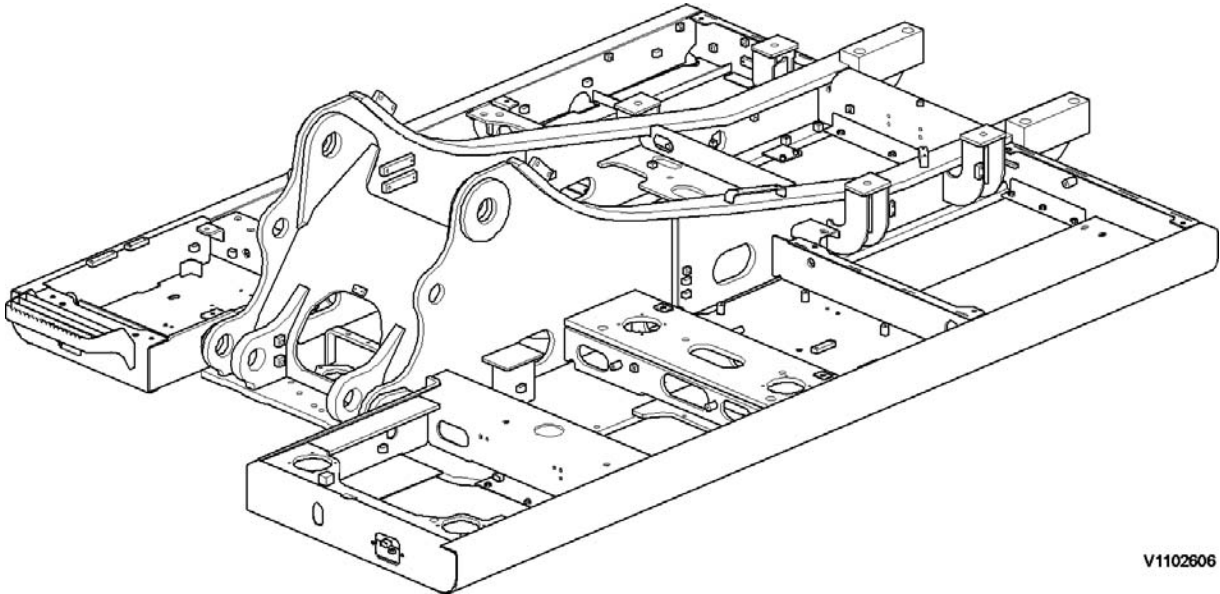

Figure 1
Upper frame

- Upper frame, weight: 1810 kg (3990 lbs)

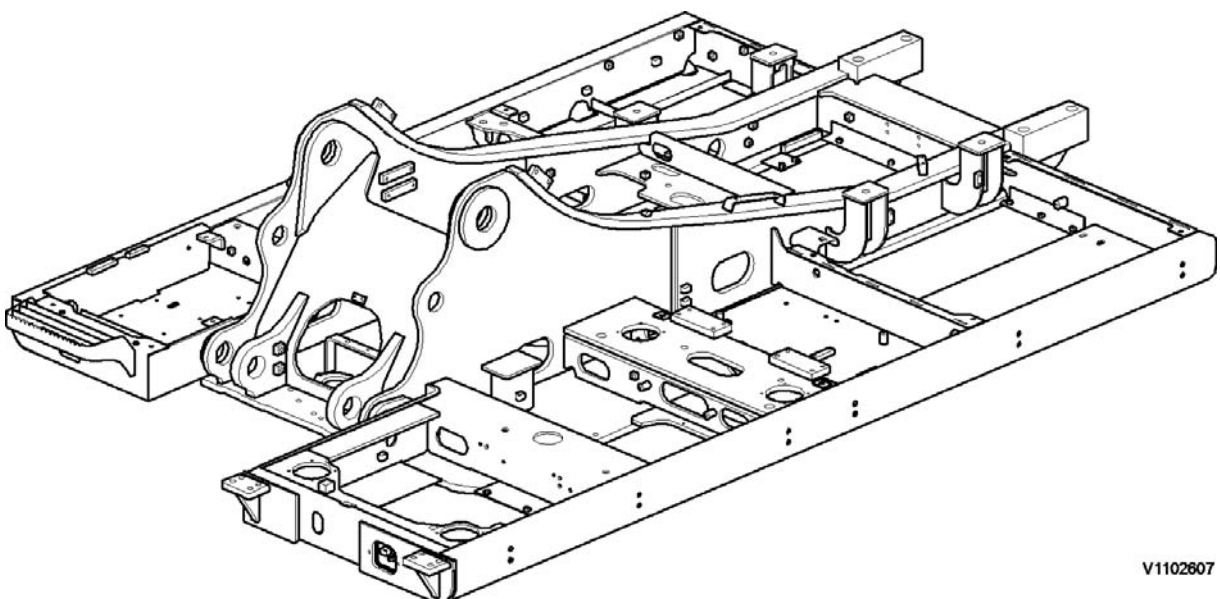

Figure 2
Upper frame

- With FOG sips, weight: 1840 kg (4057 lbs)

Lower frame type

NOTE!

See [7181 Undercarriage, description](#).

| | | | |
|--|-------------------------------|---|---------------------------|
| Document Title: Superstructure, removing | Function Group: 710 | Information Type: Service Information | Date: 2015/9/15 |
| Profile: EXC, EC220D LR [GB] | | | |

Superstructure, removing

Op nbr 710-001

1. Park the machine in the service position D. See [091 Service positions](#).
Position the machine on flat, firm and level ground, free from any obstructions or interference.
When the engine is running, the hydraulic line is under high pressure. Stop the engine, and remove the residual pressure inside the hydraulic line by operating the control lever smoothly 3-4 times with the ignition key at "ON" position. Turn the ignition key to "OFF" position.
2. Remove the hydraulic oil hoses, stopper screw, seal cover fixing screws, clamp and seal covers from center passage.

NOTICE

When a hose has been disconnected, plug both the hose and the connection immediately. The hoses should be marked for correct connection.

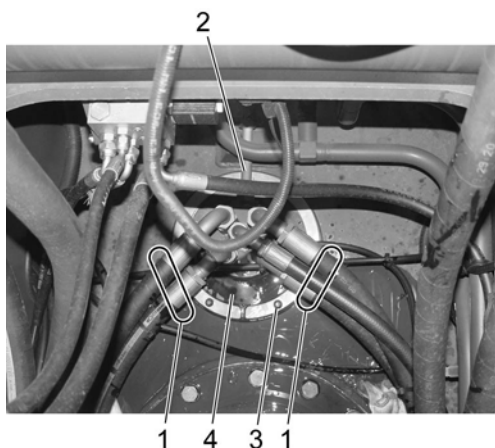

V1096385

Figure 1
Removal, hydraulic hoses

1. Hydraulic oil hoses
 2. Stopper screw
 3. Seal cover fixing screw
 4. Seal cover
3. Remove the two lifting points covers from the top of counterweight. See [716 Counterweight, removing](#).

<https://www.ebooklibonline.com>

Hello dear friend!

Thank you very much for reading.

Enter the link into your browser.

The full manual is available for immediate download.

<https://www.ebooklibonline.com>

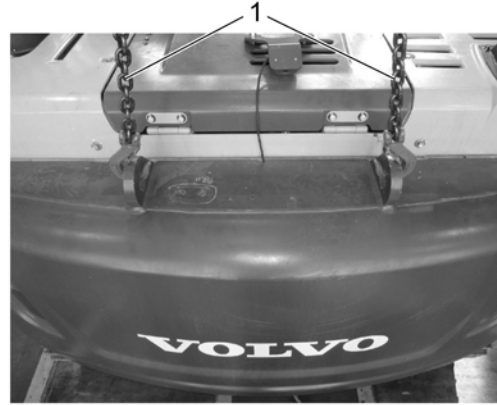
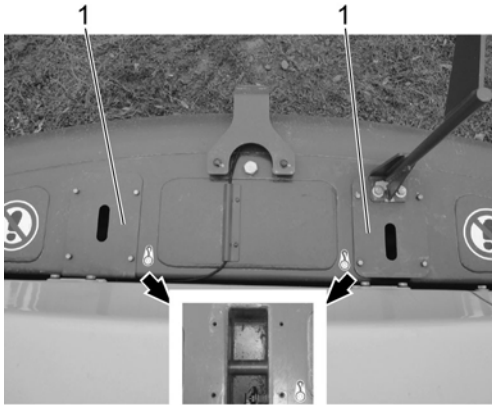

V1104184

Figure 2
Lifting points type

4. **! WARNING**
Risk of personal injury. Very heavy object.

! WARNING
The parts are heavy. Take appropriate safety cautions when handling them.

! WARNING
Never lift the machine with a person in the cab.

! WARNING
Always use classified cables, lifting straps, shackles and hooks with sufficient lifting capacity.

Hold the superstructure with wire ropes (cables).

Check the superstructure weight. See [710 Machine weight specifications](#).

Check the wire ropes length (cables). Refer to the operators manual for further operation or decal in cab. See [Operating instructions. Transporting machine. Lifting machine](#).

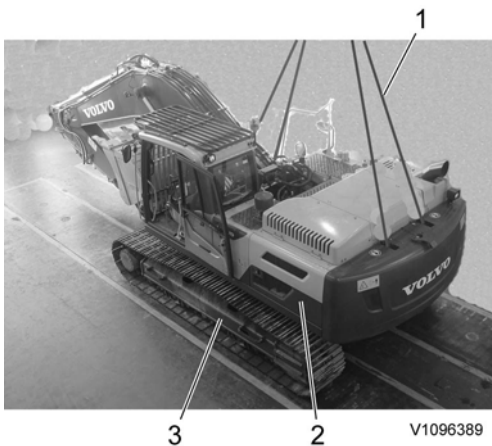

V1096389

Figure 3
Lifting superstructure

1. Wire rope (cable)
2. Superstructure
3. Undercarriage

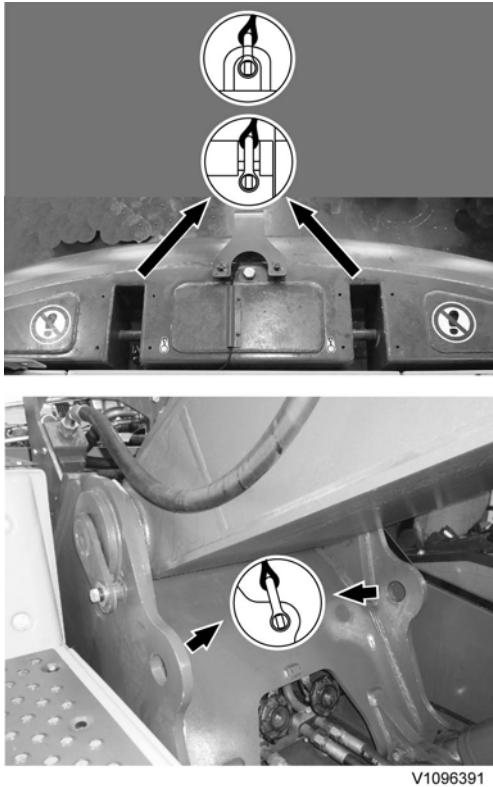

V1096391

Figure 4
Lifting points

NOTE!

As shown in the decal for lifting, connect lifting wire ropes (cables) or slings with sufficient strength for the machine weight at the lifting points correctly.

After installation of all hoisting equipment, lift the machine a little to check its balance, if satisfactory, lift it slowly and evenly.

5. Remove the superstructure mounting screws from the swing ring gear.

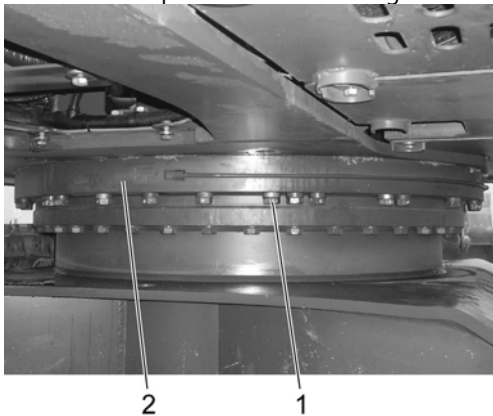

V1096387

Figure 5
Removal, superstructure mounting screws

1. Superstructure mounting screw
2. Swing ring gear

! WARNING

6. **The superstructure is heavy. Pay attention to safe footing and the area around the crane before proceeding to remove or install the superstructure.**

Remove the superstructure slowly and lower onto the 4 jacks safely.
Maintain good visibility of the machine at all times during the lift. And continuously check that the machine is level.



Figure 6
Removal, lifting superstructure (1)

| | | | |
|--|-------------------------------|---|---------------------------|
| Document Title: Superstructure, installing | Function Group: 710 | Information Type: Service Information | Date: 2015/9/15 |
| Profile: EXC, EC220D LR [GB] | | | |

Superstructure, installing

Op nbr 710-002

- ! WARNING**
Risk of personal injury. Very heavy object.

! WARNING
The parts are heavy. Take appropriate safety cautions when handling them.

! WARNING
Never lift the machine with a person in the cab.

! WARNING
Always use classified cables, lifting straps, shackles and hooks with sufficient lifting capacity.

Hold the superstructure with wires (cables).

Check the superstructure's weight. See [710 Machine weight specifications](#).

Wires' length (cables). Refer to the Operator's Manual for further operation or cab in lifting machine decal. See [Operating instructions, Transporting machine, Lifting machine](#).

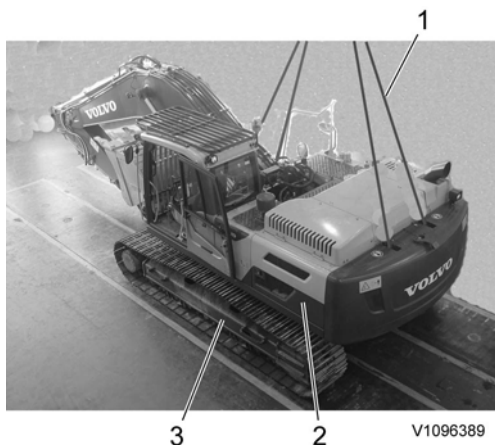
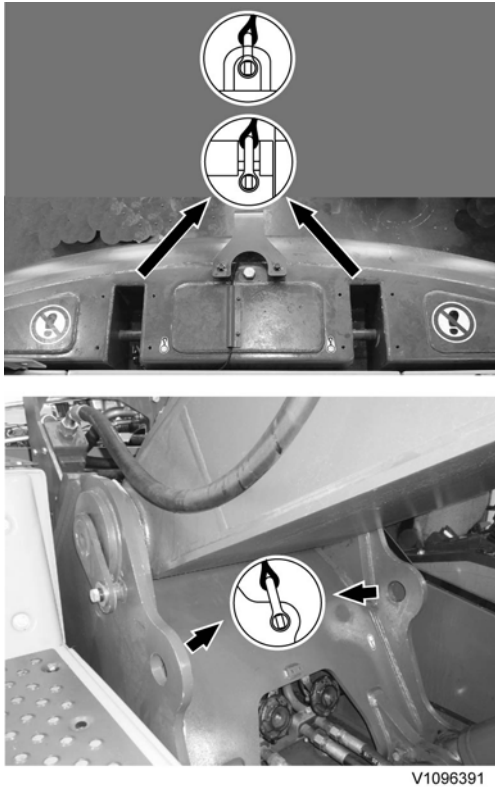

Figure 1
Lifting superstructure

1. Wire (cable)
2. Superstructure
3. Undercarriage



V1096391

Figure 2
Lifting points

NOTE!

As shown in the decal for lifting, connect lifting wires (cables) or slings with sufficient strength for the machine weight correctly at the lifting points.

After installation of all hoisting equipment, lift the machine a little to check its balance, if satisfactory, lift it slowly and evenly.

2. Clean the mounting surface thoroughly.
Before replacing the superstructure, apply sealing compound to the mounting surface.

NOTE!

If impurities remain, adhesion with bond agent will not be good.

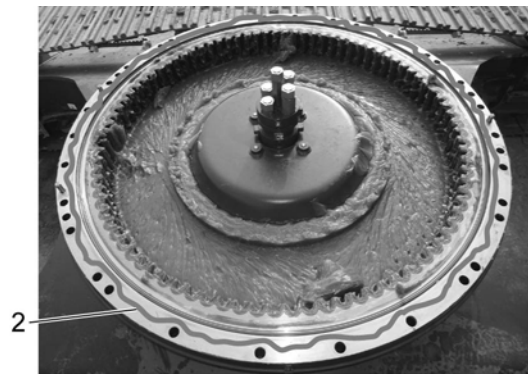

V1096393

Figure 3
Clean the mounting surface

1. Clean the mounting surface
2. Sealing compound

3.  **WARNING**

The superstructure is heavy. Pay attention to safe footing and the area around the crane before proceeding to remove or install the superstructure.

Lift the superstructure and install it to the swing ring gear.

Maintain good visibility of the machine at all times during the lift. Check continuously that the machine is level.

NOTE!

Match the "S" mark (soft zone position) on inner race and the plug on outer race.

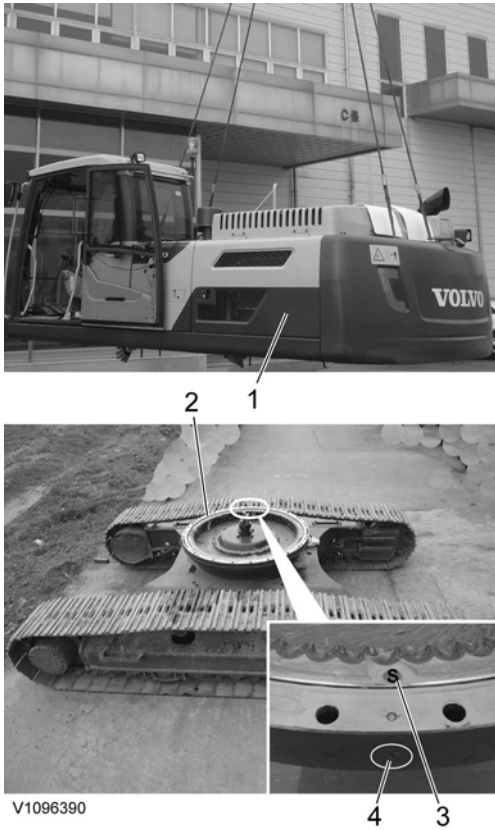

Figure 4
Installation, superstructure

1. Superstructure
2. Swing ring gear
3. "S" mark inner race (soft zone position)
4. Plug outer race

4. Install the superstructure's attaching bolts for the swing ring gear. Tightening torque. See [492 Swing ring gear, description](#). Apply Loctite #277 or equivalent locking fluid.



Figure 5
Installation, superstructure attaching bolts

1. Superstructure, attaching bolt
 2. Swing ring gear
5. Remove the wires (cables) at the lifting points.
 Install the seal covers, seal cover bolts, stop screw, clamp, and hydraulic oil hoses for the center passage.
 Tightening torque, seal cover bolt: 22.6 ± 1.96 Nm (2.3 ± 0.2 kgf m) (16.6 ± 1.4 lbf ft)
 Apply Loctite #277 or equivalent locking fluid.

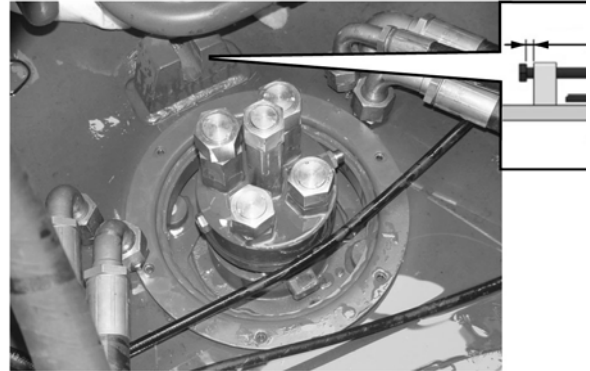
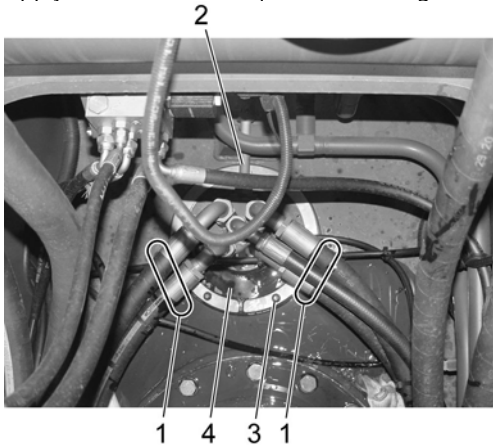

Figure 6
Installation, hydraulic hoses

1. Hydraulic oil hoses
 2. Stop screw: 242.2 ± 24.5 Nm (24.7 ± 2.5 kgf m) (178.3 ± 18 lbf ft)
 3. Seal cover bolts
 4. Seal cover
 5. Stop screw: 15 mm (0.59 inch)
6. Install the two lifting points' covers on the top of counterweight. See tightening torque. [716 Counterweight, tightening torques](#).

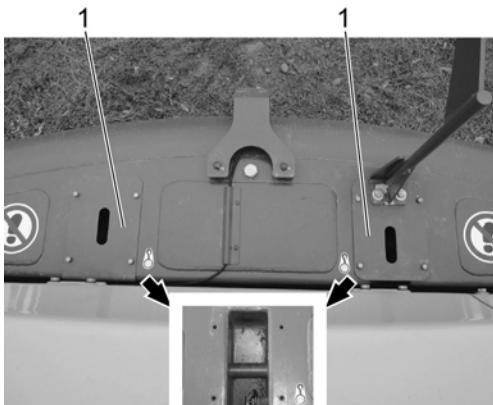

Figure 7
Lifting points type

7. Check the function of the swing, hydraulic oil hoses, and swing ring gear's attaching bolts.

| | | | | |
|---|--------------------|-------------------------------|---|---------------------------|
| Document Title: Tightening specifications | torque, 715 | Function Group: 715 | Information Type: Service Information | Date: 2015/9/15 |
| Profile: EXC, EC220D LR [GB] | | | | |

Tightening torque, specifications

Protection plates

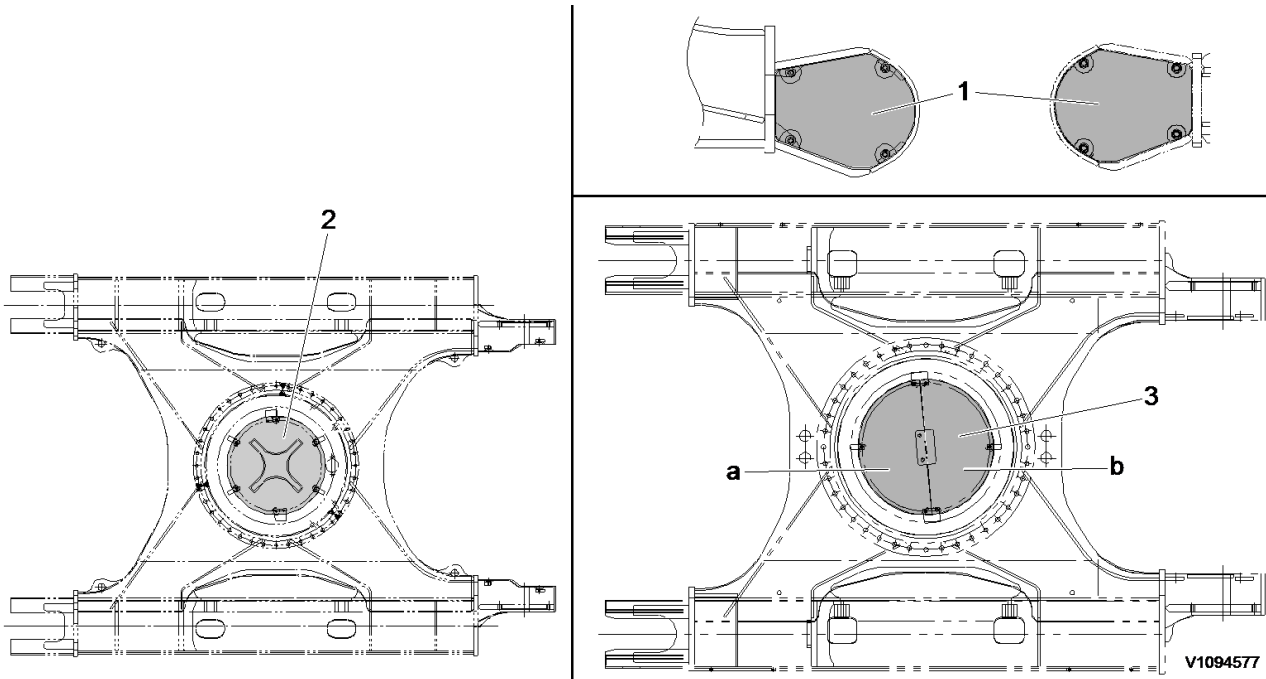

Figure 1
Machine view, protecting plate

Tightening torque: Nm (kgf m) (lbf ft)

| No. | Items | Weight: kg (lbs) | Tightening torque: Nm (kgf m) (lbf ft) |
|-----|---|----------------------------------|--|
| 1 | Track motor protection cover (LH, RH) | LH: 11.8 (26) RH: 11.8 (26) | 700 Undercarriage, tightening torque |
| 2 | Undercover standard (mud) Apply Loctite #277 or equivalent locking fluid | 20.2 (44.5) | 265 ±29 (27 ±3) (195 ±22) |
| 3 | Undercover heavy duty (mud) Apply Loctite #277 or equivalent locking fluid | a: 28.4 (62.6) b: 22.1 (48.7) | |

| | | | |
|--|-------------------------------|---|---------------------------|
| Document Title: Counterweight, description | Function Group: 716 | Information Type: Service Information | Date: 2015/9/15 |
| Profile: EXC, EC220D LR [GB] | | | |

Counterweight, description

Fabrication type

The counterweight is a counterbalancing weight that is located at the rear of the machine. The counterweight is designed in order to give the machine extra weight in the back end in order to counter the weight that is located at the front of the machine, in particular the boom and dipper arm.

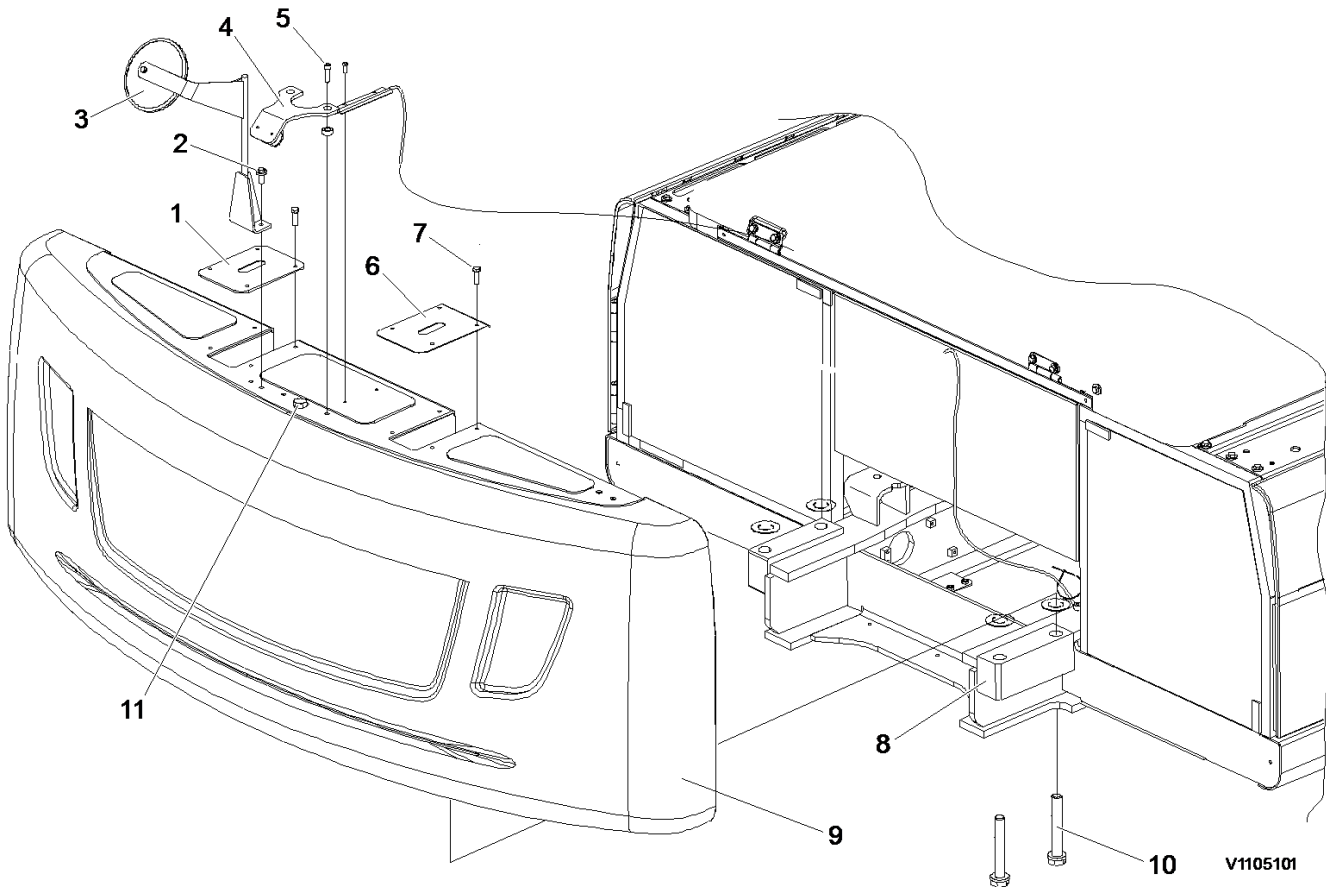

Figure 1
Counterweight, structure

| | | | | | |
|---|--------------------|---|-------------|----|---------------|
| 1 | Cover | 5 | Screws | 9 | Counterweight |
| 2 | Screws | 6 | Cover | 10 | Screws |
| 3 | Reflector assembly | 7 | Screws | 11 | Screw |
| 4 | Camera assembly | 8 | Upper frame | | |

| | | | |
|--|-------------------------------|---|---------------------------|
| Document Title: Counterweight, replacing | Function Group: 716 | Information Type: Service Information | Date: 2015/9/15 |
| Profile: EXC, EC220D LR [GB] | | | |

Counterweight, replacing

Fabrication type

Op nbr 716-003



The parts are heavy. Take appropriate safety cautions when handling them.

1. Park the machine in the service position B. See [091 Service positions](#).
2. Remove the two lifting points screws, covers and a reflect bracket from the top of counterweight.

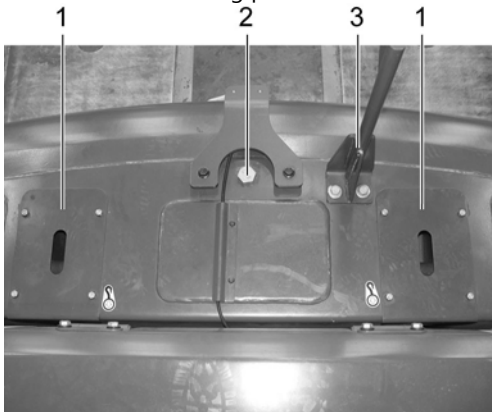

V1103196

Figure 1
Removal, lifting points covers

1. Lifting points covers
 2. Eye bolt lifting points
 3. Reflect bracket
3. Remove the wire harness connector.



V1103198

Figure 2
Removal, wire harness connector

1. Working light wire harness connector
4. Hold the counterweight with cables and remove the counterweight. See counterweight weight [716 Counterweight, specifications](#)

NOTE!

For fabrication type, the rate of the length for lifting cables and balance cables is 1 : 0.7.

Remove the four mounting screws, using socket wrench or power wrench. See [716 Counterweight, tightening torques](#).

Maintain the clearance. See [716 Counterweight, tightening torques](#).

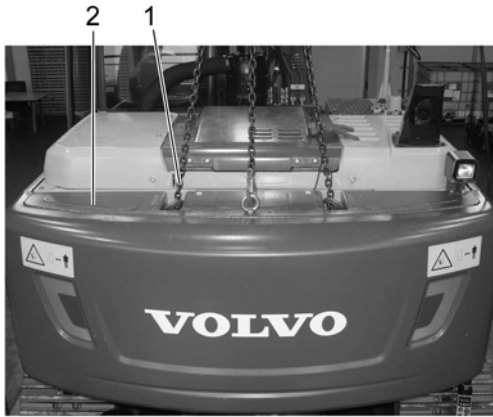

V1103199

Figure 3
Removal, mounting screw

1. Lifting cable
2. Counterweight

5. Move and assemble the working light and rear view camera of removed the counterweight to the new counterweight.



The parts are heavy. Take appropriate safety cautions when handling them.

6. Hold the counterweight with cable and install the counterweight. See counterweight weight [716 Counterweight, specifications](#)

NOTE!

For fabrication type, the rate of the length for lifting cables and balance cables is 1 : 0.7.

Install the four mounting screws, using socket wrench or power wrench. See [716 Counterweight, tightening torques](#).

Maintain the clearance. See [716 Counterweight, tightening torques](#).



Suggest:

For more complete manuals. Please go to the home page.

<https://www.ebooklibonline.com>

If the above button click is invalid. Please download this document first, and then click the above link to download the complete manual.

Thank you so much for reading

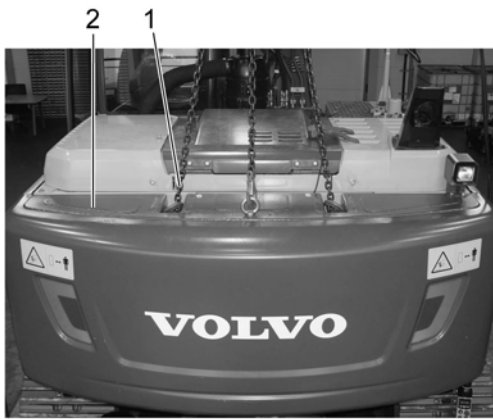

V1103199

Figure 4
Installation, mounting screw

1. Lifting cable
2. Counterweight

7. Install the wire harness connector.



V1103198

Figure 5
Installation, wire harness connector

1. Working light wire harness connector

8. Install the two lifting points covers, screws and a mirror bracket from the top of counterweight.

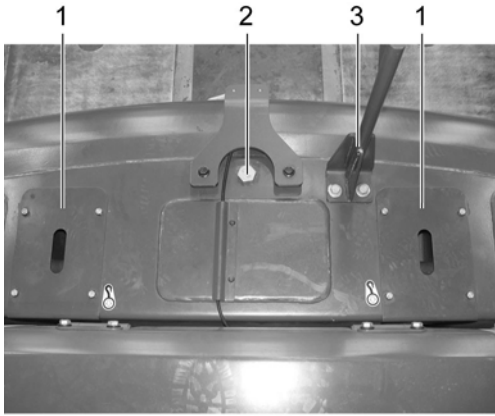

V1103196

Figure 6
Installation, lifting points covers

1. Lifting points cover
2. Eye bolt lifting points
3. Reflect bracket

<https://www.ebooklibonline.com>

Hello dear friend!

Thank you very much for reading.

Enter the link into your browser.

The full manual is available for immediate download.

<https://www.ebooklibonline.com>