

DOMINATOR 130

Repair manual

Genuine repair manual

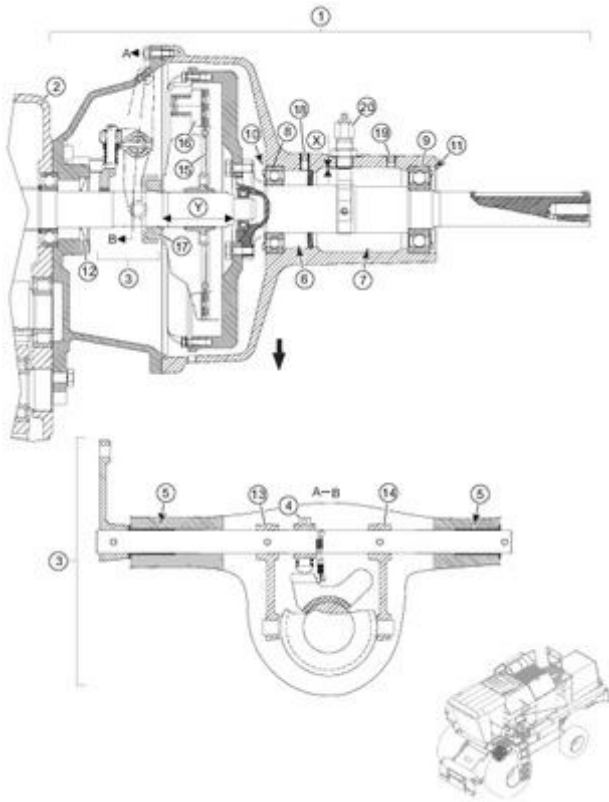

	Value	CCN	Remark / designation	
1	60 kg		Ground drive clutch	
2			Manual gearbox	<u>Manual gearbox</u>
3			Clutch brake Observe dimensions (Y1) and (Y2) when adjusting the clutch brake! Clean the brake lining and ensure it is free of grease and rust. Check brake components for oil and dirt, as well as for wear.	
4, 5			Grease pins (4) and bushings (5) with CLAAS AGRIGREASE EP 2.	<u>Ground drive clutch</u>
6, 7			Fill hollow spaces (6) and (7) completely with 30 g of CLAAS AGRIGREASE EP 2 each.	<u>Ground drive clutch</u>
8 - 11			Install bearings (8) and (9) with the closed side facing the outside . Insert bearing seal rings at (10) and (11).	
12			- Installation of radial shaft seal (12): <ul style="list-style-type: none"> • Apply a little CLAAS AGRIGREASE EP 2 to the dust lip prior to installation. • Seal the housing with omniFIT FD 10. 	<u>Ground drive clutch</u>
13, 14			Observe the installation position of clutch forks (13) and (14)!	

	Value	CCN	Remark / designation	
15, 16			Observe the installation position of clutch plate (15)!	
			Clean clutch plate (15) and thrust plate (16) so they are free of grease and rust.	
			Check clutch components for oil and dirt, as well as for wear.	
17			Check if clutch release ring (17) is worn.	
18, 19			Plugs (18) and (19) must face up when installing the ground drive clutch.	
20			Adjust speed sensor (20) to dimension (X).	
X	0.5 - 1 mm		Adjustment dimension	
Y1	94 ± 2 mm		Check dimension (beginning of braking process)	
Y2	79 mm		Check dimension (clutch actuation travel)	
Tightening torques not specified, see "Introduction / Tightening torques" chapter				

Removal

- ▶ Remove the driven pulley of belt (R18).
Driven pulley of belt (R18)

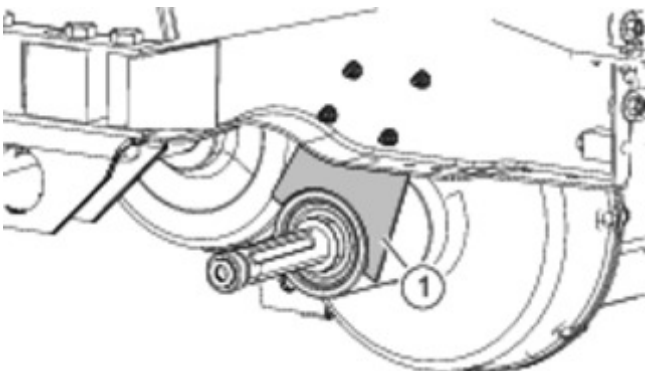

- ▶ Remove bracket (1).

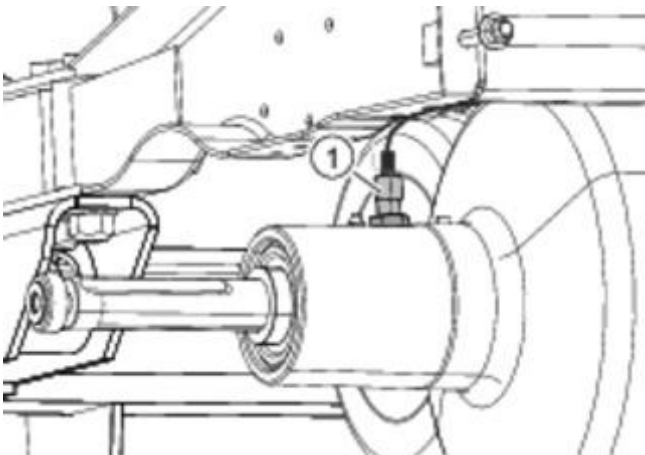

- ▶ Pull off cable connector from sensor (1).

<https://www.ebooklibonline.com>

Hello dear friend!

Thank you very much for reading.

Enter the link into your browser.

The full manual is available for immediate download.

<https://www.ebooklibonline.com>

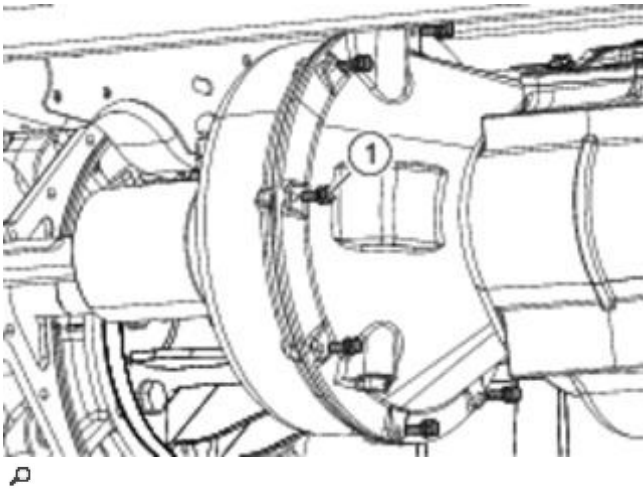

- ▶ Unscrew bolts (1) from the clutch housing.

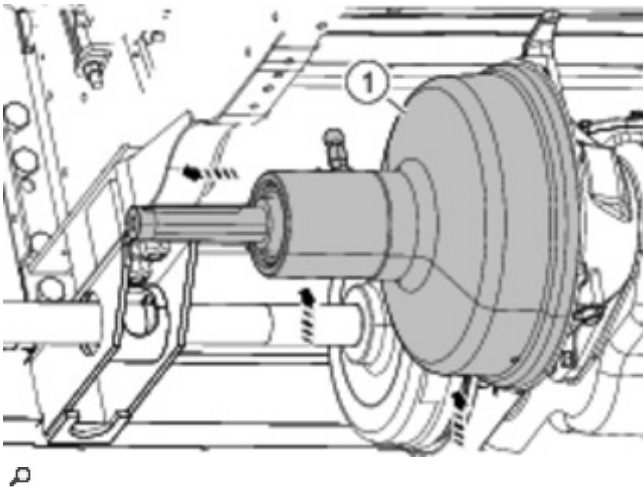

⚠ WARNING

Lifting heavy components.

Risk of death or serious injury.

- ▶ Use a lifting tool with a sufficient bearing load.
- ▶ Use a lifting tool that operates reliably.
- ▶ Use the lifting tool on solid and even ground.
- ▶ Attach the lifting tool to the component at the intended or a suitable position.
- ▶ Only use faultless and sufficiently dimensioned lifting accessories.
- ▶ Protect lifting accessories against sharp corners and edges, for example using protectors.

-
- ▶ Slightly lift ground drive clutch (1) using a suitable lifting device.

Weight of ground drive clutch:

Ground drive clutch

- ▶ Pull away ground drive clutch (1) in the direction of the arrow.
- ▶ Remove the clutch actuation.

Ground drive clutch

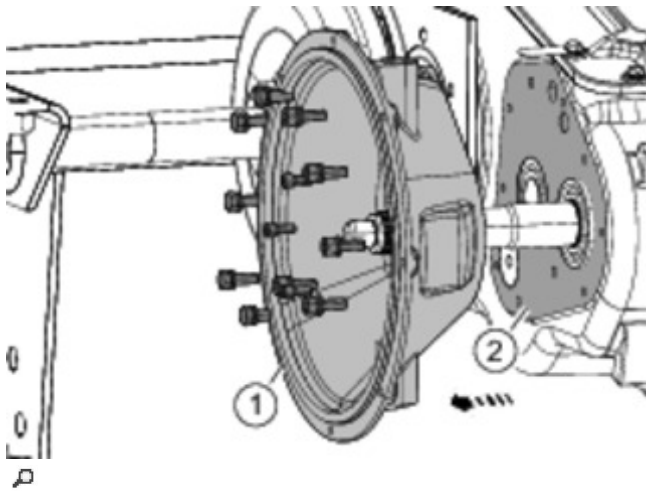

- ▶ Remove clutch housing (1) with seal (2) and the existing shims.

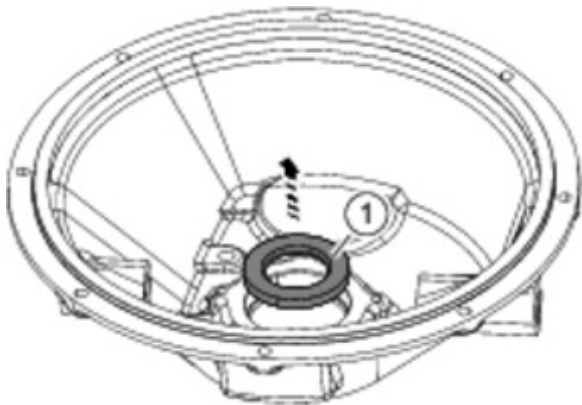

- ▶ Drive out radial shaft seal (1).

Disassembly

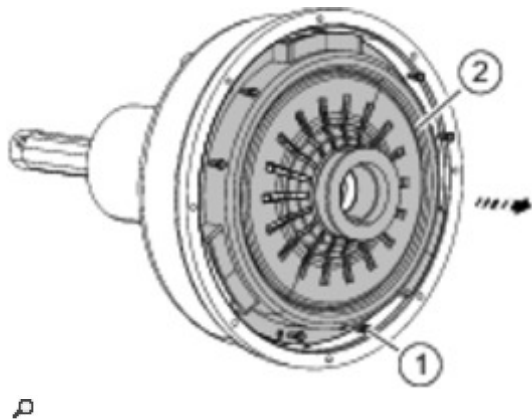

- ▶ Unscrew bolts (1) from thrust plate (2).
- ▶ Remove thrust plate (2).

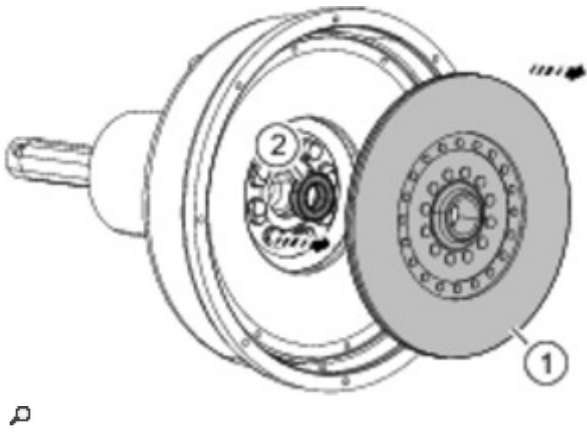

- ▶ Remove clutch plate (1).
- ▶ Pull out bearing (2).

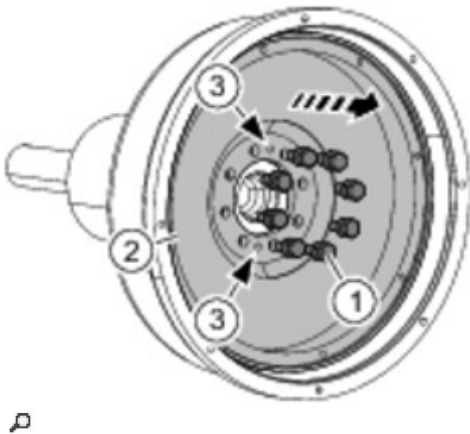

- ▶ Unscrew plugs (1).
- ▶ Removing the flywheel (2):
 - ▶ Screw two existing bolts (1) into the free tapped holes (3).
 - ▶ Push off flywheel (2).

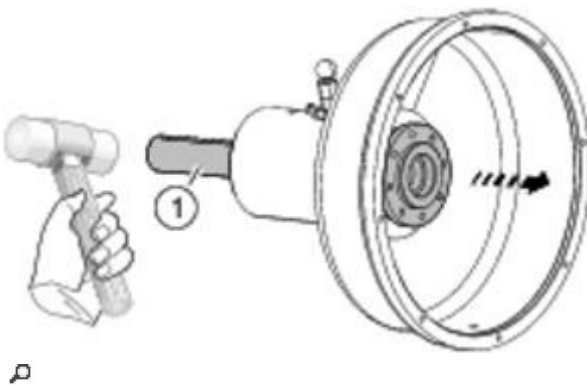

- ▶ Drive out flanged shaft (1) with a plastic-tip hammer.

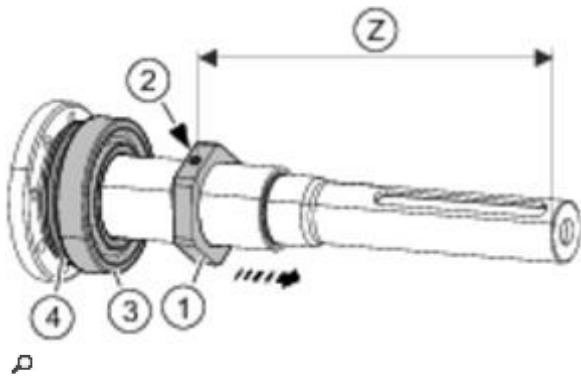

- ▶ Determine dimension (Z) from the shaft end to the cam wheel (1).
- ▶ Slacken off clamping bolt (2).
- ▶ Pull off bearing (3) and bearing seal ring (4).

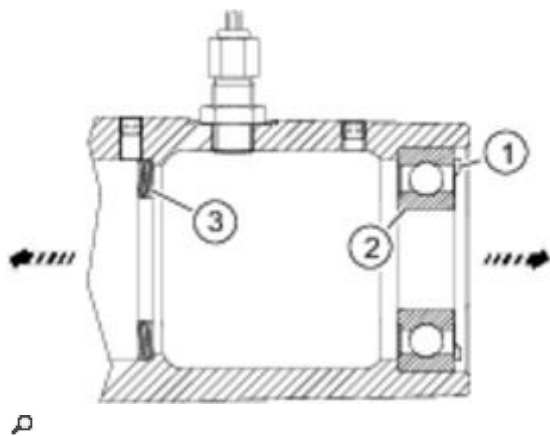
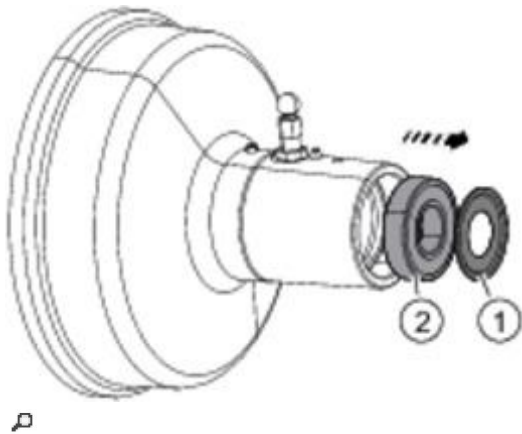

- ▶ Drive out bearing seal ring (1) and bearing (2).
- ▶ Drive out segment seal (3).

Assembly

Observe the technical specifications!

Ground drive clutch

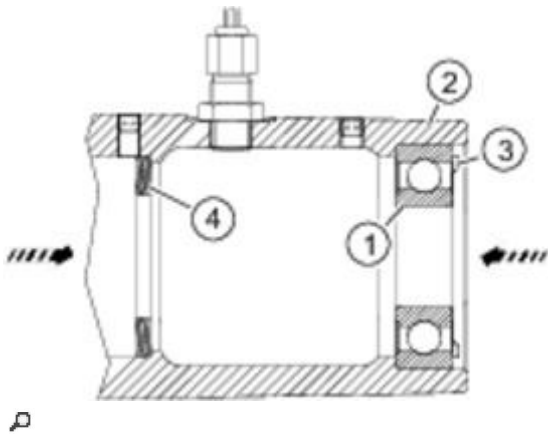
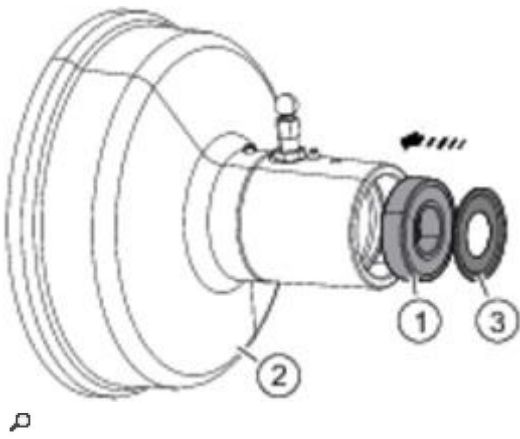

- ▶ Drive bearing (1) into housing (2) with the closed side facing the **outside** .
- ▶ Install bearing seal ring (3).
- ▶ Drive in segment seal (4).

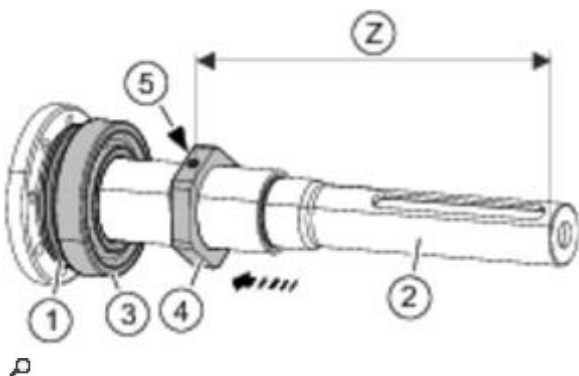

- ▶ Slide bearing seal ring (1) on the flanged shaft (2).
- ▶ Heat up bearing (3) to **approx. 100 °C** and install it with the closed side **facing the flange** .
- ▶ Slide on cam wheel (4) with the previously determined dimension (Z).
- ▶ Bolt down clamping bolts (5).

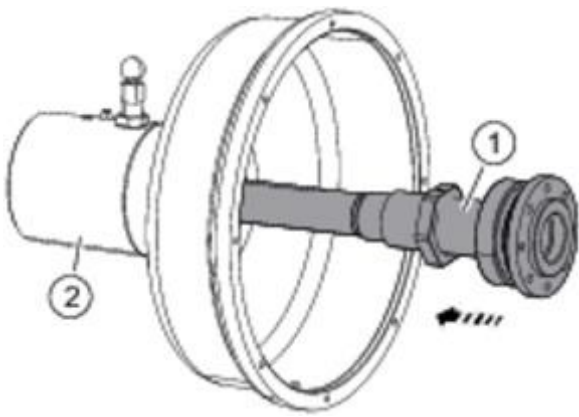

D

- ▶ Press flanged shaft (1) (pre-assembled) into housing (2) (pre-assembled).

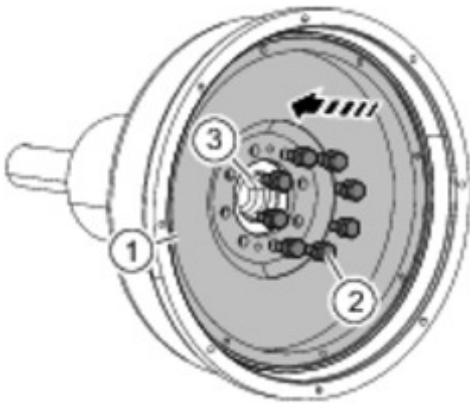

D

- ▶ Bolt flywheel (1) down to the flanged shaft (3) with bolts (2) with **new** circlips.

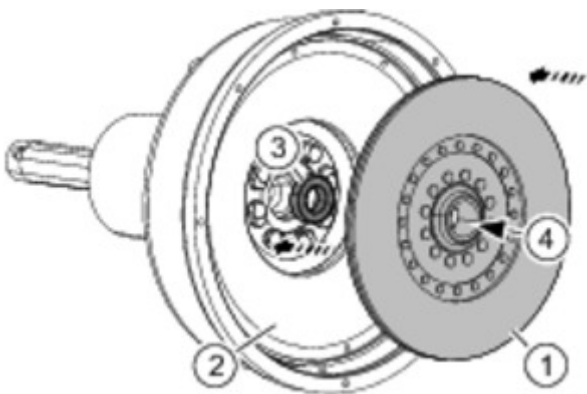

D

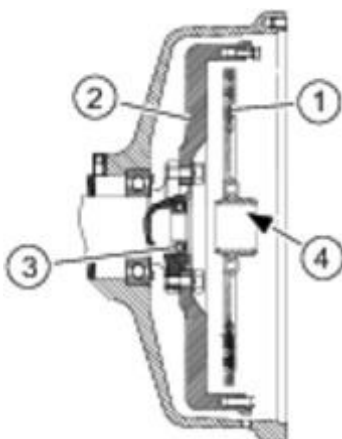

D

Check clutch components for oil and dirt, as well as for wear, and replace if necessary.

Clean clutch plate (1) and friction face of flywheel (2) so they are free of grease and rust.

Observe the installation position of clutch plate (1)!

- ▶ Drive bearing (3) into flywheel (2).
- ▶ Insert clutch plate (1).
- ▶ Coat gearing (4) of clutch plate (1) with Anti-Seize.
Ground drive clutch

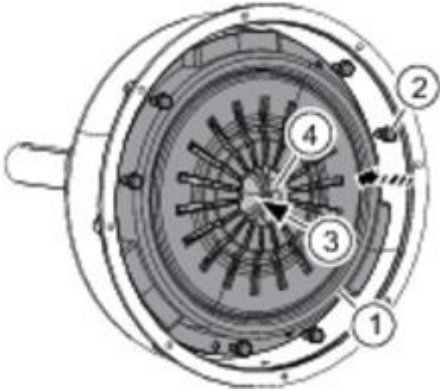

p

Use special tool (l) (centring tool):

Ground drive clutch

- ▶ Clean friction face of thrust plate (1) and ensure it is free of rust and grease.
- ▶ Bolt thrust plate (1) down to the flywheel loosely with bolts (2) and new circlips.
- ▶ Introduce special tool (l) into gearing (3) of clutch plate (4).
- ▶ Bolt down the thrust plate (1) crosswise.
- ▶ Remove special tool (l).

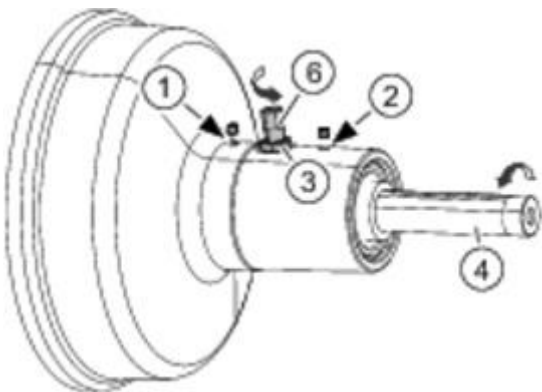

p

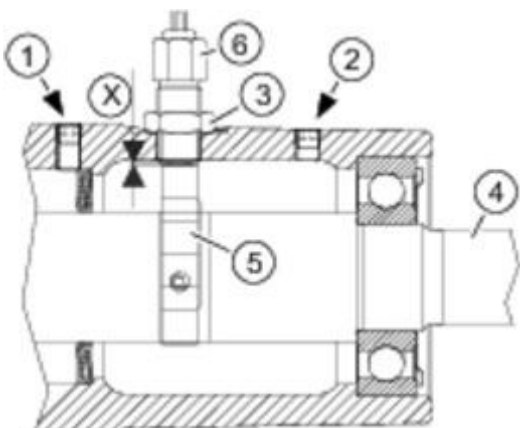

- Ⓟ
- ▶ Unscrew plugs at (1) and (2).
 - ▶ Unscrew sensor (6).
 - ▶ Check the installation position of cam wheel (5) relative to the tapped hole and change by relocating on shaft (4) if necessary.
 - ▶ Align cam wheel (5) to the highest position relative to the tapped hole by rotating shaft (4).
 - ▶ Screw in sensor (6) up to the stop and then turn out by **half** a turn.
 - ▶ Tighten lock nut (3).
 - ▶ Fill in **30 g** of CLAAS AGRIGREASE EP 2 each at (1) and (2).
Ground drive clutch
 - ▶ Plug openings tightly with plugs at (1) and (2).
 - ▶ Rotate shaft (4) and check if it runs smoothly.
 - ▶ Prepare the ground drive clutch for installation, with sensor (6) facing **up** .

Installation

Observe the technical specifications!

Ground drive clutch

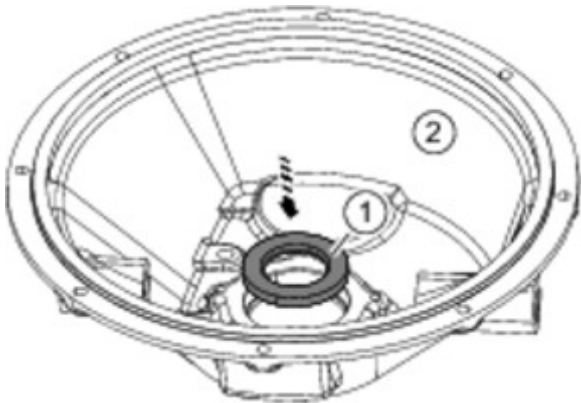

Ⓟ

Grease dust lip of radial shaft seal (1) slightly with CLAAS AGRIGREASE EP 2.

Ground drive clutch

Apply omniFIT FD 10 to the housing.

- ▶ Drive radial shaft seal (1) into clutch housing (2) to be flush with the housing edge.

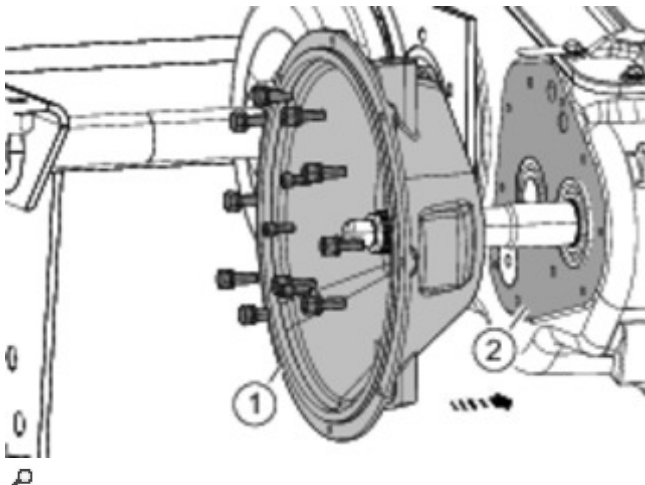

Ⓟ

Insert bolts with omniFIT FD 10.

Ground drive clutch

- ▶ Install clutch housing (1) (pre-assembled) on the manual gearbox with a **new** seal (2) and the existing shims.
- ▶ Install the clutch actuation.

Ground drive clutch

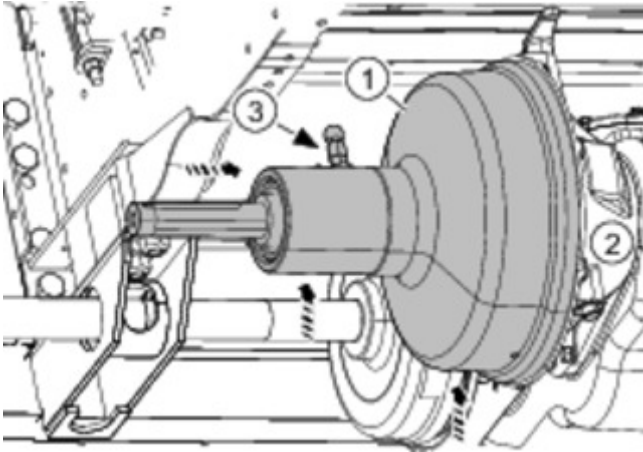

⚠ WARNING

Lifting heavy components.

Risk of death or serious injury.

- ▶ Use a lifting tool with a sufficient bearing load.
- ▶ Use a lifting tool that operates reliably.
- ▶ Use the lifting tool on solid and even ground.
- ▶ Attach the lifting tool to the component at the intended or a suitable position.
- ▶ Only use faultless and sufficiently dimensioned lifting accessories.
- ▶ Protect lifting accessories against sharp corners and edges, for example using protectors.

Align ground drive clutch (1) to be exactly straight when installing in order to avoid damaging components.

- ▶ Slightly lift ground drive clutch (1) (pre-assembled) using a suitable lifting device.
Weight of ground drive clutch:
Ground drive clutch
- ▶ Lift ground drive clutch (1) ahead of clutch housing (2) laterally in the direction of the arrow.
Caution! The sensor (3) must face **up** !

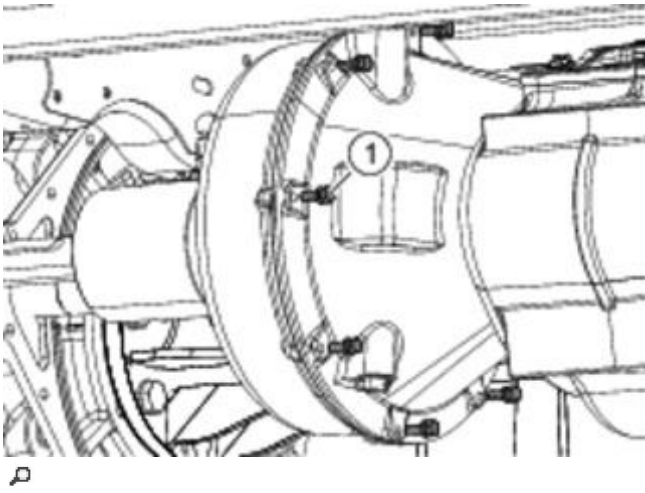

- ▶ Bolt ground drive clutch down to the clutch housing with bolts (1).

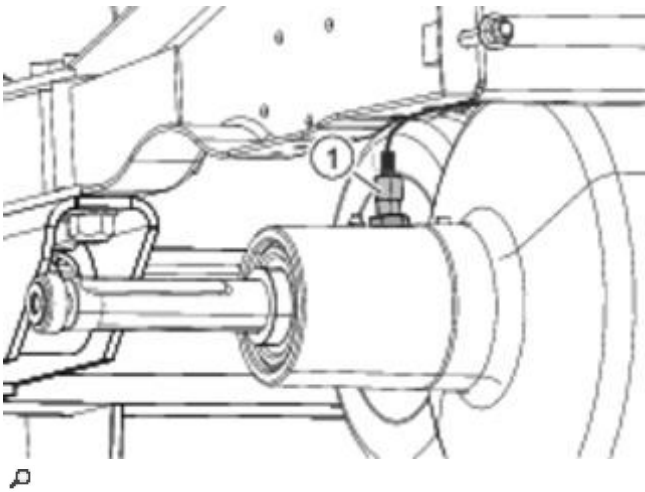

- ▶ Connect connector to sensor (1).

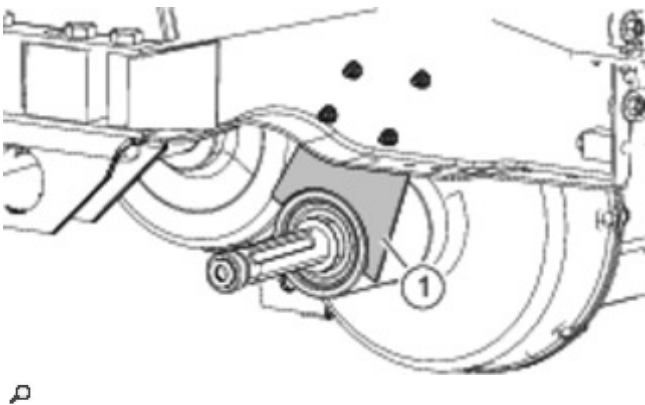

- ▶ Install bracket (1) and push it **down** as far as possible in the slotted holes.
- ▶ Install the driven pulley of belt (R18).
Driven pulley of belt (R18)
- ▶ Adjust the ground drive clutch.
Ground drive clutch
- ▶ Check the function.

Adjustment

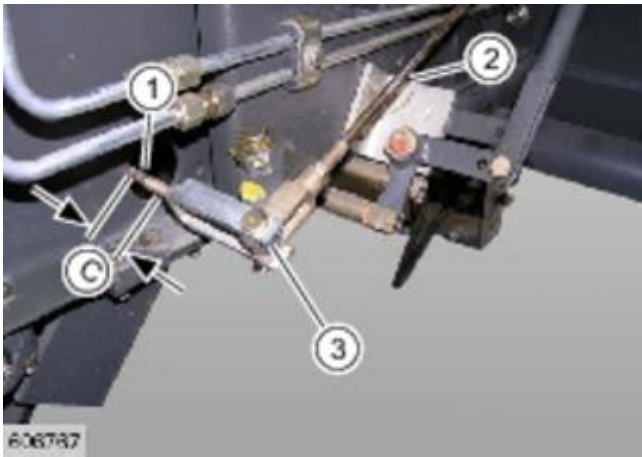

D

- ▶ Unhook rods (1) and (2) fitted on lever (3).
- ▶ Pull rod (1) to the outside against the resistance.
- ▶ Adjust dimension (C) between the inner edge of nut and the side wall.
Adjusting dimension (C) = 40 mm

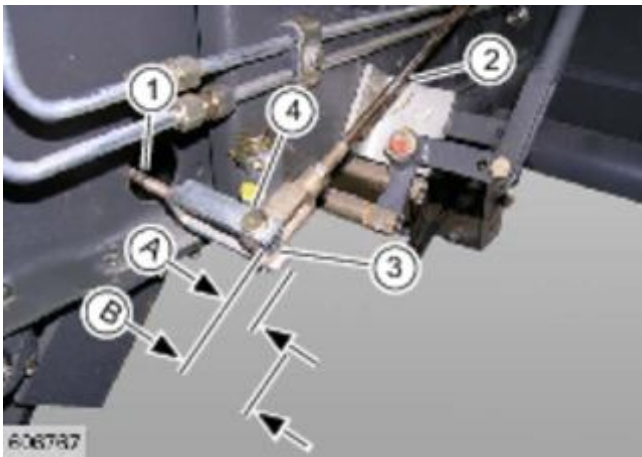

D

- ▶ Fit rods (1) and (2) to lever (3), using pin (4).
- ▶ Press the clutch pedal until a resistance is felt.
- ▶ Determine deflection (A) and adjust on rod (1) if required.
Adjusting dimension (A) = 7 - 11 mm
- ▶ Press the clutch pedal down to the end.
- ▶ Determine deflection (B) and adjust on rod (1) if required.
Adjusting dimension (B) = 20 ± 1 mm



D

- ▶ With the clutch pedal in rest position, adjust linkage (1) so that lever (2) of hydraulic valve is retracted by **3 to 5 mm** .

Removing the clutch actuation

- ▶ Remove the ground drive clutch.
Ground drive clutch

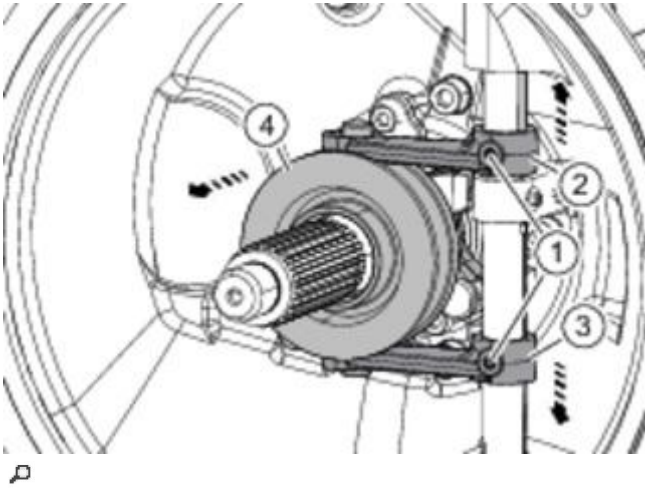

- ▶ Drive out expansion pins (1).
- ▶ Push forks (2) and (3) up and down.
- ▶ Remove slip ring (4).

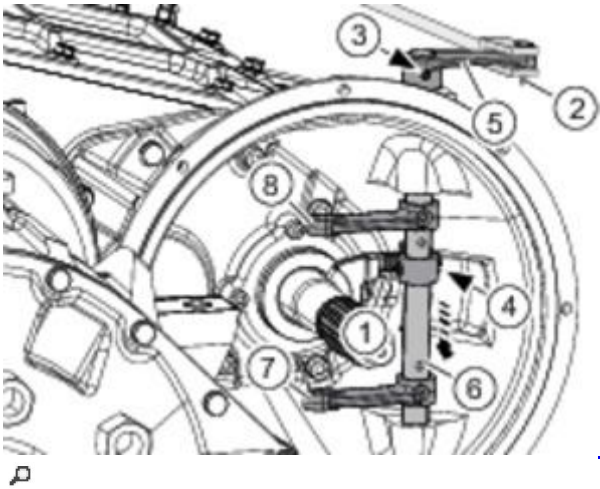

Observe the installation position of all components!

- ▶ Unhinge spring (1).
- ▶ Unlock pin (2) and pull it out.
- ▶ Drive out expansion pins (3) and (4).
- ▶ Pull off lever (5).
- ▶ Pull shaft (6) out to the bottom.
- ▶ Remove forks (7) and (8).

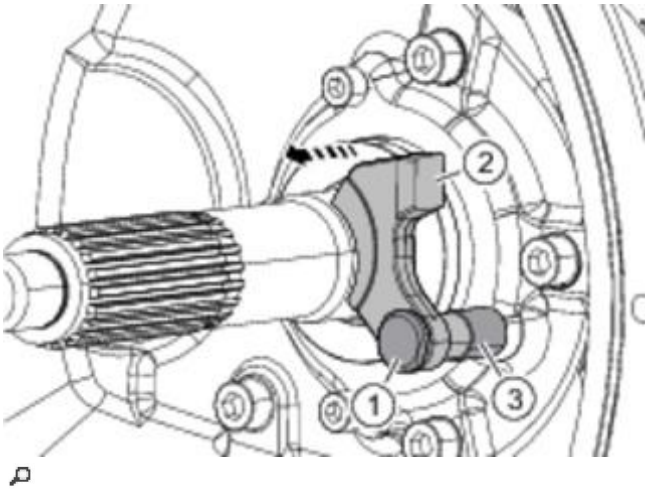

- ▶ Unscrew pin (1).
- ▶ Remove brake shoe (2) and sleeve (3).

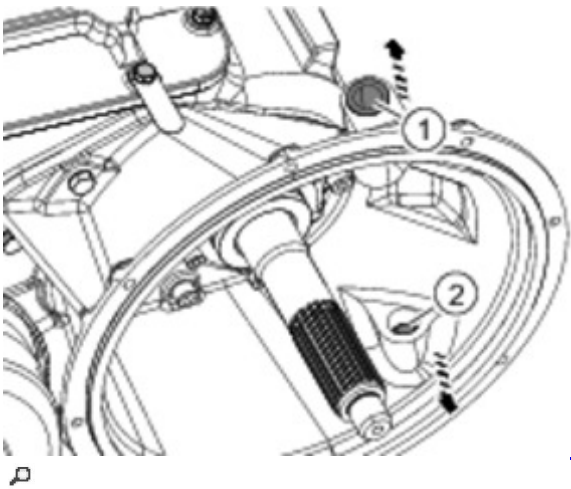

- ▶ Drive out bushings (1) and (2).

Installing the clutch actuation

Observe the technical specifications!

Ground drive clutch

Check components for oil and dirt, as well as for wear, and replace if necessary.

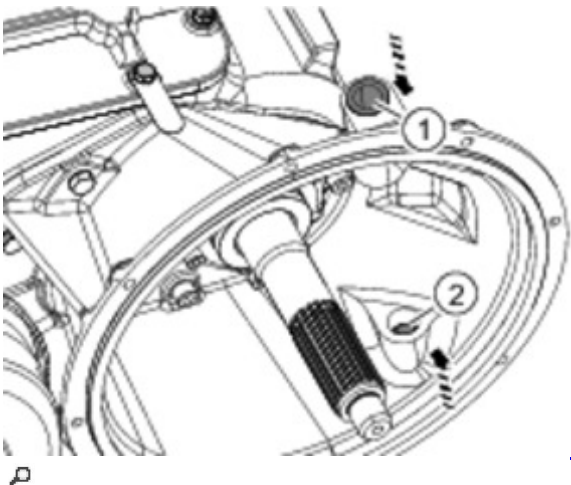

- ▶ Drive in **new** bushings (1) and (2).
- ▶ Grease bushings (1) and (2) with CLAAS AGRIGREASE EP 2.
Ground drive clutch

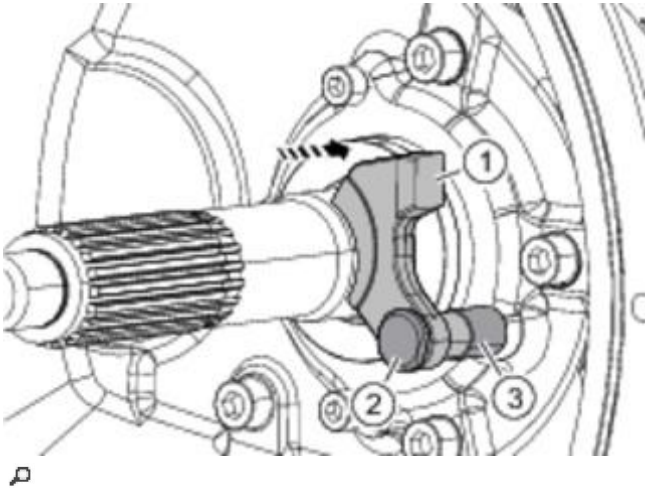

Clean brake shoe (1) and friction face of shaft (2) so they are free of grease and rust.

- ▶ Bolt down brake shoe (1) with bolts (2) and sleeve (3).

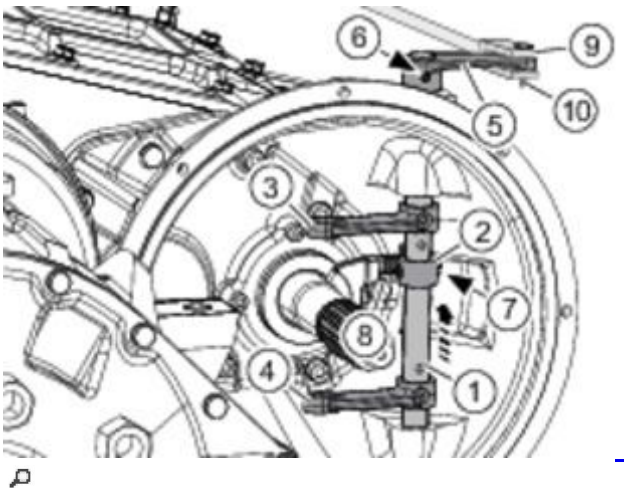

Observe the installation position of all components!

- ▶ Insert shaft (1) from the bottom with lever (2), forks (3) and (4) and lever (5).
- ▶ Drive in **new** expansion pins (6) and (7).
- ▶ Fit spring (8).
- ▶ Fit fork (9).
- ▶ Insert and secure pin (10).

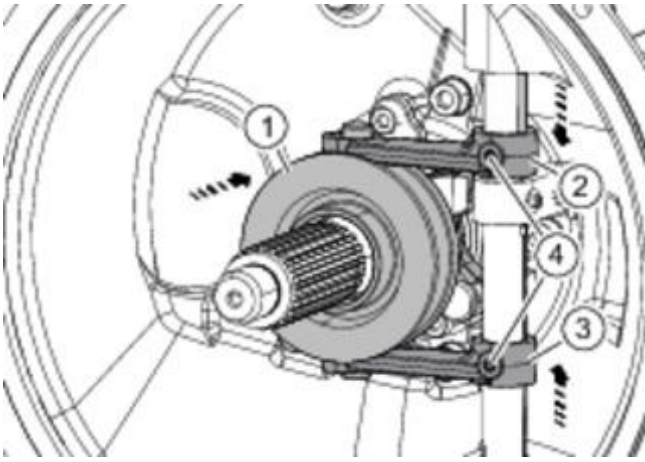

- ▶ Coat inner sliding face of slip ring (1) with Anti-Seize.
Ground drive clutch
- ▶ Insert slip ring (1).
- ▶ Push forks (2) and (3) into the installation position.
- ▶ Drive in **new** expansion pins (4).

- ▶ Install the ground drive clutch.
Ground drive clutch
- ▶ Check the function.

Wheel bolt

Work preparation

Operating utilities:

- ▶ Solid lubricant, for example:
MOLYKOTE G-n Plus - 00 0177 571 0
- ▶ Assembly paste, for example:
Anti-Seize - 00 0136 571 0

Special tool

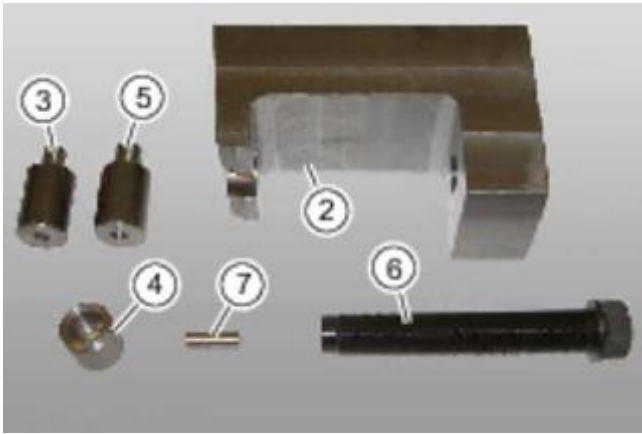

▢

	Special tool (I)	Pcs.
1	Installation tool kit 00 0181 861 0	
Consisting of:		
2	Puller bridge 00 0181 862 0	1
3	Adapter 00 0181 863 0	1
4	Adapter 00 0181 864 0	1
5	Adapter 00 0181 865 0	1
6	Threaded spindle 00 0181 801 1	1
7	Cylinder pin 00 0242 867 0	1

Technical specifications

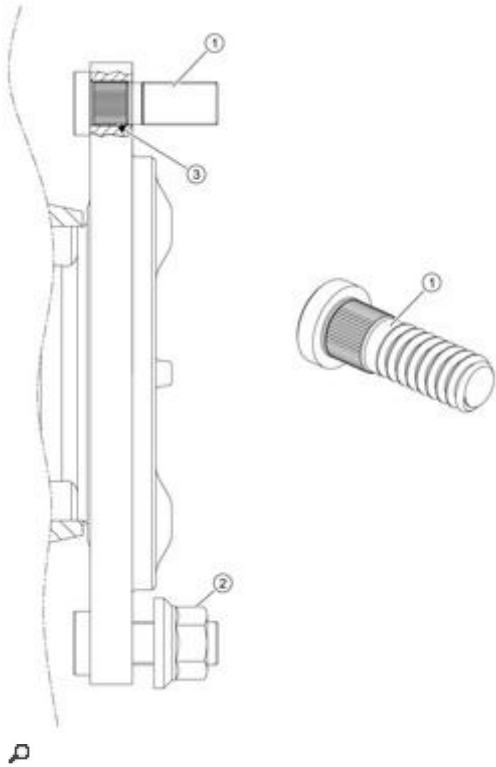

P

	Value	CCN	Remark / designation	
1			Clean wheel bolts so they are free of grease, rust, burrs and are dry prior to installation. Coat gearing of wheel bolts with Anti-Seize.	<u>Wheel bolt</u>
2	400 Nm		Pull in wheel bolt with wheel nut in two steps: <ul style="list-style-type: none"> • Step 1: 400 Nm • For tightening torque stage 2 see the Operator's Manual of the machine in question. 	
3			Clean bore so it is free of grease, rust, burrs and is dry prior to installation.	
Tightening torques not specified, see "Introduction / Tightening torques" chapter				

Removal

- ▶ Secure the machine with wheel chocks so it will not roll away. Ensure that the parking brake is **not** engaged.
- ▶ Put gear shift mechanism in neutral position.
- ▶ Jack up the machine and support it safely at the specified supporting point beneath the drive axle.
- ▶ Remove the drive wheel.
See the Operator's Manual of the machine in question.



⤵

Use special tool (I) (installation tool kit).

Wheel bolt

- ▶ Coat spindle (1) and pin (2) of special tool (I) with MOLYKOTE G-n plus.
Wheel bolt
- ▶ Pre-assemble special tool (I) as shown in the picture.
- ▶ Put adapter (3) of special tool (I) on the wheel bolt.

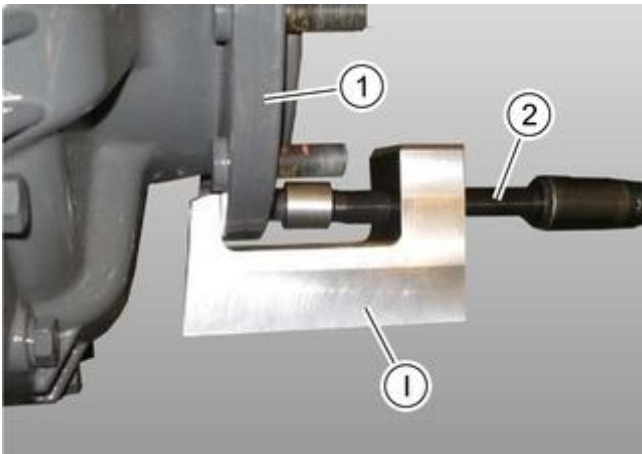

⤵

NOTICE

High axial forces are involved.

Damage of hand tools and machine components.

- ▶ Install the special tool precisely without tilting.
- ▶ Actuate the special tool only with a hand tool.
- ▶ **Never** use an impact wrench!

Use special tool (I) (installation tool kit).

Wheel bolt

- ▶ Install special tool (I).
 - ▶ Turn the wheel shaft (1) to do this if necessary.
 - ▶ Force out the wheel bolt by evenly rotating threaded spindle (2).

Installation

NOTICE

Wheel bolts damaged by incorrect storage or rough treatment.

Damage of machine components.

- ▶ Check the wheel bolt threads and tooting prior to installation.
- ▶ Remove any existing burrs and rust.
- ▶ Use only flawless wheel bolts.

Observe the technical specifications!

Wheel bolt

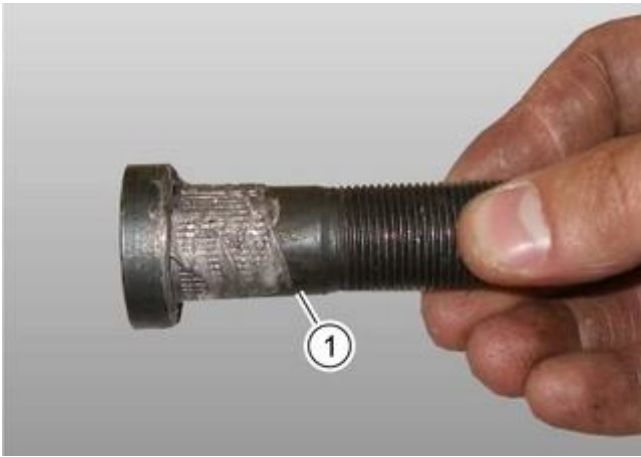

♣

- ▶ Check wheel bolt (1) for damage and prepare them for installation.
- ▶ Coat gearing of wheel bolts (1) with Anti-Seize.

Wheel bolt

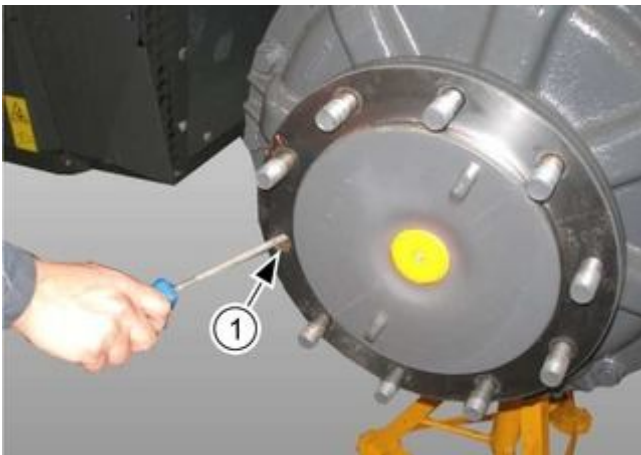

♣

- ▶ Check the corresponding bore (1) for damage and prepare for installation.



Suggest:

For more complete manuals. Please go to the home page.

<https://www.ebooklibonline.com>

If the above button click is invalid. Please download this document first, and then click the above link to download the complete manual.

Thank you so much for reading

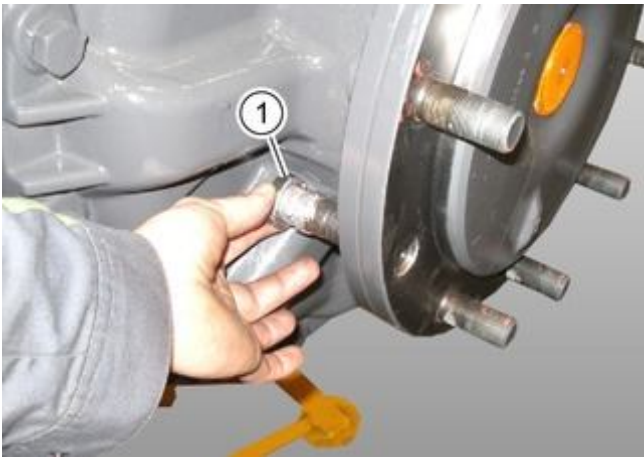

p

- ▶ Insert wheel bolt (1).
 - ▶ Ensure that the external tothing of the wheel bolt engages with the existing tothing of the bore.
 - ▶ Turning the wheel bolt must **no longer** be possible.

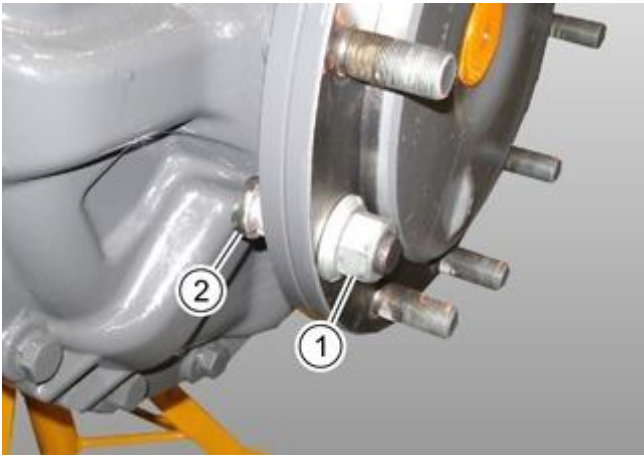

p

- ▶ Remove any grease from thread of wheel nut (1) and screw it on the wheel bolt (2).
- ▶ Pull wheel nut (1) forward until wheel bolt (2) starts being pulled into the drilled hole.
 - ▶ *In case of considerable stiffness, the tothing of the wheel bolt must be newly inserted.*

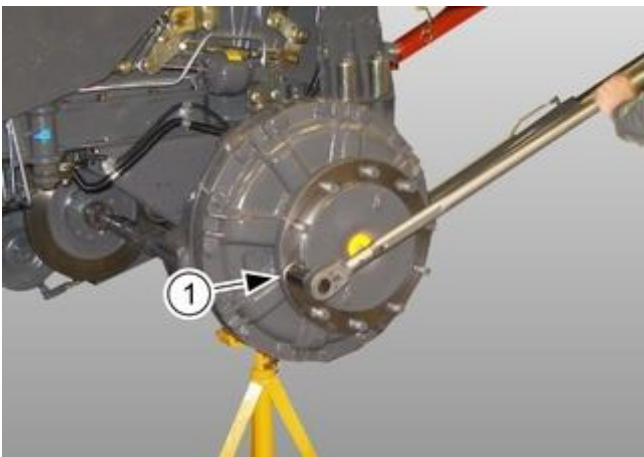

p

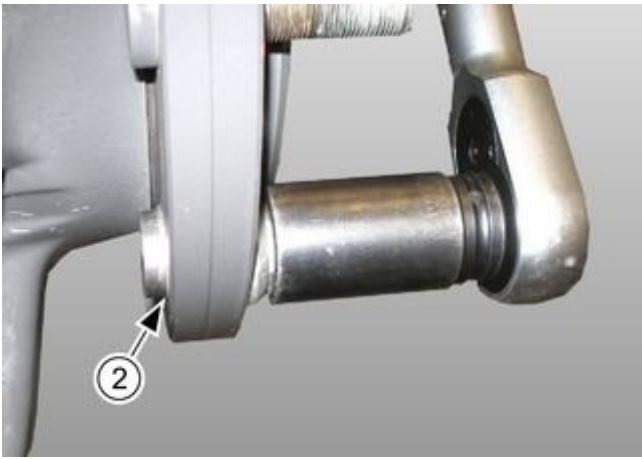

- ▶ Block the wheel shaft with the service brake.
- ▶ Pulling in the wheel bolt (1) in two steps:
 - ▶ Step 1: Pull the wheel bolts (1) evenly and smoothly into the drilled hole until collar (2) makes contact with the flange surface.
 - ▶ Step 2: Re-tighten the wheel bolts (1).
See the Operator's Manual of the machine in question.
- ▶ Unscrew wheel nut.
- ▶ Check the thread of wheel nut and of wheel bolt.
- ▶ Check wheel bolt for elongation.
- ▶ Install the drive wheel.
See the Operator's Manual of the machine in question.
- ▶ Check for correct operation.

<https://www.ebooklibonline.com>

Hello dear friend!

Thank you very much for reading.

Enter the link into your browser.

The full manual is available for immediate download.

<https://www.ebooklibonline.com>