

OPERATOR'S MANUAL

ROTARY TILLERS

RT 1060 E

RT 1070 E

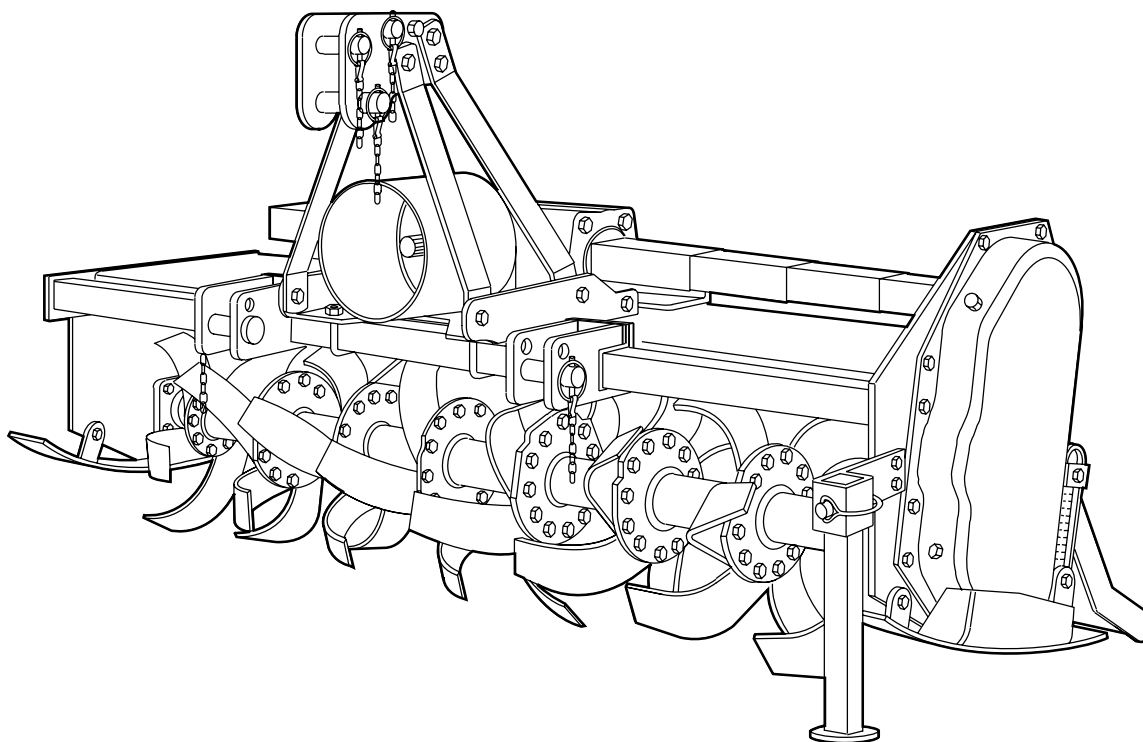

FRONTIER.

Cod. F07010183 / Rev. 00 (2005-01)

TABLE OF CONTENTS

Technical specification		During tilling	18
Technical specification.....	4	Replacement parts	18
Technical specification - Hitch	5		
Safety signs		Service Machine Safely	
Safety-Alert symbol	6	Practice safe maintenance	19
Machine safety labels.....	7	Wear appropriate clothing	19
		Stay clear of rotating drivelines	19
Machine safety labels and positions		Service lubrication	
Machine safety labels and positions.....	8	Service lubrication.....	20
		Every 8 work hours.....	20
Preparing the vehicle		Every 50 work hours.....	20
Preparing the tractor	9	Every 400 work hours.....	20
Park vehicle safety.....	9	Greasing and lubricant points.....	20
Stay clear of rotating drivelines	9	Lubricants.....	20
		Service	
Installing		Chain stretcher	21
Installing tiller on tractor.....	9	Service intervals.....	21
PTO shaft	11	Bolts tightening torques.....	21
PTO shaft with shear pin	12	Replacing tines.....	21
Quick Coupler (optional).....	12	Tines.....	22
Park vehicle safely	12		
Stay clear of rotating drivelines	12	Troubleshooting	
		Using troubleshooting chart	23
Removing		Storing machine	
Removing tiller.....	13	Storing tiller	23
Removing tiller with Quick Coupler.....	13	Removing tiller from storage	23
Operating		Assembly / Spare parts	
Operate safely	14	RT 1060 E	24
Wear appropriate clothing	15	RT 1070 E	26
Stay clear of rotating driveline	15	Installing driveline on tiller	28
Raising parking stand.....	15	Spare parts.....	28
Lowering parking stand	15		
Leveling attachments (side-to-side).....	15		
Leveling tiller (front-to-rear)	16		
Adjusting skid shoes	16		
Adjusting levelling board.....	16		
Adjustable offset.....	17		
Tilling tips	18		

TO THE DEALER:

Assembly and proper installation of this product is the responsibility of the Frontier dealer. Read manual instruction and safety rules. Make sure all items on the Dealer's Pre-Delivery Check List in the Operator's Manual are completed before releasing equipment to the owner.

The dealer must complete the Warranty Registration, located on the Frontier website. **Warranty claims will be denied if the Warranty Registration has not been completed.**

TO THE OWNER:

Read this manual before operating your frontier equipment. The information presented will prepare you to do a better and a safer job. Keep this manual handy for ready reference. Require all operators to read this manual carefully and become acquainted with all the adjustment and operating procedures before attempting to operate. Replacement manuals can be obtained from your selling dealer.

The equipment you have purchased has been carefully engineered and manufactured to provide dependable and satisfactory use. Like all mechanical products, it will require cleaning and upkeep. Lubricate the unit as specified. Observe all safety information in this manual and safety decals on the equipment.

For service, your authorized Frontier dealer has trained mechanics, genuine Frontier service parts, and the necessary tools and equipment to handle all your needs.

Use only genuine Frontier service parts. Substitute parts will void the warranty and may not meet standards required for safe and satisfactory operation. Record the model number and serial number of your equipment in the spaces provided:

Model: _____

Date of Purchase

Serial Number: (see Safety Decal section for location)

Provide this information to your dealer to obtain correct repair parts.

Throughout this manual, the term **IMPORTANT** is used to indicate that failure to observe can cause damage to equipment. The terms **CAUTION**, **WARNING** and **DANGER** are used in conjunction with the Safety-Alert Symbol, (a triangle with an exclamation mark), to indicate the degree of hazard for items of personal safety.



This Safety-Alert Symbol indicates a hazard and means **ATTENTION! BECOME ALERT! YOUR SAFETY IS INVOLVED!**



Indicates an imminently hazardous situation that, if not avoided, will result in death or serious injury.



Indicates a potentially hazardous situation that, if not avoided, could result in death or serious injury, and includes hazards that are exposed when guards are removed.



Indicates a potentially hazardous situation that, if not avoided, may result in minor or moderate injury.

IMPORTANT

Indicates that a failure to observe can cause damage to equipment.

NOTE

Indicates helpful information.

<https://www.ebooklibonline.com>

Hello dear friend!

Thank you very much for reading.

Enter the link into your browser.

The full manual is available for immediate download.

<https://www.ebooklibonline.com>

TECHNICAL SPECIFICATIONS

RT 1060 E (Adjustable offset)



Model	Work/width inches	Tractor HP min	Tractor HP max	Weight lbs.	Side Drive	PTO shaft	Speeds gear box	Input speed	Hitch	Max offset	Tines STD	Rotor blades	Rotor flanges
RT 1060 E	57	15-30	40	480	Chain ASA 80	Shear Pin	Single	540	Cat. "I"-"II" Quick coupler	16.5"	"C"	4	7

RT 1070 E



Model	Work/width inches	Tractor HP min	Tractor HP max	Weight lbs.	Side Drive	PTO shaft	Speeds gear box	Input speed	Hitch	Tines STD	Rotor blades	Rotor flanges
RT 1070 E	73	30-60	60	660	Chain ASA 100	Shear Pin	Single	540	Cat. "I"-"II" Quick coupler	"L"	4	9

TECHNICAL SPECIFICATIONS - HITCH

RT 1060 E: Cat. «I» and «II» Standard

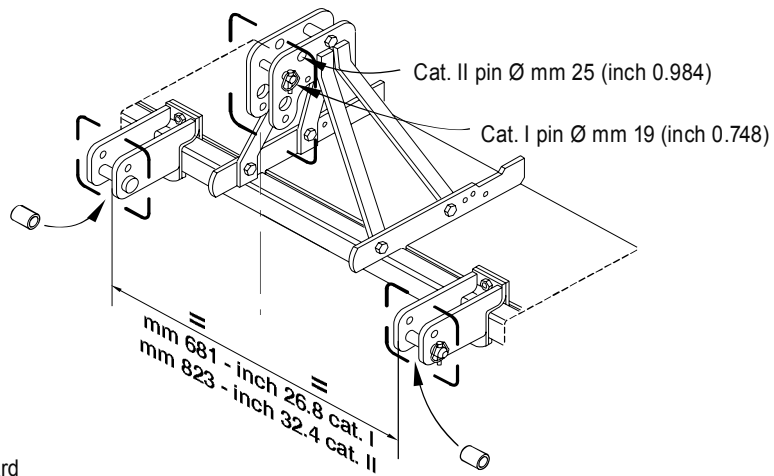

Without bushings: Cat. «I» Standard
 With bushings: Cat. «II» Standard

RT 1060 E: Cat. «I» and «II» Quick Coupler

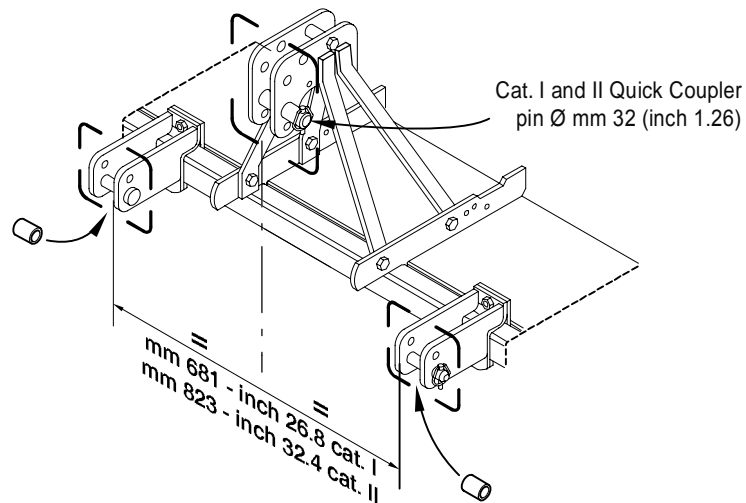

With bushings

RT 1070 E: Cat. «II» Standard and Quick Coupler

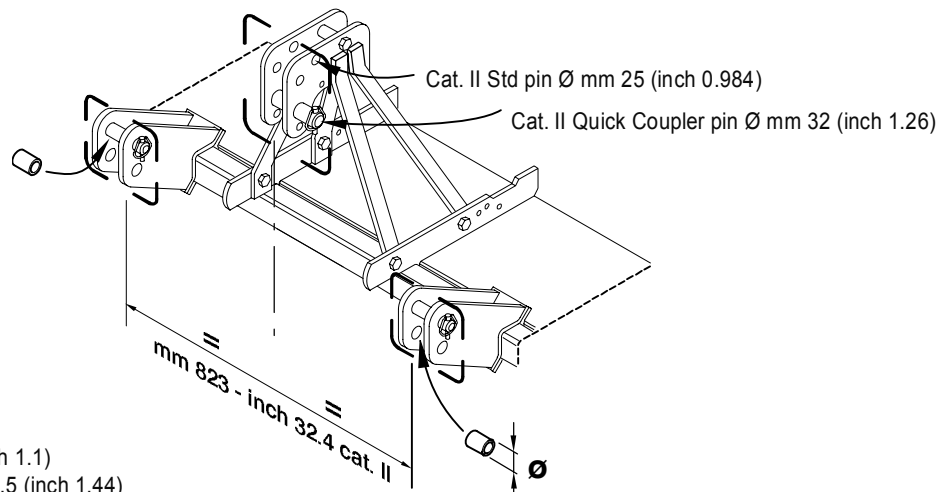

Cat. «II» Standard bushings Ø = 28 (inch 1.1)
 Cat. «II» Quick coupler bushings Ø = 36,5 (inch 1.44)

SAFETY SIGNS

Safety-alert symbol

Read and recognize safety information.

Be alert to the potential for personal injury when you see this safety-alert symbol.



On your machine safety labels, the words DANGER, WARNING, and CAUTION are used with safety-alert symbol.

DANGER identifies the most serious hazards. In this manual, the word CAUTION and this symbol call attention to safety messages.

Identification machine

Identification plate machine

Machine safety labels

1) WARNING: AVOID INJURY FROM ROTATING KNIVES:

- Keep hands, feet and clothing away.

2) WARNING: AVOID INJURY FROM PTO:

- Keep all shields in place. Keep hands, feet and clothing away.
- Operate only with 540 RPM.

3) CAUTION: AVOID INJURY

- Read Operator's Manual
- Ballast power unit per operator's manual
- Know location and function of controls
- Keep all shields in place
- Stay clear of power driven parts
- Never carry riders
- Keep people and pets a safe distance away from machine

BEFORE DISMOUNTING OR SERVICING

- Shut off engine and remove key
- Lock brake for park
- Lower or block up machine

4) DANGER: ROTATING DRIVELINE - CONTACT CAN CAUSE DEATH - KEEP AWAY! - DO NOT OPERATE WITHOUT:

- All driveline, tractor and equipment shields in place
- Drivelines securely attached at both ends
- Drivelines shields that turn freely on driveline.

5) DANGER: SHIELD MISSING DO NOT OPERATE

Picture Note: Separate telescoping driveshaft members to locate safety label. Label attached to outer profile tube.

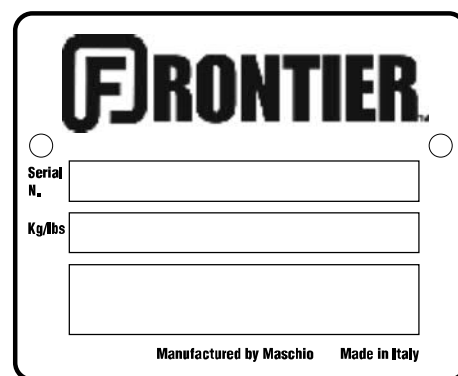

MACHINE SAFETY LABELS AND POSITIONS

RT 1060 E

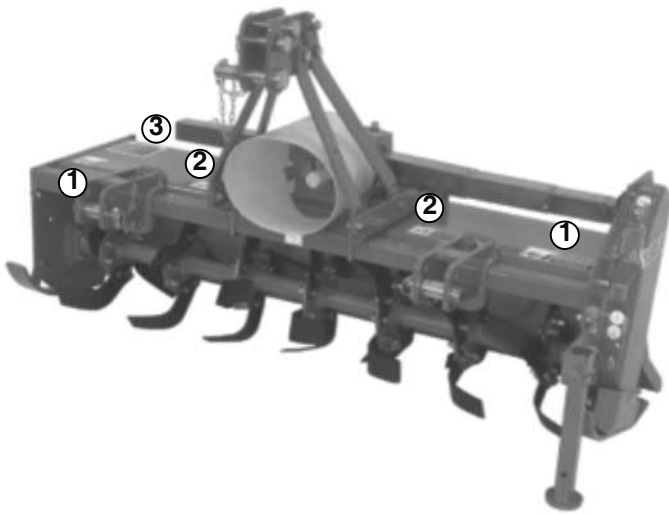

1



2

RT 1070 E

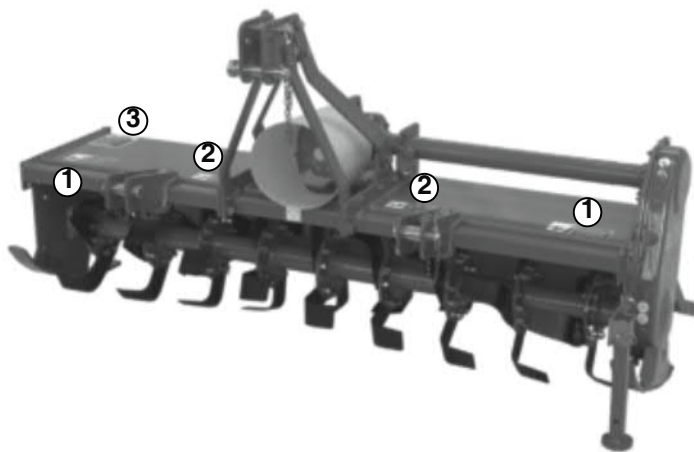

3

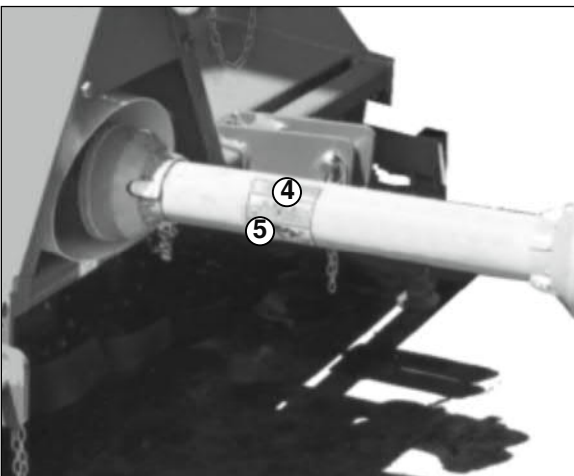

4



5

MACHINE SAFETY LABELS AND POSITIONS

RT 1060 E

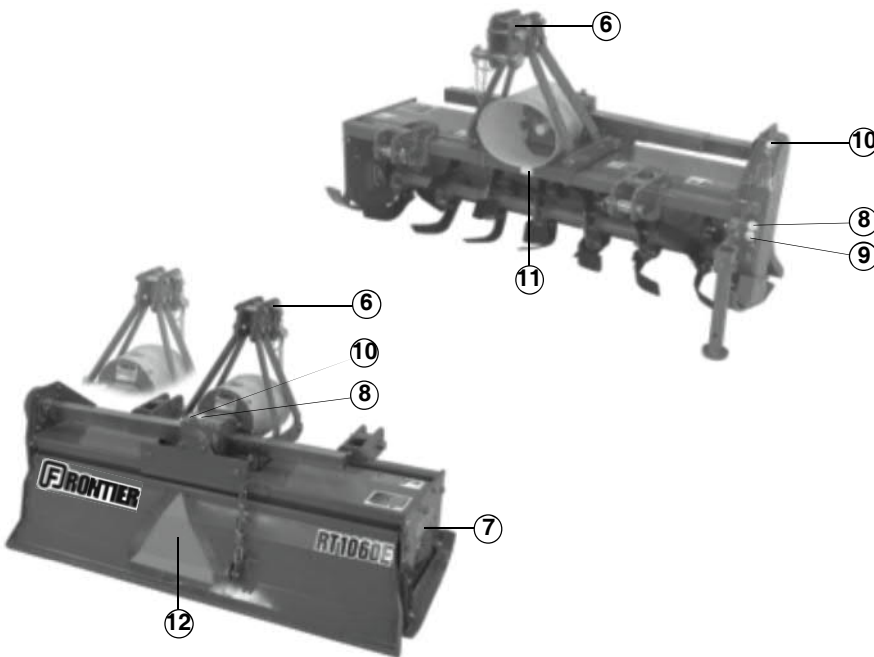

6



7

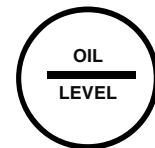

8



9



10



11

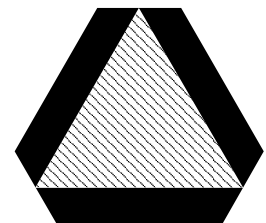

12

RT 1070 E

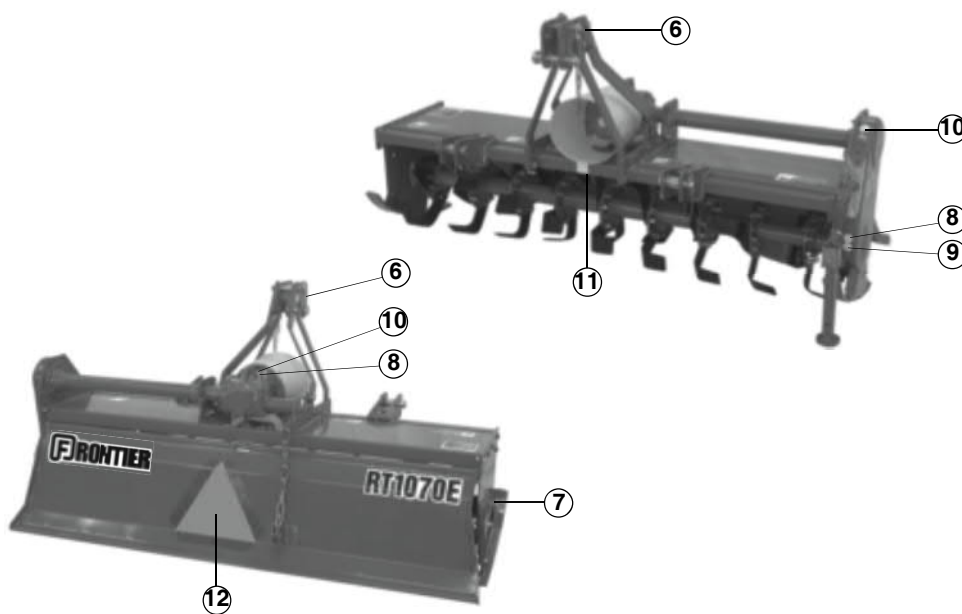

- 6) Coupling point for lifting (indicating the maximum capacity)
- 7) Greasing point
- 8) Oil level plug
- 9) Oil drain plug
- 10) Oil fill plug
- 11) Number of revolutions of power takeoff
- 12) Warning, slow machine

PREPARING THE VEHICLE

Preparing the tractor



CAUTION: Avoid injury. Proper ballasting is required for safe operation of your tiller

IMPORTANT: Refer to the tractor operator manual for proper ballasting information and tire inflation

- A 540 rpm PTO
- Refer to the tractor operator manual for correct ballasting and tire pressure, depending on installed equipment.

Park vehicle safety

- Stop vehicle on a level surface, not on a slope.
- Disengage PTO.
- Engage the park brake.
- STOP the engine.
- Remove the key.
- Before you leave the operator's seat, wait for engine and all moving parts to STOP.

Stay clear of rotating drivelines

Entanglement in rotating driveline can cause serious injury or death:

- Wear close fitting clothing.
- STOP the engine and be sure PTO driveline is stopped before getting near it.

Installing tiller on tractor

1. Back tractor into position and align draft links (A) with draft link brackets on tiller using tractor rockshaft control.

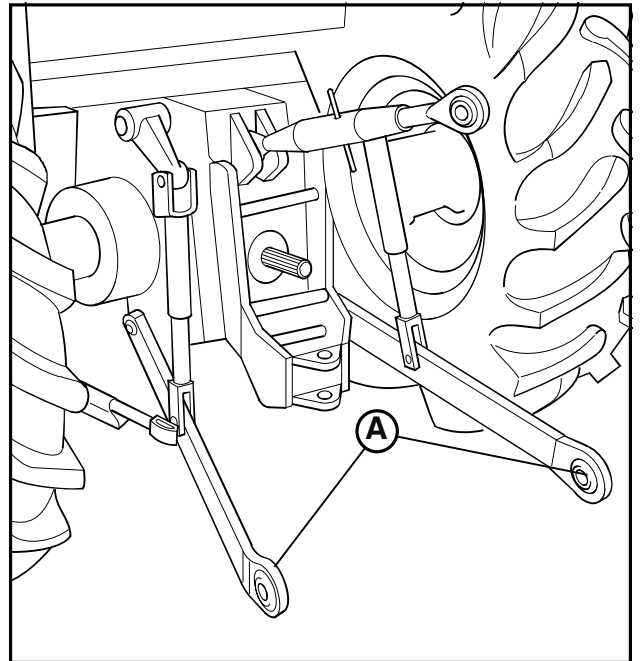

CAUTION: Before you work around hitch:

- STOP engine.
- LOCK park brake.
- FIRMLY block tiller on horizontal surface.



Suggest:

If the above button click is invalid.

Please download this document

first, and then click the above link

to download the complete manual.

Thank you so much for reading

INSTALLING

Locate driller pin in lower lift brackets holes (B).

RT 1060 E model.

2. Fasten each draft link to draft link brackets with drilled pins and quiklock pins (C).

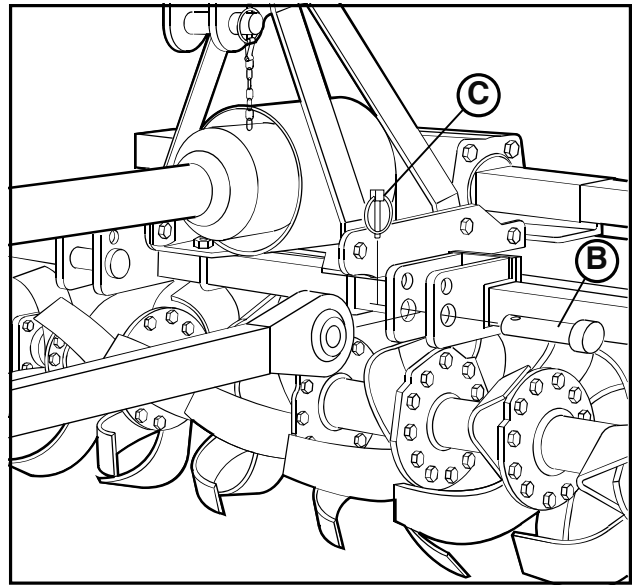

Locate driller pin in holes (B).

RT 1070 E model.

2. Fasten each draft link to draft link brackets with drilled pins and quiklock pins (C).

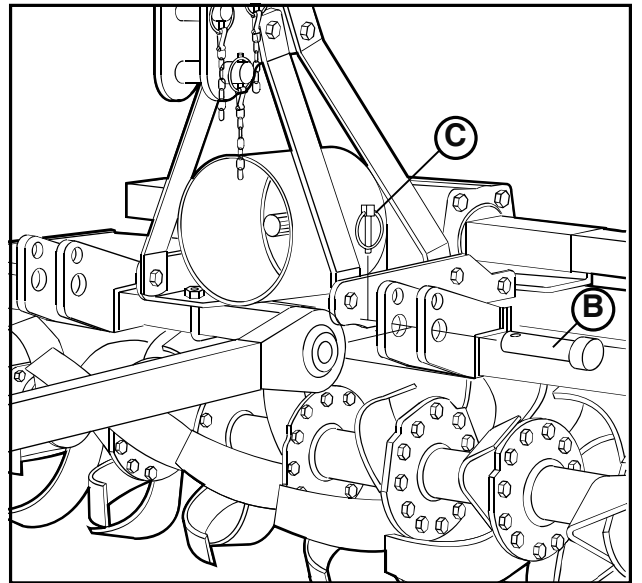

Locate driller pin in top holes (D)

RT 1060 E and RT 1070 E model.

3. Install center link (F) on tiller and fasten with drilled pin and quiklock pin (E).

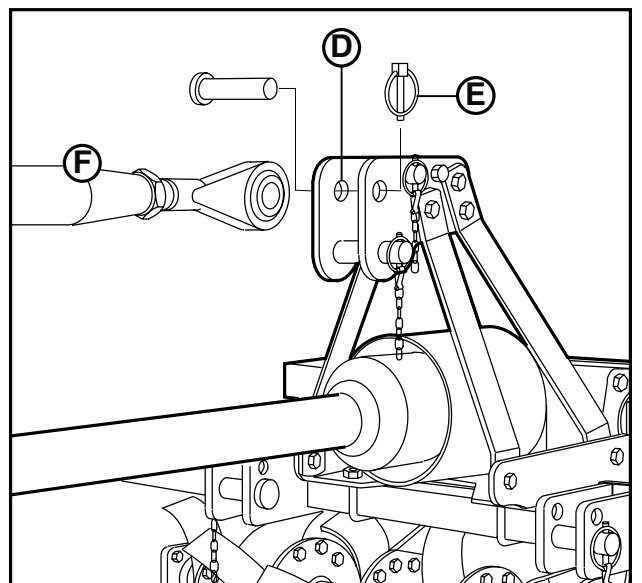

<https://www.ebooklibonline.com>

Hello dear friend!

Thank you very much for reading.

Enter the link into your browser.

The full manual is available for immediate download.

<https://www.ebooklibonline.com>