

6601 Combine



JOHN DEERE

OPERATORS MANUAL

6601
Combine

OMH111326 Issue B2 English

Harvester Works
OMH111326 Issue B2

LITHO IN U.S.A.
ENGLISH

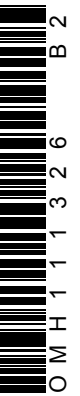

INTRODUCTION



This safety alert symbol identifies important safety messages in this manual. When you see this symbol, be alert to the possibility of personal injury and carefully read the message that follows.

Your Operator's manual contains SI Metric equivalents which follow immediately after the U.S. customary units of measure.

"Right-hand" and "left-hand" sides are determined by facing in the direction the combine will travel when in use.

Record your combine serial numbers in the space provided on page 115.

The warranty on this combine appears on your copy of the purchase order which you should have received from your dealer when making your purchase. This warranty provides you the assurance that John Deere will back its products where defects appear within the warranty period. In some circumstances, John Deere also provides field improvements, often without charge to the customer, even if the product is out of warranty.

Warranty and field improvements are a part of John Deere's product support program for customers who operate and maintain their equipment as described in this manual. Should the equipment be abused, or modified to change its performance beyond the original factory specifications, the warranty will become void and field improvements may be denied.

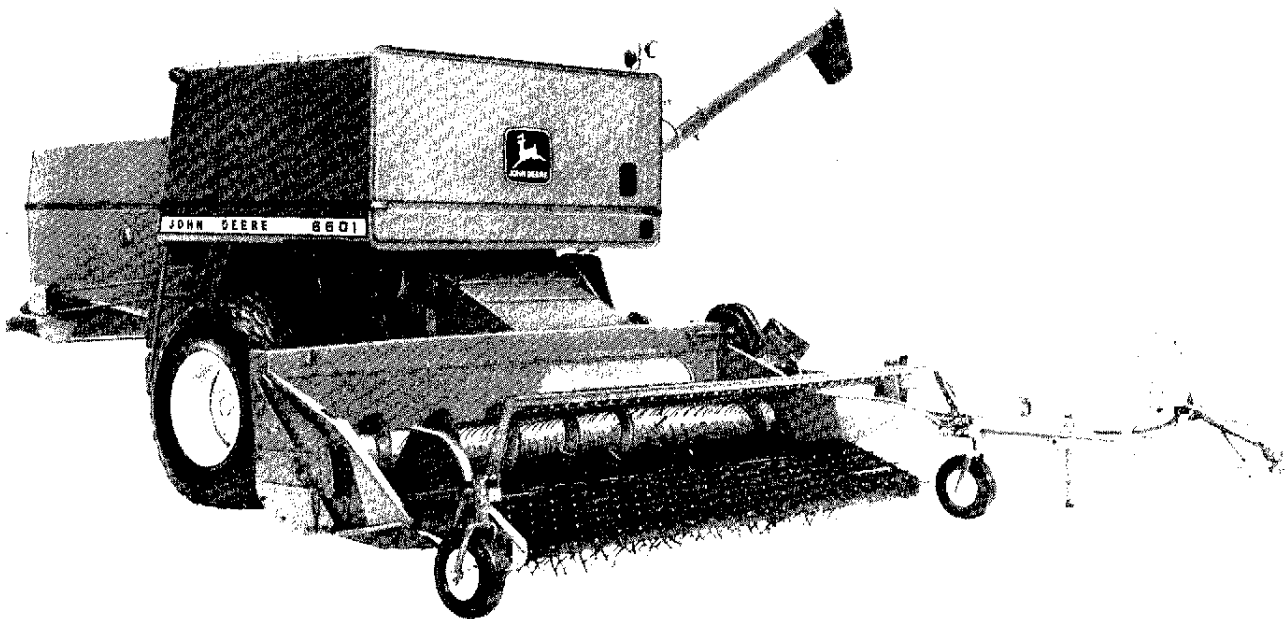



Contents

	Page
Introduction	
Contents	1
Safety	2-5
Combine Function Controls	6
Initial Tractor Preparation	7-14
Preparing the Combine	15
Attaching and Detaching the Combine	16-18
Transporting	19-21
Lighting and Signals	22
Operating the Combine	23-28
Lubricants	29,30
Lubrication and Maintenance	31-36
Fundamentals of Combine Harvesting	37-41
Platform and Feeder House	42-54
Separator	55-93
Grain Tank and Unloading Auger	94-99
Electrical System	100,101
Monitors	102-104
Hydraulic System	105
Power Train	106,107
Trouble Shooting	108-113
Storage	114
Specifications	115,116
Index	117-119

<https://www.ebooklibonline.com>

Hello dear friend!

Thank you very much for reading.

Enter the link into your browser.

The full manual is available for immediate download.

<https://www.ebooklibonline.com>



Safety



Safety of the operator was one of the prime considerations in the minds of John Deere engineers when this combine was designed. Shielding, simple adjustments, and other safety features were built into the combine wherever possible. Unauthorized modifications to the machine may also impair the functions and or safety and affect machine life.

AVOID CONTACT WITH MOVING PARTS

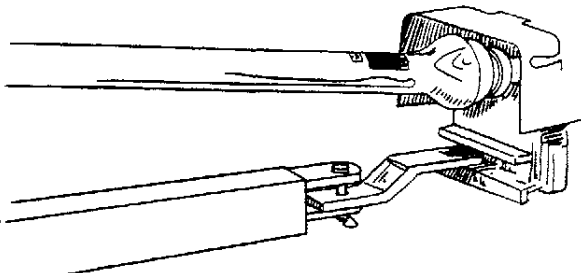

A19405

A19405

Keep guards and shields in place at all times while operating the combine. Always disengage tractor PTO and shut off engine before removing guards or shields.

Keep hands, feet, and clothing away from power-driven parts.

Never clean, lubricate, or adjust the combine when it is running.

Everyone must be clear before starting tractor engine or running combine.

Never attempt to clear obstructions off the header unless the PTO is disengaged and the tractor engine is shut off.

OPERATE SAFELY

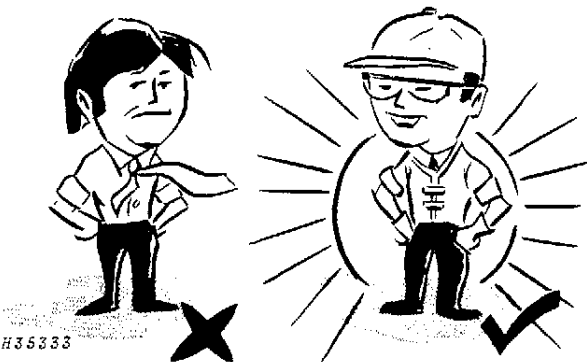

H35333

Clothing worn by operator must be fairly tight and belted. Loose jackets, shirts, or sleeves must never be worn.

The gearshift lever of tractor must be in neutral and the PTO lever disengaged before starting tractor engine.

Be careful when operating on hillsides so the combine or tractor will not tip sideways.

Always keep the tractor in gear when going down hills.

AVOID HIGH PRESSURE LEAKS

Escaping hydraulic fluid under pressure can have sufficient force to penetrate the skin, causing serious injury. Before disconnecting lines, relieve all pressure. Before applying pressure to the system, all connections must be tight and lines, pipes, and hoses must be in good condition.

Fluid escaping from a very small hole can be almost invisible. Use a piece of cardboard or wood, rather than hands, to search for suspected leaks.

If injured by escaping fluid, see a doctor at once. Serious infection or reaction can develop if proper medical treatment is not administered immediately.

Cracking hydraulic line fittings to lower the feeder house will result in an instantaneous dropping of feeder house or feeder house and header.

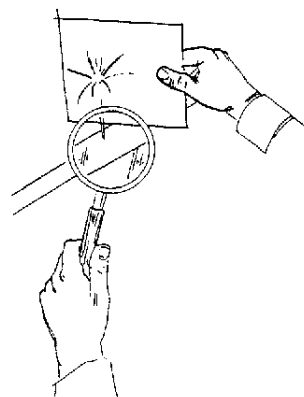

H35336

LEVELING COMBINE UNATTENDED

Before leaving combine unattended, support header with either hydraulic cylinder safety stop or with blocks, or lower it to ground.

Lower hitch and separator support stands and block wheels.

If combine is attached to tractor, place tractor transmission in park, stop engine and remove tractor key.

If platform is to be removed from separator, use support stand on separator.



CAUTION: Before platform is removed attach support stand to separator and place in "down" position as shown with dotted lines. Adjust stand to contact ground so hitch tube will not fly upward when platform is removed.

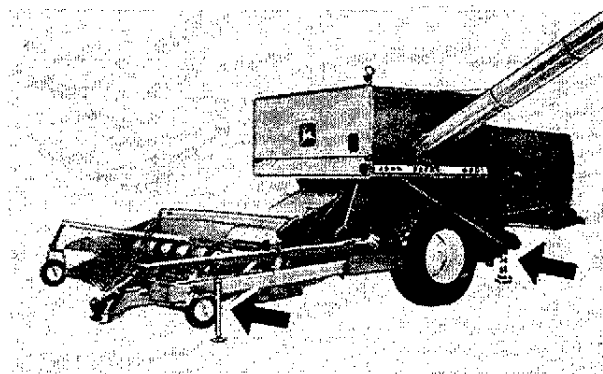

H37031

TRANSPORT SAFELY

Never ride or allow anyone on the tractor, drawbar, or hitch.

Be extra careful when transporting the combine in hilly country.

Use a tractor large enough to maintain control. When transporting the combine on a road or highway, use accessory lights and devices for adequate warning to the operators of other vehicles. In this regard, check local governmental regulations.

Tow only with an agricultural tractor equipment with stationary drawbar.

Support stands must be rotated 90 degrees for transporting.

Do not transport combine over 20 MPH (32.2 km/h).

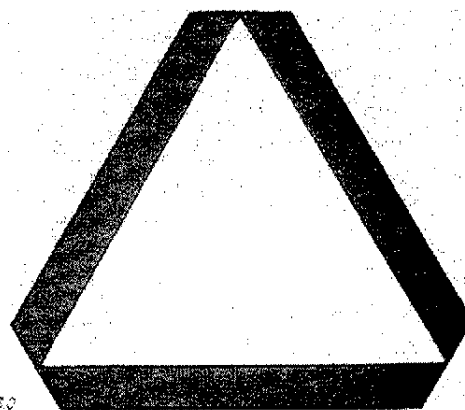

H28930

H28930

4 Safety

RECOMMENDED MAXIMUM TOWING SPEED

To assure adequate braking performance and control during transport, do not exceed recommended maximum towing speed given in table below. When operating on slopes or less than optimum traction conditions, these towing speeds must be reduced. Always refer to this table before transporting combine.

Weight of Tractor	Total Weight of Combine with Empty Grain Tank and Attaching Equipment		
	10,000 lbs. (4536 kg)	16,000 lbs. (7200 kg)	18,000 lbs. (8100 kg)
0-3,300 lbs. (0-1497 kg)	Do not tow	Do not tow	Do not tow
3,300-5,300 lbs. (1497-2404 kg)	10 mph (16.1 km/h)	Do not tow	Do not tow
5,300-6,000 lbs. (2404-2722 kg)	10 mph (16.1 km/h)	10 mph (16.1 km/h)	Do not tow
6,000-10,000 lbs. (2722-4536 kg)	10 mph (16.1 km/h)	10 mph (16.1 km/h)	10 mph (16.1 km/h)
10,000-16,000 lbs. (4536-7258 kg)	20 mph (32.2 km/h)	10 mph (16.1 km/h)	10 mph (16.1 km/h)
16,000-18,000 lbs. (7258-8100 kg)	20 mph (32.2 km/h)	20 mph (32.2 km/h)	10 mph (16.1 km/h)
18,000 lbs. (8100 kg)—Up	20 mph (32.2 km/h)	20 mph (32.2 km/h)	20 mph (32.2 km/h)

SAFETY CHAINS

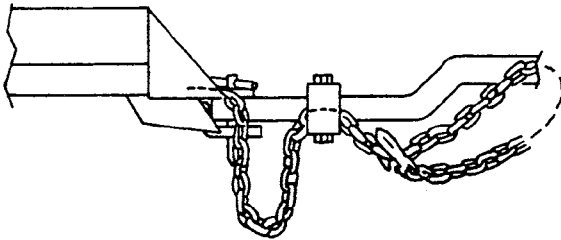

Install safety chain before transporting combine.

H37032

CHANGING TIRES SAFELY

Failure to follow proper procedures when mounting a tire on a wheel or rim can produce an explosion which may result in serious injury or death. Do not attempt to mount a tire unless you have the proper equipment and experience to perform the job. Have it done by your John Deere dealer or a qualified tire repair service. See page 107.

SAFETY DECALS



CAUTION or WARNING: Decals with these headings and symbol indicate the possibility of personal injury.

IMPORTANT: Decals with this heading indicate the possibility of damage to the machine.

Decals are located in areas where they apply.

NOISE

Prolonged exposure to loud noise can cause impairment or loss of hearing.

Wear a suitable hearing protective device such as earmuffs (A) or earplugs (B) to protect against objectionable or uncomfortable loud noises.

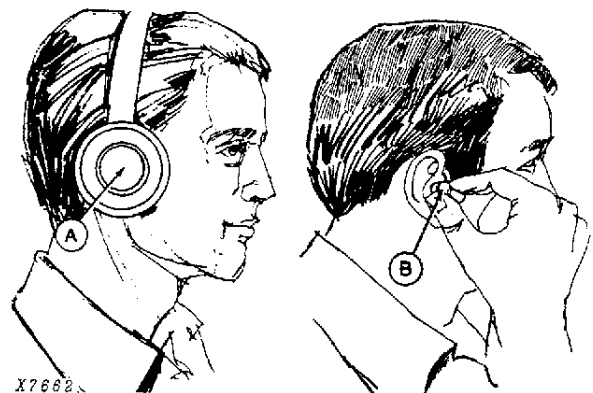

A—Earmuffs
B—Earplugs

X7662

X7662

FIRE EXTINGUISHER

Have a multipurpose dry chemical fire extinguisher filled and handy. Know how to use it.

DO NOT refuel with the tractor engine running.

DO NOT smoke or use a lantern when refueling.

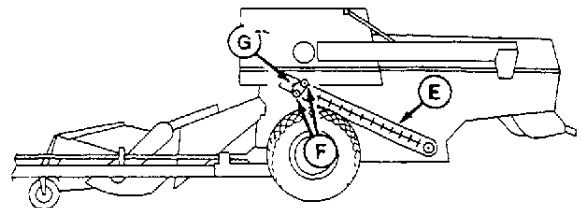

N32054



Combine Function Controls

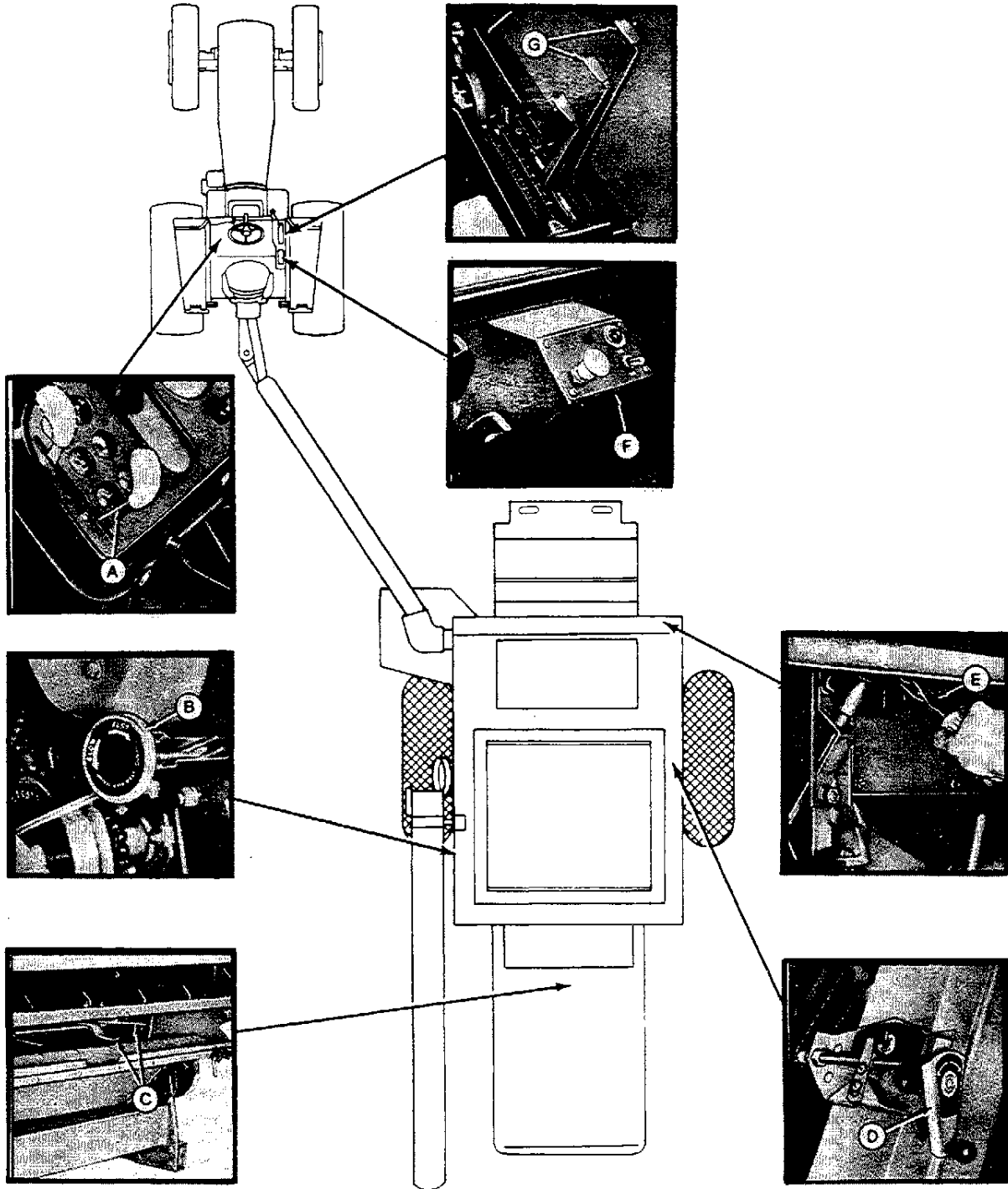

A—PTO Clutch Lever
B—Cleaning Fan Speed Control Wheel
C—Chaffer and Sieve Levers

See page 55
See page 58
See page 87

D—Cylinder Speed Control Crank
E—Concave Spacing Control Ratchet
F—Control Box
G—Header Height Control

See page 58
See page 56
See page 24
See page 23



Initial Tractor Preparation

ATTACHING SWITCH BOX TO TRACTORS WITH PRESOUND-GARD® CABS (1968-1971)

1. Push top edge of housing under trim and then use housing as a template. Locate two screw holes in tabs. Mark and center punch holes. Remove housing.
2. Drill two 1/8-inch (3 mm) holes.

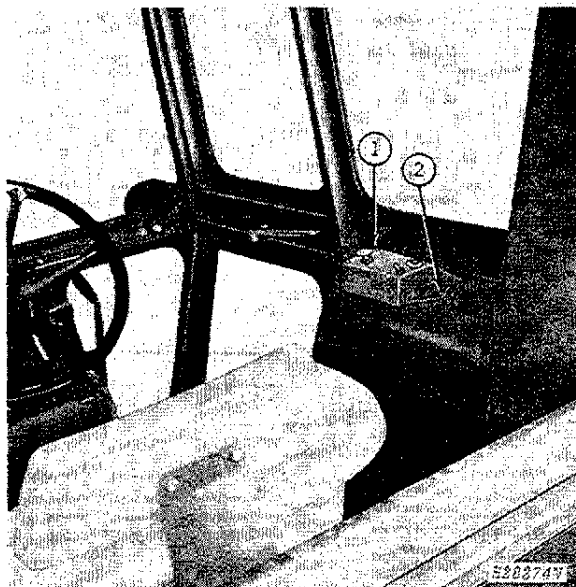

3. Reinstall housing and secure with two self-tapping screws.
4. (Not Illustrated) Run wires from switch box toward rear of cab.

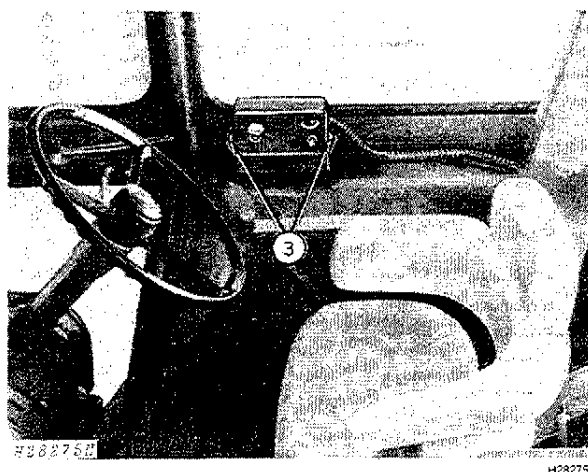

8 Initial Tractor Preparation

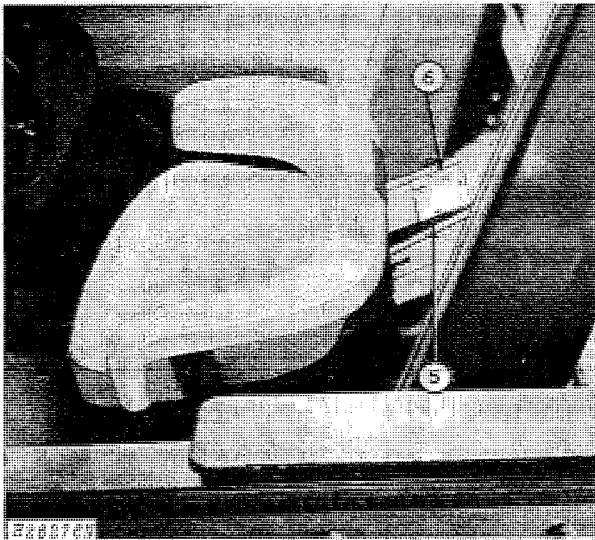

H28276N

5. Cut and drill holes, to dimensions shown, in right-hand rear deck of tractor cab next to roll bar.
6. Attach harness plate provided to cover hole in rear deck, using three $1/4 \times 7/8$ -inch truss head machine screws. Install grommet in harness plate.
7. (Not Illustrated) Run wires from switch box through hole in harness plate.

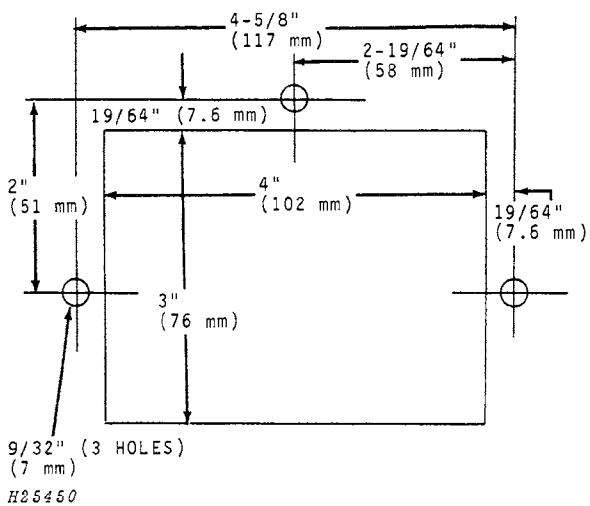

H25450

INSTALLING STRAW WALKER WARNING HORN ON TRACTORS WITH PRE SOUND-GARD CABS (1968-1971)

1. Secure horn to mounting bracket with special nut.
2. Secure relay to mounting bracket with two 1/4 x 1/2-inch cap screws, lock washers, and nuts.
3. Secure bracket to outside of harness plate with two 5/16 x 5/8-inch truss head machine screws, lock washers, and nuts.
4. Secure plate to existing wiring connector, using existing hardware.
5. Slide connectors onto relay and horn.
6. Secure seven-pin connector to the bracket with four No. 6 x 1/2-inch pan head machine screws, lock washers, and nuts.

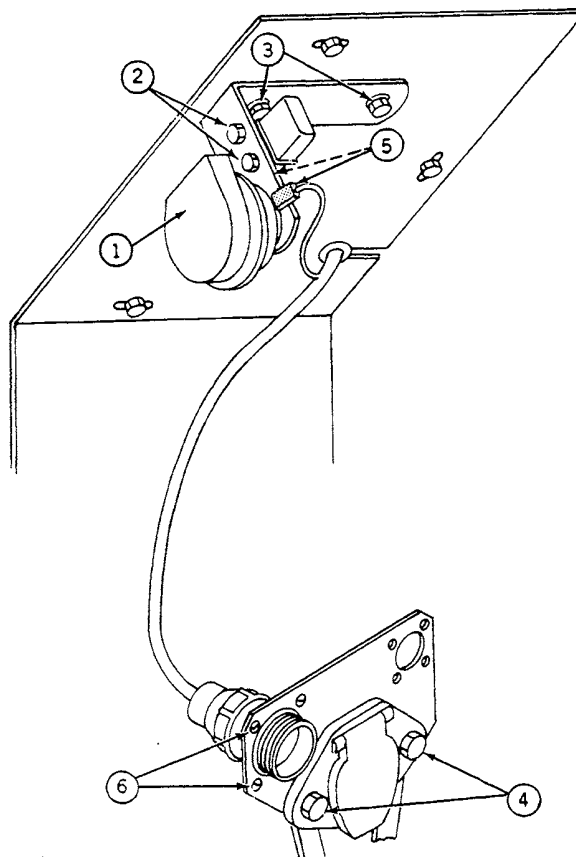

H29486

H29486

INSTALLING LOW SHAFT SPEED MONITOR SYSTEM BOX TO TRACTORS WITH PRE SOUND-GARD CABS (1968-1971)

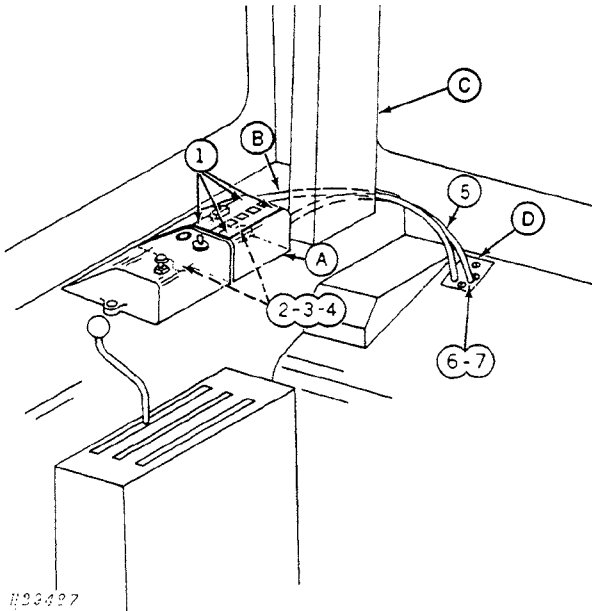

H29487
A—Monitor Housing
B—Harness
C—Roll Bar
D—Harness Plate

1. Remove four No. 6 self-tapping screws from monitor housing face plate and turn face plate so lettering can be read from tractor seat. Reinstall four screws.
2. Push top edge of monitor housing (A) under trim. Use housing as template, locate two screw holes in tabs; mark and center punch holes, as shown.
3. Remove housing (A) and drill two 1/8-inch (3 mm) holes.
4. Secure housing (A) with two No. 8 x 1/2-inch self-tapping screws.
5. Run wiring harness (B) in back of roll bar (C) toward rear of cab.
6. Remove button plug in harness plate (D) and replace with grommet.
7. Run wiring harness through grommet in harness plate (D).

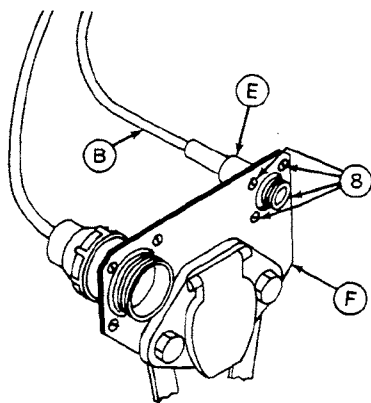

H29110
B—Harness
E—Harness Connector
F—Connector Bracket

8. Secure wiring harness connector (E) to tractor connector bracket (F) with four No. 4 UNC x 3/4-inch pan head machine screws, lock washers, and nuts.
9. (Not Illustrated) Connect combine wiring harness to tractor connector.

ATTACHING SWITCH BOX TO 4230, 4240, 4430, 4440, 4630 AND 4640 TRACTORS WITH SOUND GARD CABS

1. Measure in 4-1/2 inches (115.3 mm) from console and draw a line on foam as shown.
2. Place switch box housing edge along line with top edge under cab trim.
3. Draw line on bottom of switch box housing.
4. Draw a straight line on remaining side of switch box housing. Do not cut out for screw tabs. They must be hidden under foam. Remove housing.
5. Cut foam around edge of switch box housing.
6. (Not Illustrated) Remove cut-out of foam.
7. Insert housing into area that was cut out in Step 6 by sliding screw tabs under foam on sides and top edge under trim.
8. Using housing as template to locate screw holes in tabs by pulling back foam on sides. Mark and center punch holes.
9. (Not Illustrated) Drill two 1/8-inch (3 mm) holes.
10. Thread wire conduit under foam to rear of cab.
11. Reinstall housing and secure with self-tapping screws.
12. Pull cab foam away to expose the six 5/16 x 3/4-inch cap screws.
13. Remove cover. Route cable and wires through opening.

NOTE: Save cover removed in Step 13 for reuse when tractor is not used with combine.

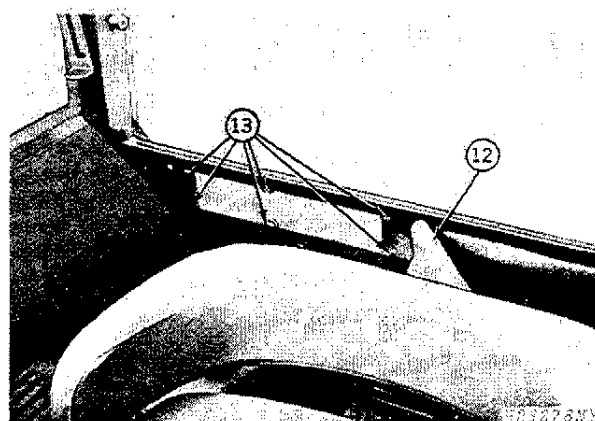
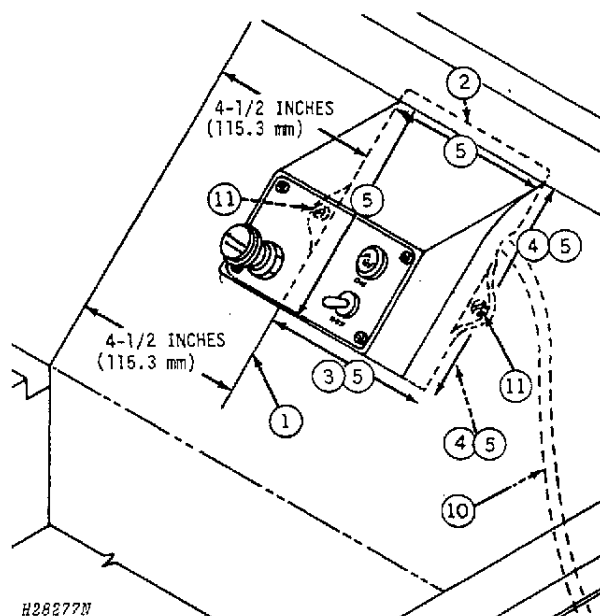

12 Operation

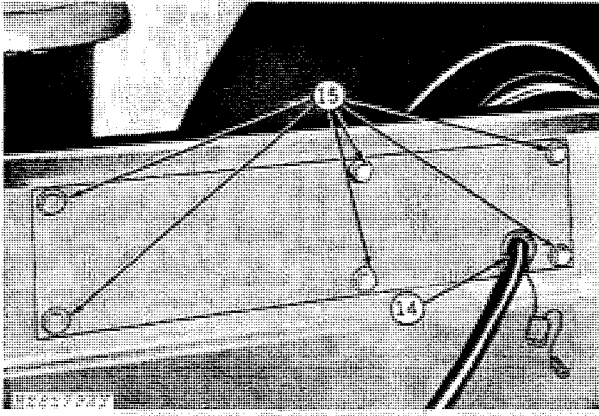

H28279NY

14. Slip grommet around cable and push into large hole in harness plate provided.

15. Attach harness plate, with new gasket, to rear of cab with hardware removed in Step 13. Replace cab foam.

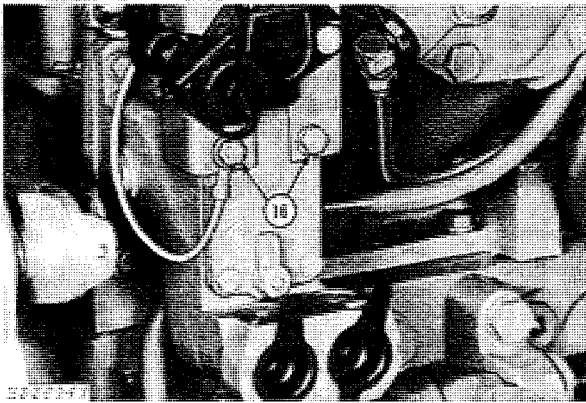

H33614Y

16. Attach bracket with socket to remote cylinder valve, using existing hardware.

INSTALLING STRAW WALKER WARNING HORN TO TRACTORS WITH SOUND-GARD CABS

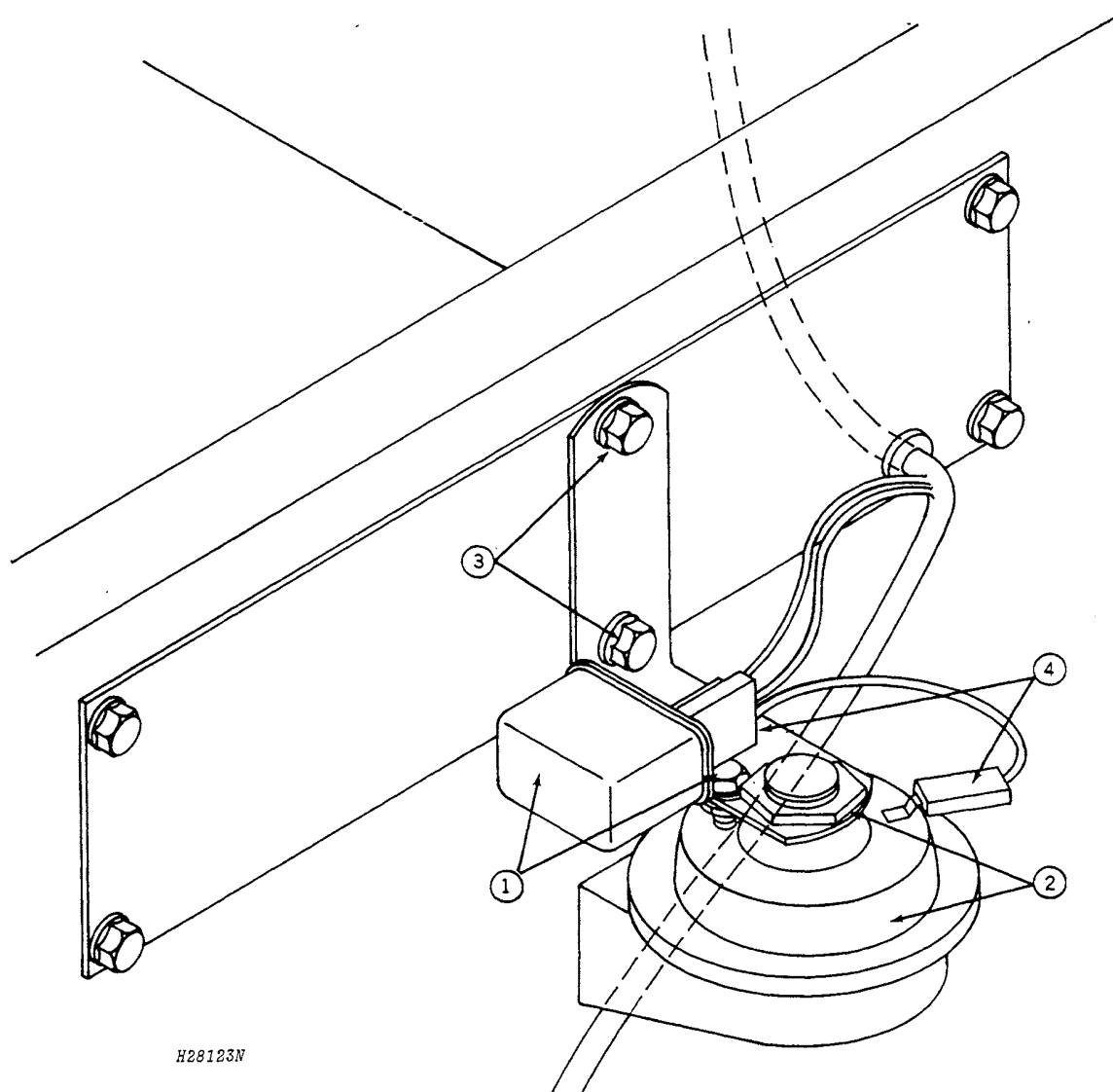

H28123N

H28123N

1. Secure relay to mounting bracket with 1/4 x 1/2-inch cap screw, lock washer, and nut.
2. Secure horn to bracket with special nut as shown.
3. Use existing hardware and secure bracket to mounting plate.
4. Attach multiple connector to relay and single connector to horn as shown.

INSTALLING LOW SHAFT SPEED MONITOR SYSTEM BOX TO TRACTORS WITH SOUND-GARD CABS

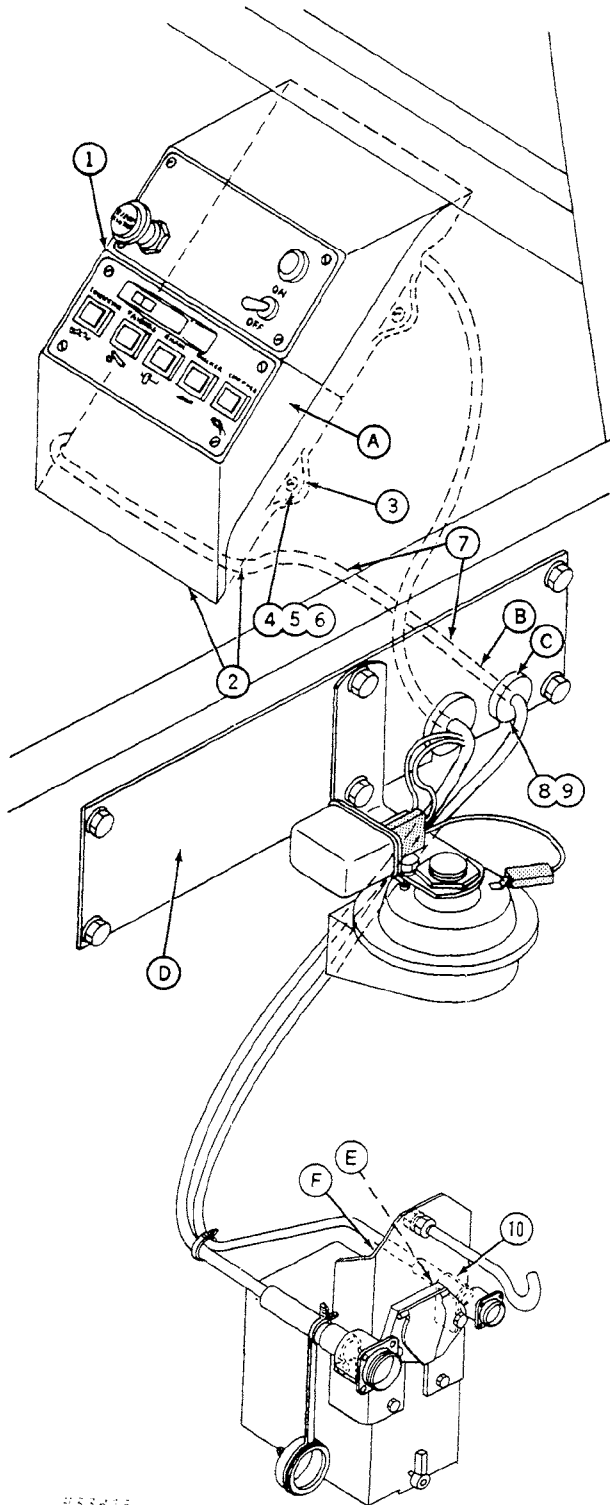

1. Place monitor housing (A) edge along line with bottom edge of switch box housing, as shown.
2. Mark around outside of monitor housing (A).
3. Cut out foam to fit housing. Do not cut out for screw tabs. Tabs must be hidden under foam.
4. Insert housing and use as template to locate screw holes. Mark and center punch holes.
5. (Not Illustrated) Remove housing (A) and drill two 1/8-inch (3 mm) holes.
6. Secure housing (A) with two No. 8 x 1/2-inch self-tapping screws.
7. Route wire harness (B) under foam to rear of cab.
8. Remove button plug in harness plate and replace with grommet (C).
9. Run wiring harness (B) through grommet (C) in harness plate (D).
10. Secure wiring harness connector (E) to tractor connector bracket with clamp and 5/16 x 1/2 self tapping screw.
11. (Not Illustrated) Connect combine wiring harness to tractor connector.

- A—Monitor Housing
- B—Harness
- C—Grommet
- D—Harness Plate
- E—Harness Connector
- F—Connector Bracket



Preparing the Combine

Before starting to combine for the first time each day:

1. Perform all daily lubrication and maintenance. See page 31.

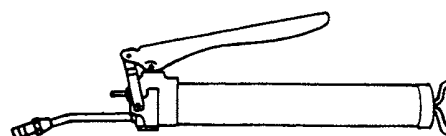

H31858

H31858

2. Clean out stone traps.

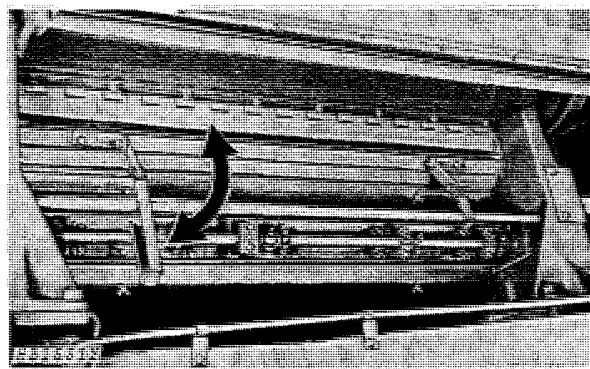

H31531Y

3. Clean tractor cab glass.



H31860

H31860



Suggest:

If the above button click is invalid.

Please download this document

first, and then click the above link

to download the complete manual.

Thank you so much for reading



Attaching and Detaching the Combine

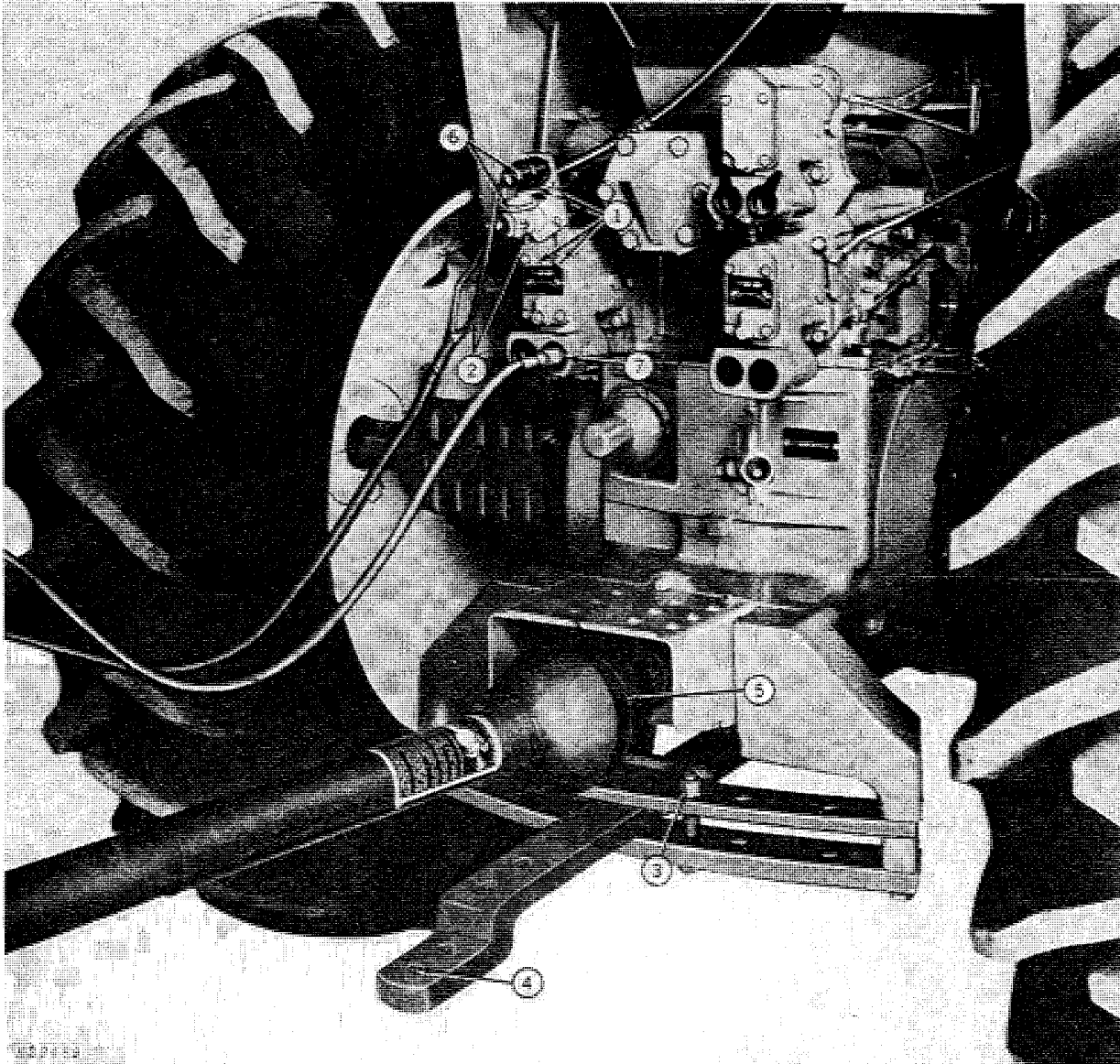

H29489

1. Attach seven-pole socket to the bracket and bracket to tractor.
2. Tractor must be equipped with three wire and auxiliary four wire kits. Wiring kits are provided with combine in Bundle Number BH-77047.
3. Lock tractor drawbar so it is straight with tractor PTO shaft.
4. Attach combine to drawbar.

<https://www.ebooklibonline.com>

Hello dear friend!

Thank you very much for reading.

Enter the link into your browser.

The full manual is available for immediate download.

<https://www.ebooklibonline.com>