

2653A Diesel Professional Utility Mower

(Serial No. 050001 –)

OPERATOR'S MANUAL

**John Deere
Lawn & Grounds Care Division
OMMT2876 L5**

**North American Version
Litho in U.S.A
English**

TABLE OF CONTENTS

	Page
Safety	
Safety-Alert Symbol	1
Machine Safety Labels	1
Controls	
Dash/Platform Controls.....	3
Foot Controls	3
Miscellaneous Controls.....	4
Operating the Machine	
SAFETY:	
Operate Safely.....	5
Mount and Dismount Safely.....	5
Avoid Tipping	6
Operator Training Required	8
Keep Riders Off	8
Wear Appropriate Clothing	9
Transport Safely	9
Avoid High Pressure Fluids	10
ADJUSTMENTS:	
Adjusting Seat.....	10
DRIVING:	
Fuel Shut-Off Valve	11
Park Brake	11
Hydrostatic Ground Drive	12
Mow/Lift Lever	12
PTO Switch.....	13
Throttle Lever.....	13
Ignition Interlock System.....	14
Starting the Engine	15
Checking Indicator Lights	17
Warming and Idling Engine.....	17
Glow Plug	18
Stopping Engine	18
Using Hydrostatic Transmission	19

<https://www.ebooklibonline.com>

Hello dear friend!

Thank you very much for reading.

Enter the link into your browser.

The full manual is available for immediate download.

<https://www.ebooklibonline.com>

TABLE OF CONTENTS

	Page
Emergency Stopping.....	20
Using Free Wheeling.....	20
Daily Operating Checklist.....	21
Testing Safety Systems	21
Checking Ignition Interlock Switches.....	22
TEST 1	22
TEST 2	23
TEST 3	23
Using the Weight Transfer Control.....	24
Avoid Damage to Plastic and Painted Surfaces.....	24
Operating the Cutting Units	
SAFETY:	
Check Ground Conditions	25
Avoid Injury From Contacting Blades.....	25
ADJUSTMENTS:	
Cutting Taller Grass (Front Rollers are Optional).....	26
Cutting Shorter Grass	27
Grass Deflector	28
Engaging Reel Drive	29
Dismounting to Inspect or Unplug Reels.....	30
Replacement Parts	
Available Parts	31
Service Machine Safely	
Practice Safe Maintenance	32
Wear Appropriate Clothing.....	33
Handling Waste Product and Chemicals.....	33
Avoid High Pressure Fluids.....	34
Avoid Injury from Contacting Blades	34

TABLE OF CONTENTS

	Page
Service Interval Chart	
Daily Service Required	36
Service - Lubrication	
Grease	38
Grease Locations: All Locations Every 50 Hours	39
Service - Engine	
Avoid Fumes	41
Engine Oil	41
Checking Engine Oil Level.....	42
Changing Engine Oil and Filter.....	43
Cleaning Plenum Air Intake Screens	44
Checking Air Restriction Indicator.....	44
Replacing Air Cleaner Element.....	45
Clean Rubber Dust Unloading Valve	47
Service Cooling System Safely.....	48
Engine Coolant	48
Checking Coolant Level.....	49
Draining Cooling System	50
Flushing Cooling System	51
Filling Cooling System	52
Checking Sediment Bowl.....	53
Cleaning Fuel Filter Sediment Bowl.....	53
Bleeding Fuel System.....	54
Service - Transmission	
Transmission and Hydrostatic Oil	55
Checking Hydraulic Oil Level.....	56
Change Hydrostatic Drive Oil	57
Replacing Hydrostatic Oil Filter	58
Adjusting Transmission Neutral	58
Adjusting Neutral Start Switch	60

TABLE OF CONTENTS

	Page
Service - Cutting Units	
Avoid Injury from Contacting Blades	61
Adjusting Cutting Units	61
Adjusting Height-of-Cut	62
Adjusting Reel-to-Bed Knife Clearance	67
Backlapping Cutting Units	69
Readjust Reel-to-Bed Knife Clearance	71
Grinding the Bed Knife	72
Replacing Bed Knife	72
Service - Electrical	
Cleaning or Replacing Battery	74
Checking Battery Electrolyte Level	75
Charge the Battery Safely	76
Charging Battery	77
Using Booster Battery	78
Charging Rates	79
Replacing Fuses	80
Replacing an Indicator Light Bulb	80
Service - Miscellaneous	
Checking Tire Pressure	81
Refueling Machine	82
Fuel	83
Filling Fuel Tank	84
Tighten Wheel Bolts	84
Raising Hood	85
Adjusting Parking Brake	85
Troubleshooting	
Using Troubleshooting Chart	87
Engine	87

TABLE OF CONTENTS

	Page
Electrical	91
Hydraulic Drive System	92
Hydrostatic Drive	93
Cutting Units	94
Steering	95
Storing Utility Mower	
Storing Safety	96
Storing the Vehicle.....	96
Removing Mower from Storage	98
Assembly	
Assemble Professional Utility Mower.....	99
Charge the Battery Safely.....	100
Charging Battery.....	101
Install Front Roller.....	102
Checking Tire Pressure	105
Specifications	
Engine.....	106
Fuel System.....	106
Electrical System	106
Capacities	107
Wheel Motor and Reel Drive.....	107
Travel Speeds.....	107
Cutting Units	108
Steering and Brakes	109
Dimensions	109
Tires.....	109
Recommended Lubricants.....	110
Metric Bolt and Cap Screw Torque Values.....	111
Unified Inch Bolt and Cap Screw Torque Values.....	114

TABLE OF CONTENTS

	Page
Warranty	
Product Warranty	117
Tire Warranty	117
Limited Engine Warranty	117
Limited Battery Warranty.....	121
 John Deere Service Literature	
Order Form.....	123

All information, illustrations and specifications in this manual are based on the latest information at the time of publication. The right is reserved to make changes at any time without notice.

COPYRIGHT© 1995
John Deere Horicon Works
All rights reserved
Previous Editions
COPYRIGHT© 1994

SAFETY SIGNS

Safety-Alert Symbol

Read and recognize safety information. Be alert to the potential for personal injury when you see this safety-alert symbol.

On your machine safety labels, the words DANGER, WARNING, and CAUTION are used with this safety-alert symbol. DANGER identifies the most serious hazards. In this manual, the word CAUTION and this symbol call attention to safety messages.



Machine Safety Labels



SAFETY SIGNS

Machine Safety Labels (Continued)

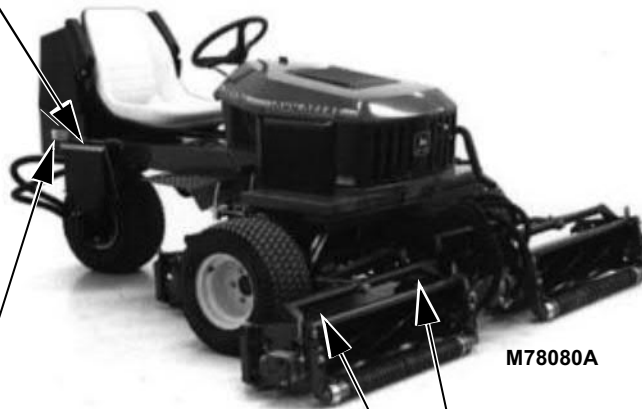

CONTROLS

Dash/Platform Controls

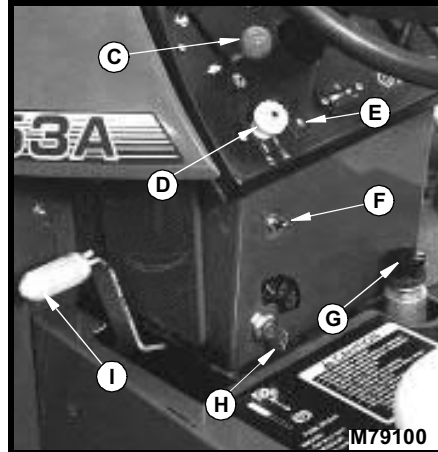
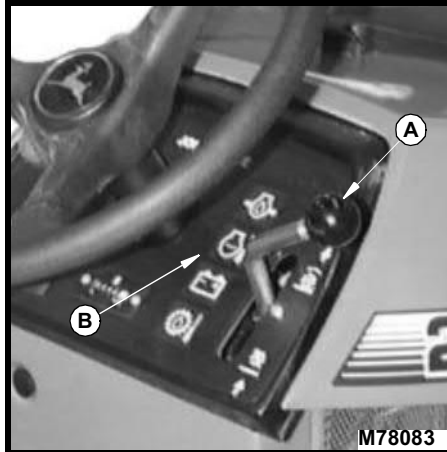

- A - Mow/Lift LeverRaises/lowers mowers
- B - Indicator Lights..... Monitors machine functions
- C - Throttle Lever..... Controls engine speed
- D - PTO Switch..... Engages attachments
- E - Glow Plug SwitchActivates engine preheat
- F - Light Switch (Optional) Toggle switch to engage lights
- G - Weight Transfer Valve Distributes machine weight
- H - Key Starts engine
- I - Park Brake Lever Engages park brake

Foot Controls

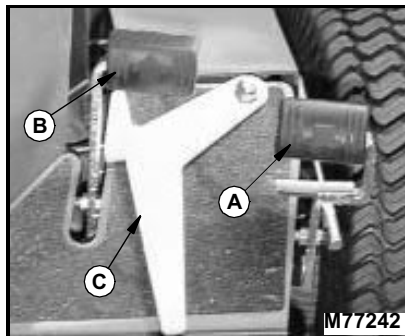

- A - Reverse Travel Pedal..... Backs machine
- B - Forward Travel Pedal.....Starts machine forward travel
- C - Speed Limiter (2WD Only)..... Limits forward speed

CONTROLS

Miscellaneous Controls

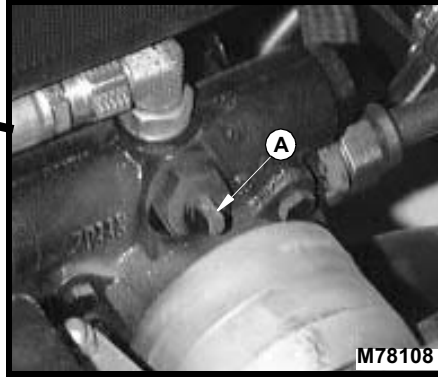
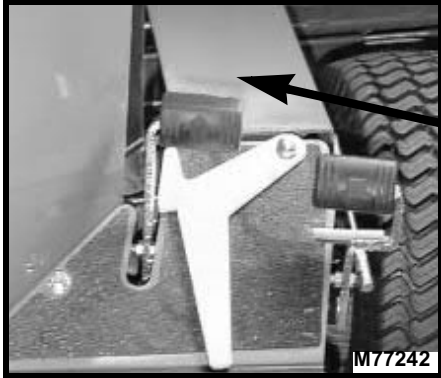

- A - Free-Wheeling Lever..... Allows machine to be moved without the engine running**
- B - Fuel Shut-Off ValveShuts off fuel to fuel line**

OPERATING THE MACHINE

SAFETY



Operate Safely

- Check brake action before you operate. Adjust or service brakes as necessary.
- Inspect machine before you operate. Be sure hardware is tight. Repair or replace damaged, badly worn, or missing parts. Make any necessary adjustments before you operate.
- Clear work area of objects that might be thrown. Keep people and pets out of the work area. Stop machine if anyone enters the area.
- If you hit an object, stop the machine and inspect it. Make repairs before you operate. Keep machine and attachments properly maintained and in good working order. Keep all shields and guards in place.
- DO NOT leave machine unattended when it is running.
- Only operate during daylight or with good artificial light.
- Be careful of traffic when operating near or crossing roadways.
- Drive slowly over rough ground.
- Do not wear radio or music headphones while operating the machine. Safe operation requires your full attention.

Mount and Dismount Safely



- Do not step on pedals when mounting or dismounting.
- Keep step area and platform clean.
- Lock parking brake, stop engine, and remove key before dismounting.

OPERATING THE MACHINE

Park Safely

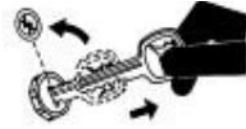

- Stop machine on a level surface, not on a slope.
- Disengage cutting units.
- Lower cutting units to the ground.
- Engage park brake.
- STOP engine.
- Remove key.
- Before you leave the operator's seat, wait for engine and all moving parts to STOP.

Avoid Tipping



- DO NOT drive machine on a slope with an incline of greater than 16° where machine could slip or tip.
- Stay alert for holes and other hidden hazards in the terrain.
- Keep away from drop-offs.
- Slow down before you make a sharp turn or operate on a slope.
- Be careful when you change direction on a slope.
- DO NOT try to stabilize the machine by putting your foot on the ground.

OPERATING THE MACHINE

Rotating Blades Are Dangerous - Prevent Accidents



PROTECT OTHERS:

- Turn machine off if another person enters the mowing area.
- Use extra care when you come to blind corners, shrubs, trees, or other objects that may block your vision.
- DO NOT let untrained person operate the machine.
- DO NOT carry or let others ride on machine.

HELP PREVENT SERIOUS OR FATAL ACCIDENTS:

- Be alert at all times, drive forward carefully. People can move quickly into the mowing area before you know it.
- DO NOT operate machine if you are under the influence of drugs or alcohol.
- Back carefully. Shut off cutting units and look behind the machine carefully before you back up.
- DO NOT mow in reverse.
- Shut off cutting units when you are not mowing.
- Stop engine and wait for reels to stop turning before making any adjustments to the cutting units.
- Keep hands and feet away from cutting units while machine is running.

OPERATING THE MACHINE

Operator Training Required

- Study operation section of this manual before operating the machine.
- Operate machine in an open, unobstructed area under the direction of an experienced operator.
- Learn the use of all controls.
- Operator experience is required to learn the moving, stopping, turning and other operating characteristics of the machine.

Keep Riders Off



- Only allow the operator on the machine. Keep riders off.
- Riders on the machine may be struck by foreign objects or thrown off the machine causing serious injury.
- Riders obstruct the operator's view resulting in the machine being operated in an unsafe manner.



Suggest:

If the above button click is invalid.

Please download this document

first, and then click the above link

to download the complete manual.

Thank you so much for reading

OPERATING THE MACHINE

Wear Appropriate Clothing



- Wear close fitting clothing and safety equipment appropriate for the job.
- Loud noise can cause impairment or loss of hearing, wear a suitable protective device such as earplugs.
- Do not wear radio or music headphones while operating the machine. Safe operation requires your full attention.

Check Wheel Bolts

- A serious accident could occur causing serious injury if wheel bolts are not tight.
- Check wheel bolt tightness often during the first 100 hours of operation.

Transport Safely



- Use safety lights and devices. Slow moving machines when driven on public roads are hard to see, especially at night. Avoid personal injury or death resulting from a collision with a vehicle.

<https://www.ebooklibonline.com>

Hello dear friend!

Thank you very much for reading.

Enter the link into your browser.

The full manual is available for immediate download.

<https://www.ebooklibonline.com>