

JOHN DEERE
WORLDWIDE COMMERCIAL & CONSUMER
EQUIPMENT DIVISION

Straight Blade and V-Blade
72-Inch

OMM163348 F0
OPERATOR'S MANUAL



JOHN DEERE

Original Instruction

All information, illustrations and specifications in this manual are based on the latest information at the time of publication. The right is reserved to make changes at any time without notice.

COPYRIGHT© 2010
Deere & Co.

John Deere Worldwide Commercial and
Consumer Equipment Division
All rights reserved
Previous Editions
COPYRIGHT©

North American Version
Litho in U.S.A.

INTRODUCTION

Table of Contents

Introduction.....	1
Product Identification.....	1
Safety Labels.....	2
Safety Labels.....	3
Safety.....	3
Assembly.....	4
Preparing Vehicle.....	6
Installing.....	7
Removing and Storage.....	8
Operating.....	10
Service.....	13
Troubleshooting.....	14
Specifications.....	15
Getting Quality Service.....	15

Introduction

Using Your Operator's Manual

Read this entire operator's manual, especially the safety information, before operating.

This manual is an important part of your machine. Keep all manuals in a convenient location so they can be accessed easily.

Use the safety and operating information in the attachment operator's manual, along with the machine operator's manual, to operate and service the attachment safely and correctly.

If your attachment manual has a section called Preparing the Machine, it means that you will have to do something to your tractor or vehicle before you can install the attachment. The Assembly and Installation sections of this manual provide information to assemble and install the attachment to your tractor or vehicle. Use the Service section to make any needed adjustments and routine service to your attachment.

If you have any questions or concerns with the assembly, installation, or operation of this attachment, see your local John Deere dealer or call the John Deere Customer Contact Center at 1-800-537-8233 for assistance.

Warranty information on this John Deere attachment can be found in the warranty that came with your John Deere tractor or vehicle.

Product Identification

Product Compatibility

The 72-Inch Straight Blade and V-Blade are compatible with HPX, XUV and T Series Gator™ Utility Vehicles. Contact your John Deere dealer for specific vehicle compatibility information.

Record Purchase Information

Record your purchase information in the spaces provided below.

DATE OF PURCHASE:

DEALER NAME:

DEALER PHONE:

SAFETY LABELS

Safety Label Location

Safety Labels

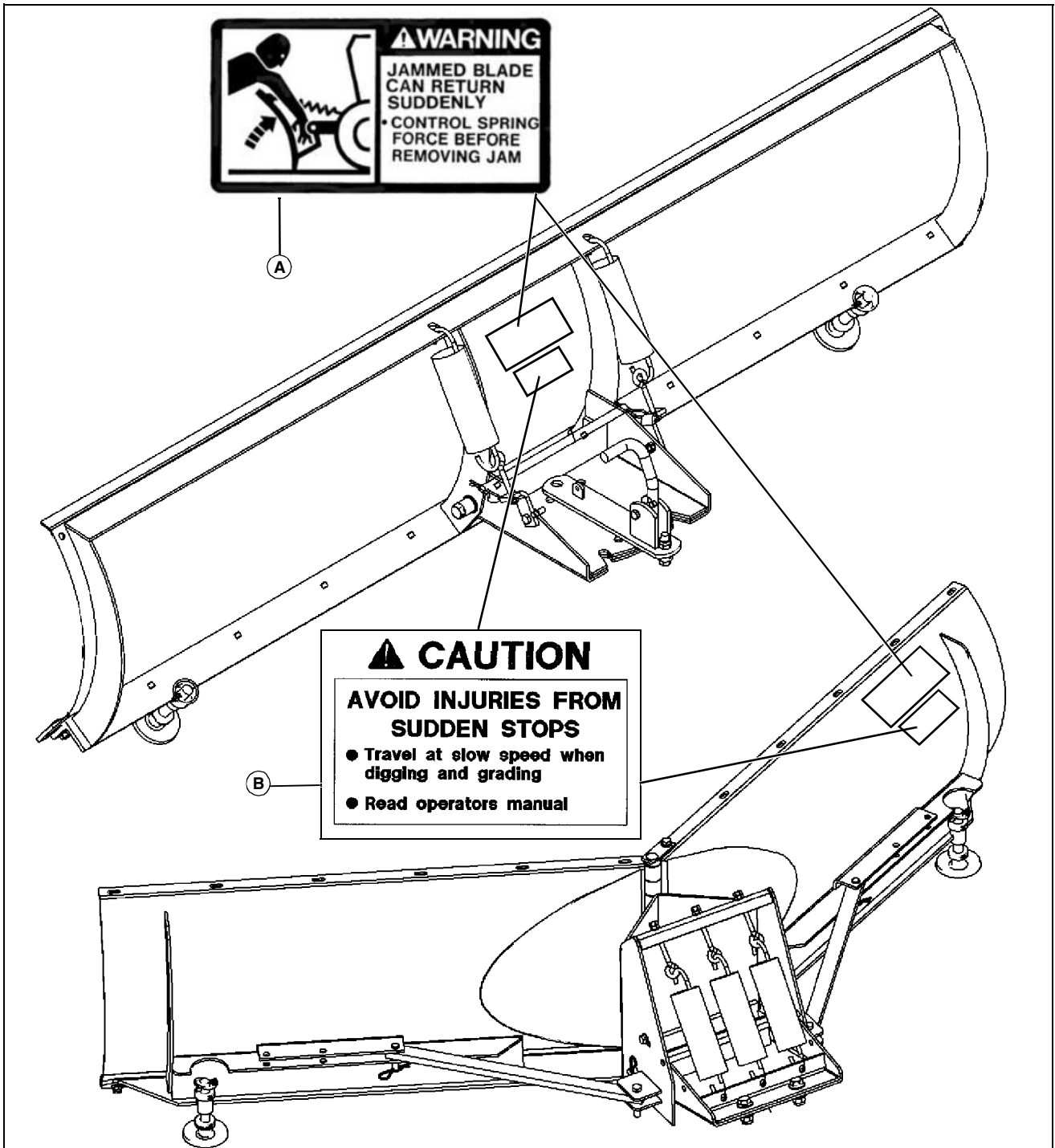

MX46319

Picture Note: Use label number listed in table below to locate complete text of safety label message following this illustration.

A- WARNING - M119672

B- CAUTION - M123368

<https://www.ebooklibonline.com>

Hello dear friend!

Thank you very much for reading.

Enter the link into your browser.

The full manual is available for immediate download.

<https://www.ebooklibonline.com>

SAFETY LABELS

Safety Labels



Understanding The Machine Safety Labels

The machine safety labels shown in this section are placed in important areas on your machine to draw attention to potential safety hazards.

On your machine safety labels, the words DANGER, WARNING, and CAUTION are used with this safety-alert symbol. DANGER identifies the most serious hazards.

The operator's manual also explains any potential safety hazards whenever necessary in special safety messages that are identified with the word, CAUTION, and the safety-alert symbol.

There can be additional safety information contained on parts and components sourced from suppliers that is not reproduced in this operator's manual.

WARNING M119672



M119672

JAMMED BLADE CAN RETURN SUDDENLY

- Control spring force before removing jam

CAUTION M123368



M123368

AVOID INJURIES FROM SUDDEN STOPS

- Travel at slow speed when digging and grading.
- Read operators manual.

Safety

Read Safety in Machine Operator's Manual

Read the general safety operating precautions in your machine operator's manual for additional safety information.

Operating Safely

- This attachment is intended for light duty moving of snow or other light, loose material and is not intended for digging or grading. Do not misuse this equipment.
- Do not exceed operating speed of 16 km/h (10 mph) when moving material with this attachment.
- Read, understand and follow all instructions in the manual and on the vehicle and attachment before operating.
- Only allow responsible adults who are familiar with the instructions to operate the machine.
- Inspect machine and attachment before you operate. Be sure hardware is tight. Repair or replace damaged, badly worn or missing parts. Be sure guards and shields are in good condition and fastened in place. Make any necessary adjustments before you operate.
- Check brake action before you operate. Adjust or service brakes as necessary.
- Stop machine if anyone enters the area.
- If you hit an object, stop and inspect the machine. Make repairs before you operate. Keep machine and attachments properly maintained and in good working order.
- Before operating, make sure all connections are tight and blade responds properly to controls. Check all connections periodically for tightness.
- Do not leave machine unattended when it is running.
- Only operate during daylight or with good artificial light.
- Be careful of traffic when operating near or crossing roadways.
- Do not wear radio or music headphones while operating the machine. Safe operation requires your full attention.
- Transport the blade with it raised to the highest position, it should be centered and not at an angle.
- Be aware of the position of the blade ends. Blade makes a wide arc when turning.
- Be aware of the possibility of objects hidden under the snow. Avoid holes, rocks, roots and other obstructions.
- Avoid the edges of ditches and banks to reduce the possibility of loss of control.
- When plowing material into a pile, travel in reverse before raising blade.
- Do not ram into a pile of material; slow down before contact is made.
- Lower attachment completely before leaving operator's seat.
- Lower any attachment completely to the ground or to an existing attachment mechanical stop before servicing the attachment. Disengage all power and stop the engine. Lock park brake and remove the key.
- Keep all parts in good condition and properly installed. Fix damage immediately. Replace worn or broken parts. Replace all worn or damaged safety and instruction decals.

Parking Safely

1. Stop machine on a level surface, not on a slope.

ASSEMBLY

2. Lower attachments to the ground.
3. Lock the park brake.
4. Stop the engine.
5. Remove the key.
6. Wait for engine and all moving parts to stop before you leave the operator's seat.
7. Close fuel shut-off valve, if your machine is equipped.
8. Disconnect the negative battery cable or remove the spark plug wire (for gasoline engines) before servicing the machine.

Checking Area to be Cleared

- Thoroughly inspect the area where the equipment is to be used and remove all doormats, sleds, boards, wires and other foreign objects.
- Keep people and pets out of the work area. Keep children indoors when using blade. Turn the machine off if anyone enters the area.
- Be extremely careful if you must clear snow from a gravel surface. Adjust the blade height to clear a gravel surface.

Avoid Injury From Hitting Obstructions

- Raise and center, not angle, attachment when you drive between jobs.
- Slow down when you remove snow. Be cautious on slopes, when you make turns or when close to buildings or trees.

Practice Safe Maintenance

- Only qualified, trained adults should service this machine.
- Understand service procedure before doing work. Keep area clean and dry.
- Do not operate the engine in a confined space where dangerous carbon monoxide fumes can collect.
- Never lubricate, service or adjust the machine or attachment while it is moving. Keep safety devices in place and in working condition. Keep hardware tight.
- Keep hands, feet, clothing, jewelry, and long hair away from any moving parts, to prevent them from getting caught.
- Lower any attachment completely to the ground or to an existing attachment mechanical stop before servicing the attachment. Disengage all power and stop the engine. Lock park brake and remove the key. Let machine cool.
- Disconnect battery or remove spark plug wire (for gasoline engines) before making any repairs.
- Before servicing machine or attachment, carefully release pressure from any components with stored energy, such as hydraulic components and springs.
- Release hydraulic pressure by lowering attachment or cutting units to the ground or to a mechanical stop and move hydraulic control levers.
- Securely support any machine or attachment elements that must be raised for service work. Use jack stands or lock service latches to support components when needed.
- Never run engine unless park brake is locked.
- Keep all parts in good condition and properly installed. Fix damage immediately. Replace worn or broken parts. Replace all worn or damaged safety and instruction decals.
- Check all hardware at frequent intervals to be sure the equipment is in safe working condition.

- Do not modify machine or safety devices. Unauthorized modifications to the machine or attachment may impair its function and safety.

Handling Waste Product and Chemicals

Waste products, such as, used oil, fuel, coolant, brake fluid, and batteries, can harm the environment and people:

- Do not use beverage containers for waste fluids - someone may drink from them.
- See your local Recycling Center or authorized dealer to learn how to recycle or get rid of waste products.
- A Material Safety Data Sheet (MSDS) provides specific details on chemical products: physical and health hazards, safety procedures, and emergency response techniques. The seller of the chemical products used with your machine is responsible for providing the MSDS for that product.

Assembly

Identify Parts

Straight Blade

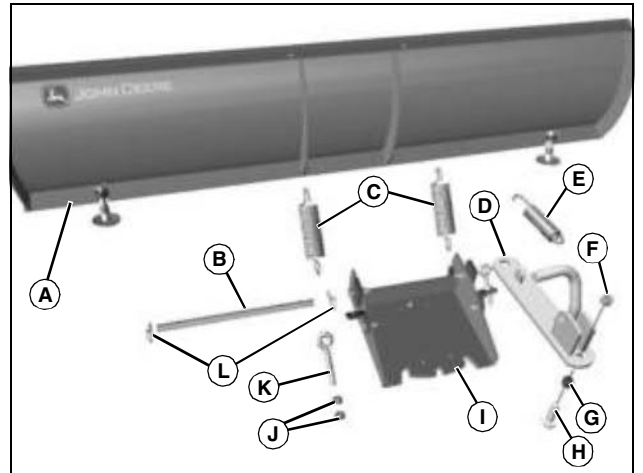

MX39592

Qty.	Description	Size
1	Blade Assembly (A)	72 in.
1	Pin, Mounting (B)	
2	Spring (C)	
1	Blade Position Bracket (D)	
1	Spring (E)	
1	Nut (F)	M10
1	Spacer (G)	
1	Bolt, Flange Head (H)	M10x40
1	Blade Pivot Bracket (I)	
4	Locknut (J)	5/16 in.
2	Eyebolt (K)	

ASSEMBLY

Qty.	Description	Size
2	Spring Locking Pin (L)	

V-Blade

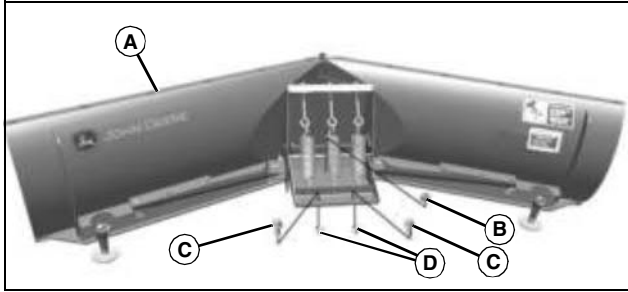

MX39593

Qty.	Description	Size
1	V-Blade Assembly (A)	72 in.
1	Locknut (B)	5/8 in.
2	Bolt, Flange Head (C)	M12x30
2	Locknut (D)	M12

Implement Frame

NOTE: Front implement lift kits must be purchased and installed previous to blade installation. You also have to purchase a separate implement frame, below, for your machine.

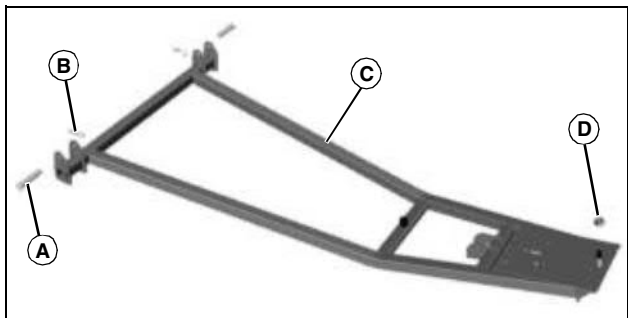

MX46316

Picture Note: XUV 625i, XUV 825i, XUV 855D Lift Frame

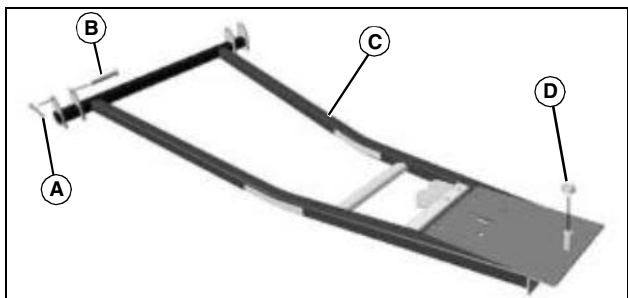

MX31051

Picture Note: HPX, XUV 620i, XUV 850D Lift Frame

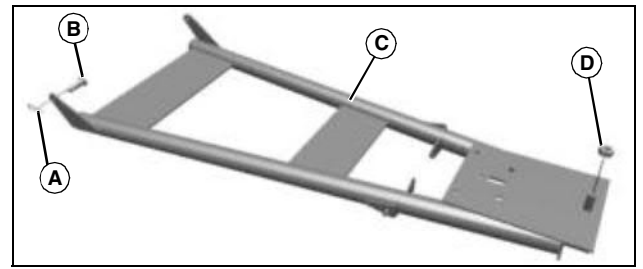

MX39601

Picture Note: T-Series Lift Frame

Qty.	Description	Size
2	Spring Locking Pin (A)	
2	Pin, Drilled (B)	
1	Implement Lift Frame (C)	
1	Locknut (D)	5/8 in.

Attach Blade to Frame

Straight Blade

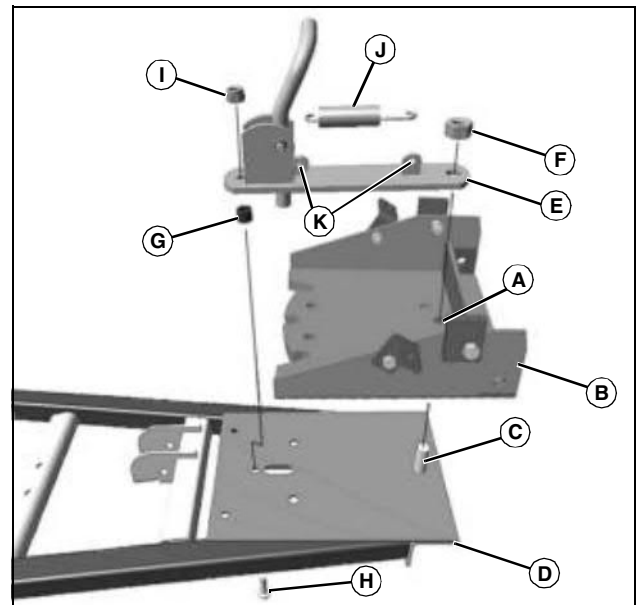

MX39594

1. Align front hole (A) in skid bracket (B) with bolt (C) welded to bottom of implement frame (D) and lower skid bracket down onto bolt.
2. Lower hole in blade position lever bracket (E) onto skid bracket (B) and bolt (C). Loosely secure with 5/8 in. locknut (F).
3. Place spacer (G) between implement frame (D) and blade position lever bracket (E), and secure with bolt (H) and nut (I).
4. Tighten front 5/8 in. nut (F), then loosen just enough so skid bracket can rotate on implement frame.
5. Install spring (J) onto two holes (K) in tabs on blade position lever bracket.



Suggest:

If the above button click is invalid.

Please download this document

first, and then click the above link

to download the complete manual.

Thank you so much for reading

PREPARING VEHICLE

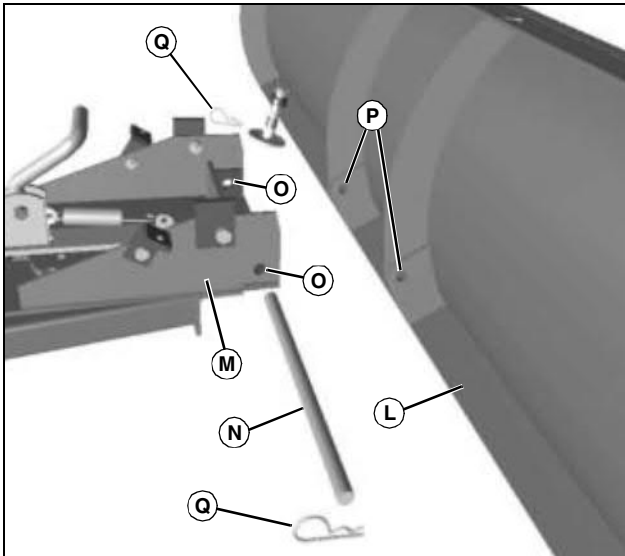

MX39595

- Center the back side of blade (L) with frame assembly (M).
- Attach blade to frame on each side with mounting pin (N) using holes (O) in frame and holes (P) in blade. Secure each side with spring locking pin (Q).

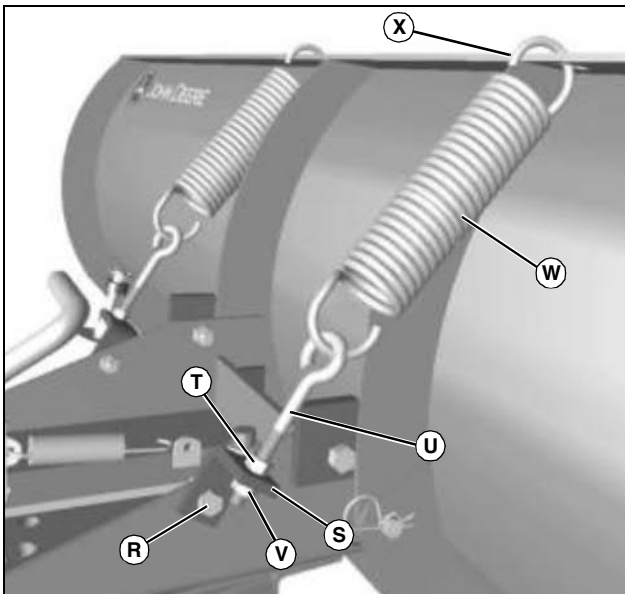

MX39596

- Loosen bolt (R) to allow bracket (S) to rotate freely. Repeat on opposite side.
- Install one locknut (T) onto eyebolt (U), and install eyebolt through hole in bracket (S). Install second locknut (V) onto eyebolt but do not tighten completely. Repeat on opposite side.

CAUTION: Avoid injury! Springs are under high tension and must be installed with hooked ends toward machine to prevent accidental detachment if blade trips.

- Install springs (W) through eyebolts and secure to blade with hooked ends (X) toward the machine.

- Tighten the locknuts (V) on the eyebolts so 15 mm (9/16 in.) of thread is exposed. Tighten top locknut (T) on each side to secure eyebolt in position.
- Adjust spring trip, blade tilt, and the skid shoes before operating.

V-Blade

CAUTION: Avoid injury! Machine component or attachment is heavy. Use a safe lifting device or get an assistant to help lift, install or remove component or attachment.

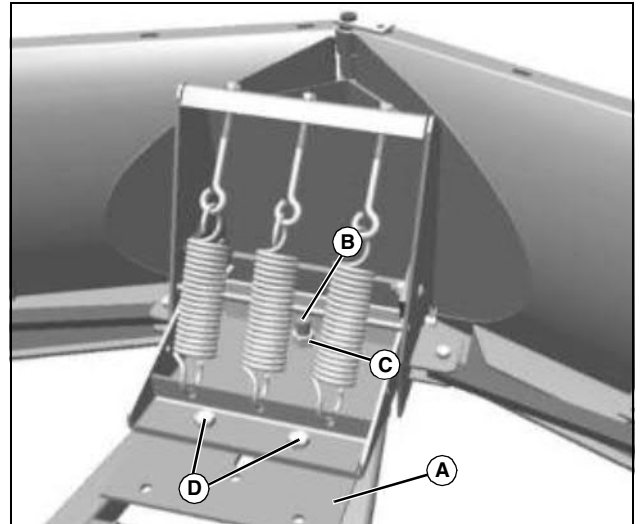

MX39597

- Tip blade forward and slide over frame center bracket (A).
- Align front hole in V-blade center bracket with bolt (B) welded to bottom of frame and lower blade down onto bolt. Secure with 5/8 in. locknut (C).
- Align two holes in frame with holes in center bracket and attach with two M12x30 flange head bolts (D). Secure with M12 locknuts.
- Tighten nuts to:
 - 5/8 in.: 210 N•m (155 lb-ft)
 - M12: 90 N•m (66 lb-ft)

Preparing Vehicle

Check Tire Pressure and Wheel Bolt Torque

See your utility vehicle operator's manual:

- Check tire pressure with an accurate gauge. Make sure tires are at recommended air pressure.
- Check wheel bolts are tightened to specified torque value. Tighten bolts in proper sequence using a torque wrench.

Loading Cargo Box With Ballast

CAUTION: Avoid injury! Loads can shift forward. Do not load cargo box above the height of load guard. Do not exceed load capacity of vehicle.

Add weight to the cargo box for proper traction and blade performance. Recommended materials include sand or bagged material. If using

<https://www.ebooklibonline.com>

Hello dear friend!

Thank you very much for reading.

Enter the link into your browser.

The full manual is available for immediate download.

<https://www.ebooklibonline.com>