

**JOHN DEERE**  
**WORLDWIDE COMMERCIAL & CONSUMER**  
**EQUIPMENT DIVISION**

---

**Heavy Duty Blade**  
**72-Inch**

OMM158122 D0

**OPERATOR'S MANUAL**



**JOHN DEERE**

**Original Instruction**

All information, illustrations and specifications in this manual are based on the latest information at the time of publication. The right is reserved to make changes at any time without notice.

COPYRIGHT© 2010  
Deere & Co.

John Deere Worldwide Commercial and  
Consumer Equipment Division

All rights reserved  
Previous Editions  
COPYRIGHT© 2010

North American Version  
Litho in U.S.A.

---

---

# INTRODUCTION

---

---

## Table of Contents

|                              |    |
|------------------------------|----|
| Introduction.....            | 1  |
| Product Identification.....  | 1  |
| Safety.....                  | 1  |
| Assembly.....                | 2  |
| Preparing Vehicle.....       | 5  |
| Installing.....              | 9  |
| Removing and Storage.....    | 10 |
| Operating.....               | 11 |
| Service.....                 | 13 |
| Troubleshooting.....         | 17 |
| Specifications.....          | 22 |
| Getting Quality Service..... | 22 |

---

---

## Introduction

### Using Your Operator's Manual

Read this entire operator's manual, especially the safety information, before operating.

This manual is an important part of your machine. Keep all manuals in a convenient location so they can be accessed easily.

Use the safety and operating information in the attachment operator's manual, along with the machine operator's manual, to operate and service the attachment safely and correctly.

If your attachment manual has a section called Preparing the Machine, it means that you will have to do something to your tractor or vehicle before you can install the attachment. The Assembly and Installation sections of this manual provide information to assemble and install the attachment to your tractor or vehicle. Use the Service section to make any needed adjustments and routine service to your attachment.

If you have any questions or concerns with the assembly, installation, or operation of this attachment, see your local John Deere dealer or call Powertach Special Services at 1-866-433-1733 for assistance.

---

---

## Product Identification

### Product Compatibility

The 72-Inch Heavy Duty Blade is compatible with HPX and XUV Series Gator™ Utility Vehicles. Contact your John Deere dealer for specific vehicle compatibility information.

### Record Purchase Information

Record your purchase information in the spaces provided below.

DATE OF PURCHASE:

\_\_\_\_\_

DEALER NAME:

\_\_\_\_\_

DEALER PHONE:

\_\_\_\_\_

---

---

## Safety

### Read Safety in Machine Operator's Manual

Read the general safety operating precautions in your machine operator's manual for additional safety information.

### Operating Safely

- This attachment is intended for light duty moving of snow or other light, loose material and is not intended for digging or grading. Do not misuse this equipment.
- Do not exceed operating speed of 16 km/h (10 mph) when moving material with this attachment.
- Read, understand and follow all instructions in the manual and on the vehicle and attachment before operating.
- Only allow responsible adults who are familiar with the instructions to operate the machine.
- Inspect machine and attachment before you operate. Be sure hardware is tight. Repair or replace damaged, badly worn or missing parts. Be sure guards and shields are in good condition and fastened in place. Make any

---

---

# ASSEMBLY

---

---

necessary adjustments before you operate.

- Check brake action before you operate. Adjust or service brakes as necessary.
- Stop machine if anyone enters the area.
- If you hit an object, stop and inspect the machine. Make repairs before you operate. Keep machine and attachments properly maintained and in good working order.
- Before operating, make sure all connections are tight and blade responds properly to controls. Check all connections periodically for tightness.
- Do not leave machine unattended when it is running.
- Only operate during daylight or with good artificial light.
- Be careful of traffic when operating near or crossing roadways.
- Do not wear radio or music headphones while operating the machine. Safe operation requires your full attention.
- Transport the blade with it raised to the highest position, it should be centered and not at an angle.
- Be aware of the position of the blade ends. Blade makes a wide arc when turning.
- Be aware of the possibility of objects hidden under the snow. Avoid holes, rocks, roots and other obstructions.
- Avoid the edges of ditches and banks to reduce the possibility of loss of control.
- When plowing material into a pile, travel in reverse before raising blade.
- Do not ram into a pile of material; slow down before contact is made.
- Lower attachment completely before leaving operator's seat.
- Lower any attachment completely to the ground or to an existing attachment mechanical stop before servicing the attachment. Disengage all power and stop the engine. Lock park brake and remove the key.
- Keep all parts in good condition and properly installed. Fix damage immediately. Replace worn or broken parts. Replace all worn or damaged safety and instruction decals.

## Parking Safely

1. Stop machine on a level surface, not on a slope.
2. Lower attachments to the ground.
3. Lock the park brake.
4. Stop the engine.
5. Remove the key.
6. Wait for engine and all moving parts to stop before you leave the operator's seat.
7. Close fuel shut-off valve, if your machine is equipped.
8. Disconnect the negative battery cable or remove the spark plug wire (for gasoline engines) before servicing the machine.

## Checking Area to be Cleared

- Thoroughly inspect the area where the equipment is to be used and remove all doormats, sleds, boards, wires and other foreign objects.
- Keep people and pets out of the work area. Keep children indoors when using blade. Turn the machine off if anyone enters the area.
- Be extremely careful if you must clear snow from a gravel surface. Adjust the blade height to clear a gravel surface.

## Avoid Injury From Hitting Obstructions

- Raise and center, not angle, attachment when you drive between jobs.
- Slow down when you remove snow. Be cautious on slopes, when you make turns or when close to buildings or trees.

## Practice Safe Maintenance

- Only qualified, trained adults should service this machine.
- Understand service procedure before doing work. Keep area clean and dry.
- Do not operate the engine in a confined space where dangerous carbon monoxide fumes can collect.
- Never lubricate, service or adjust the machine or attachment while it is moving. Keep safety devices in place and in working condition. Keep hardware tight.
- Keep hands, feet, clothing, jewelry, and long hair away from any moving parts, to prevent them from getting caught.
- Lower any attachment completely to the ground or to an existing attachment mechanical stop before servicing the attachment. Disengage all power and stop the engine. Lock park brake and remove the key. Let machine cool.
- Disconnect battery or remove spark plug wire (for gasoline engines) before making any repairs.
- Before servicing machine or attachment, carefully release pressure from any components with stored energy, such as hydraulic components and springs.
- Release hydraulic pressure by lowering attachment or cutting units to the ground or to a mechanical stop and move hydraulic control levers.
- Securely support any machine or attachment elements that must be raised for service work. Use jack stands or lock service latches to support components when needed.
- Never run engine unless park brake is locked.
- Keep all parts in good condition and properly installed. Fix damage immediately. Replace worn or broken parts. Replace all worn or damaged safety and instruction decals.
- Check all hardware at frequent intervals to be sure the equipment is in safe working condition.
- Do not modify machine or safety devices. Unauthorized modifications to the machine or attachment may impair its function and safety.

## Handling Waste Product and Chemicals

Waste products, such as, used oil, fuel, coolant, brake fluid, and batteries, can harm the environment and people:

- Do not use beverage containers for waste fluids - someone may drink from them.
- See your local Recycling Center or authorized dealer to learn how to recycle or get rid of waste products.
- A Material Safety Data Sheet (MSDS) provides specific details on chemical products: physical and health hazards, safety procedures, and emergency response techniques. The seller of the chemical products used with your machine is responsible for providing the MSDS for that product.

---

---

## Assembly

### Identify Parts

**<https://www.ebooklibonline.com>**

Hello dear friend!

Thank you very much for reading.

Enter the link into your browser.

The full manual is available for immediate download.

**<https://www.ebooklibonline.com>**

# ASSEMBLY

The blade attachment is shipped partially assembled in three boxes with the blade in one box, the blade frame assembly and associated hardware bags in another box. The hitch/ vehicle mount is in a separate box.

**NOTE: If the vehicle is equipped with a front receiver hitch, it should be removed before installing the blade.**

## Heavy Duty Blade

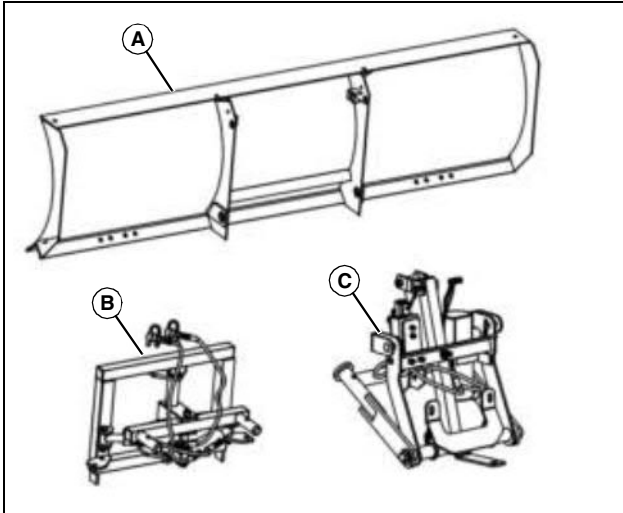

MX40175

| Qty. | Description  |
|------|--|
| 1    | Blade Weldment (A) (includes wear bar)                                       |
| 1    | Frame Assembly (B) (includes hydraulic components)                           |
| 1    | Hitch Assembly (C) (includes vehicle mounting bracket)                       |
| 1    | Wiring Harness (not shown) (includes blade control lever/switch and bracket) |
| 2    | Spring, Trip (not shown)   |
| 2    | Skid Shoe (not shown)  |
| 2    | Shoe Mount (not shown)   |

## Bag of Parts (Marked Z-1880)

| Qty. | Description                        |
|------|------------------------------------|
| 4    | Bracket, Spring                    |
| 2    | Bolt, Hex Head, 3/8 x 1-1/4 in.    |
| 2    | Bolt, Hex Head, 3/8 x 2-1/2 in.    |
| 2    | Lockwasher, 3/8 in.                |
| 2    | Nut, Hex, 3/8 in.                  |
| 2    | Locknut, with Star Washer, 3/8 in. |

## Bag of Parts (Marked Z-1885)

| Qty. | Description                     |
|------|---------------------------------|
| 2    | Bolt, Carriage, 1/4 x 3/4 in.   |
| 3    | Bolt, Hex Head, 1/2 x 1-1/2 in. |
| 3    | Washer, Special, 1/2 in.        |
| 3    | Washer, Flat, Standard, 1/2 in. |
| 3    | Lockwasher, 1/2 in.             |
| 2    | Locknut, Nylon Insert, 1/4 in.  |
| 3    | Nut, Hex, 1/2 in.               |
| 2    | Pin, Clevis, 1/2 x 1-1/4 in.    |
| 2    | Pin, Tab Lock, 3/8 x 2-3/4 in.  |
| 2    | Clamp, Conduit, 1/2 in.         |
| 2    | Spring Locking Pin              |
| 6    | Tie Strap, Nylon                |

## Bag of parts (Marked Z-1887)

| Qty. | Description                 |
|------|-----------------------------|
| 2    | Bearing, Plated             |
| 2    | Bolt, Hex Head, 5/8 x 2 in. |
| 2    | Washer, 5/8 in.             |
| 2    | Lockwasher, 5/8 in.         |

## Bag of Parts (Marked Z-1888)

| Qty. | Description                 |
|------|-----------------------------|
| 8    | Bolt, Carriage, 3/8 x 1 in. |
| 8    | Lockwasher, 3/8 in.         |
| 8    | Nut, Hex, 3/8 in.           |
| 2    | Pin, Hairpin Cotter         |

# ASSEMBLY

## Attach Blade to Frame

**NOTE:** The required hardware for this step is found in the bag of parts marked Z-1887.

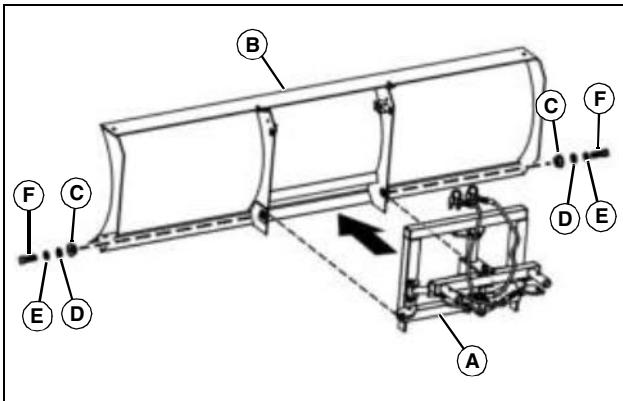

MX40151

1. Position the frame assembly (A) at the back of the blade weldment (B) and secure with a plated bearing (C), 5/8 in. flat washer (D), 5/8 in. lockwasher (E) and 5/8 x 2 in. hex head bolt (F) at each side of the bottom of the frame assembly, installed from the outside, as shown.

## Install Trip Springs

**NOTE:** Spring Bracket must be installed under frame assembly for spring to operate properly.

The required hardware for these steps is found in the bag of parts marked Z1880.

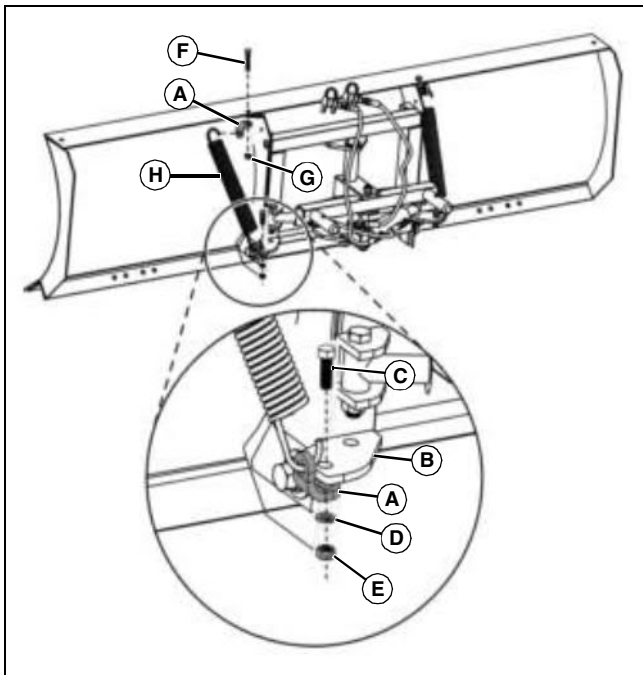

MX40154

1. Position a spring bracket (A) under the left side mounting flange (B) at the bottom of the frame assembly, with the spring bracket oriented toward the outside, as shown. The hole in the spring bracket should be aligned under the outer hole in the mounting flange. Secure with a 3/8 x 1-1/4 in. hex head bolt (C), installed from the top, and a 3/8 in. lockwasher (D) and 3/8 in. hex nut (E), under the spring bracket. Tighten hardware securely.

**NOTE:** The locknut with star washer must only be threaded minimally onto the bolt initially, for easier connection of the trip spring to the upper spring bracket.

2. Install a 3/8 x 2-1/2 in. hex head bolt (F) down through a hole located at the top of the blade, just outside of the blade rib at the left side of the frame assembly. Install a spring bracket (A) on the bolt under the blade flange, and loosely thread a 3/8 in. locknut with star washer (G) onto the bolt until the end of the bolt just starts to show past the nut. Do not tighten hardware at this time.
3. Connect a Trip Spring (H) to the remaining mounting hole on the lower spring bracket (A), then connect the trip spring to the remaining hole in the upper spring bracket.
4. To tension the trip spring, completely tighten the upper spring bracket hardware.
5. Repeat procedure for other side.

## Install Skid Shoes

**NOTE:** The required hardware for these steps is found in the bag of parts marked Z-1888.

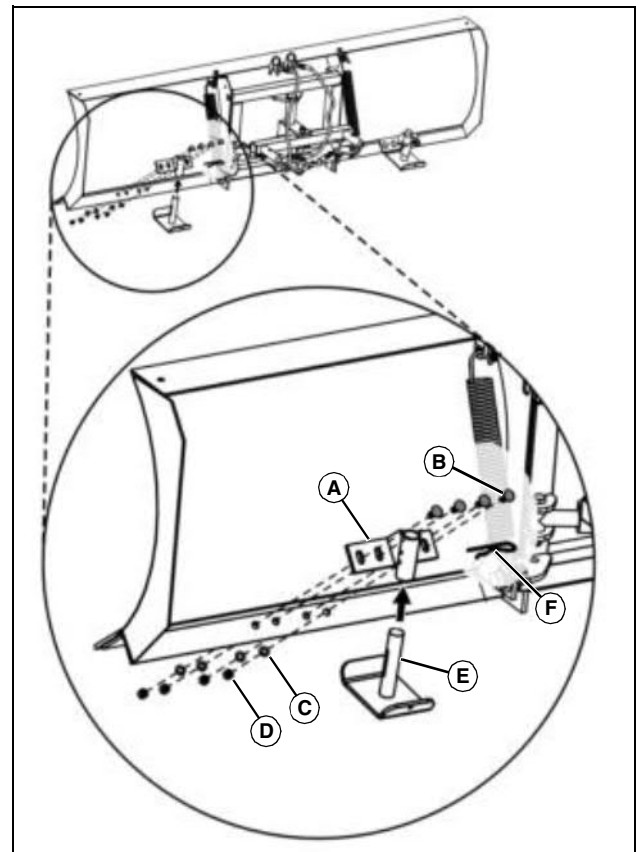

MX40155

1. Position a shoe mount (A) over the four existing holes at the left side of the blade bottom, as shown. Secure with four 3/8 x 1 in. carriage bolts (B), installed from the top, and 3/8 in. lockwashers (C) and 3/8 in. hex nuts (D), below the blade flange. Do not fully tighten.
2. Insert a skid shoe (E) into the shoe mount (A) and allow the skid shoe to slide down to ground. Note that there are several holes located on the center post of the blade shoe, these are used for adjusting skid shoe height.

# PREPARING VEHICLE

**NOTE: Blade should be on firm and level ground when leveling.**

3. Level blade by placing shims under wear bar of blade at both sides so bottom blade edge is slightly off the ground.
4. Move skid shoe to align with nearest hole in shoe mount and secure with a hairpin cotter pin (F).
5. If necessary, a minor height adjustment can be made by moving the shoe mount up or down, as the mounting holes are slotted. When adjustment is completed, tighten shoe mount hardware securely.
6. Repeat procedure for other side.

## Preparing Vehicle

### Check Tire Pressure and Wheel Bolt Torque

See your utility vehicle operator's manual:

- Check tire pressure with an accurate gauge. Make sure tires are at recommended air pressure.
- Check wheel bolts are tightened to specified torque value. Tighten bolts in proper sequence using a torque wrench.

### Preparing Vehicle

If the vehicle is equipped with a front receiver hitch, it should be removed before installing the blade.

### Install Vehicle Mounting Bracket

**NOTE: The required hardware for this procedure is found in the bag of parts marked Z-1885-C and Z-1885-D.**

1. Park vehicle on a level surface and set the parking brake.



MX45715

2. Remove one bolt (A) and nut from skidplate.

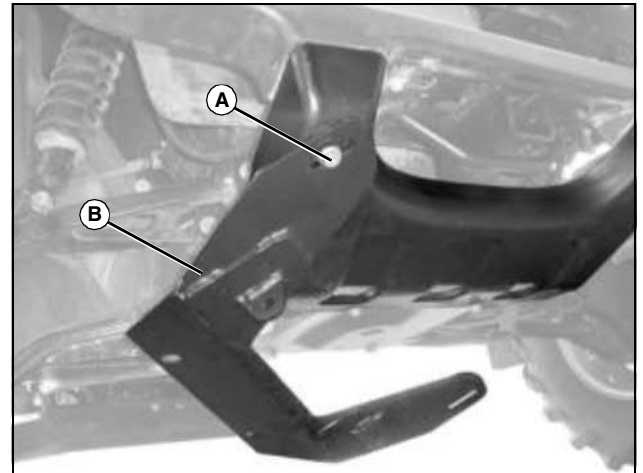

MX45716

3. Attach lower mounting bracket (B) corner as shown using bolt (A) and nut removed in step 1.

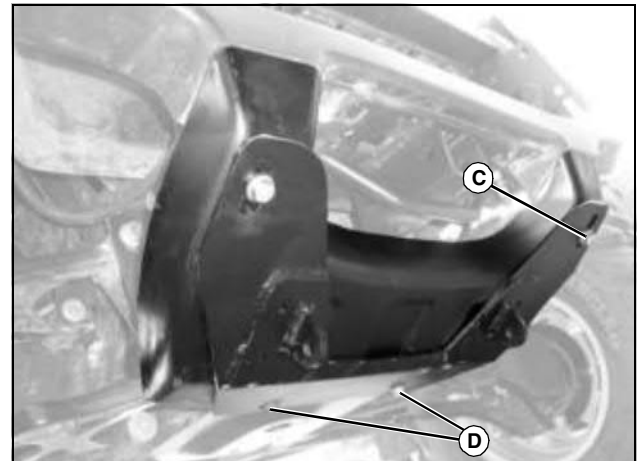

MX45717

4. Remove existing bolt (C) and nut and bolts (D). Keep hardware you will re-install in next step.
5. Rotate bracket into place, and loosely secure with hardware removed in previous step.

# PREPARING VEHICLE

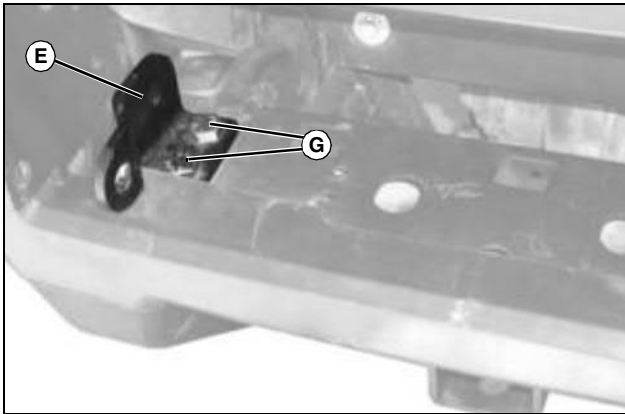

MX45718

Picture Note: Right (passenger's side) shown.

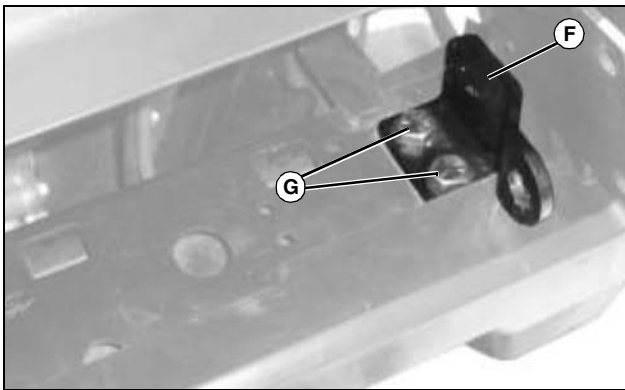

MX45719

Picture Note: Left (driver's side) shown.

6. Loosely install right (E) and left (F) upper mounting brackets to front bumper with four 1/2 x 2-1/2 in. bolts (G), 1/2 in. lockwashers, and 1/2 in. nuts.

## Install Blade Control Lever

**NOTE:** The required hardware for this step is found in the Bag of Parts marked Z-1885.

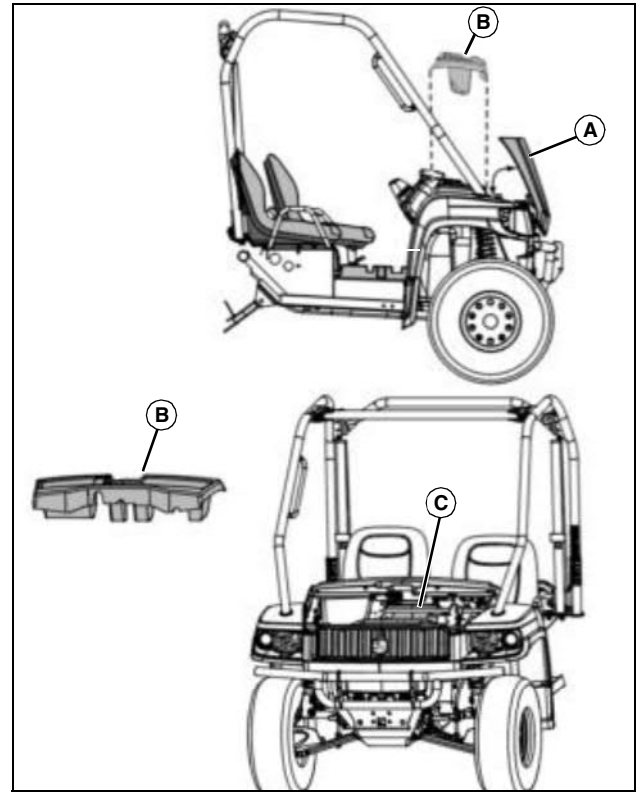

MX40163

1. Open the hood (A).
2. Remove storage tray (B) to gain easy access to the instrument panel support bar (C).
3. Disconnect the blade control lever / switch assembly from the wiring harness by unplugging the 6-pin connector at the blade control lever wiring lead.

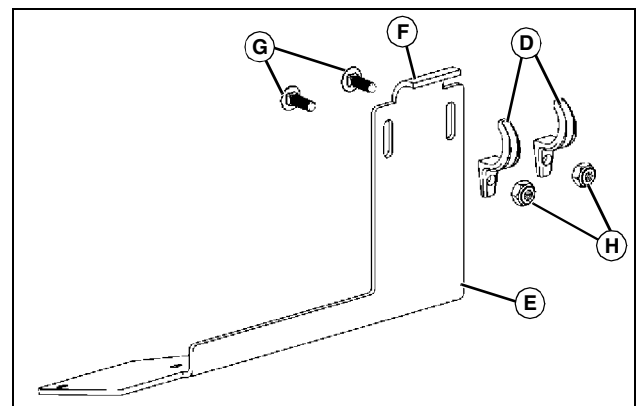

MX45725

Picture Note: Shown with the blade control lever/switch removed from bracket.

4. Pre-assemble the two conduit clamps (D) loosely to switch bracket (E) below the radiused flange (F), using two 1/4 x 3/4 in. carriage bolts (G) and 1/4 in. nylon insert locknuts (H).

# PREPARING VEHICLE

**NOTE:** With the storage tray removed, access to the instrument panel support bar can be done by reaching over the top of the instrument panel.

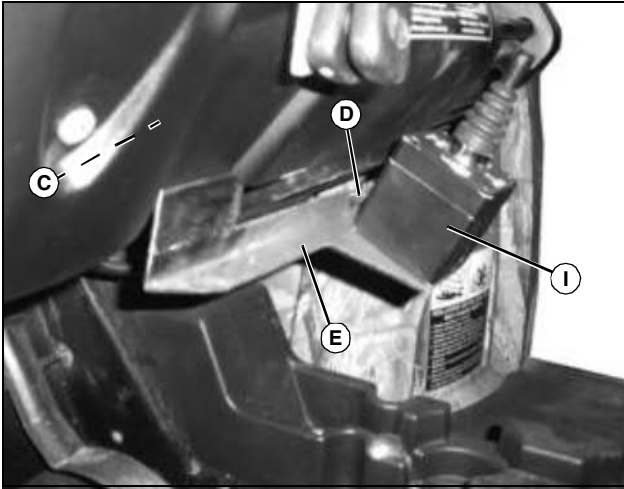

MX45720

5. From operator's station, raise and mount the switch bracket (E) to the instrument panel support bar (C) by fitting the radiused flange of the bracket up over the support bar and pivoting the loose clamps (D) over the other side of the support bar. Tighten bracket hardware only enough to hold the bracket in place, the bracket must still be able to slide on the support bar.

6. Center the blade control lever (I) inside the vehicle by sliding the switch bracket (E) to the desired position and securely tighten the two nylon insert locknuts on clamps to secure position.

## Install Wiring Harness

**NOTE:** The retainer studs are slotted. Do not force plastic retainer studs into anchors. To replace, line up slots with anchor and insert.

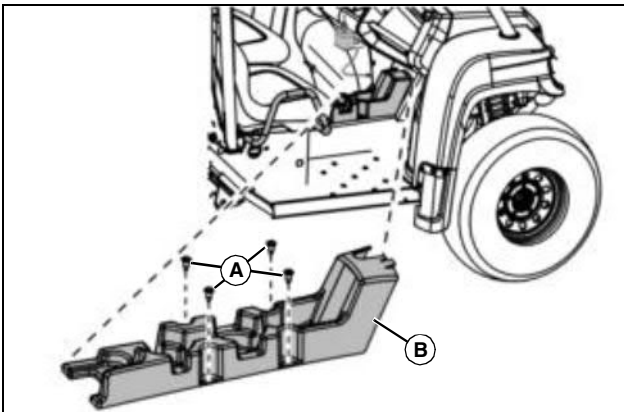

MX40169

1. The vehicle center console cup holder must be removed to run the necessary wiring back to the battery. Using a flat screwdriver or similar tool, remove and retain the four plastic retainers (A) and the center console (B).

**NOTE:** The 3-pin wiring harness must be attached to the right bumper post and the 2-pin wiring harness to the left bumper post in order to make the necessary connections to the hitch assembly.

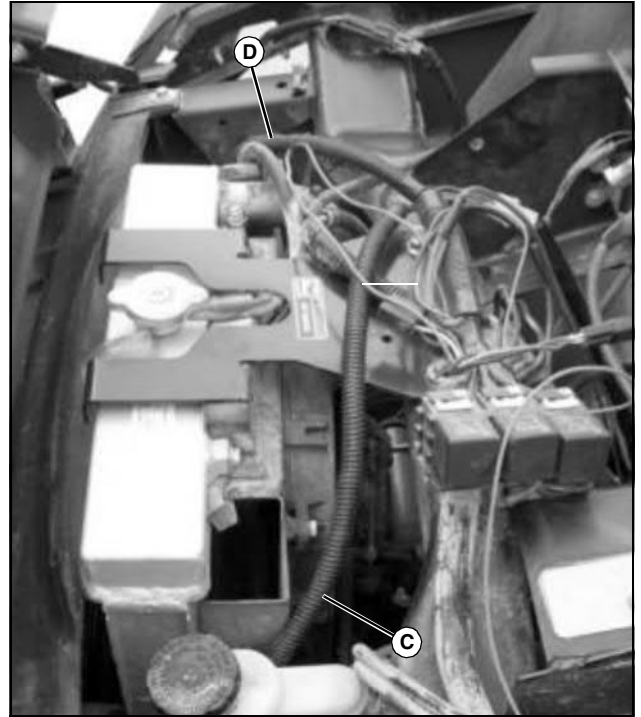

MX45721

2. Arrange the Wiring Harness by routing the 2-pin connector harness (C) and 3-pin connector harness (D) around the engine compartment, down to the underside of the vehicle.

3. Route the red positive (+) and black negative (-) wires, along with the 6-pin connector through the engine compartment to the center console.

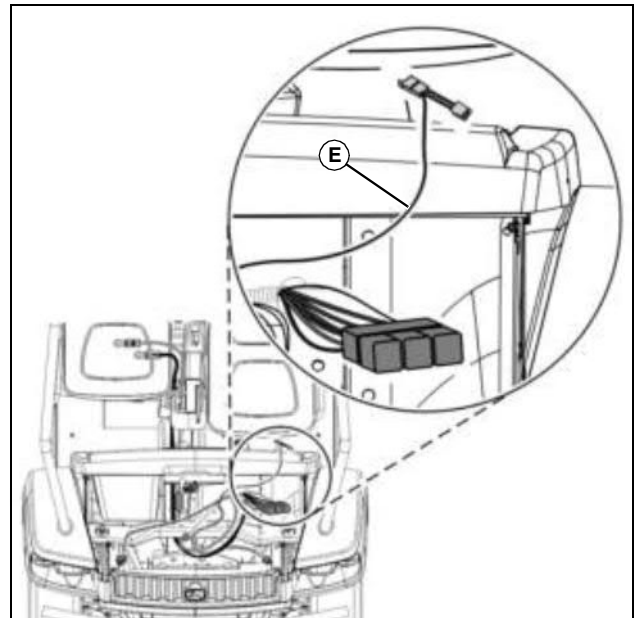

MX40171

4. Connect the purple wire (E) with the 2-pin blade connector to the 2-pin blade connection located on the wire cluster that runs along the vehicle steering column.



**Suggest:**

**If the above button click is invalid.**

**Please download this document**

**first, and then click the above link**

**to download the complete manual.**

**Thank you so much for reading**

# PREPARING VEHICLE

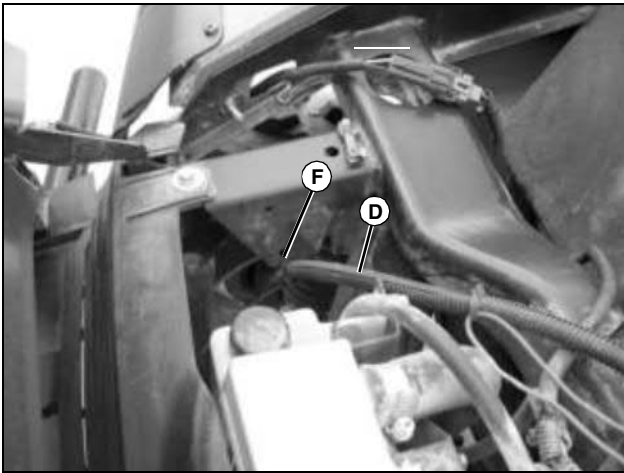

MX45722

**Picture Note: Right side, 3-pin connector harness (D) shown.**

5. To allow movement, loosely attach the 2-pin and 3-pin wiring harness to the bumper post on each side of the vehicle with a cable tie (F).

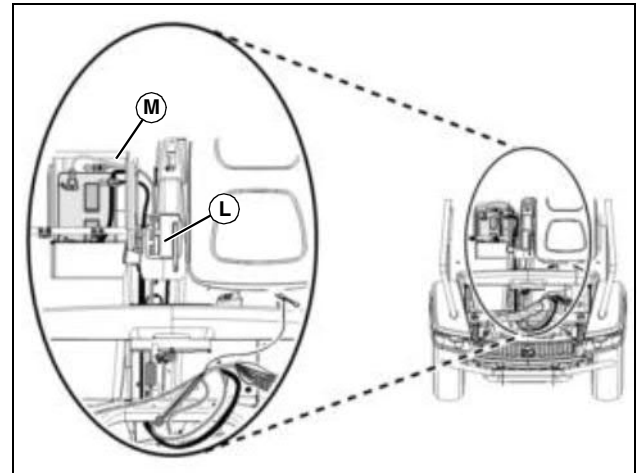

MX40173

**Picture Note: Shown with passenger seat removed.**

7. Continue routing the red positive (+) and black negative (-) wires along the recessed portion of the center console base, beneath transaxle shifter protective cover (L) toward the battery compartment (M).

8. Secure red (+) and black (-) wires to the vehicle wiring harness in the center console using a cable tie.

9. Tilt the passenger seat forward to gain access to the battery compartment.

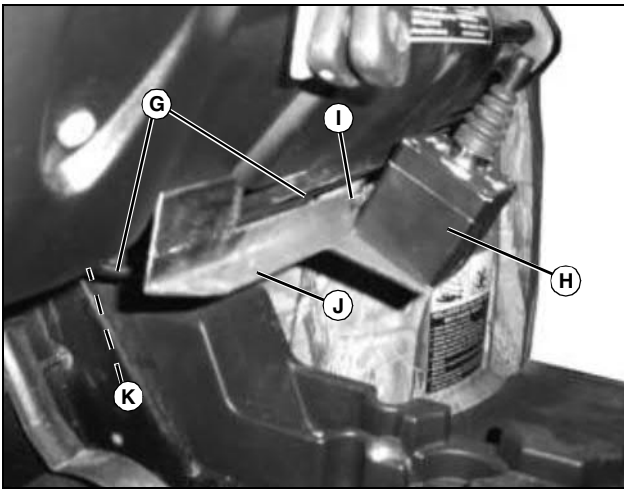

MX45720

6. Route blade control lever harness (G) behind control lever (H) and along U-shaped cutout (I) on switch bracket (J). Plug the 6-pin connector (K) on blade control lever harness (G) to the 6-pin connector from the wiring harness previously routed from the engine compartment to the center console.

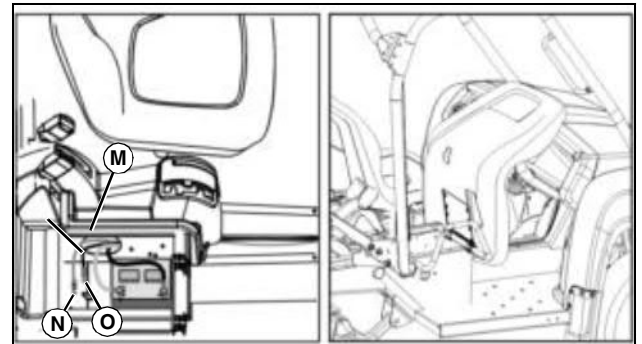

MX40168

10. Pull the red positive (+) (N) and black negative (-) (O) wires through the opening in wall of the battery compartment (M).

11. Slide back rubber protective cover and connect the red positive wire to the positive (+) battery terminal. Connect the black negative wire to the negative (-) battery terminal. Tighten all connections.

12. Slide rubber protective cover back into place over red positive (+) battery terminal.

13. Tilt passenger seat back down to normal position.

**NOTE: The retainer studs and anchors are keyed for proper alignment.**

14. Replace the center console cup holder and secure with plastic retainers, removed earlier. Install the plastic anchors first, then the plastic retainer studs.

**<https://www.ebooklibonline.com>**

Hello dear friend!

Thank you very much for reading.

Enter the link into your browser.

The full manual is available for immediate download.

**<https://www.ebooklibonline.com>**