

JOHN DEERE
AG & TURF DIVISION

AutoConnect™ Mid-Mount Mower
60D and 72D

OMLVU25183 I1

OPERATOR'S MANUAL



JOHN DEERE

Original Instruction

All information, illustrations and specifications in this manual are based on the latest information at the time of publication. The right is reserved to make changes at any time without notice.

COPYRIGHT© 2011
Deere & Co.

John Deere Ag & Turf Division
All rights reserved
Previous Editions
COPYRIGHT©

Export Version
Printed in U.S.A.

Introduction

Table of Contents

Introduction.....	1
Product Identification.....	1
Safety Labels.....	3
Safety.....	6
Assembly.....	8
Installing.....	13
Removing.....	15
Operating.....	16
Service.....	18
Specifications.....	22
Getting Quality Service.....	22
Declaration of Conformity.....	23
Declaration of Conformity.....	24

Introduction

Using Your Operator's Manual

Read this entire operator's manual, especially the safety information, before operating.

This manual is an important part of your machine. Keep all manuals in a convenient location so they can be accessed easily.

Use the safety and operating information in the attachment operator's manual, along with the machine operator's manual, to operate and service the attachment safely and correctly.

If your attachment manual has a section called Preparing the Machine, it means that you will have to do something to your tractor or vehicle before you can install the attachment. The Assembly and Installation sections of this manual provide information to assemble and install the attachment to your tractor or vehicle. Use the Service section to make any needed adjustments and routine service to your attachment.

If you have any questions or concerns with the assembly, installation, or operation of this attachment, see your local John Deere dealer or call the John Deere Customer Contact Center at 1-800-537-8233 for assistance.

Warranty information on this John Deere attachment can be found in the warranty that came with your John Deere tractor or vehicle.

Machine Use

This machine is designed solely for use in customary lawn mowing operations. Use in any other way is considered as contrary to the intended use.

The manufacturer accepts no liability for damage or injury resulting from this misuse, and these risks must be borne solely by the user. Compliance with and strict adherence to the conditions of operation, service and repair as specified by the manufacturer also constitute essential elements for the intended use.

This machine should be operated, serviced and repaired only by persons familiar with all its particular characteristics and acquainted with the relevant safety rules (accident prevention). The accident prevention regulations, all other generally recognized regulations on safety and occupational medicine and the road traffic regulations must be observed at all times.

Setting fuel delivery beyond published factory specifications or otherwise overpowering will result in loss of warranty protection for this machine.

Any arbitrary modifications carried out on this machine will relieve the manufacturer of all liability for any resulting damage or injury.

Product Identification

Product Identification

Product Compatibility

The 60D and 72D AutoConnect mowers are designed for use with compact utility tractor models: 3120, 3320, 3520 and 3720.

Before operating the mower, the following equipment must be installed on the machine. See your John Deere dealer.

- Mid-PTO Kit
- Mower Lift Kit

Record Identification Numbers

AutoConnect™ Mower

60D Serial No. (040001-)

72D Serial No. (040001-)

If you need to contact an Authorized Service Center for information on servicing, always provide the product model and serial number.

You will need to locate the model and serial number for the mower and record the information in the spaces provided below.

DATE OF PURCHASE:

DEALER NAME:

DEALER PHONE:

PRODUCT SERIAL NUMBER (A):

<https://www.ebooklibonline.com>

Hello dear friend!

Thank you very much for reading.

Enter the link into your browser.

The full manual is available for immediate download.

<https://www.ebooklibonline.com>

Safety Labels

Safety Labels

Safety Label Location

60D AutoConnect Mower

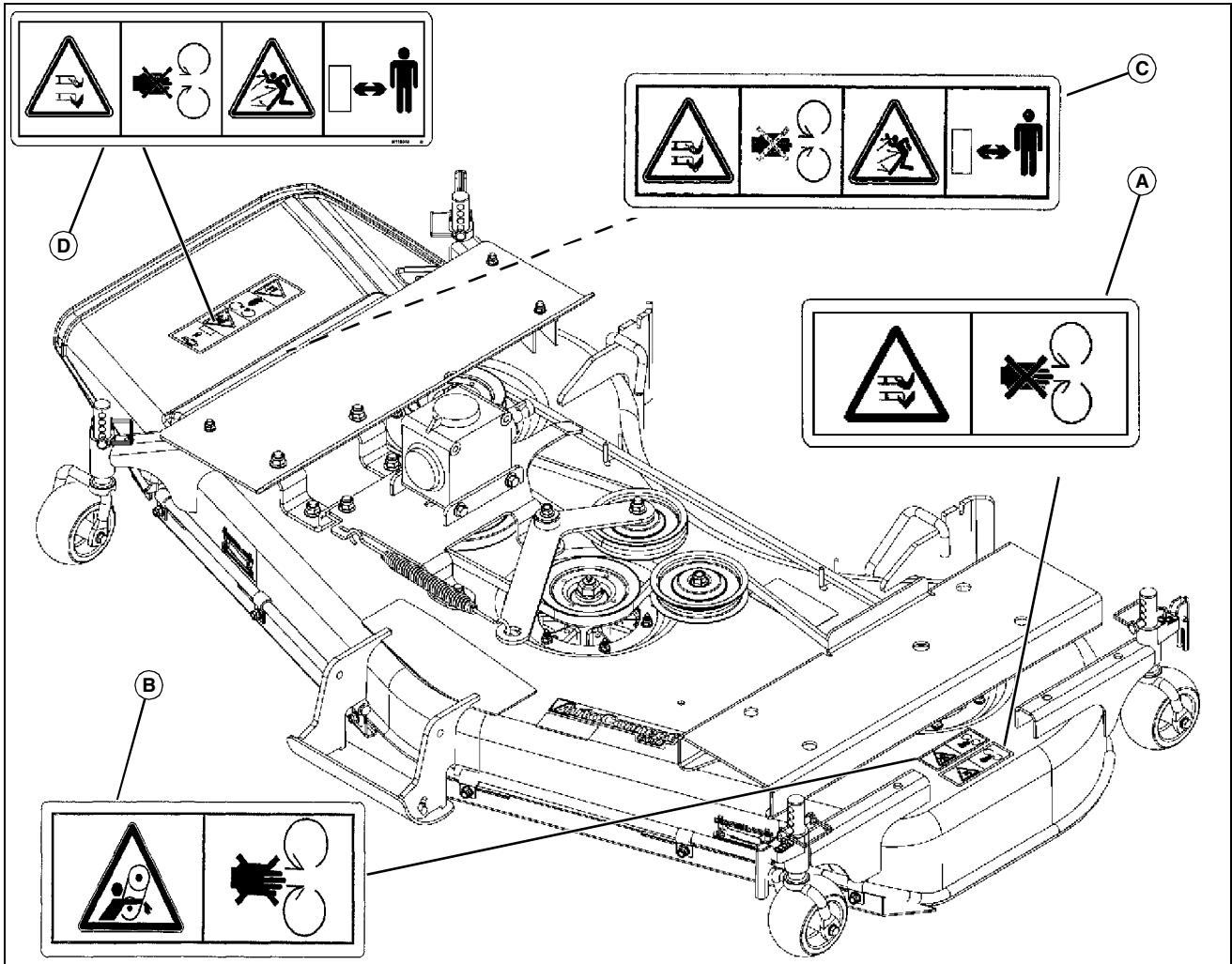

MX49647, M118040, M118041, M136436, M138631

Picture Note: Use label number listed in table below to locate complete text of safety label message following this illustration.

- A- Danger Blade Contact / Rotating Blade - M118041
- B- Danger Avoid Injury from Rotating Belt - M136436
- C- Danger Rotating Blade and Thrown Objects - M138631
- D- Danger Rotating Blade and Thrown Objects - M118040

Safety Labels

72D AutoConnect Mower

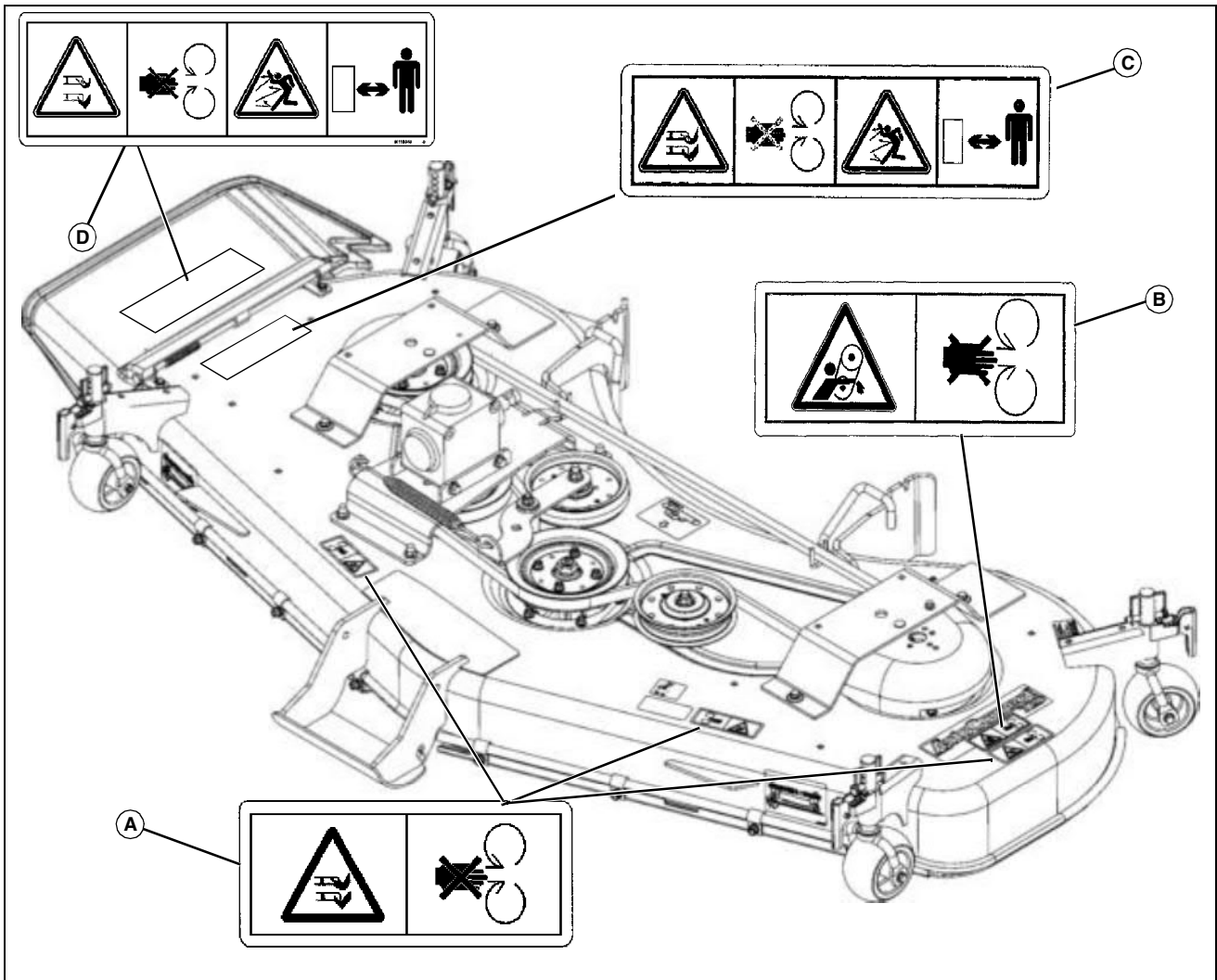

MX49648, M118040, M118041, M136436, M138631

Picture Note: Use label number listed in table below to locate complete text of safety label message following this illustration.

- A- Danger Blade Contact / Rotating Blade - M118041**
- B- Danger Avoid Injury from Rotating Belt - M136436**
- C- Danger Rotating Blade and Thrown Objects - M138631**
- D- Danger Rotating Blade and Thrown Objects - M118040**

Avoid Injury From Rotating Blades - M118041

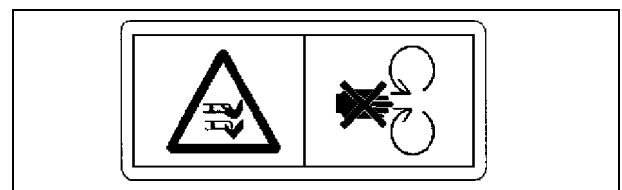

M118041

- Do not put hands or feet under or into mower when engine is running.
- Do not operate mower without discharge chute or entire grass catcher in place.



Pictorial Safety Signs

At several important places on this machine safety signs are affixed intended to signify potential danger. The hazard is identified by a pictorial in a warning triangle. An adjacent pictorial provides information how to avoid personal injury.

These safety signs, their placement on the machine and a brief explanatory text are shown in this Safety section.

There can be additional safety information contained on parts and components sourced from suppliers that is not reproduced in this operator's manual.

Safety

Avoid Injury From Getting Caught in Belt - M136436

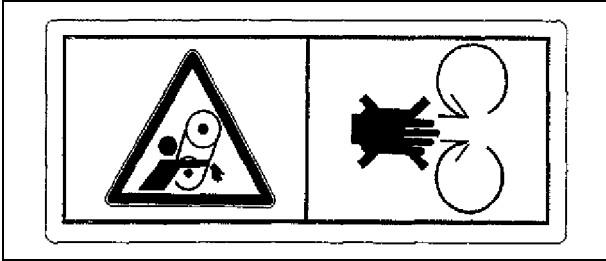

M136436

- Stay clear of belts.
- Do not operate mower without shields in place.

Avoid Injury From Rotating Blades and Thrown Objects - M138631

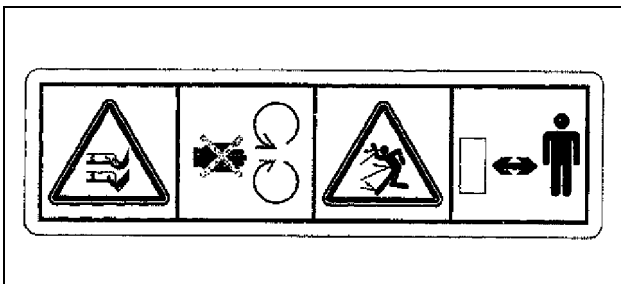

M138631

- Do not put hands or feet under or into mower when engine is running.
- Do not operate mower without discharge chute or entire grass catcher in place.
- Before mowing, clear area of objects that may be thrown by blade.
- Stay clear while engine is running.

Avoid Injury From Rotating Blades and Thrown Objects - M118040

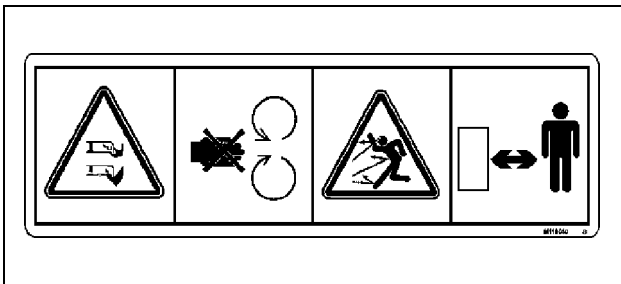

M118040

- Do not put hands or feet under or into mower when engine is running.
- Do not operate mower without discharge chute or entire grass catcher in place.
- Before mowing, clear area of objects that may be thrown by blade.
- Stay clear while engine is running.

CE Certification and Specification Label



LVU23051

Picture Note: For 60D Mower Deck

- This label on your machine indicates that this model has been certified and is in compliance with European Directive 98/37EEC (89/392EEC) Standards.

CE Certification and Specification Label

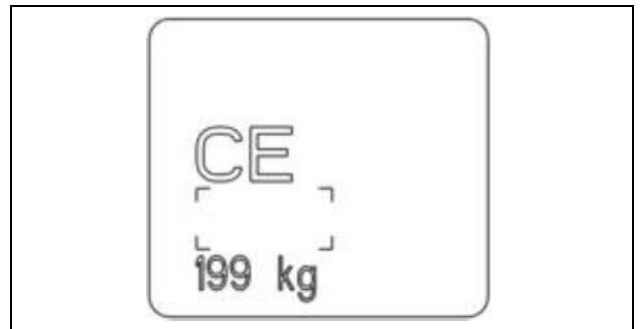

LVU23052

Picture Note: For 72D Mower Deck

- This label on your machine indicates that this model has been certified and is in compliance with European Directive 98/37EEC (89/392/EEC) Standards.

Safety

Read Safety in Machine Operator's Manual

Read the general safety operating precautions in your machine operator's manual for additional safety information.

Training

- Read the instructions carefully. Be familiar with the controls and the proper use of the equipment.
- Never allow children or people unfamiliar with these instructions to use the lawnmower. Local regulations can restrict the age of the operator.
- Never mow while people, especially children, or pets are nearby.
- Keep in mind that the operator or user is responsible for accidents or hazards occurring to other people or their property.
- Do not carry passengers.

Preparation

- While mowing, always wear substantial footwear and long trousers. Do not operate the equipment when barefoot or wearing open sandals.

Safety

- Thoroughly inspect the area where the equipment is to be used and remove all objects which can be thrown by the machine.
- Before using, always visually inspect to see that the blades, blade bolts and cutter assembly are not worn or damaged. Replace worn or damaged blades and bolts in sets to preserve balance.
- On multi-bladed machines, take care as rotating one blade can cause other blades to rotate.

Operation

- Do not operate the engine in a confined space where dangerous carbon monoxide fumes can collect.
- Mow only in daylight or in good artificial light.
- Before attempting to start the engine, disengage all blade attachment clutches and shift into neutral.
- Remember there is no such thing as a safe slope. Travel on grass slopes requires particular care. To guard against overturning:
 - never mow across the face of a slope, unless the machine is designed for this purpose.
- Stop the blades from rotating before crossing surfaces other than grass.
- Never direct discharge of material toward bystanders nor allow anyone near the machine while in operation.
- Never operate the machine with defective guards, or without safety protective devices in place.
- Do not change the engine governor settings or overspeed the engine. Operating the engine at excessive speed can increase the hazard of personal injury.
- Before leaving the operator's position:
 - disengage the drive to any attachments and lower them;
 - change into neutral and lock the parking brake;
 - stop the engine and remove the key.
- Disengage drive to attachments, stop the engine, disconnect the spark plug wires and remove the ignition key:
 - before clearing blockages or unclogging chute;
 - before checking, cleaning, or working on the machine;
 - after striking a foreign object. Inspect the machine for damage and make repairs before restarting and operating the equipment;
 - if the machine starts to vibrate abnormally (check immediately).
- Disengage drive to attachments when transporting or not in use.
- Stop the engine and disengage drive to attachment:
 - before refueling;
 - before removing the grass catcher;
 - before making height adjustment unless adjustment can be made from the operator's position.
- Reduce the throttle setting during run-out and, if the engine is provided with a shut-off valve, turn the fuel off at the conclusion of mowing.
- Inspect machine before you operate. Repair or replace damaged, badly worn, or missing parts. Make any necessary adjustments before you operate.
- Do not operate mower without discharge chute or entire grass catcher in place. Never operate with the discharge deflector raised, removed, or altered, unless using a grass catcher.
- Stop machine if anyone enters the area.

- Use only accessories and attachments approved by the manufacturer of the machine. Keep safety labels visible when installing accessories and attachments.
- Never raise mower decks when blades are running.

Maintenance and Storage

- Keep all nuts, bolts and screws tight to be sure the equipment is in safe working condition.
- Never store the equipment with fuel in the tank inside a building where fumes can reach an open flame or spark.
- Allow the engine to cool before storing in any enclosure.
- To reduce the fire hazard, keep the engine, silencer, battery compartment and fuel storage area free of grass, leaves, or excessive grease.
- Check the grass catcher frequently for wear or deterioration.
- Replace worn or damaged parts for safety.
- If the fuel tank has to be drained, this should be done outdoors.
- On multi-bladed machines, take care as rotating one blade can cause other blades to rotate.
- When machine is to be parked, stored or left unattended, lower the cutting means unless a positive mechanical lock is used.
- Use jack stands or lock service latches to support components when required. Securely support any machine elements that must be raised for service work.
- Before servicing machine or attachment, carefully release pressure from any components with stored energy, such as hydraulic components or springs.
- Release hydraulic pressure by lowering attachment or cutting units to the ground or to a mechanical stop and move hydraulic control levers back and forth.
- Disconnect battery or remove spark plug (for gas engines) before making any repairs. Disconnect the negative terminal first and the positive last. Reconnect positive first and negative last.
- Use care when checking blades. Wrap the blades or wear gloves, and use caution when servicing them. Only replace blades. Never straighten or weld them.
- Keep hands, feet, clothing, jewelry and long hair away from moving parts. If possible, do not make adjustments with the engine running.
- Charge batteries in an open well ventilated area, away from spark and flames. Unplug charger before connecting or disconnecting from battery. Wear protective clothing and use insulated tools.

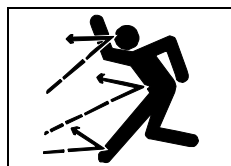

Checking Mowing Area

- Clear mowing area of objects that might be thrown. Keep people and pets out of mowing area.
- Low-hanging branches and similar obstacles can injure the operator or interfere with mowing operation. Before mowing, identify potential obstacles such as low-hanging branches, and trim or remove those obstacles.
- Study mowing area. Set up a safe mowing pattern. Do not mow where traction or stability is doubtful.
- Test drive area with mower lowered but not running. Slow down when you travel over rough ground.

Safety

Parking Safely

1. Stop machine on a level surface, not on a slope.
2. Disengage PTO and stop attachments.
3. Lower attachments to the ground.
4. Lock park brake.
5. Stop engine.
6. Remove key.
7. Wait for engine and all moving parts to stop before you leave the operator's station.
8. Close fuel shut off valve before servicing the fuel system, if your machine is equipped.
9. Disconnect the battery ground cable before making repairs to electrical system or doing any welding.

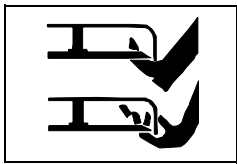

Rotating Blades are Dangerous

HELP PREVENT SERIOUS OR FATAL ACCIDENTS:

- Rotating blades can cut off arms and legs, and throw objects. Failure to observe safety instructions could result in serious injury or

death.

- Keep hands, feet and clothing away from mower deck when engine is running.
- Be alert at all times, drive forward carefully. People, especially children can move quickly into the mowing area before you know it.
- Do not mow in reverse.
- Shut off blades when you are not mowing.
- Park machine safely before leaving the operator station for any reason including emptying the catchers or unplugging the chute.

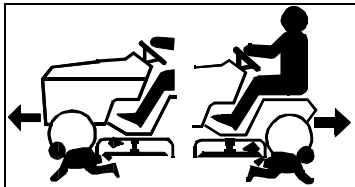

Protect Children

- Death or serious injury can occur when young children associate having fun with a lawn mowing machine simply because someone has given them a ride on a machine.

- Children are attracted to lawn mowing machines and mowing activities. They don't understand the dangers of rotating blades or the fact that the operator is unaware of their presence.
- Children who have been given rides in the past may suddenly appear in the mowing area for another ride and be run over or backed over by the machine.
- Tragic accidents with children can occur if the operator is not alert to the presence of children, especially when a child approaches a machine from behind. Before and while backing up, stop mower blades and look down and behind the machine carefully, especially for children.
- Never carry children on a machine or attachment, even with the blades off. Do not tow children in a cart or trailer. They can fall off and be seriously injured or interfere with safe machine operation.
- Never use the machine as a recreational vehicle or to entertain children.
- Never allow children or an untrained person operate the machine. Instruct all operators not to give children a ride on the machine or in an attachment.
- Keep children indoors, out of the mowing area, and in the watchful eye of

a responsible adult, other than the operator, when a mower is being operated.

- Stay alert to the presence of children. Never assume that children will remain where you last saw them. Turn the machine off if a child enters the work area.
- Use extreme care when approaching blind corners, shrubs, trees, or other objects that may block your view of a child.



Stay Clear of Rotating Drivelines

Entanglement in rotating driveline can cause serious injury or death.

- Wear close fitting clothing.
- Stop the engine and be sure PTO driveline is stopped before getting near it.

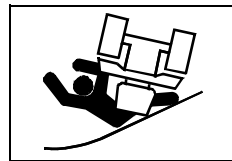

Avoid Tipping

Slopes are a major factor related to loss-of-control and tip-over accidents, which can result in severe injury or death. Operation on all slopes requires extra caution.

- Be aware that mechanical front wheel drive (MFWD) can improve access to dangerously sloped terrain, thereby increasing the possibility of a tipover.
- Drive up and down a hill - not across.
- Watch for holes, ruts, bumps, rocks, or other hidden objects. Uneven terrain could overturn the machine. Tall grass can hide obstacles.
- Do not operate machine on wet grass. Tires may lose traction. Tires may lose traction on slopes even though the brakes are functioning properly.
- Choose a low ground speed so you will not have to stop or shift while on a slope.
- Always keep the machine in gear when going down slopes. Do not shift to neutral and coast downhill.
- Avoid starting, stopping or turning on a slope. If the tires lose traction, disengage the blades and proceed slowly, straight down the slope.
- Keep all movement on slopes slow and gradual. Do not make sudden changes in speed or direction, which could cause the machine to roll over.
- Do not operate machine near drop-offs, ditches, embankments, or bodies of water. The machine could suddenly roll over if a wheel goes over the edge or the edge caves in. Leave a safety area between the machine and any hazard.
- Danger of tipping is increased greatly with tires in narrow tread setting and driving at high speed.
- Follow the manufacturer's recommendations for wheel weights or counterweights for added stability when operating on slopes or using front or rear mounted attachments. Remove weights when not required.

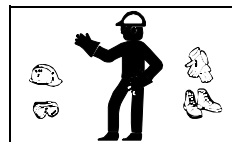

Wear Appropriate Clothing

Always wear safety goggles, or safety glasses with side shields, and a hard hat when operating the machine.

- Wear close fitting clothing and safety equipment appropriate for the job.
- While operating this machine, always wear substantial footwear and long trousers. Do not operate the equipment when barefoot or wearing open sandals.
- Wear a suitable protective device such as earplugs. Loud noise can

Assembly

cause impairment or loss of hearing.

Assembly

Parts in Lift Kit

NOTE: Some parts are installed on tractor, and others are installed on mower.

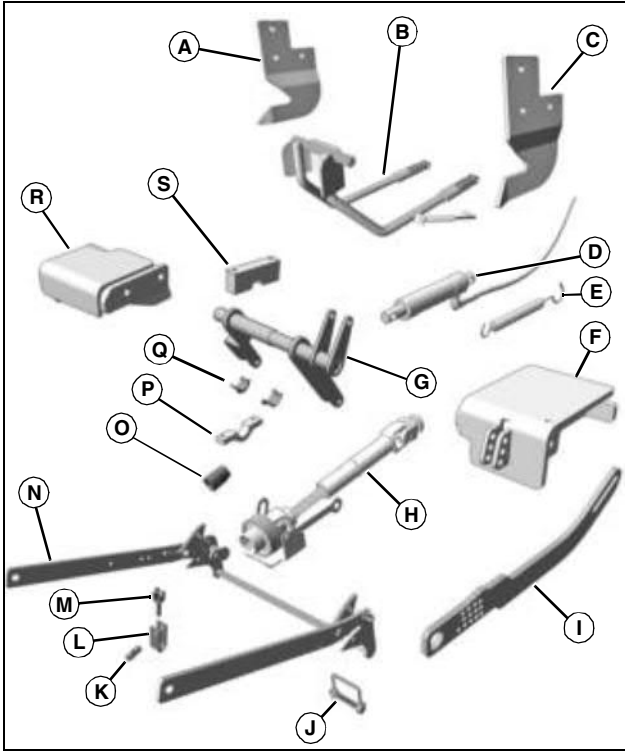

MX27199

Qty.	Description
1	Right Hanger (A)
1	**Forward Lift Link (B)
1	Left Hanger (C)
1	Cylinder (D)
1	Spring (E)
1	Left Bracket (F)
1	Mid Rockshaft (G)
1	Bearing Assembly (H)
1	Height Adjust Link (I)
2	Snap Lock Pin Assembly (J)
2	Link Pin (K)
2	U-Bracket (L)
2	Adjustable Yoke (M)

Qty.	Description
1	Rear Lift Link (N)
1	**Coupler, Male (O)
2	Half Clamp (P)
2	Rockshaft Bushing (Q)
1	Right Bracket (R)
2	Block Clamp (S)
1	**Set Screw, M8x8
2	Clevis
2	Drilled Pin
6*	Flange Head Bolt, M12x65
6*	Flange Head Bolt, M12x45
12	Locknut, M12
1	Hex Socket Head Bolt, M12x30
3	Hex Head Bolt, M12x30
4	Hex Head Bolt, M12x90
1	Pin, Cylinder to Rockshaft
1	Clevis Pin, M12x70
4	Washer, 1/2
3	Cotter Pin
4	Bushing
4	Flange Head Bolt, M12x50
2	Drilled Pin, M12x35
2	Locking Ring

* Quantity used will depend on tractor with grille guard application.

** Parts will be installed on mower deck.

Assemble Mower

Install Wheels

NOTE: 60D mower includes two offset wheels which are to be installed on right side of mower; 72D mower wheels are all the same.



CAUTION: Avoid injury! Machine component or attachment is heavy. Use a safe lifting device with correct load capacity rating to lift, install or remove component or attachment.

1. Remove mower from crate using chain hoist or other suitable device.

2. 60D Mower:

Assembly

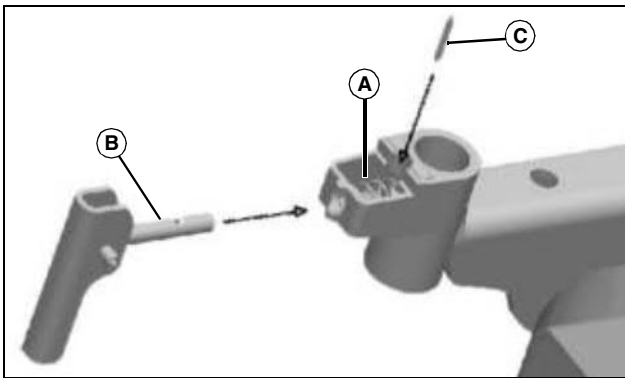

MX27138

Picture Note: 60D mower left rear wheel area shown.

- Install spring (A) in bracket as shown.
- Push wheel lock assembly (B) into bracket.
- Install roll pin (C) to secure wheel lock assembly.

NOTE: After wheels are installed, it may be necessary to lock wheels by pressing downward on handles (A) until they are perpendicular to ground. However, wheels must be in the unlocked position before installing mower on tractor.

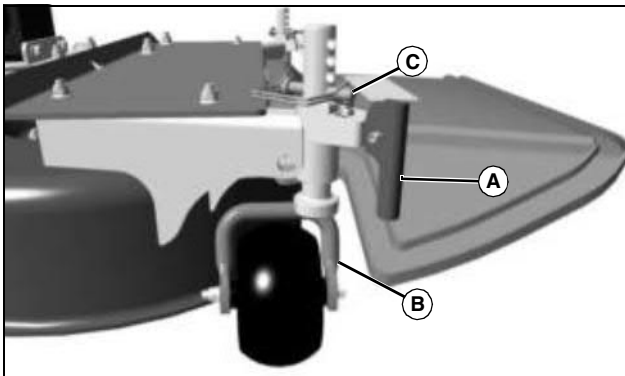

MX27127

Picture Note: 60D mower offset wheels shown installed on right side of mower.

3. Install wheels (B) by sliding wheel shaft up through wheel bracket.
4. Install spring pin (C) in each wheel.

Install Discharge Chute

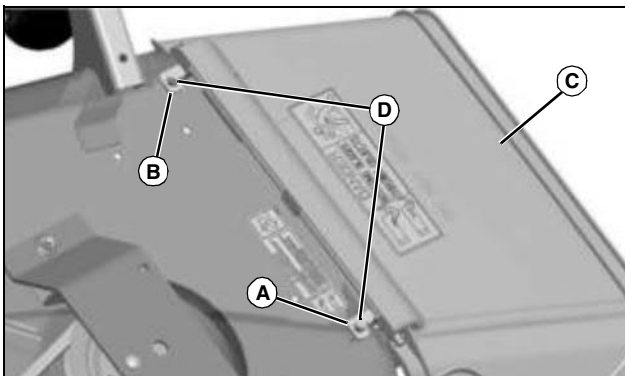

MX49646

Picture Note: 72D mower shown.

1. Attach rear hinge (A) to deck with nut. Do not tighten.

2. Pre-load spring with one hand and attach front hinge (B) to deck with nut. Do not tighten.
3. Pull chute assembly (C) away from deck as nuts (D) are tightened to help align hinges.

Install Mower Lift Kit

Install Forward Lift Link on Mower Deck

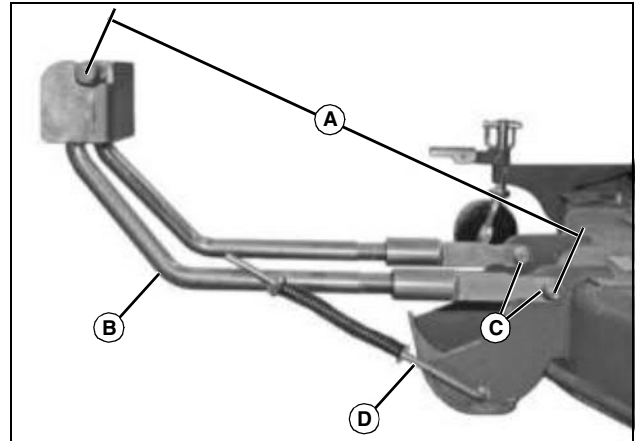

MX27187

1. Measure distance (A) from center of horizontal frame to center of bolt. Distance (A) should be 599 mm (23.6 in.).
2. Secure forward lift link (B) to mower deck with two M12x50 flange head bolts and two locknuts (C). Adjust as necessary to obtain correct distance before tightening locknuts completely.
3. Insert end of rod (D) in slot with front link raised so spring is fully extended.

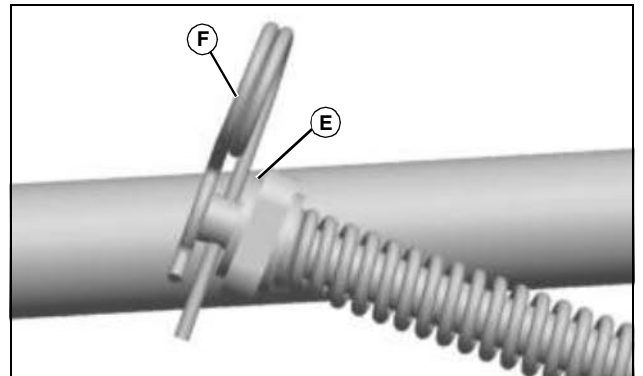

MX27128

4. Tractors with loader installed: Loader components may hit forward link when removing mower. During initial set up, add washers (E) as needed to prevent contact with loader components.

- a. Remove hair pin (F) from top of rod.
- b. Add washers (E) as needed to prevent contact with loader components.
- c. Install hair pin.

Assembly

Assemble Rear Lift Link

NOTE: If installing kit on tractor with cab, a lock (A) and roll pin (B) must be ordered separately.

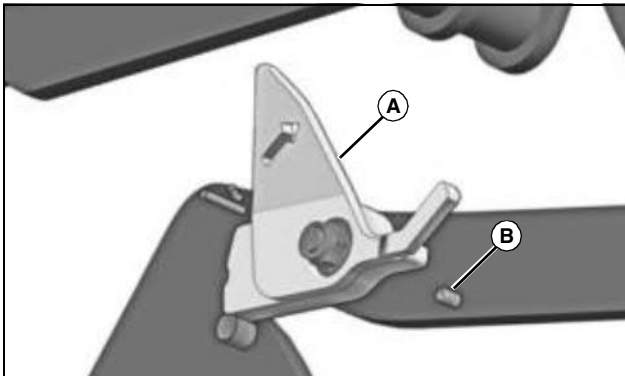

MX27200

Picture Note: Image shown from inside of rear lift link. Lock is show in the install/locked position.

1. Tractors with cab: Replace lock on left side of rear link with new lock (A). Push roll pin in from outside of rear lift link. Roll pin should clear sheet metal tab on new lock.

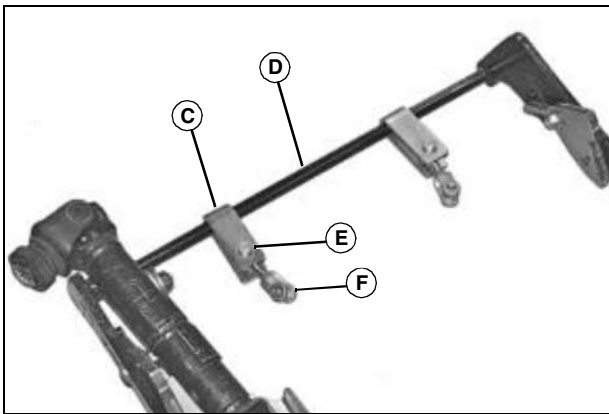

MX27108

2. Install two U-brackets (C) on rear lift link (D) with two link pins (E) and adjustable yokes (F).

Install Hangers (Tractors without Front Hitch)

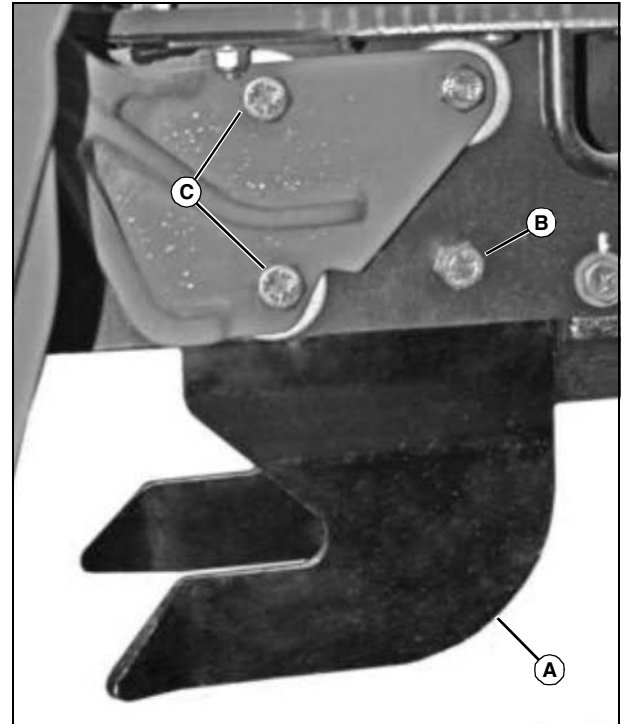

MX27109

Picture Note: Hangers shown on tractor with grille guard.

1. Tractor with grille guard:
 - a. Install left hanger (A) on inside of tractor frame with one M12x45 flange head bolt (B), two M12x65 flange head bolts (C) and three M12 locknuts.
 - b. Install right hanger.
2. Tractor without grille guard:
 - a. Install left hanger (A) on inside of tractor frame with three M12x45 flange head bolts (B and C) and M12 locknuts.
 - b. Install right hanger.
3. Push bottom of hangers fully rearward and tighten hardware to 130 N•m (96 lb-ft).

Install Hangers (Tractors with Front Hitch)

NOTE: Hangers included in this kit are intended for use on tractors without front hitch. If kit is being installed on tractor with front hitch, different hangers must be purchased and installed. See your John Deere Dealer.

1. Fully lower front hitch using hydraulics.
2. Completely close flow valve.
3. Disconnect front hitch hoses from SCV and tie out of way.

Assembly

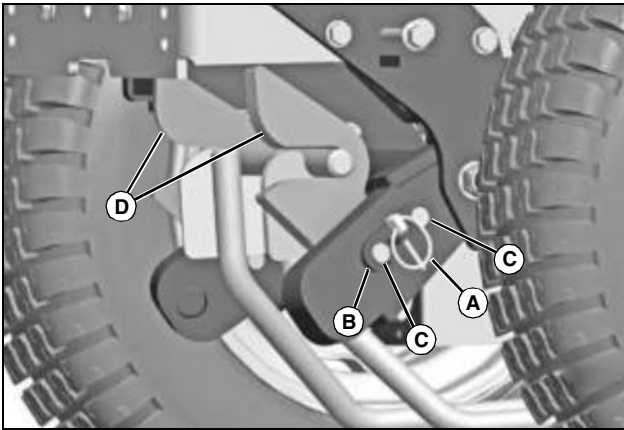

MX27228

4. Remove locking rings (A) securing hitch arms to front hitch structure.
5. Pull brackets (B) and pins (C) out enough to insert new hangers (D).
6. Push pins (C) through holes in hangers and replace locking rings (A).

Install Brackets

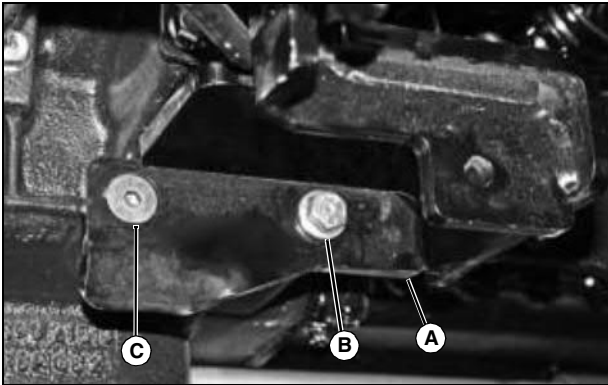

MX27110

1. Install right bracket (A) on tractor with one M12x30 hex head bolt (B) and one M12x30 hex socket head bolt (C). Push bracket fully forward and tighten hardware.

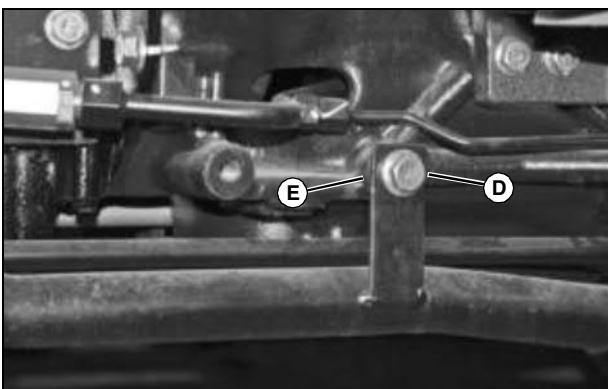

MX27111

2. Remove bolt (D) and spacer (E) from suction side filtration tube at left side of tractor.

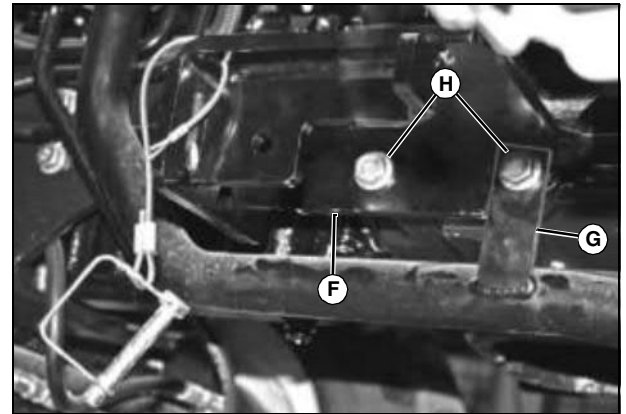

MX27112

3. Slide edge of right bracket (F) behind tab (G). Push bracket fully forward and secure with two M12x30 hex head bolts (H).

Install Mid Rockshaft

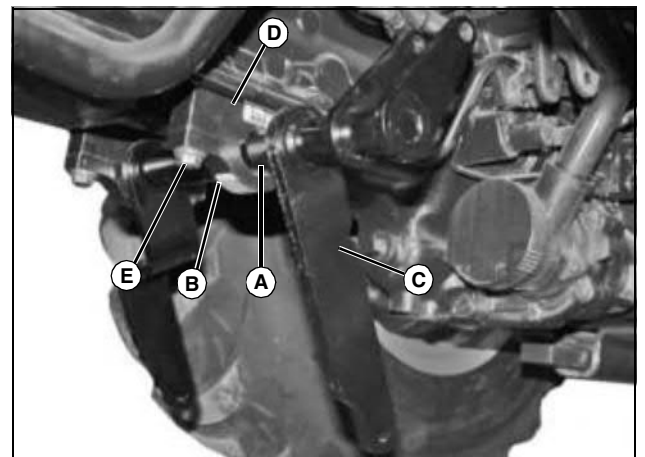

MX27113

1. Position rockshaft bushings (A) with flange end facing centerline of tractor, and between half clamp (B) and mid rockshaft (C).
2. Position block clamp (D) on top of mid rockshaft and install all parts to tractor with four M12x90 hex head bolts (E).
3. Tighten bolts to 130 N•m (96 lb-ft).

Install Height Adjust Link

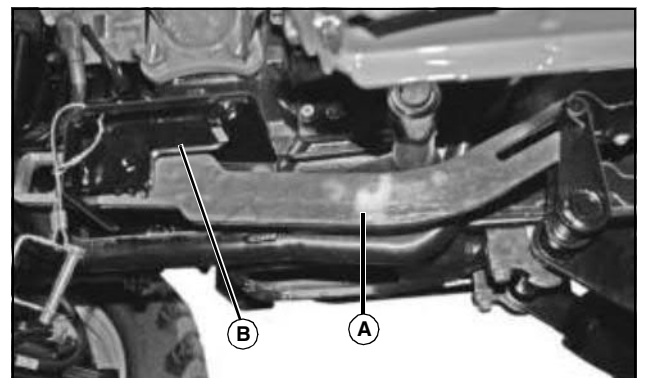

MX27114

1. Slide height adjust link (A) in left bracket (B).

Assembly

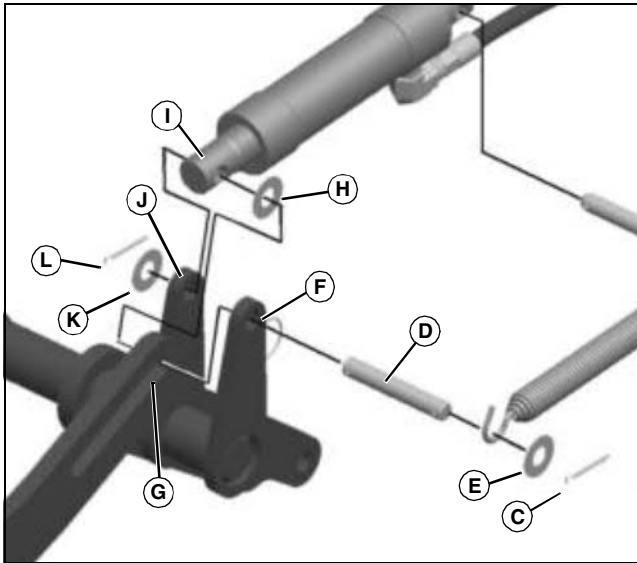

MX27225A

2. Install cylinder rod end and height lock link to rockshaft. Insert cotter pin (C) into end of rockshaft pin (D). Push pin through washer (E), first arm of rockshaft (F), slot in height lock link (G), washer (H), rod end of cylinder (I), second arm on rockshaft (J) and final washer (K). Secure with cotter pin (L). Make sure washers are installed as shown.

NOTE: If installing lift kit on tractor with cab, a separate bracket must be purchased before cylinder can be installed.

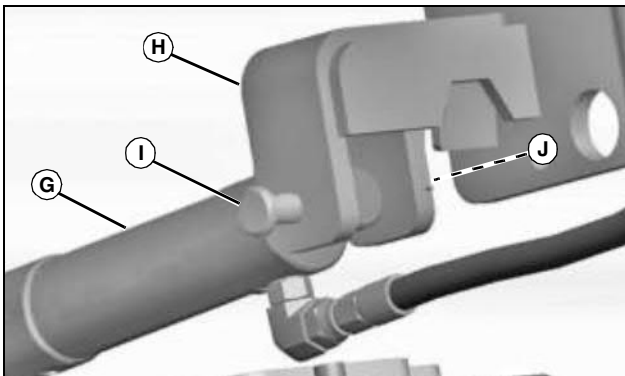

MX27226

3. Tractor with cab: Attach head end of cylinder (G) to bracket (H) with M12x70 drilled pin (I) and locking ring (J).

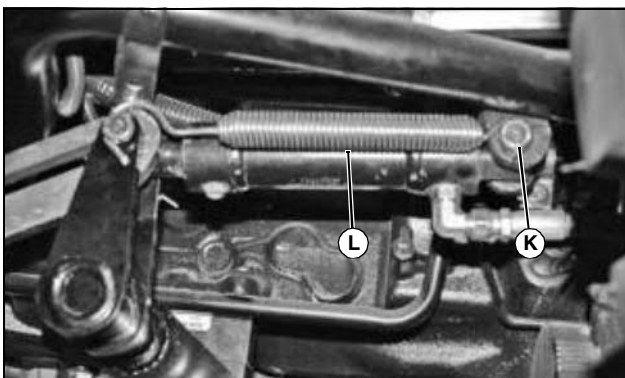

MX27115

4. Secure other end of cylinder with M12x70 drilled pin (K), washer and cotter pin.

5. Install spring (L) with spring rotation down.

Complete Installation of Lift Kit

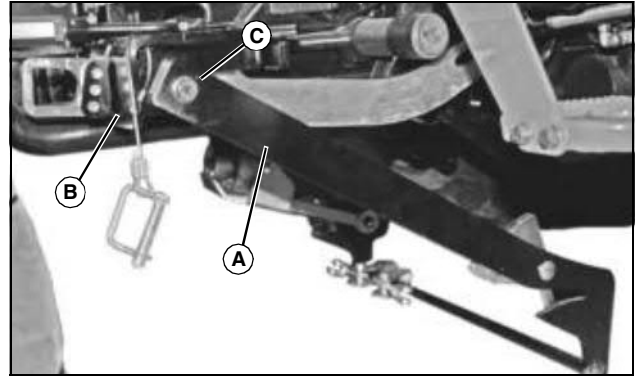

MX27116

1. Secure rear lift link (A) to left bracket (B) with one M12x50 flange bolt, one bushing and one M12 locknut (positioned at outside of lift link) (C).

2. Secure rear lift link to right bracket.

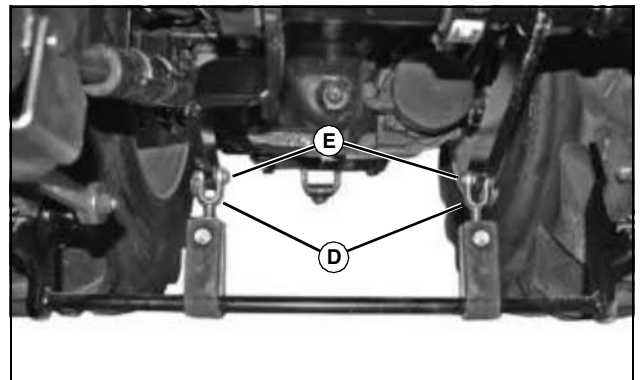

MX27117

3. Attach adjustable yokes (D) to mid rockshaft with two M12x35 drilled pins (E) and locking rings.

4. Install mid PTO shaft.

5. Either route hydraulic cylinder hose to rear of tractor and attach to third SCV, or attach it to curl circuit on dual SCV.

6. Install one hair pin in rear hole on right arm of rear lift link. Install hair pin in hole in left bracket.

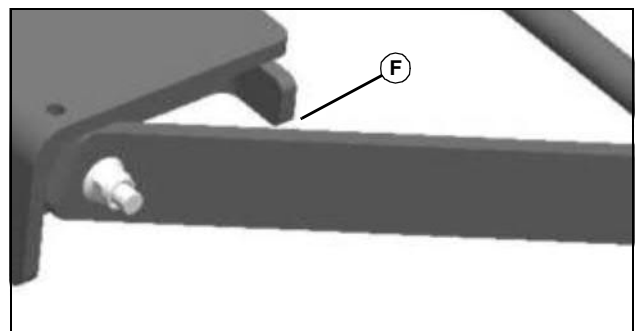

MX27132

7. Start tractor and slowly raise lift system. Arms of rear link should clear up-stops at rear of brackets mounted on transmission by 1-2 mm (0.04 - 0.08 in.) (F).

Installing

Installing

Preparing Machine

Required Equipment

- Tractor Mid-PTO
- Mower Lift Kit

Machine Setup

1. Park machine safely. (See Parking Safely in SAFETY.)
2. Follow machine operator's manual instructions to check tire pressure.
3. Follow instructions in ASSEMBLY in this manual.

Installing Mower

Prepare Tractor and PTO Coupler

1. Raise lift system fully.
2. Remove pin from height lock.
3. Lower lift system fully.
4. Remove snap lock pin from coupler support and make sure support drops completely.

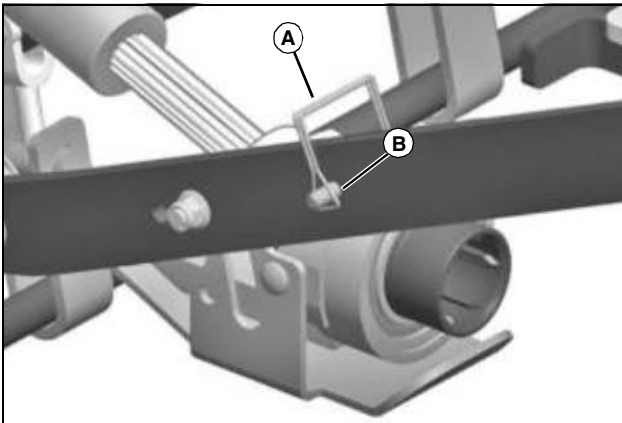

MX27224

5. Place pins (A) in forward storage holes (B) in lift link.

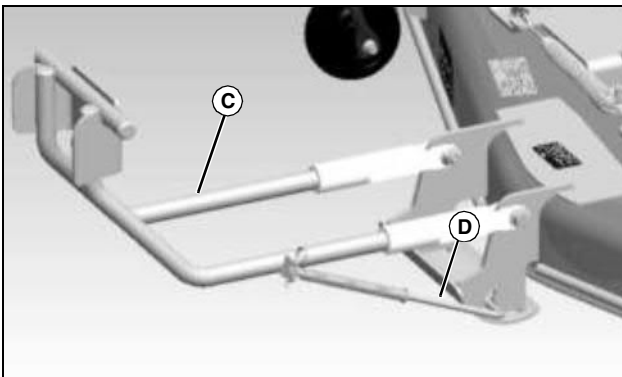

MX27133

6. Make sure front link (C) of mower is unfolded from top of deck and spring rod (D) is inserted in slot at front of deck.

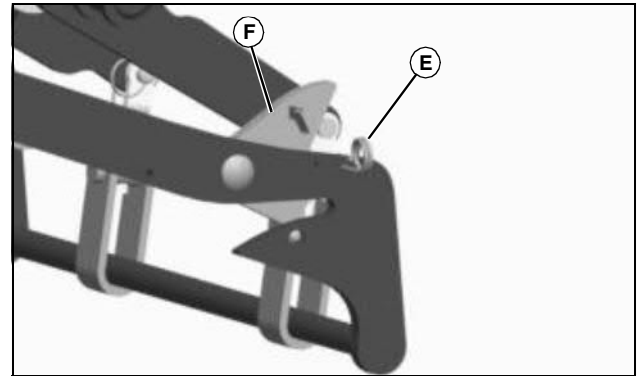

MX27135a

7. Hair pins (E) should be in the storage position and locks (F) should be in the install/locked position.

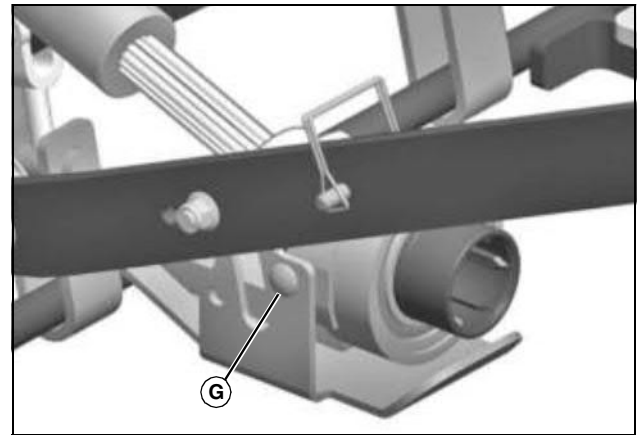

MX27224

8. For initial installation of mower deck, ensure that carriage bolts (G) on PTO coupler support are snug, but allow limited pivoting of PTO coupler.
9. Adjust PTO coupler so that it is parallel with lower plate of coupler support.

Attach Mower Deck to Tractor

1. Ensure that deck is sitting on firm, level ground. An extremely smooth surface can allow deck to be pushed along by tractor.

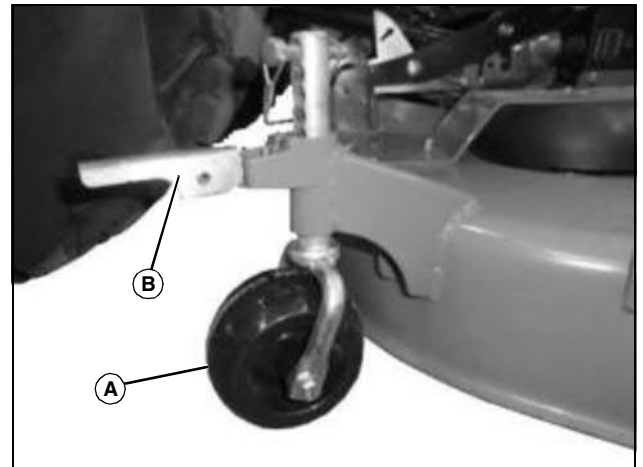

MX49649

2. Ensure that all four mower deck gage wheels (A) are in unlocked



Suggest:

If the above button click is invalid.

Please download this document

first, and then click the above link

to download the complete manual.

Thank you so much for reading

Installing

position, with handles (B) parallel to ground. Deck should be resting fully on ground.

3. Place tractor in A range four wheel drive.

4. Drive tractor onto mower deck:

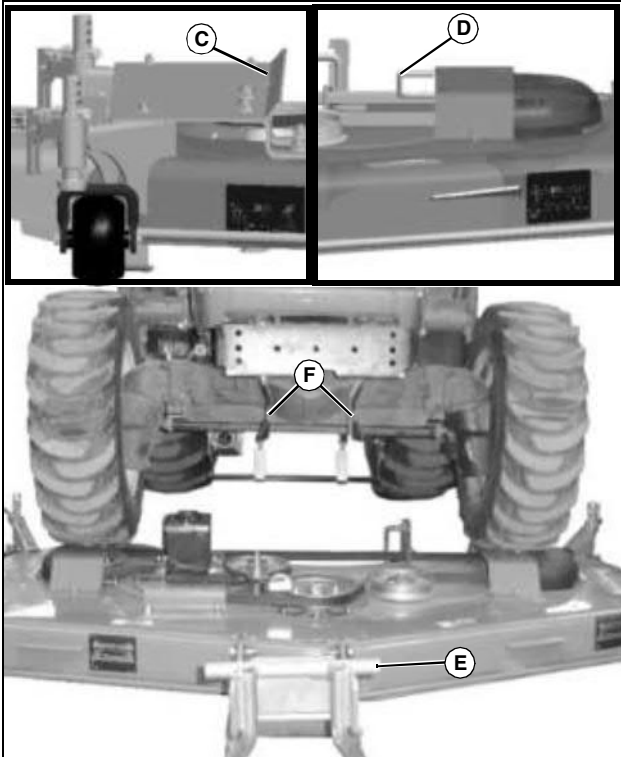

MX49651, MX28370, MX28371

NOTE: Driver should concentrate on the side of the tractor indicated in the instructions and should not look back and forth from one side to the other. while driving over mower deck. Drive forward smoothly.

- 60 D mower: Drive tractor up to mower deck with right front tire aligned approximately 1/2-in. from angled edge (C) of right drive over ramp.
- 72 D mower: Drive tractor up to mower deck with left front tire aligned approximately 1/2-in. from wire form (D) on left drive over ramp.

5. Drive tractor slowly, smoothly and straight over mower deck making sure forward lift link (E) aligns hangers (F).

6. If mower deck pulls forward early or appears to be caught in lift system, stop tractor, reverse slightly and move forward again. If mower deck still does not properly attach, stop tractor, lock park brake, dismount tractor and determine cause of problem.

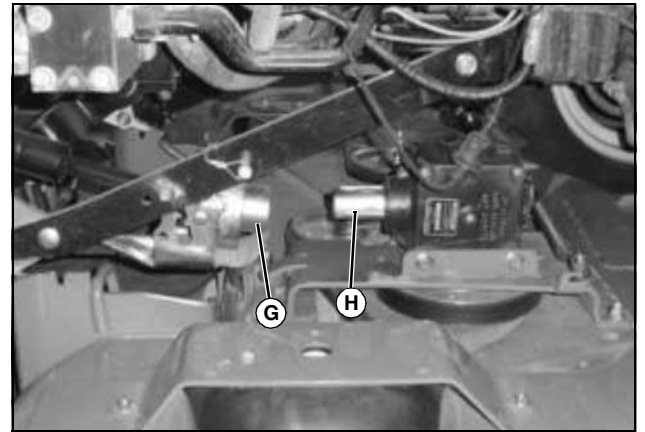

MX49652

7. PTO coupler (G) will align with gear box coupler (H).

8. Continue to slowly drive tractor forward until mower begins to pull along ground approximately 102 mm (4 inches) behind front wheels.



MX49653

9. Dismount tractor and ensure locks (I) on both sides have dropped to locked position shown. Mower may sometimes have to be pulled rearward slightly to engage lock. On first installation, mower may not lock in position if front link is too short.

10. Install hair pins in locked position.

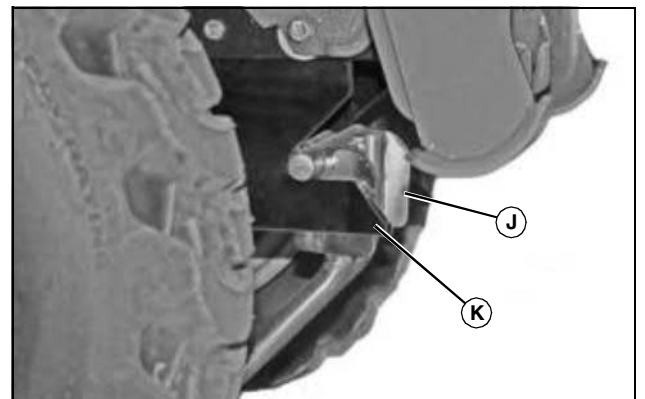

MX27186

11. Make sure forward lift link (J) is nested into hangers (K).

<https://www.ebooklibonline.com>

Hello dear friend!

Thank you very much for reading.

Enter the link into your browser.

The full manual is available for immediate download.

<https://www.ebooklibonline.com>