

GREAT **DANE**[™]

Rear Bagger and POWER FLOW[™]



14-Bushel

**OMTCU19544 B4
OPERATOR'S MANUAL**

INTRODUCTION

North American Version
Litho in U.S.A.

DANGER

Introduction

Using Your Operator's Manual

This manual is an important part of your machine and should remain with the machine when you sell it.

Use the safety and operating information in the attachment operator's manual along with the machine operator's manual to operate and service the attachment safely and correctly.

Specifications and design are subject to change without notice.

Product Identification

Product Compatibility

The Power Flow and 14-Bushel Rear Bagger are compatible with the Chariot LX with 61-inch mower and Chariot with 48, 52 and 61-inch mowers.

Record Purchase Information

Record your purchase information in the spaces provided below.

DATE OF PURCHASE:

DEALER NAME:

DEALER PHONE:

Safety

Understanding The Machine Safety Labels

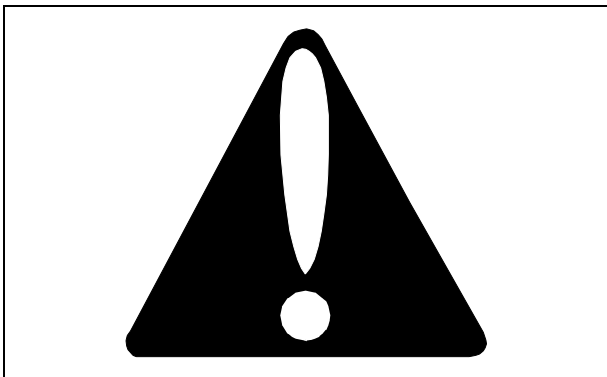

Safety-Alert Symbol

The machine safety labels shown in this section are placed in important areas on your machine to draw attention to potential safety hazards.

On your machine safety labels, the words DANGER, WARNING, and CAUTION are used with this safety-alert symbol. DANGER identifies the most serious hazards.

The operator's manual also explains any potential safety hazards whenever necessary in special safety messages that are identified with the word, CAUTION, and the safety-alert symbol.

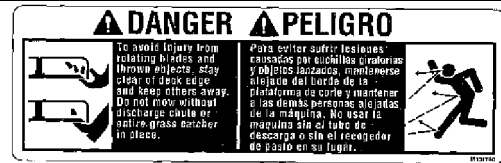

M131748, MX31129

To avoid injury from rotating blades and thrown objects, stay clear of deck edge and keep others away. Do not mow without discharge chute or entire grass catcher in place.

DANGER



M146238, MX31206

Bagger may impair rear vision, look down and behind before and while backing.

SAFETY

WARNING



TCU51051, MX31129

To avoid injury from rotating belts, keep all shields and guards in place.

WARNING: Rotating Blade-Thrown Objects



M118454, MX31129

Operate blower with entire grass catcher secured in place.

WARNING



M146356, MX31206

To avoid injury from thrown objects, keep bystanders away. Shut off engine before opening hopper top. Keep chutes in place. Never allow riders on hopper top or on frame.

CAUTION

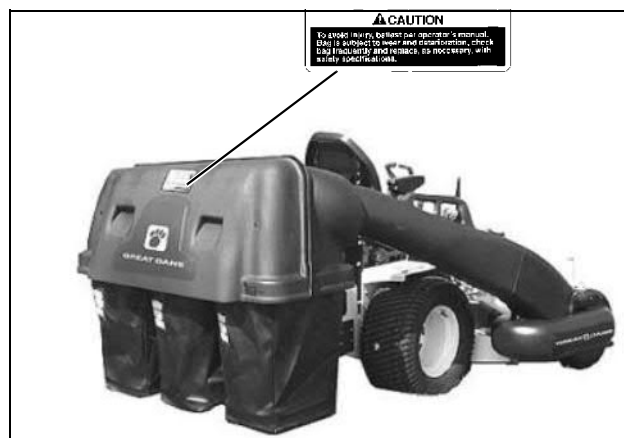

M146356, MX31206

To avoid injury, ballast per operator's manual. Bag is subject to wear and deterioration, check bag frequently and replace, as necessary, with a bag that complies with safety specifications.

<https://www.ebooklibonline.com>

Hello dear friend!

Thank you very much for reading.

Enter the link into your browser.

The full manual is available for immediate download.

<https://www.ebooklibonline.com>

SAFETY

CAUTION



GC00215, MX31206

- Bag is subject to wear and deterioration.
- Check bag frequently and replace when necessary.
- Use a bag that complies with safety specifications.

Operating Safely

- Read the machine and attachment operator's manual carefully. Be thoroughly familiar with the controls and the proper use of the equipment. Know how to stop the machine and disengage the controls quickly.
- Do not let children or an untrained person operate machine.
- Never operate the machine without proper guards or other safety devices in place.
- Disengage all clutches and shift into neutral before starting the engine.
- Inspect machine before you operate and at frequent intervals while operating. Be sure hardware is tight. Repair or replace damaged badly worn, or missing parts.
- Make any necessary adjustments before you operate. Never attempt to make any adjustments while the engine is running, unless if recommended in adjustment procedure.
- Take all possible precautions when leaving the machine unattended. Shut off the engine before unplugging the attachment, or when making any repairs, adjustments, or inspections. Disengage the PTO, lower the attachment, lock the parking brake, stop the engine, and remove the key.
- Only operate during daylight or with good artificial light.
- Look behind machine before you back up. Back up carefully.
- Do not let anyone, especially children, ride on machine or attachment. Riders are subject to injury such as being struck by foreign objects and being thrown off. Riders may also obstruct the operator's view, resulting in the machine being operated in an unsafe manner.
- Do not operate machine when you are tired or ill or under the influence of drugs or alcohol.
- Never operate the machine at high transport speeds on slippery surfaces.
- Use only attachments and accessories approved by the manufacturer of this product.
- After striking a foreign object, stop the engine, remove the spark plug wire, thoroughly inspect the machine for any damage, and repair the damage before starting and operating the machine.
- Use extreme caution when operating on or near gravel drives, walks, or roads. Stay alert for hidden hazards or traffic.
- If the machine vibrates abnormally, stop the engine and check immediately for the cause. Vibration is generally a warning of trouble.

- Disengage any power to the attachment when the machine is transported or not in use.
- Do not wear radio or music headphones while operating the machine. Safe operation requires your full attention.
- Always refer to the Storage section of the operator's manual for important details if storing this product for a long period of time.

Avoid Injury From Thrown Objects

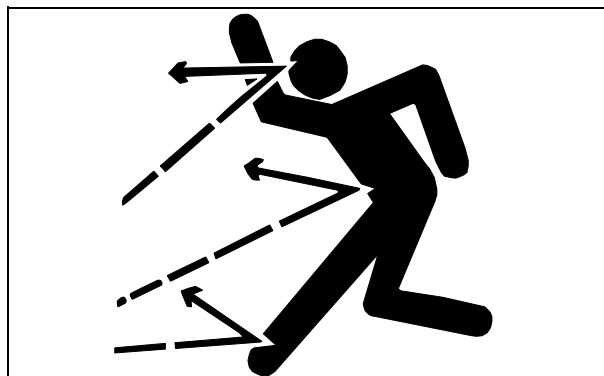

- When operating the vehicle with the attachment installed make sure all chutes and hoses are securely in place. Keep hopper top closed or MCS in operating position.
- Avoid injury from impeller blades and thrown objects. Remove attachment when operating vehicle in side discharge mode. Make sure deflector shield is in place on mower deck if attachment is removed.

Avoid Injury From Rotating Blades



MIF

- Do not put hands or feet near blower assembly when engine is running.
- Stop engine before you unplug the blower assembly.
- Do not operate the blower assembly unless entire grass catcher is fastened in place with hopper cover latched in the CLOSED position or the MCS is returned to the operating position.

Parking Safely

1. Stop machine on a level surface, not on a slope.
2. Move motion control levers to the neutral position.
3. Disengage mower blades.
4. Lower attachments to the ground.
5. Lock the park brake.

ASSEMBLY

6. Stop the engine.
7. Remove the key.
8. Wait for engine and all moving parts to stop before you leave the operator's seat.
9. Close fuel shut-off valve, if your machine is equipped.
10. Disconnect the negative battery cable or remove the spark plug wire (for gasoline engines) before servicing the machine.

Practice Safe Maintenance



- Only qualified, trained adults should service this machine.
- Understand service procedure before doing work. Keep area clean and dry.
- Do not operate the engine in a confined space where dangerous carbon monoxide fumes can collect.
- Never lubricate, service or adjust the machine or attachment while it is moving. Keep safety devices in place and in working condition. Keep hardware tight.
- Keep hands, feet, clothing, jewelry, and long hair away from any moving parts, to prevent them from getting caught.
- Lower any attachment completely to the ground or to an existing attachment mechanical stop before servicing the attachment. Disengage all power and stop the engine. Lock park brake and remove the key. Let machine cool.
- Disconnect battery or remove spark plug wire (for gasoline engines) before making any repairs.
- Before servicing attachment, carefully release pressure from any components with stored energy, such as hydraulic components.
- Securely support any machine or attachment elements that must be raised for service work. Use jack stands or lock service latches to support components when needed.
- Never run engine unless park brake is locked.
- Keep all parts in good condition and properly installed. Fix damage immediately. Replace worn or broken parts. Replace all worn or damaged safety and instruction decals.
- Check all hardware, including shear bolts, at frequent intervals to be sure the equipment is in safe working condition.
- Do not modify machine or safety devices. Unauthorized modifications to the machine or attachment may impair its function and safety.

Assembly

Identify Parts: Power Flow - 48 and 52 in.

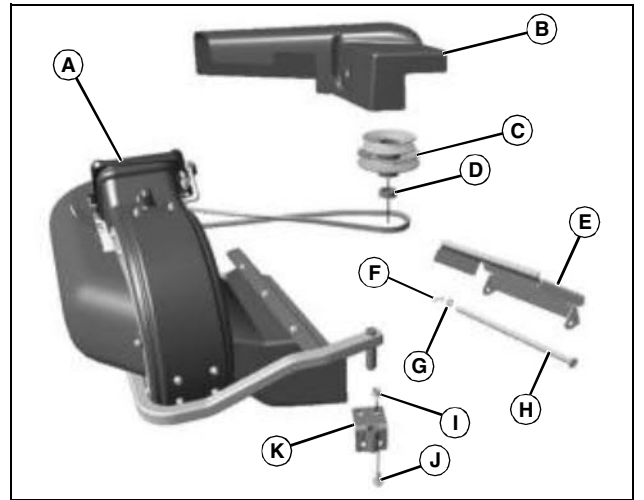

MX31268

Qty.	Description	Size
1	Hopper Assembly (A)	
1	Belt Cover (B)	
1	Double Sheave (C)	
1	Spacer (48 in. Deck) (D)	
1	Block Off Plate (E)	
1	Cotter Pin (F)	
1	Washer (G)	
1	Pin (H)	
2	Locknut (I)	
2	Bolt (J)	
1	Support Bracket (K)	

Bag of Parts (48 in.):

Qty.	Description	Size
1	Label, Danger (Thrown Object)	
1	Label, Danger	
1	Label, No Step	
2	Locknut	M10
2	Screw, Hex Flange	M10x25
1	Pivot Pin	
1	Support, Deck Lift Linkage (Lower)	
1	Bolt	M8x35
2	Washer	10.5x30

ASSEMBLY

Qty.	Description	Size
1	Cotter Pin	4x25
1	Washer	10.5x18

Qty.	Description	Size
1	Support Bracket (K)	

Bag of Parts (52 in.):

Qty.	Description	Size
1	Label, Danger (Thrown Object)	
1	Label, Danger	
1	Label, No Step	
1	Cotter Pin	4x25
1	Washer	10.5x18
2	Washer	10.5x30
2	Locknut	M10
2	Screw, Hex Flange	M10x25
1	Pivot Pin	

Bag of Parts:

Qty.	Description	Size
1	Label, Danger (Thrown Object)	
1	Label, Danger	
4	Bolt, Carriage	M10x25
1	Cotter Pin	4x25
6	Locknut	M10
2	Screw, Hex Flange	M10x25
1	Washer	10.5x18
3	Washer	10.5x30
1	Pivot Pin	

Identify Parts: Power Flow - 61 in.

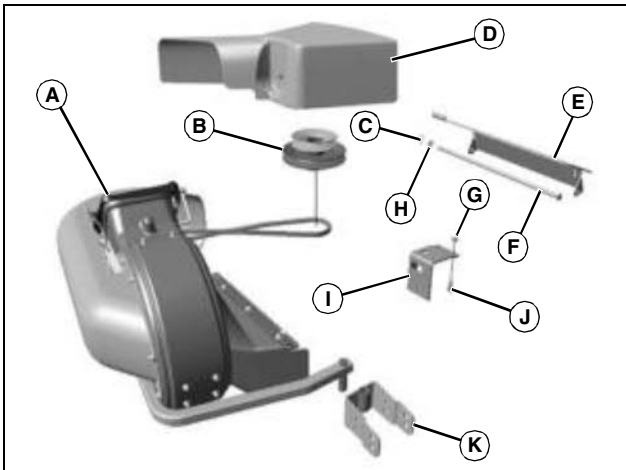

MX31266

Qty.	Description	Size
1	Hopper Assembly (A)	
1	Double Sheave (B)	
1	Cotter Pin (C)	
1	Belt Cover (D)	
1	Block Off Plate (E)	
1	Pin (F)	
2	Locknut (G)	
1	Washer (H)	
2	Bracket (I)	
2	Bolt (J)	

Identify Parts: Chute

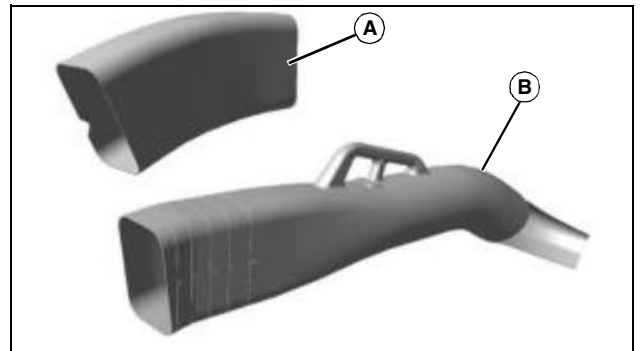

MX31267

Qty.	Description	Size
1	Lower Chute Adapter (A)	
1	Upper Chute (B)	

Identify Parts: Rear Bagger

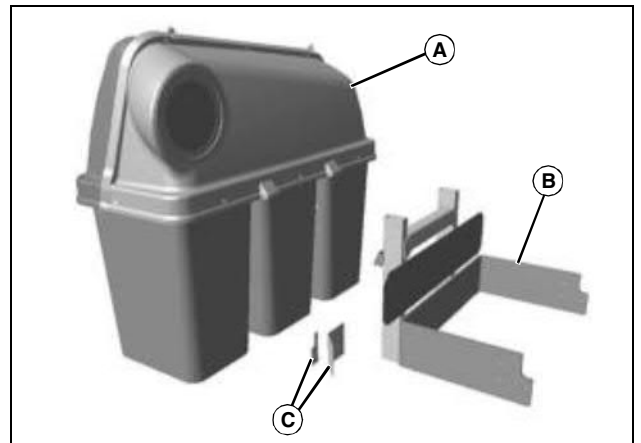

MX32213

PREPARING VEHICLE

Qty.	Description	Size
1	Hopper Assembly (A)	
1	Bracket, Rear (B)	
1	Deflector, Exhaust (C)	

Assemble Power Flow Chute

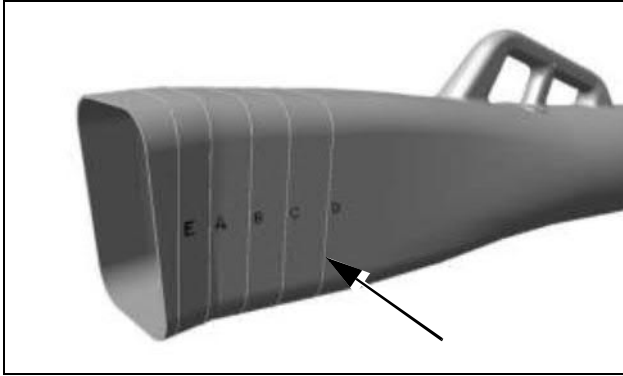

MX31263

1. Locate the appropriate cut line molded into the upper chute. The (D) line is used for this bagger.
2. Cut the chute.
3. File the edge to remove any burrs.

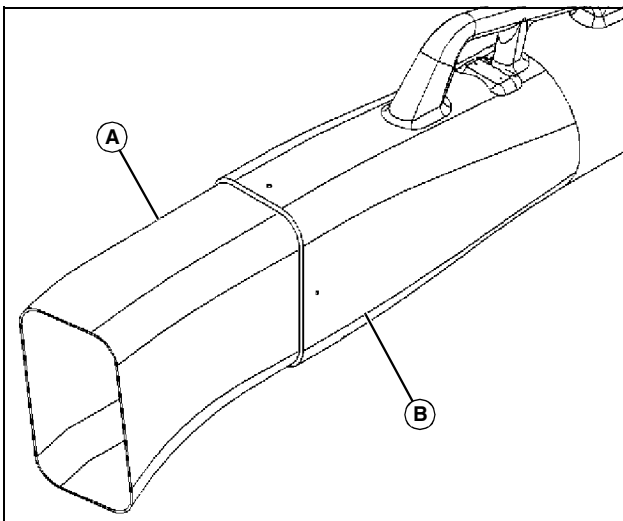

MX18499

4. Insert tapered end of lower chute adapter (A) into the trimmed end of the upper chute (B).
5. Place mower deck at lowest cutting height on the machine.
6. Install chute assembly on the machine.
7. Adjust mower deck to the highest cutting height.

NOTE: Before drilling holes, verify drill bit will pass through the upper chute and the lower chute adapter.

8. Using a 5 mm or 3/16 in. drill bit, drill a hole centered one inch from trimmed end of upper chute on top, bottom and outer sides. Temporarily insert a #10 x 5/8 in. cap screw after drilling each hole to help with alignment.

9. Remove chute assembly from mower and drill a hole centered one inch from trimmed end of inner side of chute.

10. Remove cap screws from chute assembly and place a washer on each cap screw.

IMPORTANT: Avoid damage! Hardware should only be tightened until snug. Do not allow hardware to deform chute assembly while tightening.

11. Insert each cap screw and washer through the chute assembly so that the threaded end of the screw faces outward. Install an additional washer and nut on the end of the cap screw. Tighten nut until snug.

Install Hopper Hook

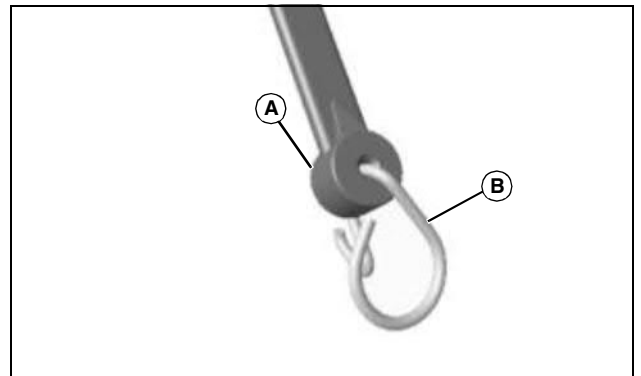

MX13161

1. Insert hopper hook (A) through hole in hopper strap (B) as shown.

Preparing Vehicle

Install Ballast



CAUTION: Avoid injury! Machine can become unstable when operating with attachment. Ballast is required when the attachment is installed.

When the attachment is removed, also remove any ballast that was added to the machine.

Use only attachments and accessories recommended by the manufacturer.

NOTE: Ballast is included with this attachment. If ballast was not shipped with the rear bagger and Power Flow, see your authorized dealer.

Install the proper front ballast to help counter-balance the total weight of the bagger. Remove ballast when the bagger is removed. This will ensure the proper operation of the machine when not bagging.

PREPARING VEHICLE

Install ballast (48 and 52 in. Mower Decks)

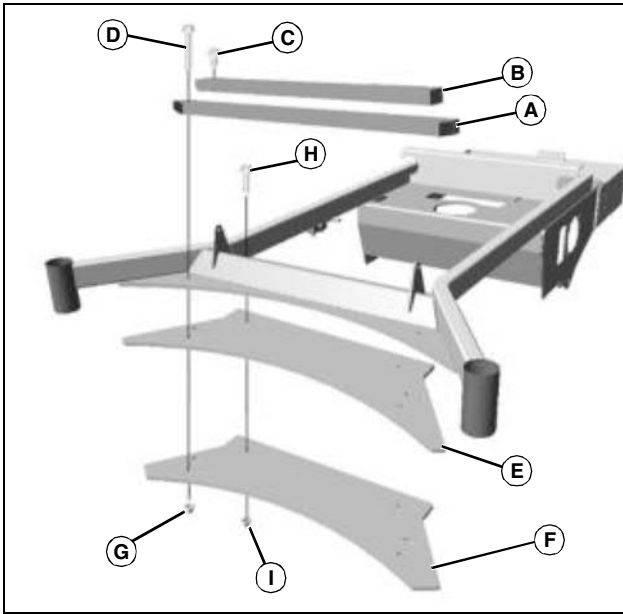

MX31204a

1. Install one 36 lb (A) and one shorter 32 lb (B) weight between the caster wheel support arms as shown. Secure top weight to bottom plate with cap screw (C).

NOTE: Machines with a 48 in. mower deck already have a 27 lb weight (E) installed. Machines with a 52 in. deck do not use the 27 lb weight (E).

2. Install lower weights.

- 48 in. Decks: Install front bolt (D) and raise one additional plate (F) from beneath machine frame, and secure the front bolt with nut (G).
- 52 in. Decks: Install front bolt (D) and raise two plates (F) from beneath machine frame, and secure the front bolt with nut (G).

3. Secure rear of plates with a flange bolt (H) and flange nut (I).

NOTE: Spacer plate (J) is not used on Chariot LX models.

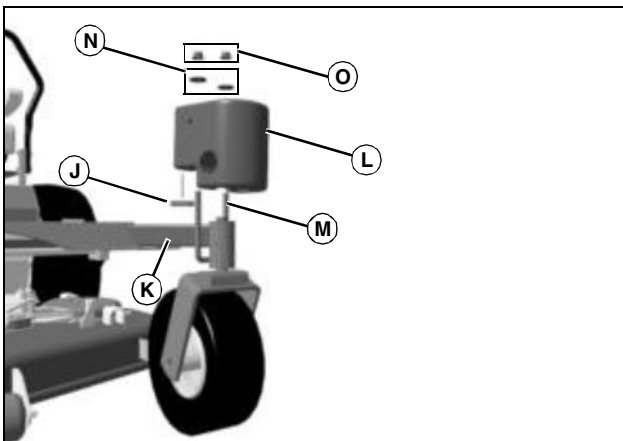

MX15655a

4. If a spacer plate (J) is supplied, (on chariot models), place spacer plate (J) onto machine rail (K). (If spacer plate (J) is not supplied in kit, you have a newer style front caster weight (L) supplied, which does not require a spacer plate.)

5. Install the front caster wheel weight (L) on each spacer plate (J) (if installed) and caster wheel support, as shown.

6. Secure the weights with U-bolt (M), washers (N) and nuts (O), as shown.

Install ballast (61 in. Mower Decks)

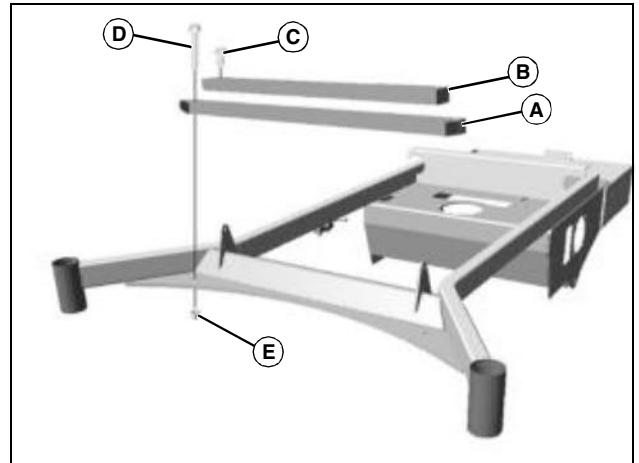

MX31205

1. Install one 36 lb (A) and one shorter 32 lb (B) weight between the caster wheel support arms as shown. Secure top weight to bottom plate with cap screw (C).

2. Secure the weights to the machine on each side with a bolt (D) and nut (E).

NOTE: Spacer plate (F) is not used on Chariot LX models.

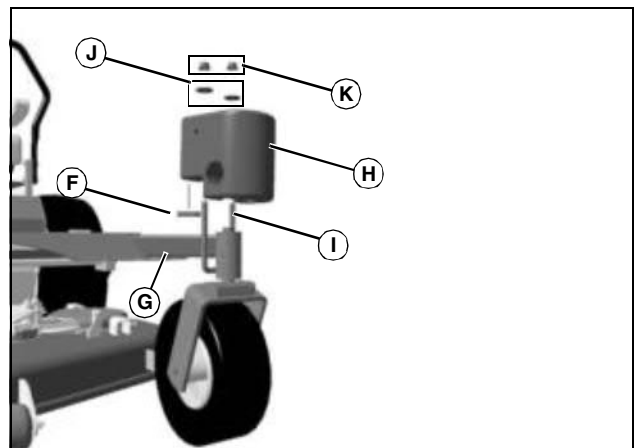

MX15655a

3. If a spacer plate (F) is supplied (on chariot models), place spacer plate (F) onto machine rail (G). (If spacer plate (F) is not supplied in kit, you have a newer style front caster weight (H) supplied, which does not require a spacer plate.)

4. Install the front caster wheel weight (H) on each spacer plate (F) (if installed) and caster wheel support, as shown.

5. Secure the weights with U-bolt (I), washers (J) and nuts (K), as shown.

Install Proper Mower Blades

For maximum performance from the Power Flow, install the correct mower blades for the application:

- Standard Blades: This blade is designed for bagging and side discharging in all mowing conditions.
- Mulching Blades: Not recommended with Power Flow.

PREPARING VEHICLE

Install Exhaust Deflector

IMPORTANT: Avoid damage! If exhaust contacts hopper bags, damage can result. For certain engines, exhaust deflector must be oriented so that exhaust does not come in direct contact with hopper bags.

NOTE: There may be some applications where you may need to bend bracket (A) to properly secure bracket to machine frame and properly deflect exhaust to protect hopper bags from heat damage.

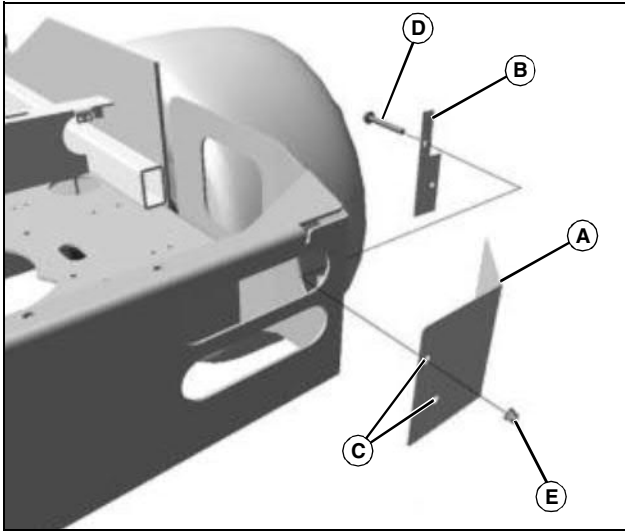

MX31209

1. Place bracket (A) and backing plate (B) onto machine frame, as shown. Secure through holes (C) in bracket and plate with M6x20 bolt (D) and M6 locknut (E).

Install Rear Mounting Bracket

1. Park machine safely. (See Parking Safely in the SAFETY section.)

NOTE: Leave two top front bolts (A) installed to hold rear bumper in position.

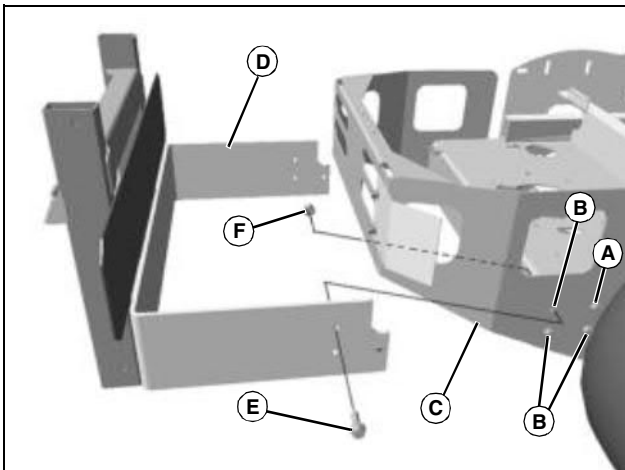

MX32214

2. Remove six hex head bolts (B) and nuts from both sides of rear bumper (C).



CAUTION: Avoid injury! Mounting bracket is heavy. Support one side of the bracket while securing the first side with hardware to prevent injury.

3. Install mounting bracket (D) as shown, and secure on both sides with six M10x35 hex head bolts (E) and the M10 nuts (F).

Install Front Mounting Bracket

48 and 52 in. Mower Decks

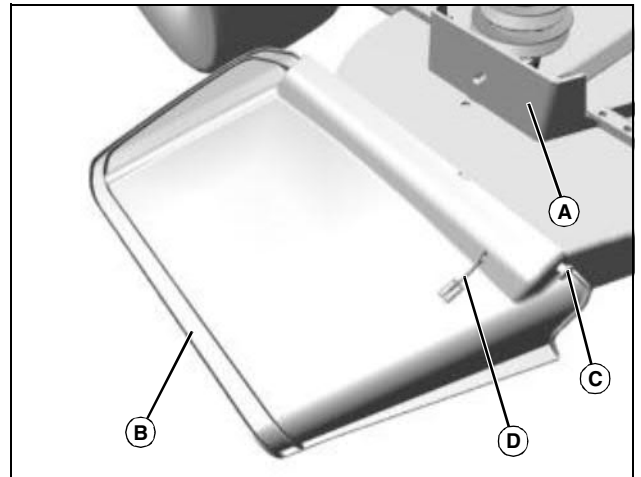

MX31087

1. Remove wing nut securing belt cover on deck reinforcing plate (A).
2. Remove discharge chute (B), leaving pin (C) and spring (D) with chute.

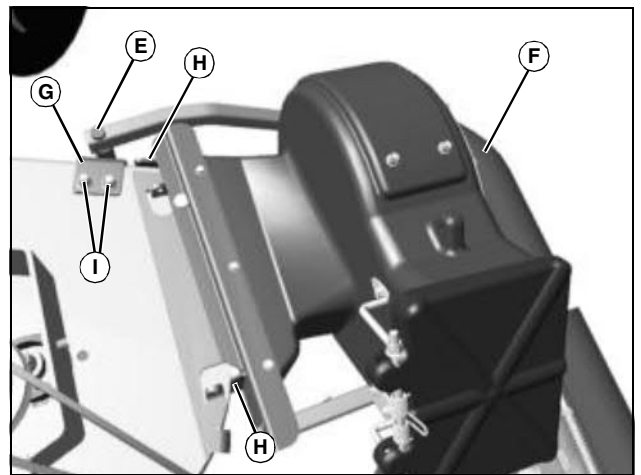

MX31086

3. Install pin (E) on blower housing (F) onto pivot bracket (G), and position assembly onto right front corner of mower deck, being certain mounting bracket ends (H) seal mower deck opening.
4. Center punch two holes pivot bracket location, and drill 11 mm in. holes.
5. Bolt bracket with two M10x25 carriage bolts and M10 nuts (I).
6. Remove blower housing (F) from pivot bracket (G).



Suggest:

If the above button click is invalid.

Please download this document

first, and then click the above link

to download the complete manual.

Thank you so much for reading

PREPARING VEHICLE

61 in. Mower Decks

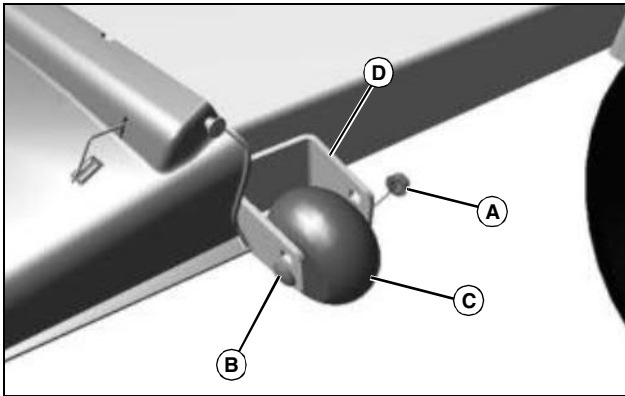

MX31216

1. Remove locknut (A) and carriage bolt (B) and anti-scalp wheel (C) from right front welded bracket (D).

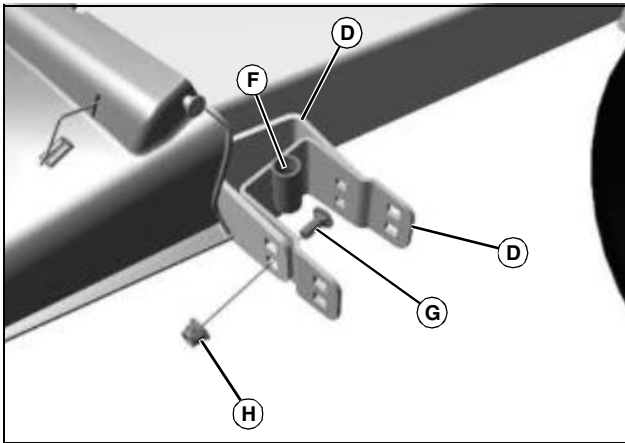

MX31217

2. Install extension bracket (E) to front welded bracket (D), with tube (F) extending upward from bracket, as shown. Secure bracket with four M10x25 carriage bolts (G) and four M10 locknuts (H).

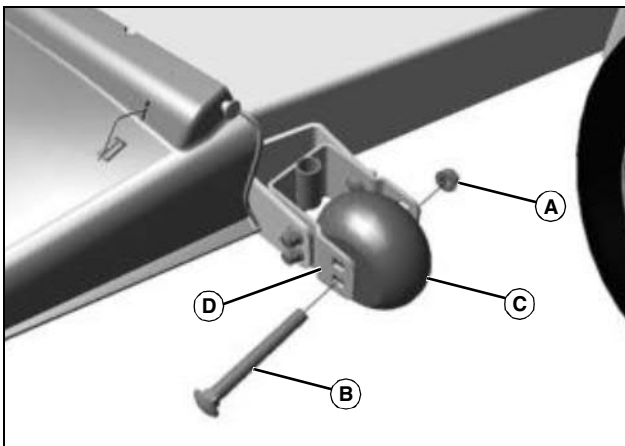

MX31218

3. Install anti-scalp wheel (C) onto bottom hole on extension bracket (D), and secure with carriage bolt (B) and locknut (A).

Install Double Sheave

48 in. Mower Decks

1. Raise deck, and place blocks under each side of deck. Take height-of-cut (HOC) adjustment pin out of lift assembly bracket, lower deck lift lever all the way down, lowering deck onto blocks. Install adjustment pin just above lift lever to prevent lever from any upper movement.

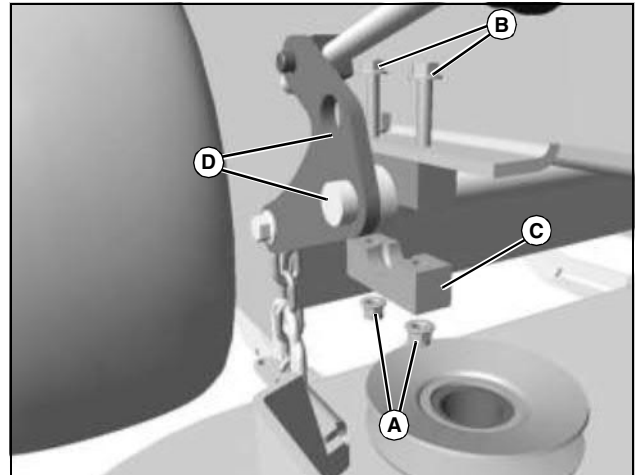

MX31507

2. Remove two nuts (A) and bolts (B) holding deck lift linkage lower support (C) onto lift arm assembly (D). Remove lift linkage lower support (C).

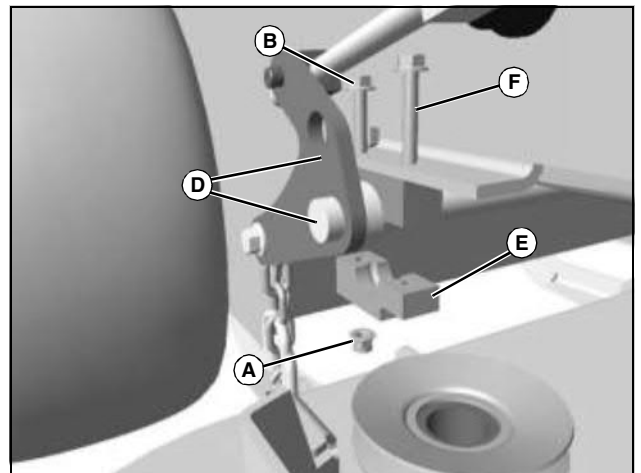

MX31508

3. Raise new stepped lower support (E) into position on lift arm assembly (D), with stepped area to front of machine, as shown.

4. Secure rear side of lower support with one bolt (B) and nut (A) removed from first step.

5. Secure front side of lower support with M8x35 bolt (F).

<https://www.ebooklibonline.com>

Hello dear friend!

Thank you very much for reading.

Enter the link into your browser.

The full manual is available for immediate download.

<https://www.ebooklibonline.com>