

JOHN DEERE
WORLDWIDE COMMERCIAL & CONSUMER
EQUIPMENT DIVISION

**Power Flow™ and Rear Bagger -
14 Bushel Commercial**

OMTCU18066 C3

OPERATOR'S MANUAL

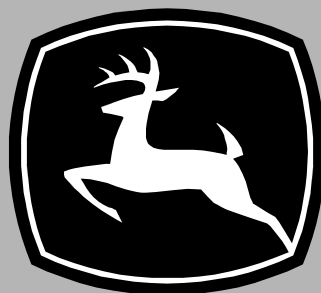

JOHN DEERE

North American Version
Litho in U.S.A.

INTRODUCTION

Thank You for Purchasing a John Deere Product

We appreciate having you as a customer and wish you many years of safe and satisfied use of your machine.

Using Your Operator's Manual

This manual is an important part of your machine and should remain with the machine when you sell it.

Reading your operator's manual will help you and others avoid personal injury or damage to the machine.

Information given in this manual will provide the operator with the safest and most effective use of the machine.

Knowing how to operate this machine safely and correctly will allow you to train others who may operate this machine.

If you have an attachment, use the safety and operating information in the attachment operator's manual along with the machine operator's manual to operate the attachment safely and correctly.

This manual and safety signs on your machine may also be available in other languages (see your authorized dealer to order).

Sections in your operator's manual are placed in a specific order to help you understand all the safety messages and learn the controls so you can operate this machine safely. You can also use this manual to answer any specific operating or servicing questions. A convenient index located at the end of this book will help you to find needed information quickly.

The machine shown in this manual may differ slightly from your machine, but will be similar enough to help you understand our instructions.

RIGHT and LEFT sides are determined by facing in the direction the machine will travel when going forward. When you see a broken line (-----), the item referred to is hidden from view.

Before delivering this machine, your dealer performed a predelivery inspection to ensure best performance.

Special Messages

Your manual contains special messages to bring attention to potential safety concerns, machine damage as well as helpful operating and servicing information. Please read all the information carefully to avoid injury and machine damage.



CAUTION: Avoid injury! This symbol and text highlight potential hazards or death to the operator or bystanders that may occur if the hazards or procedures are ignored.

IMPORTANT: Avoid damage! This text is used to tell the operator of actions or conditions that might result in damage to the machine.

NOTE: General information is given throughout the manual that may help the operator in the operation or service of the machine.

PRODUCT IDENTIFICATION

Product Compatibility

The POWER FLOW and 14 Bushel Rear Bagger is compatible with Z-TRAK models 737, 757, 777, and 797.

Record Identification Numbers

POWER FLOW

Serial No. (010001-)

If you need to contact an Authorized Service Center for information on servicing, always provide the product model and serial number.

You will need to locate the serial number for the attachment. Record the information in the spaces provided below.

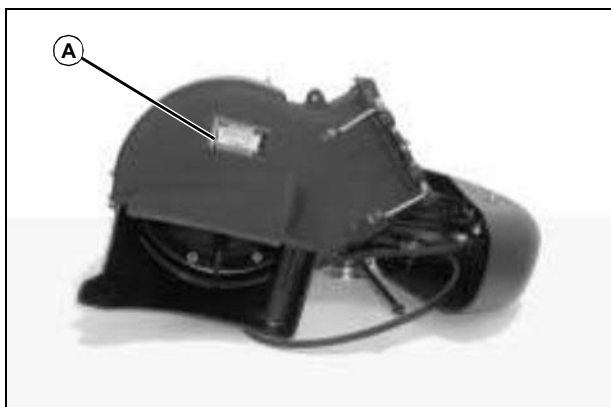

MX12469

DATE OF PURCHASE:

DEALER NAME:

DEALER PHONE:

SERIAL NUMBER (A):

<https://www.ebooklibonline.com>

Hello dear friend!

Thank you very much for reading.

Enter the link into your browser.

The full manual is available for immediate download.

<https://www.ebooklibonline.com>

TABLE OF CONTENTS

Safety	1
Preparing Vehicle	5
Installing	7
Removing	12
Operating	14
Replacement Parts	16
Service	17
Troubleshooting	19
Storage	20
Assembly	21
Specifications	23
Index	24

All information, illustrations and specifications in this manual are based on the latest information at the time of publication. The right is reserved to make changes at any time without notice.

COPYRIGHT© 2003
Deere & Co.
John Deere Worldwide Commercial and
Consumer Equipment Division
All rights reserved
Previous Editions
COPYRIGHT©

OMTCU18066 C3 - English

SAFETY

Understanding The Machine Safety Labels

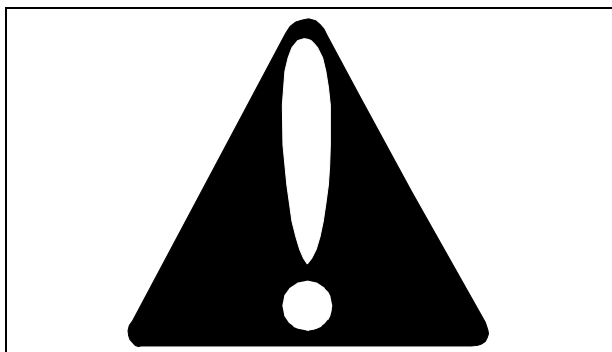

Safety-Alert Symbol

The machine safety labels shown in this section are placed in important areas on your machine to draw attention to potential safety hazards.

On your machine safety labels, the words DANGER, WARNING, and CAUTION are used with this safety-alert symbol. DANGER identifies the most serious hazards.

The operator's manual also explains any potential safety hazards whenever necessary in special safety messages that are identified with the word, CAUTION, and the safety-alert symbol.

WARNING: Rotating Blade - Thrown Objects



MX12470, M118454

Operate blower with entire grass catcher secured in place.

DANGER

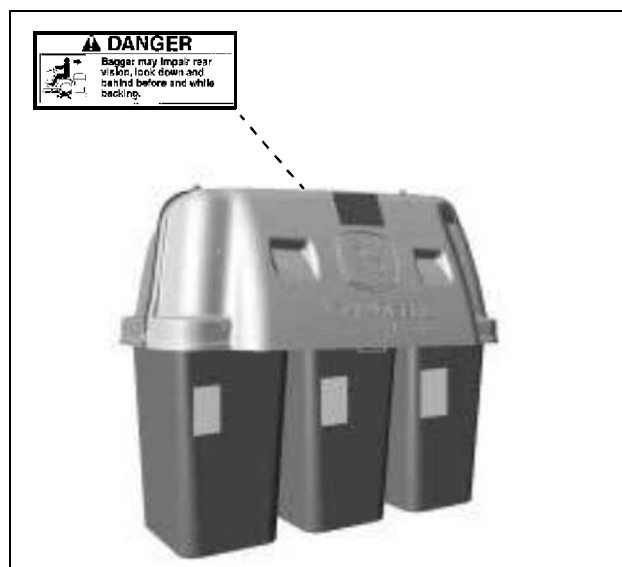

MX19991, M146238

Bagger may impair rear vision, look down and behind before and while backing.

WARNING



MX19991, M146356

To avoid injury from thrown objects, keep bystanders away. Shut off engine before opening hopper top. Keep chutes in place. Never allow riders on hopper top or on frame.

SAFETY

CAUTION



MX19991, M146356

To avoid injury, ballast per operator's manual. Bag is subject to wear and deterioration, check bag frequently and replace, as necessary, with a John Deere bag or equivalent to comply with safety specifications.

CAUTION

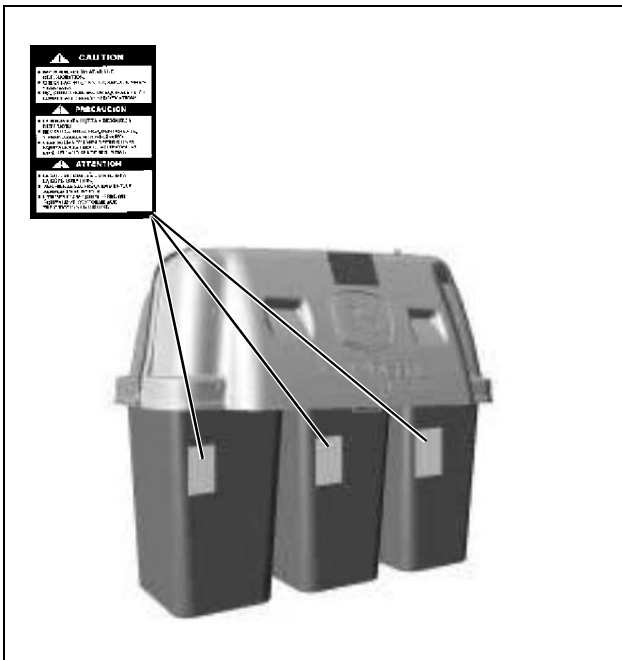

MX19991, GC00215

- Bag is subject to wear and deterioration.
- Check bag frequently and replace when necessary.

- Use John Deere bag or equivalent to comply with safety specifications.

Operating Safely

Read, understand and follow all instructions in this attachment manual, the machine operator's manual and safety signs on equipment before starting.

Use proper front ballast. Remove ballast when the material collection system is removed.

Hopper extends beyond machine. Be aware of surrounding objects when making short turns.

Do not operate material collection system unless entire grass catcher is fastened in place with hopper cover securely latched.

Do not let anyone ride on the machine or material collection system. Riders are subject to injury such as being struck by foreign objects or being thrown off. Riders may obstruct the operator's view and cause a collision.

Before you remove or install bags:

- Stop mower.
- Disengage mower.
- Stop engine and lock park brake.

Before you back up:

- Stop machine.
- Look behind hopper for children.

Bag Maintenance:

- Bag is subject to wear and deterioration.
- Check bag frequently, replace when necessary.
- Use John Deere bag or equivalent to comply with safety specifications.
- Do not leave clippings in bags overnight.

Operate safely on slopes:

- Empty bags when they are half full.
- Do not operate on steep slopes.
- Before you turn, slow down.
- Avoid sudden starts and stops.
- Avoid holes, rocks, and roots.
- Mow across slopes - not up and down.
- Do not park machine with material collection system on slopes.

SAFETY

Parking Safely

1. Stop machine on a level surface, not on a slope.
2. Move motion control levers out to the neutral lock position.
3. Disengage mower blades.
4. Lower attachments to the ground.
5. Lock the park brake.
6. Stop the engine.
7. Remove the key.
8. Wait for engine and all moving parts to stop before you leave the operator's seat.
9. Close fuel shut-off valve, if your machine is equipped.
10. Disconnect the negative battery cable or remove the spark plug wire (for gasoline engines) before servicing the machine.

Checking Mowing Area

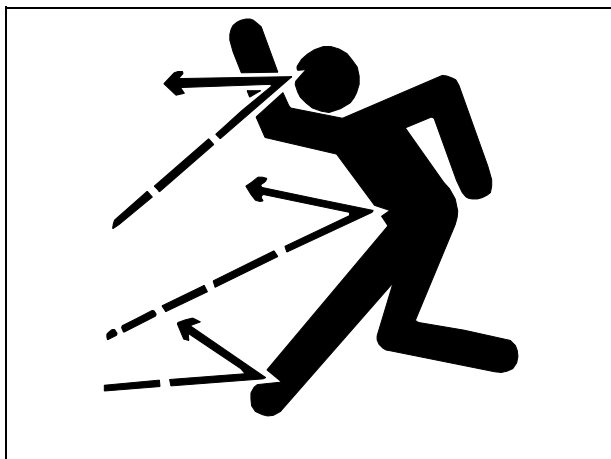

MIF

- Evaluate the terrain to determine what accessories and attachments are needed to properly and safely perform the job.
- Clear mowing area of objects that might be thrown. Keep people and pets out of mowing area.
- Low-hanging branches and similar obstacles can injure the operator or interfere with mowing operation. Before mowing, identify potential obstacles such as low-hanging branches and trim, or remove those obstacles.
- Study mowing area. Set up a safe mowing pattern. Do not mow where traction or stability is doubtful.
- Test drive area with mower lowered but not running. Slow down when you travel over rough ground.

Avoid Injury From Thrown Objects

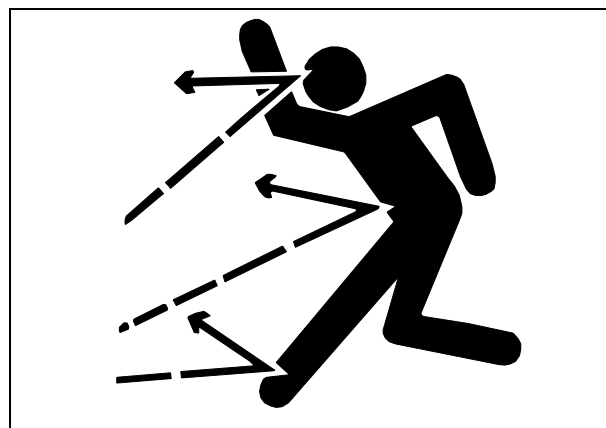

MIF

- When operating the machine with the attachment installed, make sure all chutes and hoses are securely in place. Keep hopper top closed or MCS in operating position.
- Avoid injury from impeller blades and thrown objects. Remove attachment when operating machine in side discharge mode. Make sure deflector shield is in place on mower deck if attachment is removed.

Avoid Injury From Rotating Blades



MIF

- Do not put hands or feet near blower assembly when engine is running.
- Stop engine before you unplug the blower assembly.
- Do not operate the blower assembly unless entire grass catcher is fastened in place with hopper cover latched in the CLOSED position, or the MCS is returned to the operating position.

SAFETY

Practice Safe Maintenance



MIF

- Understand service procedure before doing work. Keep area clean and dry.
- Lower attachments to the ground before servicing machine. Disengage all power and stop the engine. Lock park brake and remove the key. Let machine cool.
- Never lubricate, service or adjust the attachment while the machine is moving. Keep safety devices in place and in working condition. Keep hardware tight.
- Before servicing attachment, carefully release pressure from any components with stored energy, such as hydraulic components.
- Keep all parts in good condition and properly installed. Fix damage immediately. Replace worn or broken parts. Replace all worn or damaged safety and instruction decals.
- Unauthorized modifications to the attachment may impair its function and safety. Do not tamper with its original design.



Suggest:

If the above button click is invalid.

Please download this document first, and then click the above link to download the complete manual.

Thank you so much for reading

PREPARING VEHICLE

Preparing the Machine

NOTE: Read and complete the Assembly section at the back of this operator manual if installing the attachment for the first time.

Machine Setup

- Check tire pressure of machine before operating machine.

Installing Bagger Mounting Hardware



CAUTION: Avoid injury! Stop engine, remove key and wait for all moving parts to stop before installing the attachment.

1. Park machine safely. (See Parking Safely in the SAFETY section.)

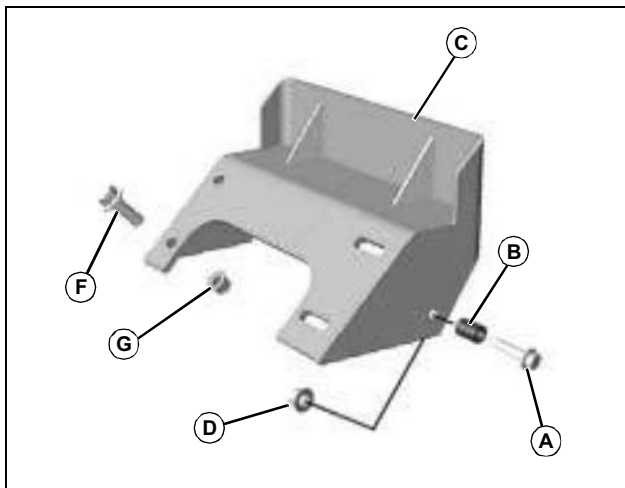

MX19999

2. Install two M12 x 1.75 x 50 bolts (A) and spacers (B) in holes on both sides of bracket (C).
3. Secure hardware with two M12 locknuts (D) positioned at inside of bracket. Tighten hardware to 130 N•m (95 lb-ft).

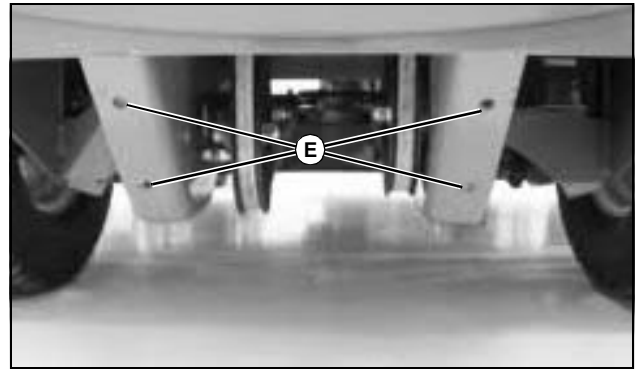

MX12477

4. Locate holes (E) in rear frame, and install bagger support bracket (C). Secure with four bolts (F) and flanged locknuts (G) thru holes in bracket and holes (E) in frame.

Install Exhaust Deflector and Bracket



CAUTION: Avoid injury! Touching hot surfaces can burn skin. The engine, components, and fluids will be hot if the engine has been running. Allow the engine to cool before servicing or working near the engine and components.

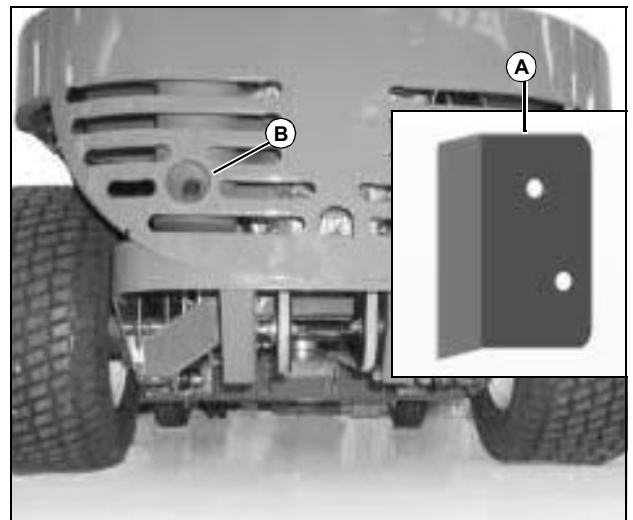

MX10367, MX12496

1. Install deflector (A) to rear grill at muffler outlet (B).
2. Install deflector bracket inside rear grill and line up with deflector.
3. Secure deflector and deflector bracket to rear grill with M6 hex flanged screws and locknuts.

<https://www.ebooklibonline.com>

Hello dear friend!

Thank you very much for reading.

Enter the link into your browser.

The full manual is available for immediate download.

<https://www.ebooklibonline.com>