

FARMALL® I10U
FARMALL® I20U
Tractor

SERVICE MANUAL

Part number 48038069

2nd edition English

October 2017

Replaces part number 47985320

CASE II
AGRICULTURE



SERVICE MANUAL

Farmall® 110U With 16x16 Semi-Powershift transmission [ZFLD00796 -]
Farmall® 120U With 16x16 Semi-Powershift transmission [ZFLD00125 -]

Link Product / Engine

Product	Market Product	Engine
Farmall® 110U With 16x16 Semi-Powershift transmission [ZFLD00796 -]	North America	F5GFL413B*B015
Farmall® 120U With 16x16 Semi-Powershift transmission [ZFLD00125 -]	North America	F5GFL413A*B023

<https://www.ebooklibonline.com>

Hello dear friend!

Thank you very much for reading.

Enter the link into your browser.

The full manual is available for immediate download.

<https://www.ebooklibonline.com>

Contents

INTRODUCTION

Engine	10
[10.001] Engine and crankcase	10.1
[10.216] Fuel tanks	10.2
[10.206] Fuel filters	10.3
[10.202] Air cleaners and lines	10.4
[10.254] Intake and exhaust manifolds and muffler	10.5
[10.500] Selective Catalytic Reduction (SCR) exhaust treatment.....	10.6
[10.501] Exhaust Gas Recirculation (EGR) exhaust treatment.....	10.7
[10.400] Engine cooling system	10.8
[10.414] Fan and drive	10.9
[10.310] Aftercooler.....	10.10
[10.304] Engine lubrication system.....	10.11
[10.218] Fuel injection system.....	10.12
Clutch	18
[18.100] Clutch mechanical release control	18.1
[18.112] Slip clutch or flywheel damper	18.2
Transmission	21
[21.111] Semi-Powershift transmission	21.1
[21.133] Semi-Powershift transmission external controls	21.2
[21.103] Semi-Powershift transmission hydraulic components.....	21.3
[21.152] Semi-Powershift transmission internal components	21.4
[21.160] Creeper	21.5
[21.109] Transmission cooler and lines.....	21.6
Four-Wheel Drive (4WD) system	23
[23.202] Electro-hydraulic control	23.1

[23.314] Drive shaft.....	23.2
Front axle system	25
[25.100] Powered front axle	25.1
[25.102] Front bevel gear set and differential	25.2
[25.108] Final drive hub, steering knuckles, and shafts	25.3
[25.122] Axle suspension control.....	25.4
Rear axle system.....	27
[27.100] Powered rear axle.....	27.1
[27.106] Rear bevel gear set and differential.....	27.2
[27.120] Planetary and final drives	27.3
Power Take-Off (PTO).....	31
[31.104] Rear electro-hydraulic control.....	31.1
[31.114] Two-speed rear Power Take-Off (PTO)	31.2
[31.116] Three-speed rear Power Take-Off (PTO)	31.3
[31.142] Front Power Take-Off (PTO) control	31.4
[31.146] Front Power Take-Off (PTO)	31.5
Brakes and controls	33
[33.202] Hydraulic service brakes	33.1
[33.110] Parking brake or parking lock	33.2
Hydraulic systems.....	35
[35.000] Hydraulic systems.....	35.1
[35.204] Remote control valves	35.2
[35.100] Main lift system.....	35.3
[35.160] Front hitch controls and lines	35.4
[35.162] Front hitch cylinders and lines	35.5
[35.116] Three-point hitch cylinder	35.6
[35.304] Combination pump units	35.7
Hitches, drawbars, and implement couplings.....	37

[37.100] Drawbars and towing hitches	37.1
[37.110] Rear three-point hitch	37.2
[37.120] Rear three-point hitch linkage	37.3
[37.162] Front hitch	37.4
[37.166] Front hitch linkage	37.5
Frames and ballasting	39
[39.140] Ballasts and supports	39.1
Steering	41
[41.101] Steering control	41.1
[41.106] Tie rods	41.2
[41.200] Hydraulic control components	41.3
[41.216] Cylinders	41.4
Wheels	44
[44.511] Front wheels	44.1
[44.520] Rear wheels	44.2
Cab climate control	50
[50.100] Heating	50.1
[50.104] Ventilation	50.2
[50.200] Air conditioning	50.3
Electrical systems	55
[55.100] Harnesses and connectors	55.1
[55.525] Cab engine controls	55.2
[55.015] Engine control system	55.3
[55.201] Engine starting system	55.4
[55.301] Alternator	55.5
[55.302] Battery	55.6
[55.011] Fuel tank system	55.7
[55.010] Fuel injection system	55.8

[55.014] Engine intake and exhaust system.....	55.9
[55.988] Selective Catalytic Reduction (SCR) electrical system	55.10
[55.989] Exhaust Gas Recirculation (EGR) electrical system	55.11
[55.640] Electronic modules	55.12
[55.513] Cab transmission controls.....	55.13
[55.024] Transmission control system	55.14
[55.020] Transmission speed sensors.....	55.15
[55.022] Transmission temperature sensors	55.16
[55.045] Front axle control system	55.17
[55.031] Parking brake electrical system	55.18
[55.512] Cab controls.....	55.19
[55.035] Remote control valve electric control	55.20
[55.051] Cab Heating, Ventilation, and Air-Conditioning (HVAC) controls.....	55.21
[55.050] Heating, Ventilation, and Air-Conditioning (HVAC) control system.....	55.22
[55.523] Cab hitch controls	55.23
[55.130] Rear three-point hitch electronic control system	55.24
[55.202] Cold start aid	55.25
[55.785] Precision farming system	55.26
[55.905] ISOBUS components	55.27
[55.911] Satellite navigation systems.....	55.28
[55.680] Autopilot/Autoguidance	55.29
[55.518] Wiper and washer system.....	55.30
[55.404] External lighting	55.31
[55.405] External lighting switches and relays	55.32
[55.408] Warning indicators, alarms, and instruments	55.33
[55.988] Selective Catalytic Reduction (SCR) electrical system	55.34
[55.DTC] FAULT CODES.....	55.35
Front loader and bucket.....	82

[82.100] Arm.....	82.1
Accessories	88
[88.100] Accessories	88.1
Platform, cab, bodywork, and decals.....	90
[90.118] Protections and footboards.....	90.1
[90.150] Cab.....	90.2
[90.151] Cab interior.....	90.3
[90.160] Cab interior trim and panels.....	90.4
[90.154] Cab doors and hatches	90.5
[90.156] Cab windshield and windows	90.6
[90.120] Mechanically-adjusted operator seat.....	90.7
[90.124] Pneumatically-adjusted operator seat.....	90.8
[90.100] Engine hood and panels	90.9
[90.102] Engine shields, hood latches, and trims	90.10
[90.116] Fenders and guards.....	90.11



INTRODUCTION

Foreword - Important notice regarding equipment servicing

All repair and maintenance work listed in this manual must be carried out only by qualified dealership personnel, strictly complying with the instructions given, and using, whenever possible, the special tools.

Anyone who performs repair and maintenance operations without complying with the procedures provided herein shall be responsible for any subsequent damages.

The manufacturer and all the organizations of its distribution chain, including - without limitation - national, regional, or local dealers, reject any responsibility for damages caused by parts and/or components not approved by the manufacturer, including those used for the servicing or repair of the product manufactured or marketed by the manufacturer. In any case, no warranty is given or attributed on the product manufactured or marketed by the manufacturer in case of damages caused by parts and/or components not approved by the manufacturer.

The manufacturer reserves the right to make improvements in design and changes in specifications at any time without notice and without incurring any obligation to install them on units previously sold. Specifications, descriptions, and illustrative material herein are as accurate as known at time of publication but are subject to change without notice.

In case of questions, refer to your CASE IH Sales and Service Networks.

Note to the Owner WARNINGS FOR AIR CONDITIONING SYSTEM REPAIR OPERATIONS

Starting the system at low temperatures can damage the compressor. Only operate the air conditioner when the engine is hot and the temperature inside the cab is at least **20 °C (68.00 °F)**.

When disconnecting the hoses, close the ends with plastic caps to prevent foreign matter and humidity from getting inside the hoses.

Handle the thermostatic sensor carefully to avoid damage that may prevent efficient system operation.

Always use two spanners to unscrew the hose fittings to avoid twisting the fitting.

Do not use any type of engine oil to lubricate the compressor and the system.

Never leave the compressor oil container open, always make sure that it is tightly closed. If left exposed the oil will absorb humidity from the air and may, subsequently, damage the system.

Do not transfer compressor oil from the original container to another container.

Do not introduce any additives to the compressor oil. Any additional substances could contain elements which are incompatible with the chemical base of the refrigerant and thus alter its characteristics.

Check that the thermostatic sensor is correctly inserted in the fins on the evaporator to ensure efficient system operation.

Safety rules

Personal safety





This is the safety alert symbol. It is used to alert you to potential personal injury hazards. Obey all safety messages that follow this symbol to avoid possible death or injury.

Throughout this manual you will find the signal words DANGER, WARNING, and CAUTION followed by special instructions. These precautions are intended for the personal safety of you and those working with you.

Read and understand all the safety messages in this manual before you operate or service the machine.

 DANGER indicates a hazardous situation that, if not avoided, will result in death or serious injury.

 WARNING indicates a hazardous situation that, if not avoided, could result in death or serious injury.

 CAUTION indicates a hazardous situation that, if not avoided, could result in minor or moderate injury.

FAILURE TO FOLLOW DANGER, WARNING, AND CAUTION MESSAGES COULD RESULT IN DEATH OR SERIOUS INJURY.

Machine safety

NOTICE: Notice indicates a situation that, if not avoided, could result in machine or property damage.

Throughout this manual you will find the signal word Notice followed by special instructions to prevent machine or property damage. The word Notice is used to address practices not related to personal safety.

Information

NOTE: Note indicates additional information that clarifies steps, procedures, or other information in this manual.

Throughout this manual you will find the word Note followed by additional information about a step, procedure, or other information in the manual. The word Note is not intended to address personal safety or property damage.



SERVICE MANUAL

Engine

Farmall® 110U With 16x16 Semi-Powershift transmission [ZFLD00796 -]
Farmall® 120U With 16x16 Semi-Powershift transmission [ZFLD00125 -]

Engine - Torque

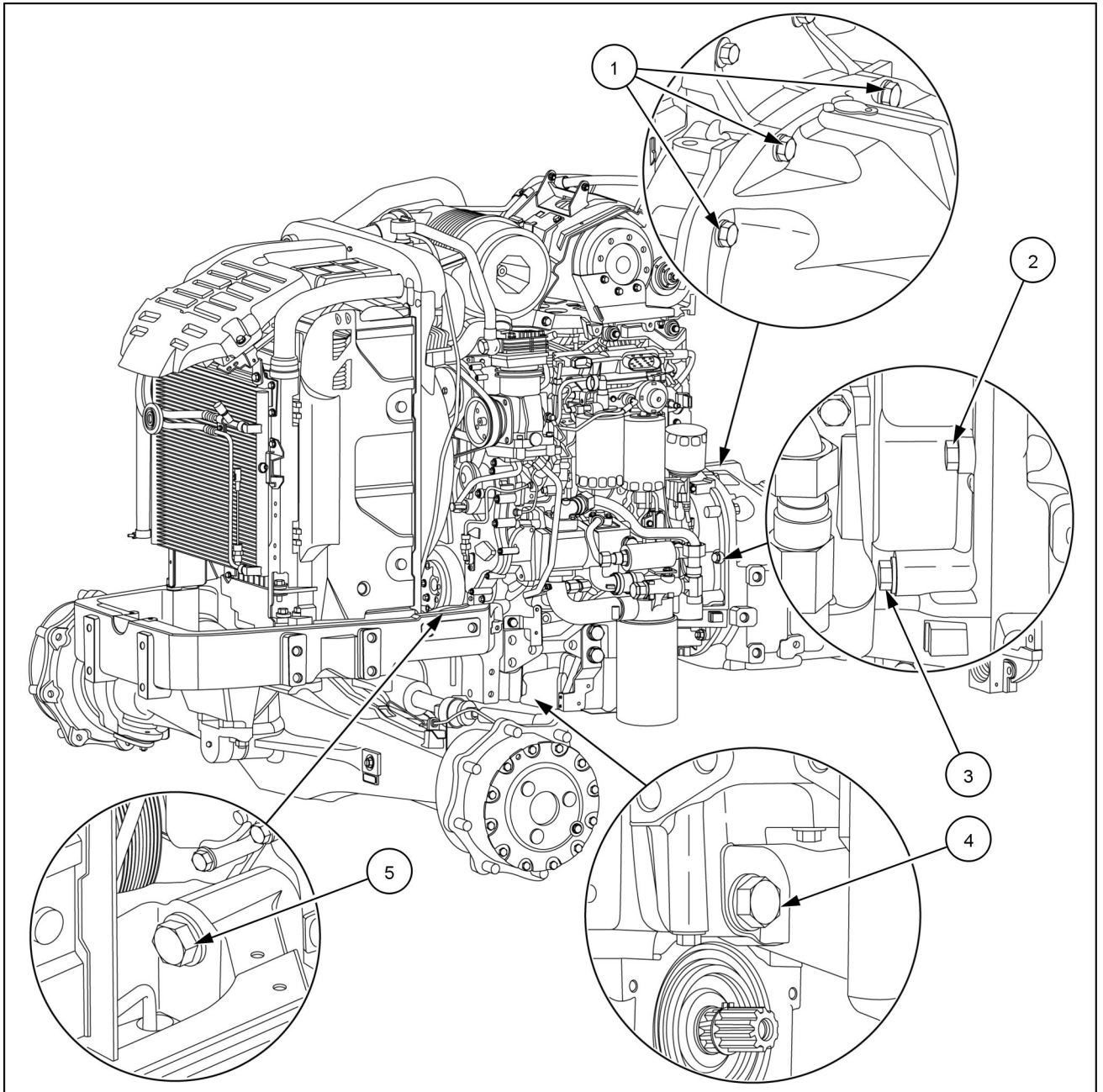

MOIL15TR01705GA 1

Part to tighten	Thread	Tightening torque
Bolt (5) retaining the front axle support to the engine block	M20 x 1.5 x 130	587 N·m (432.95 lb ft)
Bolt (4) retaining the engine block to the front axle	M20 x 1.5 x 110	587 N·m (432.95 lb ft)
Bolt (1) retaining the transmission housing to the engine block	M12 x 1.25 x 50	121 N·m (89.25 lb ft)
Bolt (2) retaining the engine block to the transmission housing	M12 x 1.25 x 50	121 N·m (89.25 lb ft)
Bolt (3) retaining the engine block to the transmission housing	M12 x 1.25 x 90	121 N·m (89.25 lb ft)

Engine - Remove

⚠ WARNING

Heavy objects!

Lift and handle all heavy components using lifting equipment with adequate capacity. Always support units or parts with suitable slings or hooks. Make sure the work area is clear of all bystanders. Failure to comply could result in death or serious injury.

W0398A

⚠ WARNING

Avoid injury!

Handle all parts carefully. Do not place your hands or fingers between parts. Use Personal Protective Equipment (PPE) as indicated in this manual, including protective goggles, gloves, and safety footwear.

Failure to comply could result in death or serious injury.

W0208A

Prior operation:

Hood - Remove (90.100).

Side panels - Remove (90.100).

Fuel tank - Remove (10.216).

Fender - Remove (90.116).

Cab and platform - Remove (90.150).

1. Position wooden wedges (1) between the front axle and the front axle support (2) to prevent articulation.

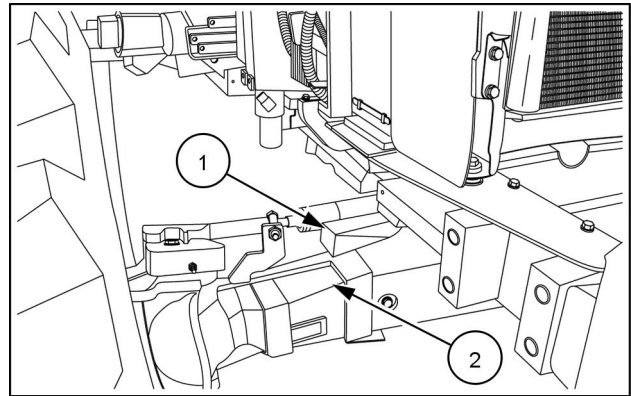

MOIL15TR01239AA 1

2. Drain the engine coolant as described in **Radiator - Drain fluid (10.400)**.
3. Position a container for transmission oil recovery under the transmission casing near the plug (1).
4. Remove the plug (1) and drain the transmission oil.

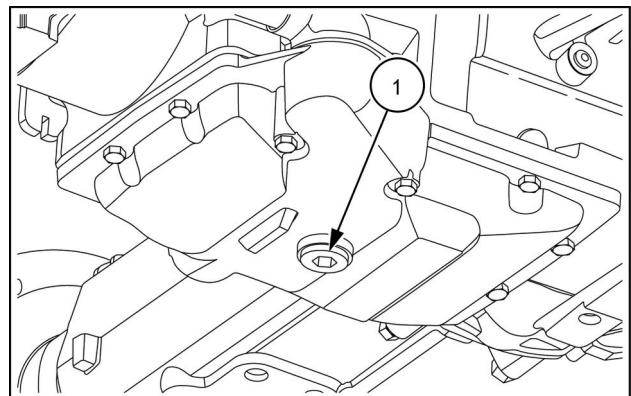

MOIL15TR01232AA 2

5. Loosen the retaining clamp (1) and disconnect the exhaust pipe (2) as described in **Selective Catalytic Reduction (SCR) muffler and catalyst - Remove (10.500)**.

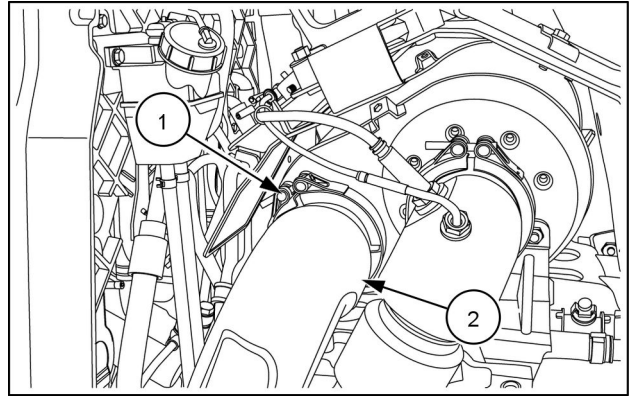

MOIL15TR00525AA 3

6. Disconnect the hydraulic fitting (3) on the capacitor (4) and loosen (1) the retaining clamp.
7. Disconnect the sensor wiring (2).

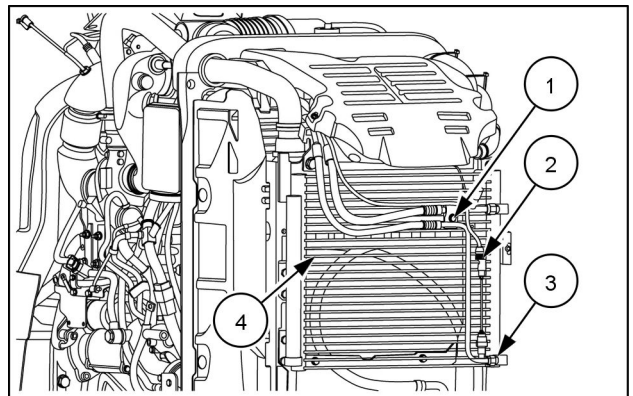

MOIL15TR01231AA 4

8. Loosen the retaining nuts and remove the plate (1) retaining the air-conditioning system lines (2).

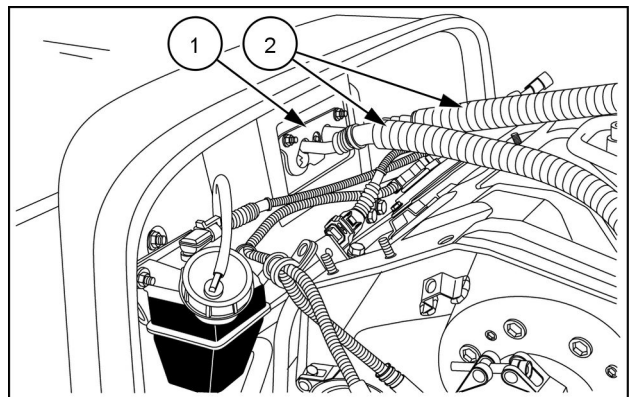

MOIL15TR00766AA 5

9. From the cab side, disconnect the air-conditioning pipes (2) from the cab to the supercharger, loosening the retaining nuts (1).

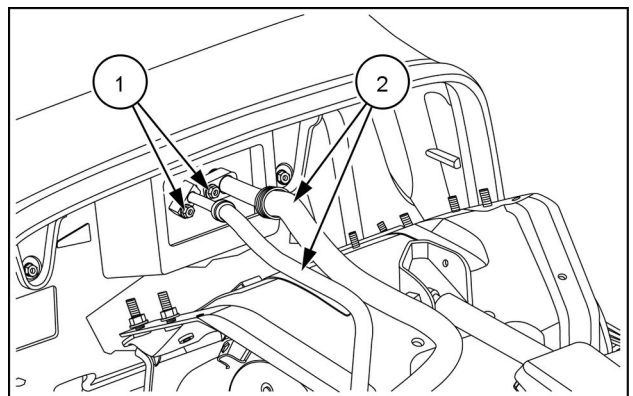

MOIL15TR00764AA 6

10. Release the lines loosening the retaining clamp (1) screw.

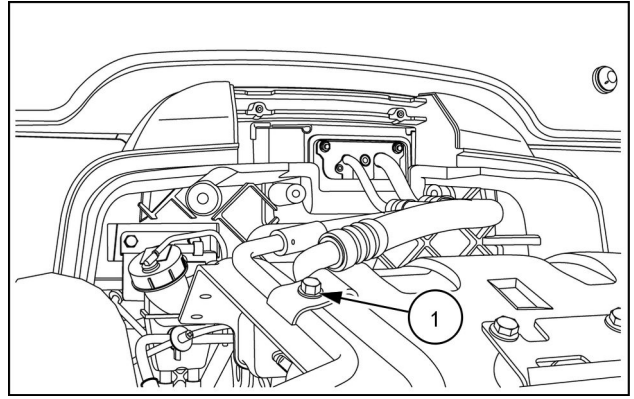

MOIL15TR00326AA 7

11. Remove the air filter (1), see **Air cleaner - Remove (10.202)**.

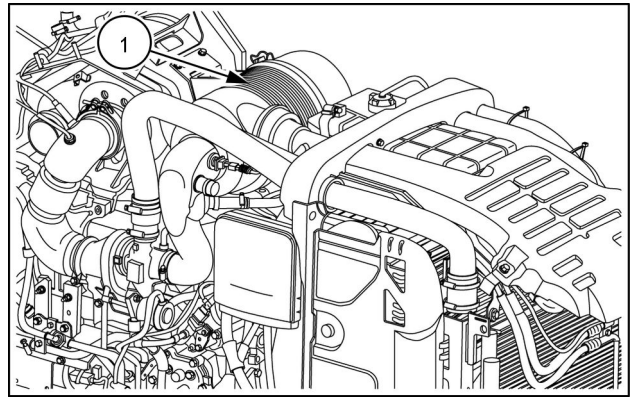

MOIL15TR01233AA 8

12. Loosen the fixing clamps (3) and disconnect the pipe (1) from the turbine to the radiator in the aftercooler.
13. Remove the air conditioning pipe (2) from the capacitor to the cab.

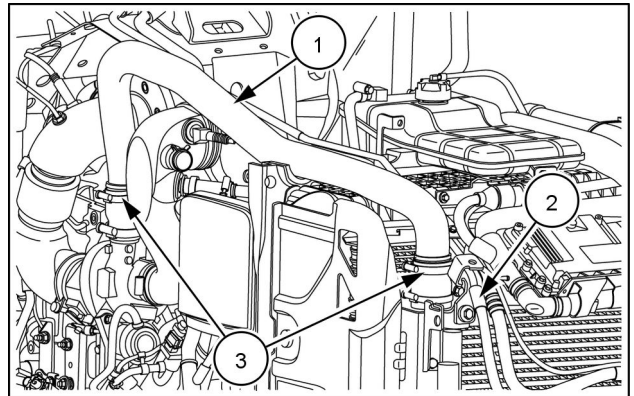

MOIL15TR01234AA 9

14. Disconnect the coupling (2) and loosen the retaining clamp (1).
15. Remove the air conditioning pipe (4) from the compressor (3).

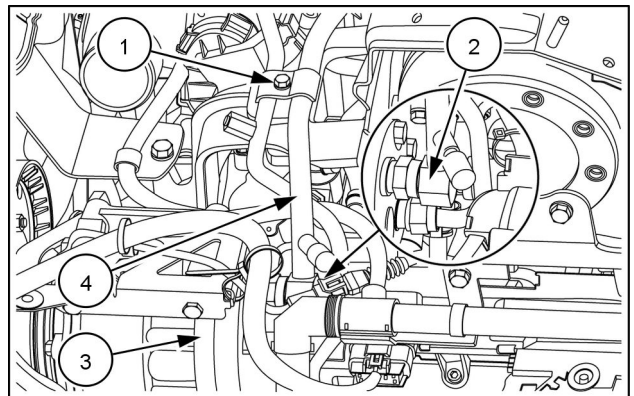

MOIL15TR01226AA 10

16. Loosen the retaining clamps **(2)** and remove the pipe **(1)** between the aftercooler radiator and the engine.

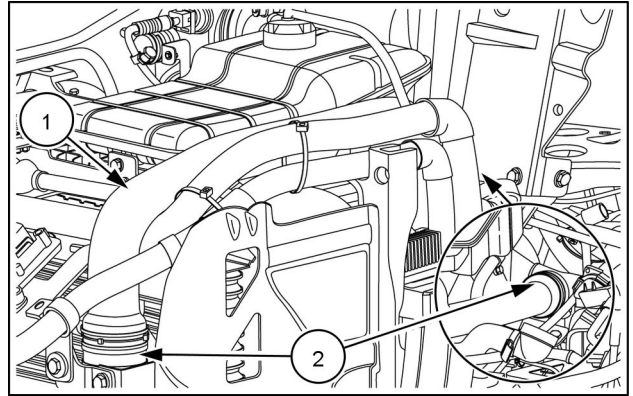

MOIL15TR01235AA 11

17. Disconnect the electrical connections **(1)** of the inlet temperature sensor of the Diesel Oxidation Catalyst DOC and the electrical connections of the NOx electronic control unit **(2)**.

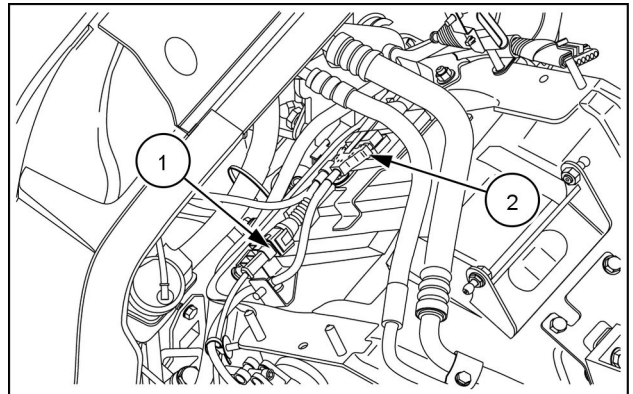

MOIL15TR00710AA 12

18. Loosen the clamp **(5)** retaining the diesel exhaust fluid dosing module **DEF/AdBLUE® (6)**.

19. Leaving the lines and electrical connection connected, remove the diesel exhaust fluid dosing module **DEF/AdBLUE® (6)** from the diesel oxidation catalyst (DOC) **(1)** and move it on one side.

20. Disconnect the electrical connection **(2)** of the coolant control valve **(3)** and the hydraulic lines **(4)**.

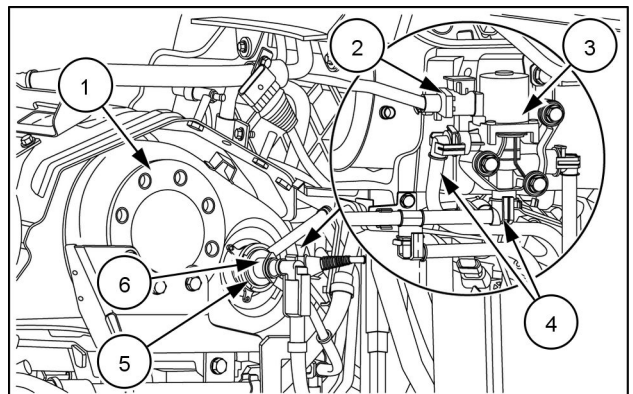

MOIL15TR01236AA 13

21. Disconnect the inlet pipe **(5)** of the filter loosening the retaining clamps.

22. Disconnect the hydraulic fitting **(3)** of the heat exchanger pipe.

23. Loosen and remove the retaining clamp **(4)**.

24. Loosen the rear retaining bolts **(2)** of the front transmission drive shaft guard **(1)**.

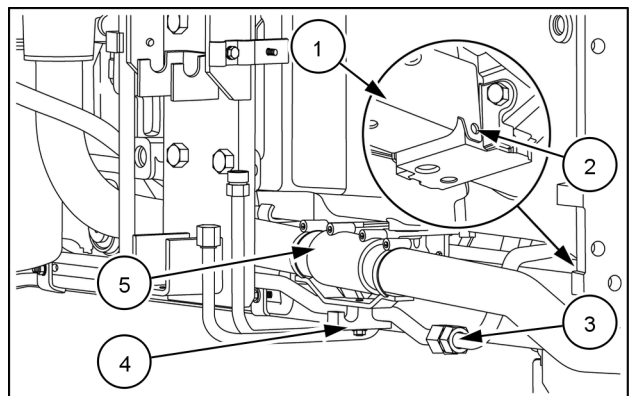

MOIL15TR01238AA 14

25. Disconnect the oil delivery line (2) to the control valves.
26. Release the steering cylinder control lines from the retaining clamps (4) and disconnect the hydraulic fittings (5) to remove them.
27. Loosen the front retaining bolts (1) from the front transmission drive shaft guard.
28. Disconnect the hydraulic fitting (3) of the oil pipe.

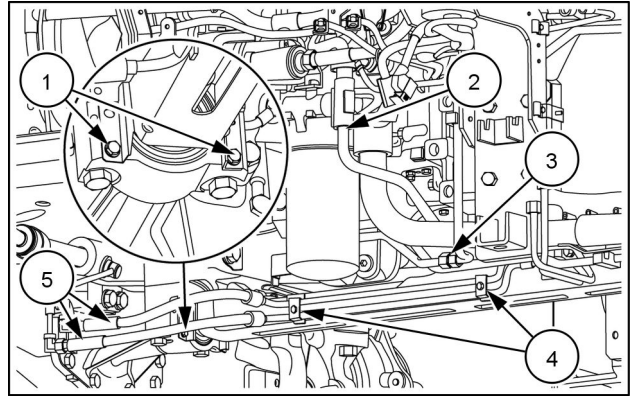

MOIL15TR01237AA 15

29. Remove the front transmission drive shaft (1) as described in **Front drive shaft - Remove (23.314)**.

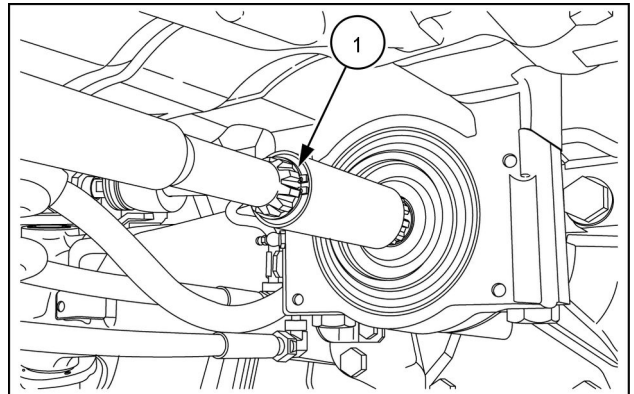

MOIL15TR01371AA 16

30. Remove the retaining clamp (5) to release the lines.
31. Remove the sleeve (1) from the oil pump to the oil filter.
32. Disconnect the hydraulic connections (3) and (6).
33. Loosen the retaining bolts (2) and remove the oil filter unit (4).

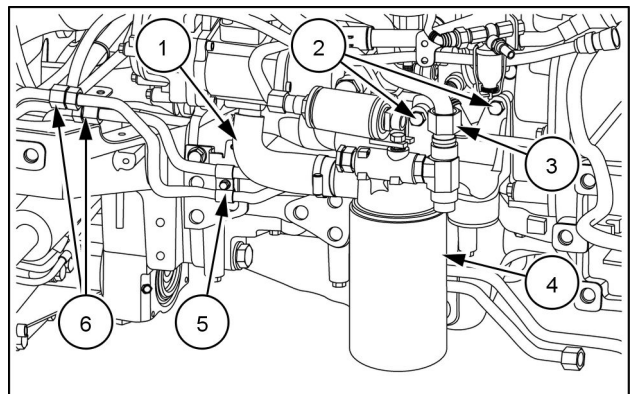

MOIL15TR01227AA 17

34. On the right-hand side of the engine disconnect the hydraulic connections (4) and (2) of the lines to the hydraulic steering system control valve.
35. Loosen the retaining bolts (1) of the filter support and remove the hydraulic steering system oil filter unit (3).
36. Remove the hydraulic steering system filter unit.

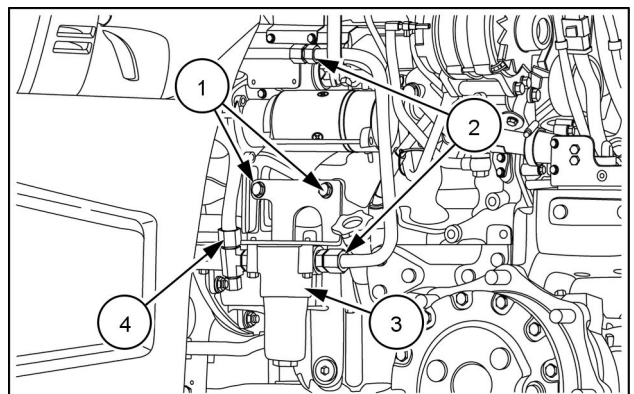

MOIL15TR01221AA 18

37. Remove the protective grille (1).

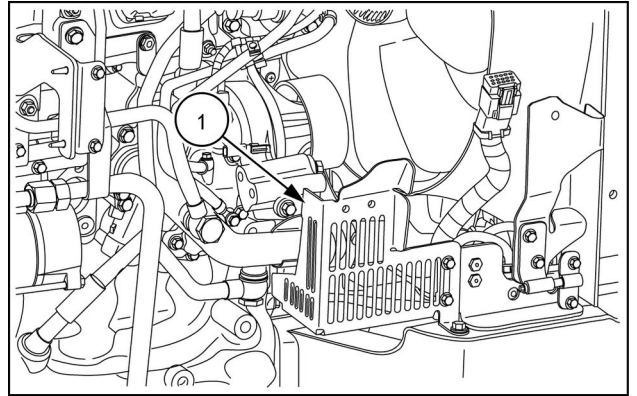

MOIL15TR00544AA 19

38. Disconnect the cab heating pipes (1).
39. Loosen the retaining clamp (2) and disconnect the line (3) from the conveyor.

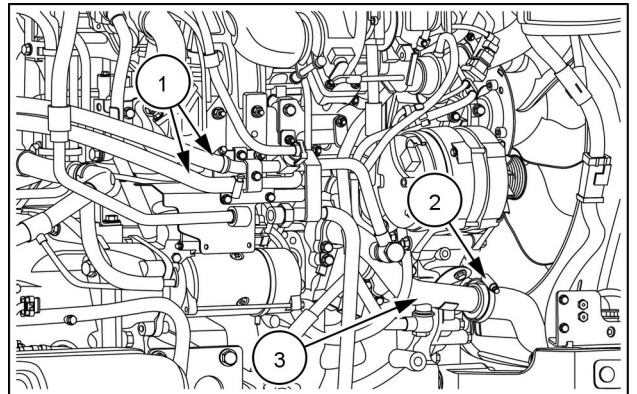

MOIL15TR01222AA 20

40. Loosen the retaining clamp (2) and disconnect the pipe (1) from the conveyor (3).

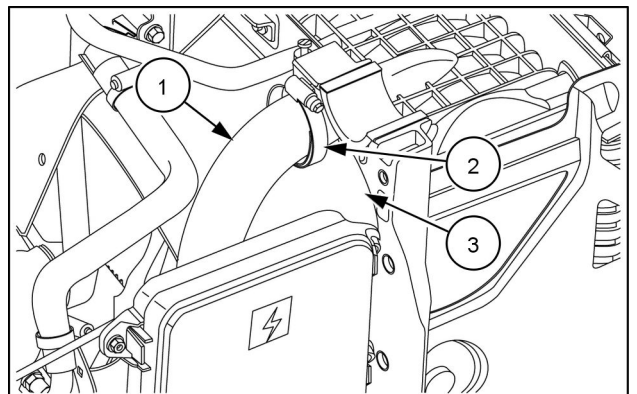

MOIL15TR01223AA 21

41. Remove the starter motor (1) on the right-hand side of the engine.

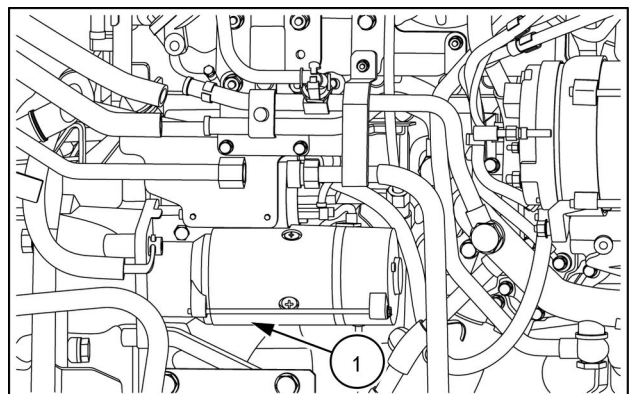

MOIL15TR01224AA 22

42. Remove the hood support (2), as described in **Hood pivoting system - Remove (90.100)**.
43. Remove the Diesel Oxidation Catalyst (DOC) (1) as described in **Diesel Oxidation Catalyst (DOC) - Remove (10.500)**.

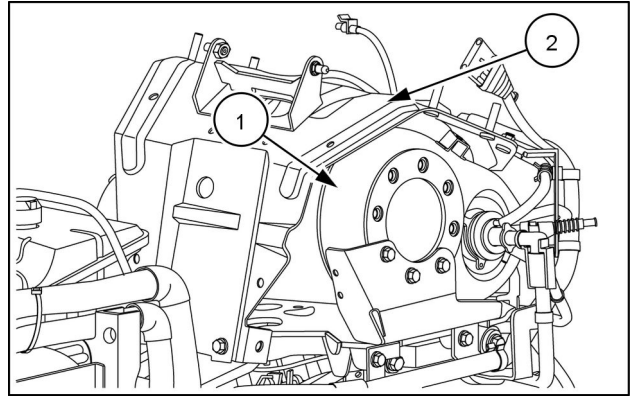

MOIL15TR01225AA 23

44. Disconnect the wiring harness starting from the engine control unit (1) up to the maxi fuse box taking care to disconnect the temperature and pressure sensors placed on the engine.
45. Collect the wiring on both sides of the engine and remove it.

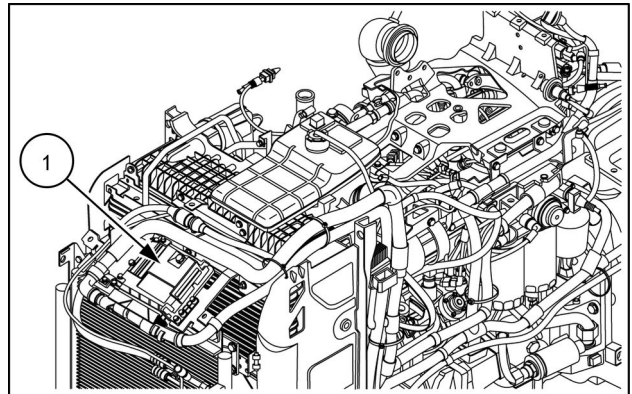

MOIL15TR01228AA 24

46. Hook the rear part of the engine onto a hoist using chains or hoisting ropes (apply two eyebolts, one to the right and one to the left, on the upper part of the flange containing the flywheel). Position a fixed jack stand (2) under the clutch housing (1) near the flange coupling on the engine.

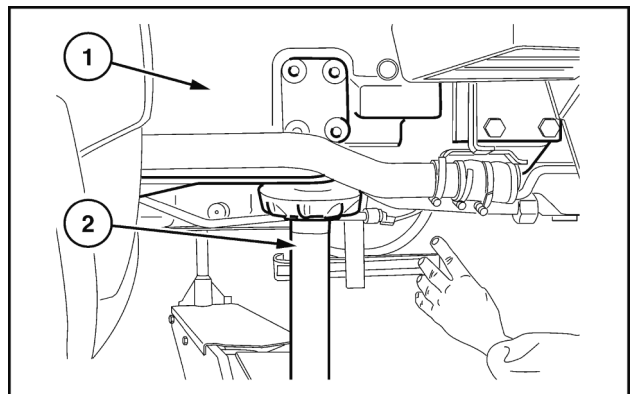

WLAPL4S10C129A 25

47. Position the movable tool for dismantling tractors 38003114 (2) with the support bracket and adapter plate under the engine. Place a wooden block (1) in the contact points between the tool and the engine.

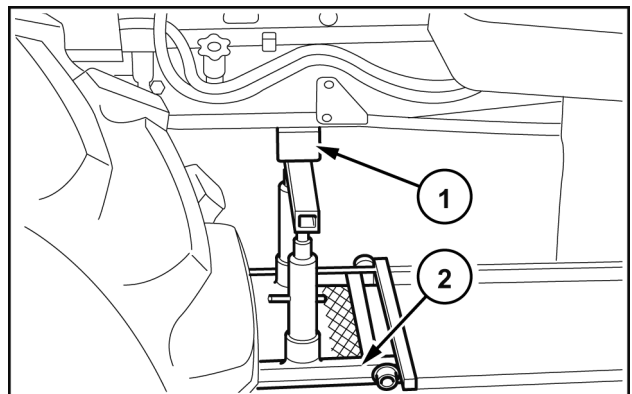

WLAPL4S10C140A 26

48. Remove the retaining screws (1) between the engine casing (2) and the transmission casing (3).

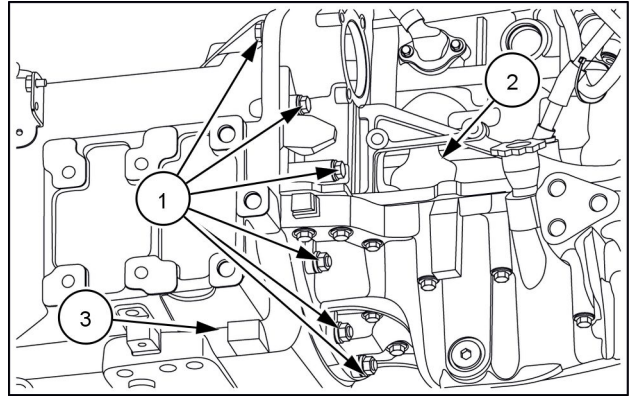

MOIL15TR01229AA 27

49. Separate the engine (1) from the transmission using the specific tool 380003114 (2).

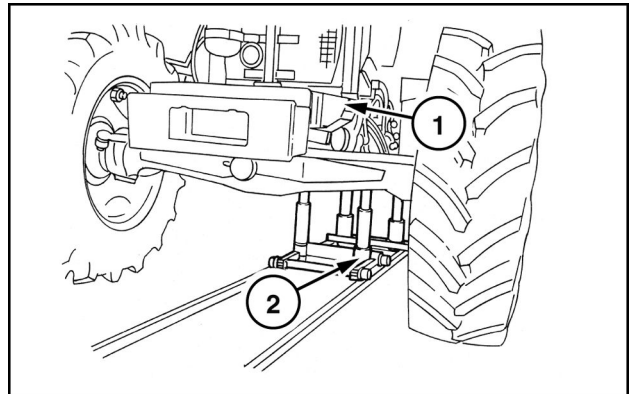

WLAPL4S10C131AA 28

50. Insert the fixed jack stand (1) under the ballast support and secure the front wheels with wooden wedges (2).

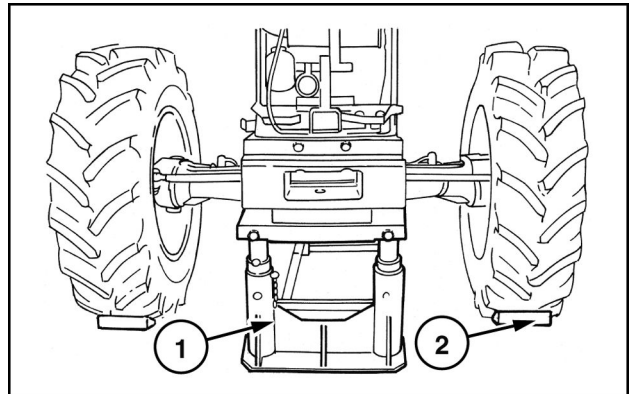

WLAPL4S10C132AA 29

51. Position a fixed jack stand (3) under the splined support (1) of the front axle Power Take-Off (PTO), placing a wooden plug (2) between parts (3) and (1).

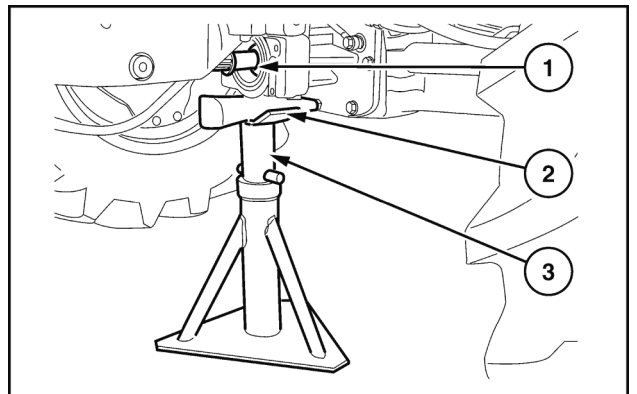

WLAPL4S10C133A 30

52. Position a jack stand under the rear part of the engine so as to be able to release the hoist with the coupling device in complete safety. Add a rope or chain **(1)** also on the front of the engine. Take up the slack with the lifting device, keeping the engine balanced.

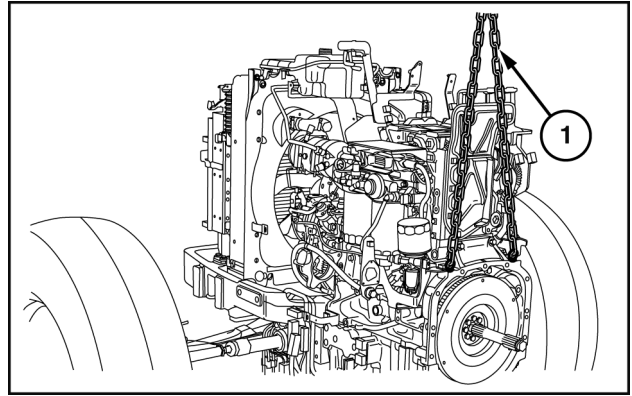

WLAPL4S10C136A 31

53. Remove the screws **(1)** and **(3)** that retain the front suspension **(2)** to the engine block **(4)**. Collect the related washers.

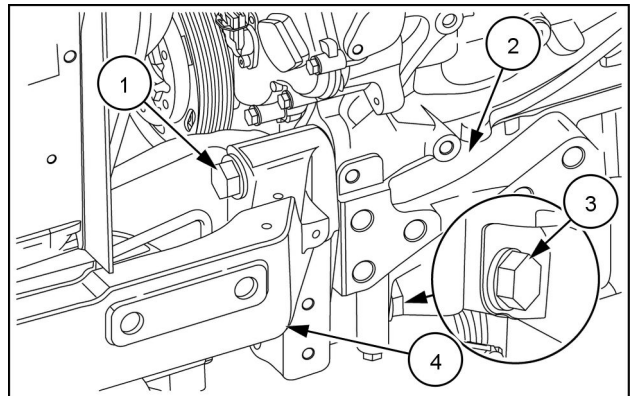

MOIL15TR01702AA 32

54. Check that there are no parts still connected or that interfere with the aftercooler group and the engine.
55. Slowly remove the engine **(2)** from the front suspension **(3)** avoiding incorrect movements to prevent damaging the fan **(1)** and the radiator body.

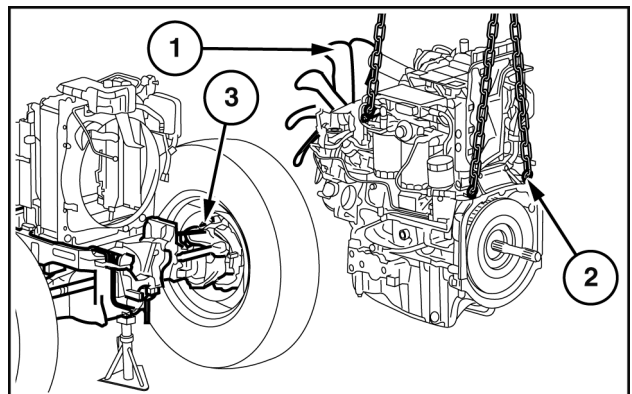

WLAPL4S10C138A 33

Engine - Install

⚠ WARNING

Heavy objects!

Lift and handle all heavy components using lifting equipment with adequate capacity. Always support units or parts with suitable slings or hooks. Make sure the work area is clear of all bystanders.

Failure to comply could result in death or serious injury.

W0398A

⚠ WARNING

Avoid injury!

Handle all parts carefully. Do not place your hands or fingers between parts. Use Personal Protective Equipment (PPE) as indicated in this manual, including protective goggles, gloves, and safety footwear.

Failure to comply could result in death or serious injury.

W0208A

Prior operation:

Engine - Remove (10.001).

1. Slowly position the engine (2) on the front suspension (3) avoiding incorrect movements to prevent damaging the fan (1) and the radiator body.

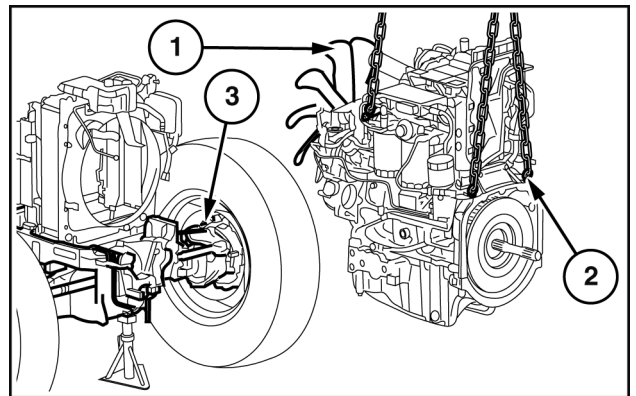

WLAPL4S10C138A 1

2. Secure the front suspension (4) to the engine block (2) tightening the screws (1) and (3) as described in Engine - Torque (10.001).

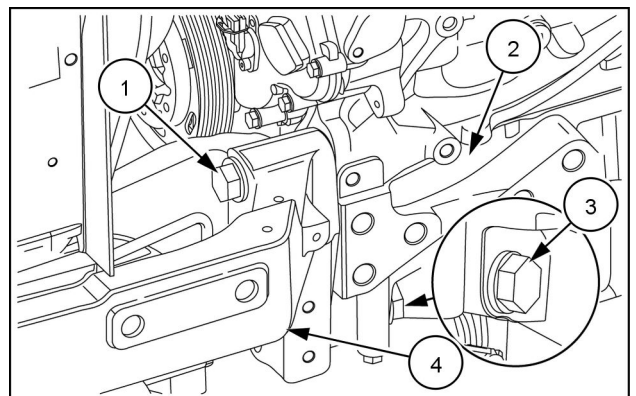

MOIL15TR01702AA 2

- Using the special tool **380003114 (2)** move the whole engine lock front suspension **(1)** towards the transmission casing.

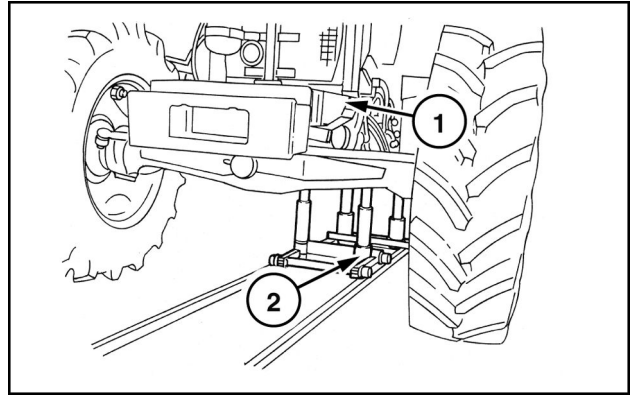

WLAPL4S10C131AA 3

- Secure the engine **(2)** to the transmission casing **(3)** tightening the screws **(1)** as described in **Engine - Torque (10.001)**.

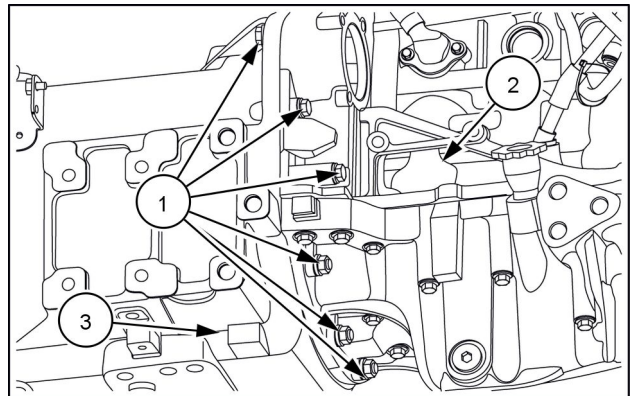

MOIL15TR01229AA 4

- Remove the special tool **(2) 380003114** recovering the adapter plate **(1)**.

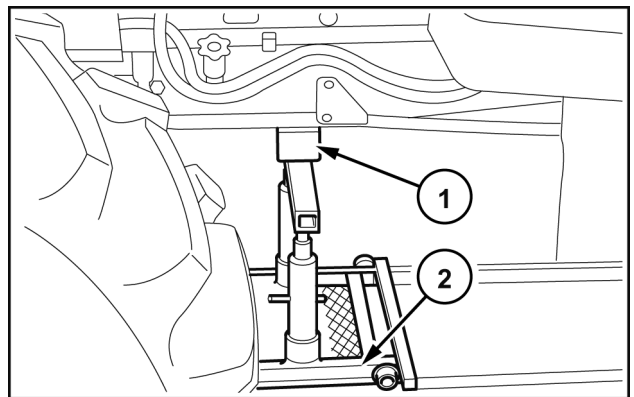

WLAPL4S10C140A 5

- Starting from the engine control unit **(1)**, lay out the electric wiring harness restoring the connections of the temperature and pressure sensors placed on the engine.

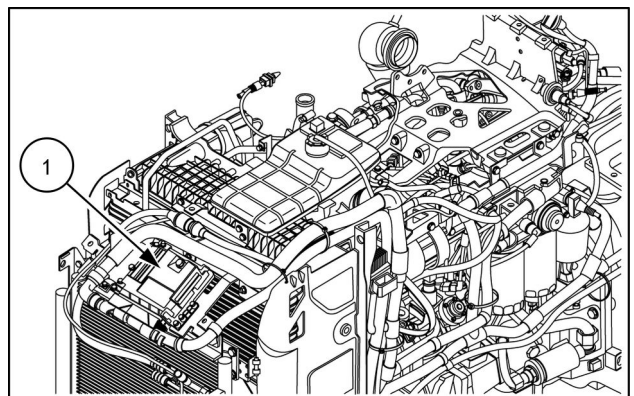

MOIL15TR01228AA 6

7. Position and secure the catalyst (1) as described in **Diesel Oxidation Catalyst (DOC) - Install (10.500)**.
8. Position the hood support (2), as described in **Hood pivoting system - Install (90.100)**.

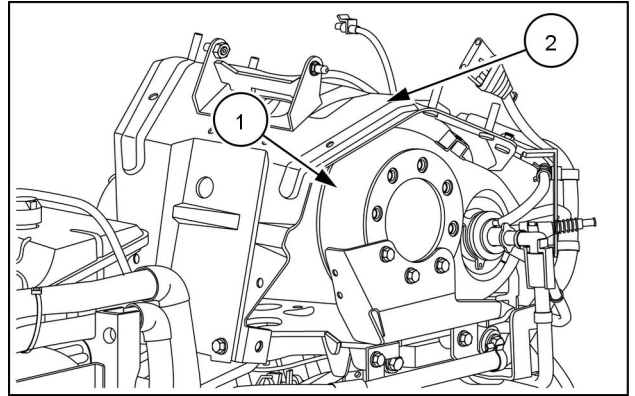

MOIL15TR01225AA 7

9. Position and secure the starter motor (1) on the right-hand side of the engine.

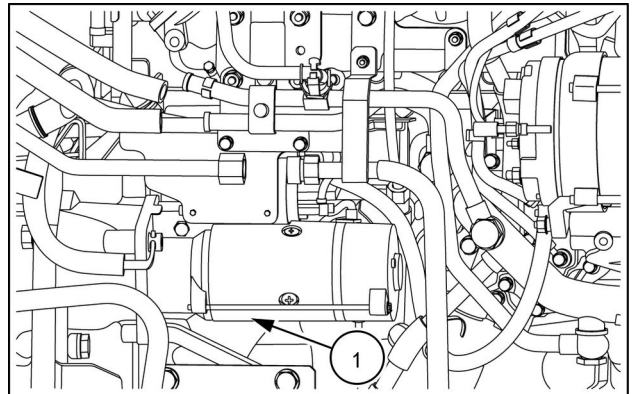

MOIL15TR01224AA 8

10. Connect the pipe (1) to the conveyor (3) and tighten the clamp (2) to secure it.

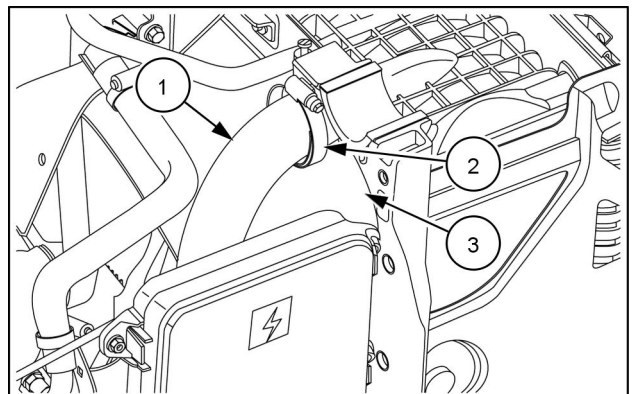

MOIL15TR01223AA 9

11. Connect the cab heating pipes (1).
12. Connect the pipe (3) to the conveyor and tighten the clamp (2) to secure it.

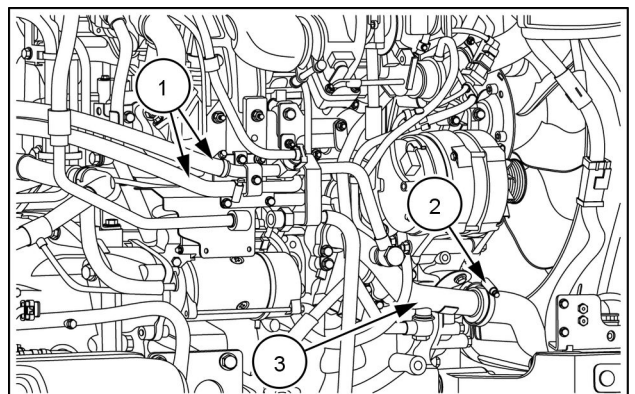

MOIL15TR01222AA 10

13. Position and secure the protective grill (1).

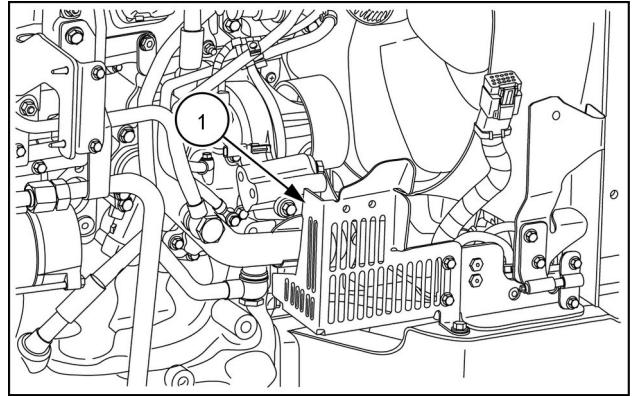

MOIL15TR00544AA 11

14. On the right-hand side of the engine position the hydraulic steering system oil filter unit (3) and tighten the retaining bolts (1) of the support.
15. Connect the hydraulic connections (2) and (4) of the lines to the hydraulic steering system control valve.

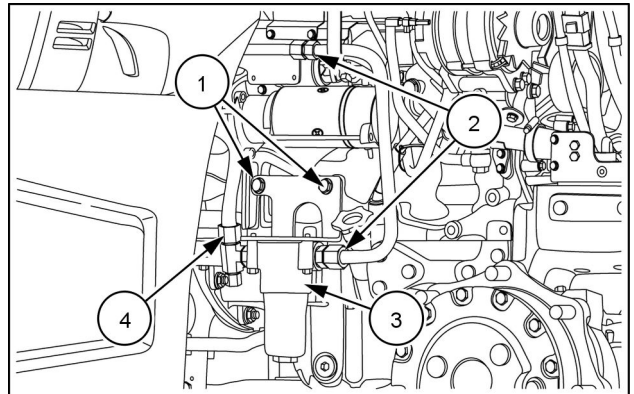

MOIL15TR01221AA 12

16. Position the oil filter unit (4) and tighten the retaining screws (2).
17. Connect the hydraulic connections (6) and (3).
18. Tighten the retaining clamp (5) to secure the lines.
19. Connect the sleeve (1) from the oil pump to the oil filter.

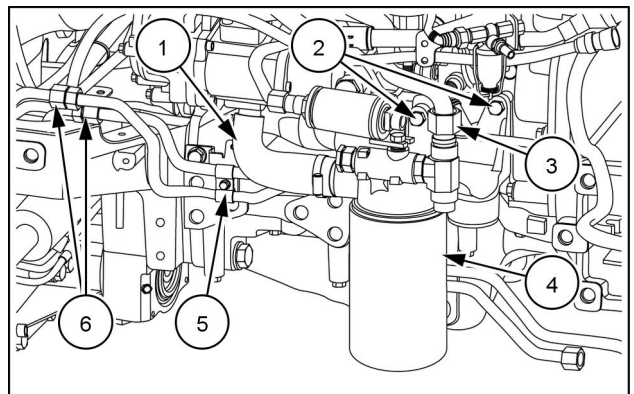

MOIL15TR01227AA 13

20. Fit the transmission drive shaft as described in **Front drive shaft - Install (23.314)**.

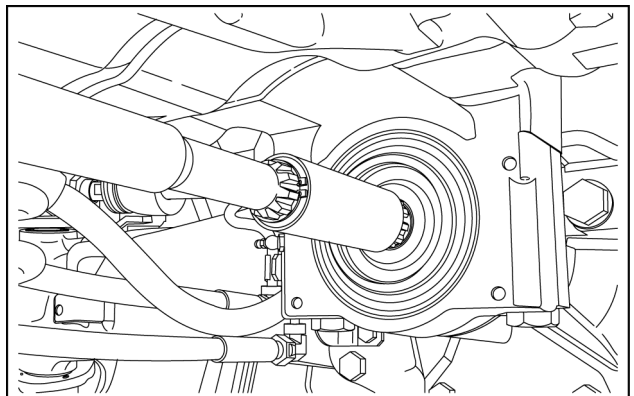

MOIL15TR01371AA 14

21. Connect the hydraulic fitting (3) in the oil pipe.
22. Screw the front retaining screws (1) of the front transmission drive shaft guard.
23. Screw the retaining clamps (4) to secure the steering cylinder control lines. Connect the hydraulic connections (5).
24. Connect the hydraulic oil delivery fitting (2) to the control valves.

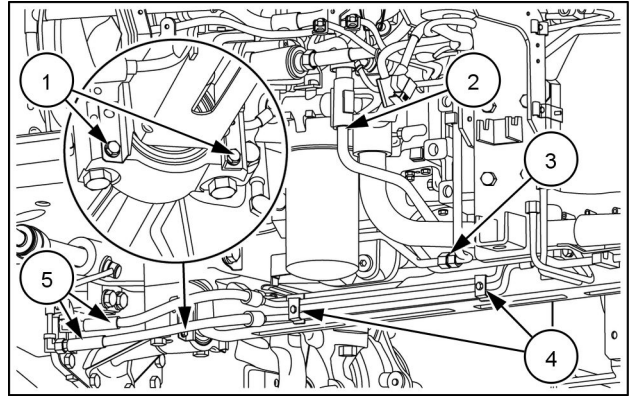

MOIL15TR01237AA 15

25. Screw the rear retaining bolts (2) of the front transmission drive shaft guard (1).
26. Connect the hydraulic fitting (3) of the heat exchanger pipe and secure it screwing the clamp (4).
27. Connect the filter intake pipe (5).

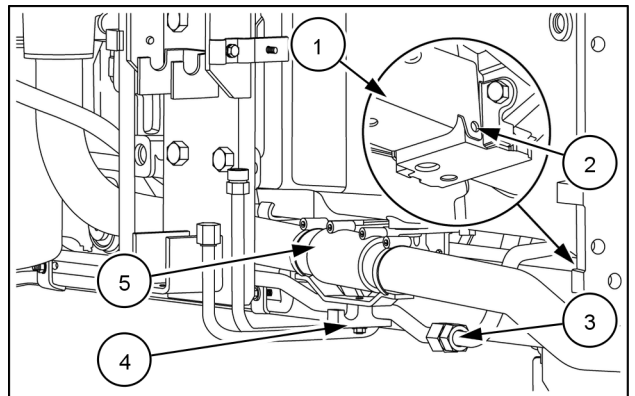

MOIL15TR01238AA 16

28. Insert the diesel exhaust liquid dosing module DEF/ AdBLUE® (6) in the Diesel Oxidation Catalyst (DOC) (1) and secure it tightening the clamp (5).
29. Connect the hydraulic fittings (3) from the coolant control valve (4).
30. Connect the electric wiring harness (2).

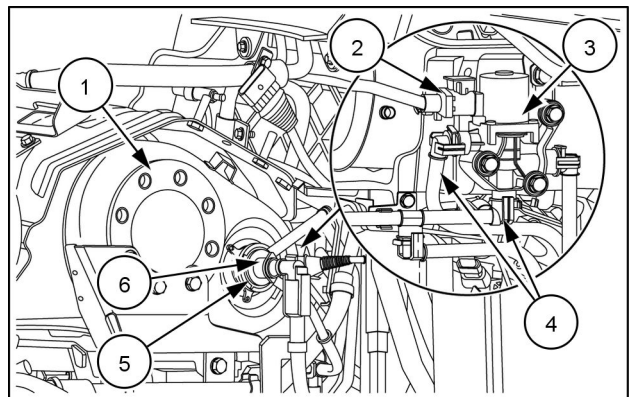

MOIL15TR01236AA 17

31. Connect the electrical connections (1) of the inlet temperature sensor to the DOC and the electrical connections of the NOx control module (2).

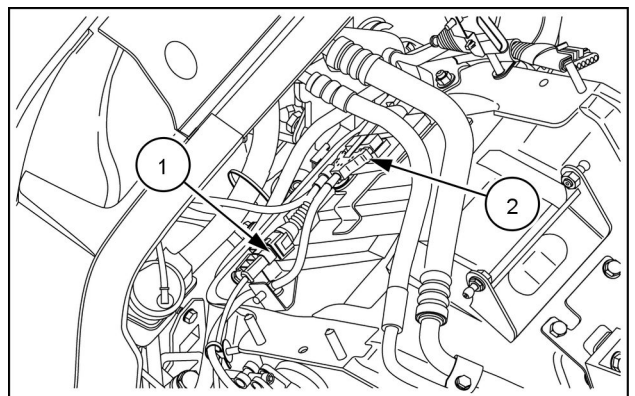

MOIL15TR00710AA 18

32. Position the pipe (1) from the after cooler radiator to the engine and secure it tightening the clamps (2).

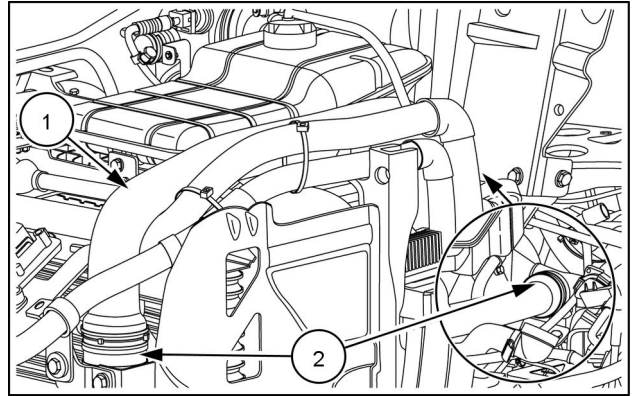

MOIL15TR01235AA 19

33. Position the air conditioning pipe (4) from the super-charger (3).
34. Connect the hydraulic coupling (2).
35. Tighten the retaining clamp (1) to secure the pipe.

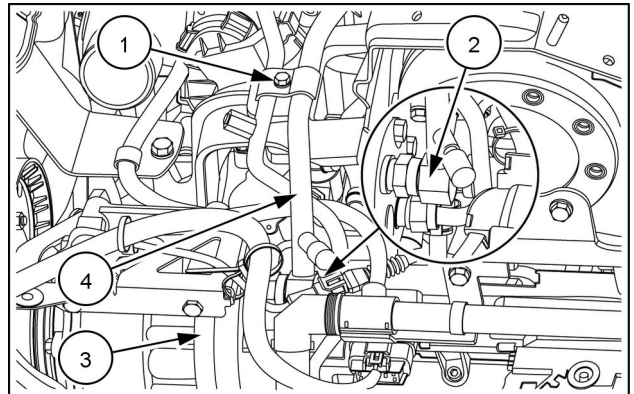

MOIL15TR01226AA 20

36. Position the air conditioned pipe (2) from the capacitor to the cab.
37. Connect the pipe (1) from the turbine to the aftercooler radiator and secure it screwing the clamps (3).

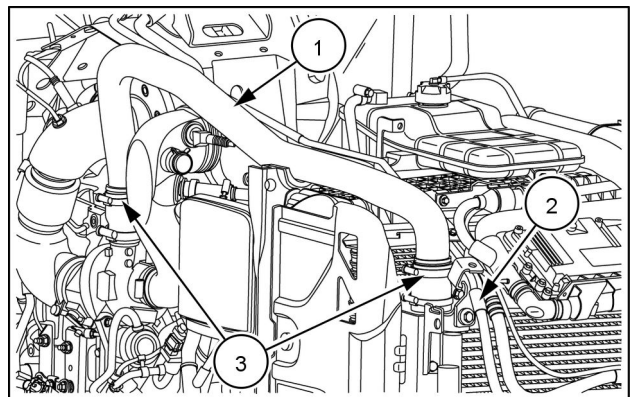

MOIL15TR01234AA 21

38. Install the air cleaner (1), as described in **Air cleaner - Install (10.202)**.

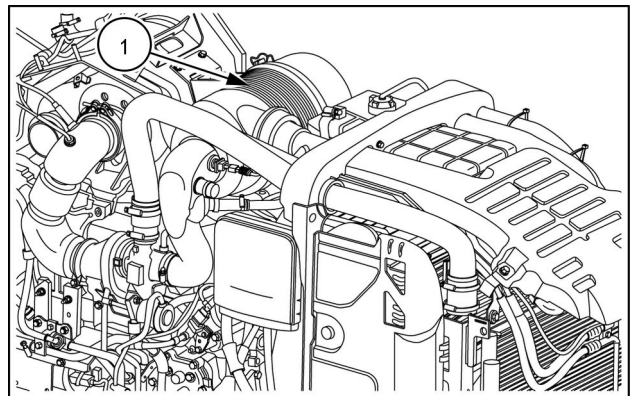

MOIL15TR01233AA 22



Suggest:

If the above button click is invalid.

Please download this document

first, and then click the above link

to download the complete manual.

Thank you so much for reading

39. From the cab side, connect the air-conditioning hoses (2) from the cab to the supercharger, tightening the retaining nuts (1).

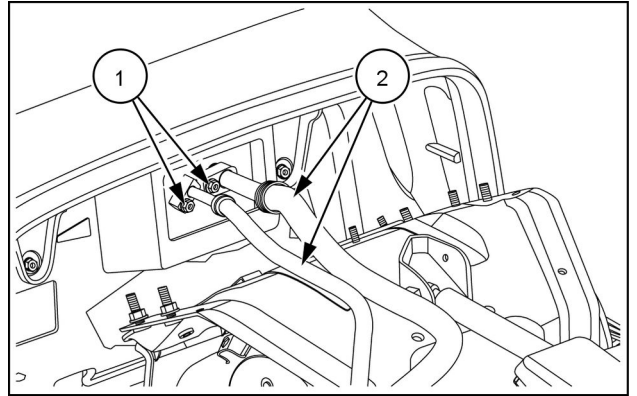

MOIL15TR00764AA 23

40. Fit the plate (1) securing the air-conditioning hoses (2) and tighten the retaining nuts.

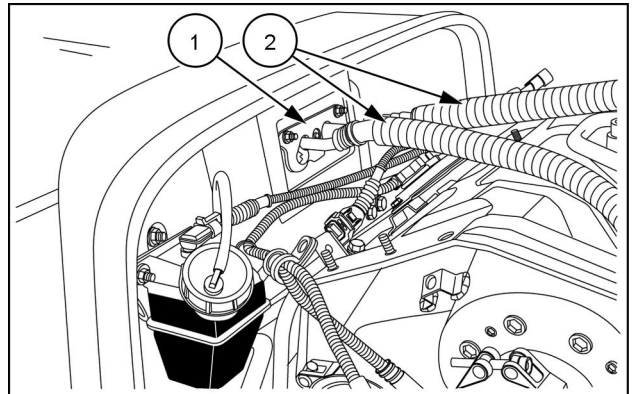

MOIL15TR00766AA 24

41. Secure the lines screwing the retaining clamp screw (1).

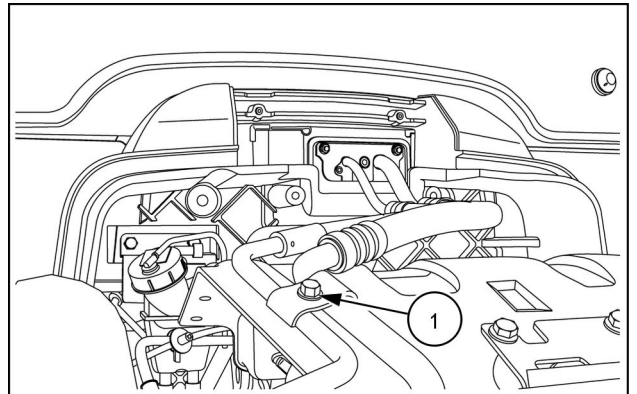

MOIL15TR00326AA 25

42. Connect the hydraulic fitting (3) on the capacitor (4) and tighten the (1) retaining clamp screw.

43. Connect the sensor wiring (2).

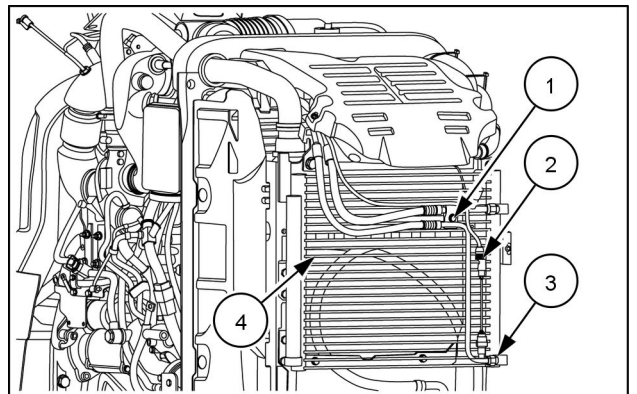

MOIL15TR01231AA 26

<https://www.ebooklibonline.com>

Hello dear friend!

Thank you very much for reading.

Enter the link into your browser.

The full manual is available for immediate download.

<https://www.ebooklibonline.com>