DX48, DX55 REPAIR MANUAL COMPLETE CONTENTS

SECTION 00 - GENERAL INFORMATION	2
SECTION 10 - ENGINE	3
SECTION 18 - CLUTCH	11
SECTION 21 - TRANSMISSION	12
SECTION 23 - FWD DRIVELINE	19
SECTION 25 - FWD FRONT AXLE	20
SECTION 27 - DIFFERENTIAL, REAR AXLE	21
SECTION 31 - POWER TAKE-OFF (PTO)	23
SECTION 33 - BRAKES	24
SECTION 35 - HYDRAULIC SYSTEM	24
SECTION 41 - STEERING	28
SECTION 44 - WHEELS AND TIRES	30
SECTION 55 - ELECTRICAL SYSTEM	31
SECTION 90 - PLATFORM	39

The following pages are the collation of the contents pages from each section and chapter of the DX48, DX55 Repair manual. Complete Repair part # 87367132.

The sections used through out all Case IH product Repair manuals may not be used for each product. Each Repair manual will be made up of one or several books. Each book will be labeled as to which sections are in the overall Repair manual and which sections are in each book.

The sections listed above are the sections utilized for the DX48, DX55 Tractors.

SECTION 00 - GENERAL INFORMATION

Chapter 1 - General Information

CONTENTS

Section	Description	Page
	Precautionary Statements	2
	Safety	3
	Safety Decals	6
	Instruction Decals	9
	Decal Placement Guide	12
	Ecology and the Environment	14
	Universal Symbols	15
	General Information	16
	Minimum Hardware Tightening Torques	17
	Lubrication	19
	Recommended Lubricants	20
	Lubrication and Maintenance Chart	21
	Lubrication Fittings	22
	Diesel Fuel	22
	Specifications	23
	Transmission Speeds	26
	General Dimensions	31
	Wheel Tread Settings	34
	Front Axle (2WD) Adjustable	34
	Liquid Ballast	38
	Tire Pressure	38
	Rear Tire Liquid	38

SAFETY

PRECAUTIONARY STATEMENTS

A careful operator is the best operator. Most accidents can be avoided by observing certain precautions. To help prevent accidents, read the following precautions before operating this equipment. Equipment should be operated only by those who are responsible and instructed to do so.

Carefully review the procedures given in this manual with all operators. It is important that all operators be familiar with and follow safety precautions.

THE TRACTOR

1. Read the Operator's Manual carefully before using the tractor. Lack of operating knowledge can lead to accidents.
2. Use an approved roll bar and seat belt for safe operation. Overturning a tractor without a roll bar can result in death or injury. If your tractor is not equipped with a roll bar and seat belt, see your Case IH Dealer.
3. Always use the seat belt. The only instance when the seat belt should not be used is if the roll bar has been removed from the tractor or folding ROPS is in down position.
4. If a front end loader is to be installed, always use a FOPS (Falling Object Protective Structure) canopy to avoid injury from falling objects.
5. Use the handholds and step plates when getting on and off the tractor to prevent falls. Keep steps and platform cleared of mud and debris.
6. Do not permit anyone but the operator to ride on the tractor. There is no safe place for extra riders.
7. Keep all safety decals clean of dirt and grime, and replace all missing, illegible, or damaged safety decals. See the list of decals in the Decal section of this manual.
3. Keep the tractor and equipment, particularly brakes and steering, maintained in a reliable and satisfactory condition to ensure your safety and comply with legal requirements.
4. Keep open flame or cold weather starting aids away from the battery to prevent fires or explosions. Use jumper cables according to instructions to prevent sparks which could cause explosion. Do not use chemical starting aids on glow plug equipped tractors.
5. Stop the engine before performing any service on the tractor.
6. Escaping hydraulic/diesel fluid under pressure can penetrate the skin causing serious injury. If fluid is injected into the skin, obtain medical attention immediately or gangrene may result.
 - DO NOT use your hand to check for leaks. Use a piece of cardboard or paper to search for leaks.
 - Stop the engine and relieve pressure before connecting or disconnecting lines.
 - Tighten all connections before starting the engine or pressurizing lines.
7. Do not modify or permit anyone else to modify or alter this tractor or any of its components or functions without first consulting a Case IH Dealer.

SERVICING THE TRACTOR

1. The cooling system operates under pressure which is controlled by the radiator cap. It is dangerous to remove the cap while the system is hot. Always turn the cap slowly to the first stop and allow pressure to escape before removing the cap entirely.
2. Keep any type of open flame away from the tractor and do not smoke while refueling. Wait for the engine to cool before refueling.
8. The fuel oil in the injection system is under high pressure and can penetrate the skin. Unqualified persons should not remove or attempt to adjust a pump, injector, nozzle, or any other part of the fuel injection system. Failure to follow these instructions can result in serious injury.
9. Continuous long-term contact with used engine oil may cause skin cancer. Avoid prolonged contact with used engine oil. Wash skin promptly with soap and water.

<https://www.ebooklibonline.com>

Hello dear friend!

Thank you very much for reading.

Enter the link into your browser.

The full manual is available for immediate download.

<https://www.ebooklibonline.com>

10. Some components of your tractor, such as gaskets and friction surfaces (brake linings, clutch linings, etc.) may contain asbestos. Breathing asbestos dust is dangerous to your health. You are advised to have any maintenance or repair on such components carried out by an authorized Case IH Dealer. However, if service operations are to be undertaken on parts that contain asbestos, the essential precautions listed below must be observed:
 - Work out of doors or in a well ventilated area.
 - Dust found on the tractor or produced during work on the tractor should be removed by extraction, not by blowing.
 - Dust waste should be dampened, placed in a sealed container, and marked to ensure safe disposal.
 - If any cutting, drilling, etc. is attempted on materials containing asbestos, the item should be dampened and only hand tools or low speed power tools used.
8. If the power steering or engine ceases operating, stop the tractor immediately.
9. Pull only from the drawbar or the lower link drawbar in the down position. Use only a drawbar pin that locks in place. Pulling from the tractor rear axle or any point above the axle may cause the tractor to upset.
10. If the front end of the tractor tends to rise when heavy implements are attached to the three-point hitch, install front end weights. Do not operate the tractor with a light front end.
11. Always set the hydraulic selector lever in position control when attaching or transporting equipment. Ensure hydraulic couplers are properly mounted and will disconnect safely in case of accidental detachment of implement.
12. Do not leave equipment in the raised position.
13. Use the flasher/turn signal lights and SMV signs when traveling on public roads both day and night (unless prohibited by law).
14. When operating at night, adjust lights to prevent blinding oncoming drivers.

OPERATING THE TRACTOR

1. Before starting the tractor, apply the parking brake, place the PTO lever in the "OFF" position, the lift control lever in the down position, the remote control valve levers in the neutral position, and the transmission in neutral.
2. Always sit in the tractor seat when starting the engine or operating controls. Do not start the engine or operate controls while standing beside the tractor.
3. Do not bypass the neutral start switches. Consult your Case IH Dealer if your neutral start controls malfunction. Use jumper cables only in the recommended manner. Improper use can result in tractor runaway.
4. Avoid accidental contact with the gear shift lever while the engine is running, as this can cause unexpected tractor movement.
5. Before getting off the tractor, disengage the PTO, turn the engine off, and apply the parking brake. Never get off the tractor while it is in motion.
6. Do not park the tractor on a steep incline.
7. Do not operate the tractor engine in an enclosed building without adequate ventilation. Exhaust fumes can cause death or illness.

DRIVING THE TRACTOR

1. Watch where you are going, especially at row ends, on roads, around trees and low hanging obstacles.
2. To avoid upsets, drive the tractor with care and at a safe speed. Use extra caution when operating over rough ground, when crossing ditches or slopes, and when turning corners.
3. To provide two-wheel braking, lock tractor brake pedals together when transporting on roads.
4. Do not coast or free wheel down hills. Use the same gear when going downhill as is used when going uphill.
5. Any towed vehicle with a total weight exceeding that of the towing tractor should be equipped with brakes for safe operation.
6. If the tractor becomes stuck or the tires become frozen to the ground, back up the tractor to prevent upset.
7. Always check overhead clearance, especially when transporting the tractor.
8. When operating at night, adjust lights to prevent blinding oncoming drivers.

OPERATING THE PTO

1. When operating PTO driven equipment, shut off the engine and wait until the PTO stops before getting off the tractor and disconnecting the equipment.
2. Do not wear loose clothing when operating the power take-off or when near rotating equipment.
3. When operating stationary PTO driven equipment, always place range gear shift lever in neutral, apply the tractor parking brake, and block the rear wheels front and back.
4. To avoid injury, do not clean, adjust, unclog, or service PTO driven equipment when the tractor engine is running.
5. Ensure the PTO master shield is installed at all times. Always replace the PTO shield cap when the PTO is not in use.
6. Wipe up spilled fuel immediately.
7. Always tighten the fuel tank cap securely.
8. If the original fuel tank cap is lost, replace it with a Case IH approved cap. A non-approved, proprietary cap may not be safe.
9. Keep equipment clean and properly maintained.
10. Do not drive equipment near open fires.
11. Never use fuel for cleaning purposes.
12. Arrange fuel purchases so that winter grade fuels are not held over and used in the spring.

DIESEL FUEL

1. UNDER NO CIRCUMSTANCES should gasoline, alcohol, or blended fuels be added to diesel fuel. These combinations can create an increased fire or explosive hazard. Such blends are more explosive than pure gasoline in a closed container such as a fuel tank. DO NOT USE THESE BLENDS.
2. Never remove the fuel cap or refuel with the engine running or hot.
3. Do not smoke while refueling or when standing near fuel.
4. Maintain control of the fuel filler pipe nozzle when filling the tank.
5. Do not fill the fuel tank to capacity. Allow room for expansion.

SAFETY FRAME (ROPS)

Your Case IH tractor is equipped with a safety frame. It must be maintained in a serviceable condition. Be careful when driving through doorways or working in confined spaces with low headroom.

UNDER NO CIRCUMSTANCES should you:

- modify, drill, or alter the safety frame in any way. Doing so may render you liable to legal prosecution.
- attempt to straighten or weld any part of the main frame or retaining brackets which have suffered damage. Doing so may weaken the structure and endanger your safety.
- secure any parts on the main frame or attach your safety frame with anything other than the special high tensile bolts and nuts specified.
- attach chains or ropes to the main frame for pulling purposes.
- take unnecessary risks even though your safety frame affords you the maximum protection possible.

SECTION 10 - ENGINE

Chapter 1 - Engine Dismantling Sequence

CONTENTS

Section	Description	Page
	Specifications	6
	Metric Bolt Torque Specifications	10
	Special Tools	11
	Compression Test and Tools	12
	Description of Operation - General Information	13
	Troubleshooting	14
	Cylinder Head and Valve Train Components	18
	Cylinder Block Assembly	18
	Engine	20
	Removal	20
	Installation	21
	Overhaul	22
	Engine	22
	Alternator	22
	Removal	22
	Cooling Fan and Pulley	22
	Removal	22
	Glow Plug and Connector	22
	Removal	22
	Nozzle/Holder	23
	Removal	23
	Fuel Injection Pipe	23
	Removal	23
	Injector	23
	Removal	23
	Water Pump	23
	Removal	23
	Cover/Intake Manifold/Exhaust Manifold	24
	Removal	24
	External Oil Pipe	24
	Removal	24
	Rocker Assembly	25
	Removal	25

SECTION 10 - ENGINE - CHAPTER 1

Section	Description	Page
	Cylinder Head	25
	Removal	25
	Tappets	25
	Removal	25
	Fuel Stop Solenoid	26
	Removal	26
	Timing Gear Cover	26
	Removal	26
10 106	Timing Gears and Camshaft	28
	Removal	28
	Front End Plate	29
	Removal	29
10 102	Oil Sump	29
	Removal	29
	Oil Suction Pipe and Strainer	30
	Removal	30
10 110	Balancer Assembly	30
	Removal	30
10 105	Connecting Rods, Bearings and Pistons, Rings	31
	Removal	31
10 103	Flywheel	31
	Removal	31
	Backplate and Oil Seal	32
	Removal	32
	Crankshaft and Main Bearings	32
	Removal	32
	Rocker Arm Assembly	33
	Disassembly	33
	Inspection and Repair	33
10 106	Timing Gear	34
	Inspection	34
	Camshaft	34
	Disassembly	34
	Inspection	34
	Oil Pump	35
	Disassembly	35
	Inspection	35
	Assembly (see Idler Gear)	35
10 101	Cylinder Head	36
	Disassembly	36
	Inspection and Repair	36

SECTION 10 - ENGINE - CHAPTER 1

Section	Description	Page
	Valves	37
	Valve Guides	37
	Valve Seat	38
	Valve Springs	39
	Rocker Arms	40
	Push Rods	41
	Cylinder Block	42
	Inspection and Repair	42
	Piston and Piston Rings	43
	Disassembly	43
	Inspection	43
	Connecting Rods	45
	Pistons, Rings and Connecting Rod	47
	Assembly	47
10 103	Crankshaft Main Bearing and Thrust Washer	48
	Removal and Inspection	48
	Crankshaft Bearing (Bushing)	49
	Inspection	49
	Removal	50
	Replacement	50
	Crankshaft Main Bearing	51
	Installation	51
	Port Block	51
	Removal	51
	Installation	51
10 103	Crankshaft and Bearing Holder	52
	Installation	52
	Relief Valve	52
	Installation	52
	Rear Oil Seal	53
	Installation	53
	Back Plate/Flyweel Housing	53
	Installation	53
10 103	Flywheel	53
	Inspection and Repair	53
	Flywheel	54
	Installation	54
10 105	Pistons and Connecting Rods	54
	Installation	54

SECTION 10 - ENGINE - CHAPTER 1

Section	Description	Page
10 110	Balancer Assembly	55
	Installation	55
	Oil Suction Pipe and Suction Strainer	56
	Installation	56
	Oil Sump	56
	Installation	56
10 106	Camshaft and Camshaft Gear	56
	Installation	56
10 106	Idler Gear, Oil Pump and Injection Timing	57
	Installation	57
10 102	Timing Gear Case	58
	Front Oil Seal and Steering Pump Seal	58
	Replacement	58
	Timing Gear Case	59
	Installation	59
	Crankshaft Pulley	60
	Installation	60
	Injection Pump	60
	Installation	60
10 101	Head Gasket Selection	61
	Head Gasket Selection Chart	61
	Cylinder Head	61
	Assembly	61
10 106	Valve Clearance Adjustment	63
	Head Cover	63
	Installation	63
	Intake/Exhaust Manifolds	63
	Installation	63
	External Oil Tube	64
	Installation	64
	Oil Pressure Switch	64
	Installation	64
	Alternator and Temperature Sender Switch	64
	Installation	64
	Glow Plug and Connector	65
	Installation	65
	Nozzle/Holder Assembly	65
	Installation	65
	Return Pipe and Injection Pipe	65
	Installation	65

SECTION 10 - ENGINE - CHAPTER 1

Section	Description	Page
	Hydraulic Oil Pump	66
	Installation	66
	Power Steering Pump	66
	Installation	66
10 304	Description of Operation - Engine Lubrication System	67
10 206	Oil Filter	70
	Construction and Function	70
	Maintenance	70
10 304	Oil Pump	70
	Removal	70
	Inspection	70
	Installation and Adjustment	71
	Engine Oil Pressure Check	72
	Oil Pressure Relief Valve	73
	Removal	73
	Installation	73
	Oil Consumption	73
10 400	Description of Operation - Cooling System	74
	Maintenance	76
	Coolant	76
	Radiator Cap	76
10 402	Thermostat	77
10 402	Water Pump	77
10 414	Cooling Fan	77
	Radiator	78
	Removal	78
	Inspection	79
	Installation	80
10 402	Water Pump	82
	Removal	82
	Inspection and Repair	83
	Installation	83
10 402	Thermostat	84
	Removal	84
	Inspection and Repair	85
	Installation	85
	Oil Cooler	86
	Removal	86
	Installation	86

SECTION 10 - ENGINE - CHAPTER 1

SPECIFICATIONS

GENERAL	DX48	DX55
Engine Model	N844L	N844L-TC
Number of Cylinders	4	4
Bore x Stroke	84 x 100 mm. (3.31 x 3.94in)	84 x 100 mm. (3.31 x 3.94in)
Displacement	135.2 cu. In.(2216 cc)	135.2 cu. In.(2216 cc)
Compression Ratio	22.5:1	22.5:1
Rated Speed(rpm)	2800	2700
Firing Order	1-3-4-2	1-3-4-2
Low Idle Speed	1000	1000
Maximum No Load Speed	3000	2900
Cylinder Arrangement	In-line vertical	In-line vertical
Valve Arrangement	Overhead	Overhead
Compression Pressure At 200 rpm (cylinder speed)	29.4 ± 3.5 bar (427 ± 50 psi)	29.4 ± 3.5 bar (427 ± 50 psi)
CYLINDER BLOCK	N844L	N844L-TC
Bore		
Standard	84.0 mm (3.3071 in.)	84.0 mm (3.3071 in.)
Maximum	84.2 mm (3.315 in.)	84.2 mm (3.315 in.)
Head Surface Warp		
Standard	.05 mm (.002 in.)	.05 mm (.002 in.)
Maximum	.12 mm (.005 in.)	.12 mm (.005 in.)
CYLINDER HEAD	N844L	N844L-TC
Head Warp		
Standard	.05 mm (.002 in.)	.05 mm (.002 in.)
Maximum	.12 mm (.005 in.)	.12 mm (.005 in.)
Valve seat width		
Standard	1.7-2.1 mm (0.067-0.082 in.)	1.7-2.1 mm (0.067-0.082 in.)
Maximum	1.8 mm (0.071 in.)	1.8 mm (0.071 in.)
Valve seat sink	N844L	N844L-TC
Standard (recess)	0.85-1.15mm (0.0334-0.0453 in.)	0.85-1.15mm (0.0334-0.0453 in.)
Maximum	1.8 mm (0.071 in.)	1.8 mm (0.071 in.)
Valve Angle	45 degrees	45 degrees
PISTON	N844L	N844L-TC
Diameter		
Standard	83.948-83.963 mm (3.30503-3.30562 in.)	83.948-83.963 mm (3.30503-3.30562 in.)
Minimum	83.7 mm (3.2953 in.)	83.7 mm (3.2953 in.)
BORE CLEARANCE	N844L	N844L-TC
Standard	0.038-0.072 mm (0.0015-0.0028 in.)	0.038-0.072 mm (0.0015-0.0028 in.)
Maximum	0.25mm (0.010 in.)	0.25mm (0.010 in.)
PISTON PIN BORE	N844L	N844L-TC
Standard	27.996-28.0mm (1.102-1.1023 in.)	27.996-28.0mm (1.102-1.1023 in.)
Maximum	27.98 mm (1.102 in.)	27.98 mm (1.102 in.)

SECTION 10 - ENGINE - CHAPTER 1

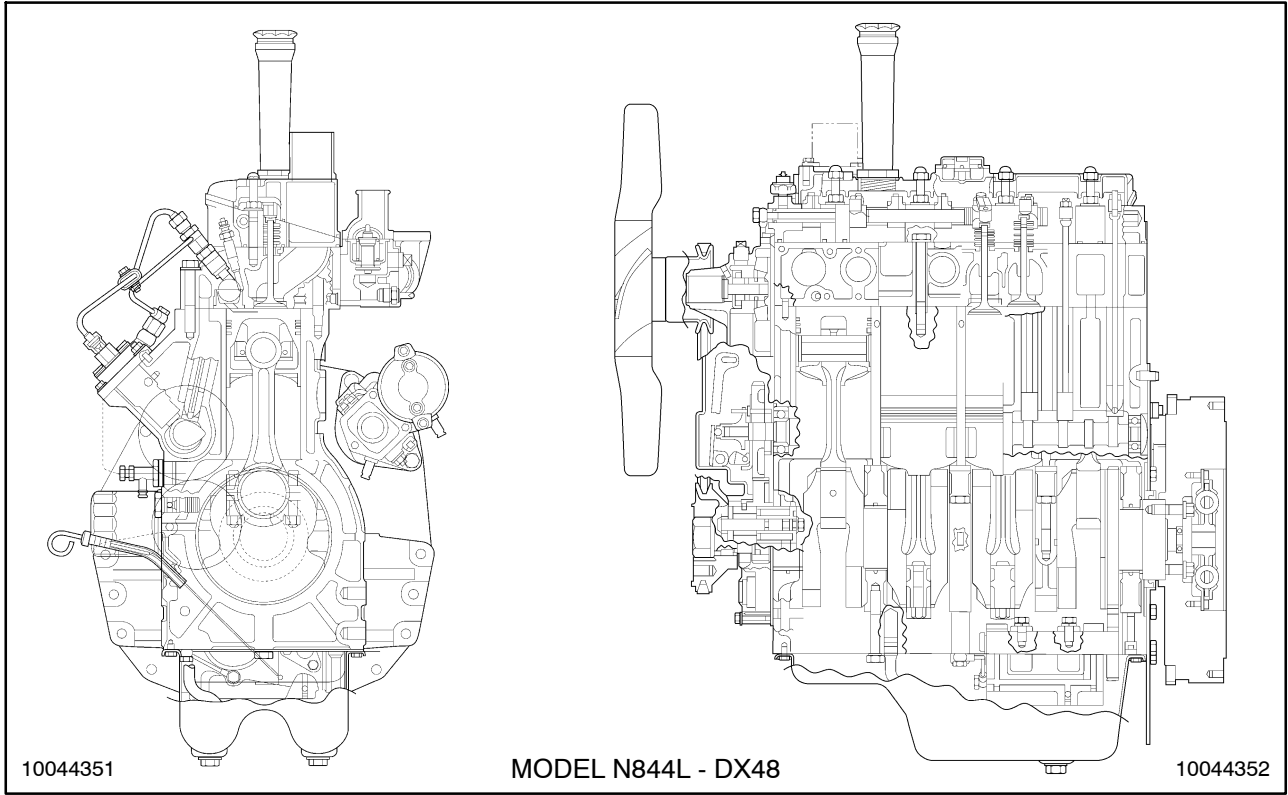

4

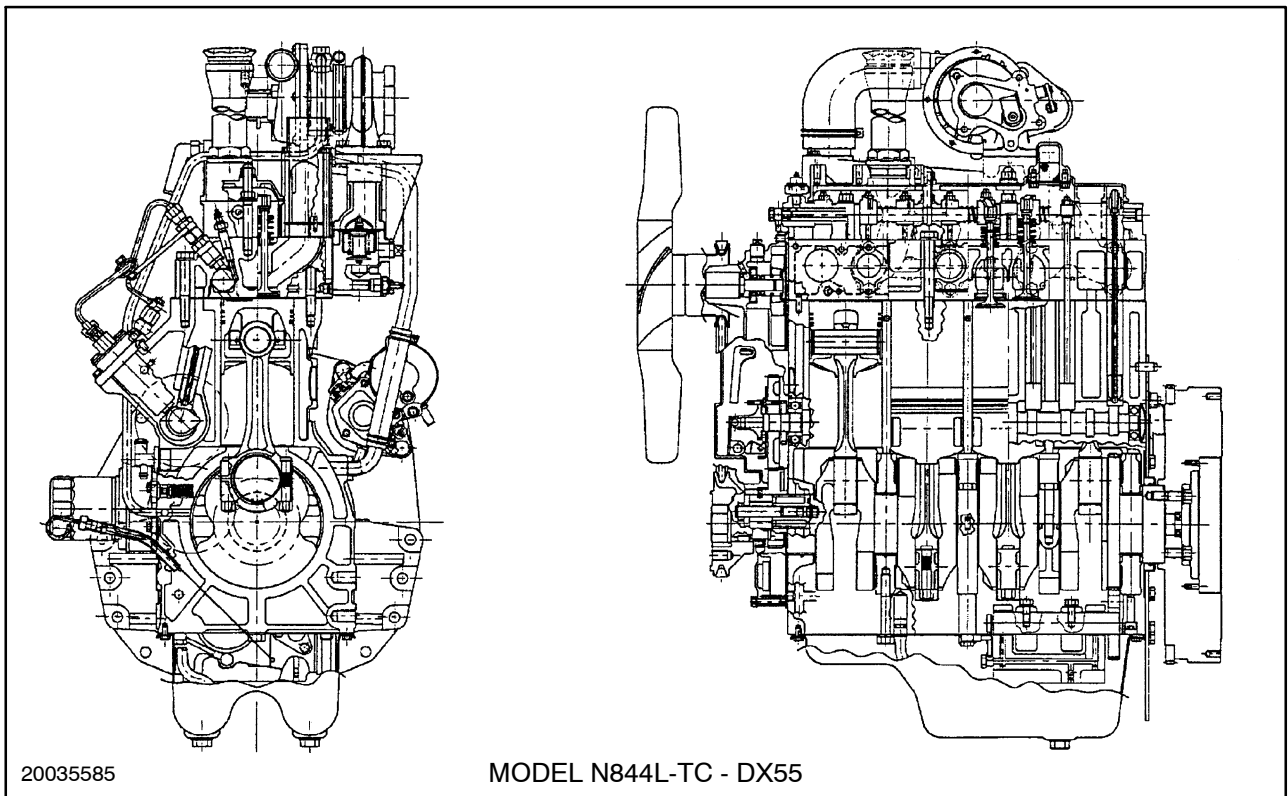

5

ENGINE

Removal

1. Disconnect the negative (-) battery cable, 1, and positive (+) battery cable, 2, from the battery.

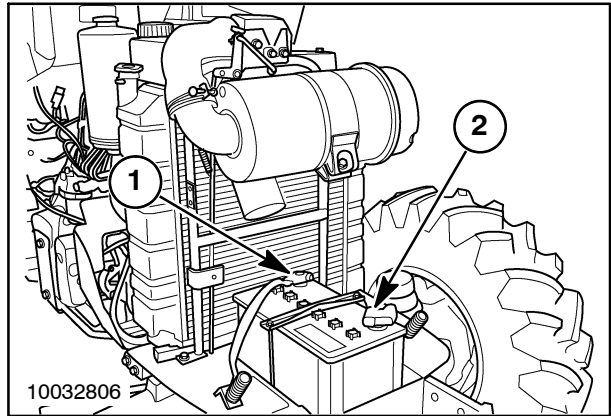

6

2. Disconnect the headlight wire harness plug, 1.
3. Remove the clips and pins, 2, from each side of the hood bracket.
4. Remove the support rod, 3, and remove the hood from the tractor.

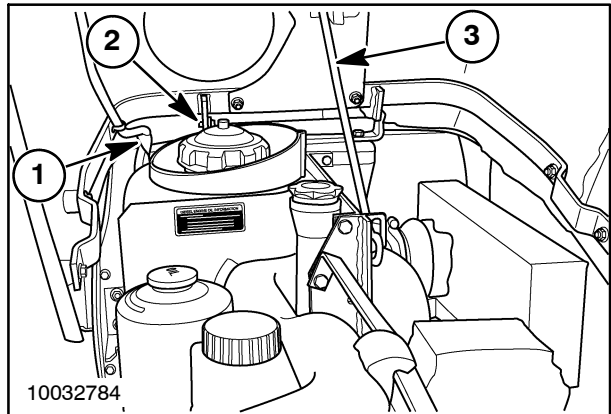

7

5. Drain the coolant from radiator, and engine using the petcock valve, 1. Remove radiator cap to assist draining.
6. Remove the radiator (see Radiator Removal in Section 10).

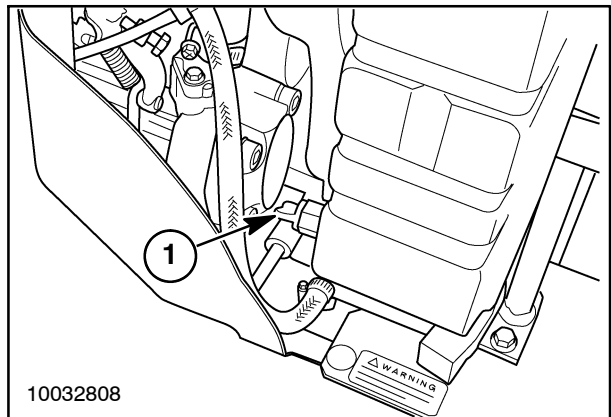

8

- Loosen and remove the drain plug, 1, from the power steering reservoir, 2, and drain into a suitable container.

NOTE: See separating the tractor at the transmission in Section 21 to separate the tractor.

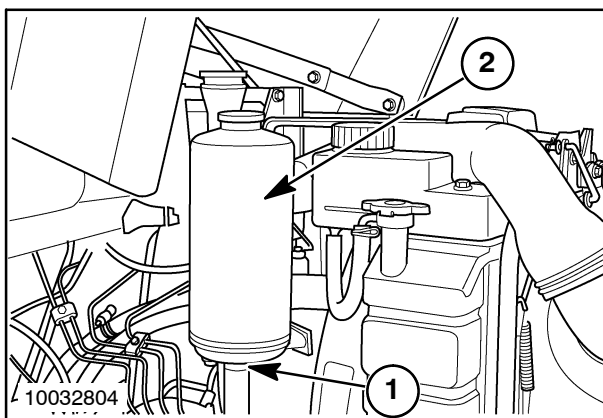

9

- After the tractor has been successfully separated, support the front axle and the front support frame with jack stands.
- Remove the firewall from the engine.
- Remove the muffler and exhaust pipe from the tractor.
- With the chain and hoist still attached to the engine, remove the mount bolts, 1, from each side of the frame rails.
- Carefully remove the engine.

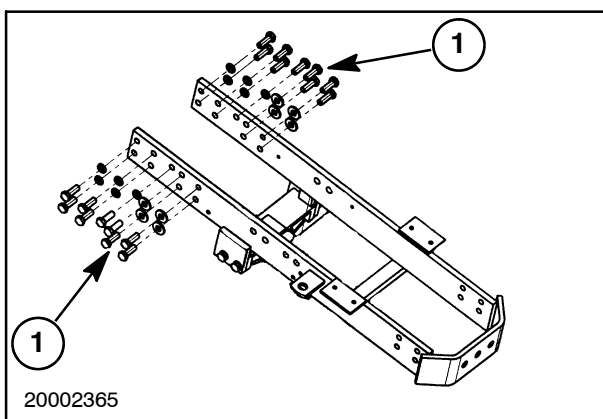

10

Installation

- Attach a hoist to the engine, and position it onto the frame.
- Install the engine mounting bolts on both sides of the frame. Apply Loctite® thread locker 242 to the thread of the bolts. Tighten bolts to the following torques:
 - torques #1 - 80 N·m (60 ft. lbs.)
 - torques #2 - 80 N·m (60 ft. lbs.)
 - torques #3 - 175 N·m (130 ft. lbs.)
- Install the muffler and exhaust pipe onto the tractor.
- Install the firewall onto the engine.

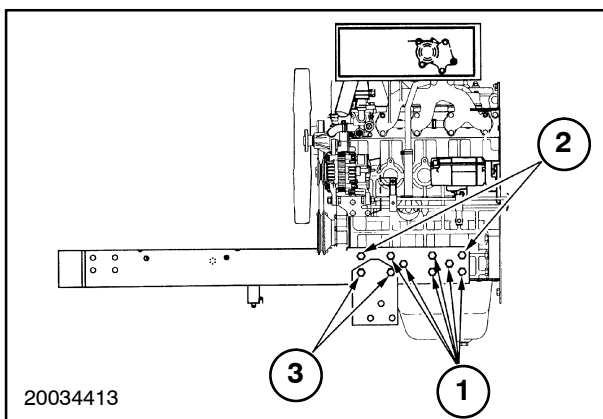

11

NOTE: See section 21 for attaching the engine to the transmission.

OVERHAUL

ENGINE

NOTE: Some procedures discussed in this chapter are shown with the engine in the tractor. Many of the procedures can be done with the engine in or out of the tractor.

ALTERNATOR

Removal

Disconnect the alternator wire harness and wires, 1.

Remove the alternator pivot and adjusting bracket, hardware, 2.

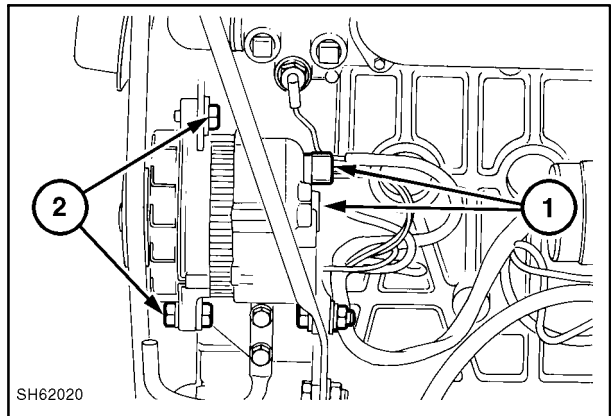

12

COOLING FAN AND PULLEY

Removal

Remove the fan, 1, retaining hardware and spacers.

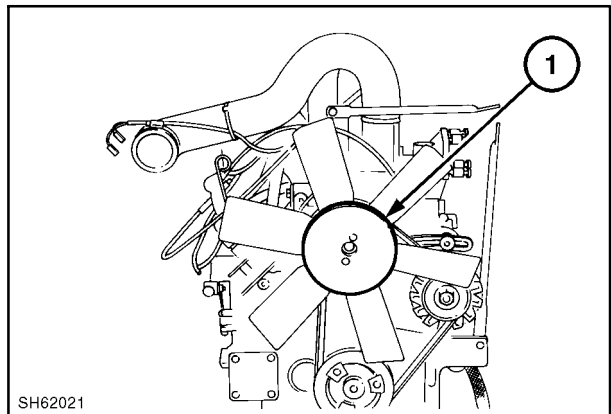

13

GLOW PLUG AND CONNECTOR

Removal

Remove the glow plugs, 1, and glow plug connectors, 2.

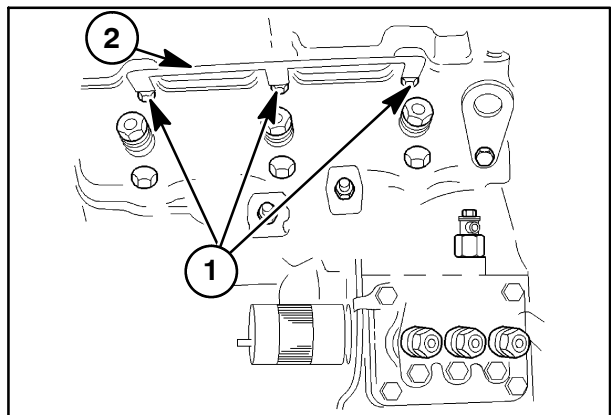

14

NOZZLE/HOLDER

Removal

Remove the nozzle and holder assembly with a socket for the nozzle holder.

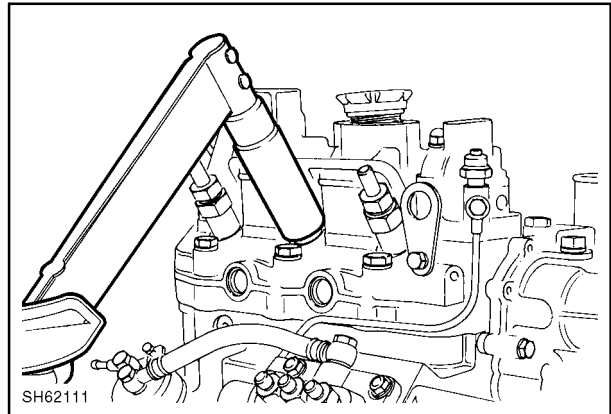

15

FUEL INJECTION PIPE

Removal

1. Loosen the fuel pipe nuts from the fuel injection pump and injectors, 1. Remove the pipes as an assembly.
2. Remove the spring clamp and fuel return hose, 2.

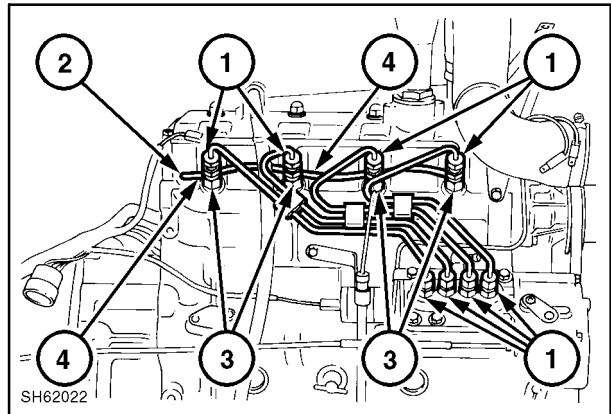

16

INJECTOR

Removal

Loosen and remove the securing nuts, 3. Remove the leak-off rail, 4. Remove the aluminum washers and discard. Remove the injectors tagging or marking with the cylinder they were removed from.

WATER PUMP

Removal

Loosen the securing bolts and remove the water pump assembly, 1, and set plate, 2.

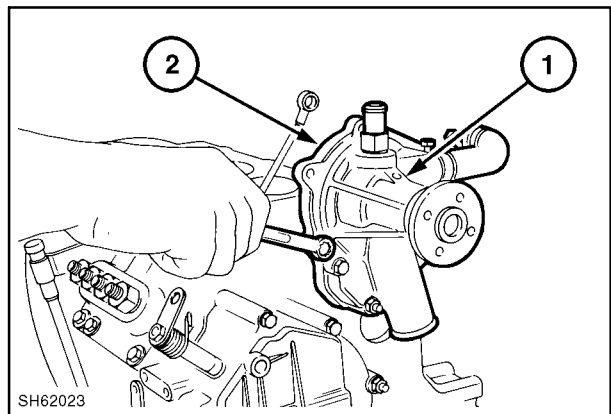

17

COVER/INTAKE MANIFOLD/EXHAUST MANIFOLD

Removal

Remove the intake manifold, 1, spacer, 2, and exhaust manifold, 3.

For the N844L-TC turbocharged engine, refer to the turbocharger section of the manual for removal and replacement.

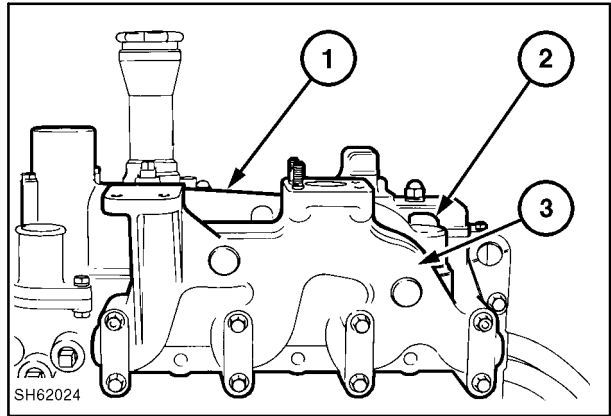

18

Loosen and remove four cap nuts with washers. Remove the head cover assembly, 1.

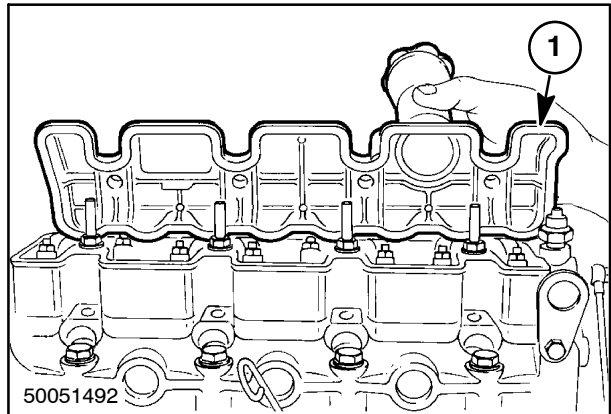

19

EXTERNAL OIL PIPE

Removal

1. Loosen and remove the two banjo bolts, 1, at the cylinder block main oil gallery and cylinder head assembly.
2. Remove the clamp, 2, from the fuel injection pump.

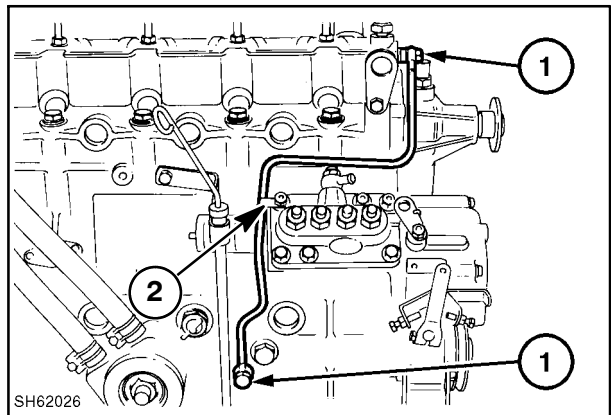

20

ROCKER ASSEMBLY

Removal

1. Loosen and remove nuts, lock washers, and flat washers from the rocker pillar stud, 1. Lift the rocker assembly, 2.
2. Remove the push rods, 3, and valve stem caps, 4.

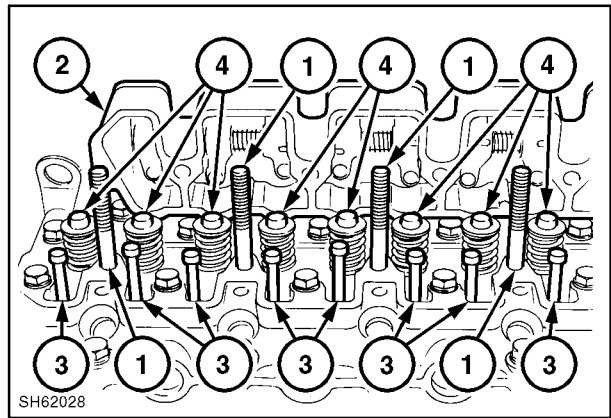

21

CYLINDER HEAD

Removal

Loosen the cylinder head bolts, starting from the center, in a circular pattern, using several steps of equal torque. Remove the head.

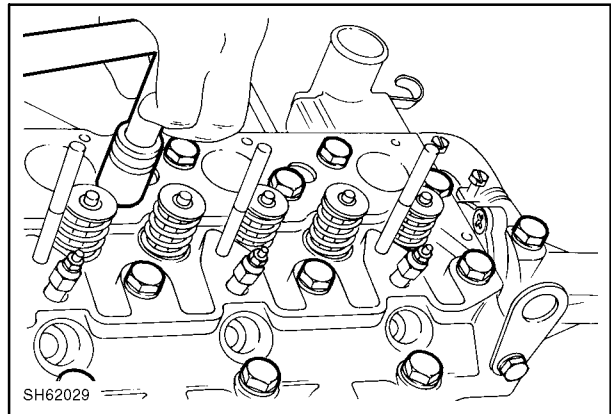

22

TAPPETS

Removal

Pull the tappets from the machined bore in the cylinder block.

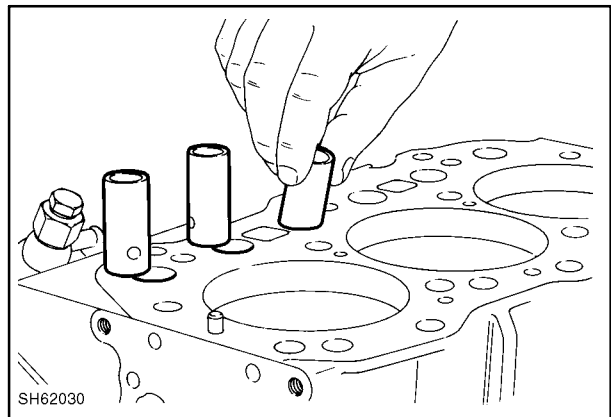

23

FUEL STOP SOLENOID

Removal

Unscrew the stop solenoid, and remove from the engine block.

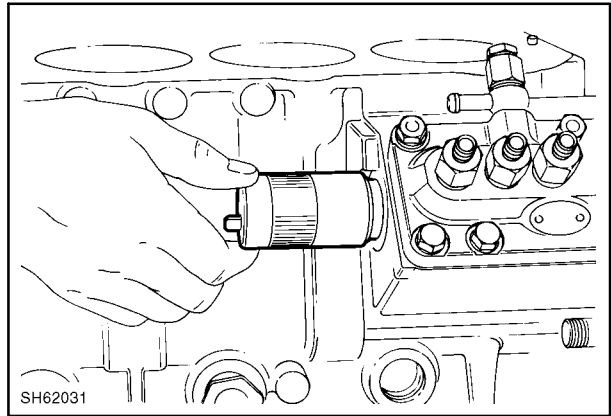

24

TIMING GEAR COVER

Removal

1. Drain the engine crankcase oil.
2. Remove the injection pump mounting nuts and raise the injection pump, 1, enough to remove the spring pin, 2, and separate the governor link from the control rack. Remove the injection pump.

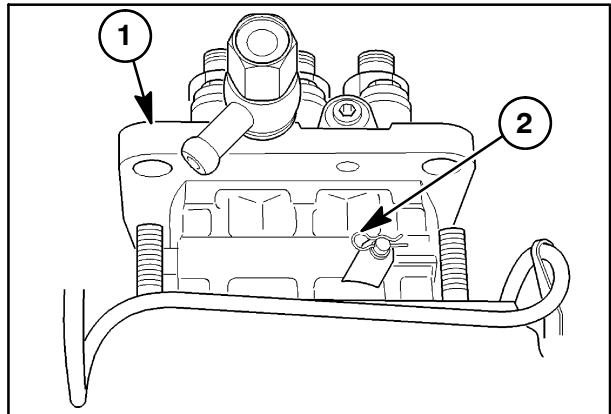

25

NOTE: Insert a small dowel, 1, through the fuel shut-off solenoid hole and slide the control rack, 2, in to allow enough clearance to the cylinder block, for the pump to be removed.

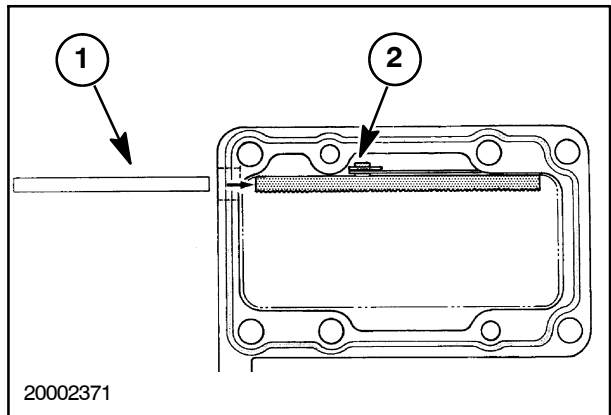

20002371

26

SECTION 10 - ENGINE - CHAPTER 1

3. Loosen the hose clamp, 1, on the suction hose, 2, and remove the suction hose from the steering pump, 3.
4. Remove the pressure tube, 4, from the bottom of the steering pump.

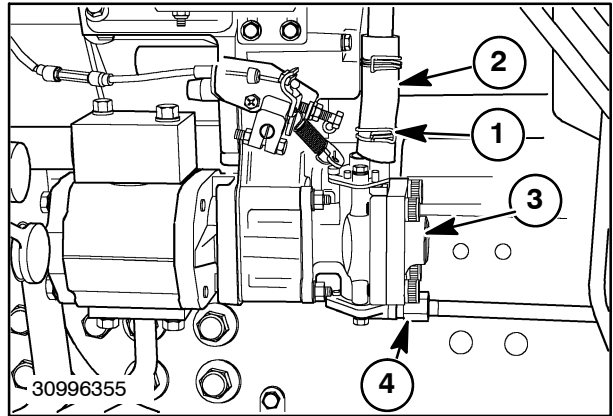

27

5. Remove the through bolts and nuts, 1, and remove the steering pump from the front cover. Cap the lines and pump openings.

NOTE: Two of the power steering pump retaining bolts are not shown.

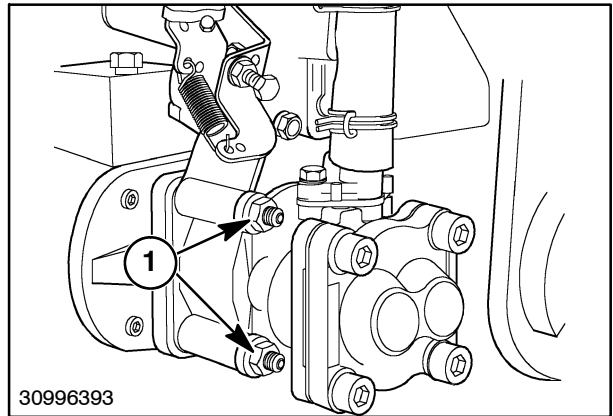

28

6. Install and tighten two nuts, 1, against each other, onto the retaining studs, 2. Remove the studs, 2, and the hydraulic pump, 3.

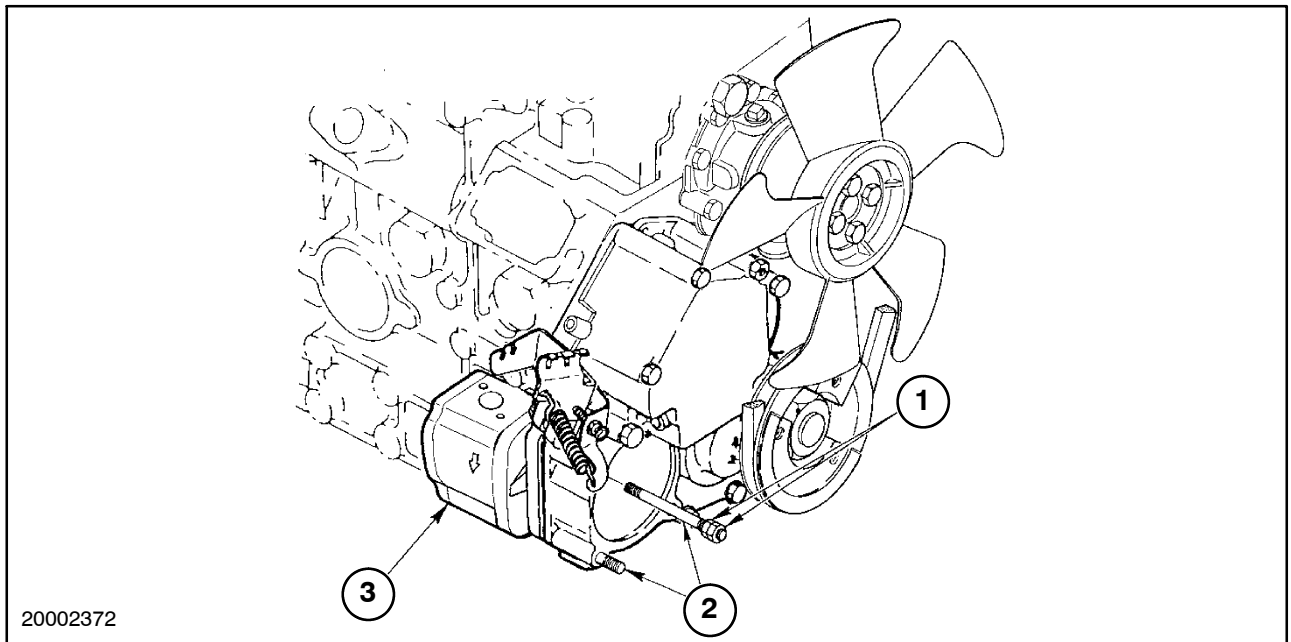

29

7. Remove the retaining nut, 1. Pull crankshaft pulley, 2, off of crankshaft, 3. Remove key, 4, from crankshaft.

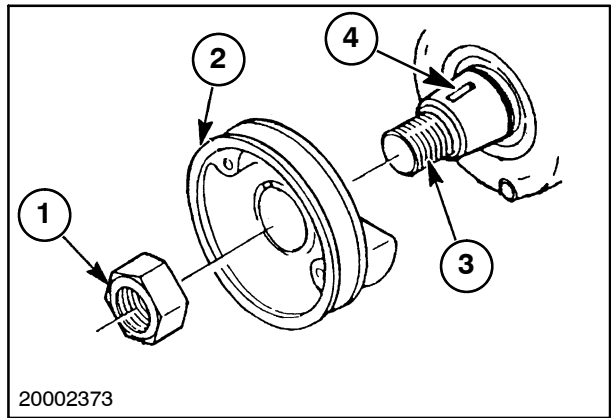

30

8. Remove the retaining bolts, 1, and lift the cover, 2, off the locating dowels.

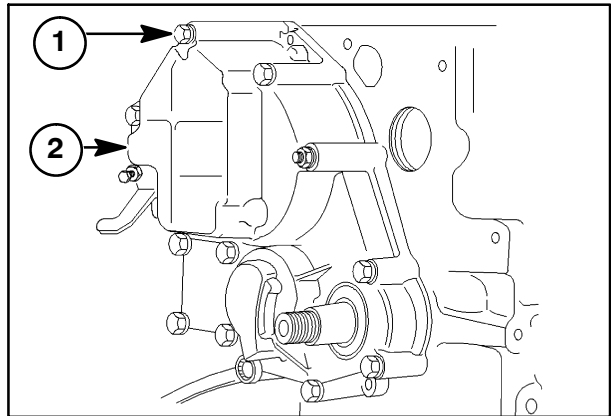

31

Op. 10 106

TIMING GEARS AND CAMSHAFT

Removal

1. Remove retaining ring, 1, and remove the idler gear, 2, and oil pump assembly, 3.

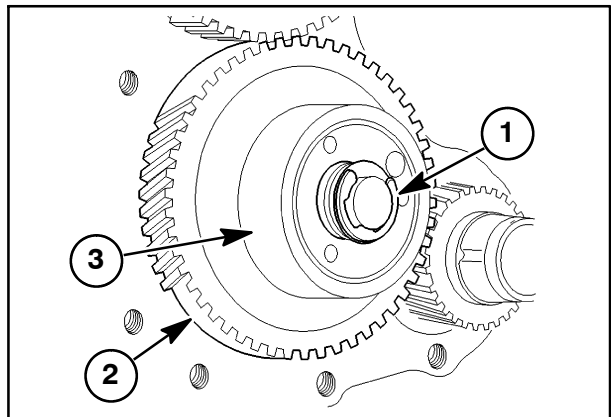

32

2. Remove the two bolts, 1, securing the keeper plate, 2. One must be accessed using the access hole, 3, in the cam gear.
3. Slide the camshaft and gear out of the camshaft bore.

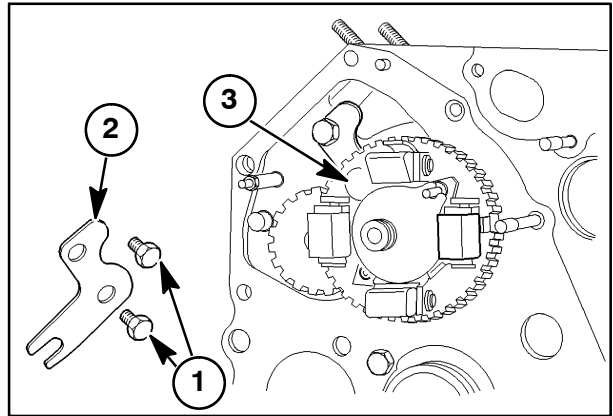

33

FRONT END PLATE

Removal

Remove the retaining bolts and lift the front plate off its locating dowels. Remove the gasket and discard.

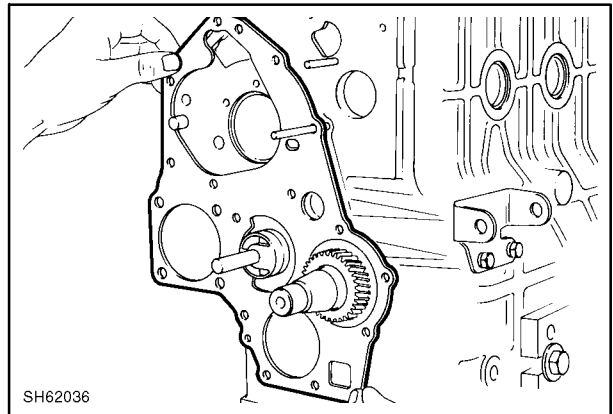

34

Op. 10 102

OIL SUMP

Removal

1. Remove the oil sump retainer bolts, 1.
2. Remove the oil sump and discard gasket.
3. Remove steel spacer, 2, from the block.

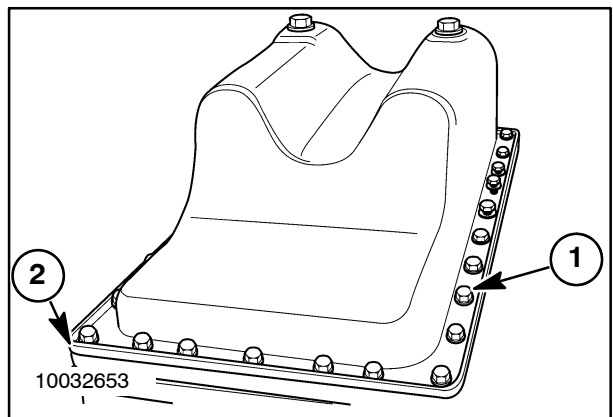

35

OIL SUCTION PIPE AND STRAINER

Removal

1. Remove the two retaining bolts, 1.
2. Remove the oil strainer, 2, and rotate the oil suction pipe, 3, out of its bore.

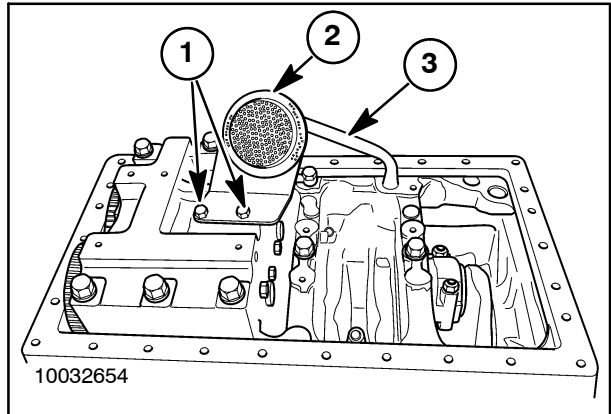

36

Op. 10 110

BALANCER ASSEMBLY

Removal

1. Remove the banjo bolts, 1, and the oil transfer pipe, 2.
2. Loosen and remove the balancer retaining bolts, 3.

NOTE: Observe the quantity and thickness of the shims, 4, (if used) for re-installation upon assembly.

3. Remove the balancer assembly, 5, from the engine block, 6.

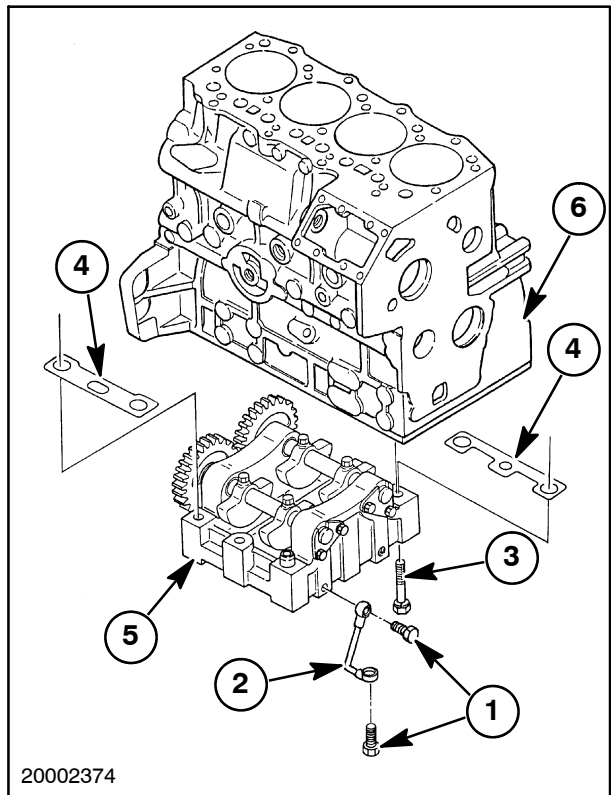

37

Op. 10 105

CONNECTING RODS, BEARINGS AND PISTONS, RINGS

Removal

1. Remove the two bolts, 1, retaining the connecting rod caps, 2.
2. Remove the connecting rod caps and lower half of connecting rod bearing.
3. If necessary, remove any ridge from the top of the cylinder bores using a suitable ridge reamer.
4. Push the piston and connecting rod out of the cylinder block.
5. Replace the connecting rod cap to the piston assembly it was removed from. Keep together in cylinder sequence.

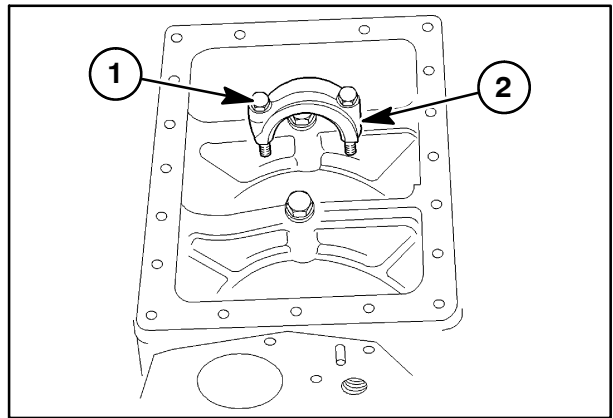

38

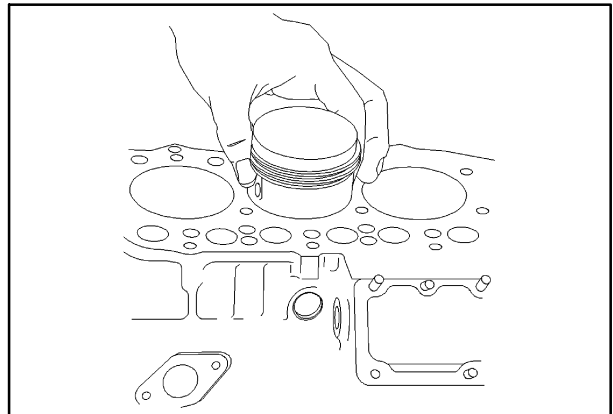

39

Op. 10 103

FLYWHEEL

Removal

1. Loosen the flywheel retaining bolts.
2. Using a brass drift and hammer, tap the end of the crankshaft, 1, to loosen the flywheel, 2, from the shaft.

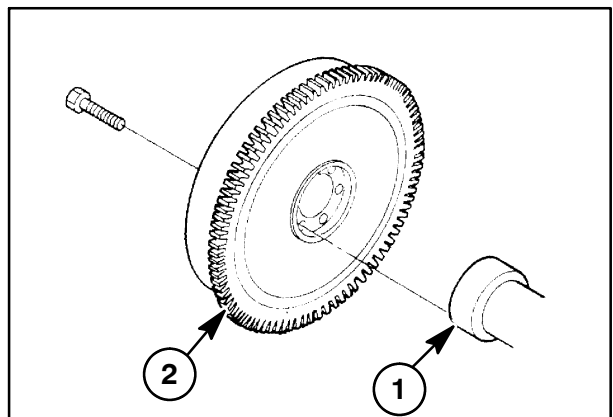

40

BACKPLATE AND OIL SEAL

Removal

1. Remove the backplate retaining bolts and remove the backplate.
2. Remove the rear oil seal, 1.

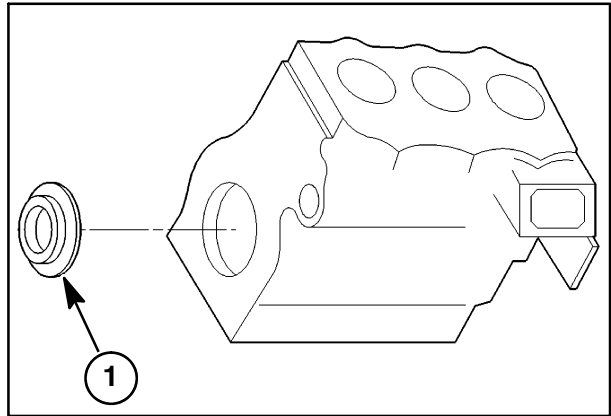

41

CRANKSHAFT AND MAIN BEARINGS

Removal

1. Remove the crankshaft bearing holder retaining bolts, 1.

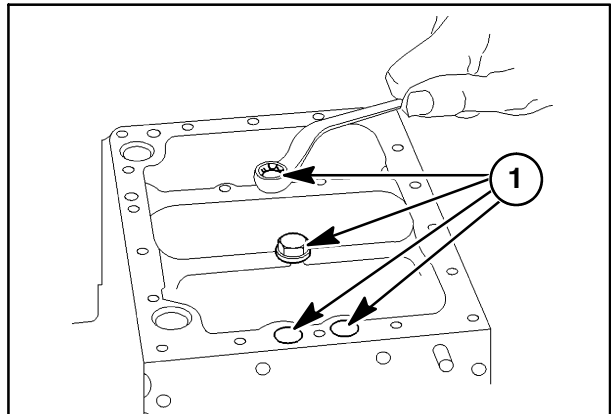

42

2. Remove the relief valve assembly, 1.
3. Slide the crankshaft and main bearing assembly through the rear of the engine.

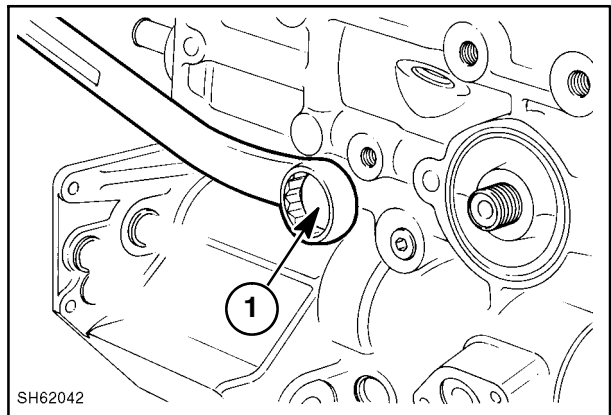

43

ROCKER ARM ASSEMBLY

Disassembly

1. Thread a 8 mm bolt into the rear end of the rocker shaft and slowly withdraw the rocker shaft, 1, while at the same time removing the rocker arms, 2, springs, 3, and shims, 4.

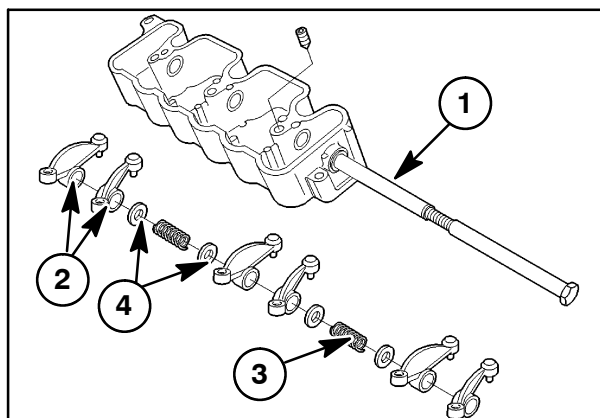

44

Inspection and Repair

1. Wear of Rocker Arm Shaft

Using a micrometer, check the outside diameter of the rocker arm shaft. If the rocker arm shaft is worn beyond the allowable limit, replace.

Standard dimension	Allowable Limit
14.95 mm - 14.97 mm (0.588" - 0.589")	14.87 mm (0.585")

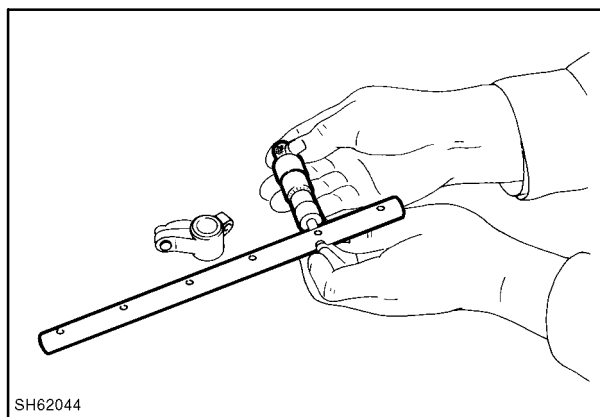

SH62044

45

2. Rocker Arm-to-Shaft Clearance

Measure the inside diameter of the rocker arm. Calculate the clearance at, 1, between the rocker arm, 2, and the rocker arm shaft, 3. If the clearance is excessive, replace.

Standard Clearance	Allowable Limit
0.030 mm - 0.093 mm (0.0012" - .0037")	0.2 mm (0.008")

3. Wear on valve stem contacts face of the rocker arm.

Check the face for step wear or score. Slight wear may be corrected using an oil stone.

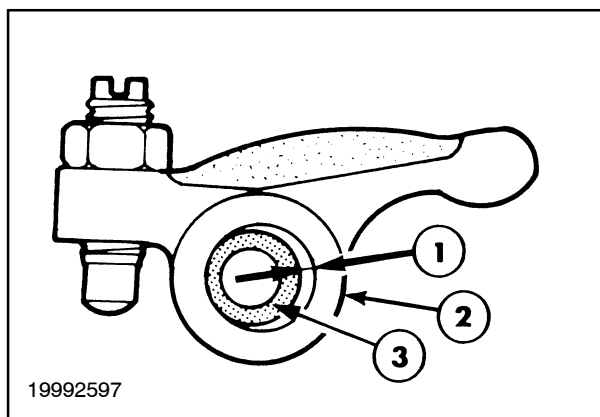

19992597

46



Suggest:

If the above button click is invalid.

Please download this document

first, and then click the above link

to download the complete manual.

Thank you so much for reading

Op. 10 106

TIMING GEAR

Inspection

1. Check the timing gears for wear and damage on the contact area. Replace if any defect is found.
2. Measure the backlash of gears with a feeler gauge or dial indicator. If the allowable limit is exceeded, replace all timing gears.

Standard	Allowable Limit
0.08 mm (0.003")	0.25 mm (0.010")

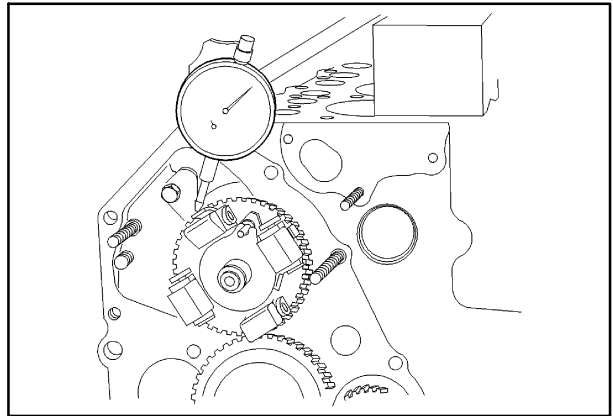

47

CAMSHAFT

Disassembly

1. Remove the slider, 1, from the camshaft gear.
2. Using a gear puller, remove the gear assembly, 2, spacer, 3, spacers, 4, tachometer gear, 5, bearing, 6, and key, 8, from the camshaft, 7.

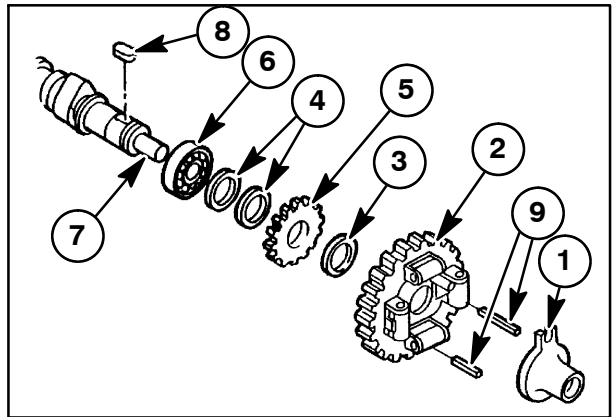

48

Inspection

1. Place the camshaft in a set of V-blocks and check the runout using a dial indicator, 1.
2. Replace or straighten the camshaft if the runout is greater than 0.1 mm (0.004").
3. Using a micrometer, measure the height of the camshaft lobes.
4. Replace the camshaft if any of the cam lobes are worn to less than the following dimensions:
 Valve Lobe: 34.1 mm (1.3425")
 Injection Pump Lobe: 42.8 mm (1.685")

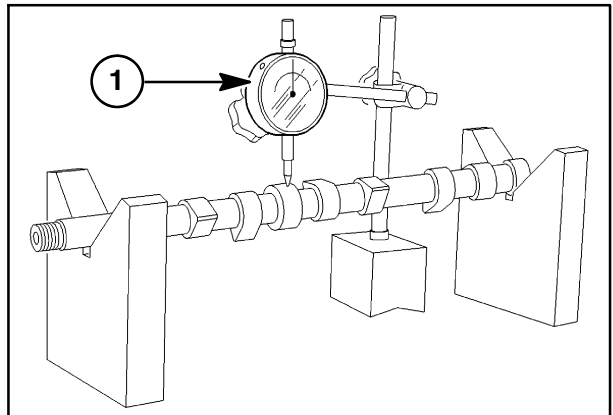

49

<https://www.ebooklibonline.com>

Hello dear friend!

Thank you very much for reading.

Enter the link into your browser.

The full manual is available for immediate download.

<https://www.ebooklibonline.com>