

1. Trim along dashed line.
2. Slide into pocket on Binder Spine.

TYPE 1-4

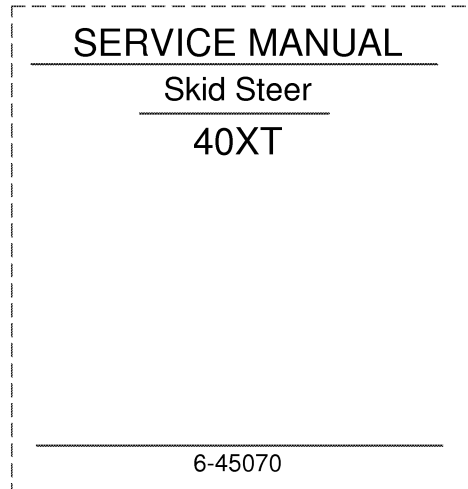

1. Trim along dashed line.
2. Slide into pocket on Binder Spine.

TYPE 1-4

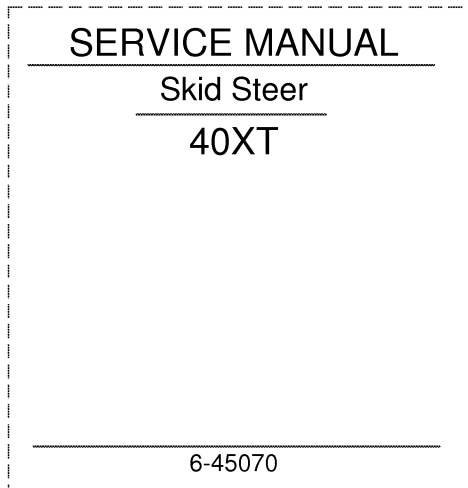

1. Trim along dashed line.
2. Slide into pocket on Binder Spine.

TYPE 1-4

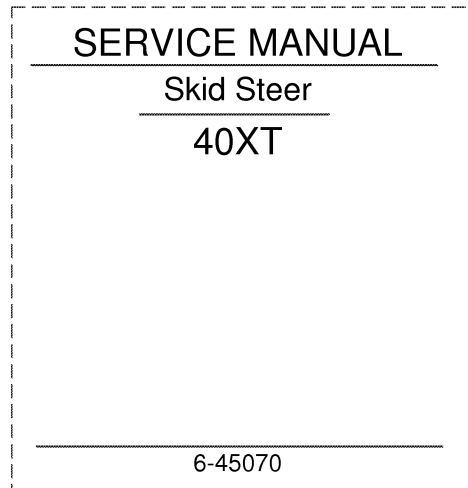

1. Trim along dashed line.
2. Slide into pocket on Binder Spine.

TYPE 1-4

40XT SKID STEER Service Manual Bur 6-45070 Table of Contents

Description	Section Number	Publication Form Number
General		
	Tab 1	
Section Index - General		6-45090
Fluids and Lubricants	1001	6-43320
Standard Torque Specifications	1002	7-52931
Metric Conversion Chart	1003	7-52950
Loctite Product Chart		8-98902
Engines		
	Tab 2	
Section Index - Engines		6-45100
Engine and Radiator Removal and Installation	2000	6-45590
For Engine Repair - See Engine Service Manual		
Fuel Systems		
	Tab 3	
Section Index - Fuel Systems		6-45110
For Fuel System Repair - See the Engine Service Manual		
Electrical		
	Tab 4	
Section Index - Electrical		6-45120
Electrical System - "How It Works"	4000	6-43331
Electrical Specifications and Troubleshooting	4001	6-43340
Battery	4005	7-51310
Starter and Starter Solenoid	4006	7-53090
Alternator	4007	7-53100
Power Train		
	Tab 6	
Section Index - Power Train		6-45140
Hydrostatic System - "How It Works"	6000	6-43350
Hydrostatic System Troubleshooting	6001	6-43360
Removal and Installation of Hydrostatic Components	6002	6-45190
Drive Coupling	6003	6-45200
Piston Pump	6004	6-45210
Drive Motors	6005	6-45220
Sprocket, Chains, and Axle Assemblies	6007	6-45180
Wheels and Tires	6011	6-45230

40XT SKID STEER Service Manual Bur 6-45070

Table of Contents (Continued)

Description	Section Number	Publication Form Number
Brakes		
		Tab 7
Section Index - Brakes		6-45150
Brake System - "How It Works"	7000	6-45250
Brake System Troubleshooting	7001	6-45260
Removal and Installation of Park Brake Components	7002	6-45270
Brake Solenoid Valve	7003	7-11740
Brakes - Spring Applied - Hydraulic Release (European and Optional North American Machines)	7004	6-41320
Brakes - Pin Lock - Cable Release	7005	6-45510
Brake Pump	7006	6-45650
Hydraulics		
		Tab 8
Section Index - Hydraulics		6-45160
Hydraulic System - "How It Works"	8000	6-43370
Hydraulic System Troubleshooting	8001	6-43380
Cleaning the Hydraulic System and Hydrostatic System	8002	6-45290
Removal and Installation of Hydraulic Components	8003	6-45320
Gear (Equipment) Pump	8004	7-11800
Loader Control Valve	8005	6-45330
Cylinders	8006	6-45340
Flat Faced Couplers	8007	7-54740
High Flow Valve	8008	6-45580
D-125 Backhoe Control Valve - NA Only	8012	7-54690
Accumulator for Ride Control	8013	6-45550
Mounted Equipment		
		Tab 9
Section Index - Mounted Equipment		6-45170
Pedals and Levers	9001	6-43391
Loader	9002	6-45350
Attachment Coupler	9003	6-45360
ROPS Canopy, Seat, Seat Belts, and Operators Compartment	9004	6-45370
Heater	9006	6-45380
Backhoe (D125 Backhoe)	9007	6-45630
Schematic Set		
Hydraulic and Electrical Schematic Foldout	In Rear Pocket	6-43400

<https://www.ebooklibonline.com>

Hello dear friend!

Thank you very much for reading.

Enter the link into your browser.

The full manual is available for immediate download.

<https://www.ebooklibonline.com>

SECTION INDEX

GENERAL

Section Title	Section Number
Fluids and Lubricants	1001
Standard Torque Specifications	1002
Metric Conversion Chart	1003
Loctite Product Chart	

Section 1001

FLUIDS AND LUBRICANTS

TABLE OF CONTENTS

CAPACITIES AND LUBRICANTS	3
ENVIRONMENT	3
ENGINE LUBRICATION	4
Engine Oil Selection	4
Oil Viscosity/Temperature Ranges	4
DIESEL FUEL SYSTEM	5
Fuel Storage	5
Specifications for Acceptable No. 2 Diesel Fuel	5

CAPACITIES AND LUBRICANTS

FUEL TANK

Capacity 83.3 litres (22 U.S. gallons)
 Specifications See diesel fuel specifications on page 5

COOLING SYSTEM

Capacity 16.6 litres (17.5 quarts)
 Recovery bottle capacity 2 litres (2.1 quarts)
 Specifications 50% water and 50% ethylene glycol

HYDRAULIC SYSTEM

Capacity - System 50.2 litres (13.3 gallons)
 Specifications Case No. 1 Engine Oil SAE 10W30
 add 1.4 litres (1.5 quarts) HTA Wear Additive

CHAIN COMPARTMENTS

Capacity - Each Side 5.7 litres (6.0 quarts)
 Specifications Case No. 1 Engine Oil, SAE 10W30

BATTERY

Quantity As required
 Specifications Distilled water

GREASE FITTINGS

Quantity As required
 Attachments (If equipped) Quantity as required
 Specifications Case molydisulfide grease

ENGINE CRANKCASE OIL

Capacity - with filter change 10.4 litres (11.0 quarts)
 Capacity - without filter change 9.5 litres (10.0 quarts)
 Specifications Case No. 1 Engine Oil SAE 15W-40 (API service CH-4)
 (See Oil Viscosity/Temperature Ranges Chart on page 4)

ENVIRONMENT

Before you service this machine and dispose of oil, fluids and lubricants, always remember the environment. Do not put oil or fluids into the ground or into containers that can leak. Check with your local environmental, recycling center or your Case dealer for correct disposal information.

ENGINE LUBRICATION

Engine Oil Selection

Case No. 1 Engine Oil is recommended for use in your Case Engine. Case Engine Oil will lubricate your engine correctly under all operating conditions.



RH99K130

Case Multi-Viscosity Engine Oil meets API engine oil service category CH-4

See the chart below for recommended viscosity at ambient temperature ranges.

NOTE: Do not put Performance Additives or other oil additive products in the engine crankcase. The oil change intervals given in the operating manual are according to tests with Case lubricants.



BS00H001

Oil Viscosity/Temperature Ranges

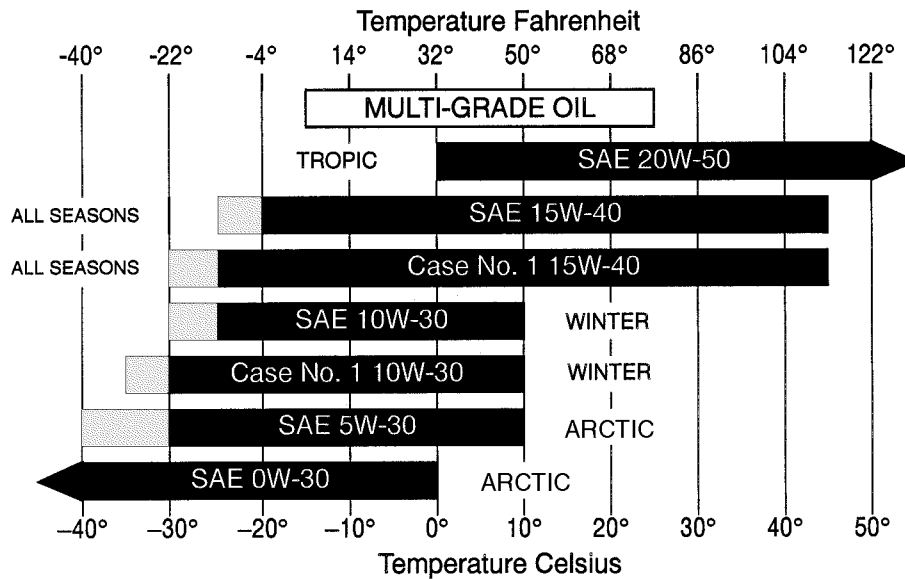

Indicates use of an engine oil heater or a jacket water heater is required.

BS99N019

DIESEL FUEL SYSTEM

Use No. 2 diesel fuel in the engine of this machine. The use of other fuels can cause the loss of engine power and high fuel consumption.

In very cold temperatures, a mixture of No. 1 and No. 2 diesel fuels is temporarily permitted. See the following:

NOTE: See your fuel dealer for winter fuel requirements in your area. If the temperature of the fuel lowers below the cloud point (wax appearance point), wax crystals in the fuel will restrict the fuel filter and cause the engine to lose power or not start.

The diesel fuel used in this machine must meet the specifications below, "Specifications for Acceptable No. 2 Diesel Fuel" or Specification D975-81 of the American Society for Testing and Materials.

Fuel Storage

If you keep fuel in storage for a period of time, you can get foreign material or water in the fuel storage tank. Many engine problems are caused by water in the fuel.

Keep the fuel storage tank outside and keep the fuel as cool as possible. Remove water from the storage container at regular periods of time.

Fill the fuel tank at the end of the daily operating period to prevent condensation in the fuel tank.

Specifications for Acceptable No. 2 Diesel Fuel

API Gravity, Minimum	34
Flash Point, Minimum	60°C (140°F)
Cloud Point (wax appearance point), Maximum	-20°C (-5°F)
Pour Point, Maximum	-26°C (-15°F)
Distillation Temperature, 90% Point	282 to 338°C (540 to 640°F)
Viscosity, at 38°C (100°F)	
Centistokes	2.0 to 4.3
Saybolt Seconds Universal	32 to 40
Cetane Number, Minimum	43 (45 to 55 for winter or high altitudes)
Water and Sediment, by Volume, Maximum	0.5 of 1%
Sulphur, by Weight, Maximum	0.5 of 1%
Copper Strip Corrosion, Maximum	No. 2
Ash, by Weight, Maximum	0.1 of 1%

SECTION INDEX

ENGINE

Section Title	Section Number
Engine and Radiator Removal and Installation	2000
For Engine Repair, see the Engine Service Manual	

2000

Section 2000

ENGINE AND RADIATOR REMOVAL AND INSTALLATION

TABLE OF CONTENTS

RADIATOR	3
Removal	3
Installation	4
ENGINE	5
Removal	5
Installation	10

RADIATOR

Removal

NOTE: Put caps on all fittings and plugs in all disconnected hoses.

STEP 1

Park the machine on a level surface. Remove the bucket or attachment from the loader arms. Raise the loader arms and lock the loader arms into the raised position.

STEP 2

Turn the ignition switch and the master disconnect switch (if equipped) to the OFF position.

STEP 3

Disconnect the negative battery cable from the battery.

STEP 4

Tilt the cab forward.

STEP 5

Open the rear access door on the machine and open the hood.

STEP 6

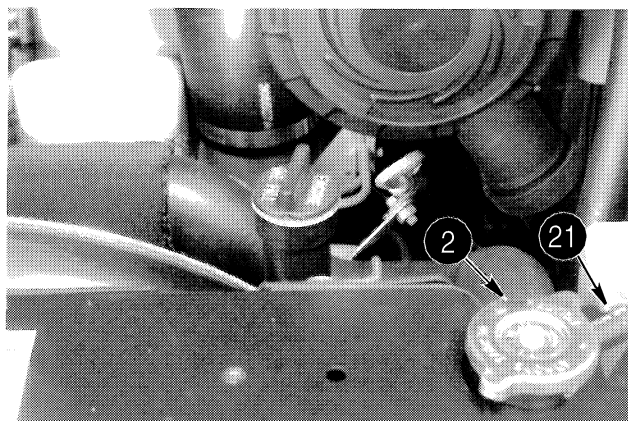

BD01C113

Slowly loosen the radiator cap (2). Disconnect the overflow hose (21) from the radiator neck.

NOTE: Refer to illustration on page 11.

STEP 7

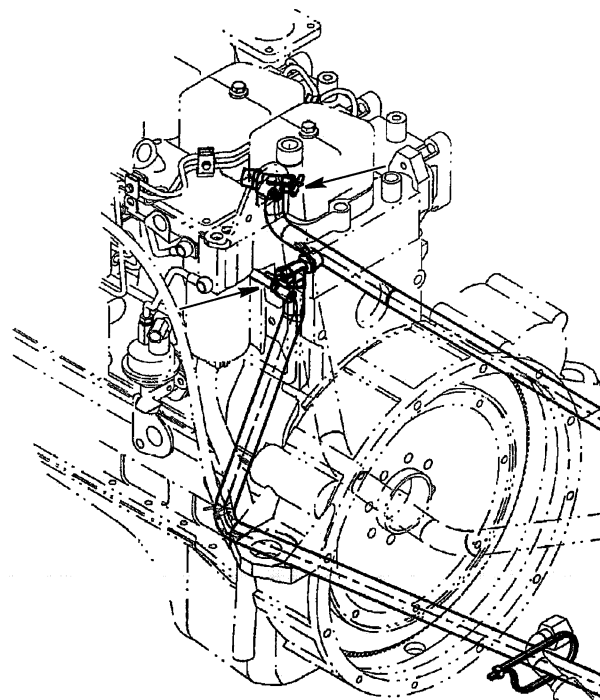

BS01F166

If equipped with a heater, open the heater coolant valves on the engine.

STEP 8

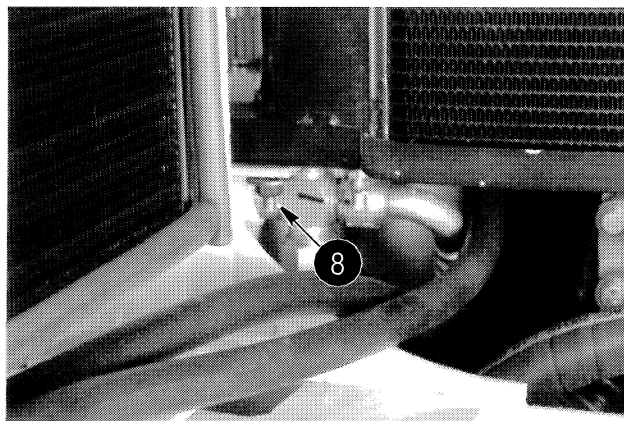

BD01C133

Install a hose on the drain valve (8) and drain the radiator (1) into a clean container that holds approximately 17 litres (4.5 gallons).

NOTE: Refer to illustration on page 11.

STEP 9

If equipped with a heater, close the heater coolant valves on the engine.

STEP 10

Loosen the clamps (4) on the lower radiator hose (5) and clamps (3) on the upper radiator hose (6).

NOTE: Refer to illustration on page 11.

STEP 11

Remove the two bolts (25) and washers (26) that fasten the fan guard (24) to the radiator (1). Remove the fan guard.

NOTE: During assembly torque the bolts (25) 15 to 20 Nm (120 to 180 pound-inches).

STEP 12

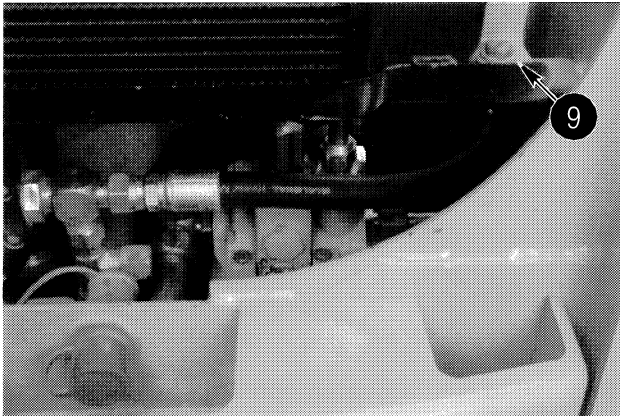

BD01J076

Loosen and remove the bolts (9), washers (10, 11, and 13), and mounts (12) that fasten the bottom of the radiator (1) to the frame.

NOTE: During assembly torque the bolt (9) 30 to 36 Nm (265 to 319 pound-inches).

STEP 13

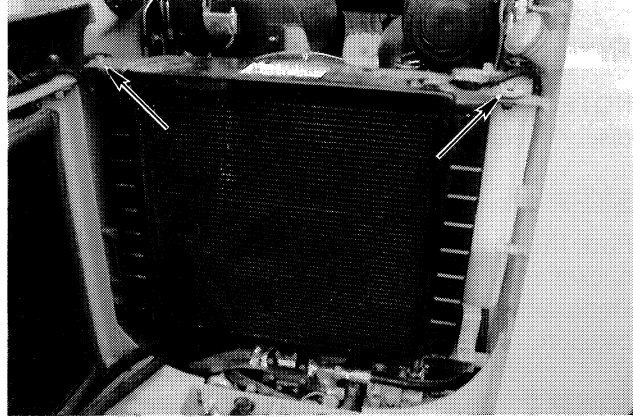

BD01J077

Loosen and remove the bolts (15), washers (16, 17, and 19), mounts (18), and nuts (20) that fasten the right side and left side of the radiator (1) to the frame.

NOTE: During assembly torque the bolts (15) 30 to 36 Nm (265 to 319 pound-inches).

STEP 14

Move the radiator (1) away from the upper radiator hose (6) and lower radiator hose (5). Remove the radiator (1) from the machine.

STEP 15

Remove the over flow bottle (23) and bracket (22).

Installation

STEP 16

Installation of the radiator is the revers of removal.

ENGINE

Removal

STEP 1

Remove the radiator from the machine.

STEP 2

Install plugs and caps on all disconnected hoses and fittings.

STEP 3

Tag all electrical connection for identification during assembly.

STEP 4

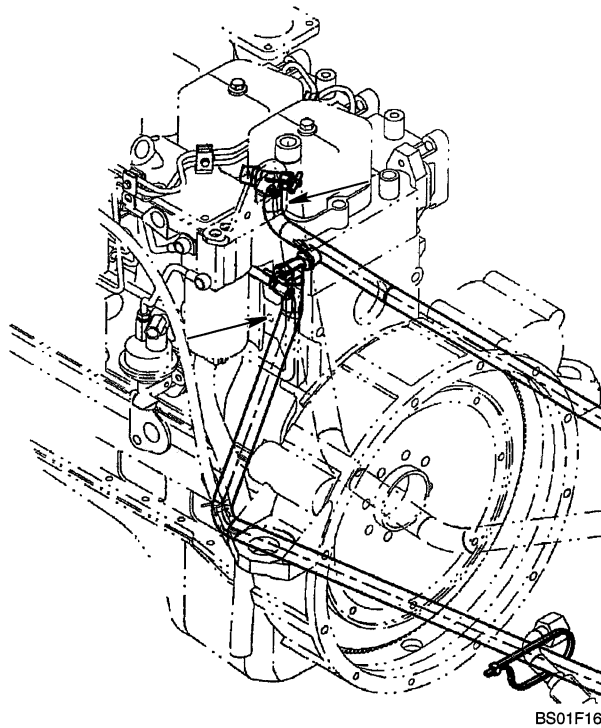

BS01F166

If equipped with a heater, disconnect the heater hoses.

STEP 5

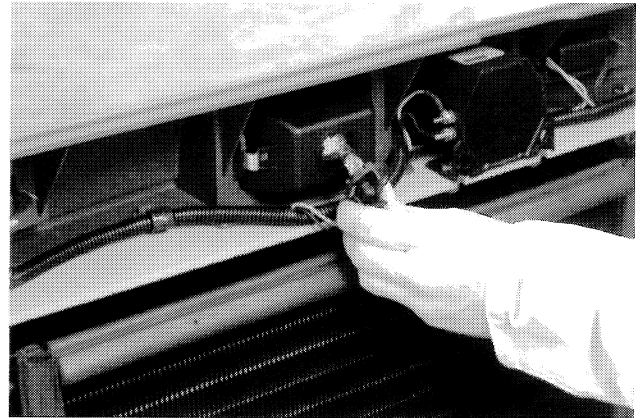

BD01C121

Remove the rear work lamp from the rear access door.

STEP 6

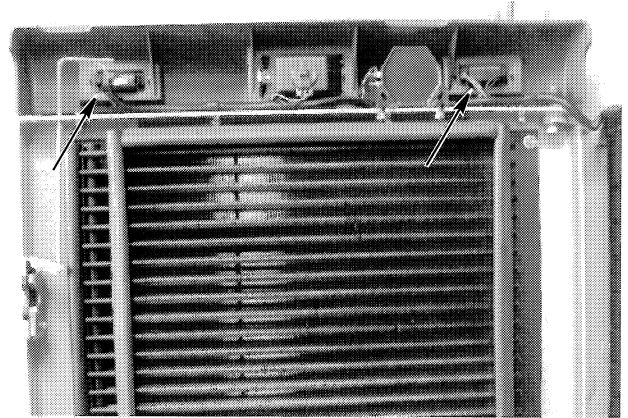

BD01C121

Disconnect the electrical connectors from the rear tail lamps on both sides of the rear access door. Put the electrical harness and rear work lamp out of the way.

STEP 7

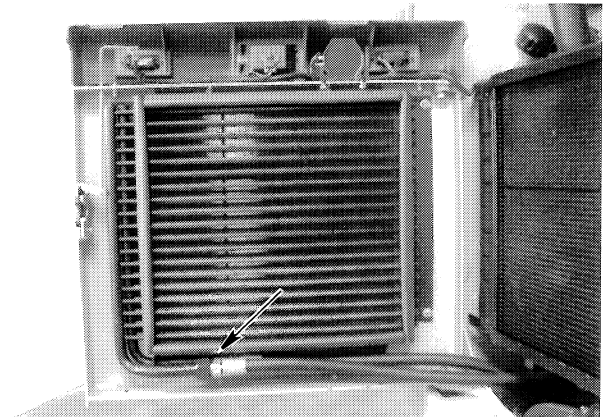

BD01C112

Tag and disconnect the hoses from the oil cooler on the rear access door.

2000-6

STEP 8

Connect acceptable lifting equipment to the rear access door.

STEP 9

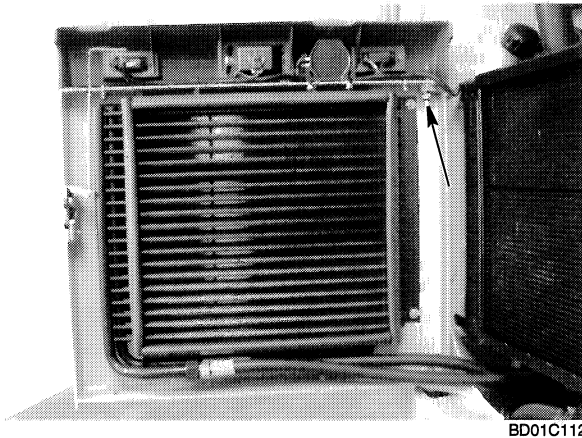

Loosen and remove the nut, spacer, bolt, and washer from the door.

STEP 10

Remove the door from the machine.

STEP 11



1. CYLINDER PIVOT BOLT

Remove the nut from cylinder pivot bolt (1) on the hood end of the cylinder.

STEP 12

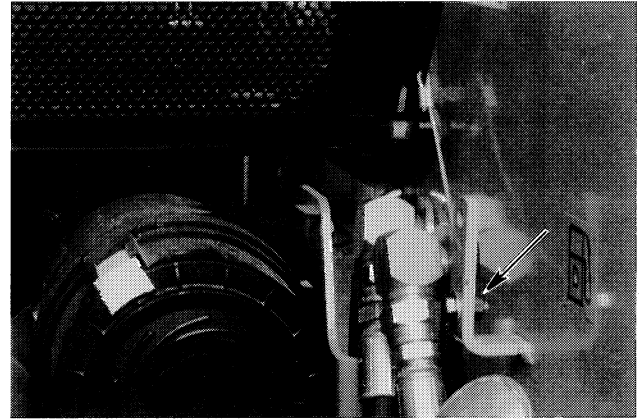

Remove the bolt, washer, and nut from the hood catch cable.

STEP 13

Push the hood to the right hand side of the machine and remove the left hand side of the hood from the pivot pin. Remove the hood from the machine.

STEP 14

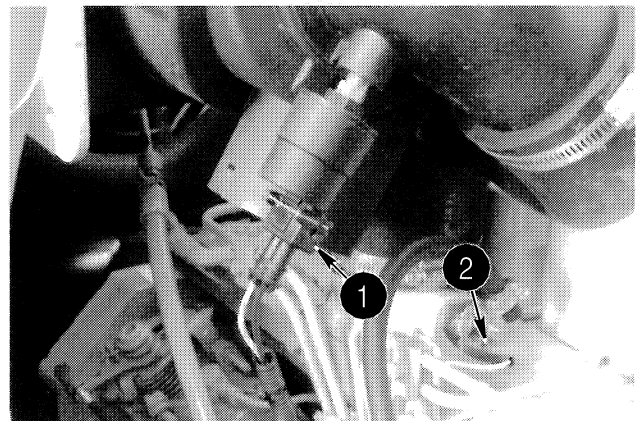

1. AIR RESTRICTION INDICATOR SWITCH
2. STARTING AID

Disconnect the electrical connector for the air restriction indicator switch (1) and starting aid switch (2).

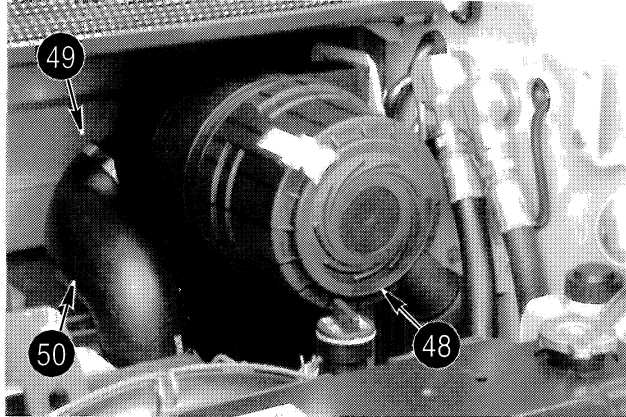
STEP 15

BD01C130

Loosen the clamps (49) on the intake manifold hose (50). Remove the hose from the intake and air filter assembly (48).

NOTE: Torque clamps (49) 3 to 4 Nm (25 to 35 pound-inches) during assembly.

NOTE: Refer to illustration on page 12.

STEP 16

Loosen and remove the bolts (53), washers (54 and 55), and nuts (56) from the air filter housing clamp (52).

STEP 17

Remove the air cleaner (48) and housing clamp (52) from the machine.

STEP 18

Loosen and remove the bolts (70) and washers (71) that fasten the muffler (60) to the exhaust manifold.

NOTE: Torque the bolts (70) 51 to 61 Nm (38 to 45 pound-feet) during assembly.

NOTE: Refer to illustration on page 13.

STEP 19

Remove the bolts (62) and washers (63) that fasten the bracket (61) to the machine.

NOTE: Torque bolts (62) 23 to 26 Nm (204 to 228 pound-inches) during assembly.

STEP 20

Remove the muffler from the machine (60).

STEP 21

Remove the bolts (27), washers (28), fan blade (29), and spacer (30) from the engine (38).

NOTE: Refer to illustration on page 11.

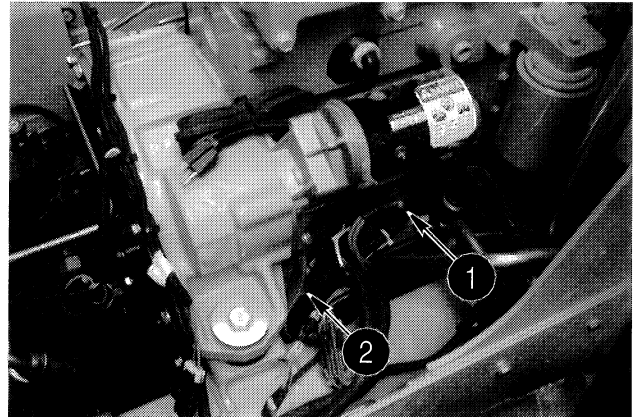
STEP 22

BD01C180

1. STARTER WIRES
2. GROUND STRAP

Disconnect the wires (1) from the starter solenoid.

STEP 23

Loosen and remove the starter mounting bolt and washer that holds the ground strap (2). Remove the ground strap from the bolt. Install the washer and starter mounting bolt.

STEP 24

Remove the bolt and wire harness clamp from the LH side of the engine.

STEP 25

Find the ground wires on the left hand side of the engine. Loosen and remove the bolts that fastens the ground wires to the engine. Keep all ground wires together.

STEP 26

BD01K21

Disconnect the wires from the alternator.

STEP 27

Loosen and remove the nut (32) and washer (33) that fastens the throttle linkage (31) to the fuel injection pump.

NOTE: Refer to illustration on page 11.

STEP 28

Loosen and remove the nut (32) and washer (33) that fastens the throttle linkage (31) to the throttle handle (34).

STEP 29

Disconnect the wire for the engine temperature switch. Cut the tie strap holding it to the engine and move out of the way.

STEP 30



Disconnect the wire connector for the fuel injection pump solenoid.

STEP 31

Loosen and remove the bolts that fasten the wire harness to the right side of the machine.

STEP 32

Move the wiring harness out of the way.

STEP 33

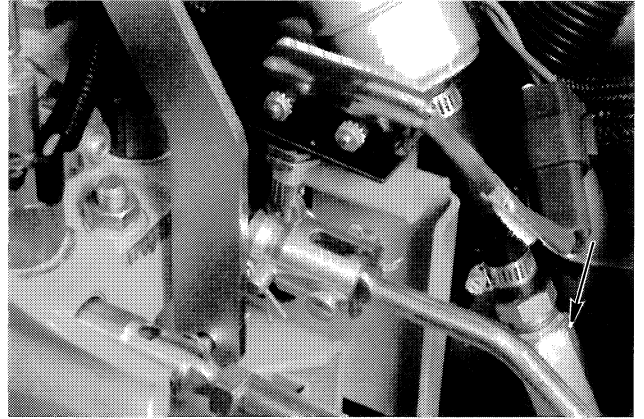

Close the fuel valves.

STEP 34

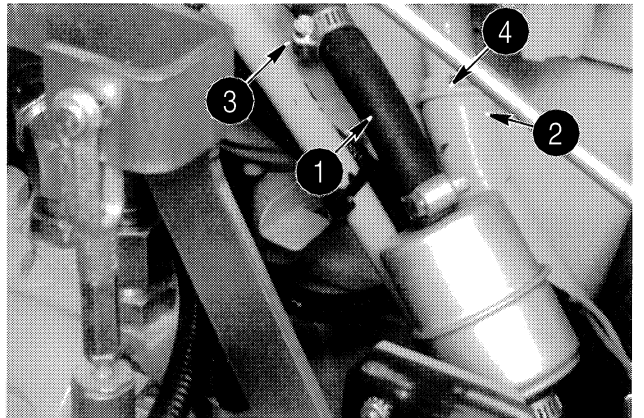

- 1. FUEL FEED LINE
- 2. FUEL RETURN LINE
- 3. CLAMP
- 4. CLAMP

Loosen the hose clamp (3) and disconnect the fuel line (1) from the fitting. Disconnect the fuel return line (2) from the engine by loosening the clamp (4) and removing the hose from the fitting.

STEP 35

Tag and disconnect all electrical connectors for the control valve. Cut the tie straps holding the wire harness to the engine and move the harness out of the way.

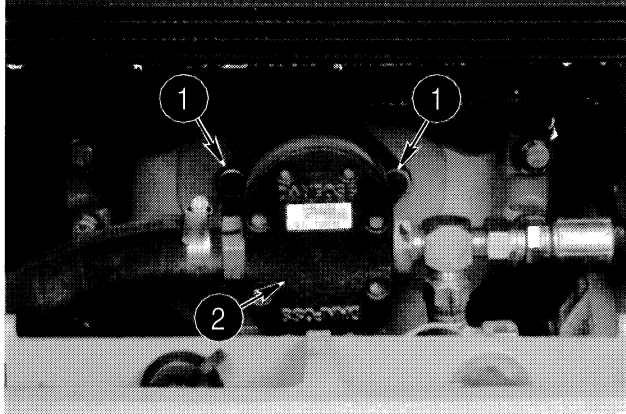
STEP 36

BD01J073

1. BOLT
2. PUMP

Loosen and remove the bolts (1) that fasten the gear pump (2) to the engine. Move the gear pump out of the way.

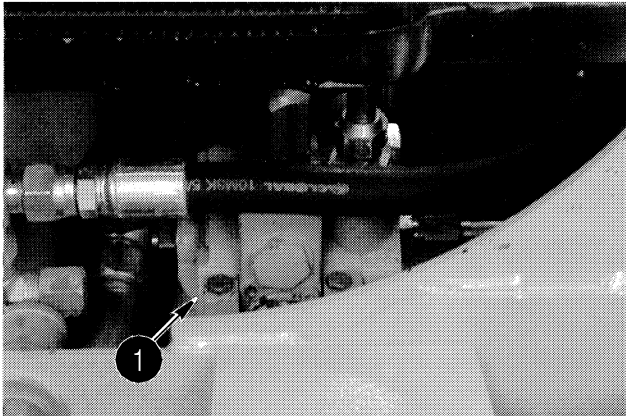
STEP 37

BD01J075

1. HIGH FLOW CONTROL VALVE

Loosen and remove the bolts, washers and self-locking nuts. Move the high flow control valve (1) toward the rear of the machine and out of the way.

STEP 38

Disconnect the hoses from the high flow pump.

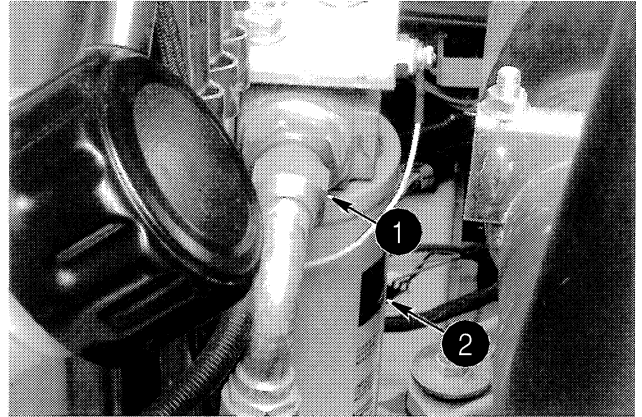
STEP 39

BD01K032

1. HOSE
2. FILTER

Disconnect the hose (1) from the fitting on the hydraulic filter (2). Remove the hydraulic filter (2).

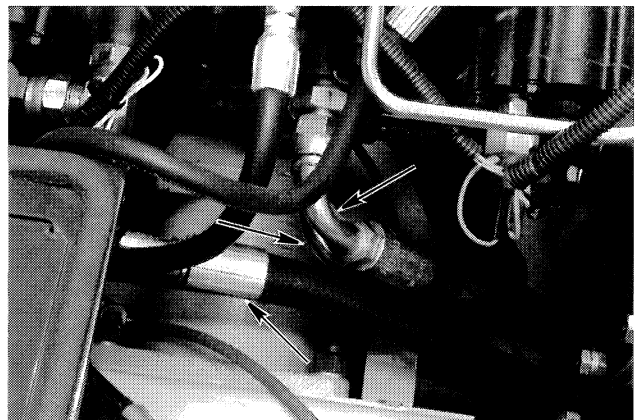
STEP 40

BD01J066

Disconnect the hydraulic lines shown from the left side of the tandem pump.

STEP 41

Connect equipment to the tandem pump that will hold the tandem pump in position when the engine is removed.

STEP 42

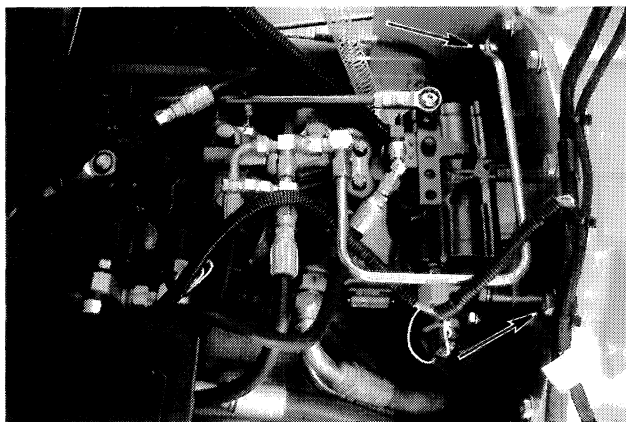

Loosen and remove the bolt (36) and washer (37) that fastens the wiring harness clamp and tube clamp to the tandem pump mounting plate (35). Move the wiring harness and tube out of the way.

NOTE: Refer to illustration on page 11.

STEP 43

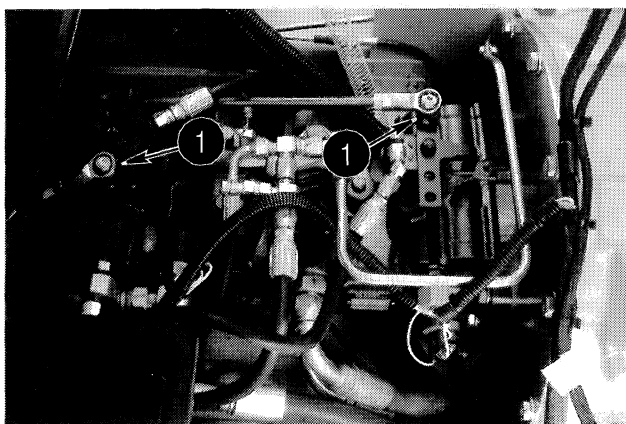

1. CONTROL ROD

Disconnect the control rods (1) from the tandem pump by removing the nut from the rod end.

STEP 44

Remove the bolts and washers that fasten the tandem pump to the mounting plate (35) on the engine (38).

NOTE: During assembly torque the bolts 39 to 47 Nm (345 to 416 pound-inches).

NOTE: Refer to illustration on page 11.

STEP 45

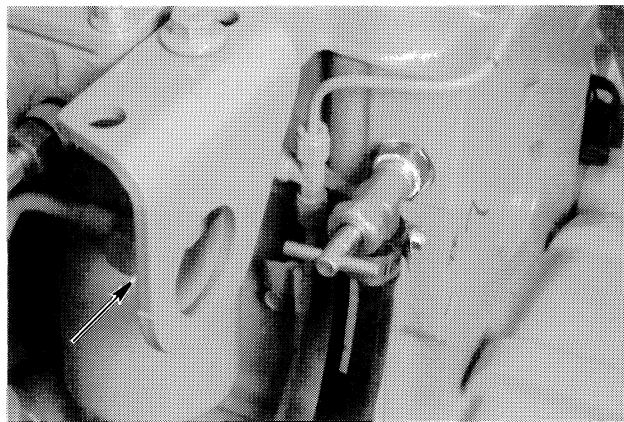

Remove the bolts from the front lifting eye (47) and turn the lifting eye right side up and install the bolts.

STEP 46

Connect acceptable lifting equipment to the engine lifting eyes (47).

STEP 47

Remove the bolts (39), washers (40 and 42), spacer (41), and nut (43) from the engine mounts.

NOTE: Torque the bolts 183 to 224 Nm (135 to 165 pound-feet) during assembly.

STEP 48

Remove the bolt (44), washer (45), and spacer (46) from the engine front mount.

NOTE: Torque the bolts 183 to 224 Nm (135 to 165 pound-feet) during assembly.

STEP 49

Move the engine away from the tandem pump mounting plate until the splined shaft on the tandem pump disengages the coupling.

STEP 50

Remove the engine (38) from the machine.

NOTE: During assembly apply anti-seize compound to the splined shaft on the tandem pump before engaging the splined shaft in the coupling.

Installation

STEP 51

Installation of the engine is the reverse of removal.

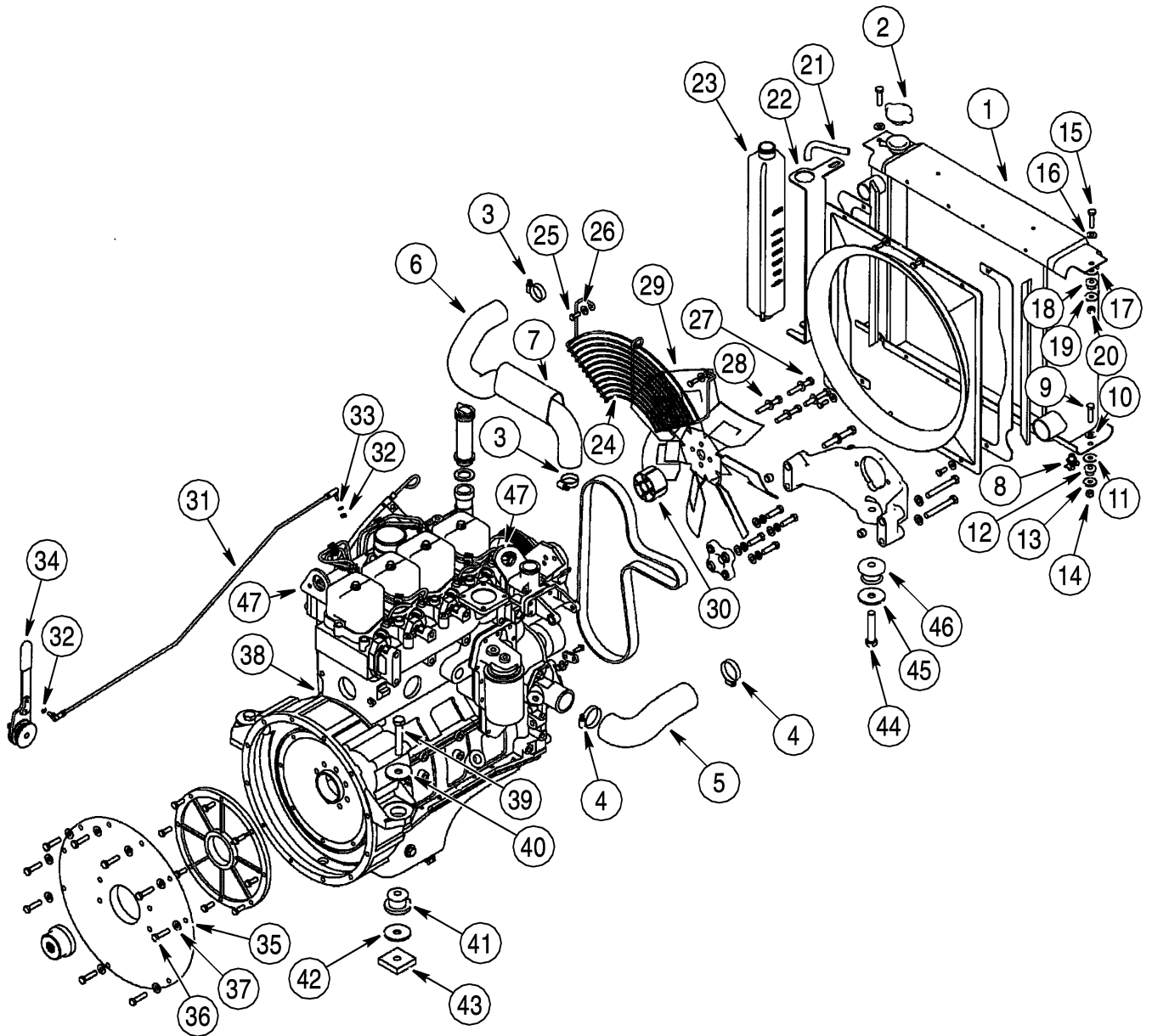

- | | | | | |
|------------------------|------------|----------------------|----------------------|-----------------|
| 1. RADIATOR | 11. WASHER | 21. OVER FLOW HOSE | 31. THROTTLE ROD | 41. MOUNT |
| 2. RADIATOR CAP | 12. MOUNT | 22. BRACKET | 32. NUT | 42. WASHER |
| 3. HOSE CLAMP | 13. WASHER | 23. OVER FLOW BOTTLE | 33. WASHER | 43. NUT |
| 4. HOSE CLAMP | 14. NUT | 24. FAN GUARD | 34. THROTTLE HANDLE | 44. BOLT |
| 5. LOWER RADIATOR HOSE | 15. BOLT | 25. BOLT | 35. PUMP MOUNT PLATE | 45. WASHER |
| 6. UPPER RADIATOR HOSE | 16. WASHER | 26. WASHER | 36. BOLT | 46. MOUNT |
| 7. HOSE HEAT GUARD | 17. WASHER | 27. BOLT | 37. WASHER | 47. LIFTING EYE |
| 8. DRAIN VALVE | 18. MOUNT | 28. WASHER | 38. ENGINE | |
| 9. BOLT | 19. WASHER | 29. FAN | 39. BOLT | |
| 10. WASHER | 20. NUT | 30. SPACER | 40. WASHER | |

ENGINE MOUNTING

BS01K211



Suggest:

If the above button click is invalid.

Please download this document first, and then click the above link to download the complete manual.

Thank you so much for reading

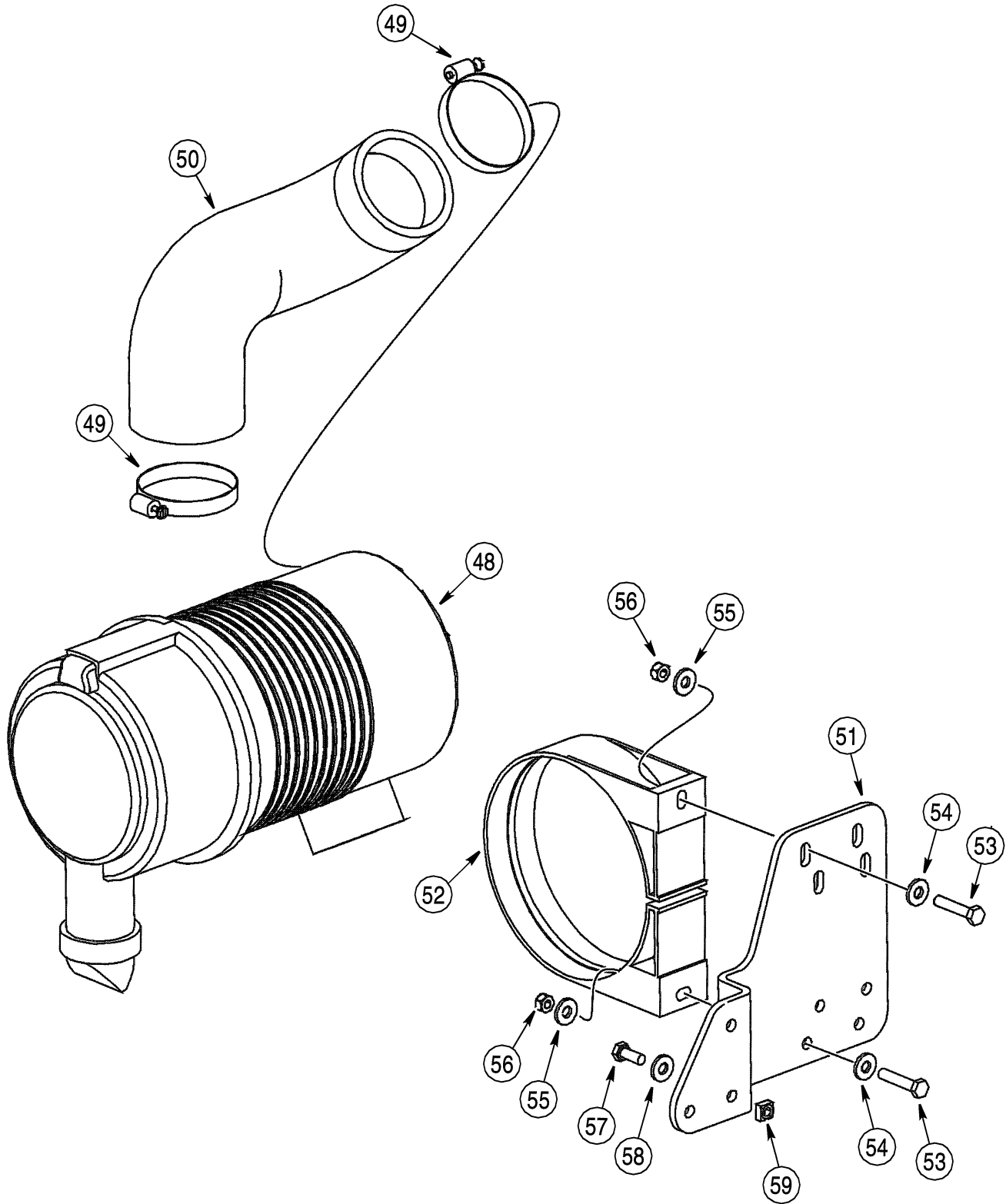

48. AIR FILTER HOUSING
49. HOSE CLAMP
50. INTAKE HOSE

51. BRACKET
52. HOUSING CLAMP
53. BOLT

54. WASHER
55. WASHER
56. NUT

57. BOLT
58. WASHER
59. NUT

AIR FILTER ASSEMBLY

BC01K147

<https://www.ebooklibonline.com>

Hello dear friend!

Thank you very much for reading.

Enter the link into your browser.

The full manual is available for immediate download.

<https://www.ebooklibonline.com>