

# Instructions for Parts Books

The heading at the top of the page will be the same for the picture of the parts as it is for the page with the part numbers.

Definition of column headings on part number pages:

**REF.No** → The number referring to the part on the picture page of the parts book.

**Part No.** → The number assigned to this part at the time of printing the parts book.

**Description** → Description of part.

**Q'ty** → Quantity of part used on that page.

**S.No.** → Serial number range of the equipment that this part will fit.

>= Your serial number should be greater than or equal to the number shown.

<= Your serial number should be lesser than or equal to the serial number shown.

**I/C** → Interchangeability of part shown.

↔ The part shown will work for the older and later serial number.

# The part shown is not interchangeable with the other serial number.

← new for old

→ old for new

**Remarks** → Notes about this particular part. Sometimes this may say except [FR] or [CA]

## Note about Country Codes:

The parts books we use in the United States of America may also contain information about a part that would be different in another country. It is important that you are aware of the country codes in some instances.

Symbol	Country
A	United States of America
CA	Canada
FR	France
GR	Greece
PO	Portugal
AU	Australia

If the remarks column says for example EXCEPT [FR] this part works in all countries except France. That means it will work here in the USA.

ALL PRODUCT INDEX  
B1550D

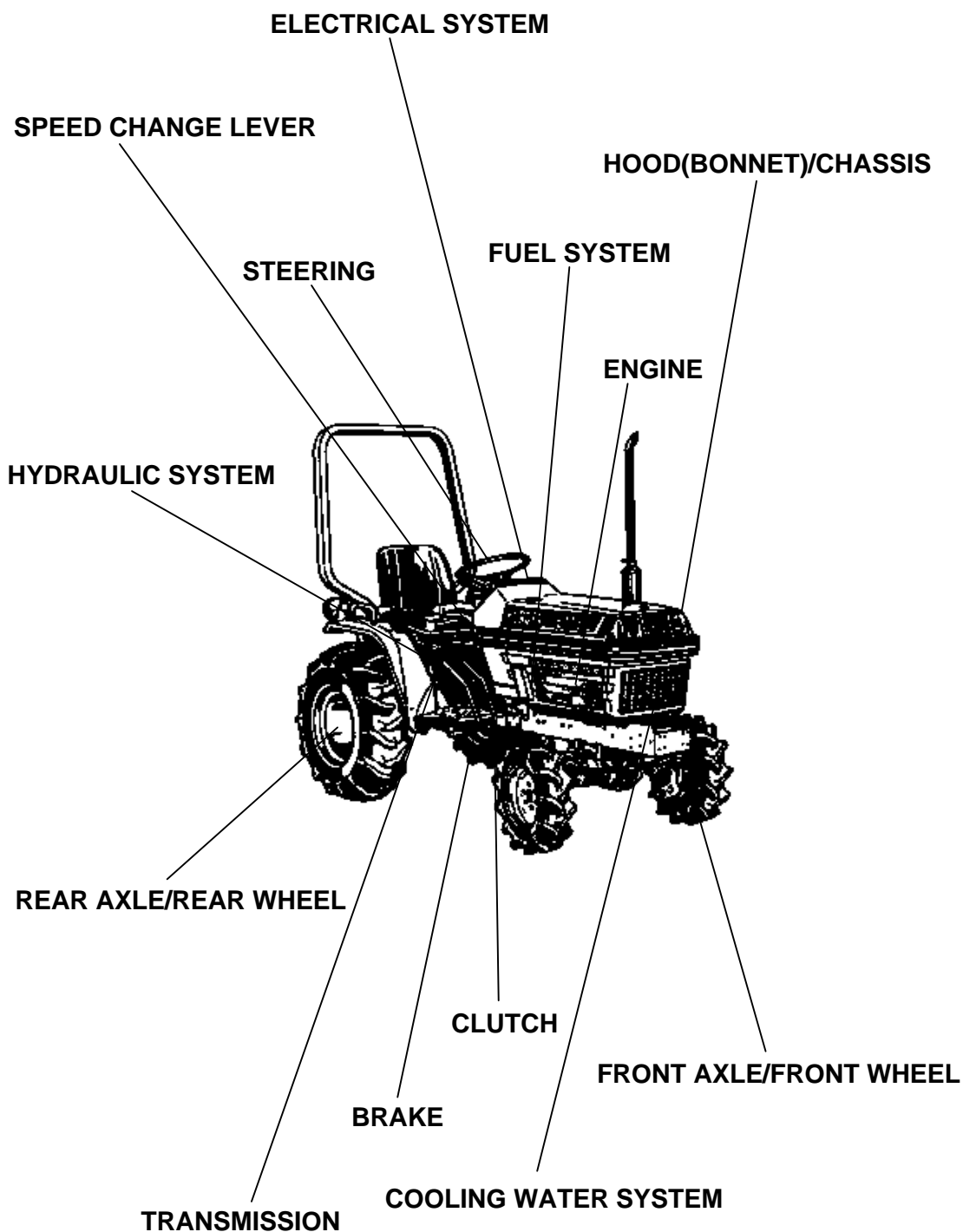

LABELS

ACCESSORIES

Item	Part No.	Description	Book	
ENGINE	01T001	CRANKCASE	100K0193	
	01T002	OIL PAN	100K0193	
	01T003	PISTON/CRANKSHAFT	100K0193	
	01T004	MAIN BEARING CASE	100K0193	
	01T005	FLYWHEEL	100K0193	
	01T006	CYLINDER HEAD	100K0193	
	01T007	VALVE/ROCKER ARM	100K0193	
	01T008	NOZZLE HOLDER	100K0193	
	01T009	NOZZLE HOLDER [COMPONENT PARTS]	100K0193	
	01T010	CYLINDER HEAD COVER	100K0193	
	01T011	INLET MANIFOLD	100K0193	
	01T013	EXHAUST MANIFOLD	100K0193	
	01T015	CAMSHAFT	100K0193	
	01T016	GEAR CASE	100K0193	
	01T017	WATER PUMP	100K0193	
	01T018	TENSION PULLEY [CA]	100K0193	
	01T019	WATER FLANGE	100K0193	
	01T020	FUEL PUMP	100K0193	
	01T021	INJECTION PUMP	100K0193	
	01T022	INJECTION PUMP [COMPONENT PARTS]	100K0193	
	01T023	ENGINE STOP LEVER	100K0193	
	01T024	SPEED CONTROL PLATE	100K0193	
	01T025	GOVERNOR	100K0193	
	01T026	UPPER GASKET KIT	100K0193	
	01T027	LOWER GASKET KIT	100K0193	
	ELECTRICAL SYSTEM	01T03501	DYNAMO [A AU]	100K0193
		01T03502	ALTERNATOR [CA]	100K0193
01T03601		DYNAMO [A AU] [COMPONENT PARTS]	100K0193	
01T03602		ALTERNATOR [CA] [COMPONENT PARTS]	100K0193	
CLUTCH	01T045	CLUTCH	100K0193	
HYDRAULIC SYSTEM	01T094	HYDRAULIC GEAR PUMP	100K0193	
	01T095	HYDRAULIC GEAR PUMP [COMPONENT PARTS]	100K0193	
ENGINE	02T012	AIR CLEANER	100K0193	
	02T01401	MUFFLER	100K0193	
	02T01402	HORIZONTAL MUFFLER [OPTION]	100K0193	
	02T028	ENGINE STOP ROD	100K0193	
	02T029	ACCELERATOR LEVER	100K0193	
FUEL SYSTEM	02T030	FUEL TANK	100K0193	
	02T031	FUEL PIPE	100K0193	
	02T032	FUEL FILTER [COMPONENT PARTS]	100K0193	
COOLING WATER SYSTEM	02T03301	WATER PIPE	100K0193	
	02T03401	RADIATOR	100K0193	
ELECTRICAL SYSTEM	02T037	STARTER	100K0193	
	02T038	STARTER [COMPONENT PARTS]	100K0193	
	02T039	BATTERY	100K0193	
	02T040	LIGHT	100K0193	
	02T041	WORKING LIGHT [OPTION]	100K0193	
	02T04201	PANEL / SWITCH [A AU]	100K0193	
	02T04202	PANEL / SWITCH [CA]	100K0193	
	02T043	PANEL BOARD [COMPONENT PARTS]	100K0193	
	02T04401	WIRE HARNESS [A AU]	100K0193	
	02T04402	WIRE HARNESS [CA]	100K0193	
	CLUTCH	02T046	CLUTCH ROD	100K0193
02T047		CLUTCH PEDAL	100K0193	
02T048		CLUTCH HOUSING	100K0193	

**<https://www.ebooklibonline.com>**

Hello dear friend!

Thank you very much for reading.

Enter the link into your browser.

The full manual is available for immediate download.

**<https://www.ebooklibonline.com>**

Item	Part No.	Description	Book
TRANSMISSION	02T049	TRANSMISSION CASE	100K0193
	02T050	TRANSMISSION CASE COVER	100K0193
	02T051	PROPELLER SHAFT	100K0193
	02T052	1ST SHAFT	100K0193
	02T053	2ND SHAFT	100K0193
	02T054	3RD SHAFT/5TH SHAFT	100K0193
	02T055	4TH SHAFT	100K0193
	02T056	PINION SHAFT GEAR	100K0193
	02T057	REVERSE SHAFT	100K0193
	02T058	REAR PTO	100K0193
	02T059	MID PTO	100K0193
	02T060	FRONT PTO [OPTION]	100K0193
	SPEED CHANGE LEVER	02T061	MAIN GEAR SHIFT LEVER
02T062		MAIN GEAR SHIFT FORK	100K0193
02T063		RANGE GEAR SHIFT LEVER	100K0193
02T064		PTO GEAR SHIFT LEVER	100K0193
REAR AXLE/REAR WHEEL	02T065	REAR DIFFERENTIAL	100K0193
	02T066	DIFF.LOCK PEDAL	100K0193
	02T067	REAR AXLE	100K0193
	02T068	REAR AXLE CASE	100K0193
	02T06902	REAR WHEEL (8-16)	100K0193
	02T06904	REAR WHEEL (29 X 12.00-15)	100K0193
	02T06906	REAR WHEEL (31 X 13.5-15 BAR) [A]	100K0193
	BRAKE	02T070	BRAKE
02T071		BRAKE ROD	100K0193
02T072		BRAKE PEDAL	100K0193
FRONT AXLE/FRONT WHEEL		02T07601	FRONT WHEEL HUB [WITHOUT BI-SPEED TURN]
	02T07602	FRONT WHEEL HUB	100K0193
	02T07701	FRONT GEAR CASE [WITHOUT BI-SPEED TURN]	100K0193
	02T07702	FRONT GEAR CASE	100K0193
	02T078	BEVEL GEAR CASE	100K0193
	02T07901	FRONT AXLE CASE [WITHOUT BI-SPEED TURN]	100K0193
	02T07903	FRONT AXLE CASE [WITH BI-SPEED TURN]	100K0193
	02T08001	FRONT DIFFERENTIAL [WITHOUT BI-SPEED TURN]	100K0193
	02T08003	FRONT DIFFERENTIAL [WITH BI-SPEED TURN]	100K0193
	02T081	BEVEL GEAR [WITH BI-SPEED TURN]	100K0193
	02T082	CLUTCH DISK [WITH BI-SPEED TURN]	100K0193
	02T083	FRONT DRIVE SHAFT	100K0193
	02T084	FRONT DRIVE LEVER	100K0193
	02T085	SHIFT FORK [WITH BI-SPEED TURN]	100K0193
	02T086	SHIFT LEVER [WITH BI-SPEED TURN]	100K0193
	02T087	BI-SPEED TURN ROD [WITH BI-SPEED TURN]	100K0193
	02T088	BI-SPEED TURN LEVER [WITH BI-SPEED TURN]	100K0193
	02T08901	FRONT WHEEL (6-12B)	100K0193
	02T08903	FRONT WHEEL (20.5 X 8.00-10)	100K0193
	02T090	FRONT AXEL FRAME	100K0193
STEERING	02T09101	KNUCKLE ARM [WITHOUT BI-SPEED TURN]	100K0193
	02T09103	KNUCKLE ARM [WITH BI-SPEED TURN]	100K0193
	02T09201	MANUAL STEERING	100K0193
	02T09202	POWER STEERING	100K0193
	02T09301	MANUAL STEERING [COMPONENT PARTS]	100K0193
HYDRAULIC SYSTEM	02T09302	POWER STEERING [COMPONENT PARTS]	100K0193
	02T096	HYDRAULIC PIPE (PS)	100K0193

Item	Part No.	Description	Book	
HYDRAULIC SYSTEM	02T097	HYDRAULIC PIPE (FRONT)	100K0193	
	02T098	HYDRAULIC PIPE (REAR)	100K0193	
	02T09901	HYDRAULIC BLOCK (MS) [COMPONENT PARTS]	100K0193	
	02T09902	HYDRAULIC BLOCK (PS) [COMPONENT PARTS]	100K0193	
	02T100	LIFT ARM	100K0193	
	02T10101	HYD.CYLINDER CAP [COMPONENT PARTS]	100K0193	
	02T10102	HYD.CYLINDER CAP [COMPONENT PARTS]	100K0193	
	02T10103	HYD.CYLINDER CAP [COMPONENT PARTS]	100K0193	
	02T102	CONTROL VALVE	100K0193	
	02T103	CONTROL VALVE [COMPONENT PARTS]	100K0193	
	02T104	TOP LINK	100K0193	
	02T105	LOWER LINK	100K0193	
	02T106	LIFTING ROD	100K0193	
	HOOD(BONNET)/CHASSIS	02T107	HOOD (BONNET)	100K0193
		02T108	LACE	100K0193
		02T109	HOOD COVER REAR	100K0193
		02T110	SKIRT (FRONT)	100K0193
		02T111	SKIRT (SIDE)	100K0193
		02T112	DUST COVER	100K0193
		02T113	TANK SUPPORT	100K0193
02T114		FENDER	100K0193	
02T115		SEAT	100K0193	
02T116		STEP	100K0193	
02T11701		ROPS [A CA]	100K0193	
02T11702		ROPS [A CA]	100K0193	
LABELS		02T118	LABEL 1	100K0193
		02T119	LABEL 2	100K0193
ACCESSORIES		02T120	ACCESSORIES AND SERVICE PARTS	100K0193

CRANKCASE

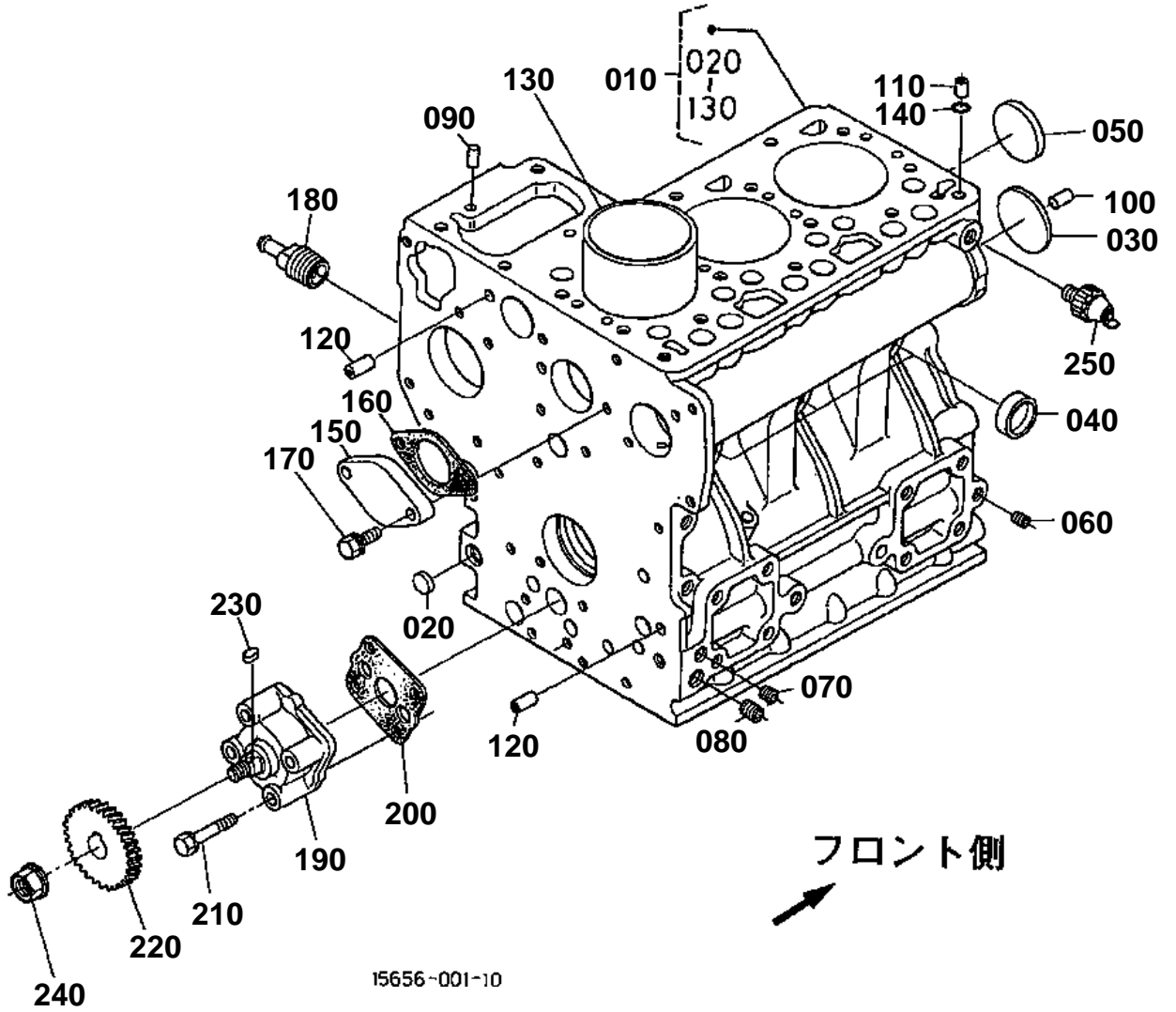

**CRANKCASE**

↔ Interchangeable; ≠ not interchangeable; ← new for old; → old for new

REF.No	Part No.	Description	Q'ty	S.No.	I/C	REMARKS	Weight (kgf)	Weight (lb)
010	15655-01010	COMP.CRANKCASE	1				28.5	62.7
020	15261-96170	PLUG	3				0.005	0.011
030	15261-96160	PLUG	1				0.02	0.044
040	15321-96260	CAP SEALING	5				0.014	0.0308
050	15221-03490	CAP SEALING	1				0.02	0.044
060	15261-96010	PLUG	6				0.002	0.0044
070	15521-96020	PLUG	3				0.003	0.0066
080	15521-96030	PLUG	1				0.007	0.0154
090	05012-00609	PIN STRAIGHT	2				0.003	0.0066
100	05012-00814	PIN STRAIGHT	2				0.006	0.0132
110	15221-33650	PIN PIPE	1				0.004	0.0088
120	15231-33960	PIN PIPE	2				0.001	0.0022
130	15901-02310	LINER CYLINDER	3	≤755814			0.398	0.8756
140	15221-33700	O RING	1				0.001	0.0022
150	15261-73910	COVER WATER	1				0.13	0.286
160	15261-73920	GASKET WATER COVER	1	≤945299			0	0
160	15263-73920	GASKET WATER COVER	1	≥945300	↔		0.002	0.0044
170	01023-50618	BOLT	2				0.006	0.0132
180	15531-73170	JOINT DRAIN PIPE	1				0.145	0.319
190	15261-35010	ASSY PUMP OIL	1				0.32	0.704
200	15261-35150	GASKET OIL PUMP	1	≤945299			0	0
200	15263-35150	GASKET OIL PUMP	1	≥945300	↔		0.001	0.0022
210	15261-91022	BOLT	4				0.012	0.0264
220	15954-35662	GEAR OIL PUMP DRIVE	1				0.14	0.308
230	05712-00410	KEY FEATHER	1				0.001	0.0022
240	02771-60100	NUT FLANGE	1				0.01	0.022
250	15531-39010	SWITCH OIL	1				0.032	0.0704

OIL PAN

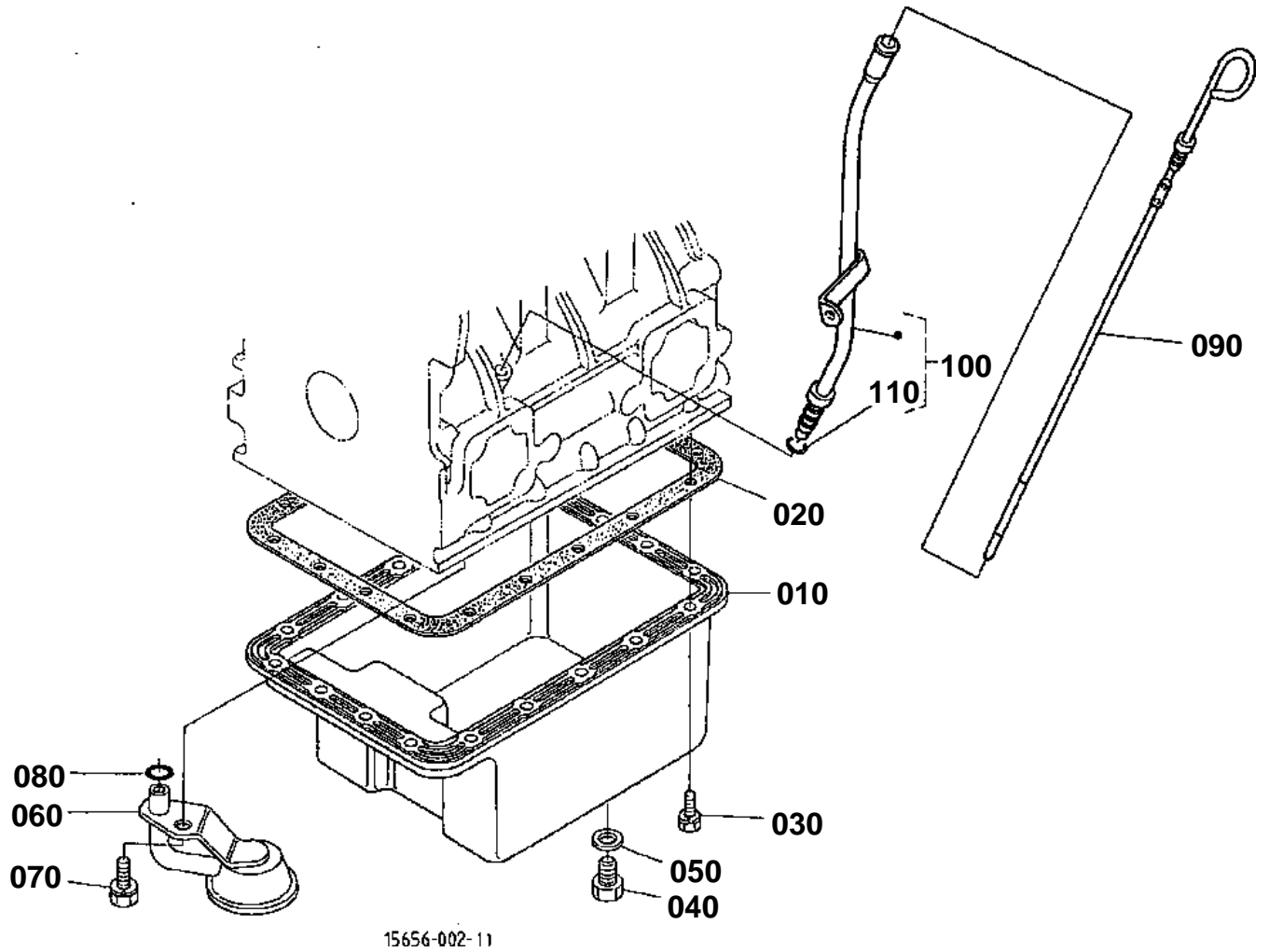

100 15655-3642-0

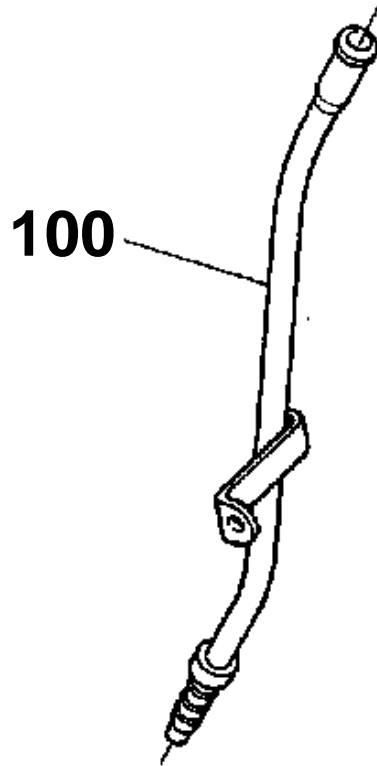

15656-803-10



# OIL PAN

↔ Interchangeable; ≠ not interchangeable; ← new for old; → old for new

REF.No	Part No.	Description	Q'ty	S.No.	I/C	REMARKS	Weight (kgf)	Weight (lb)
010	15371-01614	OIL PAN	1				1.1	2.42
020	15381-01620	GASKET OIL PAN	1	≤945299			0	0
020	15679-01620	GASKET OIL PAN	1	≥945300	↔		0.025	0.055
030	15381-91092	BOLT	18				0.002	0.0044
040	15221-33750	PLUG	1				0.032	0.0704
050	15109-33660	GASKET	1				0.001	0.0022
060	15531-32110	FILTER OIL	1				0.185	0.407
070	01123-60816	BOLT	1				0.01	0.022
080	04811-00140	RING	1				0.001	0.0022
090	15655-36410	GAUGE OIL	1				0.03	0.066
100	15655-36420	GUIDE OIL GAUGE	1	≤907383			0.1	0.22
100	15655-36500	ASSY GUIDE OIL GAUGE	1	≥907384	←		0.102	0.2244
110	04814-00090	O RING	1	≥907384			0.001	0.0022

PISTON/CRANKSHAFT

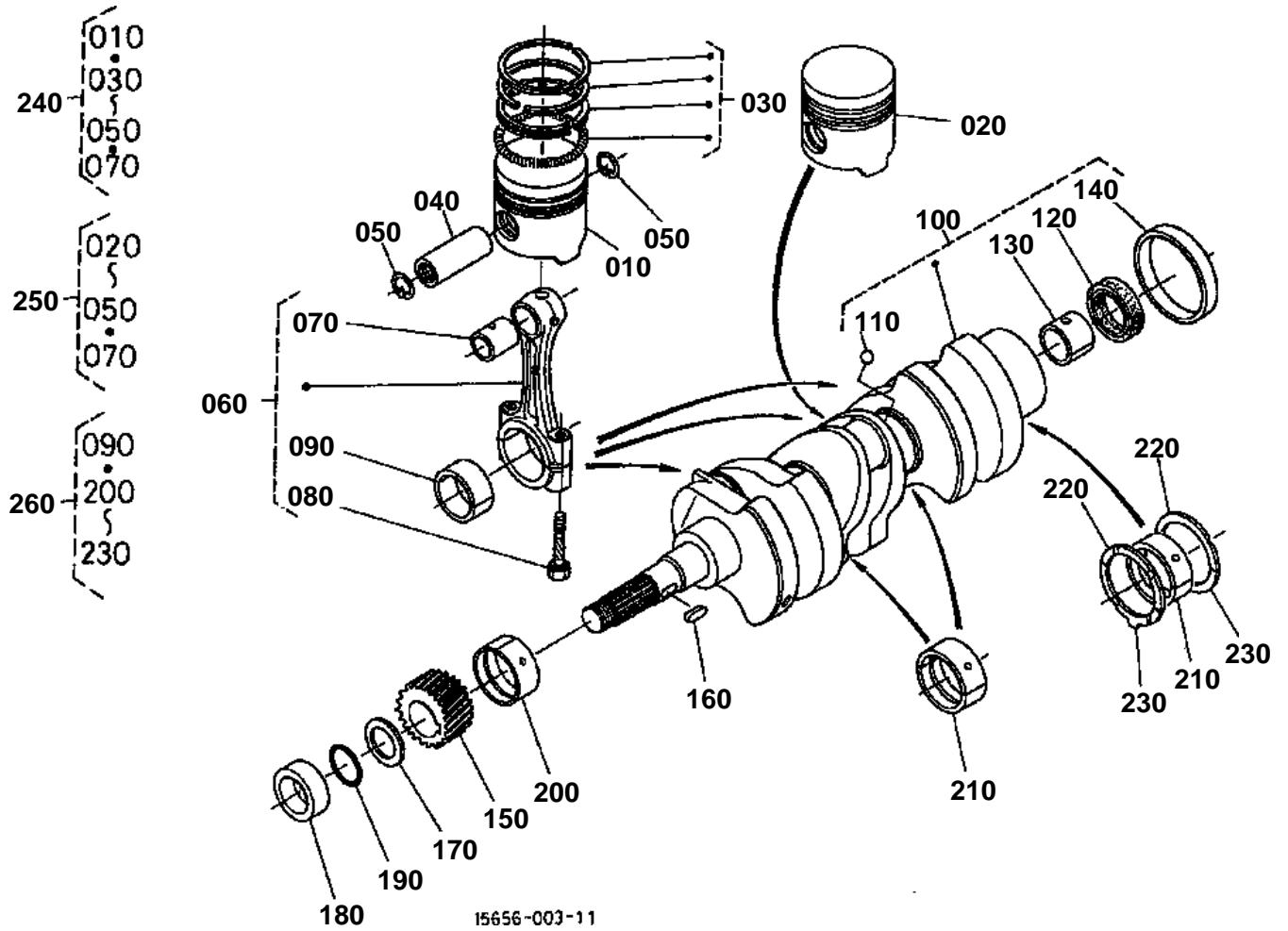



PISTON/CRANKSHAFT

↔ Interchangeable; ≠ not interchangeable; ← new for old; → old for new

REF.No	Part No.	Description	Q'ty	S.No.	I/C	REMARKS	Weight (kgf)	Weight (lb)
010	15956-21110	PISTON	3			STD	0.32	0.704
010	15956-21910	PISTON	3			+0.5MM	0.33	0.726
030	15901-21050	ASSY PISTON RING	3			STD	0.03	0.066
030	15901-21090	ASSY PISTON RING	3			+0.5MM	0.033	0.0726
040	15261-21310	PIN PISTON	3				0.102	0.2244
050	15261-21330	CIRCLIP PISTON PIN	6				0.001	0.0022
060	15381-22010	ASSY CONNECTING ROD	3	≤755815			0	0
060	15694-22010	ASSY CONNECTING ROD	3	≥755816	↔		0.5	1.1
070	15261-21980	BUSH PISTON PIN	3				0.012	0.0264
080	15381-22140	BOLT CONNECTING ROD	6				0.02	0.044
090	15531-22310	METAL CRANKPIN	3	≤755815		STD SET	0	0
090	15694-22310	METAL CRANKPIN	3	≥755816	↔	STD SET	0.02	0.044
090	15531-22970	METAL CRANKPIN	3	≤755815		-0.2MM SET	0	0
090	15694-22970	METAL CRANKPIN	3	≥755816	↔	-0.2MM SET	0.025	0.055
090	15531-22980	METAL CRANKPIN	3	≤755815		-0.4MM SET	0	0
090	15694-22980	METAL CRANKPIN	3	≥755816	↔	-0.4MM SET	0.02	0.044
100	15752-23010	COMP.CRANKSHAFT	1				8	17.6
110	07715-00401	BALL	3				0.001	0.0022
120	09400-14247	SEAL OIL	1				0.004	0.0088
130	66621-14120	BEARING DRY	1				0.006	0.0132
140	19215-23280	SLEEVE CRANKSHAFT	1				0.05	0.11
150	15752-24110	GEAR CRANKSHAFT	1				0.046	0.1012
160	05712-00515	KEY FEATHER	1				0.003	0.0066
170	15752-23310	SLINGER OIL	1				0.002	0.0044
180	15752-23250	COLLAR CRANKSHAFT	1				0.043	0.0946
190	04811-05230	RING	1				0.001	0.0022
200	15261-23470	METAL CRANKSHAFT	1	≤755815		STD	0	0
200	15694-23470	METAL CRANKSHAFT	1	≥755816	↔	STD	0.035	0.077
200	15261-23910	METAL CRANKSHAFT	1	≤755815		-0.2MM	0	0
200	15694-23910	METAL CRANKSHAFT	1	≥755816	↔	-0.2MM	0.04	0.088
200	15261-23920	METAL CRANKSHAFT	1	≤755815		-0.4MM	0	0
200	15694-23920	METAL CRANKSHAFT	1	≥755816	↔	-0.4MM	0.045	0.099
210	15261-23480	METAL CRANKSHAFT	3	≤755815		STD SET	0	0
210	15694-23480	METAL CRANKSHAFT	3	≥755816	↔	STD SET	0.04	0.088
210	15261-23930	METAL CRANKSHAFT	3	≤755815		-0.2MM SET	0	0
210	15694-23930	METAL CRANKSHAFT	3	≥755816	↔	-0.2MM SET	0.05	0.11
210	15261-23940	METAL CRANKSHAFT	3	≤755815		-0.4MM SET	0	0
210	15694-23940	METAL CRANKSHAFT	3	≥755816	↔	-0.4MM SET	0.046	0.1012
220	15261-23530	METAL SIDE	2			STD	0.006	0.0132
220	15261-23950	METAL SIDE	2			+0.2MM	0.006	0.0132
220	15261-23960	METAL SIDE	2			+0.4MM	0.007	0.0154
230	15261-23540	METAL SIDE	2			STD	0.007	0.0154
230	15261-23970	METAL SIDE	2			+0.2MM	0.006	0.0132
230	15261-23980	METAL SIDE	2			+0.4MM	0.007	0.0154
240	07916-28260	KIT PISTON AND RING	3			STD	0.2	0.44
240	07916-28480	KIT PISTON AND RING	3			+0.5MM	0.11	0.242
260	07916-28090	KIT METAL ENGINE	1			STD	0.25	0.55

MAIN BEARING CASE

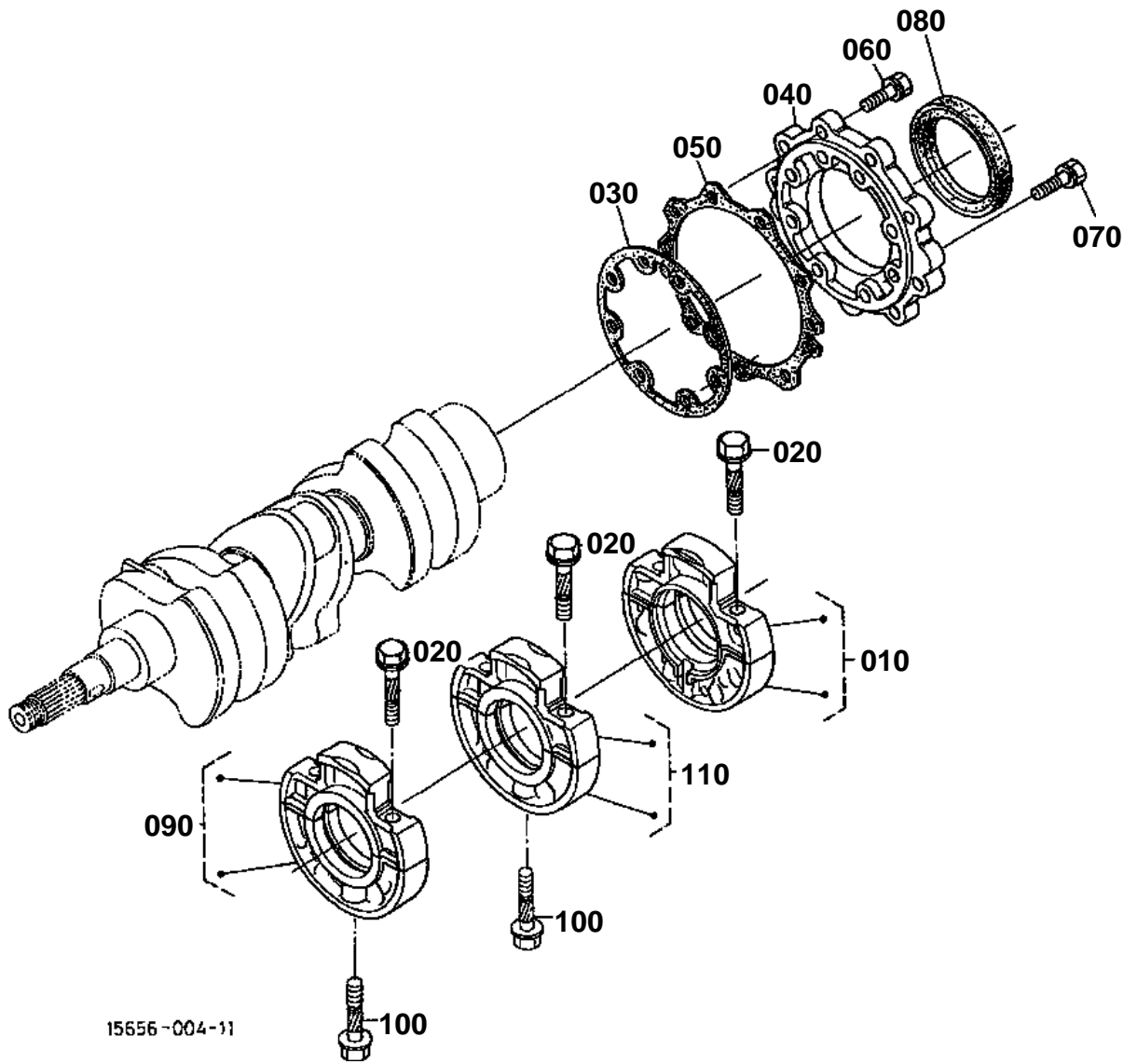



## MAIN BEARING CASE

↔ Interchangeable; ≠ not interchangeable; ← new for old; → old for new

REF.No	Part No.	Description	Q'ty	S.No.	I/C	REMARKS	Weight (kgf)	Weight (lb)
010	15261-04090	ASSY CASE MAIN BRG.	1				0.8	1.76
020	15381-04540	BOLT BEARING CASE	6				0.02	0.044
030	15261-04360	GASKET BRG.CASE	1	≤945299			0	0
030	15263-04360	GASKET BRG.CASE	1	≥945300	↔		0.005	0.011
040	15549-04810	COVER BEARING CASE	1				0.2	0.44
050	15261-04820	GASKET BRG.CASE COV.	1	≤945299			0	0
050	15263-04820	GASKET BRG.CASE COV.	1	≥945300	↔		0.001	0.0022
060	01023-50620	BOLT	9				0.006	0.0132
070	01023-50625	BOLT	8				0.007	0.0154
080	19215-04460	SEAL OIL	1				0.03	0.066
090	15261-04040	ASSY CASE MAIN BRG.	1				0.687	1.5114
100	15381-04560	BOLT BEARING CASE	2				0.02	0.044
110	15381-04050	ASSY CASE MAIN BRG.	1				0.688	1.5136

FLYWHEEL

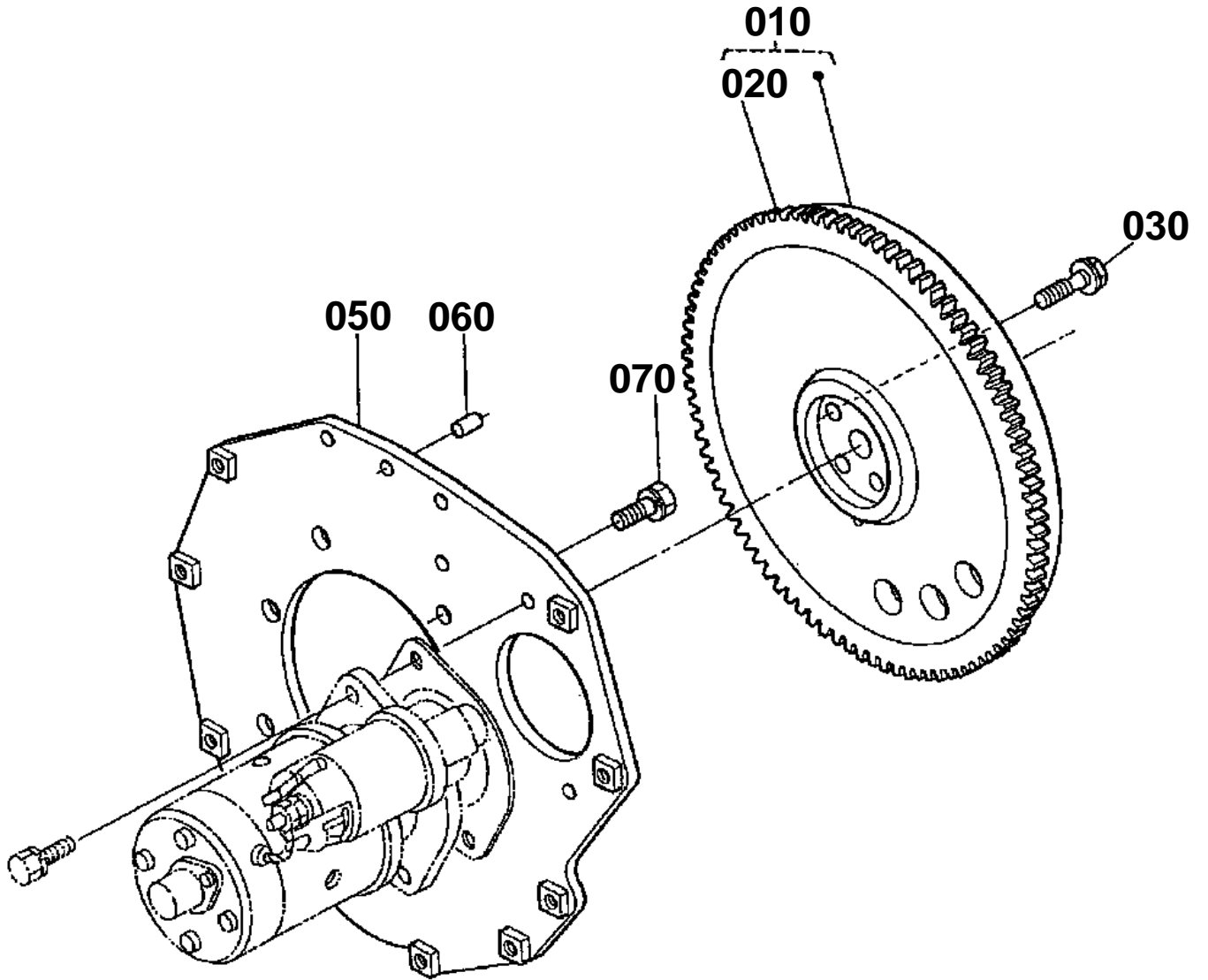

15656-005-10

FLYWHEEL

030 15533-2516-0

040 15531-2517-0

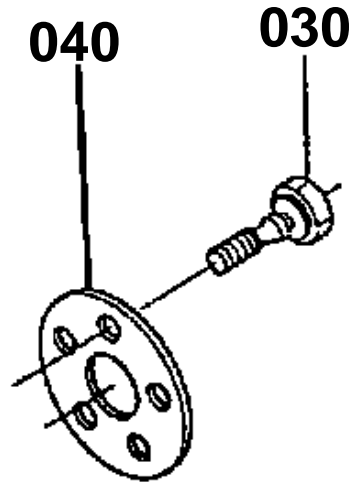

15656-800-10

**FLYWHEEL**

↔ Interchangeable; ≠ not interchangeable; ← new for old; → old for new

REF.No	Part No.	Description	Q'ty	S.No.	I/C	REMARKS	Weight (kgf)	Weight (lb)
010	15541-25012	COMP.FLYWHEEL	1				12	26.4
020	15261-63820	GEAR RING	1	<=715532			0	0
020	15262-63820	GEAR RING	1	>=715533	↔		0.65	1.43
030	15533-25160	BOLT FLYWHEEL	5	<=682801			0	0
030	15533-25162	BOLT FLYWHEEL	5	>=682802	≠		0.03	0.066
040	15531-25170	WASHER FLYWHEEL	1	<=682801			0.04	0.088
050	15541-04620	PLATE REAR END	1				2.76	6.072
060	05012-00814	PIN STRAIGHT	1				0.006	0.0132
070	15261-91190	BOLT	8				0.03	0.066

CYLINDER HEAD

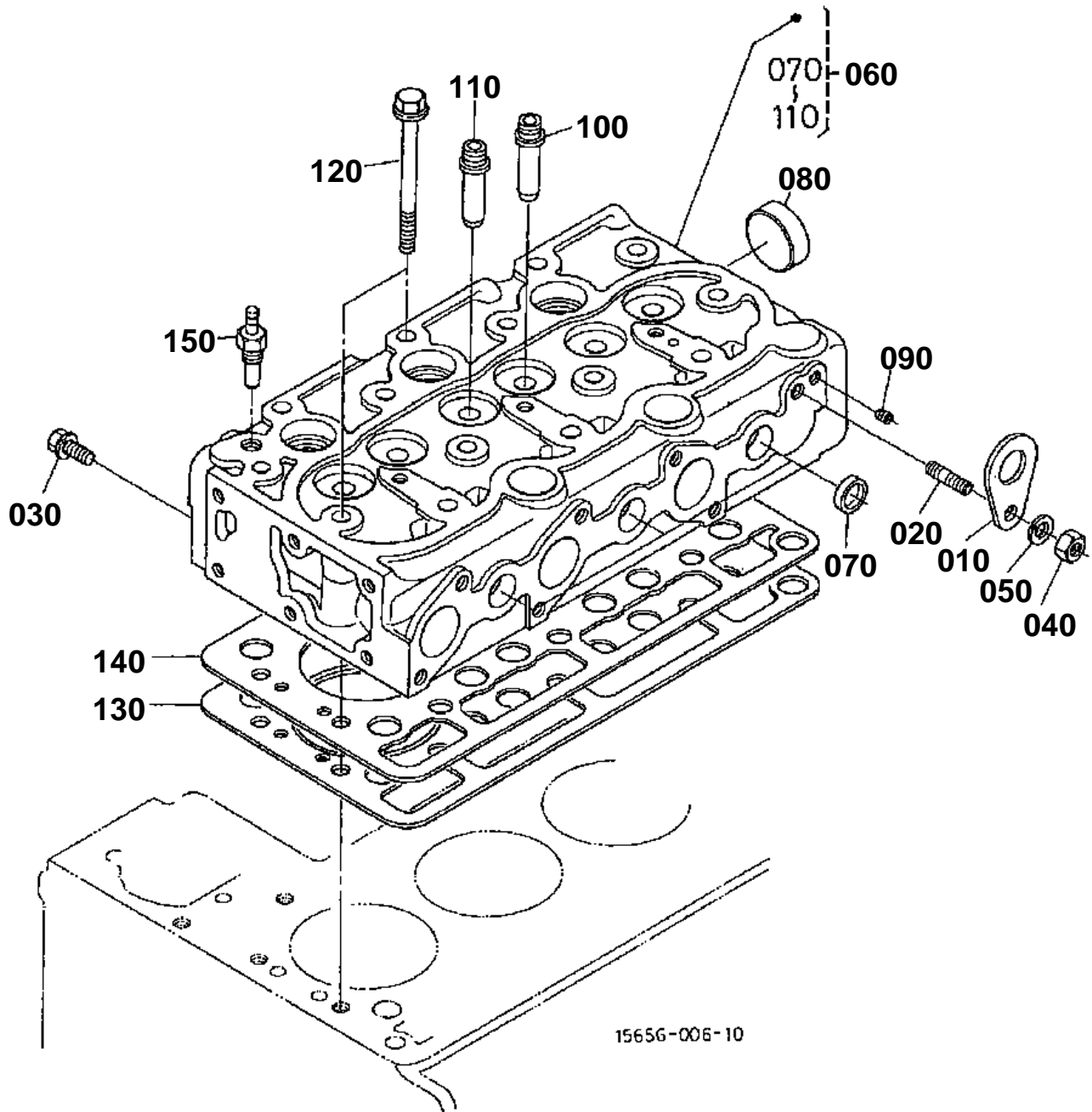



## CYLINDER HEAD

↔ Interchangeable; ≠ not interchangeable; ← new for old; → old for new

REF.No	Part No.	Description	Q'ty	S.No.	I/C	REMARKS	Weight (kgf)	Weight (lb)
010	15221-01750	HOOK ENGINE	1				0.04	0.088
020	01513-50816	STUD	1				0.009	0.0198
030	01123-60816	BOLT	1				0.01	0.022
040	02156-50080	NUT	1				0.004	0.0088
050	04512-50080	WASHER SPRING	1				0	0
060	19267-03040	COMP.CYLINDER HEAD	1				9.5	20.9
070	15261-03370	CAP SEALING	5				0.005	0.011
080	15321-96260	CAP SEALING	1				0.014	0.0308
090	15261-96010	PLUG	2				0.002	0.0044
100	15261-13540	GUIDE INLET VALVE	3				0.02	0.044
110	15261-13560	GUIDE EXHAUST VALVE	3				0.02	0.044
120	19215-03450	BOLT CYLINDER HEAD	14				0.047	0.1034
130	15582-03310	GASKET CYLINDER HEAD	1				0	0
140	15381-03320	SHIM CYL.HEAD GASKET	1				0.03	0.066
150	38240-32830	SWITCH THERMOMETER	1				0.03	0.066

VALVE/ROCKER ARM

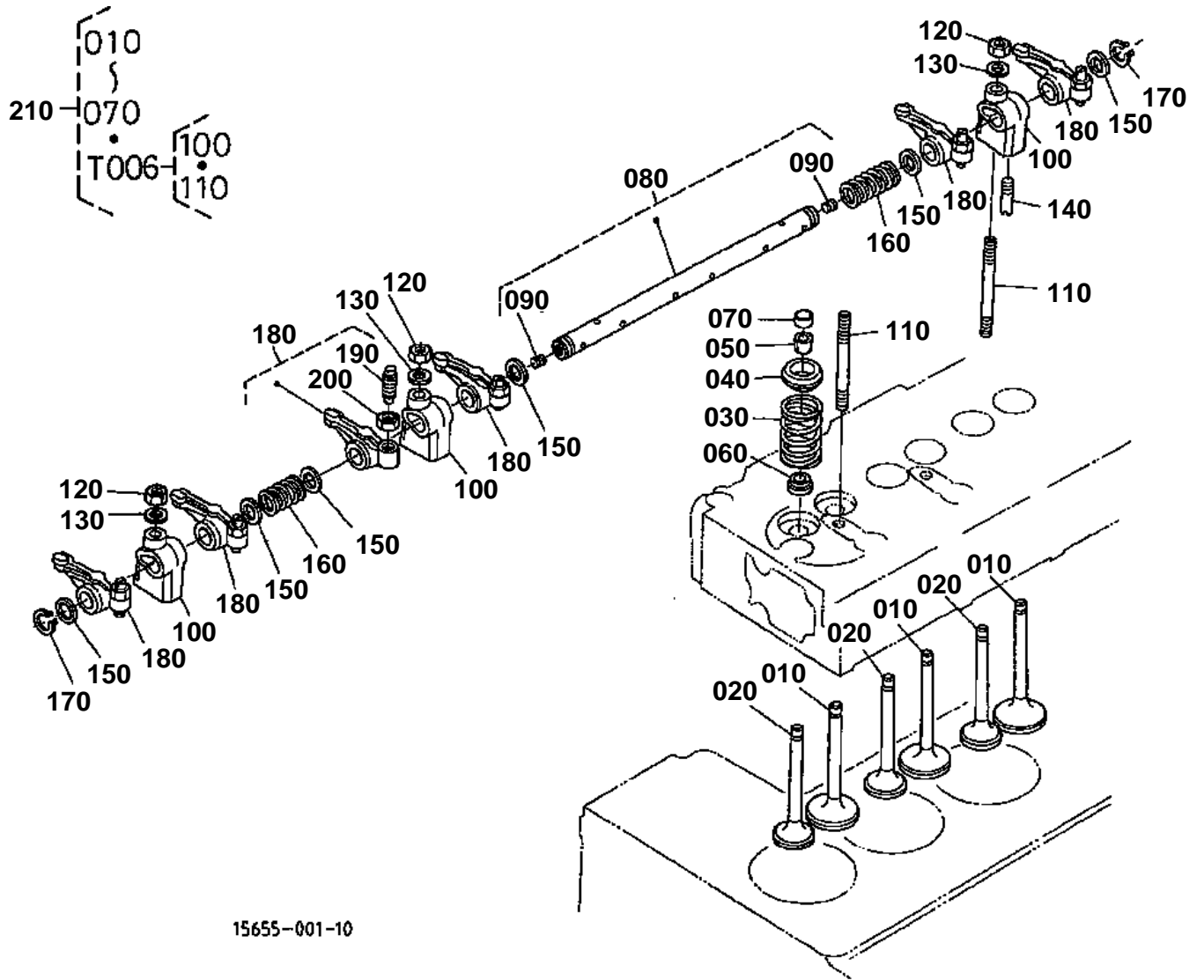

15655-001-10



VALVE/ROCKER ARM

↔ Interchangeable; ≠ not interchangeable; ← new for old; → old for new

REF.No	Part No.	Description	Q'ty	S.No.	I/C	REMARKS	Weight (kgf)	Weight (lb)
010	15393-13110	VALVE INLET	3				0.048	0.1056
020	15393-13120	VALVE EXHAUST	3				0.048	0.1056
030	15261-13240	SPRING VALVE	6				0.02	0.044
040	16241-13330	RETAINER VALVE SP.	6				0.012	0.0264
050	15261-13360	COLLET VALVE SPRING	6			SET	0.004	0.0088
060	15261-13150	SEAL VALVE STEM	6				0.001	0.0022
070	15261-13280	CAP VALVE	6	<=821125			0	0
070	16241-13280	CAP VALVE	6	>=821126	↔		0.005	0.011
080	15381-14053	ASSY SHAFT R-ARM	1				0.135	0.297
090	15381-93610	SCREW SET	2				0.001	0.0022
100	15381-14350	BRACKET ROCKER ARM	3				0.05	0.11
110	15952-14410	STUD	3				0	0
120	15261-92010	NUT	3				0.005	0.011
130	15261-94010	WASHER PLAIN	3				0.002	0.0044
140	15261-14420	SCREW SET.ROCKER ARM	1				0.002	0.0044
150	15261-14430	WASHER R-ARM.SHAFT	6				0.001	0.0022
160	15261-14310	SPRING ROCKER ARM	2				0.003	0.0066
170	04612-00110	CIRCLIP EXTERNAL	2				0.001	0.0022
180	15381-14030	ASSY ROCKER ARM	6	<=778923			0.05	0.11
180	15382-14030	ASSY ROCKER ARM	6	>=778924	→		0.05	0.11
190	15261-14232	SCREW ADJUSTING	6				0.006	0.0132
200	15261-14240	NUT	6				0.002	0.0044
210	07916-27360	KIT ENG.VALVE TRAIN	1				0.68	1.496

NOZZLE HOLDER

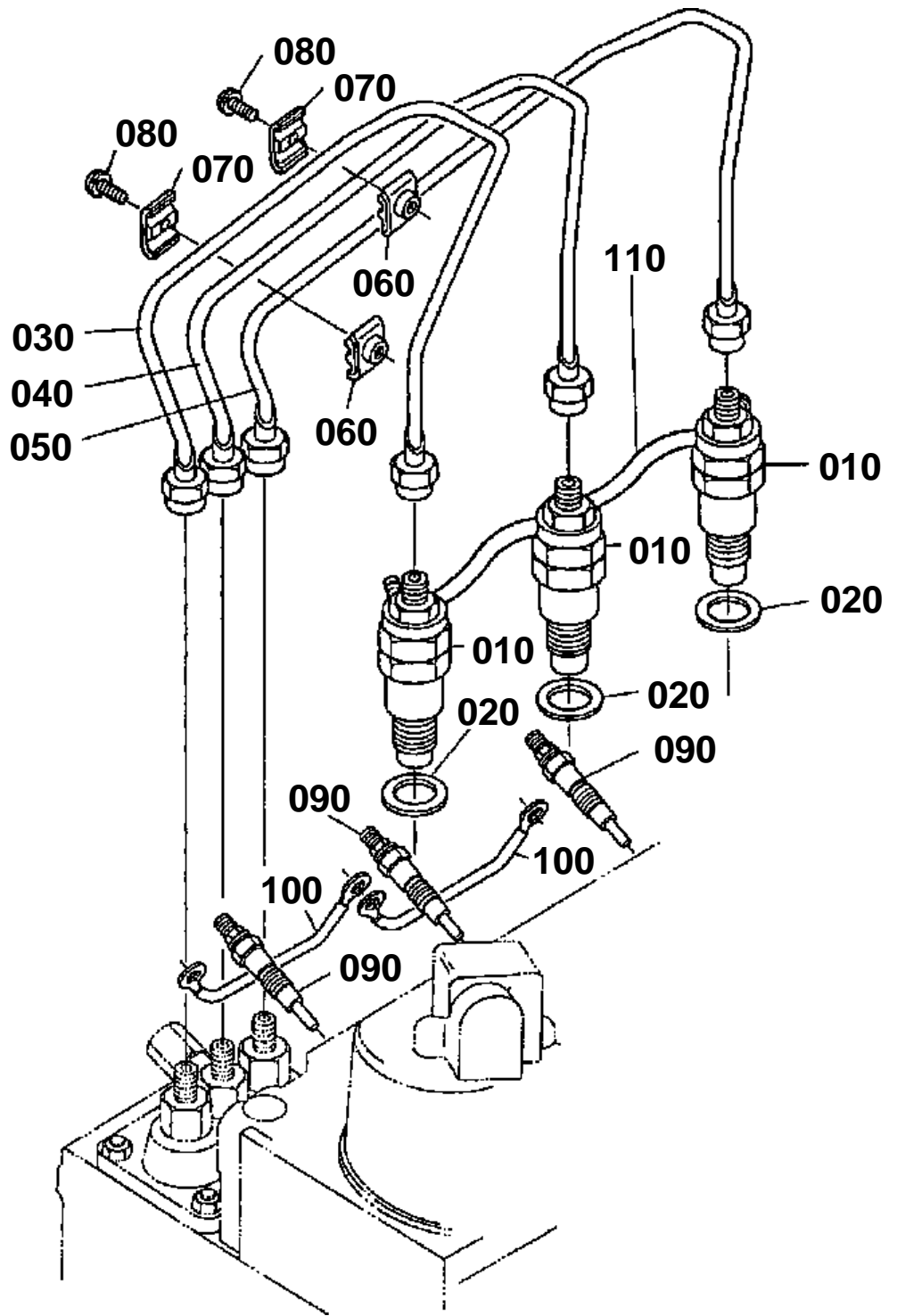

15656-008-10



# NOZZLE HOLDER

↔ Interchangeable; ≠ not interchangeable; ← new for old; → old for new

REF.No	Part No.	Description	Q'ty	S.No.	I/C	REMARKS	Weight (kgf)	Weight (lb)
010	15261-53020	ASSY HOLDER NOZZLE	3	<=821125		REFER TO L.No.0B05-R0 FOR COMPONENTS.	0	0
010	19202-53020	ASSY HOLDER NOZZLE	3	>=821126	↔	REFER TO L.No.0B05-R0 FOR COMPONENTS.	0.25	0.55
020	17011-53620	GASKET	3				0.003	0.0066
030	15727-53710	PIPE INJECTION	1				0.1	0.22
040	15727-53720	PIPE INJECTION	1				0.1	0.22
050	15727-53730	PIPE INJECTION	1				0.1	0.22
060	15841-53850	CLAMP PIPE	2				0.01	0.022
070	15841-53860	CLAMP PIPE	2				0.009	0.0198
080	03024-50520	SCREW WITH WASHER	2				0.004	0.0088
090	15694-65510	PLUG GLOW	3				0.02	0.044
100	15261-65560	CORD GLOW PLUG	2				0.005	0.011
110	15531-42500	ASSY PIPE OVER FLOW	1				0.065	0.143

NOZZLE HOLDER [COMPONENT PARTS]

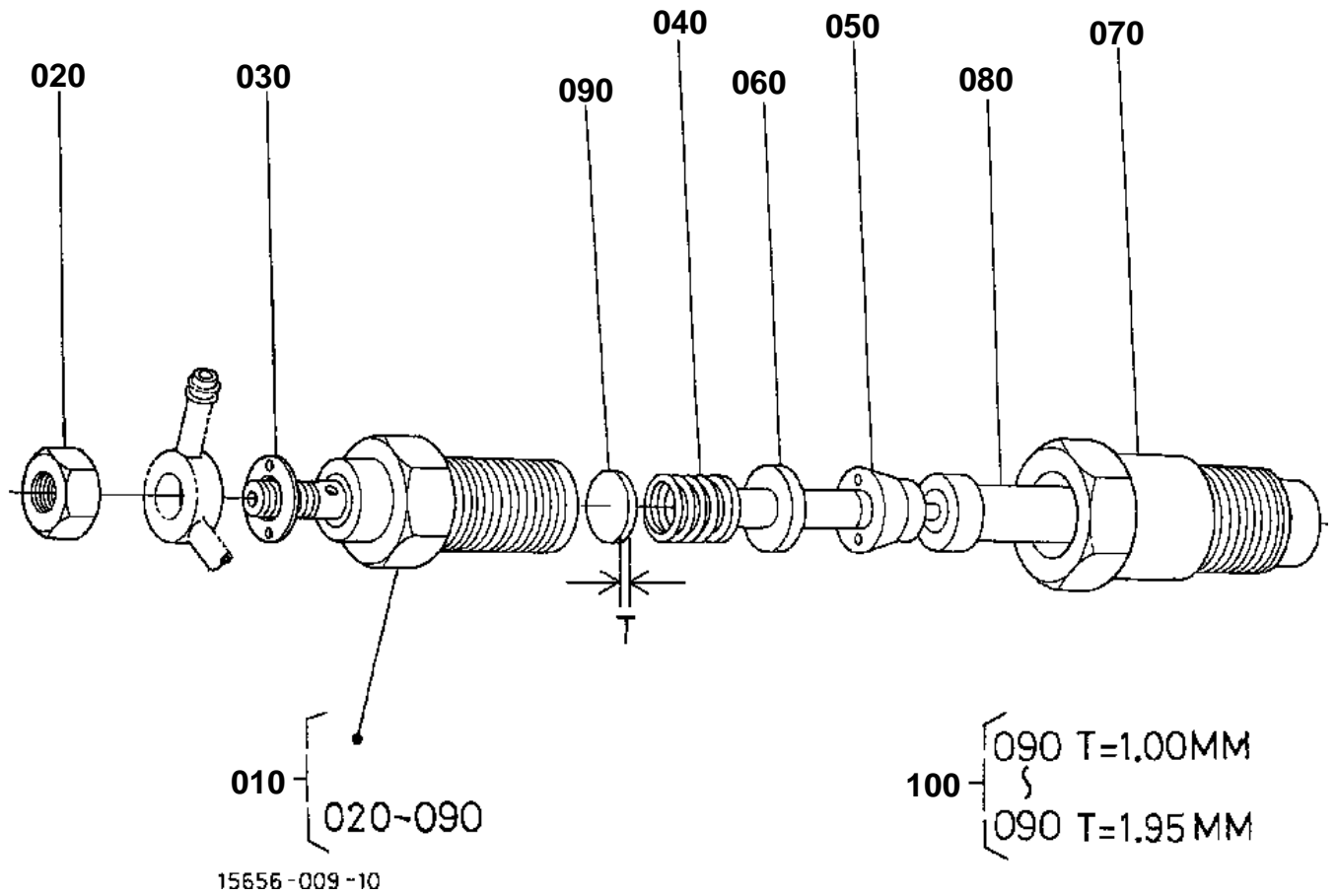



**Suggest:**

**For more complete manuals. Please go to the home page.**

**<https://www.ebooklibonline.com>**

**If the above button click is invalid. Please download this document first, and then click the above link to download the complete manual.**

**Thank you so much for reading**



**NOZZLE HOLDER [COMPONENT PARTS]**

↔ Interchangeable; ≠ not interchangeable; ← new for old; → old for new

REF.No	Part No.	Description	Q'ty	S.No.	I/C	REMARKS	Weight (kgf)	Weight (lb)
010	15261-53020	ASSY HOLDER NOZZLE	3	≤821125			0	0
010	19202-53020	ASSY HOLDER NOZZLE	3	≥821126	↔		0.25	0.55
020	15221-92020	NUT	3				0.011	0.0242
030	15221-94020	WASHER PLAIN	3				0.002	0.0044
040	15221-53170	SPRING NOZZLE	3				0.01	0.022
050	15221-53350	PIECE DISTANCE	3				0.016	0.0352
060	15221-53160	PUSH ROD	3				0.003	0.0066
070	15221-53280	NUT NOZZLE	3				0.068	0.1496
080	15021-53610	PIECE NOZZLE	3	≤821125			0	0
080	19202-53610	PIECE NOZZLE	3	≥821126	↔		0.045	0.099
090	15221-98110	WASHER ADJUSTING	3			1.00MM	0.001	0.0022
090	15221-98120	WASHER ADJUSTING	3			1.05MM	0.001	0.0022
090	15221-98130	WASHER ADJUSTING	3			1.10MM	0.001	0.0022
090	15221-98140	WASHER ADJUSTING	3			1.15MM	0.001	0.0022
090	15221-98150	WASHER ADJUSTING	3			1.20MM	0.001	0.0022
090	15221-98160	WASHER ADJUSTING	3			1.25MM	0.001	0.0022
090	15221-98170	WASHER ADJUSTING	3			1.30MM	0.001	0.0022
090	15221-98180	WASHER ADJUSTING	3			1.35MM	0.001	0.0022
090	15221-98190	WASHER ADJUSTING	3			1.40MM	0.002	0.0044
090	15221-98200	WASHER ADJUSTING	3			1.45MM	0.001	0.0022
090	15221-98210	WASHER ADJUSTING	3			1.50MM	0.001	0.0022
090	15221-98220	WASHER ADJUSTING	3			1.55MM	0.003	0.0066
090	15221-98230	WASHER ADJUSTING	3			1.60MM	0.003	0.0066
090	15221-98240	WASHER ADJUSTING	3			1.65MM	0.002	0.0044
090	15221-98250	WASHER ADJUSTING	3			1.70MM	0.002	0.0044
090	15221-98260	WASHER ADJUSTING	3			1.75MM	0.002	0.0044
090	15221-98270	WASHER ADJUSTING	3			1.80MM	0.002	0.0044
090	15221-98280	WASHER ADJUSTING	3			1.85MM	0.002	0.0044
090	15221-98290	WASHER ADJUSTING	3			1.90MM	0.002	0.0044
090	15221-98300	WASHER ADJUSTING	3			1.95MM	0.003	0.0066
100	15221-98100	ASSY WASHER ADJUST	3			OPTION	0.03	0.066

CYLINDER HEAD COVER

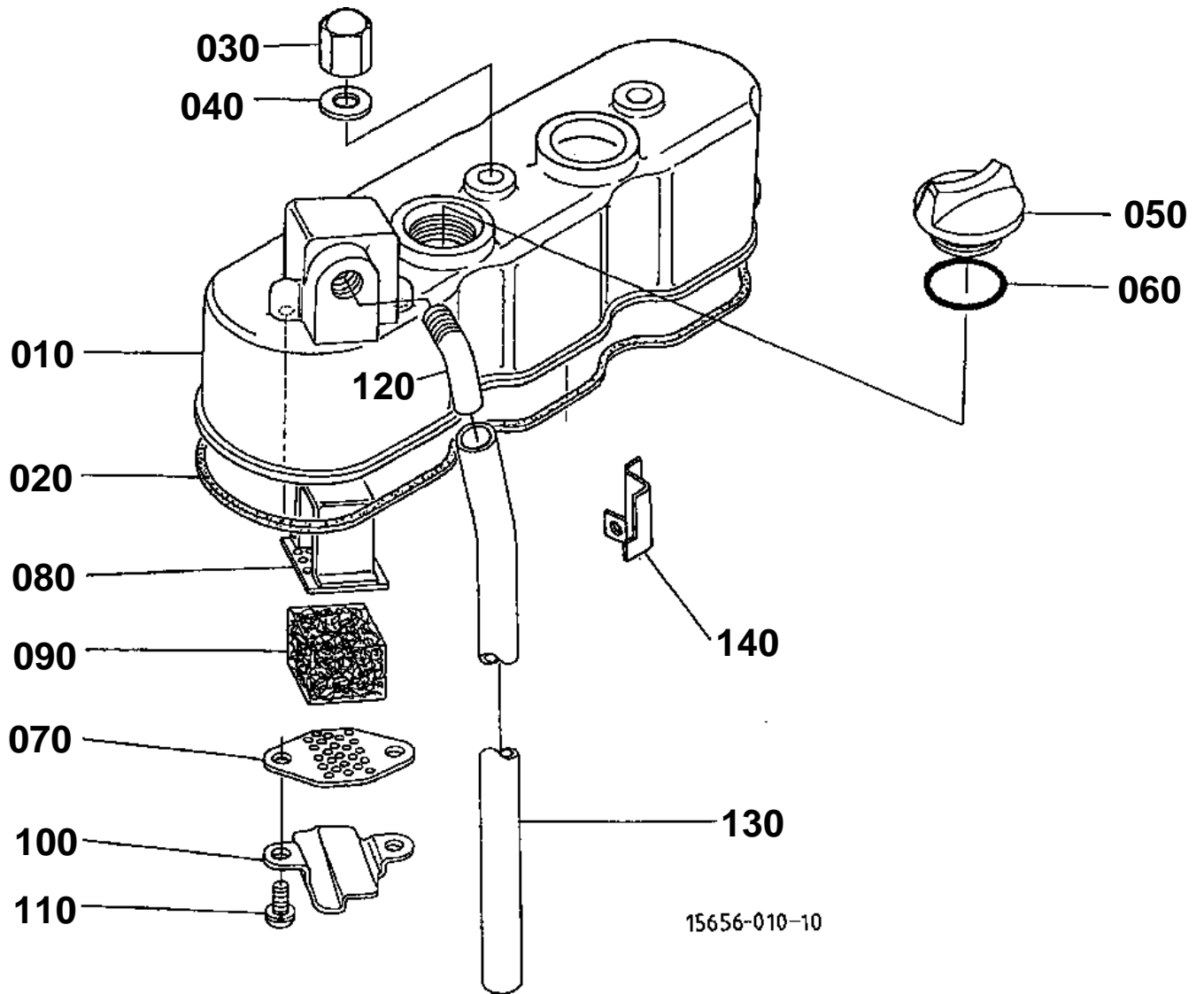

15656-010-10

**<https://www.ebooklibonline.com>**

Hello dear friend!

Thank you very much for reading.

Enter the link into your browser.

The full manual is available for immediate download.

**<https://www.ebooklibonline.com>**