

**010 COMPLETE ENGINE**

| Pos. | Part No.             | Description                       | Dimension | Quantity | Conditions |
|------|----------------------|-----------------------------------|-----------|----------|------------|
| 1    | <b>77 0005 371 5</b> | ENGINE                            |           | 1        | 1)         |
| -    |                      | <i>Please order additionally!</i> |           |          |            |
|      | 77 0004 280 2        | SUPPORT                           |           | 1,000    |            |
|      | 77 0004 772 2        | SPRING                            |           | 1,000    |            |
|      | 77 0004 772 3        | SUPPORT                           |           | 1,000    |            |
|      |                      | <i>Please order additionally!</i> |           |          |            |
|      | 77 0001 693 5        | SCREW                             |           | 8,000    |            |
|      | 77 0005 277 4        | TORSION DAMPER                    |           | 1,000    |            |
|      | 77 0005 382 9        | NUT                               |           | 1,000    |            |
|      | 77 0005 383 0        | STUD BOLT                         |           | 1,000    |            |
|      | 77 0005 383 2        | SHAFT                             |           | 1,000    |            |
| 1    | <b>77 0005 599 7</b> | ENGINE                            |           | 1        | 2)         |
| -    |                      | <i>Please order additionally!</i> |           |          |            |
|      | 77 0005 997 8        | HEXAGON HEAD BOLT                 |           | 6,000    |            |
|      |                      | <i>Please order additionally!</i> |           |          |            |
|      | 77 0103 068 6        | BEARING-1 BALL                    |           | 1,000    |            |
|      |                      | <i>Please order additionally!</i> |           |          |            |
|      | 77 0001 693 5        | SCREW                             |           | 8,000    |            |
|      | 77 0005 277 4        | TORSION DAMPER                    |           | 1,000    |            |
| 1    | <b>77 0005 371 5</b> | ENGINE                            |           | 1        | 3)         |
| -    |                      | <i>Please order additionally!</i> |           |          |            |
|      | 77 0001 693 5        | SCREW                             |           | 8,000    |            |
|      | 77 0005 277 4        | TORSION DAMPER                    |           | 1,000    |            |

**1) Equipment**

**Homologationtype** 0K0031 MECHANICAL REV.  
+ 4062  
->PL.10.1.03.A

**2) Homologationtype**

+ 4072  
->PL.10.1.03.B

**3) Equipment**

**Homologationtype** 0K0033 REVERSHIFT  
+ 4062  
->PL.10.1.03.A

DEPL. 13.1.20.A

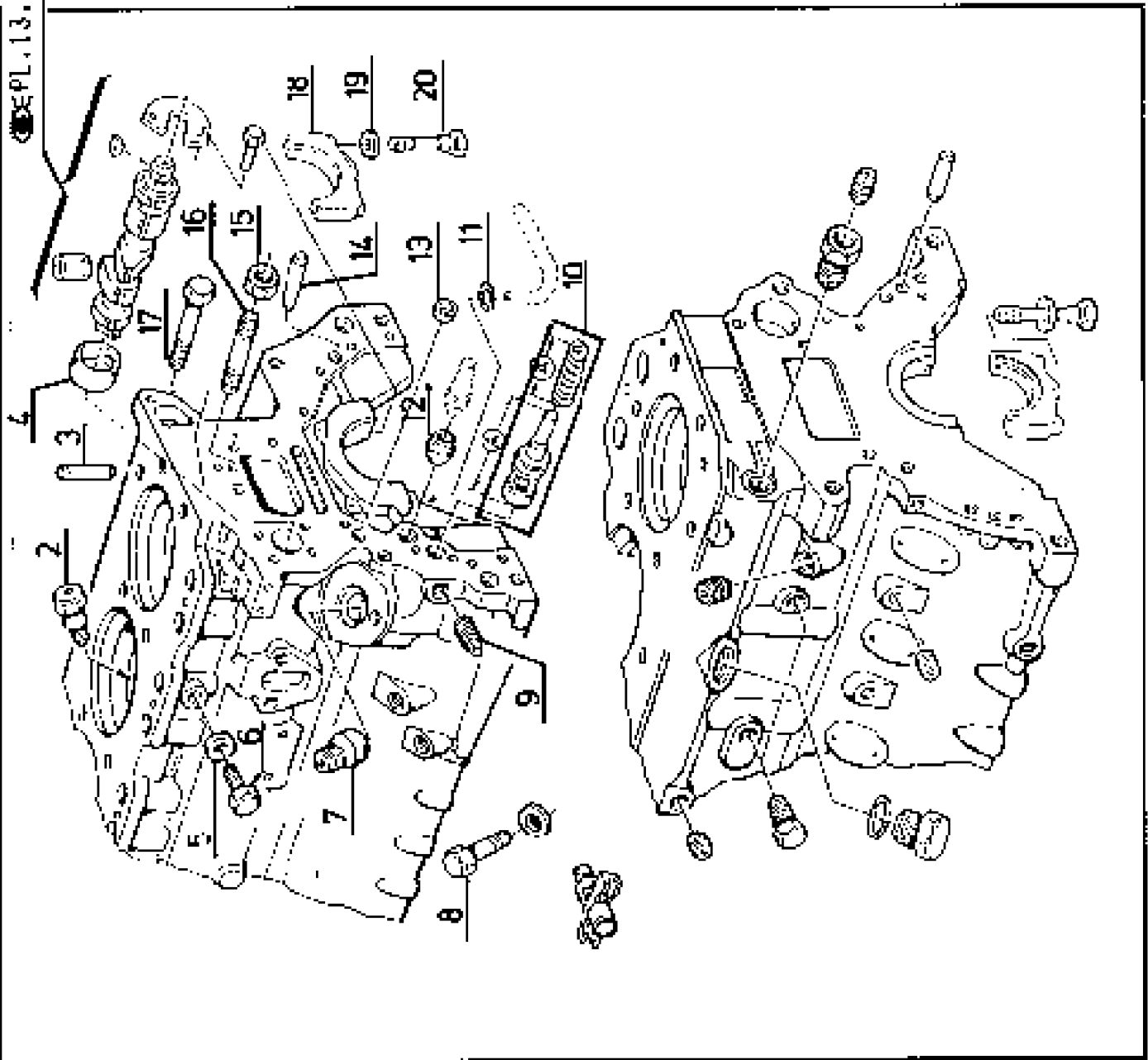

1

**<https://www.ebooklibonline.com>**

Hello dear friend!

Thank you very much for reading.

Enter the link into your browser.

The full manual is available for immediate download.

**<https://www.ebooklibonline.com>**

**100 CRANKCASE 1)**

| Pos. | Part No.             | Description    | Dimension | Quantity | Conditions |
|------|----------------------|----------------|-----------|----------|------------|
| 1    | <b>60 0501 596 7</b> | CRANKCASE      |           | 1        |            |
| 2    | <b>60 0501 318 9</b> | SCREW          |           | 6        |            |
| 3    | <b>60 0501 317 4</b> | CENTRING PIN   |           | 2        |            |
| 4    | <b>60 0501 294 1</b> | BEARING        |           | 1        |            |
| 5    | <b>60 0501 596 8</b> | WASHER         |           | 1        |            |
| 6    | <b>60 0501 289 7</b> | SCREW          |           | 1        | 2)         |
| 7    | <b>60 0501 319 1</b> | GREASE NIPPLE  |           | 1        |            |
| 8    | <b>60 0501 596 9</b> | SCREW          |           | 1        | 3)         |
| 9    | <b>60 0501 320 2</b> | LOCK           |           | 1        |            |
| 10   | <b>60 0501 402 9</b> | VALVE          |           | 1        |            |
| 11   | <b>60 0501 320 3</b> | O-RING         |           | 1        |            |
| 12   | <b>60 0501 319 9</b> | BUSHING        |           | 1        |            |
| 13   | <b>60 0501 319 8</b> | BLANKING COVER |           | 1        |            |
| 14   | <b>60 0501 319 6</b> | CENTRING PIN   |           | 2        |            |
| 15   | <b>60 0501 321 4</b> | NUT            |           | 1        | 4)         |
| 16   | <b>60 0501 319 3</b> | STUD BOLT      |           | 1        | 4)         |
| 17   | <b>60 0501 319 5</b> | SCREW          |           | 2        | 5)         |
| 18   | <b>60 0501 320 4</b> | COVER          |           | 6        |            |
| 19   | <b>60 0501 320 5</b> | WASHER         |           | 12       |            |
| 20   | <b>60 0501 320 6</b> | SCREW          |           | 12       |            |

|           |                         |             |
|-----------|-------------------------|-------------|
| <b>1)</b> | <b>Homologationtype</b> | + 4062      |
| <b>2)</b> | <b>Remarks</b>          | 3/8"x1/2"   |
| <b>3)</b> | <b>Remarks</b>          | 1/2"x1/2"   |
| <b>4)</b> | <b>Remarks</b>          | 3/8"-16UNC  |
| <b>5)</b> | <b>Remarks</b>          | 3/8"x2-1/4" |

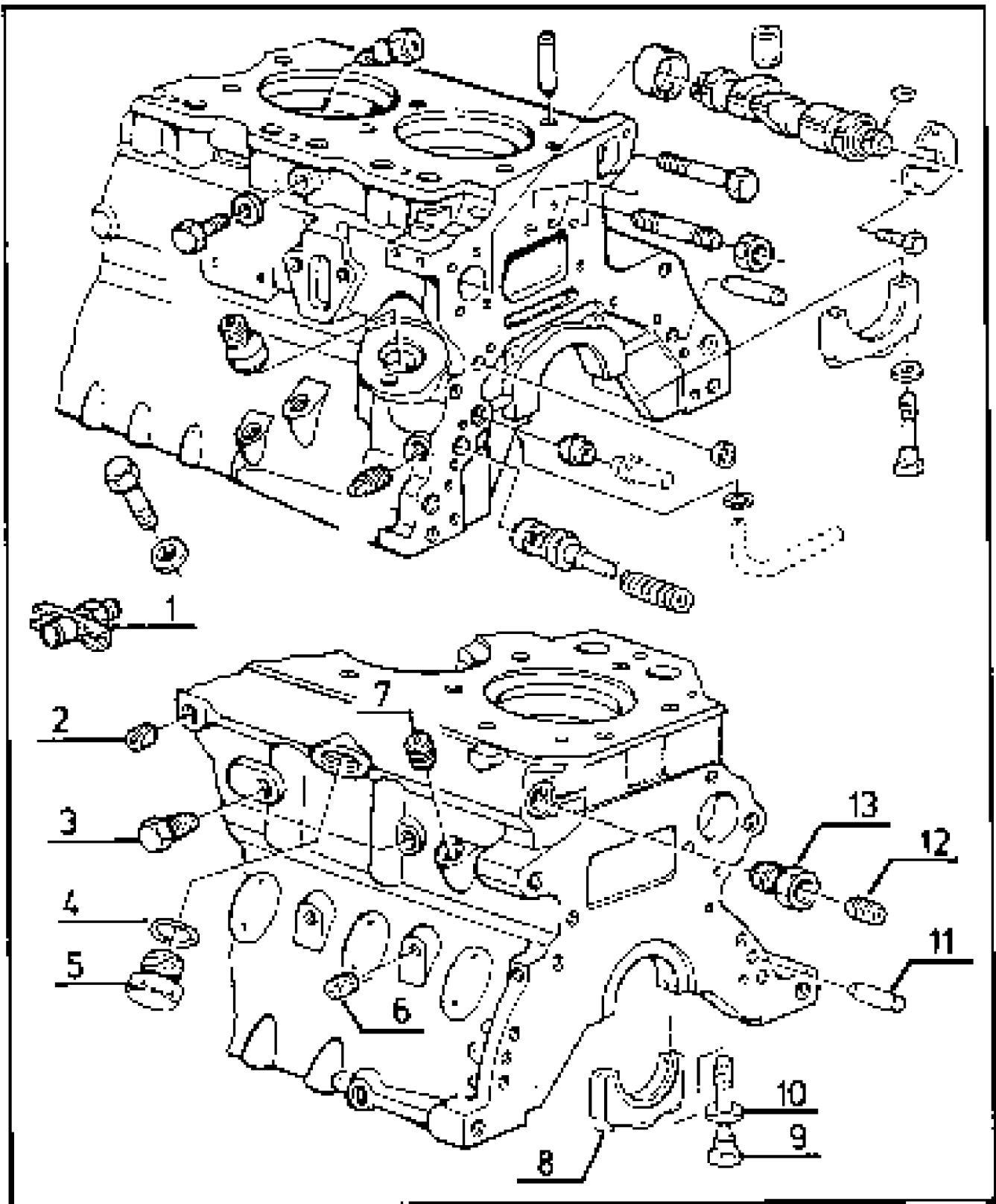

**100 CRANKCASE 1)**

| Pos.      | Part No.                | Description   | Dimension | Quantity | Conditions |
|-----------|-------------------------|---------------|-----------|----------|------------|
| 1         | <b>60 0501 320 7</b>    | VALVE         |           | 1        | 2)         |
| 2         | <b>60 0501 320 8</b>    | LOCK          |           | 1        |            |
| 3         | <b>60 0501 320 9</b>    | LOCK          |           | 2        |            |
| 4         | <b>60 0502 339 4</b>    | O-RING        |           | 1        |            |
| 5         | <b>60 0502 339 5</b>    | LOCK          |           | 1        |            |
| 6         | <b>60 0502 144 0</b>    | LOCK          |           | 7        |            |
| 7         | <b>60 0501 321 9</b>    | LOCK          |           | 1        |            |
| 8         | <b>60 0501 321 2</b>    | COVER         |           | 1        |            |
| 9         | <b>60 0501 320 6</b>    | SCREW         |           | 2        |            |
| 10        | <b>60 0501 320 5</b>    | WASHER        |           | 2        |            |
| 11        | <b>60 0501 317 4</b>    | CENTRING PIN  |           | 2        |            |
| 12        | <b>60 0501 321 8</b>    | LOCK          |           | 1        |            |
| 13        | <b>60 0501 321 7</b>    | GREASE NIPPLE |           | 1        |            |
| <b>1)</b> | <b>Homologationtype</b> |               | + 4062    |          |            |
| <b>2)</b> | <b>Remarks</b>          |               | [SR]      |          |            |

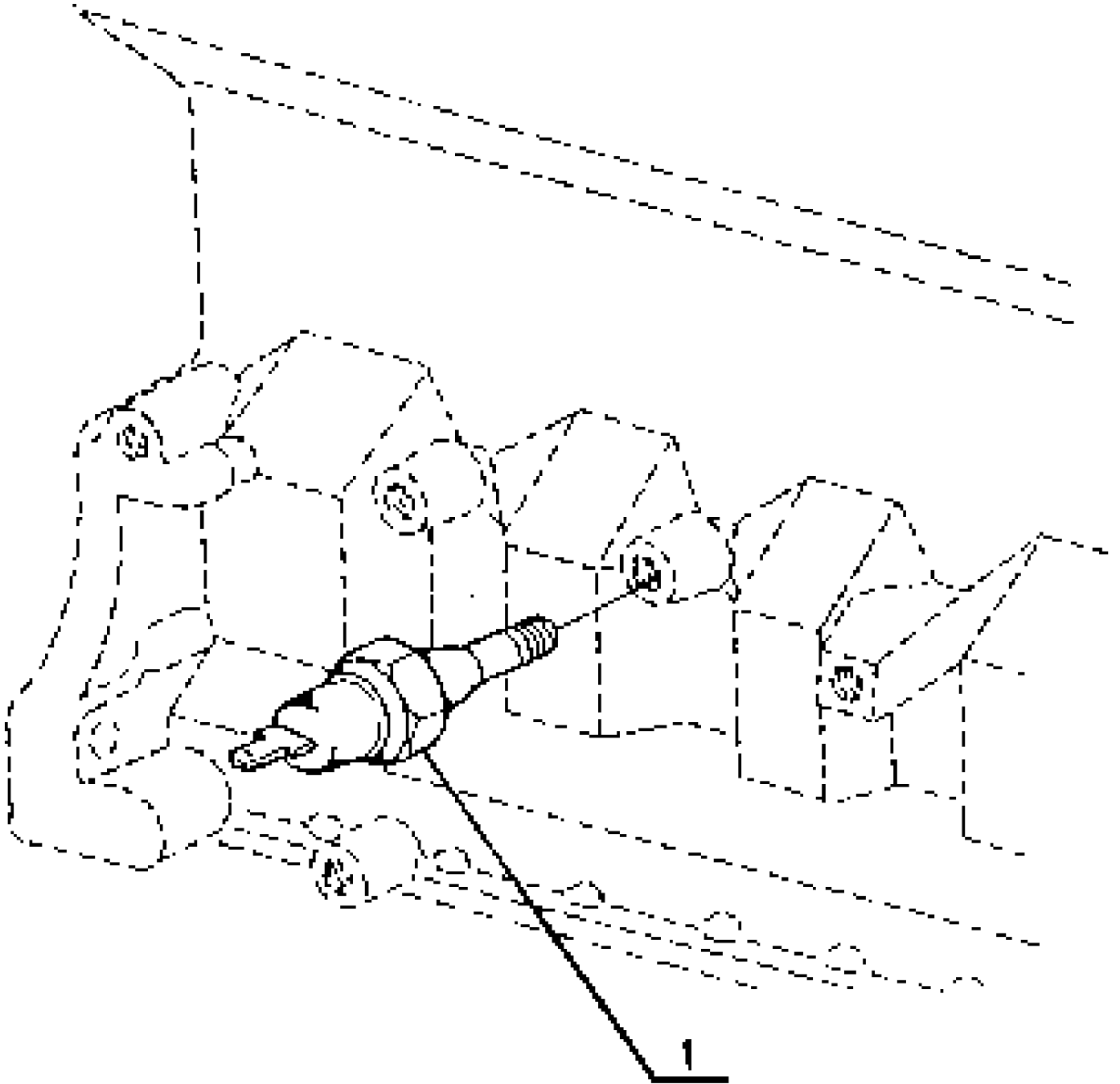

**100 CRANKCASE 1)**

| Pos.      | Part No.                | Description | Dimension | Quantity | Conditions |
|-----------|-------------------------|-------------|-----------|----------|------------|
| 1         | <b>60 0501 342 7</b>    | TRANSMITTER |           | 1        |            |
| <b>1)</b> | <b>Homologationtype</b> |             |           |          | + 4062     |

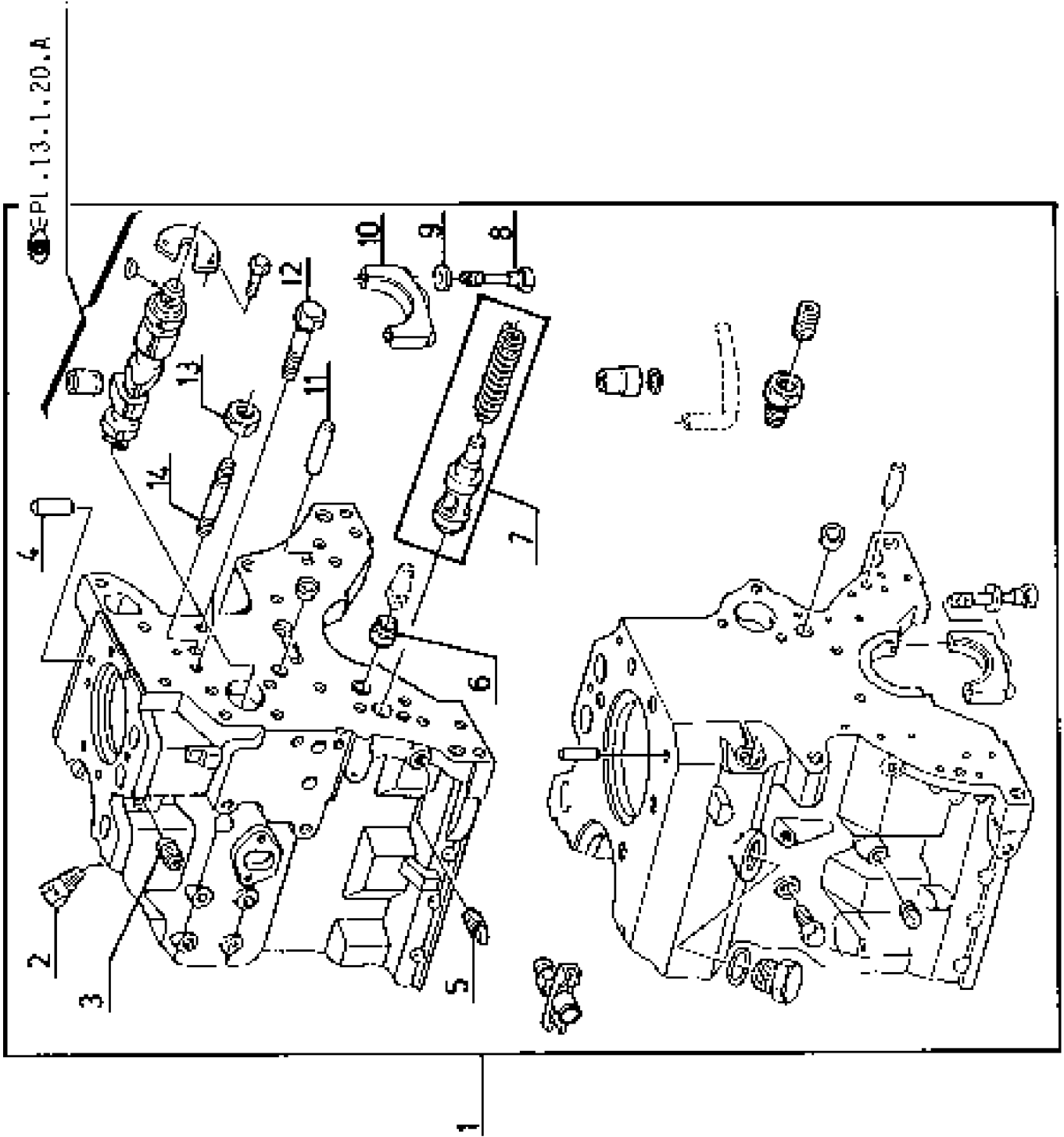

**100 CRANKCASE 1)**

| Pos.      | Part No.                 | Description  | Dimension | Quantity | Conditions |
|-----------|--------------------------|--|-----------|----------|------------|
| 1         | <b>FA-CONSIGN<br/>ES</b> | Consignes - CS   |           | 1        |            |
| -         |                          | <i>Please order!</i><br><i>60 0502 911 3 SHORT BLOCK</i> |           | 1,000    |            |
| 2         | <b>60 0501 318 9</b>     | SCREW  |           | 6        |            |
| 3         | <b>60 0501 321 0</b>     | PLUG   |           | 1        |            |
| 4         | <b>60 0501 317 4</b>     | CENTRING PIN   |           | 1        |            |
| 5         | <b>60 0501 597 1</b>     | LOCK   |           | 1        |            |
| 6         | <b>60 0501 319 9</b>     | BUSHING  |           | 1        |            |
| 7         | <b>60 0501 402 9</b>     | VALVE  |           | 1        |            |
| 8         | <b>60 0501 320 6</b>     | SCREW  |           | 12       |            |
| 9         | <b>60 0501 320 5</b>     | WASHER   |           | 12       |            |
| 10        | <b>60 0501 320 4</b>     | COVER  |           | 6        |            |
| 11        | <b>60 0501 319 6</b>     | CENTRING PIN   |           | 2        |            |
| 12        | <b>60 0501 319 5</b>     | SCREW  |           | 2        |            |
| 13        | <b>60 0501 321 4</b>     | NUT  |           | 1        |            |
| 14        | <b>60 0501 319 3</b>     | STUD BOLT  |           | 1        |            |
| <b>1)</b> | <b>Homologationtype</b>  |  | + 4072    |          |            |

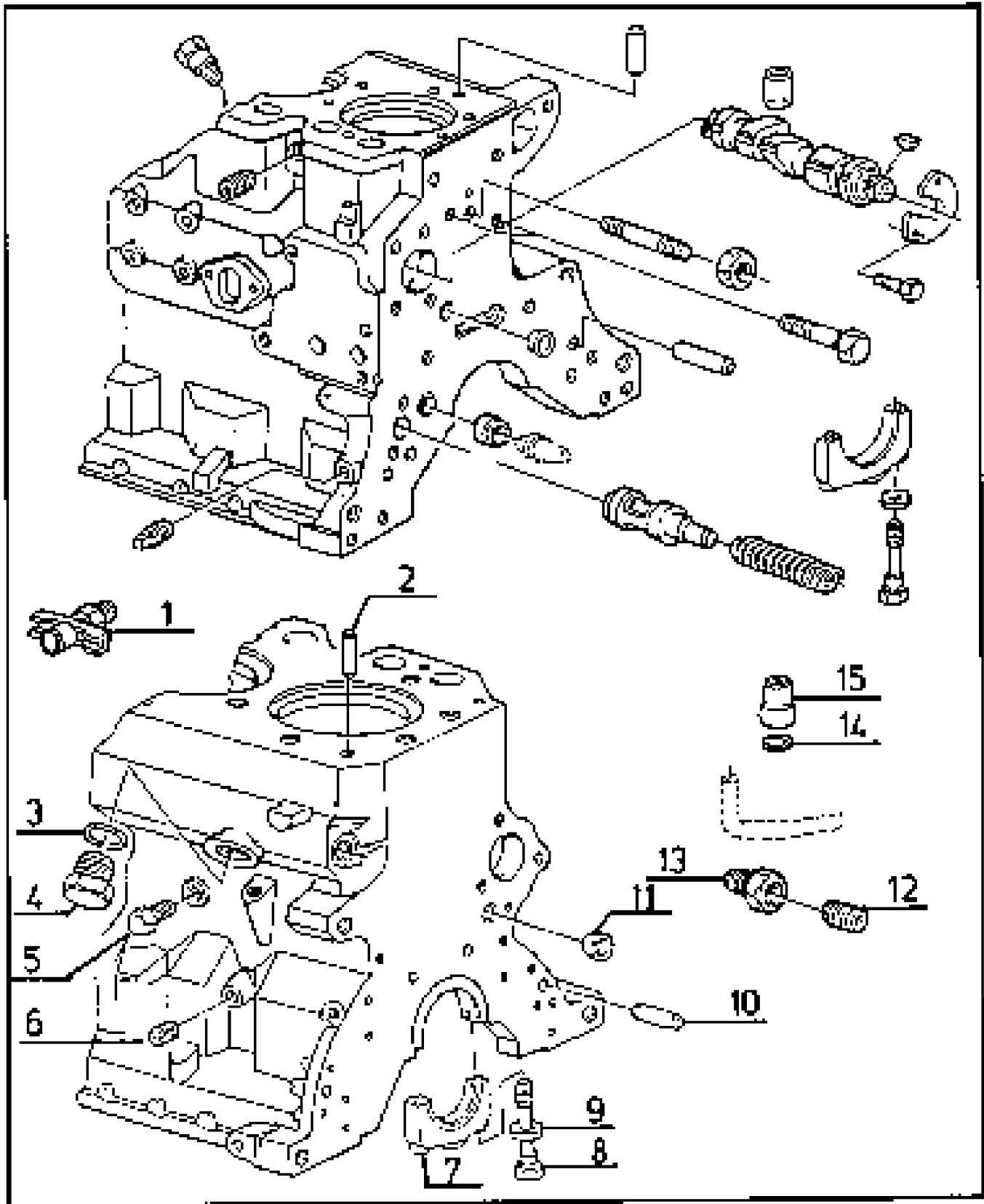

**100 CRANKCASE 1)**

| Pos. | Part No.             | Description    | Dimension | Quantity | Conditions |
|------|----------------------|----------------|-----------|----------|------------|
| 1    | <b>60 0501 320 7</b> | VALVE          |           | 1        | 2)         |
| 2    | <b>60 0501 317 4</b> | CENTRING PIN   |           | 1        |            |
| 3    | <b>60 0502 339 4</b> | O-RING         |           | 1        |            |
| 4    | <b>60 0502 339 5</b> | LOCK           |           | 1        |            |
| 5    | <b>60 0501 320 9</b> | LOCK           |           | 1        |            |
| 6    | <b>60 0502 144 0</b> | LOCK           |           | 7        |            |
| 7    | <b>60 0501 321 2</b> | COVER          |           | 1        |            |
| 8    | <b>60 0501 320 6</b> | SCREW          |           | 2        |            |
| 9    | <b>60 0501 320 5</b> | WASHER         |           | 2        |            |
| 10   | <b>60 0501 317 4</b> | CENTRING PIN   |           | 2        |            |
| 11   | <b>60 0501 319 8</b> | BLANKING COVER |           | 2        |            |
| 12   | <b>60 0501 321 8</b> | LOCK           |           | 1        |            |
| 13   | <b>60 0501 321 7</b> | GREASE NIPPLE  |           | 1        |            |
| 14   | <b>60 0501 320 3</b> | O-RING         |           | 1        |            |
| 15   | <b>60 0501 597 2</b> | BUSHING        |           | 1        |            |

**1) Homologationtype** + 4072

**2) Remarks** [SR]

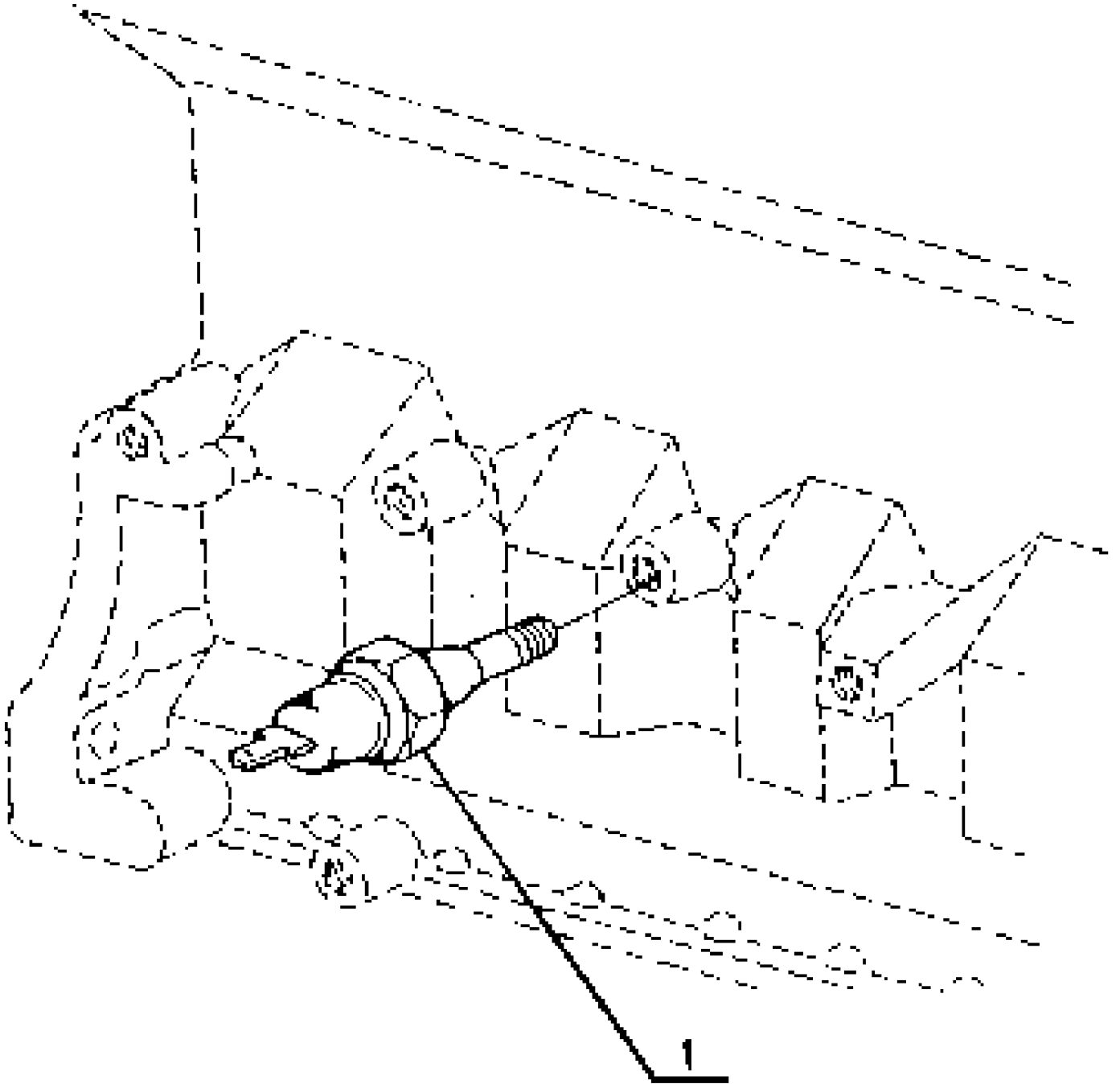

**100 CRANKCASE 1)**

| Pos.      | Part No.                | Description | Dimension | Quantity | Conditions |
|-----------|-------------------------|-------------|-----------|----------|------------|
| 1         | <b>60 0501 342 7</b>    | TRANSMITTER |           | 1        |            |
| <b>1)</b> | <b>Homologationtype</b> |             | + 4072    |          |            |

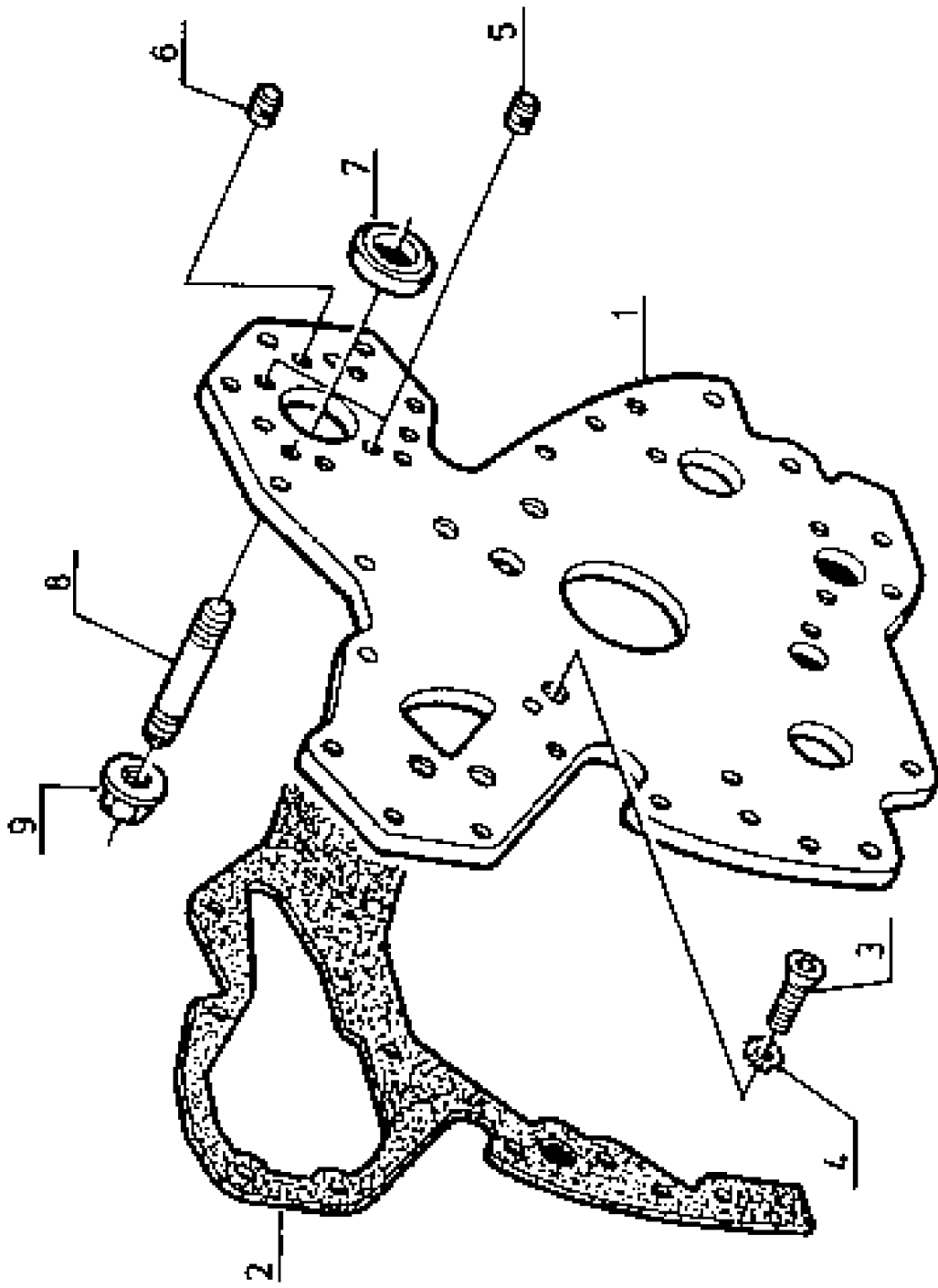

**120 TIMING CASE**

| <b>Pos.</b> | <b>Part No.</b>      | <b>Description</b> | <b>Dimension</b> | <b>Quantity</b> | <b>Conditions</b> |
|-------------|----------------------|--------------------|------------------|-----------------|-------------------|
| 1           | <b>60 0501 597 3</b> | PLATE              |                  | 1               |                   |
| 2           | <b>60 0501 276 4</b> | GASKET             |                  | 1               |                   |
| 3           | <b>60 0501 276 5</b> | SCREW              |                  | 5               |                   |
| 4           | <b>60 0501 276 6</b> | WASHER             |                  | 5               |                   |
| 5           | <b>60 0501 597 4</b> | LOCK               |                  | 2               |                   |
| 6           | <b>60 0501 597 5</b> | LOCK               |                  | 8               |                   |
| 7           | <b>60 0501 597 6</b> | RING               |                  | 1               | 1)                |
| 8           | <b>60 0501 276 7</b> | STUD               |                  | 3               |                   |
| 9           | <b>60 0501 276 8</b> | NUT                |                  | 3               |                   |
| <b>1)</b>   | <b>Remarks</b>       |                    | [SR]             |                 |                   |

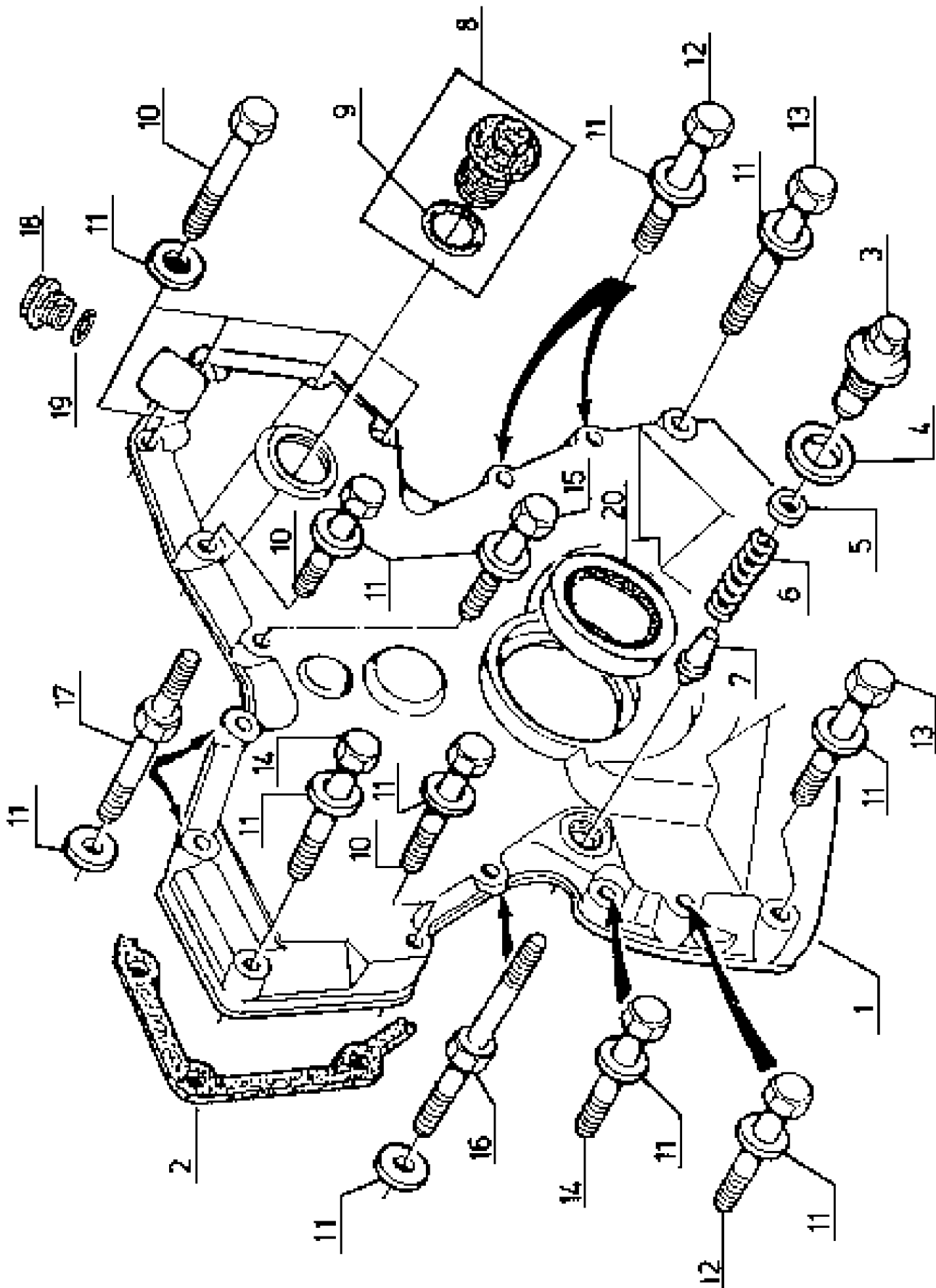

**120 TIMING CASE**

| Pos. | Part No.             | Description    | Dimension                  | Quantity | Conditions |
|------|----------------------|----------------|----------------------------|----------|------------|
| 1    | <b>60 0501 597 7</b> | HOUSING        |                            | 1        |            |
| 2    | <b>60 0501 597 8</b> | GASKET         |                            | 1        |            |
| 3    | <b>60 0501 277 1</b> | SCREW          |                            | 1        |            |
| 4    | <b>60 0501 277 2</b> | WASHER         |                            | 1        |            |
| 5    | <b>60 0501 277 3</b> | ADJUSTING DISC |                            | 1        | 1)         |
| 6    | <b>60 0501 277 4</b> | SPRING         |                            | 1        |            |
| 7    | <b>60 0501 277 5</b> | VALVE          |                            | 1        |            |
| 8    | <b>60 0501 277 6</b> | LOCK           |                            | 1        |            |
| 9    | <b>60 0501 277 7</b> | O-RING         |                            | 1        |            |
| 10   | <b>60 0501 277 8</b> | SCREW          |                            | 6        |            |
| 11   | <b>60 0501 336 9</b> | WASHER         |                            | 17       |            |
| 12   | <b>60 0501 278 0</b> | SCREW          |                            | 3        |            |
| 13   | <b>60 0501 277 9</b> | SCREW          |                            | 2        |            |
| 14   | <b>60 0501 278 1</b> | SCREW          |                            | 2        |            |
| 15   | <b>60 0501 319 5</b> | SCREW          |                            | 1        |            |
| 16   | <b>60 0502 233 3</b> | STUD BOLT      |                            | 1        |            |
| 17   | <b>60 0502 233 4</b> | STUD BOLT      |                            | 2        |            |
| 18   | <b>60 0502 895 5</b> | SCREW PLUG     | F-M20X1,5                  | 1        |            |
| 19   | <b>77 0002 464 6</b> | O-RING         | 17X2-N ERS.D.<br>0238209.0 | 1        |            |
| 20   | <b>60 0501 278 3</b> | SHAFT SEAL     |                            | 1        |            |

**1) Remarks**

[SR]

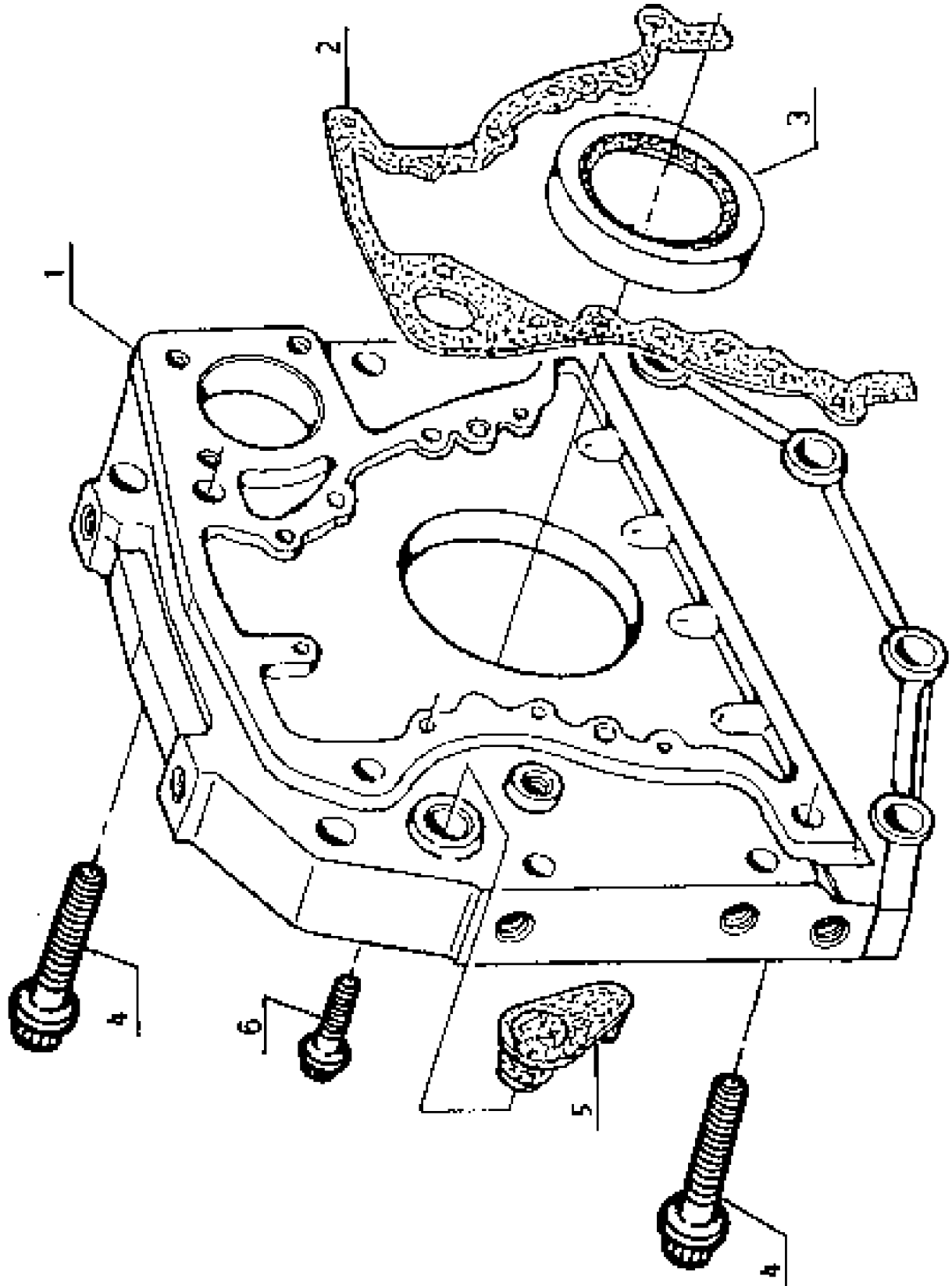

**140 FLYWHEEL HOUSING 1)**

| Pos.      | Part No.                 | Description          | Dimension  | Quantity | Conditions      |
|-----------|--------------------------|----------------------|------------|----------|-----------------|
| 1         | <b>FA-CONSIGN<br/>ES</b> | Consignes - CS       |            | 1        |                 |
| -         |                          | <i>Please order!</i> |            |          |                 |
|           | 60 0501 604 9            | O-RING               |            | 1,000    |                 |
|           | 60 0502 146 4            | LOCK                 |            | 1,000    |                 |
|           | 77 0005 577 0            | HOUSING              |            | 1,000    |                 |
|           | 77 0005 577 1            | GASKET               |            | 1,000    |                 |
| 2         | <b>60 0501 278 5</b>     | GASKET               |            | 1        |                 |
| 3         | <b>60 0501 279 0</b>     | SHAFT SEAL           | 118X146X15 | 1        |                 |
| 4         | <b>60 0501 480 7</b>     | SCREW                |            | 4        |                 |
| 5         | <b>60 0501 611 6</b>     | BLANKING COVER       |            | 1        |                 |
| 6         | <b>60 0501 480 8</b>     | SCREW                |            | 8        |                 |
| <b>1)</b> | <b>machine no.</b>       | 4062                 |            |          | up to CT62R0958 |
|           | <b>machine no.</b>       | 4072                 |            |          | up to CT72R0542 |

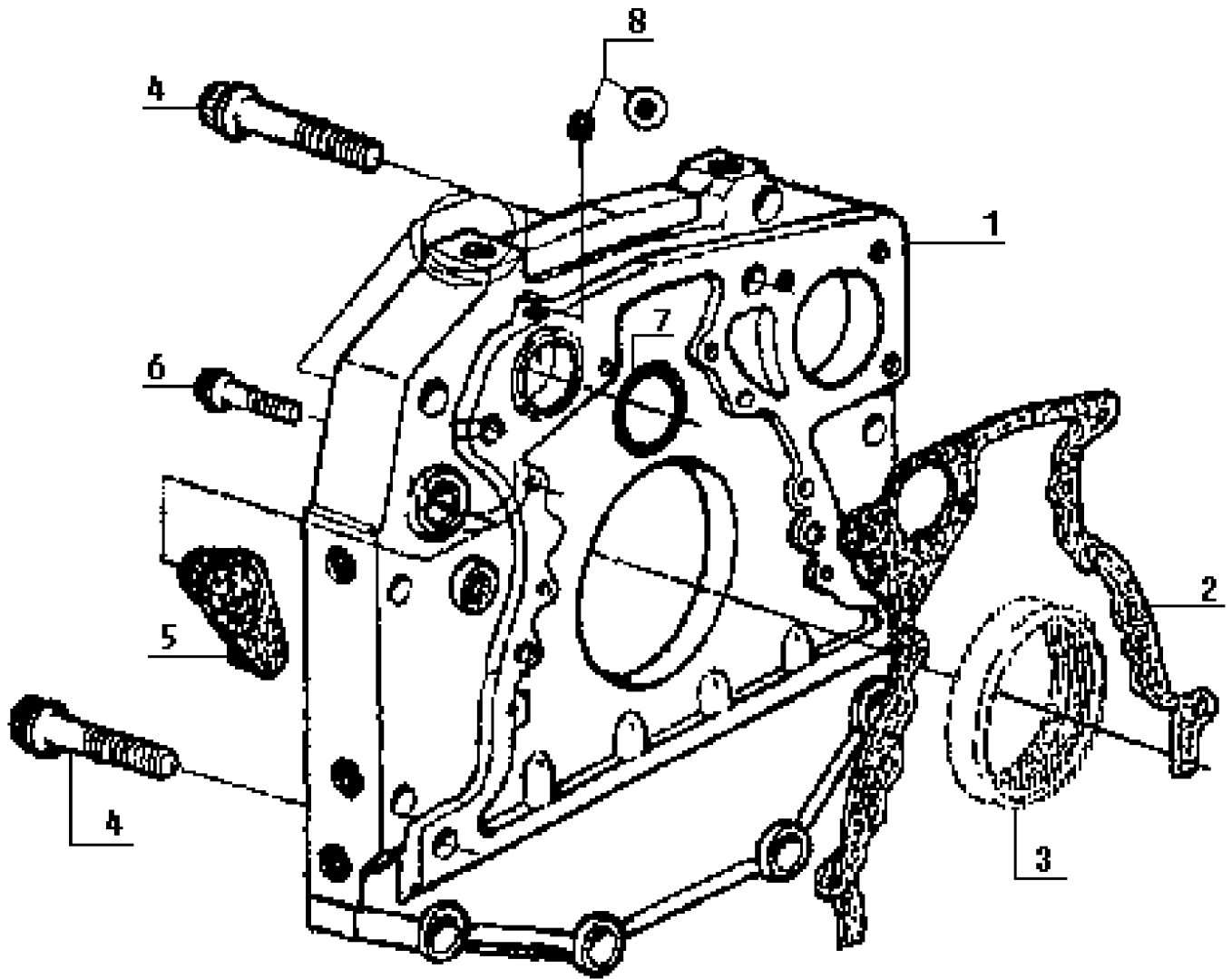

**140 FLYWHEEL HOUSING 1)**

| Pos.      | Part No.                 | Description          | Dimension  | Quantity | Conditions                     |
|-----------|--------------------------|----------------------|------------|----------|--------------------------------|
| 1         | <b>FA-CONSIGN<br/>ES</b> | Consignes - CS       |            | 1        |                                |
| -         |                          | <i>Please order!</i> |            |          |                                |
|           | 60 0501 604 9            | O-RING               |            | 1,000    |                                |
|           | 77 0005 577 0            | HOUSING              |            | 1,000    |                                |
|           | 77 0005 577 1            | GASKET               |            | 1,000    |                                |
| 2         | <b>FA-CONSIGN<br/>ES</b> | Consignes - CS       |            | 1        |                                |
| -         |                          | <i>Please order!</i> |            |          |                                |
|           | 77 0005 577 1            | GASKET               |            | 1,000    |                                |
| 3         | <b>60 0501 279 0</b>     | SHAFT SEAL           | 118X146X15 | 1        |                                |
| 4         | <b>60 0501 480 7</b>     | SCREW                |            | 4        |                                |
| 5         | <b>60 0501 611 6</b>     | BLANKING COVER       |            | 1        |                                |
| 6         | <b>60 0501 480 8</b>     | SCREW                |            | 8        |                                |
| 7         | <b>77 0005 079 6</b>     | O-RING               |            | 1        |                                |
| 8         | <b>60 0502 146 4</b>     | LOCK                 |            | 1        |                                |
| <b>1)</b> | <b>machine no.</b>       | 4062                 |            |          | from CT62R0959 up to CT62R1480 |
|           | <b>machine no.</b>       | 4072                 |            |          | from CT72R0543 up to CT72R0902 |

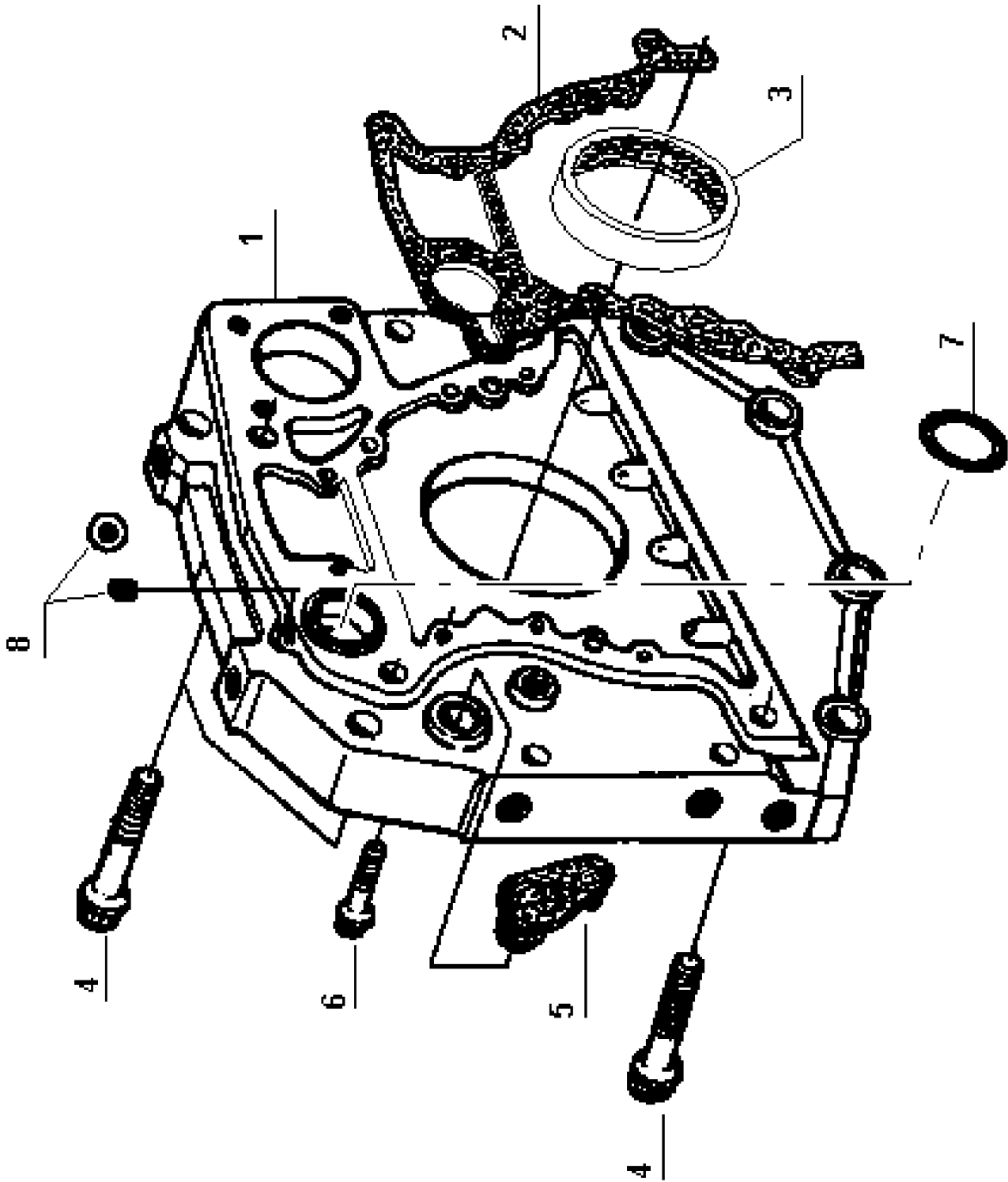

**140 FLYWHEEL HOUSING 1)**

| Pos.      | Part No.             | Description    | Dimension  | Quantity | Conditions     |
|-----------|----------------------|----------------|------------|----------|----------------|
| 1         | <b>77 0005 577 0</b> | HOUSING        |            | 1        |                |
| 2         | <b>77 0005 577 1</b> | GASKET         |            | 1        |                |
| 3         | <b>60 0501 279 0</b> | SHAFT SEAL     | 118X146X15 | 1        |                |
| 4         | <b>60 0501 480 7</b> | SCREW          |            | 4        |                |
| 5         | <b>60 0501 611 6</b> | BLANKING COVER |            | 1        |                |
| 6         | <b>60 0501 480 8</b> | SCREW          |            | 8        |                |
| 7         | <b>60 0501 604 9</b> | O-RING         |            | 1        |                |
| 8         | <b>60 0502 146 4</b> | LOCK           |            | 1        |                |
| <b>1)</b> | <b>machine no.</b>   | 4062           |            |          | from CT62R1481 |
|           | <b>machine no.</b>   | 4072           |            |          | from CT72R0903 |

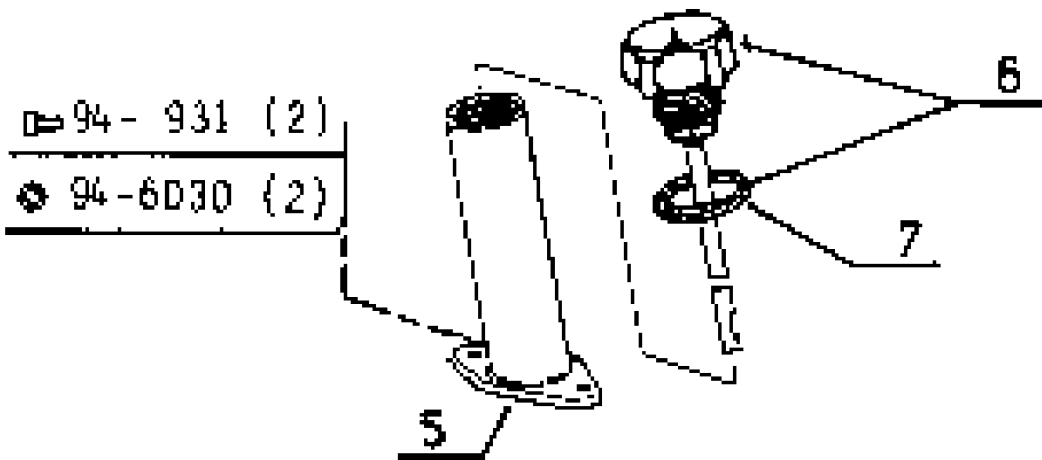

- ▣ 94-931 (2)
- 94-6030 (2)

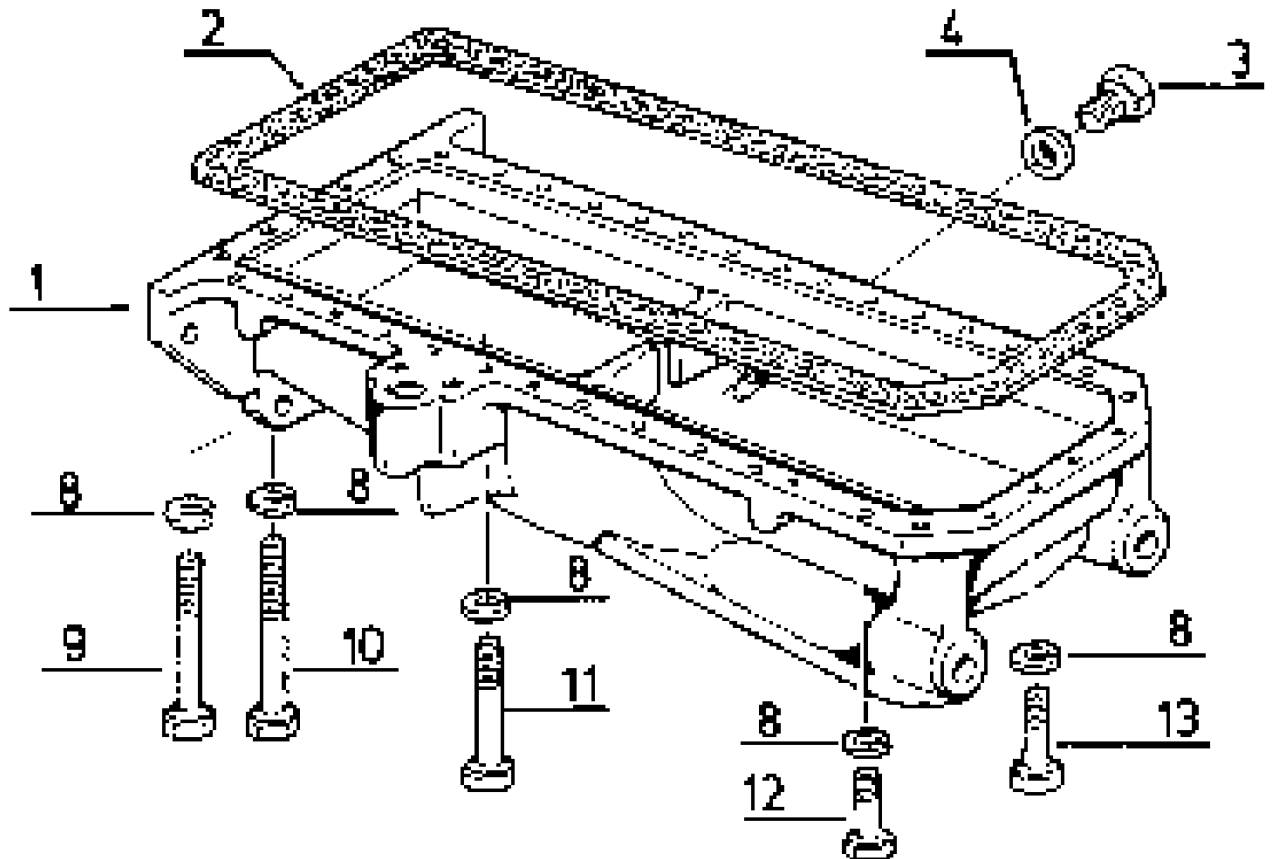

**160 OIL PAN**

| <b>Pos.</b> | <b>Part No.</b>      | <b>Description</b> | <b>Dimension</b> | <b>Quantity</b> | <b>Conditions</b> |
|-------------|----------------------|--------------------|------------------|-----------------|-------------------|
| 1           | <b>60 0501 598 5</b> | HOUSING            |                  | 1               |                   |
| 2           | <b>60 0501 598 6</b> | GASKET             |                  | 1               |                   |
| 3           | <b>60 0501 279 3</b> | LOCK               |                  | 1               |                   |
| 4           | <b>60 0501 211 0</b> | GASKET             |                  | 1               |                   |
| 5           | <b>60 0501 279 4</b> | TUBE               |                  | 1               |                   |
| 6           | <b>60 0501 279 5</b> | GAUGE              |                  | 1               |                   |
| 7           | <b>60 0501 279 6</b> | SEALING RING       |                  | 1               |                   |
| 8           | <b>60 0501 280 0</b> | WASHER             |                  | 36              |                   |
| 9           | <b>60 0501 598 7</b> | SCREW              |                  | 2               |                   |
| 10          | <b>60 0501 598 8</b> | SCREW              |                  | 2               |                   |
| 11          | <b>60 0501 598 9</b> | SCREW              |                  | 2               |                   |
| 12          | <b>60 0501 297 8</b> | SCREW              |                  | 24              |                   |
| 13          | <b>60 0502 604 3</b> | SCREW              |                  | 6               |                   |

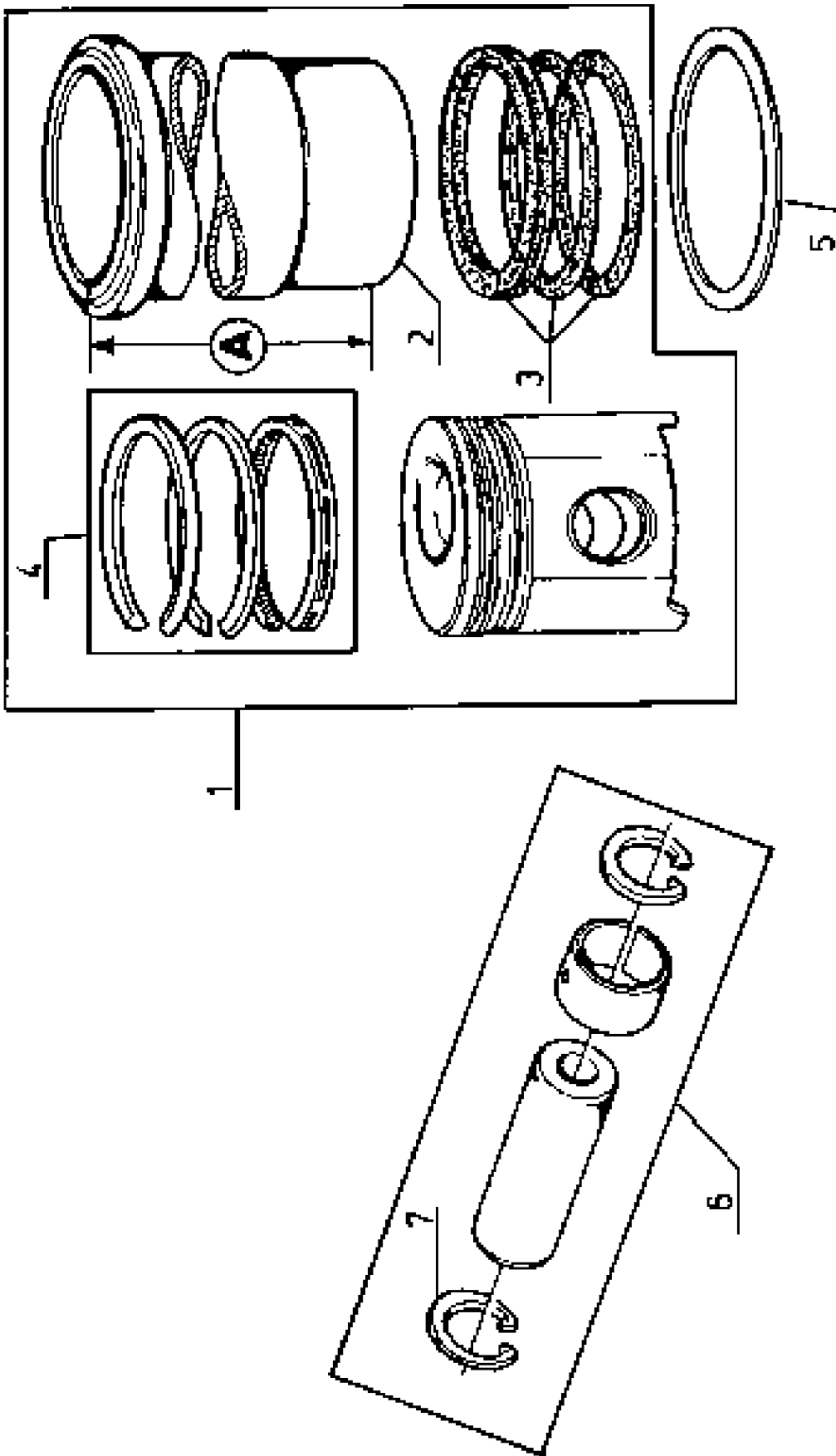

**100 CYLINDER LINER, PISTON 1)**

| Pos. | Part No.             | Description         | Dimension | Quantity | Conditions |
|------|----------------------|---------------------|-----------|----------|------------|
| 1    | <b>60 0501 280 4</b> | PISTON-LINER        |           | 6        |            |
| 2    | <b>60 0501 280 7</b> | PISTON-LINER        |           | 6        | 2)         |
| 3    | <b>60 0501 280 9</b> | SEALING RING SET    |           | 6        |            |
| 4    | <b>60 0501 281 0</b> | SET OF PISTON RINGS |           | 6        |            |
| 5    | <b>60 0501 281 5</b> | ADJUSTING DISC      |           | 6        | 3)         |
| 5    | <b>60 0501 281 6</b> | ADJUSTING DISC      |           | 6        | 4)         |
| 6    | <b>60 0501 590 9</b> | AXLE                |           | 6        | 5)         |
| 7    | <b>60 0501 281 3</b> | INT RETAINING RING  |           | 12       |            |

|           |                         |            |
|-----------|-------------------------|------------|
| <b>1)</b> | <b>Homologationtype</b> | + 4062     |
| <b>2)</b> | <b>Remarks</b>          | A 196 MM   |
| <b>3)</b> | <b>Remarks</b>          | ép. 0,05mm |
| <b>4)</b> | <b>Remarks</b>          | ép. 0,10mm |
| <b>5)</b> | <b>Remarks</b>          | De. 35mm   |

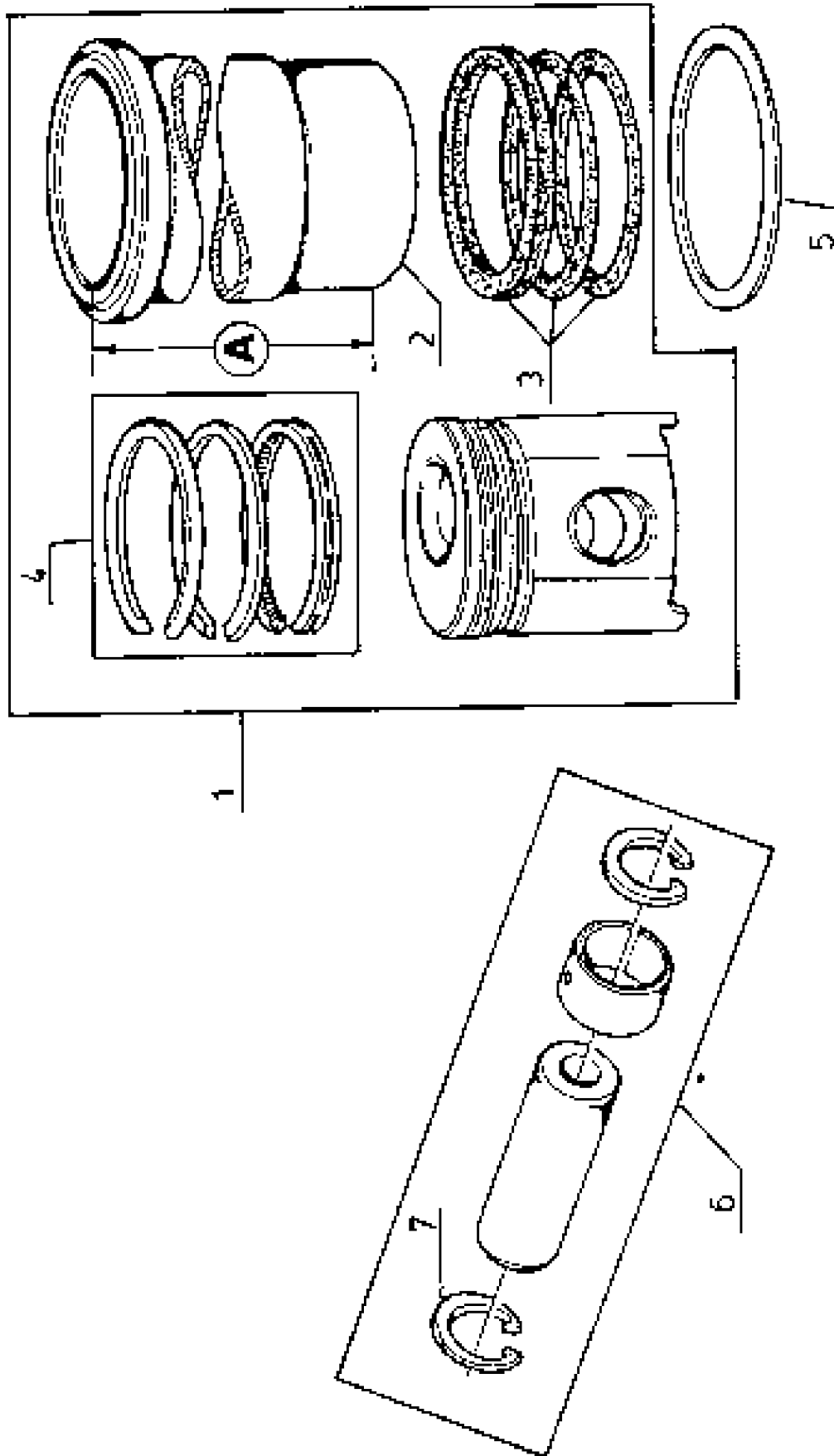

**100 CYLINDER LINER, PISTON 1)**

| Pos.      | Part No.                | Description   | Dimension  | Quantity | Conditions |
|-----------|-------------------------|---|------------|----------|------------|
| 1         | <b>60 0501 280 5</b>    | PISTON-LINER  |            | 6        |            |
| 2         | <b>FA-CONSIGN ES</b>    | Consignes - CS  |            | 6        | 2)         |
| -         |                         | <i>Please order!</i><br><i>60 0501 280 5 PISTON-LINER</i> |            | 1,000    |            |
| 3         | <b>60 0501 280 9</b>    | SEALING RING SET  |            | 6        |            |
| 4         | <b>60 0501 281 0</b>    | SET OF PISTON RINGS                                       |            | 6        |            |
| 5         | <b>60 0501 281 5</b>    | ADJUSTING DISC  |            | 6        | 3)         |
| 5         | <b>60 0501 281 6</b>    | ADJUSTING DISC  |            | 6        | 4)         |
| 6         | <b>60 0501 591 0</b>    | AXLE  |            | 6        | 5)         |
| 7         | <b>60 0501 281 4</b>    | INNER CIRCLIP   |            | 12       |            |
| <b>1)</b> | <b>Homologationtype</b> |   | + 4072     |          |            |
| <b>2)</b> | <b>Remarks</b>          |   | A 218 mm   |          |            |
| <b>3)</b> | <b>Remarks</b>          |   | ép. 0,05mm |          |            |
| <b>4)</b> | <b>Remarks</b>          |   | ép. 0,10mm |          |            |
| <b>5)</b> | <b>Remarks</b>          |   | De. 41mm   |          |            |

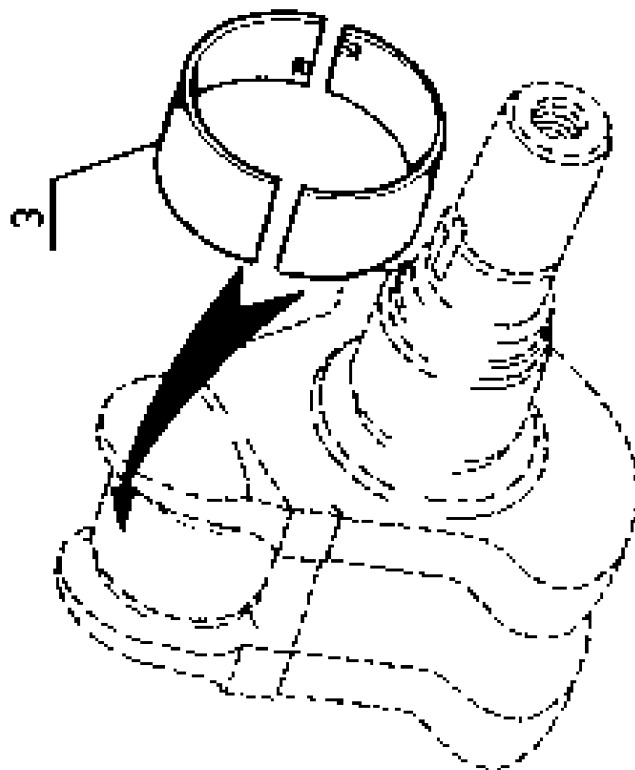
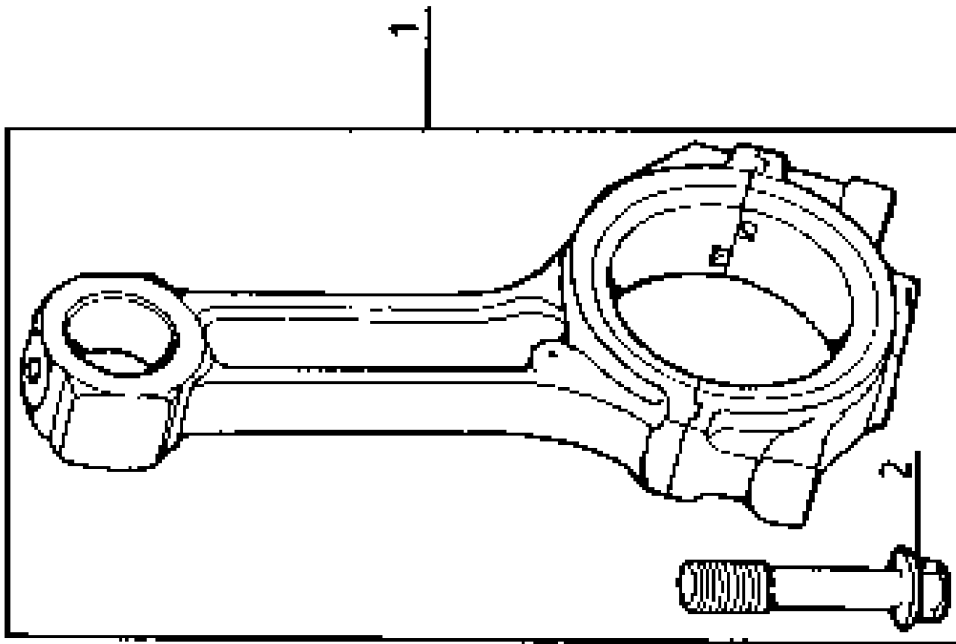

**120 CONNECTING ROD, CONNECTING ROD BEARINGS 1)**

| Pos.      | Part No.                | Description  | Dimension | Quantity | Conditions |
|-----------|-------------------------|--------------|-----------|----------|------------|
| 1         | <b>60 0501 281 7</b>    | ROD (ENGINE) |           | 6        |            |
| 2         | <b>60 0501 282 2</b>    | SCREW        |           | 12       |            |
| 3         | <b>60 0501 282 7</b>    | BEARING      |           | 6        |            |
| 3         | <b>60 0501 282 8</b>    | BEARING      |           | 6        | 2)         |
| <b>1)</b> | <b>Homologationtype</b> |              | + 4062    |          |            |
| <b>2)</b> | <b>Remarks</b>          |              | -0,254 mm |          |            |

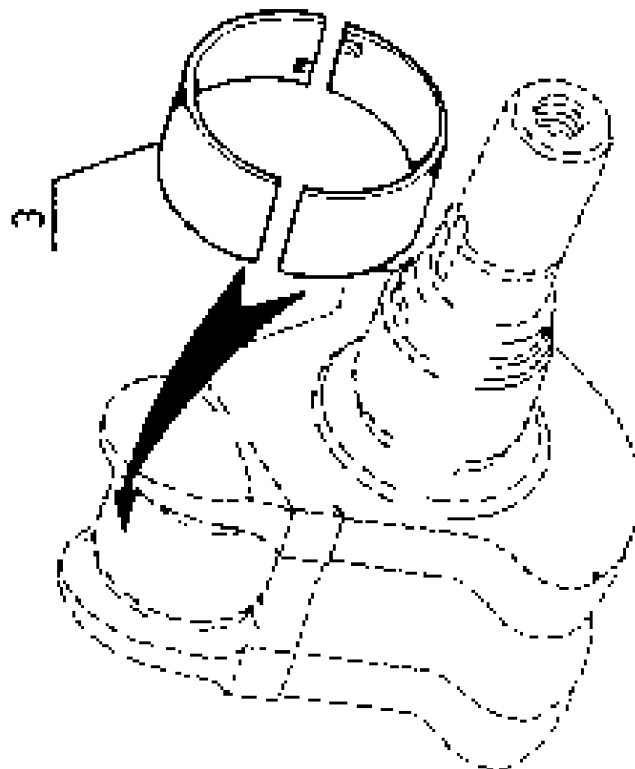
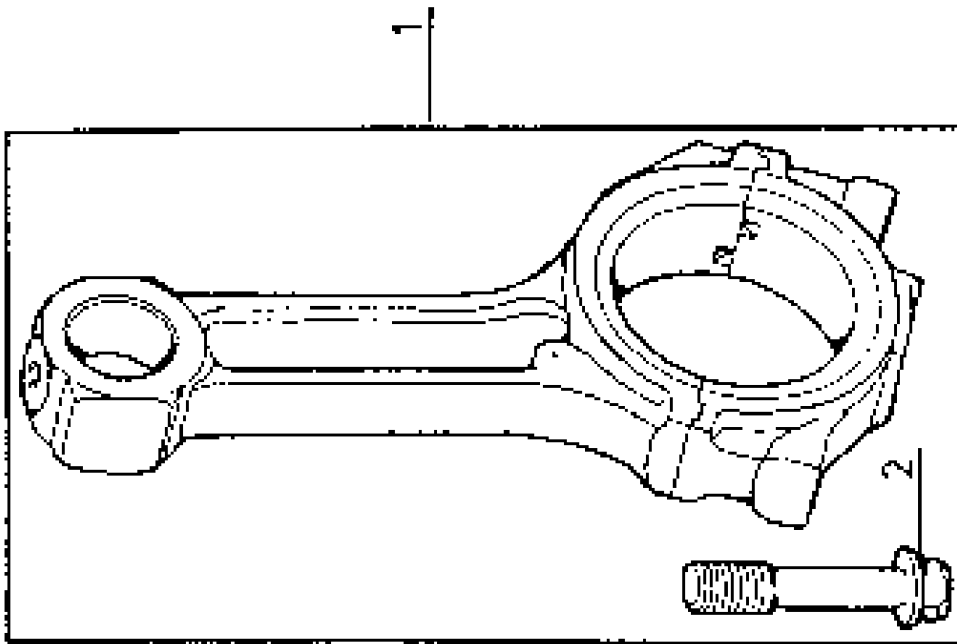

**120 CONNECTING ROD, CONNECTING ROD BEARINGS 1)**

| <b>Pos.</b> | <b>Part No.</b>         | <b>Description</b> | <b>Dimension</b> | <b>Quantity</b> | <b>Conditions</b> |
|-------------|-------------------------|--------------------|------------------|-----------------|-------------------|
| 1           | <b>60 0501 281 8</b>    | ROD (ENGINE)       |                  | 6               |                   |
| 2           | <b>60 0501 282 9</b>    | SCREW              |                  | 12              |                   |
| 3           | <b>60 0501 282 5</b>    | BEARING            |                  | 6               |                   |
| 3           | <b>60 0501 282 6</b>    | BEARING            |                  | 6               | 2)                |
| <b>1)</b>   | <b>Homologationtype</b> |                    | + 4072           |                 |                   |
| <b>2)</b>   | <b>Remarks</b>          |                    | -0,254mm         |                 |                   |

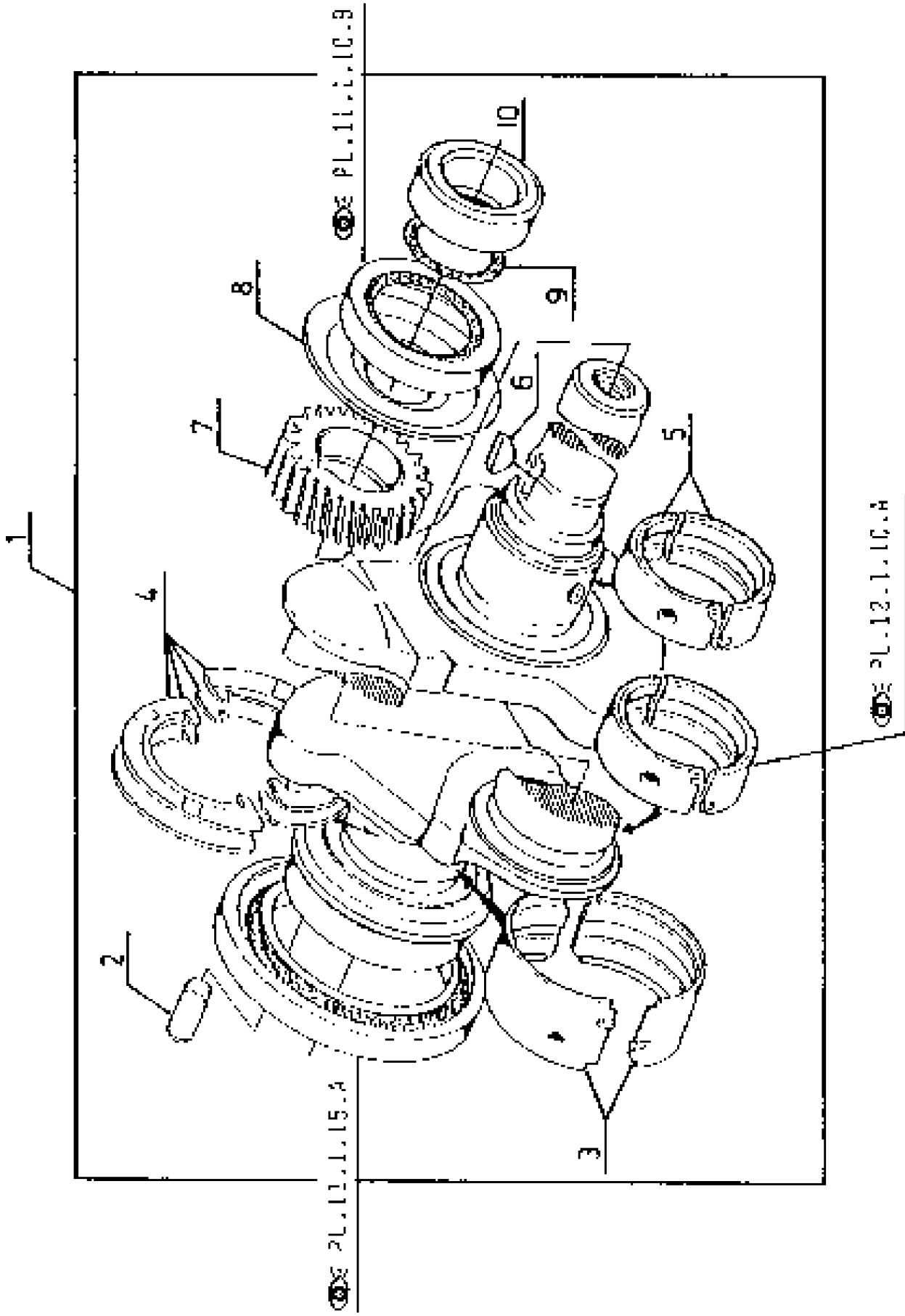



**Suggest:**

**For more complete manuals. Please go to the home page.**

**<https://www.ebooklibonline.com>**

**If the above button click is invalid. Please download this document first, and then click the above link to download the complete manual.**

**Thank you so much for reading**

**140 CRANKSHAFT**

| Pos. | Part No.             | Description  | Dimension | Quantity | Conditions |
|------|----------------------|--------------|-----------|----------|------------|
| 1    | <b>60 0501 599 0</b> | CRANKSHAFT   |           | 1        | 1)         |
| 1    | <b>60 0502 761 9</b> | CRANKSHAFT   |           | 1        | 2)         |
| 2    | <b>60 0501 317 4</b> | CENTRING PIN |           | 1        |            |
| 3    | <b>60 0501 317 5</b> | BEARING      |           | 1        |            |
| 3    | <b>60 0501 317 6</b> | BEARING      |           | 1        | 3)         |
| 4    | <b>60 0501 317 7</b> | FLANGE       |           | 1        |            |
| 4    | <b>60 0501 317 8</b> | FLANGE       |           | 1        | 4)         |
| 5    | <b>60 0501 317 9</b> | BEARING      |           | 6        |            |
| 5    | <b>60 0501 318 0</b> | BEARING      |           | 1        | 5)         |
| 6    | <b>60 0501 294 0</b> | KEY          |           | 1        |            |
| 7    | <b>60 0501 599 2</b> | WHEEL        |           | 1        | 6)         |
| 8    | <b>60 0501 318 1</b> | DEFLECTOR    |           | 1        |            |
| 9    | <b>60 0501 318 3</b> | O-RING       |           | 1        |            |
| 10   | <b>60 0501 318 4</b> | SLEEVE       |           | 1        |            |

|           |                         |           |
|-----------|-------------------------|-----------|
| <b>1)</b> | <b>Homologationtype</b> | + 4062    |
| <b>2)</b> | <b>Homologationtype</b> | + 4072    |
| <b>3)</b> | <b>Remarks</b>          | - 0,254mm |
| <b>4)</b> | <b>Remarks</b>          | ép. +0,18 |
| <b>5)</b> | <b>Remarks</b>          | -0,254mm  |
| <b>6)</b> | <b>Remarks</b>          | 24 Dts    |

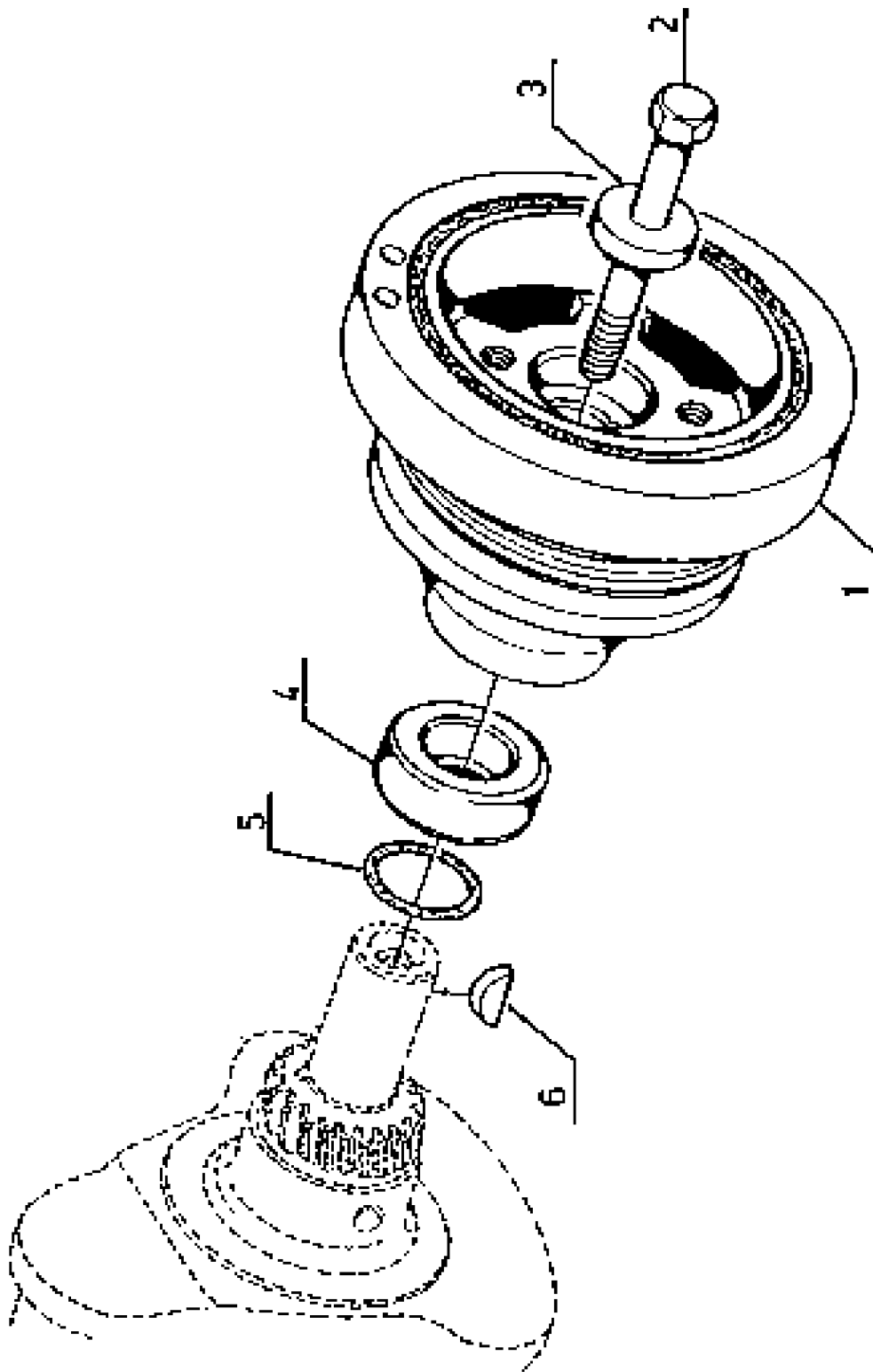

**161 CRANKSHAFT PULLEY WHEEL 1)**

| Pos.      | Part No.             | Description          | Dimension                | Quantity | Conditions |
|-----------|----------------------|----------------------|--------------------------|----------|------------|
| 1         | <b>77 0004 335 7</b> | ANTI-VIBRATION WHEEL |                          | 1        |            |
| 2         | <b>60 0501 608 2</b> | SCREW                |                          | 1        |            |
| 3         | <b>77 0004 256 4</b> | SPACER               |                          | 1        |            |
| 4         | <b>60 0501 318 4</b> | SLEEVE               |                          | 1        |            |
| 5         | <b>60 0501 318 3</b> | O-RING               |                          | 1        |            |
| 6         | <b>60 0501 340 5</b> | KEY                  |                          | 1        |            |
| <hr/>     |                      |                      |                          |          |            |
| <b>1)</b> | <b>Equipment</b>     |                      |                          |          |            |
|           |                      | OK0060               | W/OUT FR LIFTING AND PTO |          |            |
|           |                      | OK0062               | FR LIFT 2.5T TE          |          |            |

**<https://www.ebooklibonline.com>**

Hello dear friend!

Thank you very much for reading.

Enter the link into your browser.

The full manual is available for immediate download.

**<https://www.ebooklibonline.com>**