

SDX30/SDX40
Single Disk No-Till Air Drill
Repair Manual

87605427
Issued May, 2007
Replaces 6-12432

CASE *III*

REPAIR PARTS

REPAIR PART IDENTIFICATION - SDX30

The drill is identified by the use of a Product Identification Number Plate like the one shown.

The plate is located on the front bar of the machine. This number should be provided when requesting parts or service.

CASE III [®]		CNH America LLC Racine, WI 53404 U.S.A.
		Made In Canada
○	Model Number	○
Product Identification Number		

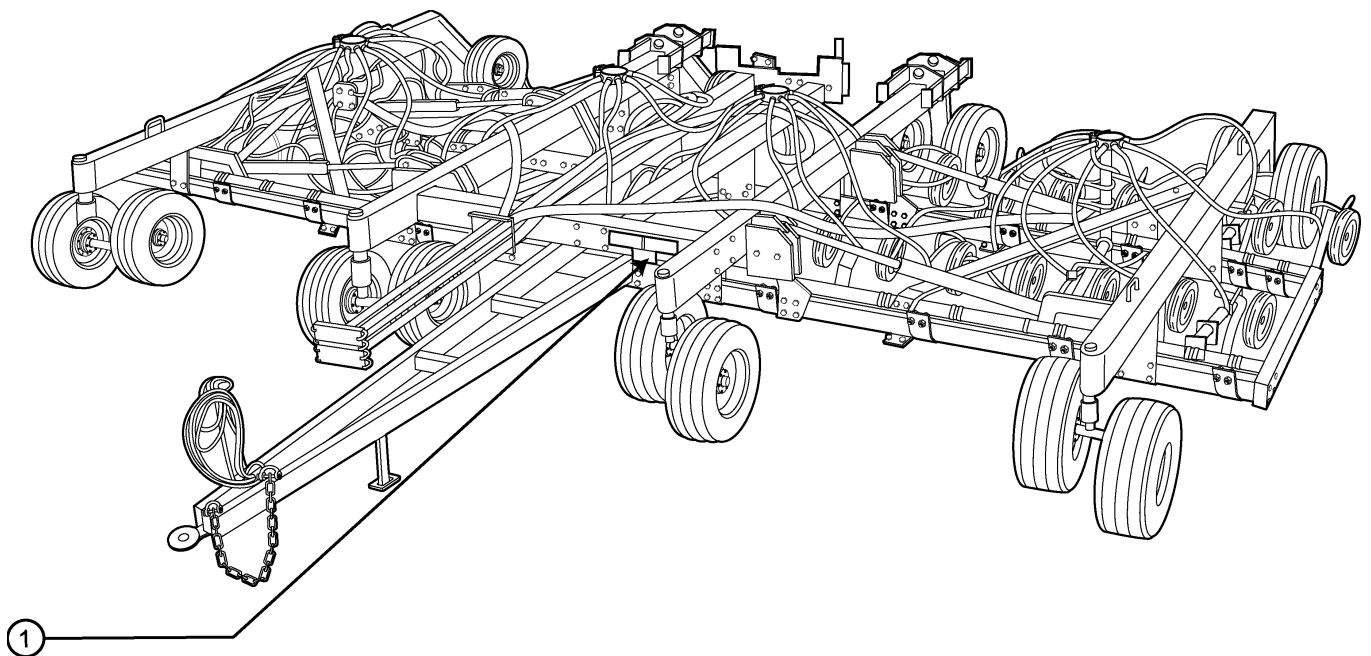
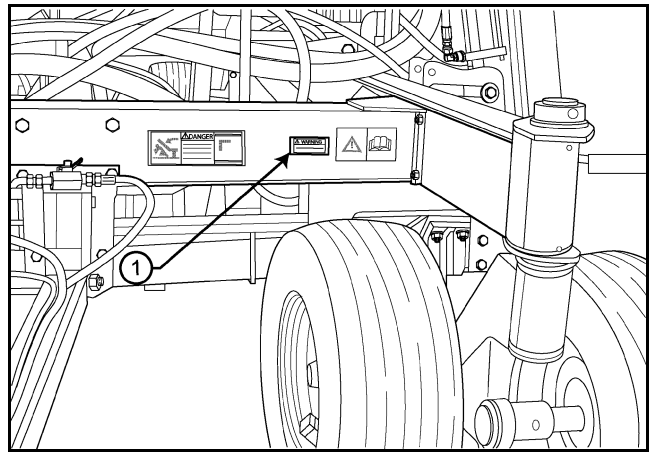

REPAIR PARTS

REPAIR PART IDENTIFICATION - SDX40

The drill is identified by the use of a Product Identification Number Plate like the one shown.

The plate is located on the front bar of the machine. This number should be provided when requesting parts or service.

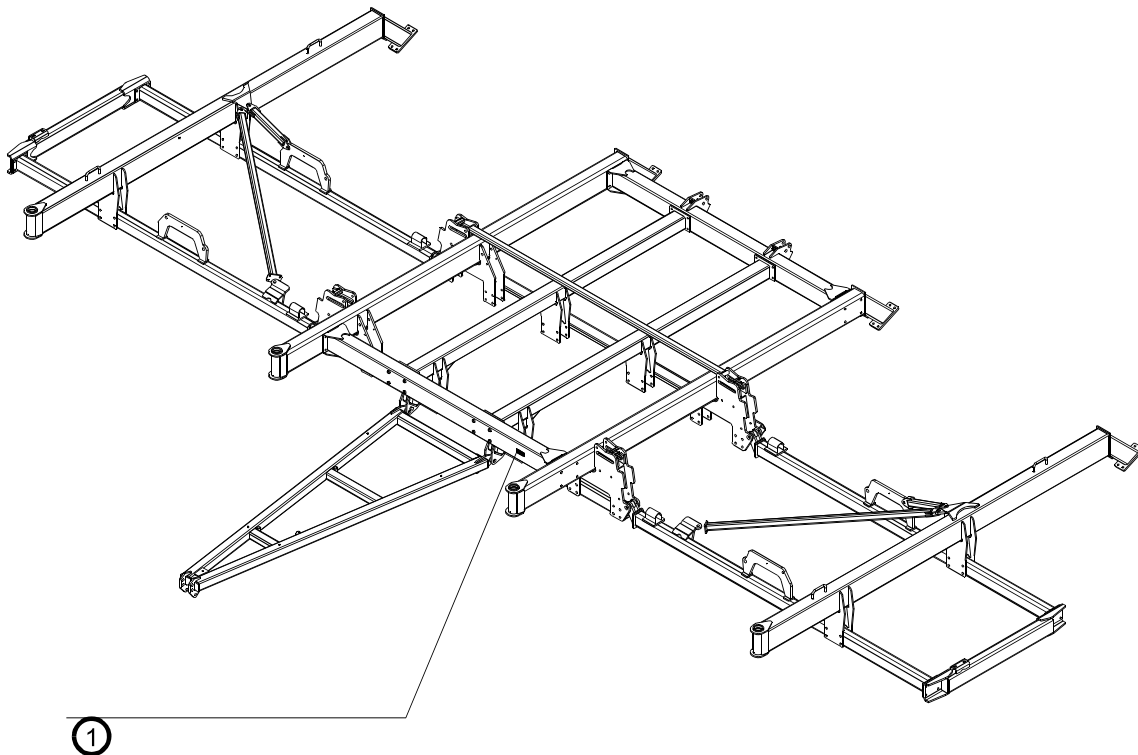
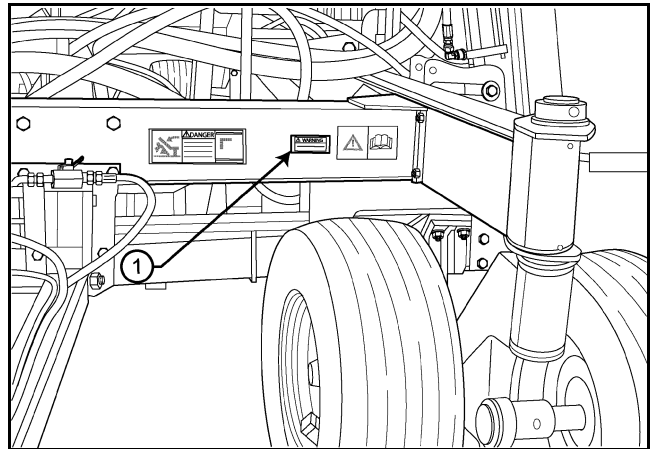
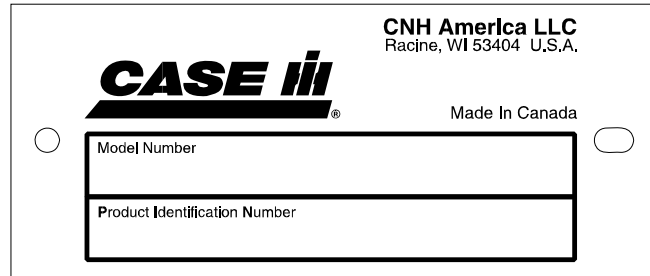

<https://www.ebooklibonline.com>

Hello dear friend!

Thank you very much for reading.

Enter the link into your browser.

The full manual is available for immediate download.

<https://www.ebooklibonline.com>

SDX30/SDX40 Single Disk No-Till Air Drill SERVICE MANUAL

TABLE OF CONTENTS

Pages listed are a table of contents for that section

Section - Title	Page
1 - SAFETY 1-1 Safety Decal Locations Reflector Decals, Slow Moving Vehicle Sign and Transport Lighting	5 - OPENER SERVICE 5-1 Troubleshooting Tables Adjustments Opener Service
2 - MECHANICAL SERVICE 2-1 General Service Information Specifications Locking Openers / Subbar for Service Replacing the Serial / PIN Plate Grease Locations and General Maintenance Storage Welding Procedures SDX30 Frame Brace Kit Fold Linkages Wheel Bolt Torque Hub / Spindles / Wheels	6 - AIR SYSTEM SERVICE 6-1 Troubleshooting Table Single Rank Operation Setting the Fan Speed - Concord Air Systems Hoses Theory of Operation To Determine Adequate Carrying Velocities Air System Components - Concord Air System Air System Components - ADX Air System
3 - HYDRAULIC SYSTEM SERVICE 3-1 Hydraulics Hydraulic Cylinder Seal Replacement Hydraulic Cylinder Components Wing Lift Hydraulic Schematics Subbar Hydraulics	7 - ENDMARKER SERVICE 7-1 Endmarkers SDX30 Endmarker SDX30 Endmarker Adjustments SDX40 Endmarker SDX40 Endmarker Adjustments Endmarker Service
4 - ELECTRICAL SYSTEM SERVICE 4-1 Electrical System Service Clutches and Work Switch Connector Service Kit	INDEX

This Page is Left Blank

SECTION 1

SAFETY

CONTENTS OF THIS SECTION

	Page
SAFETY	1-3
General Safety Practices	1-4
Servicing Safety Precautions	1-4
Safety During Operation	1-5
Air and Air Hoses	1-8
Hydraulics and Hydraulic Leaks	1-8
Shields	1-9
Electrical	1-9
Tires	1-9
Safety During Transport	1-10
Safety Decals	1-10
DECAL LOCATIONS	1-11
SDX30 Safety Decal Locations	1-11
SDX40 Safety Decal Locations	1-12
REFLECTOR DECALS, SLOW MOVING VEHICLE SIGN AND TRANSPORT LIGHTING	1-13
SDX30 1 st Serial Range - to Serial Number BSN CKB0028188	1-13
SDX30 2 nd Serial Range - starting at Serial Number CBJ0007001	1-14
SDX40 Transport Lighting and Reflector Decals	1-16
Transport Lighting Wiring Schematic - for SDX30 Second Serial Number Range and SDX40	1-18

This Page is Left Blank

SAFETY

SAFETY-ALERT SYMBOL





This symbol is used to denote possible danger and care should be taken to prevent bodily injury.
This symbol means **ATTENTION! BECOME ALERT! YOUR SAFETY IS INVOLVED!**

THIS SYMBOL APPEARS WITH TEXT READING “DANGER!”, “CAUTION!”, OR “WARNING!” THESE WORDS INDICATE THREE LEVELS OF POSSIBLE HAZARDS, THAT ARE DESCRIBED BELOW.

THREE WORDS USED IN CONJUNCTION WITH THE SAFETY-ALERT SYMBOL:

DANGER!  Indicates an imminently hazardous situation that, if not avoided, will result in death or serious injury. The color associated with Danger is RED.

WARNING!  Indicates a potentially hazardous situation that, if not avoided, could result in death or serious injury. The color associated with Warning is ORANGE.

CAUTION!  Indicates a potentially hazardous situation that, if not avoided, may result in minor or moderate injury. The color associated with Caution is YELLOW.

GENERAL SAFETY PRACTICES

REVIEW this manual and operator's manual before servicing equipment.

NEVER allow anyone unfamiliar, untrained, or complacent to operate the drill.

ALWAYS USE the jack supplied when unhooking the drill.

NEVER transport the drill at speeds higher than 32 km/hr (20 mph).

MAINTAIN YOUR DRILL in proper working condition. Unauthorized modifications to the machine may impair function and/or safety and affect machine life.

It is PREFERRED to transport the drill separately without an air cart attached. However, this is not always practical. If you are transporting the drill with a tow between air cart, the air cart should be full. If you are transporting the drill with a tow behind air cart, the air cart should be empty.

BE SURE the drill is securely fastened to a large farm tractor or an air cart that is attached to a large farm tractor before operating hydraulics.

USE EXTREME CARE when making adjustments.

KEEP CHILDREN AWAY from all farm equipment.

SERVICING SAFETY PRECAUTIONS

BLOCK the wheels to prevent movement when servicing.

BE SURE the subbar cylinder locks are in place before servicing or adjusting opener assemblies or working on the drill.

CAUTION!



The tractor engine should be stopped and the wheels blocked to prevent any movement during servicing.

Always be sure that the depth control safety lock is in place when servicing the drill.

Always be sure the wings are in field position before servicing the drill.

Escaping hydraulic fluid is a serious hazard. Escaping hydraulic fluid that is under pressure can penetrate the skin, causing serious injury. Relieve pressure before disconnecting the hydraulic lines. Check/tighten all connections before applying pressure.

Never use your hand to search for leaks. Use a piece of cardboard or paper. If any fluid is injected into the skin, seek immediate medical attention. Gangrene may result if the wound is not treated within a few hours. Check your hydraulic fluid containers for warnings concerning the hydraulic fluids you use.

DO NOT walk within the radius of raised drill wings.

Failure to comply with these cautions may result in serious injury or death.

SAFETY DURING OPERATION

DO NOT ALLOW ANYONE ON THE DRILL while operating the drill hydraulics.

NEVER disconnect the tractor from the drill while the drill wings are raised.

KEEP CHILDREN AWAY from the drill during operation.

NEVER STAND within the radius of the raised wings. Hydraulic or mechanical failure may result in rapid or uncontrolled falling of the wings.

OPERATE the wings only on level ground with the depth control fully raised.



097002S

PARK ON LEVEL GROUND and block adequately.

AVOID moving machines.

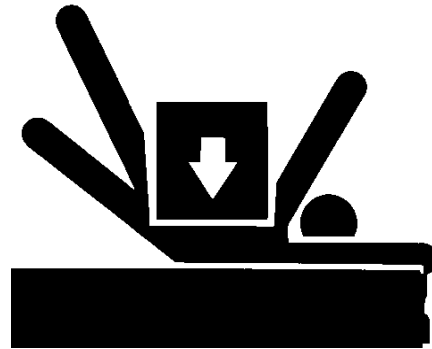

098001M1

DISENGAGE POWER AND SHUT DOWN the tractor engine (remove the key from the tractor ignition), be certain that all moving parts have stopped, and all pressure in the system is relieved BEFORE cleaning, adjusting or lubricating the drill.

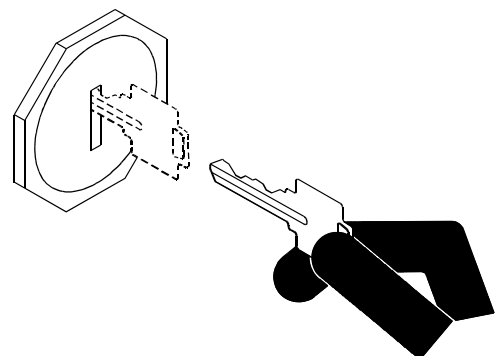

192169C

SECTION 1 - ⚠ SAFETY

READ the operators manual thoroughly.

KEEP the service area clean.



098002M1

DO NOT enter tight areas.

BE CERTAIN machine is tagged 'out of order' or work area is supervised.

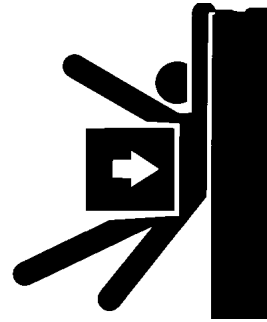

098003M1

DO NOT work around rotating equipment. Loose clothing, rings, watchbands, etc., may get caught and cause serious injury.

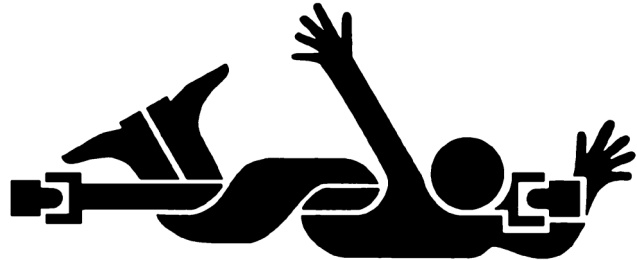

097001S

BE CERTAIN all moving parts have stopped before servicing.



098004M1

AVOID toxic vapors. Breath clean air.

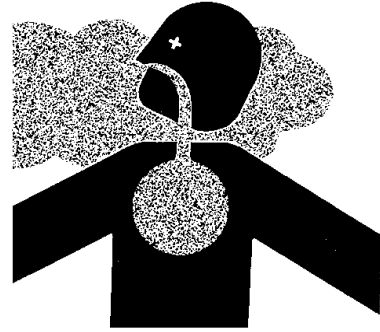

0960039S

DO NOT permit smoking.



196150S

WEAR protective clothing.

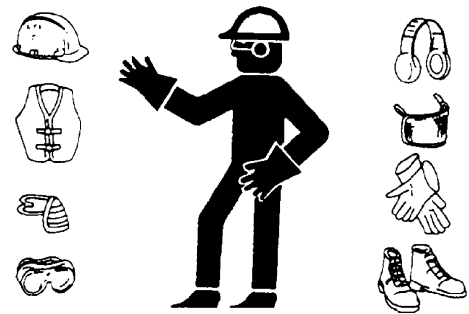

192078S

AIR AND AIR HOSES

COMPRESSOR HOSES may move unexpectedly when suddenly disconnected.



098005M1

USE PROPER air nozzles. Do not use compressed air to clean clothing or otherwise direct it toward yourself.

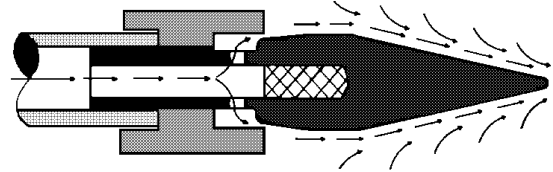

098006M1

AVOID getting chemicals into eyes. Use eye protection.

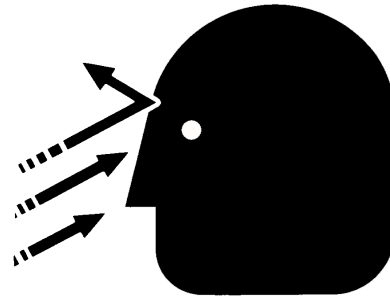

098007M1

HYDRAULICS AND HYDRAULIC LEAKS

AVOID high-pressure fluids.

ESCAPING HYDRAULIC FLUID IS A SERIOUS HAZARD. Escaping hydraulic fluid that is under pressure can penetrate the skin causing serious injury. Relieve pressure before disconnecting the hydraulic lines. Check/tighten all connections **BEFORE** applying pressure.

BEWARE excessive hydraulic pressure. Explosive structural failure can result.

BEWARE air locks in cylinders. Large cylinder displacements can occur without hydraulic oil flow.

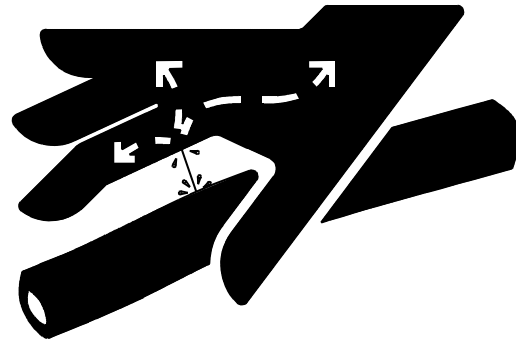

000002C

SHIELDS

REPAIR damaged shields.

KEEP all shields in place.

BE EXTRA CAUTIOUS when repairing or servicing without protective shields.

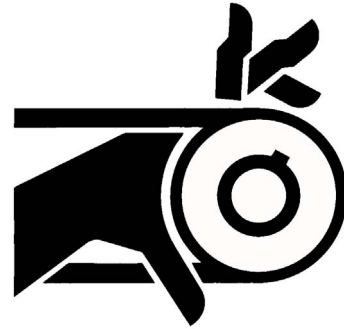

098008M1

ELECTRICAL

REMOVE the ground wire to avoid arcing contacts.

REMOVE GROUND WIRE when welding.



098009M1

TIRES

USE A CAGE IF POSSIBLE when setting tires on rims.

AVOID excessive air pressure.

DO NOT OVERINFLATE tires. NEVER lean over a tire while inflating it.



0960041S



Suggest:

For more complete manuals. Please go to the home page.

<https://www.ebooklibonline.com>

If the above button click is invalid. Please download this document first, and then click the above link to download the complete manual.

Thank you so much for reading

SAFETY DURING TRANSPORT

CHECK with local authorities regarding transport on public roads. Obey all applicable laws and regulations.

ONLY TOW at a safe speed [32 km/hr (20 mph)]. Use caution when turning corners or meeting traffic.

BE SURE safety lighting is plugged in and that the red taillight(s), amber flashers, and amber signal lights are all working properly.

ALWAYS be certain that no one is behind or near the drill before moving it.

BE SURE all safety transport locks are in place before transporting the drill.

BE SURE the reflector decals are clearly visible from all sides of the drill and the 'Slow Moving Vehicle' sign is at the rear of the drill in clear view of overtaking traffic.

BE SURE the tractor weight is equal to or greater than the total weight of the air cart and drill.

BE SURE all the wheel bolts are torqued to proper specifications before transporting the drill.

WATCH for power poles and overhead power lines.

ALWAYS lock the tractor drawbar when transporting the drill.

ALWAYS park the drill on level ground and block the wheels before unhooking from the towing vehicle.

NEVER subject the drill to steep side grades while in transport position.

ALWAYS use the hitch jack supplied with the drill when unhooking from the tractor.

NEVER brake or decelerate during cornering.

ALWAYS enter corners slowly. SLOW the machine to turning speed before entering a corner.

DO NOT decelerate while executing the turn.

SAFETY DECALS

KEEP SAFETY DECALS CLEAN. Wipe clean when necessary.

CHECK that the safety decals are not obstructed by the openers. If the decals are covered up, replace in a location that is clear to view.

REPLACE missing or unreadable decals. New decals are available from your dealer.

To replace decals:

1. Remove the old decal. Clean the area where the new decal will be affixed.
2. Remove the decal backing. Carefully affix the decal to the drill.
3. Work the air bubbles out from under the decal. Use a clean piece of paper or the decal backing itself.

DECAL LOCATIONS

SDX30 SAFETY DECAL LOCATIONS

The following safety decals are affixed to the drill.

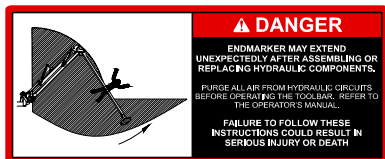
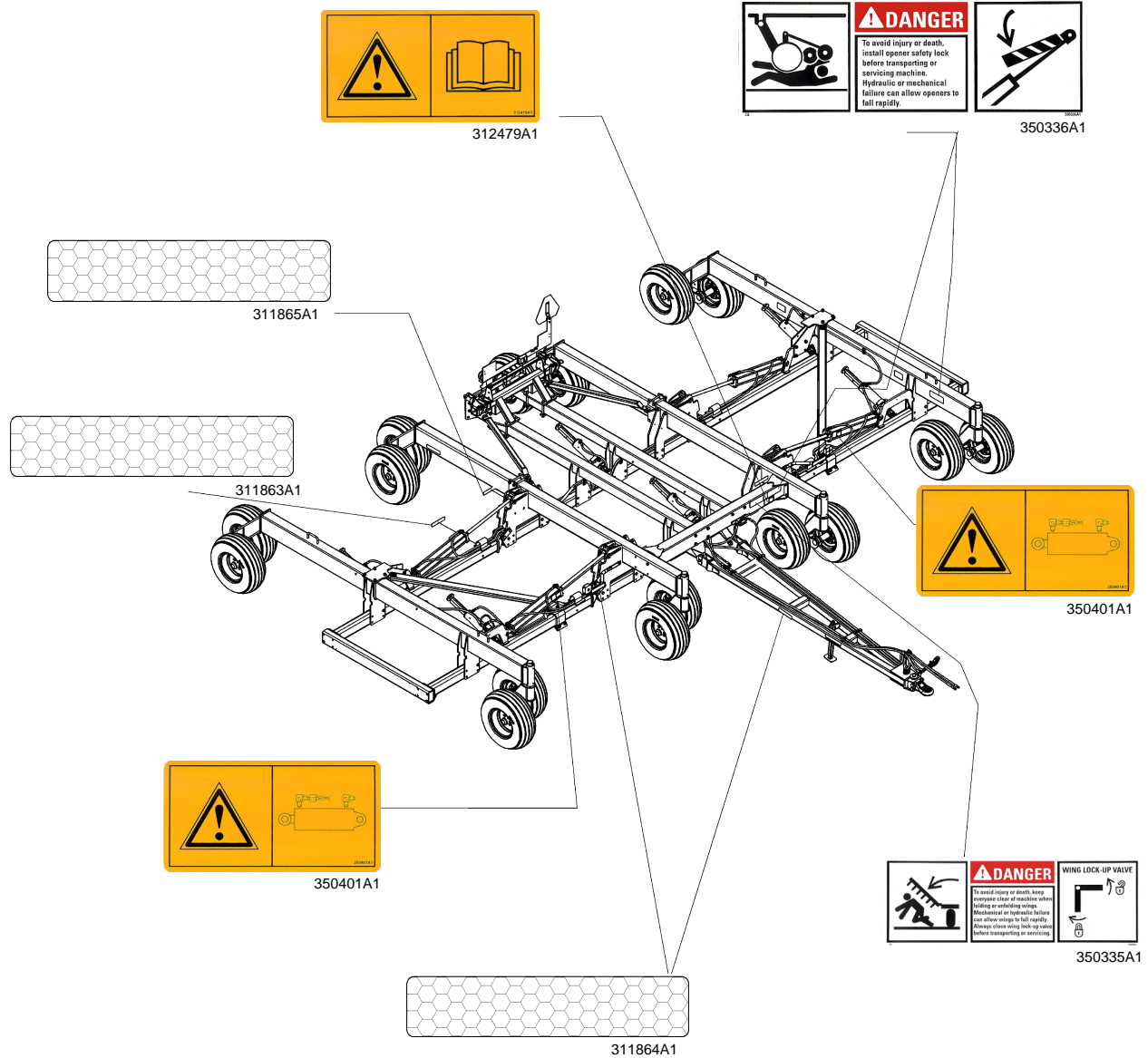

23251

Located on Endmarker Outer Arm (not shown)

<https://www.ebooklibonline.com>

Hello dear friend!

Thank you very much for reading.

Enter the link into your browser.

The full manual is available for immediate download.

<https://www.ebooklibonline.com>