

AMF

Harley-Davidson

SERVICE MANUAL

on CD

Electra Glide

Duo-Glide

1969

1959 to

TABLE OF CONTENTS

	Page Number		Page Number		Page Number
PRODUCT		FIBERGLASS		TOOLS	
GENERAL		Surface Finishing	2J-1	Tools	3T-1
Specifications	1A-1	Touch-up and Surface Repairs	2J-1		
Sprocket and Gear Ratios	1A-1	Patching Holes, Punctures and Breaks	2J-2	TRANSMISSION	
Tire Data	1A-1			GENERAL	
SERVICE		TOOLS		Transmission Specifications	4A-1
Servicing a New Motorcycle	1B-1	Tools	2T-1	Function of Transmission	4A-1
Lubrication and Service	1B-2	ENGINE		Stripping Motorcycle for Transmission Repair	4A-2
Lubricants, Engine and Transmission	1B-4A	GENERAL			
LOCATING TROUBLES		Engine Specifications	3A-1	CLUTCH	
Engine	1C-1	Engine Description	3A-1	Adjusting Clutch	4B-3
Generator	1C-2	Lubrication	3A-3	Disassembling Clutch	4B-3
Carburetor	1C-2	Servicing Oil Filter	3A-4		
Transmission	1C-2	Engine Oiling and Breather System	3A-5	STARTER	
Clutch	1C-2	Engine Repair Procedure	3A-9	Disassembling Kick Starter	4C-1
Brakes	1C-2	Stripping Motorcycle for Engine Repair	3A-9	Disassembling Kick Starter Clutch	4C-1
CHASSIS		CYLINDER HEAD		ELECTRIC STARTER	
DRIVE		Removing Cylinder Head	3B-1	Starter Drive	4C-2A
Chain Adjustment	2B-1	Replacing Valve Guides	3B-2B	Disassembling Electric Starter	4C-2A
Chain Lubrication	2B-2	Replacing Valve Seats	3B-3		
Removing and Installing Rear Chain	2B-2A	Grinding Valves	3B-3	GEAR BOX	
Removing and Installing Front Chain	2B-2A	Lapping Valves	3B-4	Adjusting Shifting Linkage	4D-1
WHEELS		Assembling Cylinder Head	3B-4	Adjusting Foot Shifter Cover	4D-1
Removing Wheels	2C-1	Adjusting Tappets	3B-4	Replacing Main Drive Gear Oil Seal	4D-1
Wheel Hub	2C-3	CYLINDER		Disassembling Shifter Cover	4D-3
Replacing Rear Wheel Sprocket	2C-5	Disassembling Cylinder and Piston	3C-1	Disassembling Shifter Forks	4D-6
Spoking Wheels	2C-5	Refinishing Cylinder	3C-2	Disassembling Gear Box	4D-7
Truing Wheels	2C-6	Fitting Piston Rings	3C-3		
Tires	2C-6A	Connecting Rod Bushing	3C-4	TOOLS	
Wheel Alignment	2C-6B	Straightening Connecting Rods	3C-4	Tools	4T-1
HANDLEBAR		Assembling Cylinder and Piston	3C-6	ELECTRICAL	
Spark and Throttle Controls	2D-1	GEARCASE		WIRING	
FRAME		Oil Pump	3D-1	Wiring Diagram with Key (1959)	5B-1
Basic Dimensions	2E-2	Valve Tappets and Guides	3D-1	Wiring Diagram with Key (1960)	5B-11
FORKS		Disassembling Timing Gears	3D-5	Wiring Diagram with Key (1961-1964)	5B-19
Changing Front Fork Oil	2F-1	Replacing Cover Bushings	3D-6	Wiring Diagram with Key (1965-1967)	5B-52
Disassembling Fork Slider	2F-5	CRANKCASE		Wiring Diagram with Key (1968)	5B-52A
Adjusting Steering Damper	2F-5	Disassembling Crankcase	3E-1	SWITCHES	
Adjusting Front Fork Trail	2F-6	Disassembling Flywheels	3E-3	Disassembling Ignition-Light Switch	5C-1
Disassembling Front Fork	2F-6	Lapping Connecting Rods	3E-4	Button Switch	5C-2
Steering Head Bearings	2F-7	Fitting Rod Bearing Races	3E-4	Headlamp Dimmer and Horn Switch	5C-2
Replacing Front Fork Slider Bushings	2F-7	Assembling Flywheels	3E-5	Transmission Neutral Switch	5C-2A
Straightening Front Fork	2F-8	Lapping Engine Main Bearing	3E-8	Solenoid Switch	5C-2A
Rear Shock Absorbers	2F-11	Fitting Pinion Shaft Bearings	3E-9		
Rear Fork	2F-14	Fitting Sprocket Bearing	3E-9	LAMPS	
BRAKES		Assembling Crankcase	3E-9	Removing Headlamp	5D-1
Adjusting Front Brake	2G-1	FUEL SYSTEM		Adjusting Headlamp Beam	5D-1
Disassembling Brakes	2G-1	Model HD Carburetor	3F-1	Bulb Chart	5D-2
Adjusting Rear Brakes	2G-3	Model M Carburetor	3F-11		
Rear Brake Master Cylinder	2G-3	Model DC Carburetor	3F-15		
SEAT		Model MD Carburetor	3F-21		
Seat Post	2H-1	Fuel Strainer	3F-25		
		Air Cleaner	3F-25		
		Fuel Tank	3F-25		
		Fuel Supply Valve	3F-25		

TABLE OF CONTENTS (CONT)

	Page Number		Page Number		Page Number
GENERATOR (STANDARD)		SPARK PLUGS		STARTER MOTOR	
Testing Generator Output	5E-1	Removing	5H-1	Locating Troubles	5L-5
Testing Field Coils	5E-3	Cleaning, Inspecting and		Removing Starter Motor	5L-5
Testing Armature	5E-4	Repair	5H-1	and Drive	5L-5
Disassembling Generator	5E-6	Adjusting Electrode Gap	5H-2	Delco-Remy Starter	
		Testing	5H-2	Motor Service	5L-5
		Installing	5H-2	Presto Lite Starter	
				Motor Service	5L-7
GENERATOR (FAN COOLED)		REGULATOR			
Testing Generator Output	5E-7	Servicing	5I-1		
Testing Field Coils	5E-7	Testing Specifications	5I-2		
Testing Armature	5E-9				
Disassembling Generator	5E-9				
CIRCUIT BREAKER		BATTERY		TOOLS	
Description	5F-1	Battery Care	5J-1	Tools	5T-1
Adjusting Breaker Points	5F-2	Charging	5J-1		
Adjusting Ignition	5F-2	Changing Electrolyte	5J-1		
Disassembling Circuit					
Breaker	5F-5	HORN		MISCELLANEOUS	
		General Information	5K-1		
IGNITION COIL		Disassembling Horn	5K-2	INSTRUMENTS	
Trouble Shooting	5G-1	Adjusting Horn	5K-2	Servicing Tachometer	6D-1
Replacing Cables	5G-2				

<https://www.ebooklibonline.com>

Hello dear friend!

Thank you very much for reading.

Enter the link into your browser.

The full manual is available for immediate download.

<https://www.ebooklibonline.com>

**1959 to 1969
ELECTRA GLIDE
DUO-GLIDE
SERVICE
MANUAL**

PRODUCT	1
CHASSIS	2
ENGINE	3
TRANSMISSION	4
ELECTRICAL	5
MISCELLANEOUS	6

The maintenance and repair information in this manual applies to the 1959 to 1969 Harley-Davidson Duo-Glides and Electra Glides

TABLE OF CONTENTS

	PAGE
General	1A-1
Service	1B-1
Locating Troubles	1C-1

SERVICE

SERVICING A NEW MOTORCYCLE

PREDELIVERY

Service operations to be performed before delivery to customer are specified in the Setting Up Instructions and Important Instructions included with new vehicle.

CHECK AT FIRST 500 MILES

1. Drain oil tank through drain plug, flush with kerosene and refill with fresh oil.
2. Clean oil filter (if applicable). Clean overhead valve and tappet oil supply screen.
3. Drain transmission through drain plug and refill to level of filler opening with fresh oil. Use same grade oil used in engine.
4. Lubricate all points indicated for 2000 mile attention in the regular service intervals chart.
5. Aim headlight.
6. Inspect and service air cleaner if needed.
7. Check adjustment of chains and readjust if necessary.
8. Check lubrication of front chain and readjust chain oiler adjusting screw if necessary (1964 and earlier Models).
9. Check lubrication of rear chain and readjust chain oiler (if provided).
10. Check wheel mounting bolts and tighten if needed. These bolts must be kept very tight.
11. Check level of solution in battery and add distilled water if needed. See that terminals are clean and connections tight.
12. Check tightness of all cylinder head bolts and all cylinder base nuts, and tighten where necessary.
13. Check brake adjustment and hydraulic fluid level.
14. Check tire pressure and inspect tread.
15. Check front fork bearing adjustment.
16. Clean carburetor gas strainer.
17. Clean chain housing magnetic plug (if applicable).

18. Inspect and clean spark plugs.

19. Check ignition timing and circuit breaker point gap.

20. Check all nuts, bolts and screws, and tighten any found loose.

21. Check and tighten wheel spokes.

22. Check clutch adjustment.

23. Road test.

CHECK AT FIRST 1000 MILES

1. Drain oil tank and refill with fresh oil.
2. Clean oil filter (if applicable).
3. Check level of oil in transmission and add oil if needed. Use same grade of oil used in engine.
4. Service air cleaner.
5. Check adjustment of chains and adjust if necessary.
6. Check lubrication of front chain and readjust chain oiler adjusting screw if necessary (1964 and earlier Models).
7. Check lubrication of rear chain and readjust chain oiler (if provided).
8. Check level of solution in battery, and add distilled water if needed. See that terminals are clean and connections tight.
9. Check circuit breaker point clearance and adjust if necessary.
10. Check brake adjustment and hydraulic fluid level.
11. Check clutch adjustment.
12. Check tire pressure.
13. Road Test.

Above operations are described fully in section pertaining to particular part of motorcycle. See table of contents for location.

The following chart outlines recommended Maintenance and Lubrication intervals after performance of service on a new motorcycle and the initial break-in period. Refer to Figure 1B-1 when using the chart.

IMPORTANT: To prevent over-greasing, use hand grease gun on all grease fittings.

REGULAR SERVICE INTERVALS CHART

REGULAR SERVICE INTERVAL	FIG. 1B-1 & 1B-1A INDEX NO.	GREASE	FIG. 1B-1 & 1B-1A INDEX NO.	OIL	FIG. 1B-1 & 1B-1A INDEX NO.	SERVICE
EVERY 1,000 MILES			14	Rear Chain (if chain oiler not used)	24 25 26 33	Air Cleaner Battery Rear Chain Adjustment Hydraulic Brake Fluid
EVERY 2,000 MILES	10 9 8 11 1 17 18 22A	Saddle Post Saddle Bar Bearing Rear Brake Pedal Bearing Foot Shift Lever Bearing Hand Clutch Booster Bearing Front Wheel Hub Thrust Bearing (1966 & earlier) Rear Wheel Hub Thrust Bearing (1966 & earlier) Foot Clutch Pedal Bearing Rear Fork Pivot Bearing (1962 Model)	15 5 23 20 7 12 21 19	Clutch Hand Lever Brake Hand Lever Clutch Control Cable Front Brake Cable Throttle Control Cable Spark Control Cable (1964 and earlier) Clutch Booster Lever Rod Clevis (1967 and earlier) Shifter Control Joints Generator Bearing (1960 and earlier) Saddle Post Roller and Bolt	27 28 29 34 30 31	Oil Filter Fuel Strainer Tappet Oil Screen (if applicable) Front Chain Adjustment (1965 and later) Front Chain Oiler Rear Chain Oiler Circuit Breaker Points Clutch Adjustment Brake Adjustment
EVERY 5,000 MILES OR 1 YEAR (whichever comes first)	7 6 2 13 16 31	Throttle Control Spiral Spark Control Spiral (1964 and earlier) Front Wheel Hub (Center) (1966 and earlier) Rear Wheel Hub (Center) (1966 and earlier) Sidecar Wheel Hub (Center) (1966 and earlier) Compensating Engine Sprocket (1964 and earlier) Circuit Breaker Camshaft Speedometer and Tachometer Cables			32 27 31 4 35	Replace: Spark Plugs Oil Filter Element Time Ignition Switch Tires Check Generator Brushes Check Shock Rubber Bushings



Suggest:

For more complete manuals. Please go to the home page.

<https://www.ebooklibonline.com>

If the above button click is invalid. Please download this document first, and then click the above link to download the complete manual.

Thank you so much for reading

REGULAR SERVICE INTERVALS CHART (CONT)

REGULAR SERVICE INTERVAL	FIG. 1B-1 & 1B-1A INDEX NO.	GREASE	FIG. 1B-1 & 1B-1A INDEX NO.	OIL	FIG. 1B-1 & 1B-1A INDEX NO.	SERVICE
EVERY 10,000 MILES	22 4	Repack Rear Fork Pivot Bearings (1959 to 1961 Models) Generator Bearing (1961 and later)				
EVERY 50,000 MILES	3	Repack Steering Head Bearings				
WEEKLY						Check Tires Check Battery

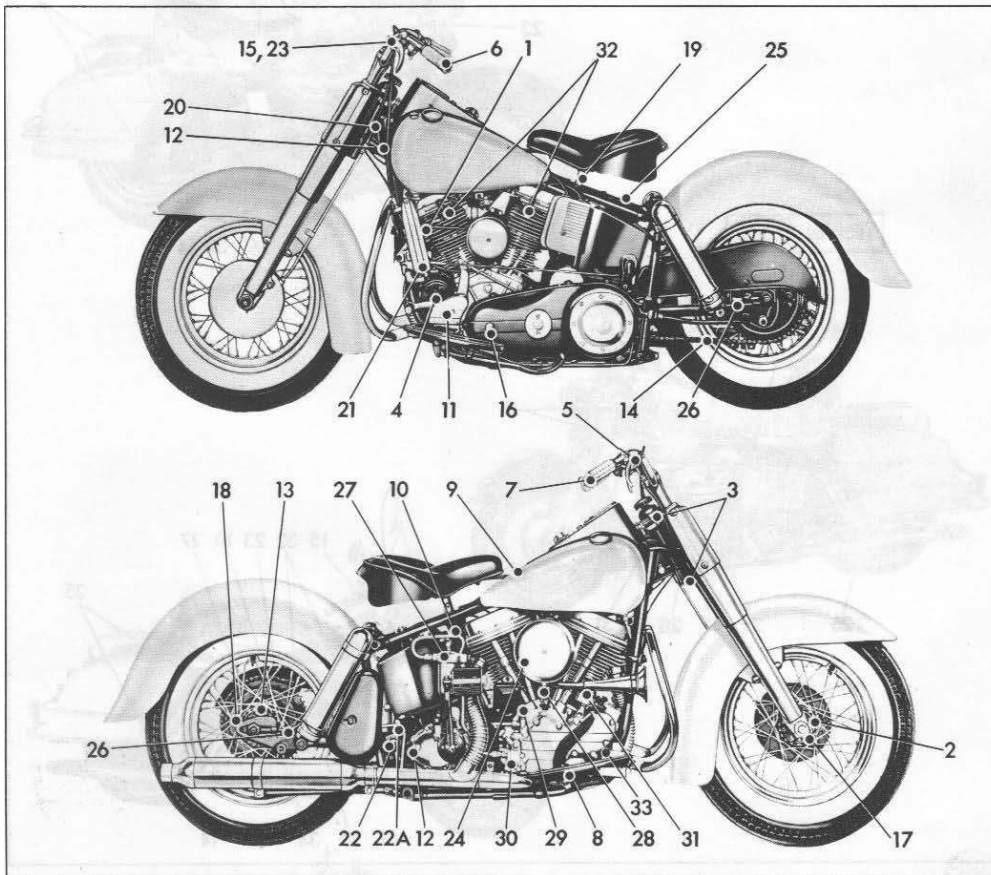

Figure 1B-1A. Lubrication and Service Chart (1964 & earlier Models)

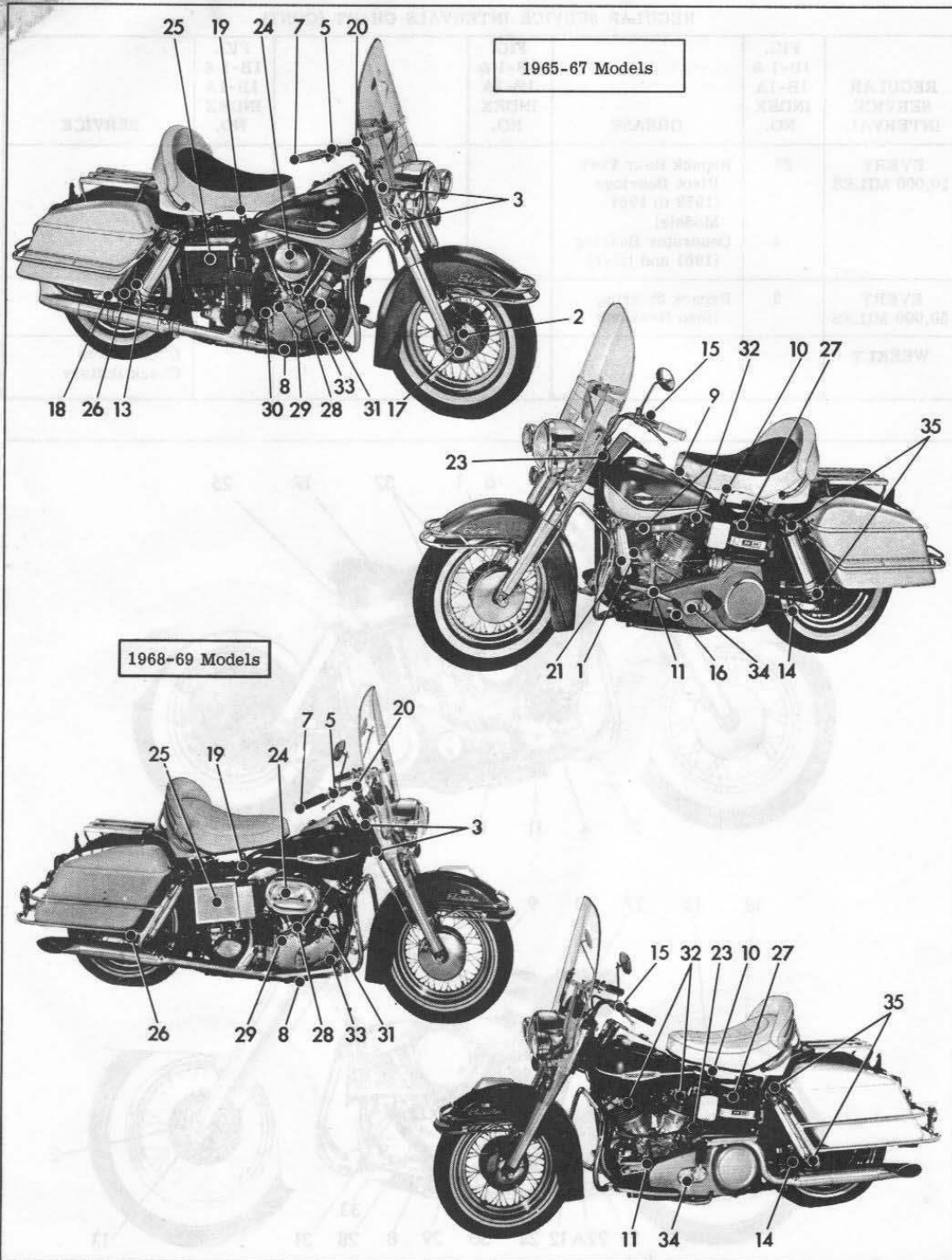

Figure 1B-1. Lubrication and Service Chart

<https://www.ebooklibonline.com>

Hello dear friend!

Thank you very much for reading.

Enter the link into your browser.

The full manual is available for immediate download.

<https://www.ebooklibonline.com>