

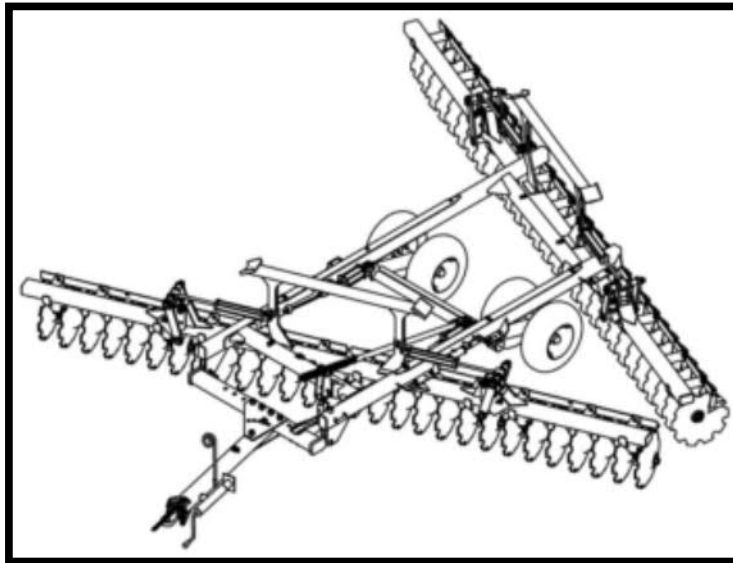

ASSEMBLY & OPERATING INSTRUCTIONS



WHEEL-TYPE OFFSET DISK HARROWS

FRONTIER WING-FOLD SERIES:

MODELS

DH4119, DH4121, DH4122 & DH4125

FORM NO. 5RPMAN331AO

Printed in USA

PUBLISHED DATE: 06-08



Suggest:

For more complete manuals. Please go to the home page.

<https://www.ebooklibonline.com>

If the above button click is invalid. Please download this document first, and then click the above link to download the complete manual.

Thank you so much for reading

Contents

Introduction	1
Table of Contents	2-4
Product Identification - Models DH4119 thru DH4122 Wing-Fold Offset Disks.....	5
Product Identification - Model DH4125 Wing-Fold Offset Disk.....	6
General Information	7
Checklists	8-10
Pre-delivery Checklist.....	8
Delivery Checklist.....	9
After Sale Checklist.....	10
Each Morning of Operation Checklist.....	10
Before Each Season Checklist.....	10
Safety Signs	11-13
Safety Sign Location.....	13
Safety	14-23
Recognize Safety Information.....	14
Understand Signal Words.....	14
Follow Safety Instructions.....	14
Use Seat Belt Properly.....	15
Operate Safely.....	15
Keep Riders Off Machine.....	16
Prepare For Emergencies.....	16
Wear Protective Clothing.....	16
Protect Against Noise.....	16
Use Safety Lights and Devices.....	17
Use A Safety Chain.....	17
Transport Safety.....	18
Tow Loads Safely.....	19
Practice Safe Maintenance.....	20
Remove Paint Before Welding or Heating.....	21
Avoid Heating Near Pressurized Fluid Lines.....	21
Avoid High - Pressure Fluids.....	22
Avoid Harmful Asbestos Dust.....	22
Store Attachments Safely.....	23
Dispose Of Waste Properly.....	23
Preparing the Tractor	24
Positioning Drawbar.....	24
Preparing the Disk	25
Checking And Lubricating Disk.....	25
Adjusting Rigid Scrapers.....	25
Attaching and Detaching	26-31
Attaching Disk to Tractor.....	26
Attaching Safety Chain To Tractor.....	26
Attaching Hydraulic Hoses.....	27
Attaching Warning Light Plug.....	27
Detaching Disk From Tractor.....	28

<https://www.ebooklibonline.com>

Hello dear friend!

Thank you very much for reading.

Enter the link into your browser.

The full manual is available for immediate download.

<https://www.ebooklibonline.com>

Contents

Attaching and Detaching Continued	26-31
Checking Transport Control Operation	29
Checking Leveling Adjustment.....	30
Leveling Setup Dimensions.....	31
Transporting Machine	32-34
Caution: Safety Guidelines.....	32
Positioning Tractor Drawbar for Transport (4-Wheel Drive).....	33
Positioning Tongue Jack For Transport.....	33
Attaching Safety Chain To Tractor.....	33
Install Transportation Locks.....	34
Attach Warning Light Plug.....	34
Transporting The Machine.....	34
Operating the Machine	35-44
Caution: Safety Guidelines.....	35
Guidelines For Use.....	36
Tighten Hardware.....	36
Operating Speed.....	36
Setting Drawbar Angle.....	37
Positioning Drawbar On Offset Bar.....	38
Positioning Drawbar To Reduce Draft on the Tractor.....	39
Adjusting For Side Draft.....	40,41
Angling Front And Rear Gangs.....	42
Wing Leveling Adjustment Screws.....	43
Leveling Disk Front To Rear.....	43
Setting Depth Of Penetration.....	43
Transport Hydraulic Control.....	44
Lubrication	45
Lubricate Storage.....	45
Lubricate Gang Bearings.....	45
Lubricate Wheel Bearings.....	45
Maintenance	46-55
Caution: Safety Guidelines.....	46
Daily Maintenance.....	47
Checking Wheel Bolts And Bearings.....	48
Repack Wheel Hub Bearings Annually.....	48
Gang Bearings.....	49
Disk Gangs.....	49
Hydraulic Hoses.....	49
Fasteners.....	49
Removing Hydraulic Cylinders.....	50
Bleeding Transport Cylinders.....	50
Servicing Disk Gangs.....	51
Assembling Disk Spacers.....	51
Gang Axle Wrenches.....	51
Tighten Gang Axle Nuts.....	52

Contents

Maintenance Continued	46-55
Attaching Disk Gangs To Standards.....	53
Servicing Tires Safely.....	54
Checking Tire Pressure.....	54
Tire Pressure Chart.....	55
Storage	56
Beginning Of Season Maintenance.....	56
End Of Season Maintenance.....	57
Assembly	57-73
Caution: Safety Guidelines.....	57
Check All Parts On Packing List.....	58
Step 1. Assembling Gangs.....	58,59
Step 2. Installing Gangs On Gang Carriers.....	60
Step 3. Installing Gang Carriers To Center Frame.....	60
Step 4. Installing Transport Assembly.....	61
Step 5. Attaching Wing-Fold Stops.....	61
Step 6. Installing Wheel Assemblies.....	61
Step 7. Attaching Transport Assembly Cylinders.....	62
Step 8. Attaching Offset Bar.....	62
Step 9. Attaching Leveling Control Assembly.....	62
Step 10. Installing (4) Wing-Fold Cylinders.....	63,64
Step 11. Attaching Drawbar.....	65
Step 12. Attaching Tongue Jack And Hose Support.....	65
Step 13. Installing Turnbuckle Assembly.....	65
Step 14. Attaching Transport Locks And Gang Bolt Wrenches.....	66
Step 15. Installing Transport Cylinder Hydraulic Hoses.....	66,67
Step 16. Installing Wing-Fold Cylinder Hydraulic Hoses And Hydraulic Groups.....	68-72
Step 17. Purge Air From Hydraulic Systems.....	73
Attachment Assembly	74,75
Install Safety Chain.....	74
Bearing Wear Plates.....	74
Install Warning Lights.....	75
Suggested Repair Parts	76-79
Model DH4119.....	76
Model DH4121.....	77
Model DH4122.....	78
Model DH4125.....	79
Manuals (Operators and Parts).....	80
Specifications	81,82

General

PRODUCT IDENTIFICATION -

FRONTIER MODEL DH4119 THRU DH4122 WING-FOLD WHEEL-TYPE OFFSET DISK HARROW

- 1-SAFETY CHAIN
- 2-CLEVIS
- 3-DRAWBAR
- 4-JACK
- 5-HOSE HOLDER
- 6-DRAWBAR PLATE
- 7-OFFSET BAR
- 8-TURNBUCKLE
- 9-WING-FOLD CYLINDER
- 10-TRANSPORT CYLINDER
- 11-TRANSPORT
- 12-LEVELING GROUP
- 13-FRONT GANG CARRIER
- 14-DISK SPACER
- 15-GANG ASSEMBLY
- 16-TIRE & WHEEL ASSEMBLY
- 17-SCRAPER BAR
- 18-REAR GANG CARRIER
- 19-SCRAPER ASSEMBLY
- 20-FRAME
- 21-TRANSPORT BEARING

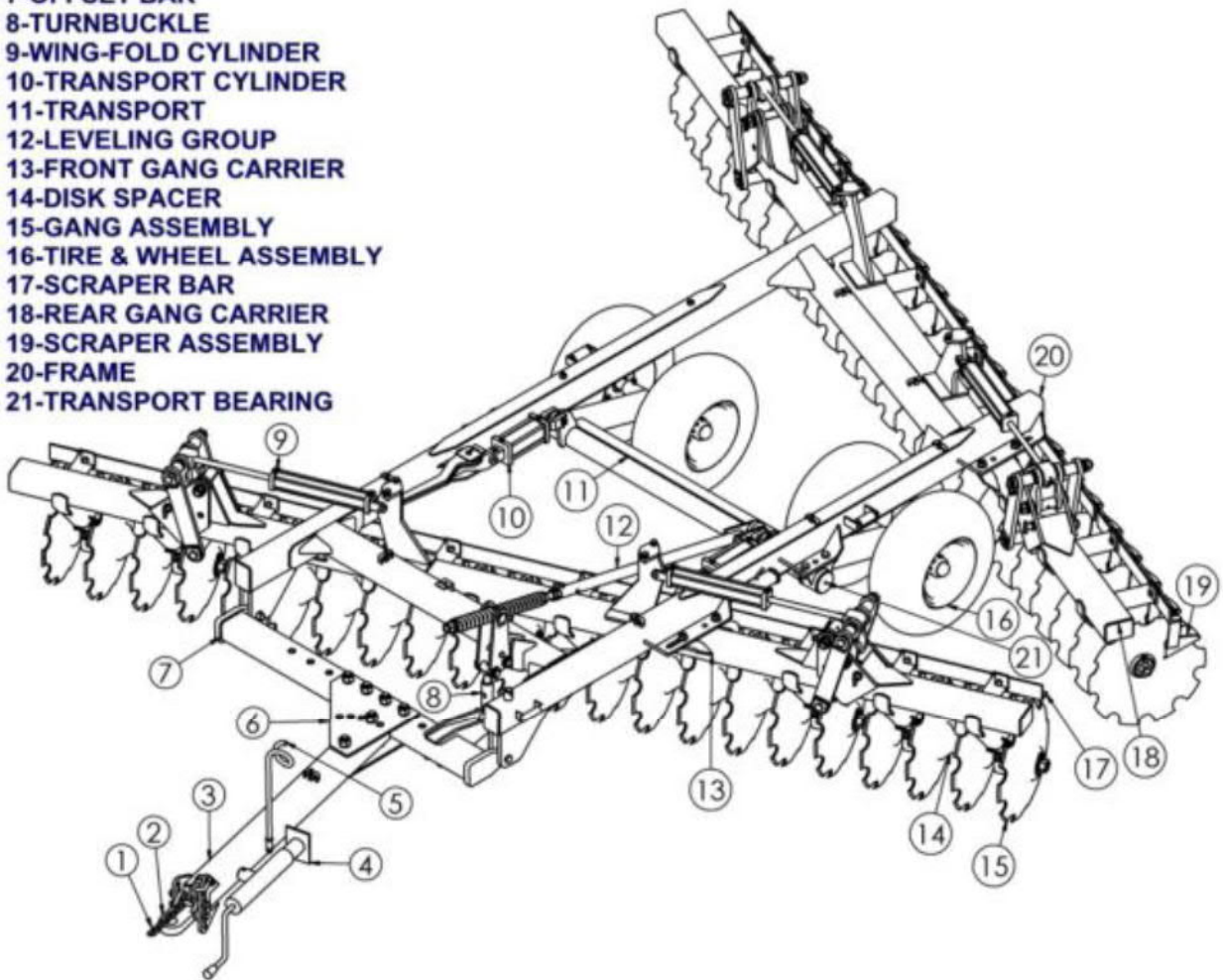

General

PRODUCT IDENTIFICATION – FRONTIER MODEL DH4125 WING-FOLD WHEEL-TYPE OFFSET DISK HARROW

- 1-SAFETY CHAIN
- 2-CLEVIS
- 3-DRAWBAR
- 4-JACK
- 5-HOSE HOLDER
- 6-DRAWBAR PLATE
- 7-OFFSET BAR
- 8-TURNBUCKLE
- 9-FRONT GANG CARRIER
- 10-DISK SPACER
- 11-GANG ASSEMBLY
- 12-SCRAPER BAR
- 13-LEVELING GROUP
- 14-WING STOP FRAME
- 15-TRANSPORT CYLINDER
- 16-TRANSPORT
- 17-TIRE & WHEEL ASSEMBLY
- 18-TRANSPORT BEARING
- 19-REAR GANG CARRIER
- 20-SCRAPER ASSEMBLY
- 21-FRAME

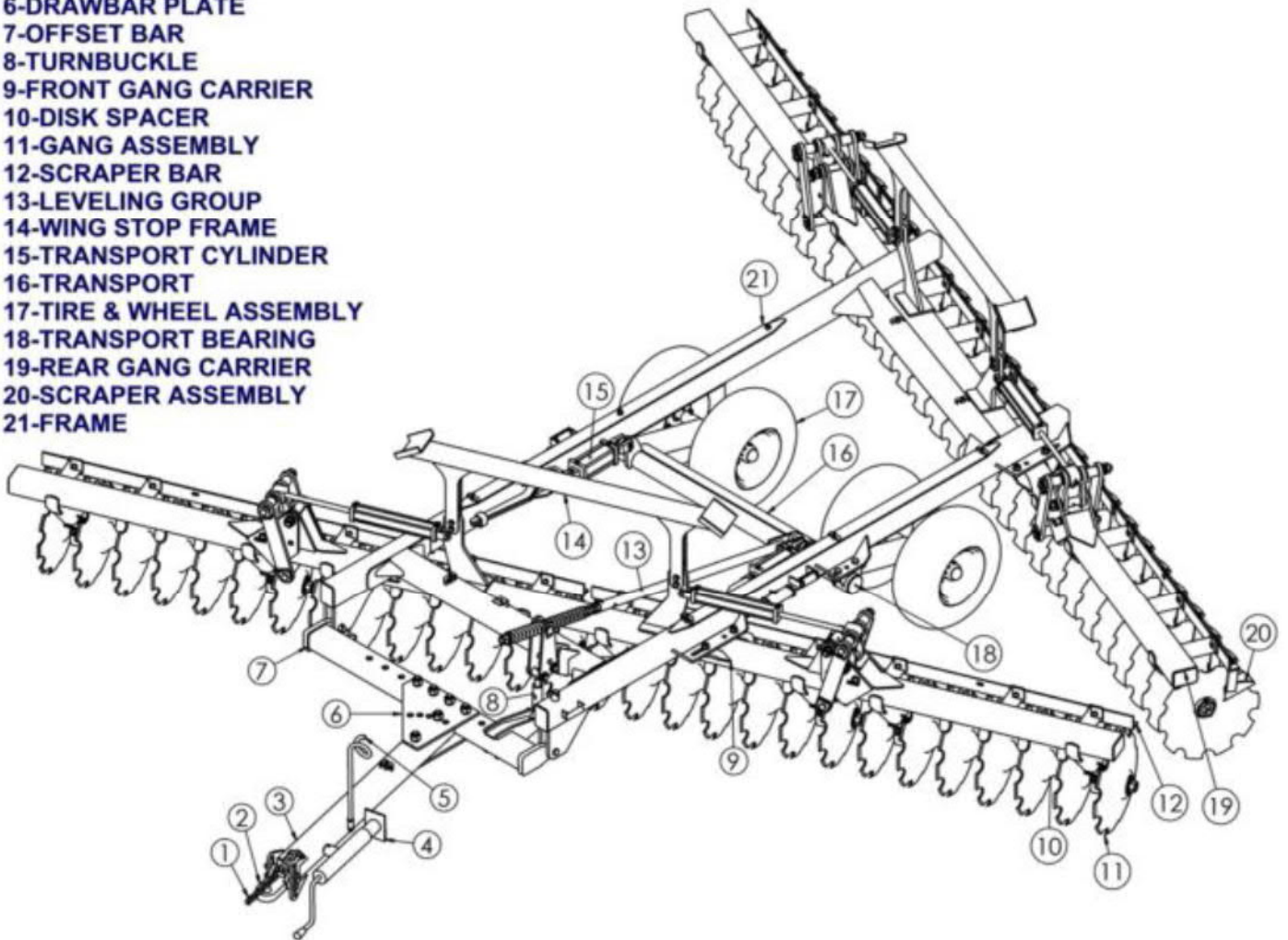

<https://www.ebooklibonline.com>

Hello dear friend!

Thank you very much for reading.

Enter the link into your browser.

The full manual is available for immediate download.

<https://www.ebooklibonline.com>