

T45050

John Deere > Construction And Forestry >BACKHOE, LOADER >310B - BACKHOE, LOADER >310A, 310B Backhoe Loaders >4 ENGINE 4 >CAMSHAFTS AND VALVE ACTUATING MEANS 0402 >00402-2 -
ROCKER ARM COVER [01D02]

KEY	PART NO.	PART NAME	QTY	310A	310B	REMARKS	
1	R56463	O-RING	1	X	X	(SUB FOR R495R, THIS APPLICATION)	
2	AR103811	SCREW WITH WASHER	8	X		(SUB FOR AR45530, THIS APPLICATION) (SUB FOR AR100124)	
3	AT18015	VALVE COVER	1	X	X		
4	AR100596	GASKET	1	X		(SUB FOR T20075) (ALSO ORDER (8) AT100124)	

<https://www.ebooklibonline.com>

Hello dear friend!

Thank you very much for reading.

Enter the link into your browser.

The full manual is available for immediate download.

<https://www.ebooklibonline.com>

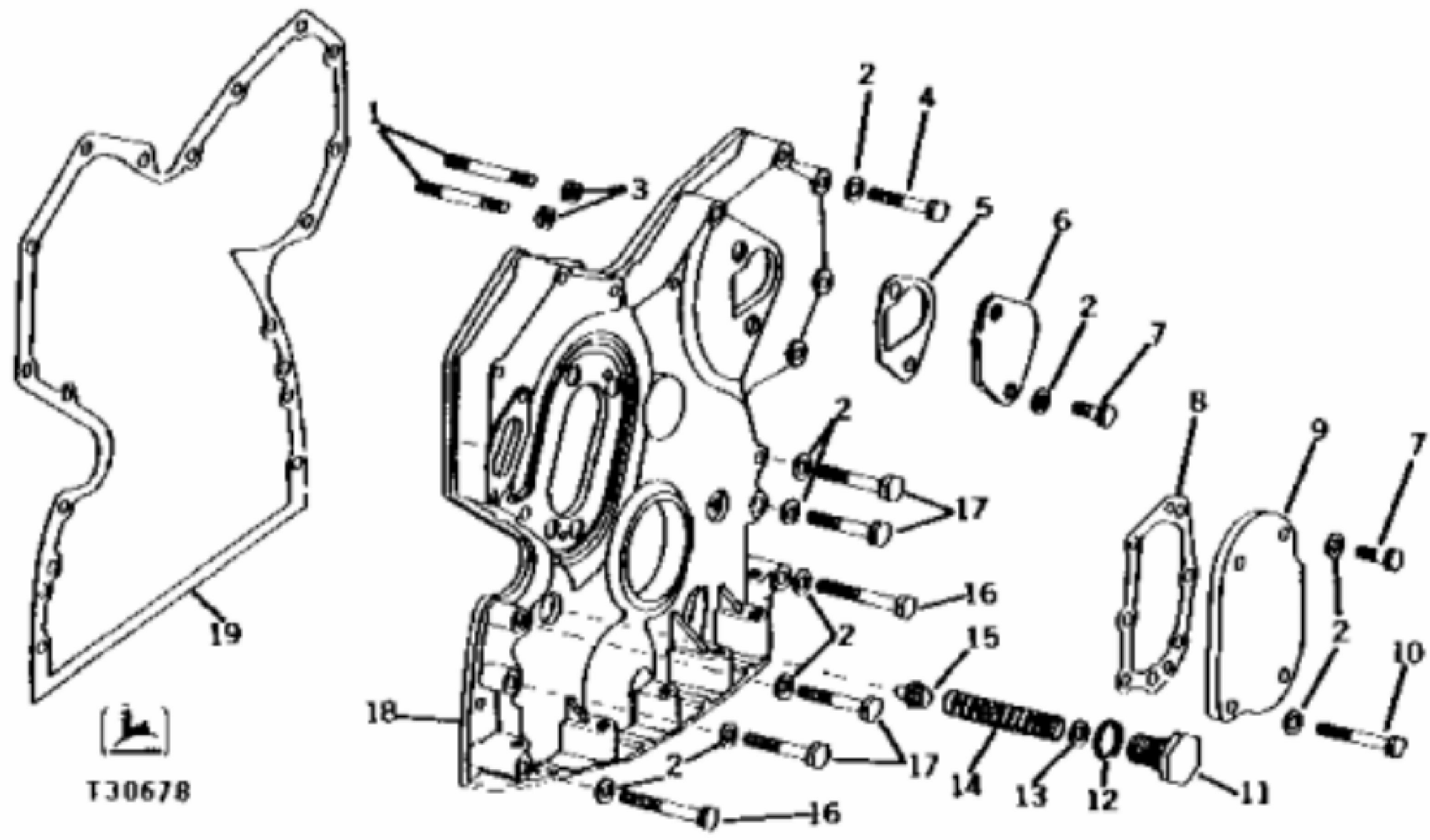

John Deere > Construction And Forestry >BACKHOE, LOADER >310B - BACKHOE, LOADER >310A, 310B Backhoe Loaders >4 ENGINE 4 >CAMSHAFTS AND VALVE ACTUATING MEANS 0402 >00402-3 - TIMING GEAR COVER [01D03]

KEY	PART NO.	PART NAME	QTY	310A	310B	REMARKS
1	R122226	STUD	2	X	X	(SUB FOR R122226)
2	24H1304	WASHER	AR	X	X	13/32" X 23/32" X 0.120"
3	14H812	NUT	2	X	X	3/8"
4	19H2549	CAP SCREW	5	X	X	3/8" X 1-7/8"
5	R78366	GASKET	1	X		(SUB FOR R69260 AND T20364)
6	R126041	COVER	1	X	X	(SUB FOR T20362)
7	19H2284	CAP SCREW	3	X	X	3/8" X 7/8"
7	R124277	CAP SCREW	2	X	X	(USE WITH R126041) (SUB FOR R122618, THIS APPLICATION)
8	T20273	GASKET	1	X	X	
9	T20272	COVER	1	X	X	
10	19H1726	CAP SCREW	1	X	X	3/8" X 2-1/4"
11	T27657	FITTING PLUG	1	X	X	
12	A4827R	WASHER	1	X	X	
13	24H1290	WASHER	1	X	X	
14	T27658	SPRING	1	X	X	
15	R83169	VALVE	1	X	X	OIL PRESSURE RELIEF, (SUB FOR R51516)
16	19H3031	CAP SCREW	2	X	X	3/8" X 2-1/2"
17	19H2549	CAP SCREW	4	X	X	3/8" X 1-7/8"
18	AR58196	COVER	1	X	X	(MARKED R52880) (ALSO ORDER T20272, T20273, (3) 19H2284, 19H1726, (4) 24H1304 AND 15H275)
19	T20155	GASKET	1	X	X	

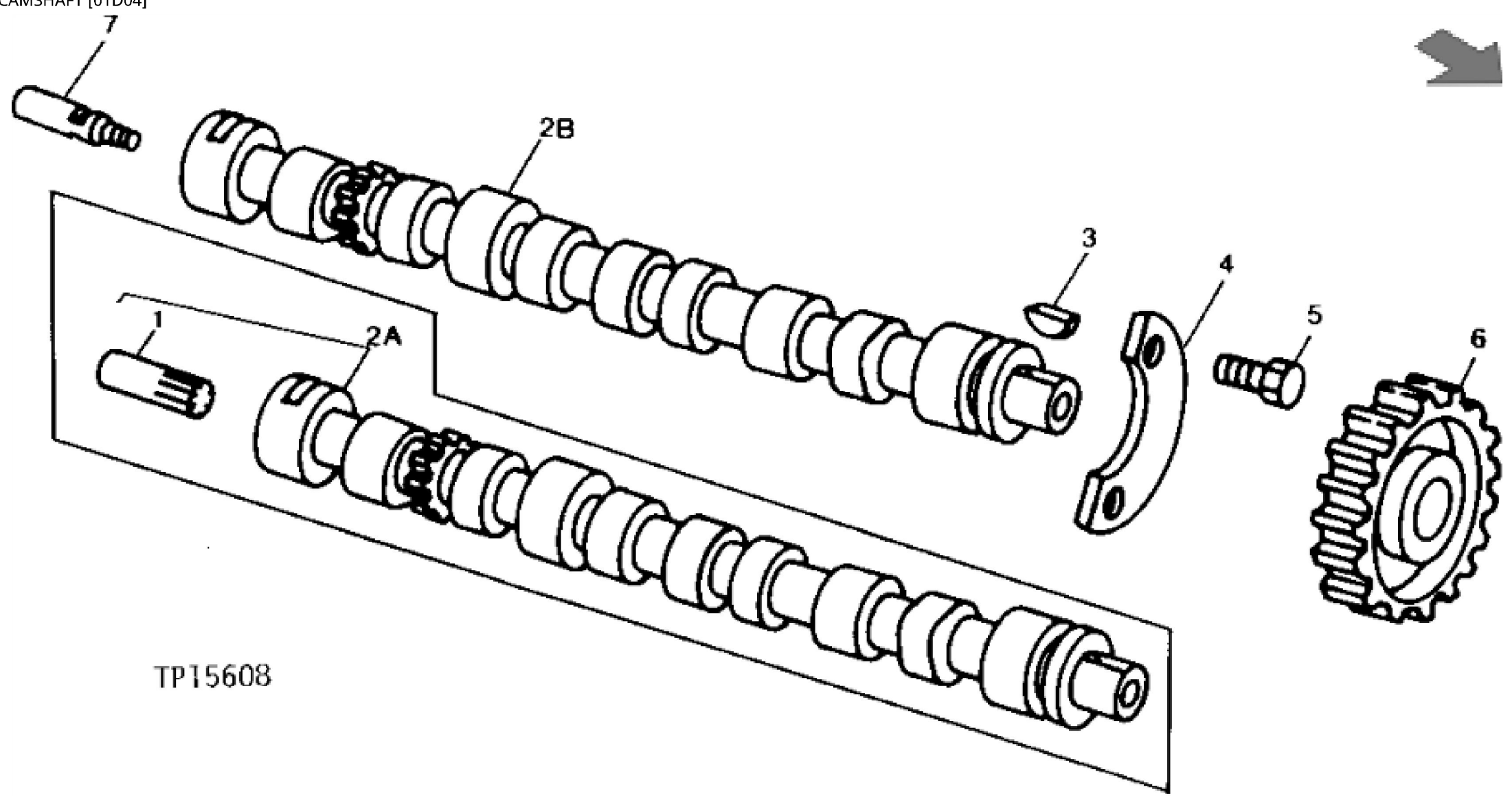

TP15608



Suggest:

For more complete manuals. Please go to the home page.

<https://www.ebooklibonline.com>

If the above button click is invalid. Please download this document first, and then click the above link to download the complete manual.

Thank you so much for reading

John Deere > Construction And Forestry >BACKHOE, LOADER >310B - BACKHOE, LOADER >310A, 310B Backhoe Loaders >4 ENGINE 4 >CAMSHAFTS AND VALVE ACTUATING MEANS 0402 >00402-4 - CAMSHAFT [01D04]

KEY	PART NO.	PART NAME	QTY	310A	310B	REMARKS
1	T20071	DRIVE SHAFT	1	X	X	TACHOMETER, (USE WITH AT18049)
2A	AT18049	CAMSHAFT	1	X	X	WITH TACHOMETER DRIVE GEAR, (MARKED T20013) (SUB R82820 AND R81513)
2B	R82820	CAMSHAFT	1	X	X	
3	T28041	SHAFT KEY	1	X	X	
4	T20072	PLATE	1	X	X	
5	19H2676	CAP SCREW	2	X	X	3/8" X 1"
6	T20070	HELICAL GEAR	1	X	X	(48 TEETH)
7	R81513	DRIVE SHAFT	1	X	X	(USE WITH R82820)

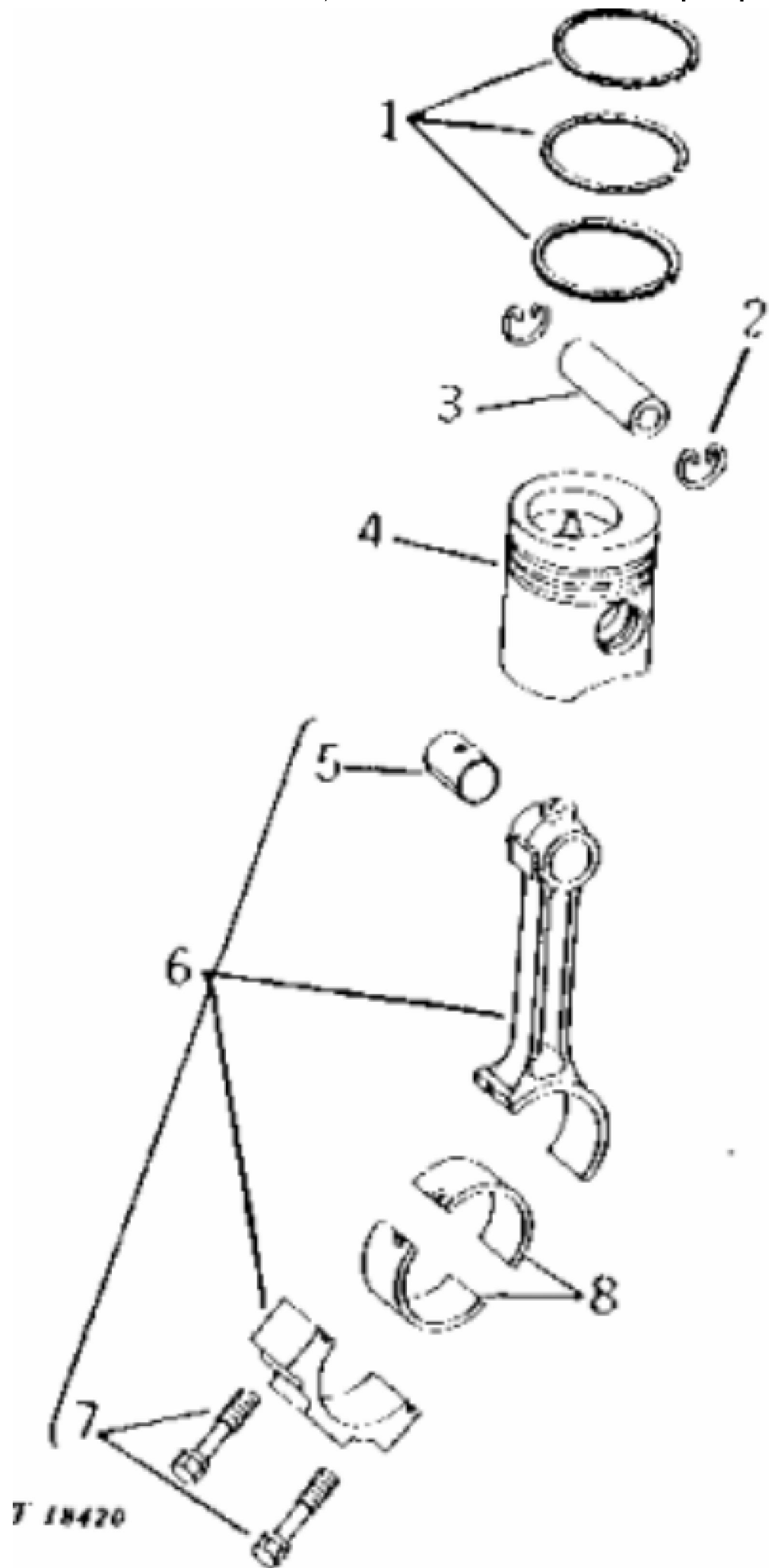

T 18420

<https://www.ebooklibonline.com>

Hello dear friend!

Thank you very much for reading.

Enter the link into your browser.

The full manual is available for immediate download.

<https://www.ebooklibonline.com>