

MP18844

KEY	PART NO.	PART NAME	QTY	REMARKS
1	M801186	BOLT	18	
2	M806505	ENGINE CYLINDER HEAD GASKET	1	
3	AM879992	CYLINDER BLOCK	1	
4	CH10335	PLUG	2	
5	PT13744	PLUG	1	
6	M802255	PIN	4	
7	M806840	PLUG	1	(SUB FOR M800973)
8	CH18079	SPRING PIN	2	
9	30M7023	PLUG	8	
10	15H562	PIPE PLUG	1	1"
11	M800977	BUSHING	1	
12	M800978	SHAFT	1	
13	CH19101	BOLT	2	
14	M87801	PLUG	2	
15	M800974	PIPE	2	
16	MIA880555	BEARING	2	(SUB FOR AM875373)
17	AM875371	BEARING KIT	5	(STD)
17	MIA880550	BEARING	5	.25MM (.010") US, (SUB FOR AM875374)
18	BEARING CAP	4	
19	M801189	BOLT	10	
20	BEARING CAP	1	
21	CH15002	PLUG	1	
22	CH10554	PACKING	4	
23	19M7864	SCREW	4	M8 X 12
24	T113961	PLUG	1	
25	LVU10333	SHIELD	1	(RH) (SUB FOR M130266 AND LVU10269)
26	LVU10332	SHIELD	1	(LH) (SUB FOR M130267)
27	19M7783	SCREW	1	M10 X 16
28	19M7864	SCREW	2	M8 X 12
29	19M7866	SCREW	1	M8 X 20
30	19M7783	SCREW	1	M10 X 16
31	14M7298	FLANGE NUT	1	M8
..	AM125480	DIESEL ENGINE	1	(MARKED 4TNE84-JTC45) (SUB AM880565)
..	AM129540	DIESEL ENGINE	1	(MARKED 4TNE84-EJTC45) (SUB AM880565)
..	AM130051	DIESEL ENGINE	1	(MARKED 4TNE84-EFTC45S) (SUB AM880565)

<https://www.ebooklibonline.com>

Hello dear friend!

Thank you very much for reading.

Enter the link into your browser.

The full manual is available for immediate download.

<https://www.ebooklibonline.com>

KEY	PART NO.	PART NAME	QTY	REMARKS	
..	AM125481	DIESEL ENGINE	1	(MARKED 4TNE84-JT45) (SUB AM880565)	
..	AM129541	DIESEL ENGINE	1	(MARKED 4TNE84-EJTF45) (SUB AM880565)	
..	AM129999	DIESEL ENGINE	1	(MARKED 4TNE84-EJTF45S) (SUB AM880565)	
..	LVU10364	ISOLATOR	1	RH, AIRDAM	
..	LVU10365	ISOLATOR	1	LH, AIRDAM	
..	LVU10366	ISOLATOR	1	BOTTOM, AIRDAM	
..	AM880565	SHORT BLOCK ASSEMBLY	1		

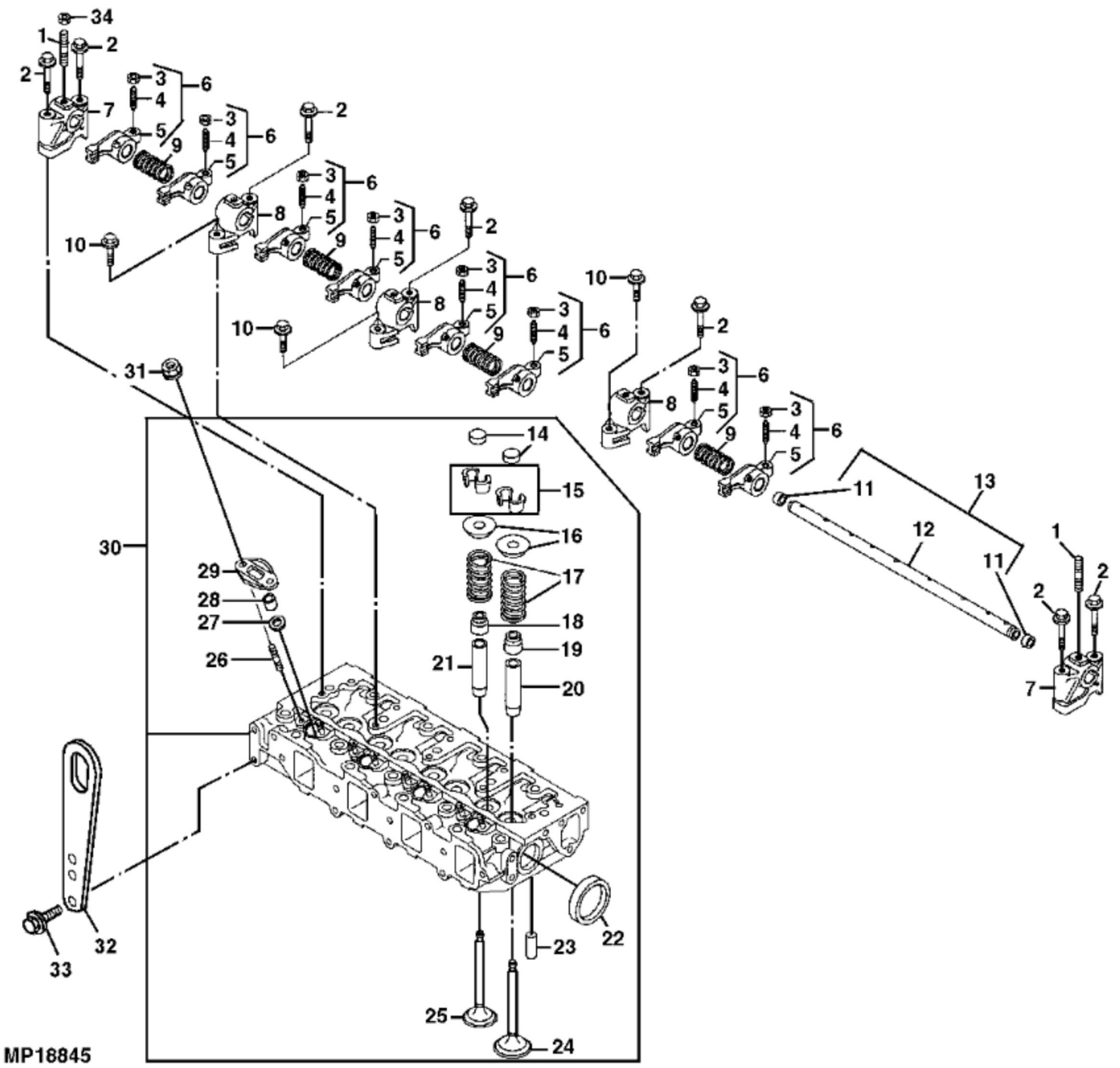

MP18845



Suggest:

For more complete manuals. Please go to the home page.

<https://www.ebooklibonline.com>

If the above button click is invalid. Please download this document first, and then click the above link to download the complete manual.

Thank you so much for reading

ARMS

KEY	PART NO.	PART NAME	QTY	REMARKS
1	M801024	STUD	3	
2	19M7800	SCREW	7	M8 X 50
3	M801028	NUT	1	
4	M801027	SCREW	1	
5	ROCKER ARM	1	
6	AM875383	ROCKER ARM	8	
7	M801022	SUPPORT	2	ROCKER ARM
8	M801023	SUPPORT	3	ROCKER ARM
9	M801025	SPRING	4	
10	19M7867	SCREW	3	M8 X 25
11	M800002	PLUG	2	
12	ROCKER ARM SHAFT	1	
13	AM875382	SHAFT	1	ROCKER ARM
14	M801224	CAP	8	
15	AM878862	RETAINER KIT	4	(2 PER PKG), VALVE
16	M801223	RETAINER	8	SPRING
17	M801222	SPRING	8	VALVE
18	T110650	SEAL	4	EXHAUST
19	CH10450	SEAL	4	INTAKE
20	M801227	GUIDE	4	INTAKE
21	M801228	GUIDE	4	EXHAUST
22	CH16751	PLUG	2	
23	CH18079	SPRING PIN	2	
24	M801220	INTAKE VALVE	4	
25	MIU800494	EXHAUST VALVE	4	(SUB FOR M801221)
26	M801219	BOLT	8	
27	M801017	VALVE SEAT	4	
28	M801016	SEAL	4	(SUB FOR M806732 OR M810460)
29	M801018	RETAINER	4	
30	AM878615	CYLINDER HEAD	1	(ENGINE MARKED 4TNE84-JTC45/4TNE84-JT45)
30	AM879737	CYLINDER HEAD	1	(ENGINE MARKED 4TNE84-EJTC45/4TNE84-EJTF45/4TNE84-EFTC45S/4TNE84-EJTF45S)
31	14M7303	FLANGE NUT	8	M6
32	AT211695	LIFT LINK	1	

KEY	PART NO.	PART NAME	QTY	REMARKS	
33	19M7865	SCREW	2	M8 X 16	
34	14M7273	NUT	3	M8	

<https://www.ebooklibonline.com>

Hello dear friend!

Thank you very much for reading.

Enter the link into your browser.

The full manual is available for immediate download.

<https://www.ebooklibonline.com>