

John Deere > Construction And Forestry > EXCAVATOR > 350DLC - EXCAVATOR > 350DLC Excavator (PIN: 1FF350DX\_ \_D805001- ) > 04A ENGINE 6090HT002 - RE541427-RE541427 > 0400A ENGINE 6090HT002 - RE541427-RE541427 6090HT002 - RE541427 > ST30542 - 1106 ROCKER ARM COVER

KEY	PART NO.	PART NAME	QTY	REMARKS
1	R527884	GASKET	1	SUB FOR R518263
2	RE536688	COVER	1	MARKED R545611 OR R527342 OR RE536688; SUB FOR RE529971
3	R523317	BREATHER	1	
4	19M7775	SCREW	2	M6 X 16
5	19M7796	SCREW	1	M6 X 30
6	R522401	O-RING	1	
7	RE528027	FILLER CAP	1	
8	T122075	O-RING	1	
9	RE529871	ELBOW FITTING	1	SUB FOR RE527976
10	R519533	MEDALLION	1	
11	19M8291	SCREW	15	M8 X 35

**<https://www.ebooklibonline.com>**

Hello dear friend!

Thank you very much for reading.

Enter the link into your browser.

The full manual is available for immediate download.

**<https://www.ebooklibonline.com>**

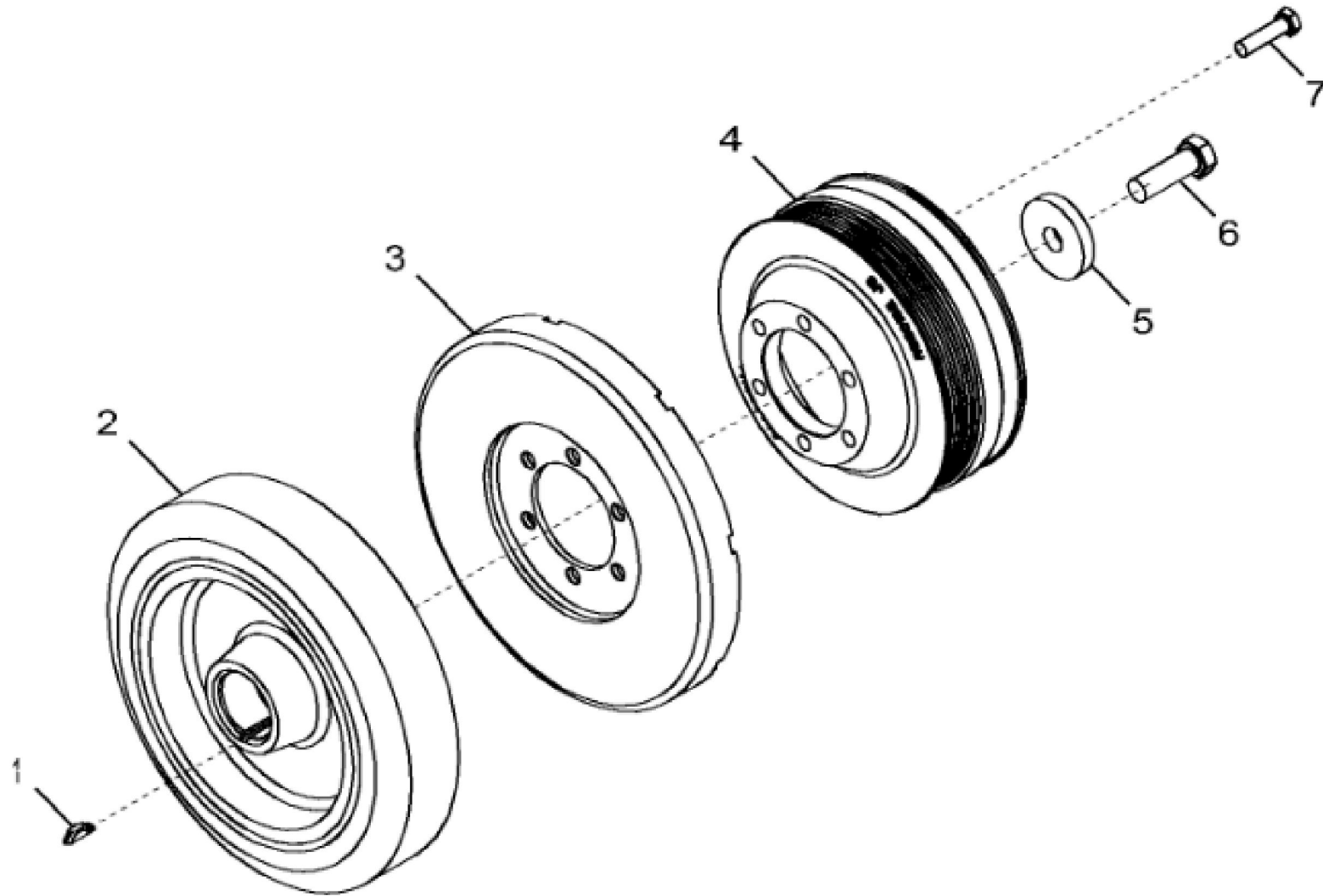

1312\_RE525492\_PCD

John Deere > Construction And Forestry > EXCAVATOR > 350DLC - EXCAVATOR > 350DLC Excavator (PIN: 1FF350DX\_ \_D805001- ) > 04A ENGINE 6090HT002 - RE541427-RE541427 > 0400A ENGINE 6090HT002 - RE541427-RE541427 6090HT002 - RE541427 > ST74603 - 1312 CRANKSHAFT PULLEY AND DAMPER

KEY	PART NO.	PART NAME	QTY	REMARKS	
1	R116311	KEY	1	ORDER R523306	
1	R523306	KEY	1		
2	RE520465	TORSIONAL DAMPER	1		
3	RE57604	TORSIONAL DAMPER	1		
4	R520445	PULLEY	1	MARKED R520182 OR R520445	
5	R26333	WASHER	1		
6	19M8889	CAP SCREW	1	M16 X 50	
7	19M8637	CAP SCREW	6	M10 X 40	



**Suggest:**

**For more complete manuals. Please go to the home page.**

**<https://www.ebooklibonline.com>**

**If the above button click is invalid. Please download this document first, and then click the above link to download the complete manual.**

**Thank you so much for reading**

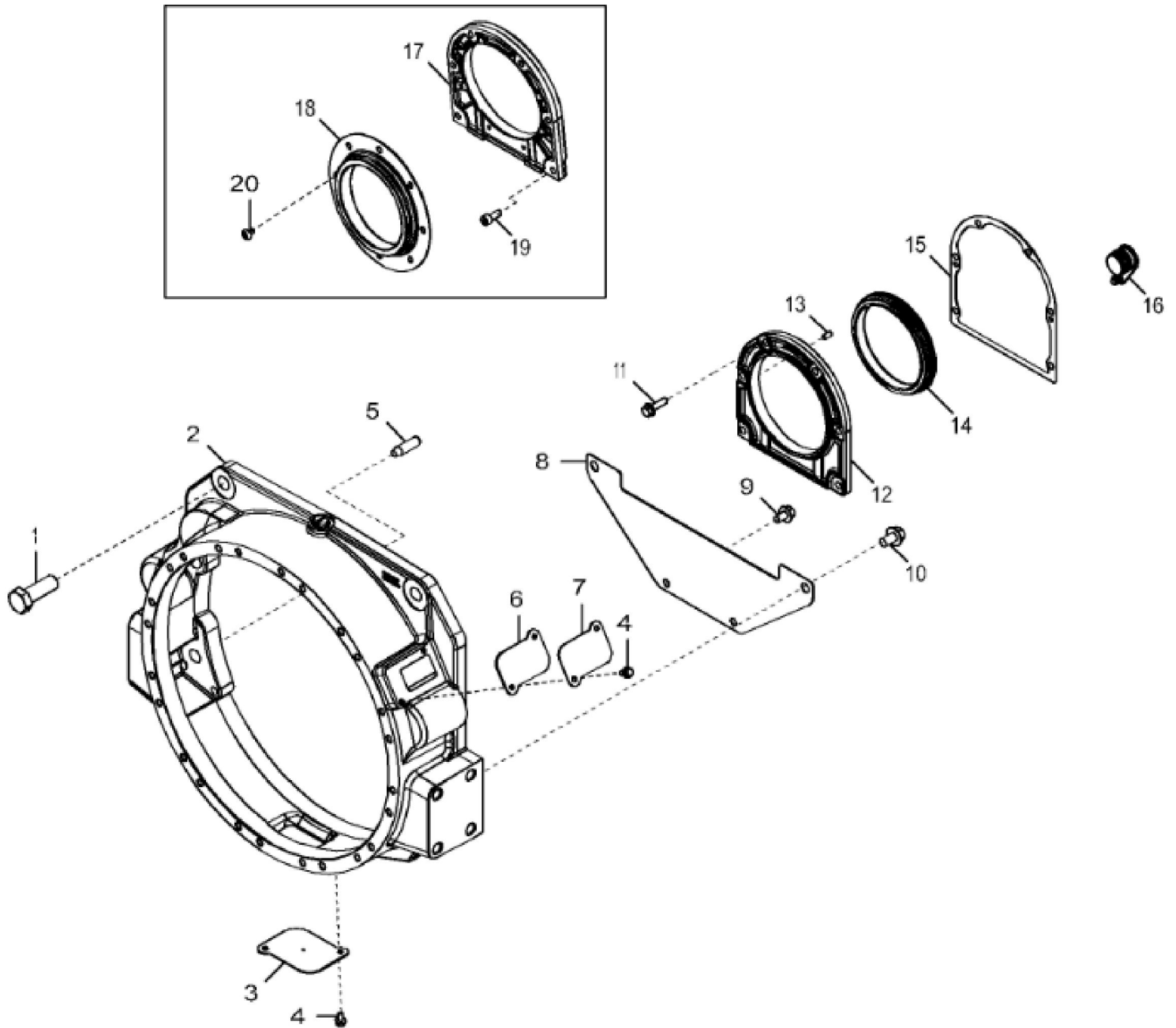

John Deere > Construction And Forestry > EXCAVATOR > 350DLC - EXCAVATOR > 350DLC Excavator (PIN: 1FF350DX\_ \_D805001- ) > 04A ENGINE 6090HT002 - RE541427-RE541427 > 0400A ENGINE 6090HT002 - RE541427-RE541427 6090HT002 - RE541427 > ST702692 - 1405 FLYWHEEL HOUSING

KEY	PART NO.	PART NAME	QTY	REMARKS
1	19M8002	CAP SCREW	6	M20 X 55
2	R519256	HOUSING	1	
3	R89195	PLATE	1	
4	19M7774	SCREW	4	M6 X 12
5	H79910	DOWEL PIN	2	
6	R67989	GASKET	1	
7	R519255	COVER	1	
8	R519506	COVER	1	
9	19M7783	SCREW	2	M10 X 16
10	19M7787	SCREW	2	M12 X 20
11	19M7868	SCREW	6	M8 X 30
12	R531312	HOUSING	1	USE WITH RE520036; SUB FOR R531570, R530233 AND R518551
13	F1743R	DOWEL PIN	2	
14	RE520036	SEAL	1	USE WITH R531312 OR R531570; SUB FOR RE530121
15	R522768	GASKET	1	
16	R121929	PLUG	1	
17	R518551	HOUSING	1	ORDER R531312; USE WITH RE530121
18	RE530121	SEAL	1	ORDER RE520036; USE WITH R518551 AND R522160
19	19M8446	SCREW	6	M8 X 20
20	R522160	SCREW	8	USE WITH RE530121

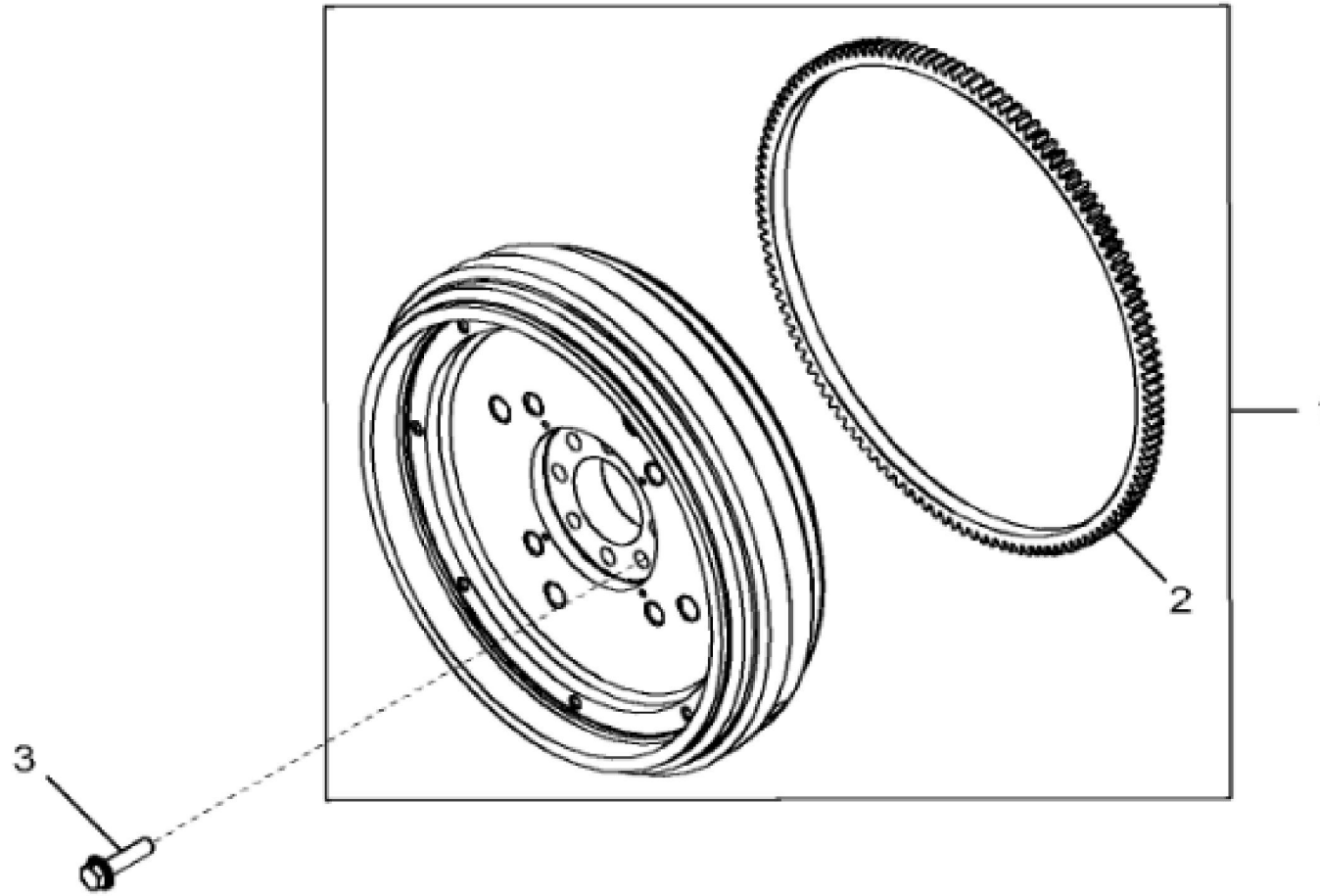

1543\_RE525493\_PCD

**<https://www.ebooklibonline.com>**

Hello dear friend!

Thank you very much for reading.

Enter the link into your browser.

The full manual is available for immediate download.

**<https://www.ebooklibonline.com>**