

TP16465

| KEY | PART NO. | PART NAME | QTY | REMARKS | |
|-----|----------|-------------------|-----|--------------------|--|
| 1 | 19H2036 | CAP SCREW | 1 | 1/4" X 7/8" | |
| 2 | 12H302 | LOCK WASHER | 1 | 1/4" | |
| 3 | R64764 | WASHER | 1 | | |
| 4 | AR103811 | SCREW WITH WASHER | 8 | (SUB FOR AR100124) | |
| 5 | AR65864 | FILLER CAP | 1 | | |
| 6 | AR71130 | VALVE COVER | 1 | | |
| 7 | AR100596 | GASKET | 1 | | |

<https://www.ebooklibonline.com>

Hello dear friend!

Thank you very much for reading.

Enter the link into your browser.

The full manual is available for immediate download.

<https://www.ebooklibonline.com>



TP861

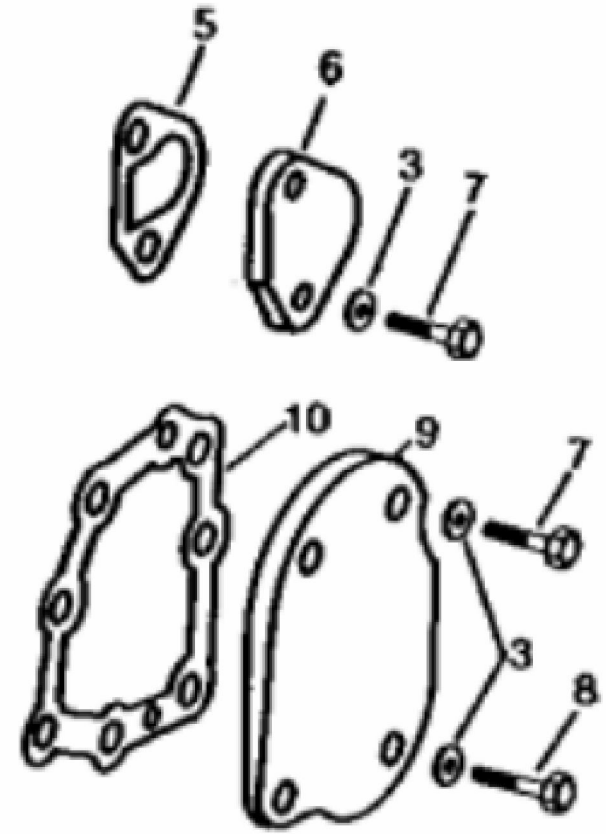
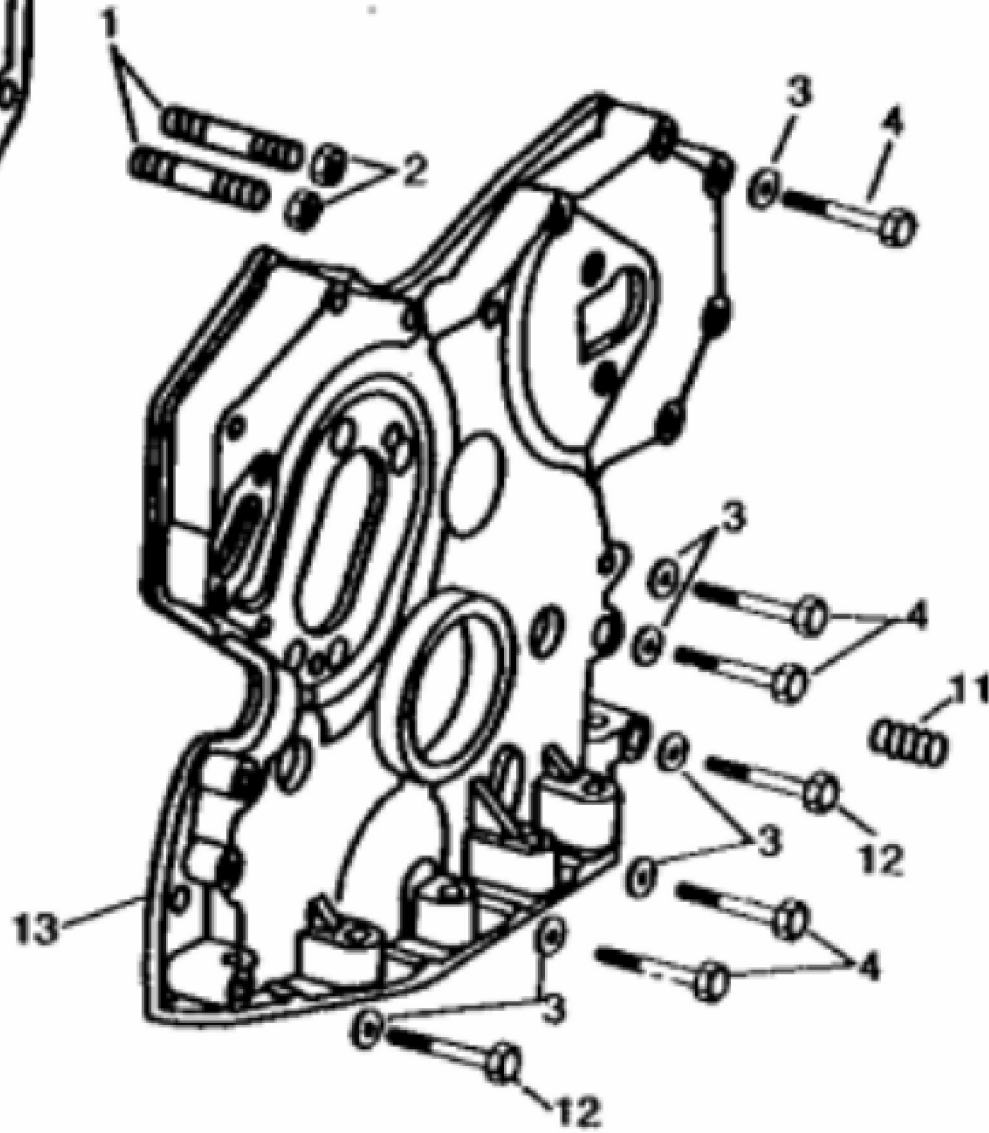

| KEY | PART NO. | PART NAME | QTY | REMARKS |
|-----|----------|-----------|-----|---|
| 1 | R122226 | STUD | 2 | (SUB FOR R122226) |
| 2 | 14H1076 | NUT | 2 | 3/8" |
| 3 | 24H1304 | WASHER | AR | 13/32" X 23/32" X 0.120" |
| 4 | 19H2549 | CAP SCREW | 10 | 3/8" X 1-7/8" |
| 5 | R78366 | GASKET | 1 | |
| 6 | R126041 | COVER | 1 | (SUB FOR T20362) |
| 7 | 19H2284 | CAP SCREW | 3 | 3/8" X 7/8" |
| 7 | R124277 | CAP SCREW | 2 | (USE WITH R126041) (SUB FOR R122618, THIS APPLICATION) |
| 8 | 19H1726 | CAP SCREW | 1 | 3/8" X 2-1/4" |
| 9 | T20272 | COVER | 1 | |
| 10 | T20273 | GASKET | 1 | |
| 11 | 15H275 | PIPE PLUG | 1 | 1/4" |
| 12 | 19H3031 | CAP SCREW | 2 | 3/8" X 2-1/2" |
| 13 | AR58196 | COVER | 1 | (MARKED R52880) (ALSO ORDER T20272, T20273, 15H275, 19H1726, (3) 19H2284 AND (4) 24H1304) (SUB RE39252) |
| 14 | T20155 | GASKET | 1 | |



Suggest:

For more complete manuals. Please go to the home page.

<https://www.ebooklibonline.com>

If the above button click is invalid. Please download this document first, and then click the above link to download the complete manual.

Thank you so much for reading

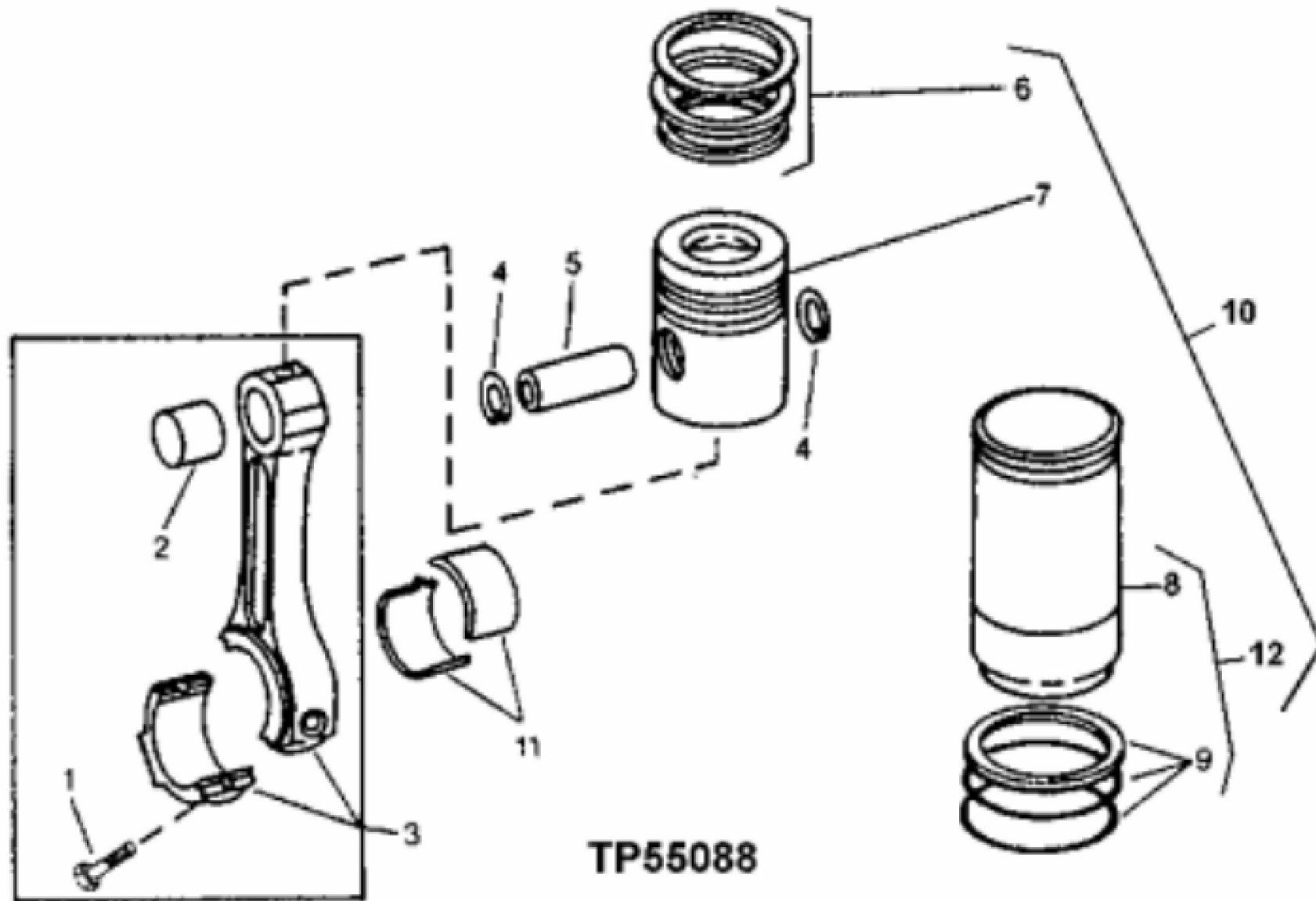

TP55088

| KEY | PART NO. | PART NAME | QTY | REMARKS |
|-----|----------|-----------------|-----|--|
| 1 | R80033 | CAP SCREW | 8 | |
| 2 | R55647 | BUSHING | 4 | |
| 3 | SE500747 | CONNECTING ROD | 4 | (MARKED R80034) (REMANUFACTURED) |
| 4 | M41029 | SNAP RING | 8 | |
| 5 | R125754 | PISTON PIN | 4 | (SUB FOR R51731) |
| 6 | RE66820 | PISTON RING KIT | 4 | (SUB FOR RE15674 AND RE48818) |
| 7 | | PISTON | 4 | (USE IF AVAIABLE) (WHEN RE19282 IS NO LONGER AVAILABLE, SUB RE30250) |
| 8 | R116281 | CYLINDER LINER | 4 | (SUB FOR R51726 OR R90059) (SUB RE500023) (SUB (4) RE30250) (RE30250 PISTON LINER KIT) |
| 9 | AR65507 | O-RING KIT | 4 | |
| 10 | RE30250 | KIT | 4 | (SUB FOR RE24458) |
| 11 | RE27348 | BEARING KIT | 4 | (SUB FOR AT21138) STANDARD (SET OF (2) T20011) |
| 11 | | BEARING | 4 | (AT21122 NO LONGER AVAILABLE) 0.05 MM (.002") UNDERSIZE (SET OF (2) T23566) |
| 11 | RE27349 | KIT | 4 | (SUB FOR AT21124) 0.25 MM (.010") UNDERSIZE (SET OF (2) T23568) |
| 11 | RE27358 | KIT | 4 | (SUB FOR AT21126) 0.51 MM (.020") UNDERSIZE (SET OF (2) T23570) |
| 11 | RE27364 | BEARING KIT | 4 | (SUB FOR AT21128) 0.76 MM (.030") UNDERSIZE (SET OF (2) T23572) |
| 12 | RE500023 | KIT | 4 | |

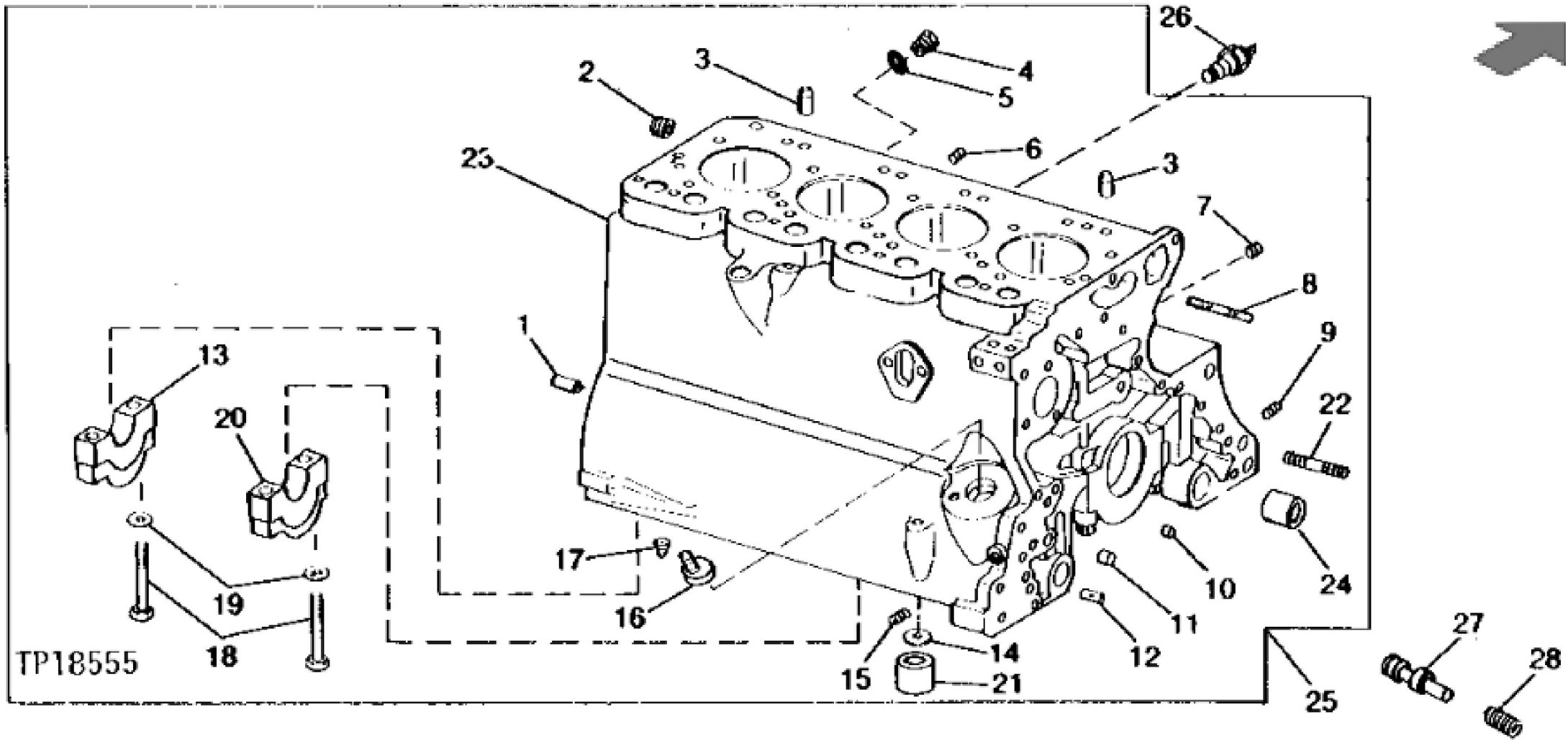

<https://www.ebooklibonline.com>

Hello dear friend!

Thank you very much for reading.

Enter the link into your browser.

The full manual is available for immediate download.

<https://www.ebooklibonline.com>