

omar178326 - 8110, 8210, 8310 and 8410 Tractors (010001-) Front Console

Front Console

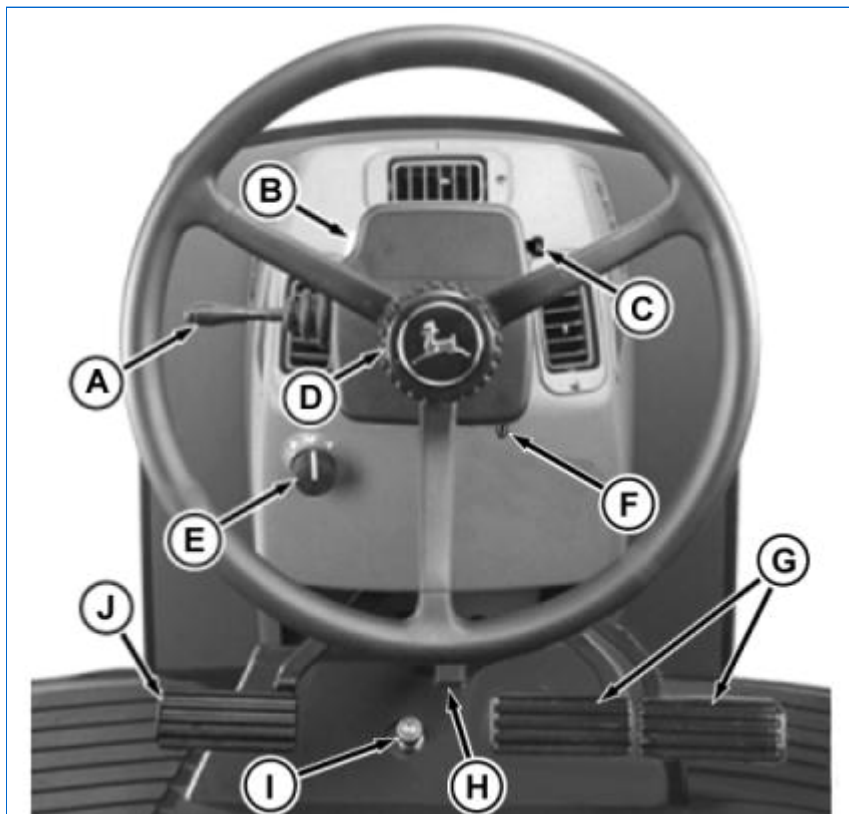

RW26224-UN: Front Console

LEGEND:

- A - Turn Signal Lever, Dimmer Switch, Horn, Flash-to-Pass
- B - Ether Aid Switch
- C - Key Switch
- D - Steering Wheel Telescope Release
- E - Air Flow Direction Knob
- F - Steering Wheel Tilt Release
- G - Brake Pedals
- H - Steering Column Foot Release
- I - Differential Lock
- J - Clutch Pedal

omar178326 - 8110, 8210, 8310 and 8410 Tractors (010001-) Corner Post Display

Corner Post Display

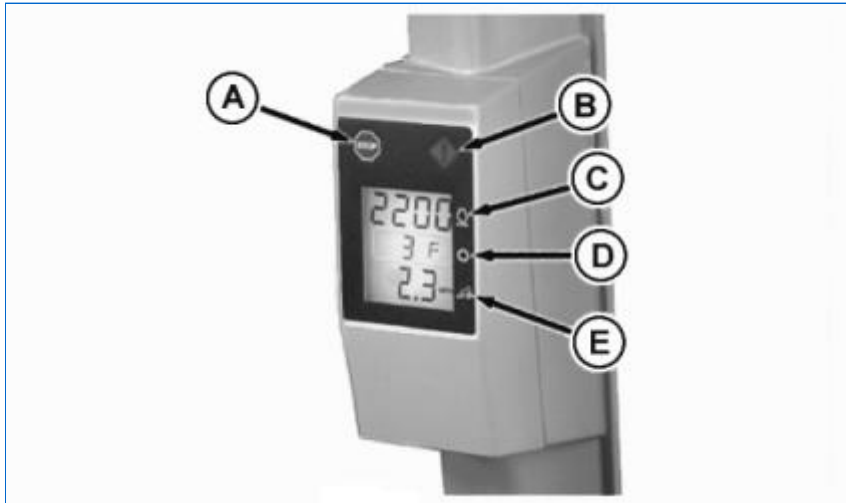

RW26225-UN: Corner Post Display

LEGEND:

- A - Stop Engine Symbol
- B - Service Alert Symbol
- C - Engine Speed
- D - Transmission Gear
- E - Ground Speed [Displays True Ground Speed With Radar; Displays Wheel Speed With No Radar]

<https://www.ebooklibonline.com>

Hello dear friend!

Thank you very much for reading.

Enter the link into your browser.

The full manual is available for immediate download.

<https://www.ebooklibonline.com>

omar178326 - 8110, 8210, 8310 and 8410 Tractors (010001-) Side Console

Side Console

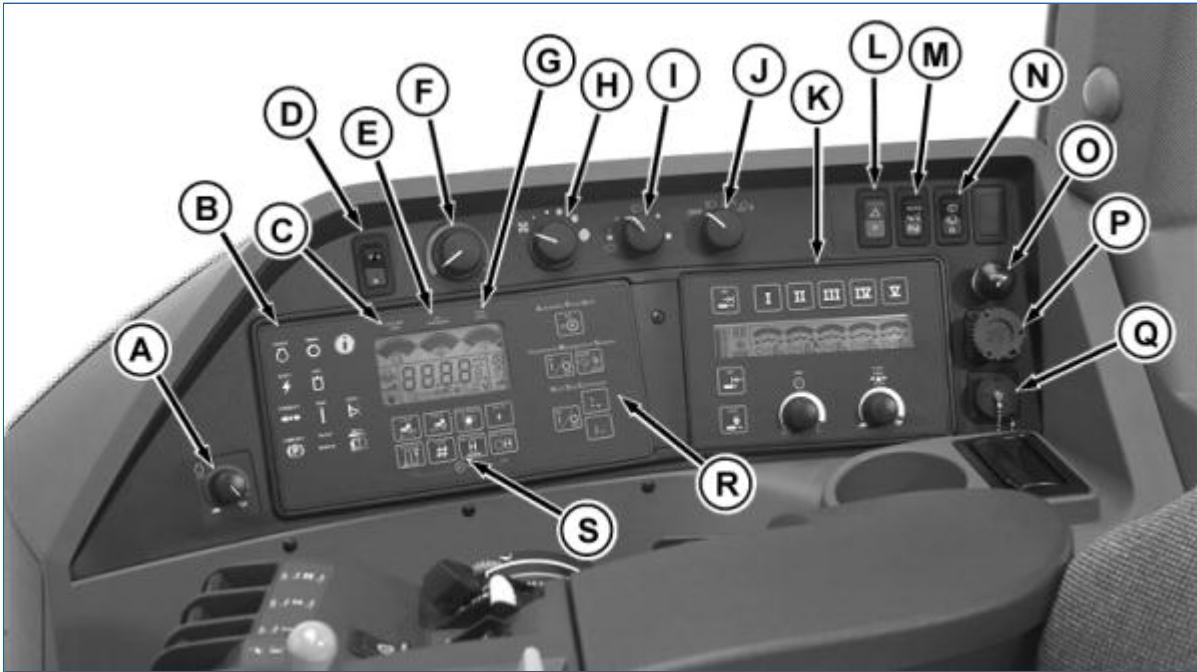

RW27030-UN: Side Console

LEGEND:

- A - Field Cruise
- B - Vehicle Monitor
- C - Engine Temperature Gauge
- D - Air Conditioning Switch
- E - Engine Oil Pressure Gauge
- F - Temperature Control
- G - Fuel Level
- H - Blower Speed Control
- I - Wiper Control
- J - Light Switch
- K - SCV TouchSet Control Panel
- L - Hazard Light Switch
- M - MFWD Switch (*Optional*)
- N - Rear Washer/Wiper Switch (*Optional*)
- O - Cigarette Lighter
- P - Diagnostic Outlet [Used only by your John Deere Dealer]
- Q - Convenience Electrical Outlet
- R - Command Control System
- S - Display Functions

omar178326 - 8110, 8210, 8310 and 8410 Tractors (010001-) Armrest Controls

Armrest Controls

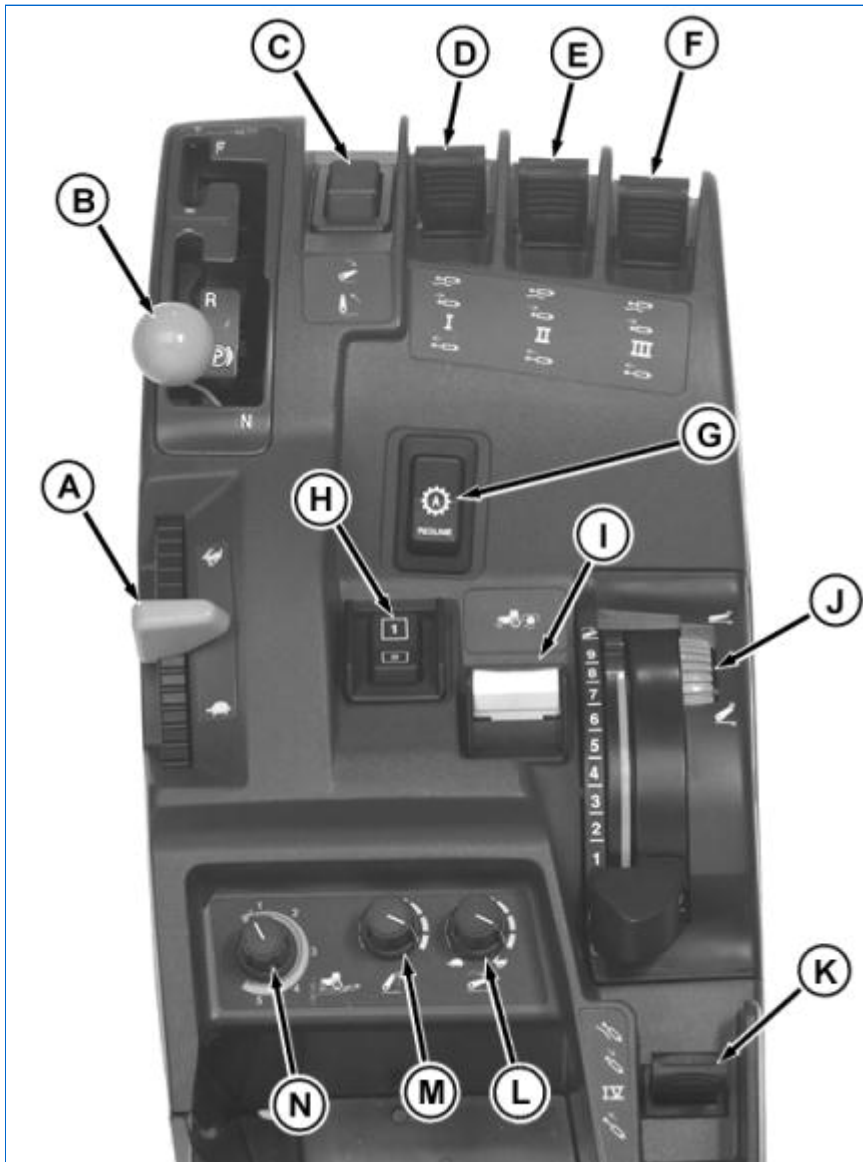

RW26227-UN: Armrest Controls

LEGEND:

- A - Hand Throttle
- B - Gear Shift Lever
- C - Hitch Raise/Lower Switch
- D - Remote Hydraulic Lever (*SCV I*)
- E - Remote Hydraulic Lever (*SCV II*)
- F - Remote Hydraulic Lever (*SCV III*)
- G - Automatic Powershift Resume Switch (*APS*)
- H - Sequence Switch (*IMS*)
- I - Rear PTO Switch
- J - Hitch Control
- K - [Label not defined in legend]
- L - [Label not defined in legend]
- M - [Label not defined in legend]
- N - [Label not defined in legend]

- K - Remote Hydraulic Lever (**SCV IV**)
- L - Hitch Rate of Drop (**Inside Armrest**)
- M - Hitch Height Limit (**Inside Armrest**)
- N - Hitch Load/Depth Control (**Inside Armrest**)

omar178326 - 8110, 8210, 8310 and 8410 Tractors (010001-) Vehicle Monitor Warning System

Vehicle Monitor Warning System



RW26228-UN: Corner Post Display

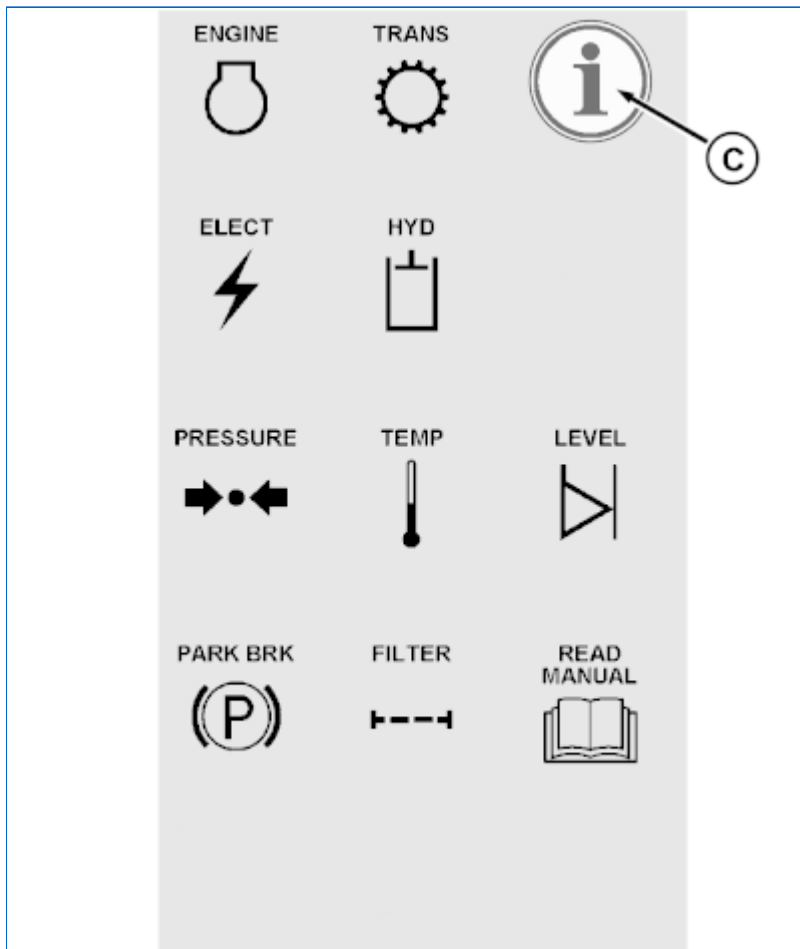

RW26229-UN: Vehicle Monitor Indicators

LEGEND:

- A - PRIORITY-Stop Engine Symbol
- B - PRIORITY-Service Alert Symbol
- C - PRIORITY-Information Symbol

IMPORTANT:

See your John Deere Dealer if any system indicates malfunction.

Vehicle monitor warning system alerts operator to malfunctions or needed service of the engine, transmission, electrical and hydraulic functions.

Indicators light and a warning sounds momentarily when the key switch is turned to the ON position.

A serious malfunction is indicated when the **Stop Engine Symbol** (A) flashes and a warning sounds in conjunction with a system indicator and function indicator. **Stop engine immediately** and determine the cause.

Automatic Shut-Down System -Engine will stop if the tractor is in PARK position, operator is not present, and the **Stop Engine Symbol** is active for more than 3 seconds.

A serious problem has developed when the **Service Alert Symbol** (B) flashes and warning horn sounds in conjunction with a system, function, or status indicator. Observe gauges and indicator lights.

A problem has developed when the **Information Symbol** (C) flashes in conjunction with a system, function, or status indicator. Continue to operate tractor and address problem when convenient.

Service codes can be viewed on the digital display whenever a “priority” lights. (See Changing Display Functions in this section.) One problem will be displayed at a time, with most severe problem overriding all others. (See Service Codes Section.)

omar178326 - 8110, 8210, 8310 and 8410 Tractors (010001-)
Vehicle Monitor

Vehicle Monitor

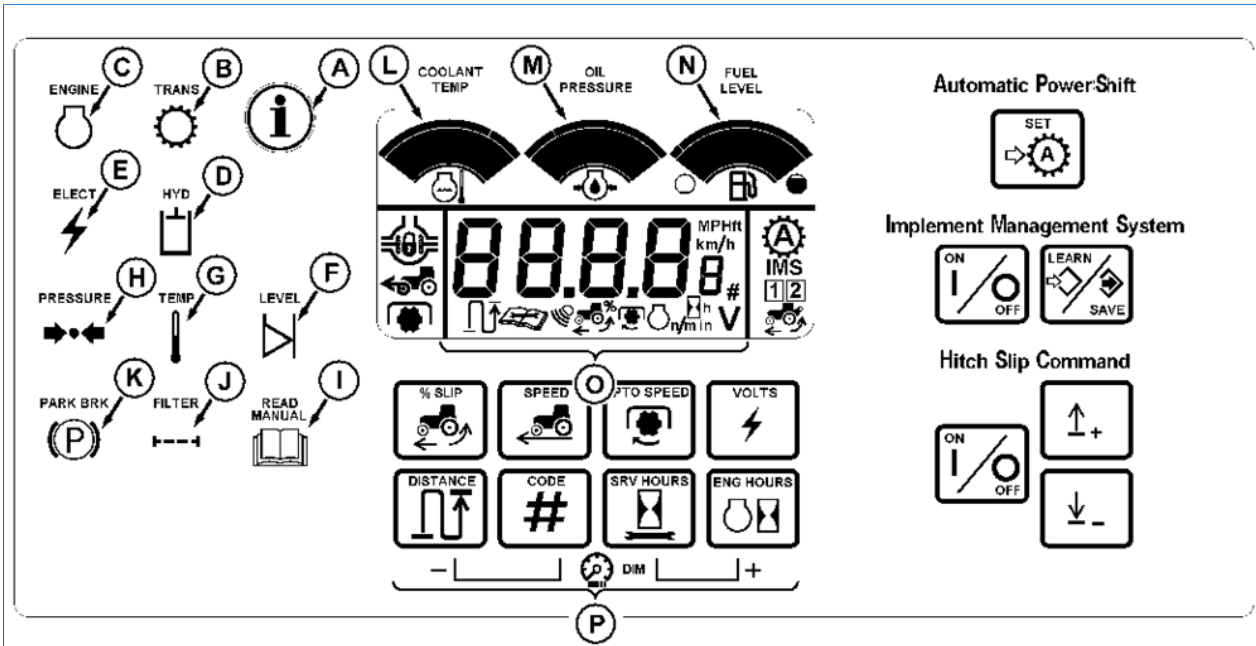

RW26230-UN: Vehicle Monitor

A "PRIORITY" is the STOP ENGINE, SERVICE ALERT, or INFORMATION indicators.

A "SYSTEM" refers to engine, transmission, hydraulic, or electrical indicators.

A "FUNCTION" refers to pressure, temperature, level, or filter.

A "STATUS" indicates operational mode.

-: Vehicle Monitor

KEY	INDICATOR	FUNCTION
A	INFORMATION	Problem has developed possibly reducing performance-Continue to operate and address problem when convenient-Push Code # and check displayed code-Indicator flashes in conjunction with a "SYSTEM", "FUNCTION", or "STATUS" indicator
B	Transmission	Flashes in conjunction with "PRIORITY" and "FUNCTION" indicators
C	Engine	Flashes in conjunction with "PRIORITY" and "FUNCTION" indicators
D	Hydraulic	Flashes in conjunction with "PRIORITY" and "FUNCTION" indicators
E	Electrical	Flashes in conjunction with "PRIORITY" and "FUNCTION" indicators
F	Level	Flashes in conjunction with "PRIORITY" and "SYSTEM" indicators
G	Temperature	Flashes in conjunction with "PRIORITY" and "SYSTEM" indicators
H	Oil Pressure	Flashes in conjunction with "PRIORITY" and "SYSTEM" indicators
I	Read Manual	Lights in conjunction with "PRIORITY" indicator and "FUNCTION" indicator-See Service Sections
J	Filter	Flashes in conjunction with "PRIORITY" and "SYSTEM" indicators
K	Park Brake	Lights when transmission is in PARK position
L	Coolant Temperature	Indicates coolant temperature of engine
M	Oil Pressure	Indicates oil pressure of engine
N	Fuel	Indicates remaining amount of fuel-Flashes when approximately 60 L (16 gal) of fuel remains
O	Digital Display *	Displays percent wheel slip, ground speed, PTO speed, distance traveled, service codes, hours since last service, electrical system voltage, and total engine hours
P	Function Selectors	Changes digital display functions

* Wheel Slip, Ground Speed, and Distance Traveled requires radar for accurate reading

omar178326 - 8110, 8210, 8310 and 8410 Tractors (010001-) Changing Display Functions

Changing Display Functions

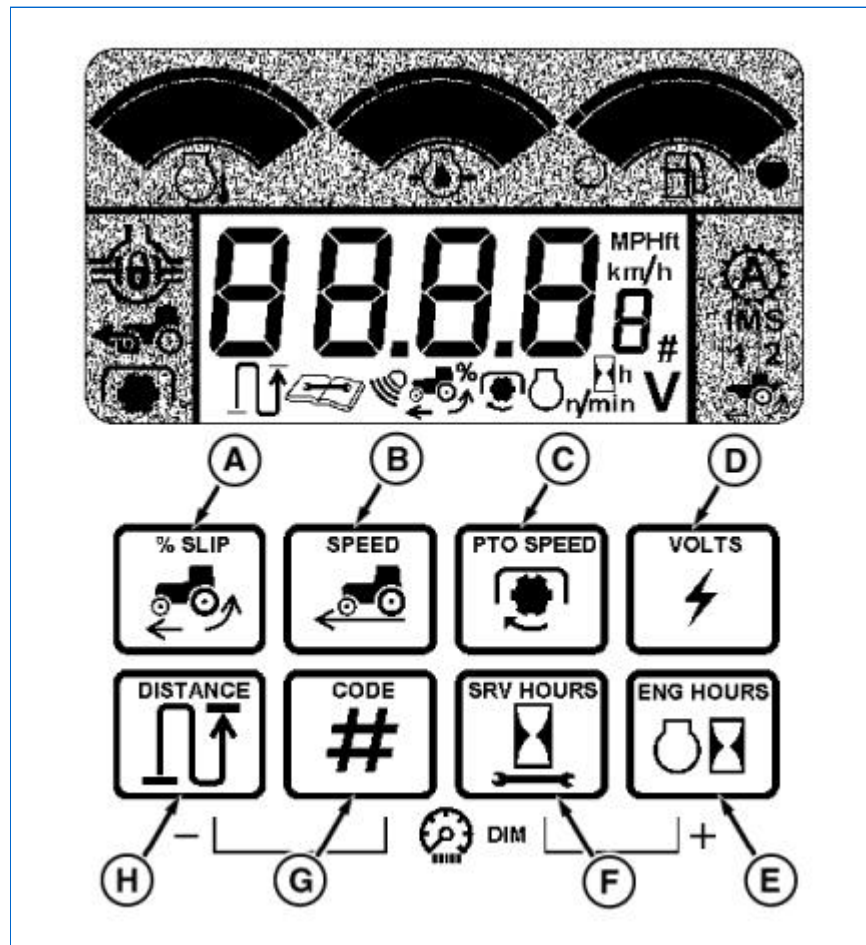

RW26231-UN: Change Display Functions Using Touch Switches

LEGEND:

- A - Wheel Slip Percentage
- B - Ground Speed
- C - PTO Speed
- D - Voltage
- E - Engine Hours
- F - Service Hours
- G - Service Codes
- H - Distance Traveled

Display functions are changed using the touch switches on the center of the vehicle monitor.

Ground Speed and Wheel Slip (TRACTORS WITH RADAR)

NOTE:

*Dashes are displayed for tractors **without** radar unit.*

The calculated ground speed does not allow for traction slip.

Press % slip switch (A) to display percent of wheel slip.

Press ground-speed switch (B) to display true ground speed. Pressing switch a second time will change to a calculated speed. Display will alternate between axle speed and true ground speed each time switch is pressed.

PTO Speed

Press PTO speed switch (C) to display the PTO rpm.

Volts

Press volts switch (D) to display the current system voltage in tenths of volts.

Engine Hours

NOTE:

Tenths of hours digit is half size and decimal point is implied.

Press engine hours switch (E) to display accumulated engine hours.

Service Hours

Press service hours switch (F) to display operating hours since tractor was last serviced. Display will show current service hours and service book symbol will flash when operating hours since last service exceeds interval set point.

NOTE:

The service hour set point can be changed. See your John Deere Dealer.

Default service interval set point is 250 hours. Press switch (F) for 3 seconds to reset to zero after scheduled service.

Service Code

Press code switch (G) to display code for current active alarm, if any. Press switch to display electronic controller and code number. Record controller and code number for future reference.

Check code displayed with codes listed in Service Codes Section to find possible solution for problem listed beside service code.

NOTE:

Alarms can be suppressed, for the duration of the operation, by pressing the code switch for 7 seconds. The alarm will reappear the next time the tractor is started, if the problem still exists.

Distance Traveled

NOTE:

Radar is required for accurate readings to adjust for traction slippage.

Press distance switch (H) to display distance in feet (meters) since tractor was started or distance traveled was reset. Reset to zero by pressing switch for three seconds.

Engine Coolant Temperature

Hold switches (B) and (G) simultaneously to display current engine coolant temperature.

Hydraulic Oil Temperature

Holding switches (C) and (F) simultaneously will display current hydraulic oil temperature.

Display Light Intensity

Night-time light intensity for all displays can be adjusted when the light switch is in the "ON" position.

Pressing switches (E) and (F) simultaneously on panel will INCREASE the light intensity. Pressing switches (G) and (H) simultaneously will DECREASE the intensity.

NOTE:

Key switch must remain ON for 30 seconds to save new setting.

omar178326 - 8110, 8210, 8310 and 8410 Tractors (010001-) Calibrating Tire Size-With Radar

Calibrating Tire Size-With Radar

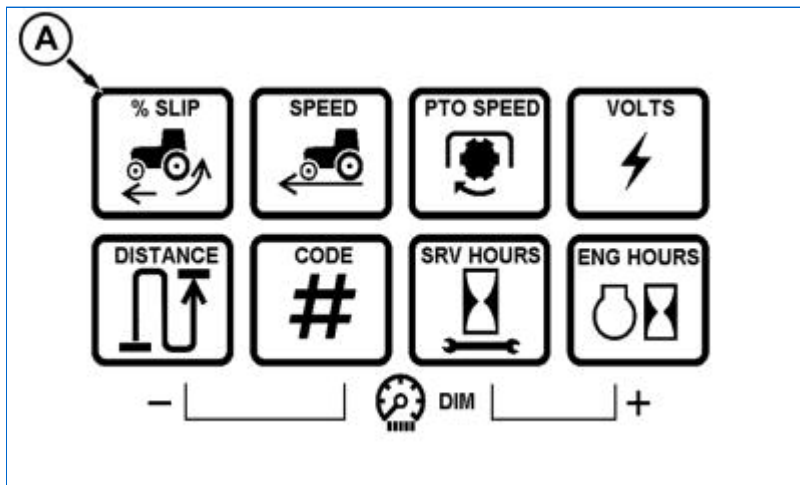

RW26232-UN: Calibrate Tire Size-With Radar

NOTE:

Calibrating tire size is necessary to obtain accurate wheel slip percentage. Calibration needs to be taken on a hard surface with no load.

Drive tractor straight at 8 km/h (5 mph) while pressing and holding wheel slip switch (A) for three seconds. Display will read zero percent wheel slip if calibrated correctly. Display will read **Err** if not calibrated correctly.

NOTE:

Tractor must be moving and radar installed correctly to ensure correct wheel slip calibration. See Calibrating Radar.



Suggest:

For more complete manuals. Please go to the home page.

<https://www.ebooklibonline.com>

If the above button click is invalid. Please download this document first, and then click the above link to download the complete manual.

Thank you so much for reading

omar178326 - 8110, 8210, 8310 and 8410 Tractors (010001-) Calibrating Radar

Calibrating Radar

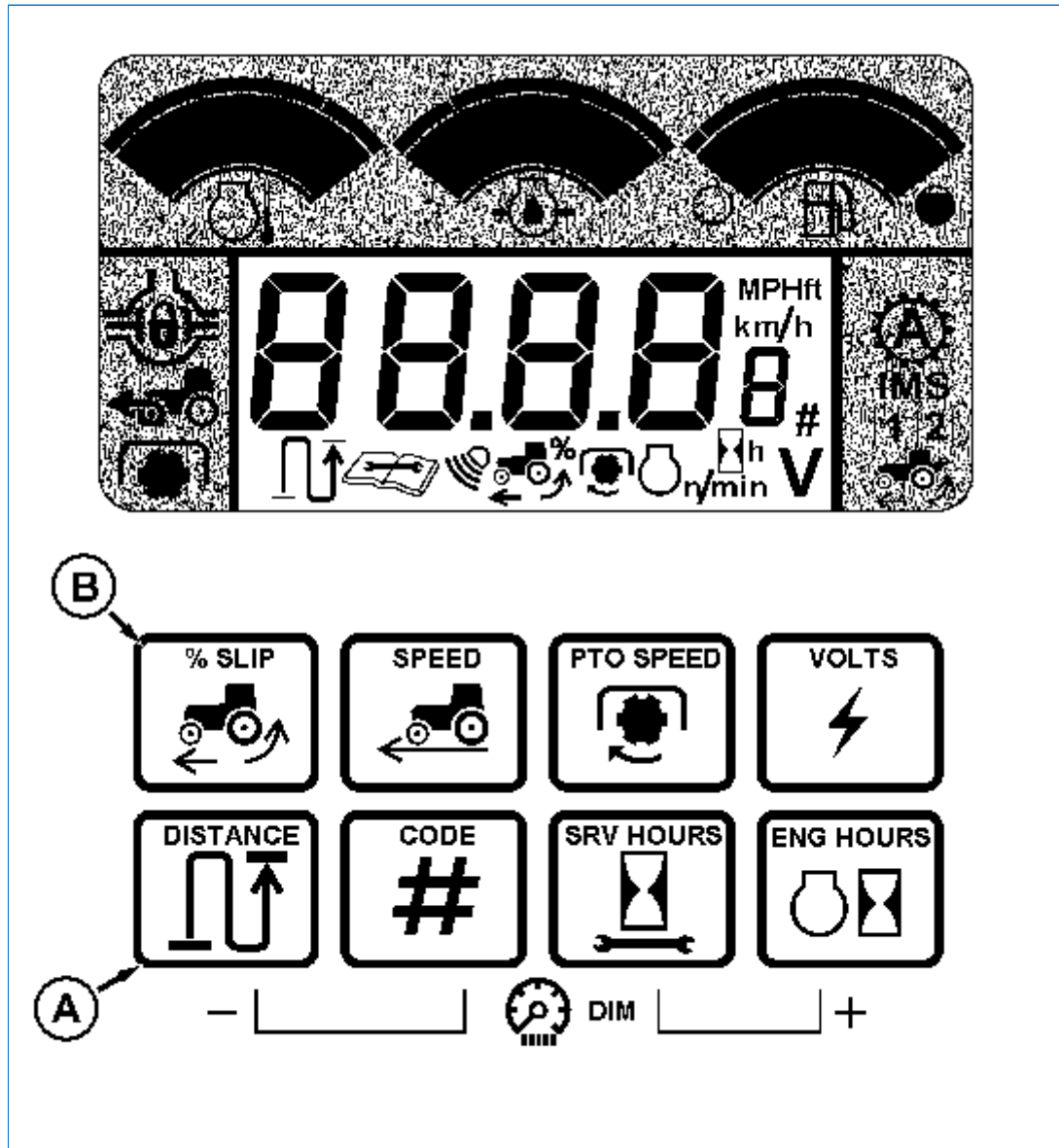

RW26233-UN: Recalibrate Radar as Tire/Tractor Load Change

NOTE:

Changing tire size or loading of tractor can cause angle of radar to change which will require a recalibration of the radar system.

Mark a straight-line course of 122 m (400 ft).

At starting point, press and hold distance touch switch (A) for 3 seconds. Display will show zero.

Drive tractor at approximately 3.2 km/h (2 mph) to the 122 m (400 ft) mark and stop.

NOTE:

Do not backup if end point is exceeded. Return to starting point and repeat procedure.

Press percent slip touch switch (B) and distance touch switch (A) simultaneously. Display will show "End" if calibration was successful. If not, display will show "Err" and calibration should be performed again at a slightly faster speed, but less than 11.3 km/h (7 mph).

<https://www.ebooklibonline.com>

Hello dear friend!

Thank you very much for reading.

Enter the link into your browser.

The full manual is available for immediate download.

<https://www.ebooklibonline.com>