

# omar116314 - 8100, 8200, 8300 and 8400 Tractors ( -010000) Operating Lights

## Operating Lights

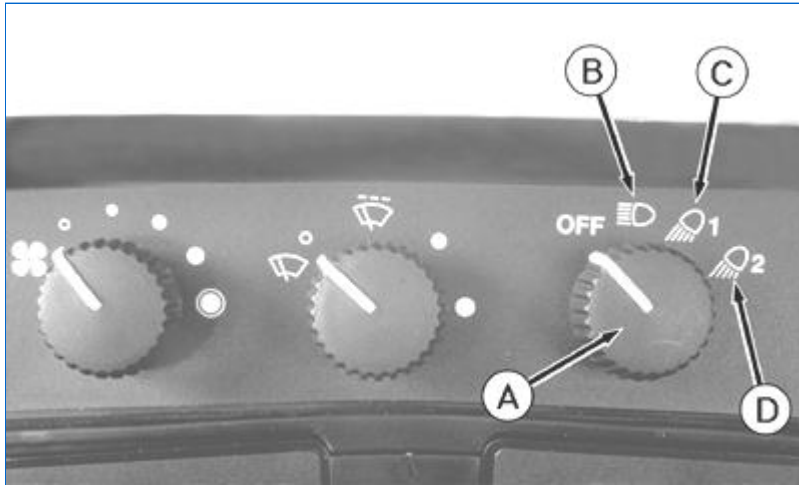

RW55221-UN: Operating Light Locations

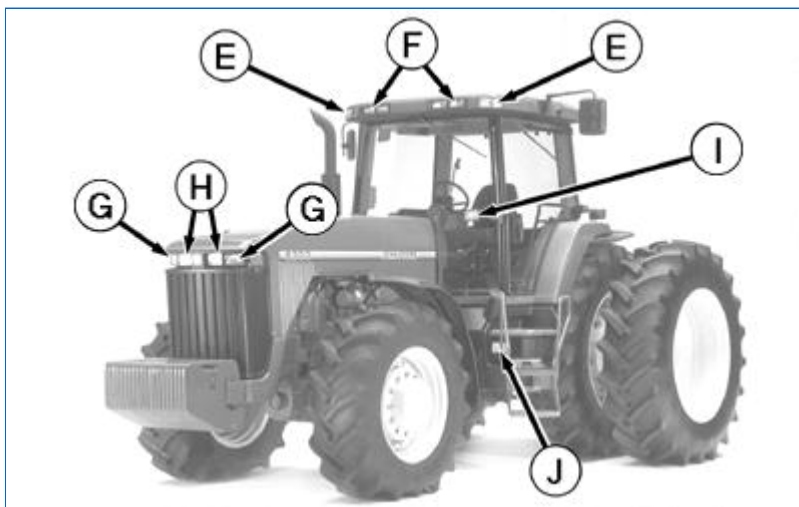

RW55222-UN: Operating Light Locations

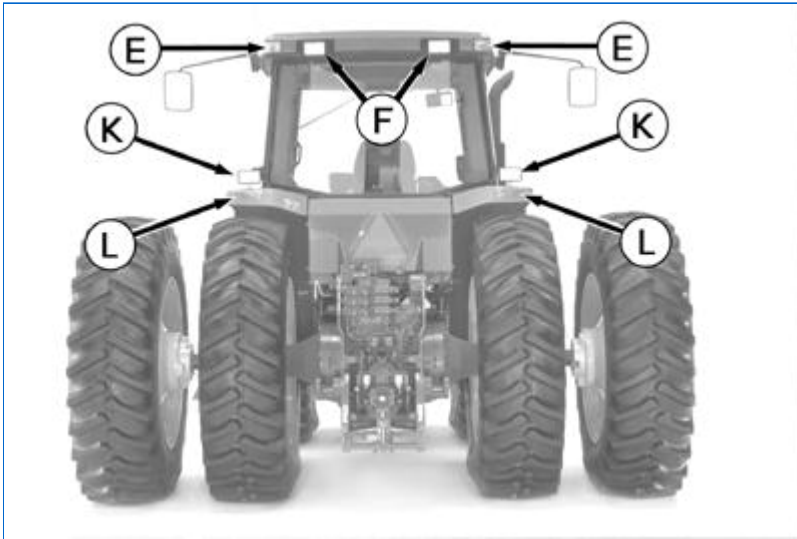

RW55223-UN: Operating Light Locations

**LEGEND:**

- A - Light Switch
- B - Road Position
- C - Field Position 1
- D - Field Position 2
- E - Amber Warning Lights
- F - Roof Flood Lights
- G - Front Flood Lights
- H - Head Lights
- I - Upper Side Flood Lights *(Optional)*
- J - Lower Side Flood Lights
- K - Rear Fender Flood Lights
- L - Red Tail Lights



**CAUTION:**

*Avoid injury caused by accidental collision with another vehicle. Use headlights, flashing warning lights, and turn signals day and night. Always comply with traffic regulations when driving tractor on a road and follow local regulations for equipment lighting and marking. Dim headlights to low-beam for oncoming vehicles. Avoid using flood lights which could blind or confuse other drivers.*

The light switch (A) has four positions and operates regardless of the key position.

**OFF POSITION -**

Turns off all lights

**ROAD POSITION - (B)**

-: Road Position

Low Beam Position:      High Beam Position:

Head Lights

Head Lights

**<https://www.ebooklibonline.com>**

Hello dear friend!

Thank you very much for reading.

Enter the link into your browser.

The full manual is available for immediate download.

**<https://www.ebooklibonline.com>**

Amber Warning Lights Amber Warning Lights

Tail Lights

Tail Lights

**FIELD POSITION 1 - (C)**

-: Field Position 1

Low Beam Position: High Beam Position:

Head Lights

Head Lights

Front Floods

Front Floods

Rear Fender Floods Rear Fender Floods

Lower Side Floods Lower Side Floods

Upper Side Floods Upper Roof Floods

Rear Roof Floods

**FIELD POSITION 2 - (D)**

-: Field Position 2

Low Beam Position: High Beam Position:

Head Lights

Head Lights

Front Floods

Front Floods

Rear Fender Floods Rear Fender Floods

Lower Side Floods Lower Side Floods

Front Roof Floods Front Roof Floods

Rear Roof Floods

## omar116314 - 8100, 8200, 8300 and 8400 Tractors ( -010000) Operating Hazard Light

---

### Operating Hazard Light

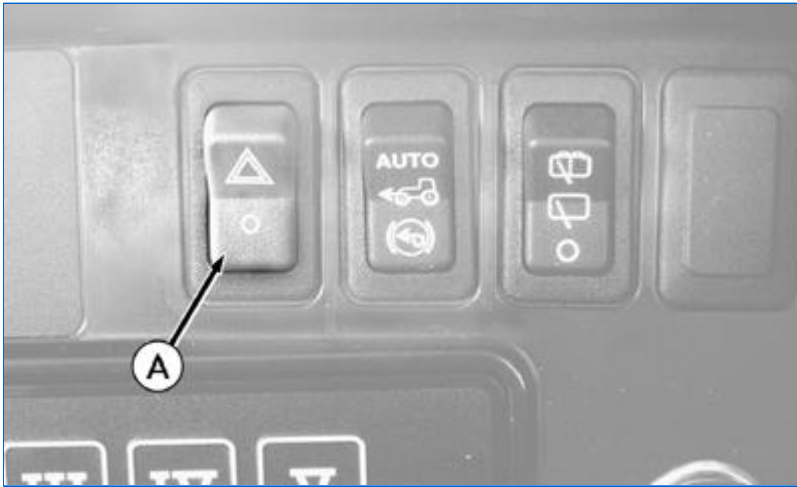

RW55224-UN: Operating Hazard Light Switch

Push top of switch (A) to activate lights.

Turn signals operate as hazard lights regardless of key position.

# omar116314 - 8100, 8200, 8300 and 8400 Tractors ( -010000) Operating Turn Signals, Horn and High/Low Beam

---

## Operating Turn Signals, Horn and High/Low Beam

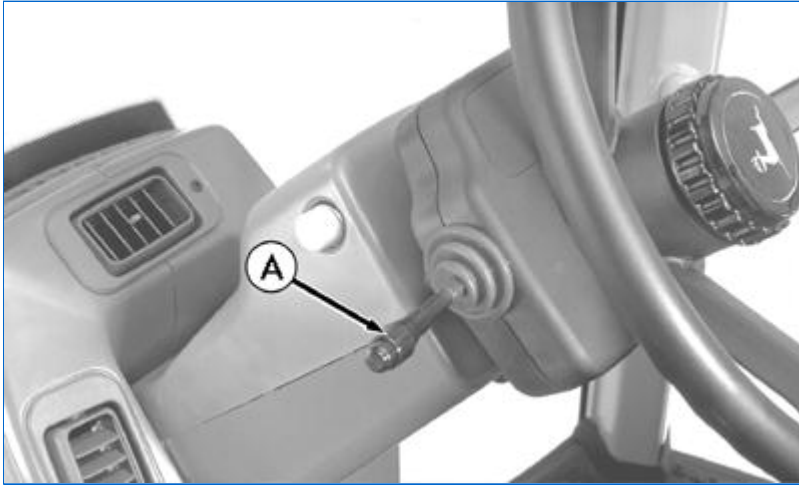

RW55225-UN: Turn Signal Lever

### Turn Signals

Push lever (A) up for a right turn, or pull down for a left turn. Return lever to center position after completing turn.

### Horn

Push inward on end of lever (A) to activate horn.

### High/Low Beam

Push lever (A) forward to activate high beam head lights.

Pull lever into center position to operate low beam.

Pull lever toward you and release to flash high beam.

Dim headlights for oncoming vehicles. Adjust headlights correctly. (See Service/As Required Section.)



**Suggest:**

**For more complete manuals. Please go to the home page.**

**<https://www.ebooklibonline.com>**

**If the above button click is invalid. Please download this document first, and then click the above link to download the complete manual.**

**Thank you so much for reading**

# omar116314 - 8100, 8200, 8300 and 8400 Tractors ( -010000) Seven-Terminal Outlet

## Seven-Terminal Outlet

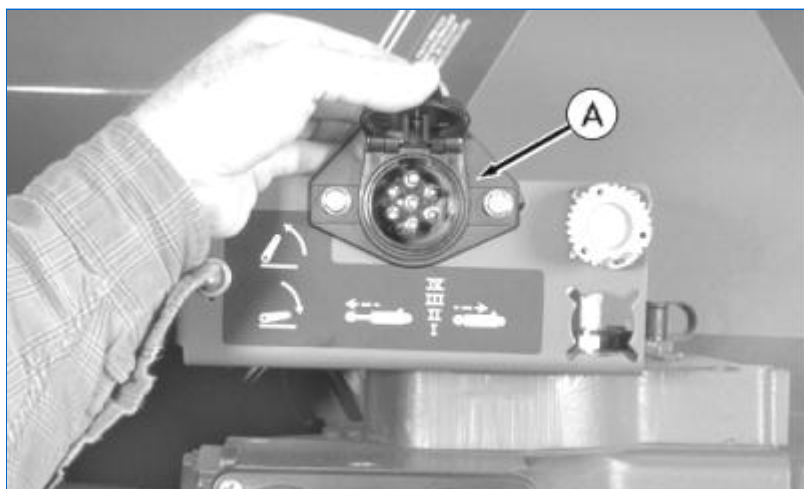

RW55226-UN: Seven-Terminal Outlet

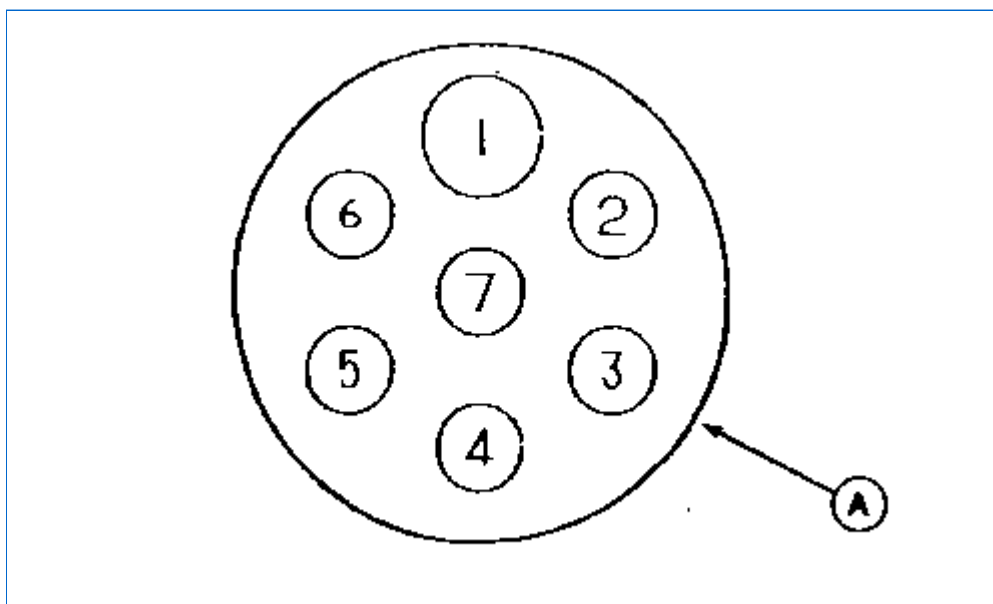

RW21249-UN: Seven-Terminal Outlet

Outlet (A) is used to connect lights, turn signals, and remote electrical equipment on trailers or implements. Always use auxiliary light on towed implement when tractor rear signals and other lights are obscured.

### *NOTE:*

*Matching plug is available through your John Deere Dealer.*

-: Seven-Terminal Outlet

**Terminal Function Wire Color**

- 1 Ground Black
- 2 Flood Light White
- 3 Left Turn Dark Green
- 4 Accessory Red
- 5 Right Turn Dark Green
- 6 Tail Light Gray
- 7 Accessory Red

**<https://www.ebooklibonline.com>**

Hello dear friend!

Thank you very much for reading.

Enter the link into your browser.

The full manual is available for immediate download.

**<https://www.ebooklibonline.com>**