



Service Repair Manual

Models

385C FS Excavator

[Previous Screen](#)

Product: FRONT SHOVEL

Model: 385C FRONT SHOVEL MMA

Configuration: 385C FS Excavator MMA00001-UP (MACHINE) POWERED BY C-18 Engine

Disassembly and Assembly C15 and C18 Engines for Caterpillar Built Machines

Media Number -REN8261-28

Publication Date -01/08/2015

Date Updated -28/08/2018

i02905549

Valve Actuator (Variable) - Remove

SMCS - 1105-011

Removal Procedure

Start By:

- a. Remove the valve mechanism cover. Refer to Disassembly and Assembly, "Valve Mechanism Cover - Remove and Install".

Note: Do not disassemble the variable valve actuator after the component has been removed. Any attempt to disassemble the variable valve actuator will void the warranty of the component.

NOTICE

Care must be taken to ensure that fluids are contained during performance of inspection, maintenance, testing, adjusting, and repair of the product. Be prepared to collect the fluid with suitable containers before opening any compartment or disassembling any component containing fluids.

Refer to Special Publication, NENG2500, "Dealer Service Tool Catalog" for tools and supplies suitable to collect and contain fluids on Cat products.

Dispose of all fluids according to local regulations and mandates.

NOTICE

Keep all parts clean from contaminants.

Contaminants may cause rapid wear and shortened component life.

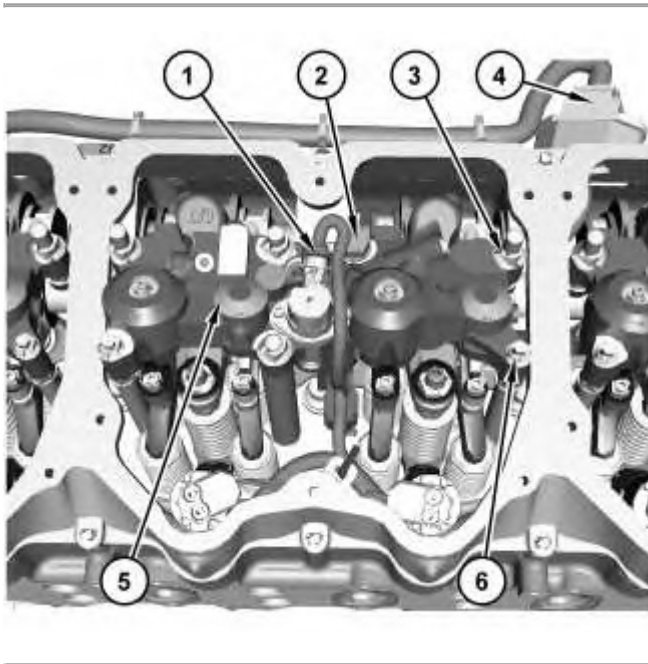

Illustration 1

g01446246

1. Disconnect harness assembly (4). Disconnect harness assembly (1).
2. Remove bolt (2). Remove four nuts (3) and two nuts (6).
3. Remove variable valve actuator (5).

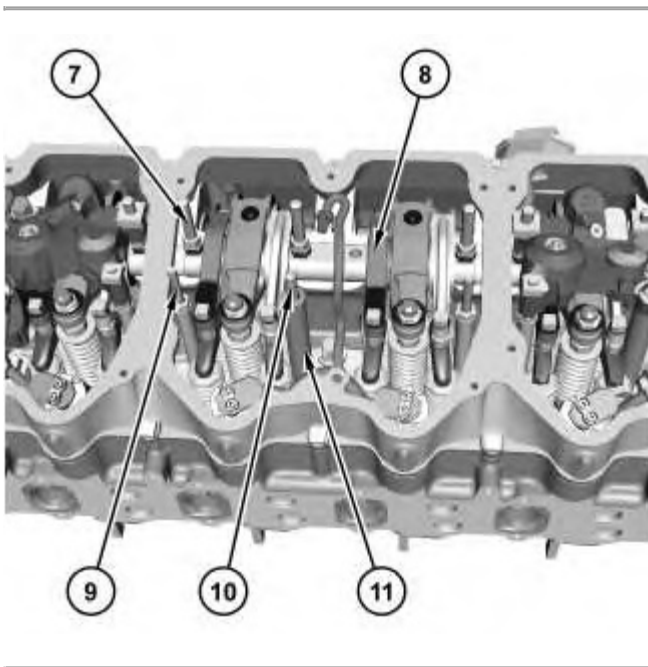

Illustration 2

g01446248

4. Remove support (11) and stud (10).

<https://www.ebooklibonline.com>

Hello dear friend!

Thank you very much for reading.

Enter the link into your browser.

The full manual is available for immediate download.

<https://www.ebooklibonline.com>

5. Remove two studs (9) and three studs (7).

6. Remove rocker arm assembly (8).

[Copyright 1993 - 2020 Caterpillar Inc.](#)

Mon Oct 12 11:41:36 UTC+0800 2020

[All Rights Reserved.](#)

[Private Network For SIS Licensees.](#)

[Previous Screen](#)

Product: FRONT SHOVEL

Model: 385C FRONT SHOVEL MMA

Configuration: 385C FS Excavator MMA00001-UP (MACHINE) POWERED BY C-18 Engine

Disassembly and Assembly C15 and C18 Engines for Caterpillar Built Machines

Media Number -REN8261-28

Publication Date -01/08/2015

Date Updated -28/08/2018

i02905633

Valve Actuator (Variable) - Install

SMCS - 1105-012

Installation Procedure

NOTICE

Keep all parts clean from contaminants.

Contaminants may cause rapid wear and shortened component life.

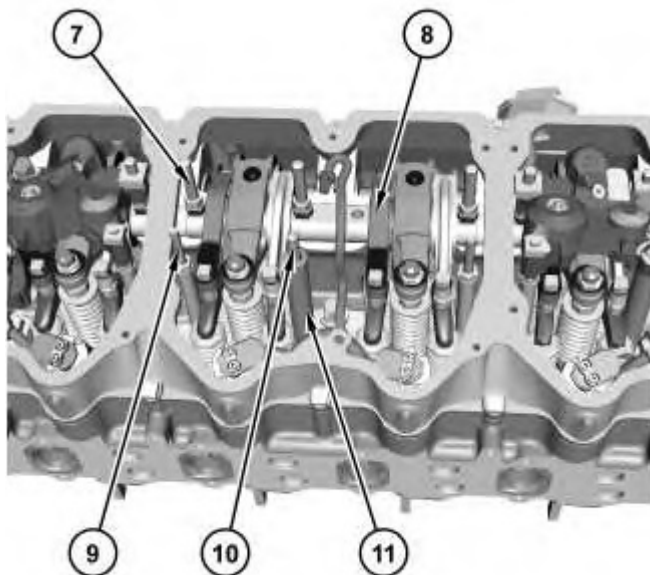

Illustration 1

g01446248

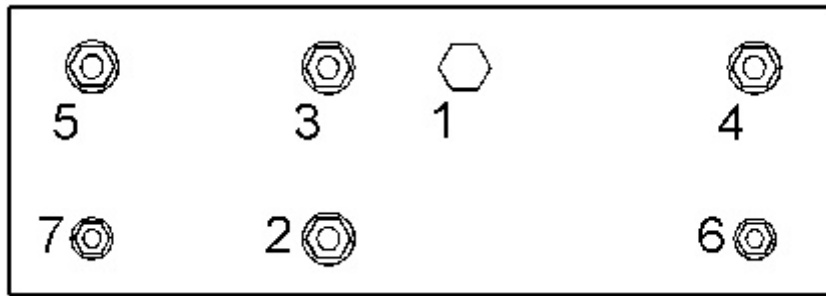

Illustration 2

g01446408

1. Install two studs (9) at Location 6 and Location 7. Tighten studs (9) to a torque of $47 \pm 9 \text{ N}\cdot\text{m}$ ($35 \pm 7 \text{ lb ft}$).
2. Install stud (10) at Location 2. Tighten stud (10) to a torque of $65 \pm 10 \text{ N}\cdot\text{m}$ ($48 \pm 7 \text{ lb ft}$). Install support (11).
3. Position rocker arm assembly (8). Install three studs (7) at Location 3, Location 4, and Location 5. Tighten studs (7) to a torque of $50 \pm 5 \text{ N}\cdot\text{m}$ ($37 \pm 4 \text{ lb ft}$). Turn studs (7) for an additional 45 ± 5 degrees.

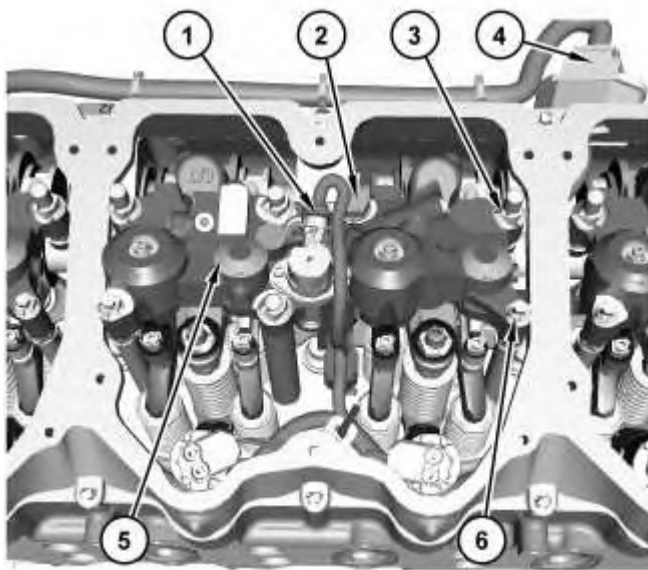

Illustration 3

g01446246

4. Install variable valve actuator (5).
 5. Install bolt (2). Install four nuts (3). Install two nuts (6). Refer to the tightening sequence.
 6. Tighten bolt (2) to a torque of $105 \pm 20 \text{ N}\cdot\text{m}$ ($77 \pm 15 \text{ lb ft}$). Tighten nuts (3) to a torque of $105 \pm 20 \text{ N}\cdot\text{m}$ ($77 \pm 15 \text{ lb ft}$). Tighten nuts (6) to a torque of $47 \pm 9 \text{ N}\cdot\text{m}$ ($35 \pm 7 \text{ lb ft}$). Tighten the nuts and the bolt in a numerical sequence.
 7. Connect harness assembly (4). Connect harness assembly (1) to variable valve actuator (5).
-

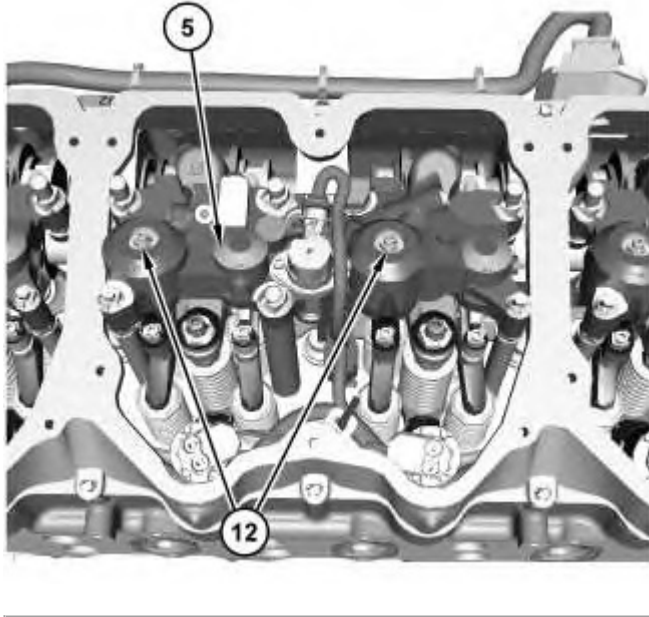

Illustration 4

g01446444

8. First adjust the lash on the exhaust and then adjust the compression brake on variable valve actuator (5). Refer to Testing and Adjusting, "Compression Brake Lash - Adjust" for more information on adjusting the lash for the compression brake. Tighten jam nut (12) to a torque of $15 \pm 3 \text{ N}\cdot\text{m}$ ($11 \pm 2 \text{ lb ft}$).

End By:

- a. Install the valve mechanism cover. Refer to Disassembly and Assembly, "Valve Mechanism Cover - Remove and Install".

[Previous Screen](#)

Product: FRONT SHOVEL

Model: 385C FRONT SHOVEL MMA

Configuration: 385C FS Excavator MMA00001-UP (MACHINE) POWERED BY C-18 Engine

Disassembly and Assembly C15 and C18 Engines for Caterpillar Built Machines

Media Number -REN8261-28

Publication Date -01/08/2015

Date Updated -28/08/2018

i02906282

Rocker Arm and Shaft - Remove

SMCS - 1102-011

Removal Procedure

Table 1

Required Tools			
Tool	Part Number	Part Description	Qty
A	124-2946	Lifting Bracket	1

Start By:

- A. Remove the valve mechanism cover. Refer to Disassembly and Assembly, "Valve Mechanism Cover - Remove and Install".
- B. Remove the variable valve actuator, if necessary. Refer to Disassembly and Assembly, "Valve Actuator (Variable) - Remove".

NOTICE

Keep all parts clean from contaminants.

Contaminants may cause rapid wear and shortened component life.

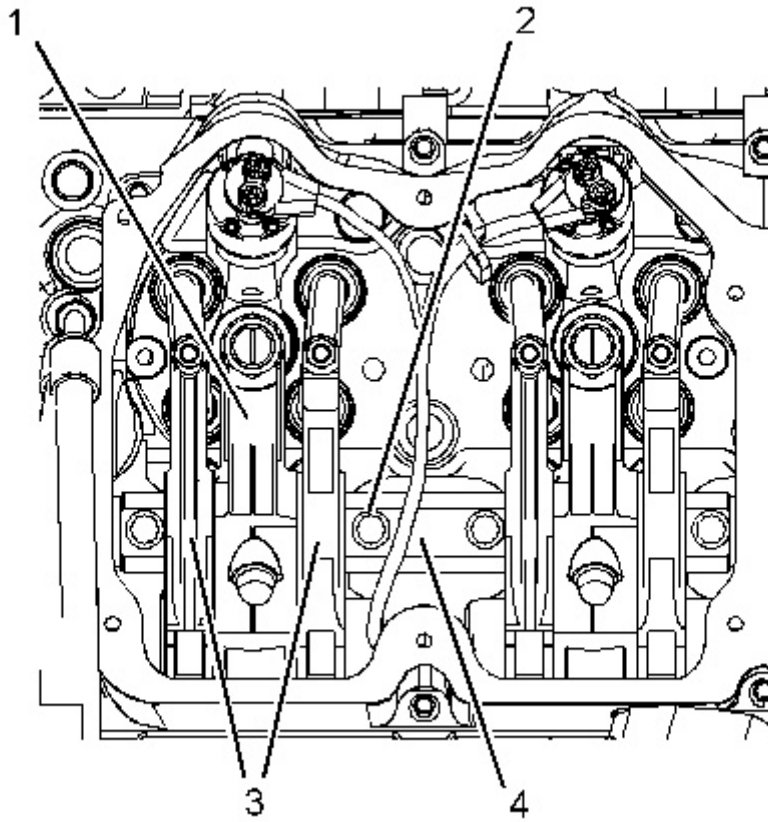

Illustration 1

g01117306

1. Remove bolts (2) .
2. Use Tooling (A) to remove rocker arm shaft assembly (4) , valve rocker arms (3) , and electronic unit injector rocker arms (1) as a unit.

[Previous Screen](#)

Product: FRONT SHOVEL

Model: 385C FRONT SHOVEL MMA

Configuration: 385C FS Excavator MMA00001-UP (MACHINE) POWERED BY C-18 Engine

Disassembly and Assembly C15 and C18 Engines for Caterpillar Built Machines

Media Number -REN8261-28

Publication Date -01/08/2015

Date Updated -28/08/2018

i04997049

Rocker Arm - Disassemble

SMCS - 1123-015

Disassembly Procedure

Start By:

- a. Remove the rocker arms and the rocker shaft. Refer to Disassembly and Assembly, "Rocker Arm and Shaft - Remove".

NOTICE

Keep all parts clean from contaminants.

Contaminants may cause rapid wear and shortened component life.

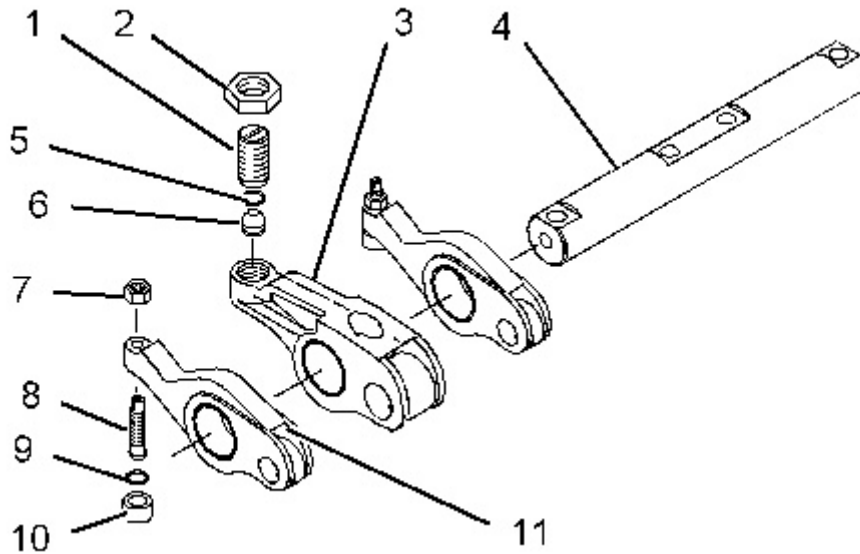

Illustration 1

g01047557

1. Remove valve rocker arms (11) and electronic unit injector rocker arm (3) from rocker shaft assembly (4).
2. Remove jam nut (7) from adjustment screw (8).
3. Remove adjustment screw (8) from valve rocker arms (11).
4. Remove button (10) from adjustment screw (8). Remove O-ring seal (9) from the adjustment screw.
5. Remove jam nut (2) from unit injector adjustment screw (1).
6. Remove unit injector adjustment screw (1) from electronic unit injector rocker arm (3).
7. Remove button (6) from unit injector adjustment screw (1). Remove O-ring seal (5) from the unit injector adjustment screw.

Previous Screen

Product: FRONT SHOVEL

Model: 385C FRONT SHOVEL MMA

Configuration: 385C FS Excavator MMA00001-UP (MACHINE) POWERED BY C-18 Engine

**Disassembly and Assembly
C15 and C18 Engines for Caterpillar Built Machines**

Media Number -REN8261-28

Publication Date -01/08/2015

Date Updated -28/08/2018

i04998150

Rocker Arm - Assemble

SMCS - 1123-016

Assembly Procedure

NOTICE

Keep all parts clean from contaminants.

Contaminants may cause rapid wear and shortened component life.

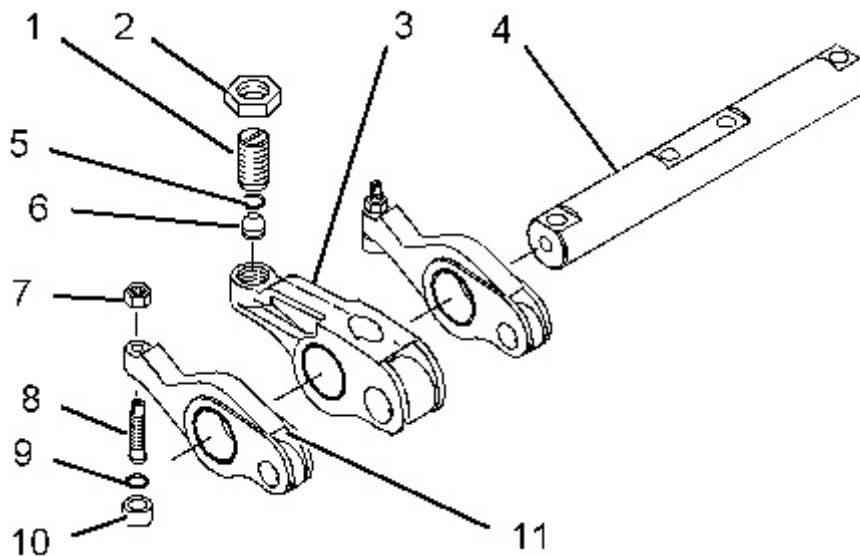

Note: Do not reuse the O-ring seal on the adjustment screw if the button is removed from the adjustment screw.

1. Install O-ring seal (9) in button (10).
2. Use a soft hammer to seat button (10) on adjustment screw (8).
3. Install adjustment screw (8) in valve rocker arms (11). Install jam nut (7) on the adjustment screw.
4. Install O-ring seal (5) in button (6).
5. Use a soft hammer to seat button (6) on unit injector adjustment screw (1).
6. Install unit injector adjustment screw (1) in electronic unit injector rocker arm (3). Install jam nut (2) on the unit injector adjustment screw.
7. Lubricate rocker shaft assembly (4) with clean engine oil.
8. Install valve rocker arms (11) and electronic unit injector rocker arm (3) on rocker shaft assembly (4).

End By:

- a. Install the rocker arms and the rocker shaft. Refer to Disassembly and Assembly, "Rocker Arm and Shaft - Install".

Previous Screen

Product: FRONT SHOVEL

Model: 385C FRONT SHOVEL MMA

Configuration: 385C FS Excavator MMA00001-UP (MACHINE) POWERED BY C-18 Engine

**Disassembly and Assembly
C15 and C18 Engines for Caterpillar Built Machines**

Media Number -REN8261-28

Publication Date -01/08/2015

Date Updated -28/08/2018

i07394739

Rocker Arm and Shaft - Install

SMCS - 1102-012

Installation Procedure

Table 1

Required Tools			
Tool	Part Number	Part Description	Qty
A	124-2946	Lifting Bracket	1

NOTICE

Keep all parts clean from contaminants.

Contaminants may cause rapid wear and shortened component life.

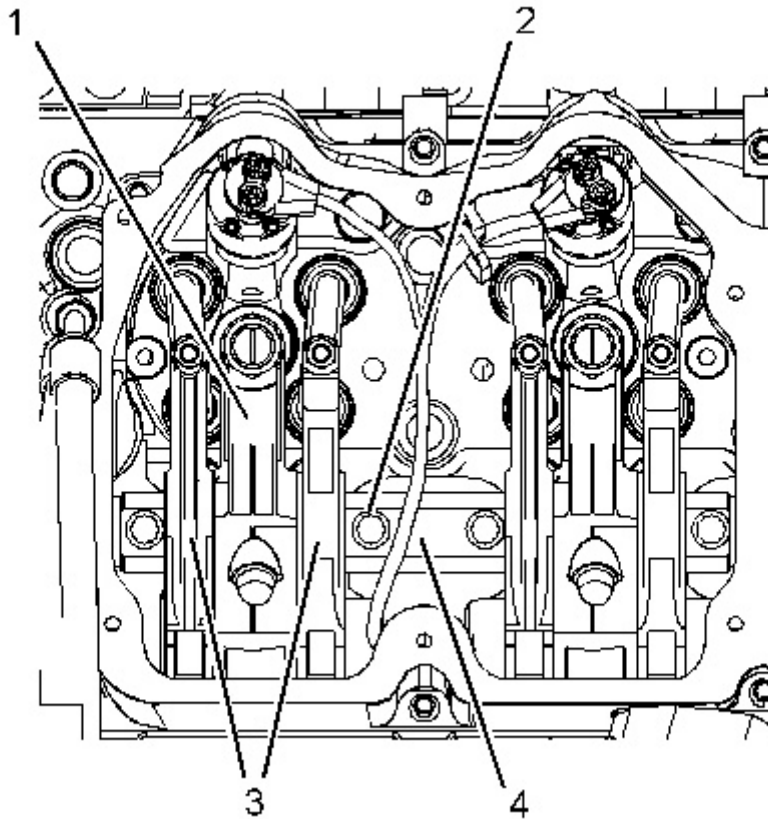

Illustration 1

g01117306

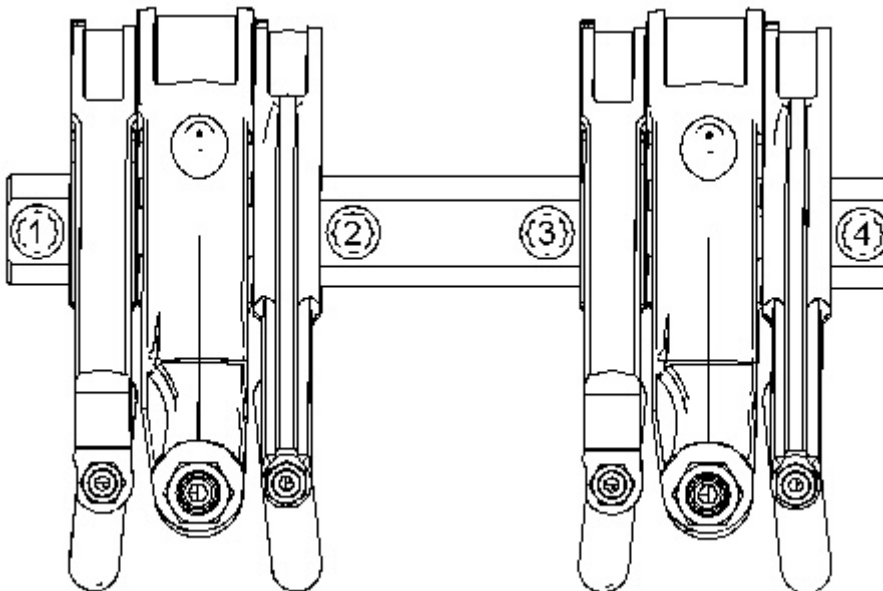

Illustration 2

g01325993

1. Position rocker arm shaft assembly (4), valve rocker arms (3), and electronic unit injector rocker arms (1) as a unit with Tooling (A) on the cylinder head.

Note: Apply clean engine oil to the underside of the bolt heads prior to installation.

2. Install bolts (2) and tighten to a torque of 55 ± 5 N·m (41 ± 4 lb ft). Tighten bolts (2) again to a torque of 55 ± 5 N·m (41 ± 4 lb ft). Turn bolts (2) for an additional 60 ± 5 degrees. Tighten the bolts in the following sequence: 2, 3, 1, 4.
3. Adjust the electronic unit injectors. Refer to Testing and Adjusting, "Electronic Unit Injector - Adjust".
4. Adjust the engine valve lash. Refer to Testing and Adjusting, "Engine Valve Lash-Inspect/Adjust".

End By:

- a. Install the variable valve actuator, if necessary. Refer to Disassembly and Assembly, "Valve Actuator (Variable) - Install".
- b. Install the valve mechanism cover. Refer to Disassembly and Assembly, "Valve Mechanism Cover - Remove and Install".

[Previous Screen](#)

Product: FRONT SHOVEL

Model: 385C FRONT SHOVEL MMA

Configuration: 385C FS Excavator MMA00001-UP (MACHINE) POWERED BY C-18 Engine

Disassembly and Assembly C15 and C18 Engines for Caterpillar Built Machines

Media Number -REN8261-28

Publication Date -01/08/2015

Date Updated -28/08/2018

i02211115

Cylinder Head - Remove

SMCS - 1100-011

Removal Procedure

Start By:

- a. Remove the camshaft gear. Refer to Disassembly and Assembly, "Camshaft Gear - Remove and Install".
- b. Remove the electronic unit injectors. Refer to Disassembly and Assembly, "Electronic Unit Injector - Remove".
- c. Remove the valve mechanism cover base. Refer to Disassembly and Assembly, "Valve Mechanism Cover Base - Remove and Install".
- d. Remove the turbochargers. Refer to Disassembly and Assembly, "Turbocharger - Remove".

NOTICE

Care must be taken to ensure that fluids are contained during performance of inspection, maintenance, testing, adjusting, and repair of the product. Be prepared to collect the fluid with suitable containers before opening any compartment or disassembling any component containing fluids.

Refer to Special Publication, NENG2500, "Dealer Service Tool Catalog" for tools and supplies suitable to collect and contain fluids on Cat products.

Dispose of all fluids according to local regulations and mandates.

NOTICE

Keep all parts clean from contaminants.

Contaminants may cause rapid wear and shortened component life.

NOTICE

Do not turn the crankshaft or the camshaft while the camshaft gear is removed. If the front gear group is not correctly timed during installation, interference can occur between the pistons and the valves, resulting in damage to the engine.

1. Drain the cooling system. Refer to Operation and Maintenance Manual, "Cooling System Coolant - Change".
-

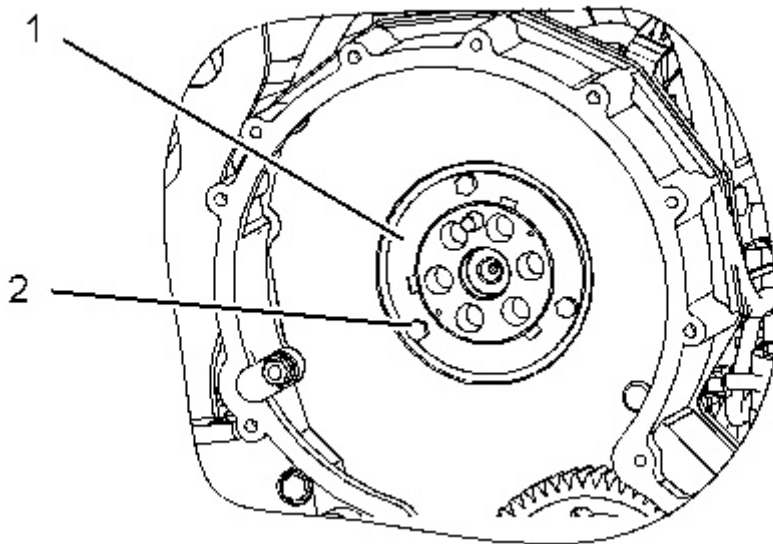

Illustration 1

g01056681

2. Remove bolts (2) and thrust plate (1).
-

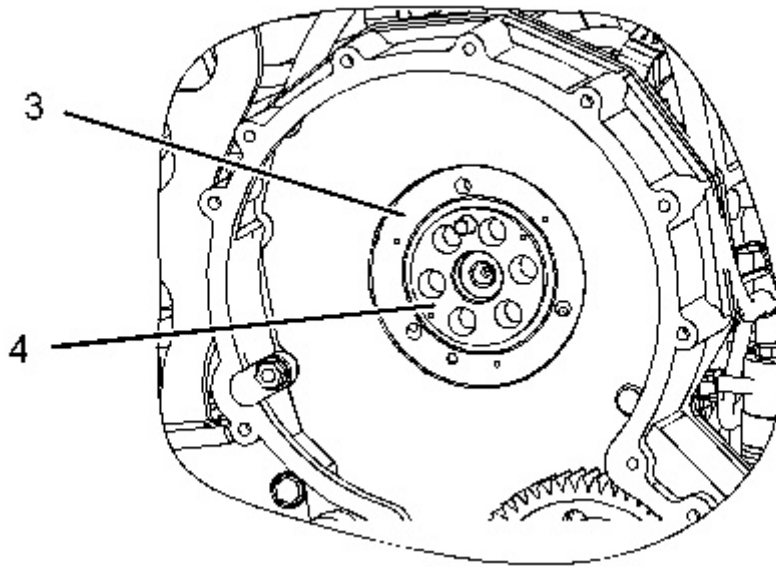

Illustration 2

g01116390

3. Remove sealing plate (3) and adapter assembly (4).
-

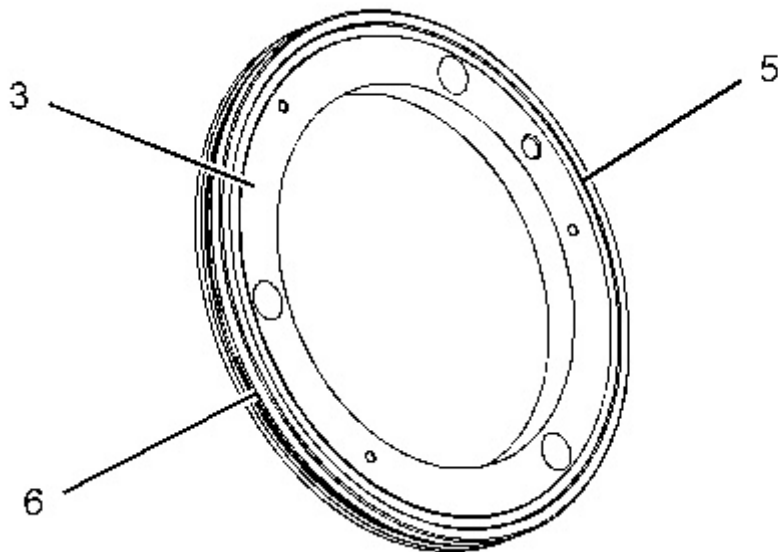

Illustration 3

g01056684

4. Remove O-ring seal (5) and O-ring seal (6) from sealing plate (3).
-

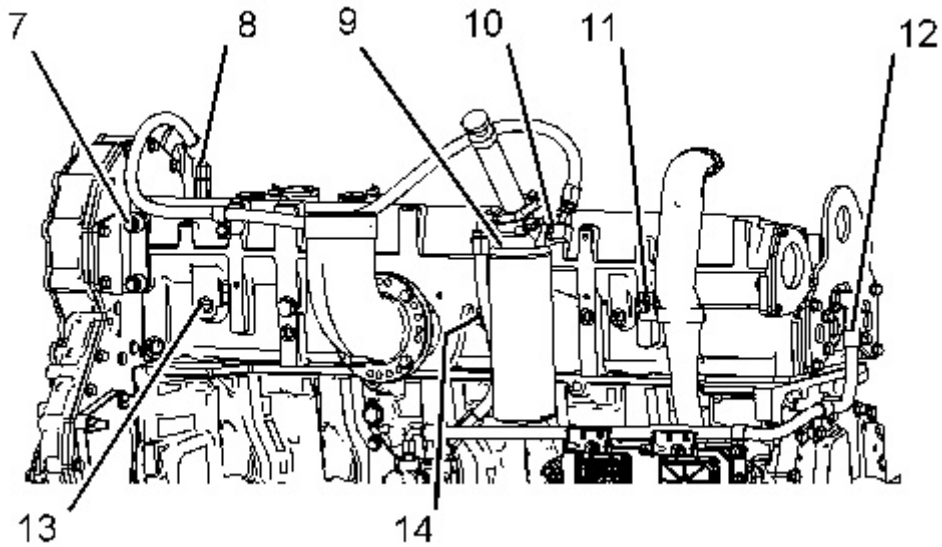

Illustration 4

g01117768

5. Disconnect hose assembly (8).
 6. Disconnect hose assembly (12).
 7. Remove bolts (10). Position fuel filter base (9) out of the way.
 8. Remove bolt (11) and the breather tube from the cylinder head.
 9. Remove bolts (7) and remove the bracket from the cylinder head.
 10. Disconnect boost pressure sensor (13).
 11. Disconnect inlet air temperature sensor (14).
-

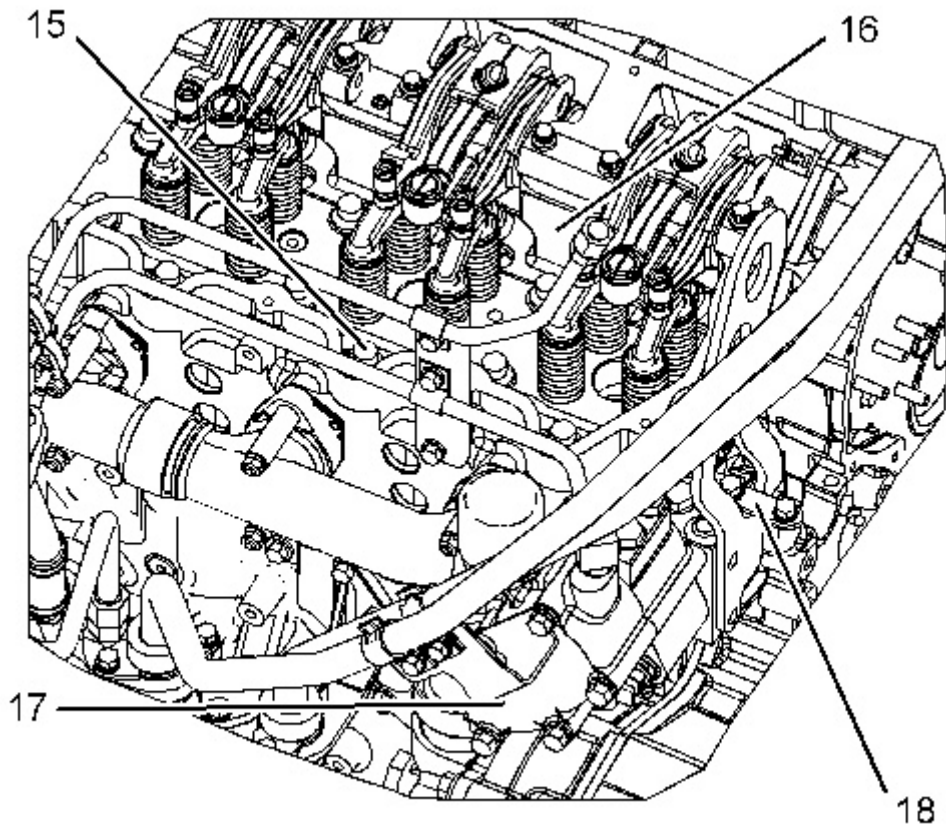

Illustration 5

g01116398

12. Remove water temperature regulator housing (17).
 13. Remove strap (18).
 14. Attach a suitable lifting device to cylinder head (16). The weight of the cylinder head is approximately 235 kg (518 lb).
 15. Remove cylinder head bolts (15).
 16. Carefully remove cylinder head (16).
-

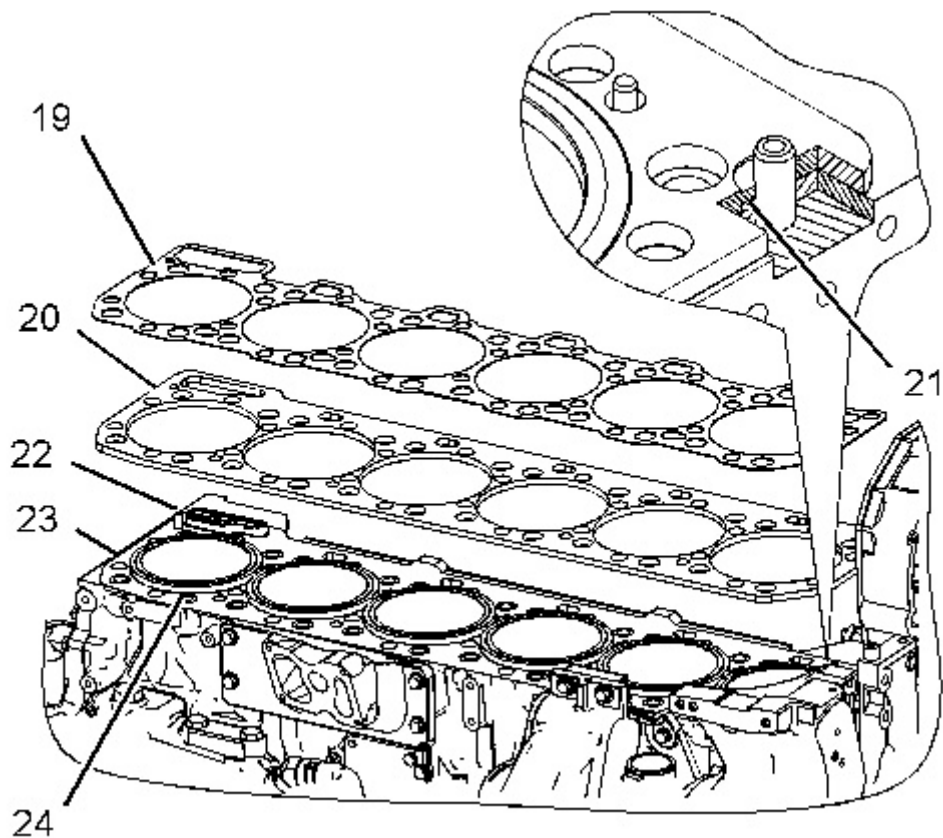

Illustration 6

g01117797

17. Remove cylinder head gasket (19).
18. Remove spacer plate (20).
19. Remove seals (24) and seal (22).
20. Remove spacer plate gasket (23).
21. Remove O-ring seal (21) from the dowel in the cylinder block.

Previous Screen

Product: FRONT SHOVEL

Model: 385C FRONT SHOVEL MMA

Configuration: 385C FS Excavator MMA00001-UP (MACHINE) POWERED BY C-18 Engine

**Disassembly and Assembly
C15 and C18 Engines for Caterpillar Built Machines**

Media Number -REN8261-28

Publication Date -01/08/2015

Date Updated -28/08/2018

i04410295

Cylinder Head - Install

SMCS - 1100-012

Installation Procedure

Table 1

Required Tools			
Tool	Part Number	Part Description	Qty
A	6V-4876	Lubricant	1
B	8T-2998	Lubricant	1
C	9S-3263	Thread Lock Compound	1

NOTICE

Keep all parts clean from contaminants.

Contaminants may cause rapid wear and shortened component life.

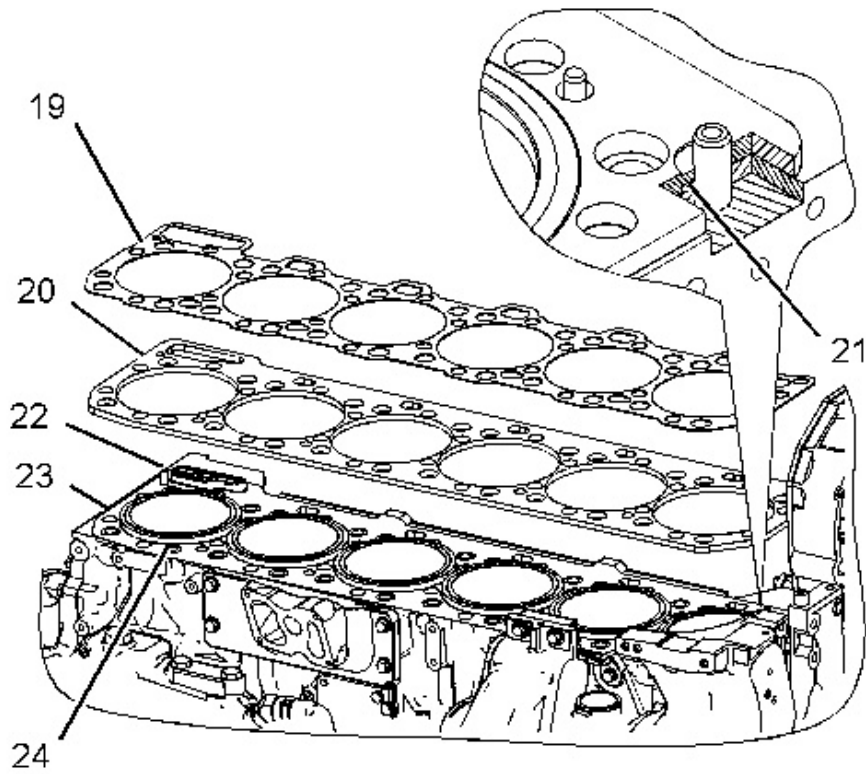

Illustration 1

g01117797

1. Install O-ring seal (21) on the dowel in the cylinder block.
 2. Install spacer plate gasket (23) on the cylinder block.
 3. Install seals (24) and seal (22) .
 4. Install spacer plate (20) .
 5. Install cylinder head gasket (19) on the spacer plate.
-



Suggest:

If the above button click is invalid.

Please download this document

first, and then click the above link

to download the complete manual.

Thank you so much for reading

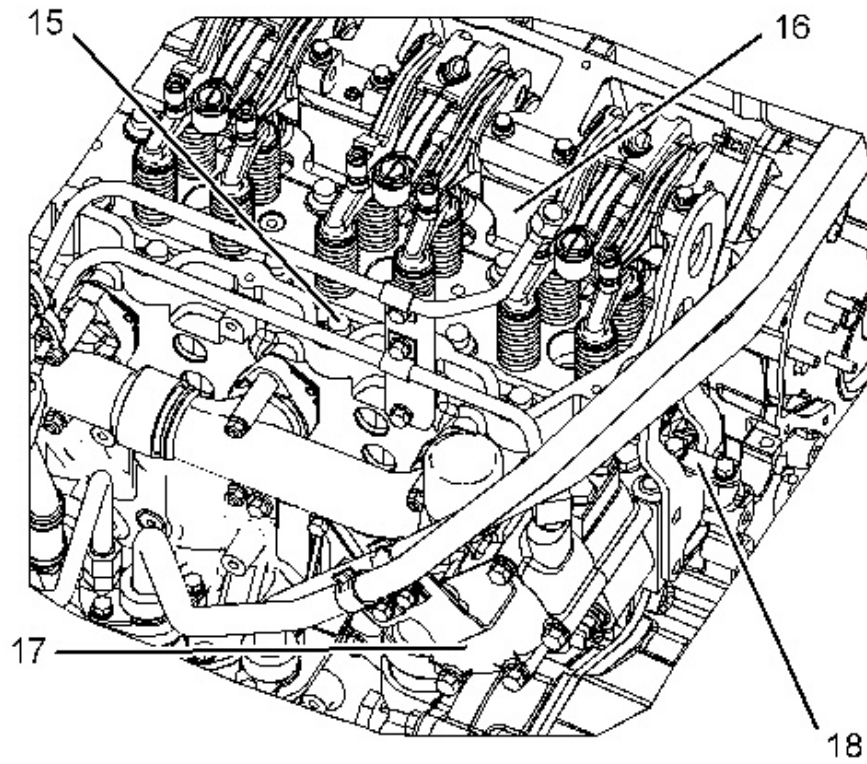
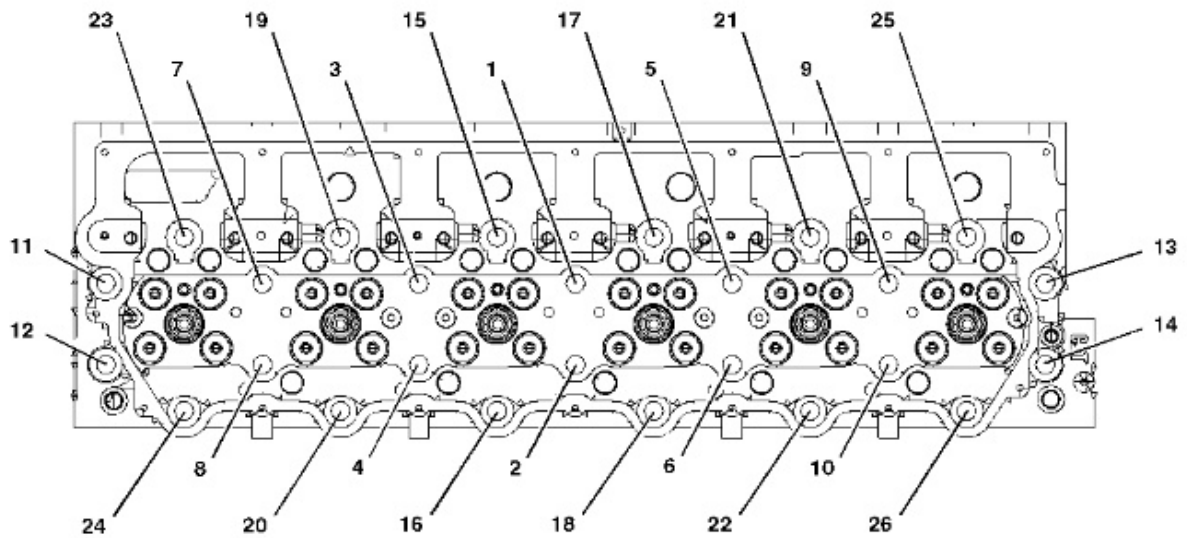

Illustration 2

g01116398

6. Attach a suitable lifting device to cylinder head (16) . The weight of the cylinder head is approximately 235 kg (518 lb).
7. Carefully install cylinder head (16) on the dowel pins on the cylinder block.



<https://www.ebooklibonline.com>

Hello dear friend!

Thank you very much for reading.

Enter the link into your browser.

The full manual is available for immediate download.

<https://www.ebooklibonline.com>